

SAMEDAN OIL CORPORATION  
2207 WILCO BUILDING  
MIDLAND, TEXAS 79701

January 4, 1974

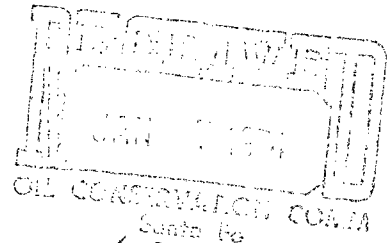

Oil Conservation Commission  
State of New Mexico  
P. O. Box 2088  
Santa Fe, New Mexico 87501

Attention: Mr. A. L. Porter, Jr.

RE: Unorthodox Location Request  
East Morton-Wolfcamp Pool  
Lea County, New Mexico

Dear Mr. Porter:

Samedan Oil Corporation requests administrative approval of an unorthodox location for its Superior-Owens Well No. 1 in the subject Pool under Rule 5, Order No. R-4111, Special Rules and Regulations for the East Morton-Wolfcamp Pool. The proposed location is 990 feet from the north line and 330 feet from the west line of Section 3, Township 15 South, Range 35 East, Lea County, New Mexico.

This request for administrative approval of an unorthodox location is based on topographical conditions existing in the area of the proposed location. Plat No. 1 shows that the regular location would fall within the center of a heavily irrigated farming tract. The surface owner contends that a well and tank battery at this location would cause economic hardship on his farming operation by complicating his irrigation system. The plat further shows that by drilling the well at the proposed location, damage to the farm land and the irrigation system will be minimal. If this is a successful well, the tank battery would be located west of the well on the unimproved grass land.

Plat No. 2 reflects the lease ownership in the vicinity of the proposed location. All operators offsetting the proposed location have been sent copies of this application. Written waivers from all operators concerned are enclosed. A letter from Mr. R. B. Jones, the surface owner, is also enclosed. Forms C-101 and C-102 are enclosed also.

Very truly yours,

SAMEDAN OIL CORPORATION

A handwritten signature in cursive script, appearing to read "William S. McCuen".

William S. McCuen  
Production Superintendent

WSM:ls  
Enclosures

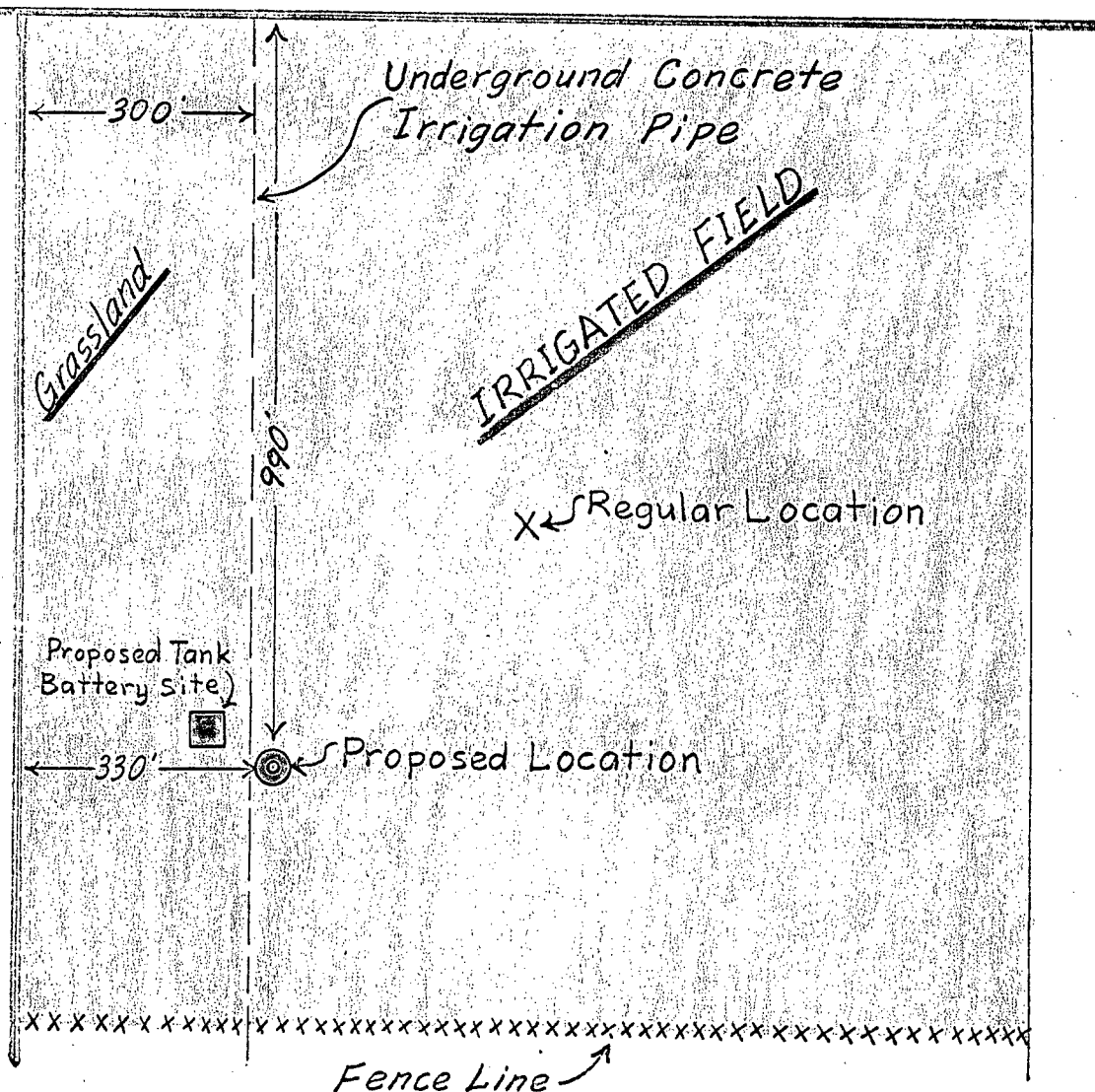

SAMEDAN OIL CORPORATION  
 PROPOSED LOCATION SUPERIOR-OWENS No. 1  
 NW/4 NW/4 Sec. 3, T-15-S, R-35-E  
 Lea County, New Mexico  
 Scale: 1" = 250'

Plat No. 1

Union Oil and Gas Division: Central Region

Union Oil Company of California  
500 North Marienfeld, Midland, Texas 79701  
Telephone (915) 682-9731

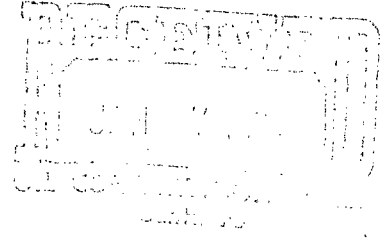

Midland District

December 26, 1973

Mr. A. L. Porter, Jr.  
New Mexico Oil Conservation Commission  
P. O. Box 2088  
Santa Fe, New Mexico 87501

Dear Mr. Porter:

Samedan Oil Corporation  
No. 1 Superior-Owens  
NW/4 of NW/4, Section 3,  
T-15-S, R-35-E, Lea County, New Mexico  
Unorthodox Location

This is to advise that the undersigned has been given due notice that Samedan has made application for an unorthodox location for the drilling of the Samedan Oil Corporation No. 1 Superior-Owens. It is further understood that the proposed location will comply with Statewide Rules (a minimum distance of 330' from the west line and 990' from the north line of the proration unit), but will be an exception to spacing rules for the Morton Wolfcamp East Field.

Union Oil Company of California waives objection to the proposed unorthodox location as described above.

Very truly yours,

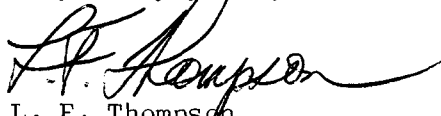
  
L. F. Thompson  
District Operations Manager

LFT:rb

SAMEDAN OIL CORPORATION  
2207 WILCO BUILDING  
MIDLAND, TEXAS 79701

December 17, 1973

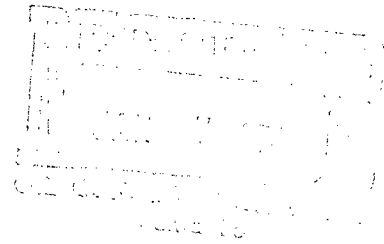

Mr. A. L. Porter, Jr.  
New Mexico Oil and Gas Commission  
P. O. Box 2088  
Santa Fe, New Mexico 87501

RE: Samedan Oil Corporation  
No. 1 Superior-Owens  
Unorthodox Location

Dear Mr. Porter:

This is to advise that the undersigned has been given due notice that Samedan has made application for an unorthodox location for the drilling of the Samedan Oil Corporation No. 1 Superior-Owens. It is further understood that the proposed location will comply with Statewide rules (a minimum distance of 330' from the west line and 990' from the north line of the proration unit), but will be an exception to spacing rules for the Morton Wolfcamp East Field.

The request for an unorthodox location is due to topographic conditions resulting from an irrigation system on the drill site tract.

We waive objections to the proposed unorthodox location as described above.

*The* SUPERIOR OIL COMPANY

BY: *J. D. Collier Jr.*  
12-18-73

ls

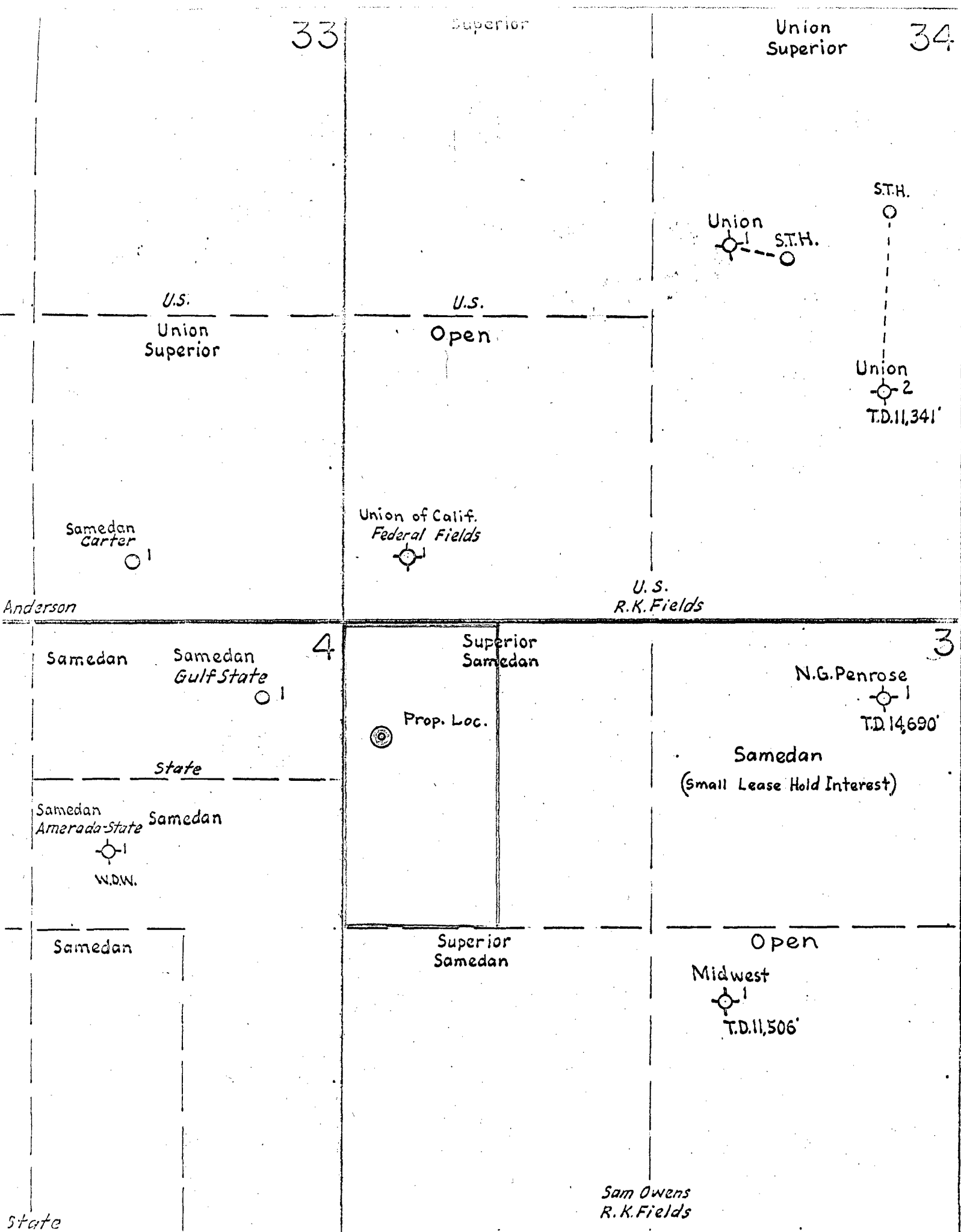

**SAMEDAN OIL CORPORATION**  
 Proposed Location Superior-Owens No. 1  
 Morton Wolfcamp, East Field  
 Sec. 33+34, T-14-S, R-35-E  
 Sec. 3+4, T-15-S, R-35-E  
 Lea County, New Mexico  
 Scale: 1" = 1000'