

# AMERADA HESS CORPORATION

April 30, 1975

P. O. DRAWER "D"  
MONUMENT, NEW MEXICO 88265

393-2144

New Mexico Oil Conservation Commission  
P. O. Box 2088  
Santa Fe, New Mexico 87501

Re: Administrative Approval of  
Non-Standard Location

Gentlemen:

Amerada Hess Corporation request approval of a non-standard location and request a 160 acre proration unit be assigned to the E. W. Walden Well No. 2, located in Unit K, 1911' FWL and 2009' FSL of Section 15, T-22-S, R-37-E, Lea County, New Mexico.

The well was originally completed in the Drinkard pool. Administrative Order No. MC-2186 dated April 14, 1975 authorized dual completion in the Blinebry oil and gas pool and the Drinkard pool.

Amerada Hess Corporation is the owner and operator at the E. W. Walden Lease described as the SW/4, Section 15, T-22-S, R-37-E, Lea County, New Mexico. This acreage is currently assigned to the E. W. Walden Well No. 7 located in Unit N, Section 15. This well is a marginal producer in the Blinebry pool and will be abandoned on approval of this application.

The following offset operators have been furnished a copy of this application:

Exxon Company - P. O. Box 1600 - Midland, Texas 79701  
Gulf Oil Corporation - P. O. Box 460 - Hobbs, New Mexico 88240  
Texas Pacific Oil Company - Box 4067 - Midland, Texas 79701  
Marathon Oil Company - Box 2409 - Hobbs, New Mexico 88240

Form C-102 and a plat of all wells in the area is attached.

Yours very truly,

  
M. C. Black

Supervisor, Administrative Services

MCB: jm  
Attachment

*NSL-713*  
*Blinebry Gas Pool*  
*Blue*  
*May 21*  
*Rule 3*  
*R-1670-N*

**NEW MEXICO OIL CONSERVATION COMMISSION  
WELL LOCATION AND ACREAGE DEDICATION PLAT**

Form C-102  
Supersedes C-128  
Effective 1-1-65

All distances must be from the outer boundaries of the Section.

Operator <b>Amerada Hess Corporation</b>			Lease <b>E.W. Walden</b>		Well No. <b>2</b>
Unit Letter <b>K</b>	Section <b>15</b>	Township <b>22-S</b>	Range <b>37-E</b>	County <b>Lea Santa Fe</b>	
Actual Footage Location of Well: <b>2009</b> feet from the <b>South</b> line and <b>1911</b> feet from the <b>West</b> line					
Ground Level Elev. <b>3402'</b>	Producing Formation <b>Blinebry</b>		Pool <b>Blinebry Gas</b>		Dedicated Acreage: <b>160</b> Acres

1. Outline the acreage dedicated to the subject well by colored pencil or hachure marks on the plat below.
2. If more than one lease is dedicated to the well, outline each and identify the ownership thereof (both as to working interest and royalty).
3. If more than one lease of different ownership is dedicated to the well, have the interests of all owners been consolidated by communitization, unitization, force-pooling, etc?

☐ Yes    ☐ No    If answer is "yes," type of consolidation \_\_\_\_\_

If answer is "no," list the owners and tract descriptions which have actually been consolidated. (Use reverse side of this form if necessary.) \_\_\_\_\_

No allowable will be assigned to the well until all interests have been consolidated (by communitization, unitization, forced-pooling, or otherwise) or until a non-standard unit, eliminating such interests, has been approved by the Commission.

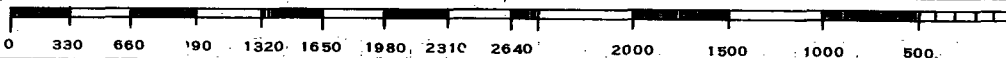
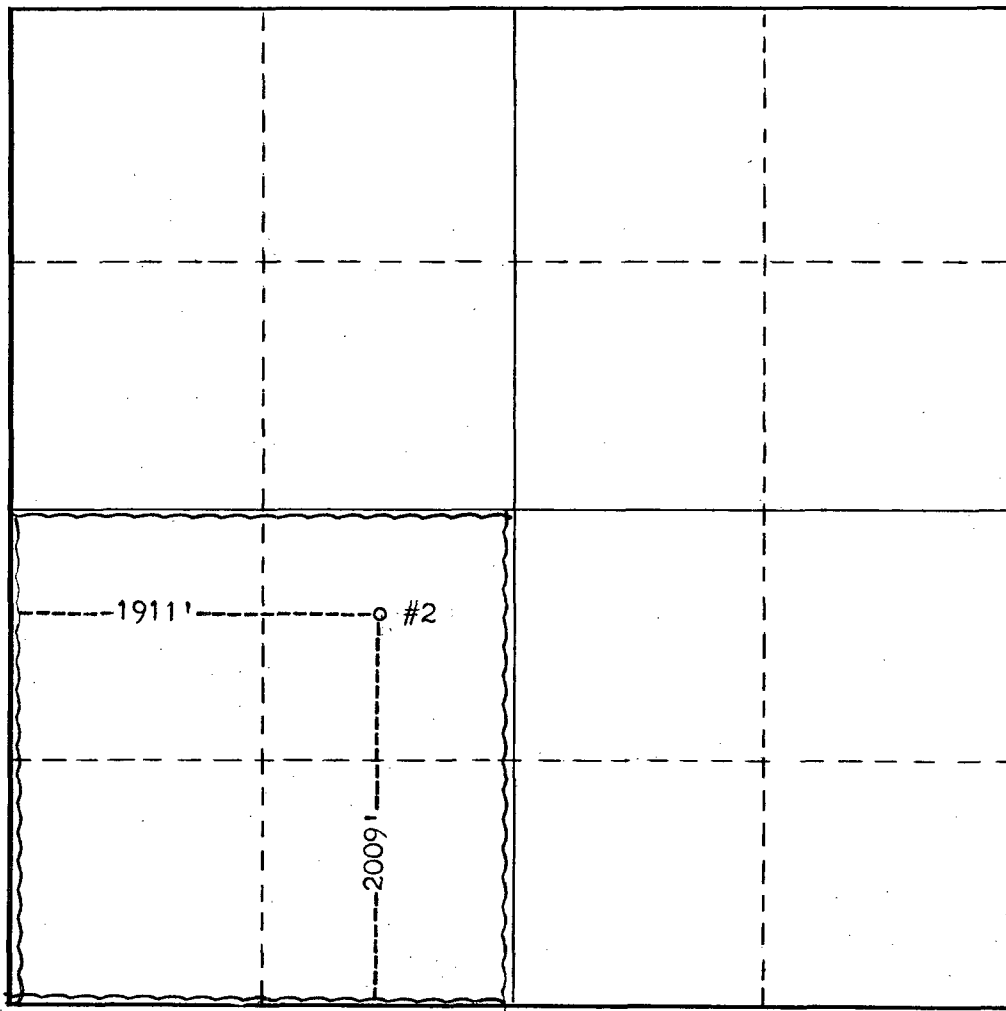

**CERTIFICATION**

*I hereby certify that the information contained herein is true and complete to the best of my knowledge and belief.*

Name \_\_\_\_\_  
 Position \_\_\_\_\_  
**Supver., Admin. Serv.**  
 Company  
**Amerada Hess Corporation**  
 Date  
**4-29-75**

*I hereby certify that the well location shown on this plat was plotted from field notes of actual surveys made by me or under my supervision, and that the same is true and correct to the best of my knowledge and belief.*

Date Surveyed \_\_\_\_\_  
 Registered Professional Engineer  
 and/or Land Surveyor  
 \_\_\_\_\_  
 Certificate No. \_\_\_\_\_

R-37-E

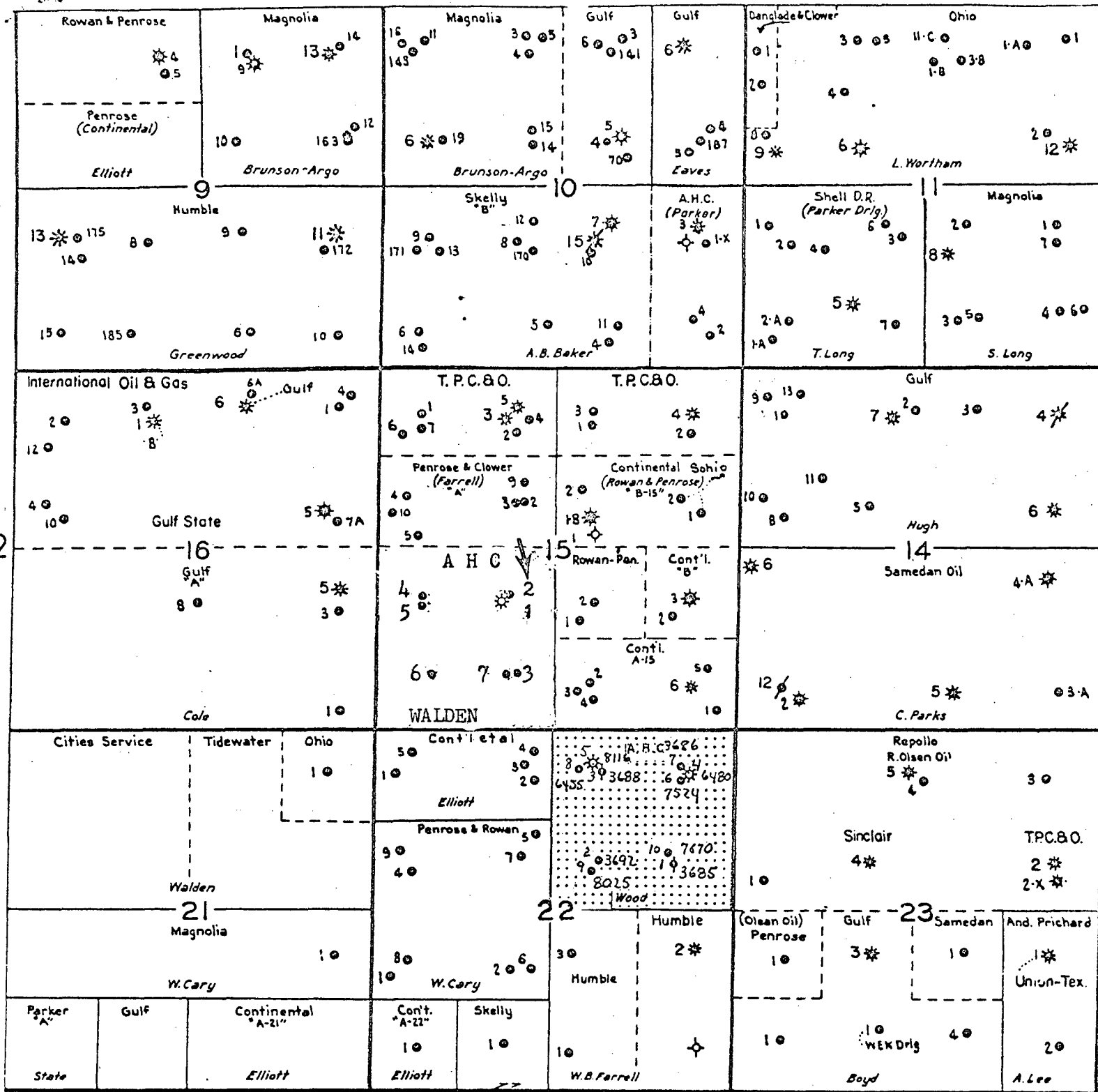

AMERADA HESS CORPORATION  
DRAWER "D"  
MONUMENT, NEW MEXICO

EUNICE FIELD  
Lea Co., New Mexico

Scale: 1" = 2000'