

NSL - 717

|||
= dp =
|||

dugan production corp. 2 wells

due Aug 20

104 F

July 30, 1975

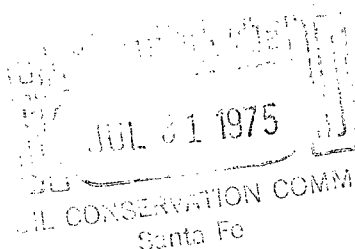

Joe D. Ramey
Secretary-Director
N. M. Oil Conservation Commission
Box 2088
Santa Fe, New Mexico 87501

Dear Mr. Ramey:

Your approval is requested for unorthodox locations for two of our proposed gas wells, the Ojo-He-He #3 (1960' FSL - 990' FWL), and the Ojo-He-He #5 (1905' FSL - 1853' FEL). Both wells are in Section 33, Township 27 North, Range 13 West, San Juan County, New Mexico.

The reason for our request is that these wellsites are within the Navajo Indian Irrigation Project and they have planned their sprinkler system in this area. We have located the wells at the turning point of the sprinkler system so that they will interfere as little as possible with the planned sprinkler system. Our planning was done in conjunction with Mr. J. Y. Christiansen of the Bureau of Indian Affairs here in Farmington. These locations will also result in shorter pipelines and less interference with the Navajo Indian Irrigation Project.

Sincerely,

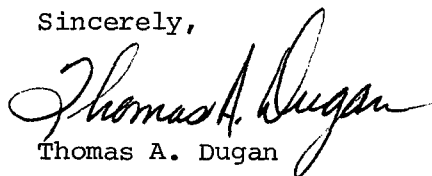

Thomas A. Dugan

cb

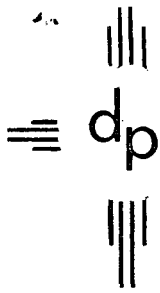
cc: NMOCC (Aztec)

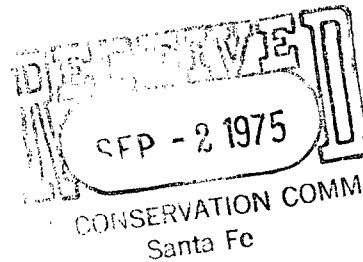

dugan production corp.



August 29, 1975

J. E. Kapteina
N. M. Oil Conservation Commission
Box 2088
Santa Fe, New Mexico 87501

Dear Mr. Kapteina:

Our letter of July 30, 1975 requested your approval of unorthodox locations for the Ojo-He-He Nos. 3 and 5. To support this request attached are the following:

1. Ownership Map
2. BIA Irrigated Farm Plat
3. BIA Detailed Land Classification

If you need any additional information, please call us.

Sincerely,

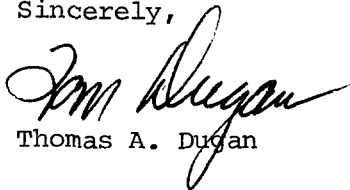

Thomas A. Dugan

cb

encl (3)

OWNERSHIP MAP
Dugan Production Corp.
Unorthodox Location Application
Ojo-He-He Well Nos. 3 & 5

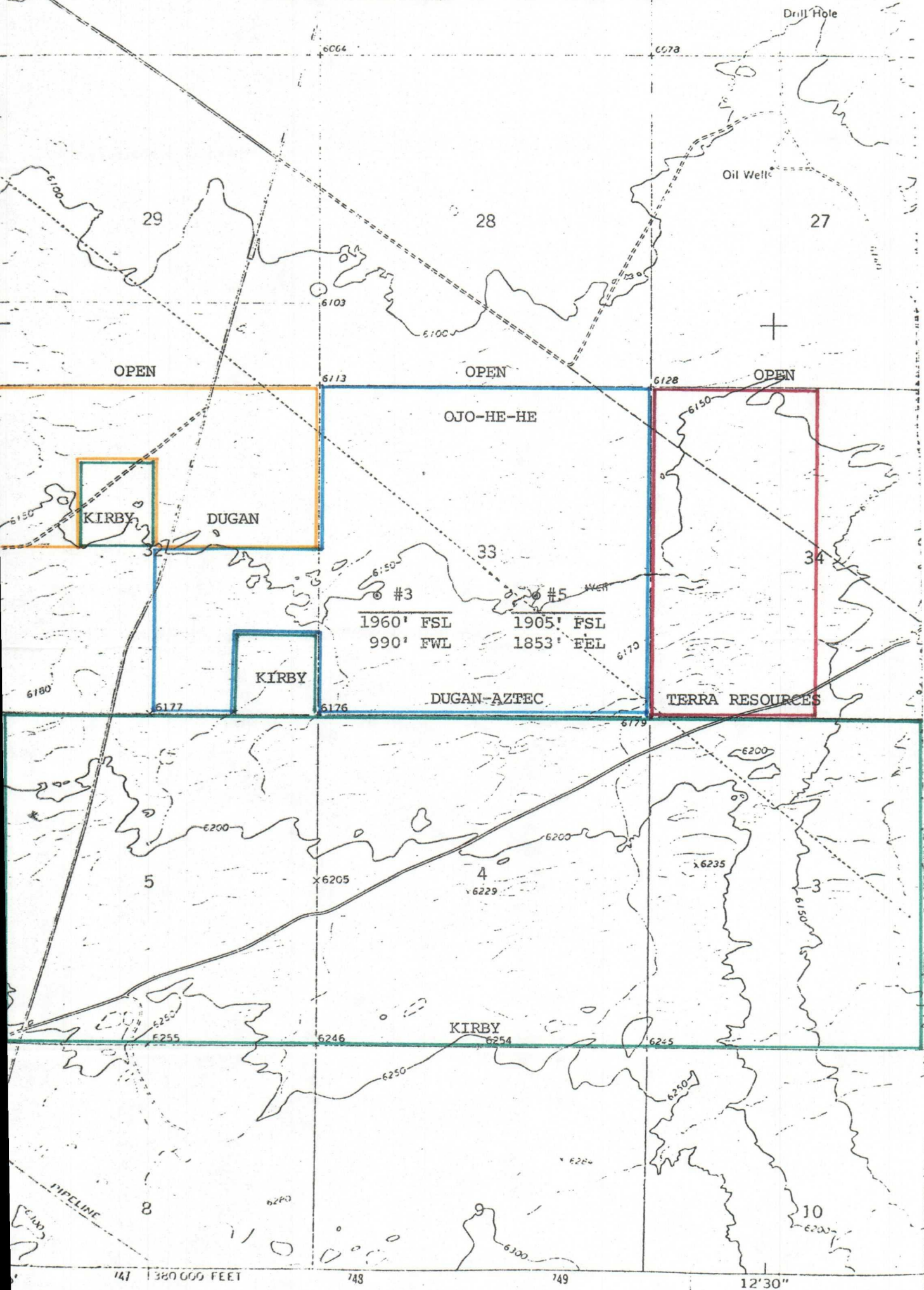

BIA IRRIGATED FARM PLAT
Dugan Production Corp.
Unorthodox Location Application
Ojo-He-He Well Nos. 3 & 5

8-41

152 Ac.
66 psi
El. 6084

8-40

153 Ac.
68 psi
El. 6111

8-39

212 Ac.
69 psi
El. 6113

8-33

8-38

61 Ac.
67 psi
El. 6129

193 Ac.
63 psi
El. 6157

8-37

152 Ac.
65 psi
El. 6149

8-32

73 Ac.
65 psi
El. 6178

8-36

153 Ac.
69 psi
El. 6171

8-35

188 Ac.
65 psi
El. 6175

10-26

151 Ac.
67 psi
El. 6209

10-25

151 Ac.
67 psi
El. 6211

10-24

144 Ac.
64 psi
El. 6233

SOUTH HALF, SECTION 33
BIA DETAILED LAND CLASSIFICATION
Dugan Production Corp.
Unorthodox Location Application
Ojo-He-He Well Nos. 3 & 5

