

Atlantic Richfield Company

North American Producing Division
Rocky Mountain District
1860 Lincoln St. — Suite 501
Denver, Colorado 80203
Telephone 303 573-4049

W. A. Walther, Jr.
Operations Manager

June 7, 1976

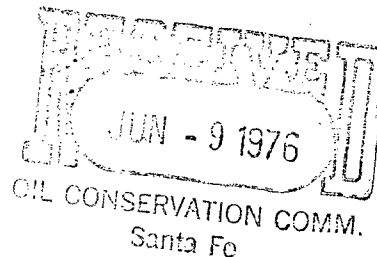

Mr. Joe D. Ramey, Secretary-Director
Oil Conservation Commission, State of New Mexico
P. O. Box 2088
Santa Fe, New Mexico 87501

Re: Horseshoe Gallup Unit
San Juan County, New Mexico

Dear Mr. Ramey:

Atlantic Richfield Company, Operator of the Horseshoe Gallup Unit, and pursuant Case No. 5236, Order No. R-2210-A, hereby requests administrative approval to drill seven (7) infill Gallup formation producing wells at unorthodox locations. As set forth in Order No. R-2210-A, the following are enclosed:

1. (a) Copy of Certified Location Plat, each well.
(b) Copy of Application for Permit to Drill, each well.
(c) Map showing the Unit boundary, all existing wells, and location of the seven (7) proposed wells.
2. Schematic drawing for each well, based on current information.

Atlantic Richfield Company is the Operator of all offset locations, therefore, notification to offset operators is not required.

Your administrative approval is respectfully requested.

Very truly yours,

W. A. Walther, Jr.

Encls.

HGU 291 50' FNL & 50' FEL Sec 23 } T31N, R17W
292 2474' FSL & 2463' FEL Sec 24 }
293 1260' FNL & 1470' FWL Sec 30 }
294 1378' FSL & 1330' FEL Sec. 30 } T31N, R16W
295 50' FNL & 50' FEL Sec. 31 }
296 1350' FSL & 1250' FEL Sec 32 }
297 1550' FSL & 1250' FEL Sec 4, T30N, R16W

UNITED STATES
DEPARTMENT OF THE INTERIOR
GEOLOGICAL SURVEY

APPLICATION FOR PERMIT TO DRILL, DEEPEN, OR PLUG BACK

1a. TYPE OF WORK

DRILL ☒DEEPEN ☐PLUG BACK ☐

1b. TYPE OF WELL

OIL
WELL ☒GAS
WELL ☐OTHER ☐SINGLE
ZONE ☒MULTIPLE
ZONE ☐

2. NAME OF OPERATOR

Atlantic Richfield Company

3. ADDRESS OF OPERATOR

501 Lincoln Tower Bldg., 1860 Lincoln St., Denver, Colo. 80203

4. LOCATION OF WELL (Report location clearly and in accordance with any State requirements.)*

At surface

Unit A - 50' f/North & 50' f/East lines Sec. 23

At proposed prod. zone

Approx. Same

14. DISTANCE IN MILES AND DIRECTION FROM NEAREST TOWN OR POST OFFICE*

See attached maps

16. DISTANCE FROM PROPOSED*

2590' f/Tr. 13 line

LOCATION TO NEAREST
PROPERTY OR LEASE LINE, FT.
(Also to nearest drlg. unit line, if any)

18. DISTANCE FROM PROPOSED LOCATION*

812' f/#84 in

TO NEAREST WELL, DRILLING, COMPLETED,
OR APPLIED FOR, ON THIS LEASE, FT.

NE NE Sec. 23

15. NO. OF ACRES IN LEASE

Tr. 13, 1442.28 Ac.

Unit 13, 527.80 Ac.

19. PROPOSED DEPTH

1650'

17. NO. OF ACRES ASSIGNED
TO THIS WELL

N/A Unit

20. ROTARY OR CABLE TOOLS

Rotary

21. ELEVATIONS (Show whether DF, RT, GR, etc.)

5873' GL, Ungr.

22. APPROX. DATE WORK WILL START*

When appls rec'd.

Est. 7/1/76

23.

PROPOSED CASING AND CEMENTING PROGRAM

SIZE OF HOLE	SIZE OF CASING	WEIGHT PER FOOT	SETTING DEPTH	QUANTITY OF CEMENT
12-1/4"	8-5/8"	24#	120'	120 sx (Cmt to surface)
7-7/8"	5-1/2"	14#	T.D.	225 sx

Propose to drill well to depth sufficient to test the Gallup Formation. Est. tops: Upper Gallup 1424', Lower Gallup 1534'. Will set 8-5/8" surface casing at approx. 120' and cement to surface; drill 7-7/8" hole to T.D.; log; if productive, set 5-1/2" casing with sufficient cement to protect all zones. Productive zone(s) will be perforated, treated if necessary, and well completed.

Re: New Mexico Oil Conservation Commission Order No. R-2210 & R-2210-A

Attachments: Certified Location Plat
Pertinent Drilling Information
Development Plan for Surface Use w/ att.
Archaeological Clearance Report

IN ABOVE SPACE DESCRIBE PROPOSED PROGRAM: If proposal is to deepen or plug back, give data on present productive zone and proposed new productive zone. If proposal is to drill or deepen directionally, give pertinent data on subsurface locations and measured and true vertical depths. Give blowout preventer program, if any.

24.

SIGNED

W. A. Walther, Jr.
W. A. Walther, Jr.

TITLE

Operations Manager

DATE

6/1/76

(This space for Federal or State office use)

PERMIT NO.

APPROVAL DATE

APPROVED BY

TITLE

DATE

CONDITIONS OF APPROVAL, IF ANY:

*See Instructions On Reverse Side

**NEW MEXICO OIL CONSERVATION COMMISSION
WELL LOCATION AND ACREAGE DEDICATION PLAT**

Form C-102
Supersedes C-128
Effective 1-1-65

All distances must be from the outer boundaries of the Section.

Operator Atlantic Richfield Company			Lease		Well No. 291
Unit Letter A	Section 23	Township 31	Range 17	County San Juan	
Actual Footage Location of Well: 50 feet from the North line and 50 feet from the East line					
Ground Level Elev. 5873	Producing Formation Gallup		Pool Horseshoe Gallup		Dedicated Acreage: NA - Unitized Acres

Re: Order No. R-2210

1. Outline the acreage dedicated to the subject well by colored pencil or hachure marks on the plat below.
2. If more than one lease is dedicated to the well, outline each and identify the ownership thereof (both as to working interest and royalty).
3. If more than one lease of different ownership is dedicated to the well, have the interests of all owners been consolidated by communitization, unitization, force-pooling, etc?

☒ Yes ☐ No If answer is "yes," type of consolidation Unitization

If answer is "no," list the owners and tract descriptions which have actually been consolidated. (Use reverse side of this form if necessary.) _____

No allowable will be assigned to the well until all interests have been consolidated (by communitization, unitization, forced-pooling, or otherwise) or until a non-standard unit, eliminating such interests, has been approved by the Commission.

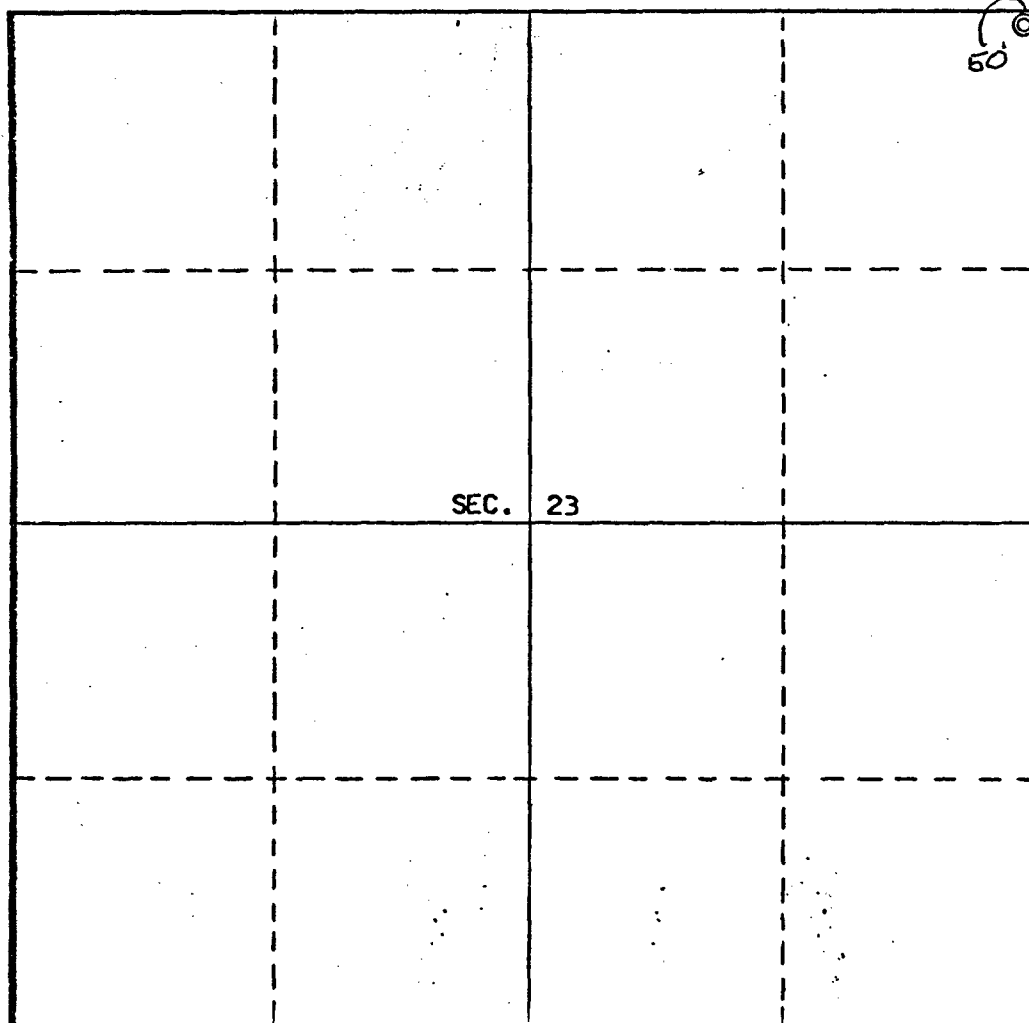

CERTIFICATION I hereby certify that the information contained herein is true and complete to the best of my knowledge and belief.	
Name <u>W. A. Walther Jr.</u> Position <u>W. A. Walther, Jr.</u> <u>Operations Manager</u> Company <u>ATLANTIC RICHFIELD COMPANY</u> Date _____	
Date Surveyed <u>May 21, 1976</u> Registered Professional Engineer and/or Land Surveyor <u>E.V. Echomaw</u> Certificate No. <u>3602</u> <u>E.V. Echomaw LS</u>	

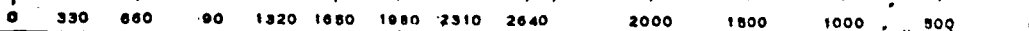

Elevation 5873' - GL, Ungraded



8-5/8" OD Casing set at 120' and cemented to surface

2-3/8" OD EUE tubing

Upper Gallup - Perforated as indicated from logs.

Lower Gallup - Perforated as indicated from logs.

5-1/2" OD casing set at total depth with sufficient cement to protect all zones.

1650' Estimated total depth.

HORSESHOE GALLUP UNIT, Well No. 291
Unit "A" - 50' f/North & 50' f/East lines
Section 23-31N-17W
San Juan County, New Mexico

UNITED STATES
DEPARTMENT OF THE INTERIOR
GEOLOGICAL SURVEY

APPLICATION FOR PERMIT TO DRILL, DEEPEN, OR PLUG BACK

1a. TYPE OF WORK

DRILL ☒DEEPEN ☐PLUG BACK ☐

b. TYPE OF WELL

OIL
WELL ☒GAS
WELL ☐OTHER ☐SINGLE
ZONE ☒MULTIPLE
ZONE ☐

2. NAME OF OPERATOR

Atlantic Richfield Company

3. ADDRESS OF OPERATOR

501 Lincoln Tower Bldg., 1860 Lincoln St., Denver, Colo. 80203

4. LOCATION OF WELL (Report location clearly and in accordance with any State requirements.*)

At surface

Unit "J" - 2474' f/South & 2463' f/East lines Sec. 24

At proposed prod. zone

Approx. same

14. DISTANCE IN MILES AND DIRECTION FROM NEAREST TOWN OR POST OFFICE*

See attached maps

15. DISTANCE FROM PROPOSED* LOCATION TO NEAREST PROPERTY OR LEASE LINE, FT.
(Also to nearest drlg. unit line, if any)166' f/Tr. 15 line
822' f/#99 in16. NO. OF ACRES IN LEASE
Tr. 15 - 880.00 Ac.
Unit - 13,527.80 Ac.19. PROPOSED DEPTH
1530'17. NO. OF ACRES ASSIGNED
TO THIS WELL

N/A Unit

21. ELEVATIONS (Show whether DF, RT, GR, etc.)

5707' GL, Ungr.

22. APPROX. DATE WORK WILL START*

When appls rec'd.

Rd & loc est 7/1/76.

Drlg after #291

23. PROPOSED CASING AND CEMENTING PROGRAM

SIZE OF HOLE	SIZE OF CASING	WEIGHT PER FOOT	SETTING DEPTH	QUANTITY OF CEMENT
12-1/4"	8-5/8"	24#	120'	128 sx (Cmt to surface)
7-7/8"	5-1/2"	14#	T.D.	225 sx

Propose to drill well to depth sufficient to test the Gallup Formation. Est tops: Upper Gallup 1305', Lower Gallup 1415'. Will set 8-5/8" OD surface casing at approx. 120' and cement to surface; drill 7-7/8" hole to T.D.; log; if productive, set 5-1/2" OD casing w/ sufficient cement to protect all zones. Productive zone(s) will be perforated, treated if necessary, and well completed.

Re: New Mexico Oil Conservation Commission Order No. R-2210 and R-2210-A

Attachments: Certified Location Plat
Pertinent Drilling Information
Development Plan for Surface Use w/ att.
Archaeological Clearance Report

IN ABOVE SPACE DESCRIBE PROPOSED PROGRAM: If proposal is to deepen or plug back, give data on present productive zone and proposed new productive zone. If proposal is to drill or deepen directionally, give pertinent data on subsurface locations and measured and true vertical depths. Give blowout preventer program, if any.

24.

SIGNED W. A. Walther, Jr. TITLE Operations Manager DATE 6/4/76

(This space for Federal or State office use)

PERMIT NO. _____ APPROVAL DATE _____

APPROVED BY _____ TITLE _____ DATE _____

CONDITIONS OF APPROVAL, IF ANY:

*See Instructions On Reverse Side

**NEW MEXICO OIL CONSERVATION COMMISSION
WELL LOCATION AND ACREAGE DEDICATION PLAT**

Form C-102
Supersedes C-128
Effective 1-1-65

All distances must be from the outer boundaries of the Section.

Operator Atlantic Richfield Company			Lease		Well No. 292
Unit Letter J	Section 24	Township 31	Range 17	County San Juan	
Actual Footage Location of Well: 2474 feet from the South line and 2463 feet from the East line					
Ground Level Elev. 5707	Producing Formation Gallup		Pool Horseshoe Gallup		Dedicated Acreage: NA - Unitized Acres

Re: Order No. R-2210

1. Outline the acreage dedicated to the subject well by colored pencil or hachure marks on the plat below.
2. If more than one lease is dedicated to the well, outline each and identify the ownership thereof (both as to working interest and royalty).
3. If more than one lease of different ownership is dedicated to the well, have the interests of all owners been consolidated by communitization, unitization, force-pooling, etc?

☒ Yes ☐ No If answer is "yes," type of consolidation Unitization

If answer is "no," list the owners and tract descriptions which have actually been consolidated. (Use reverse side of this form if necessary.) _____

No allowable will be assigned to the well until all interests have been consolidated (by communitization, unitization, forced-pooling, or otherwise) or until a non-standard unit, eliminating such interests, has been approved by the Commission.

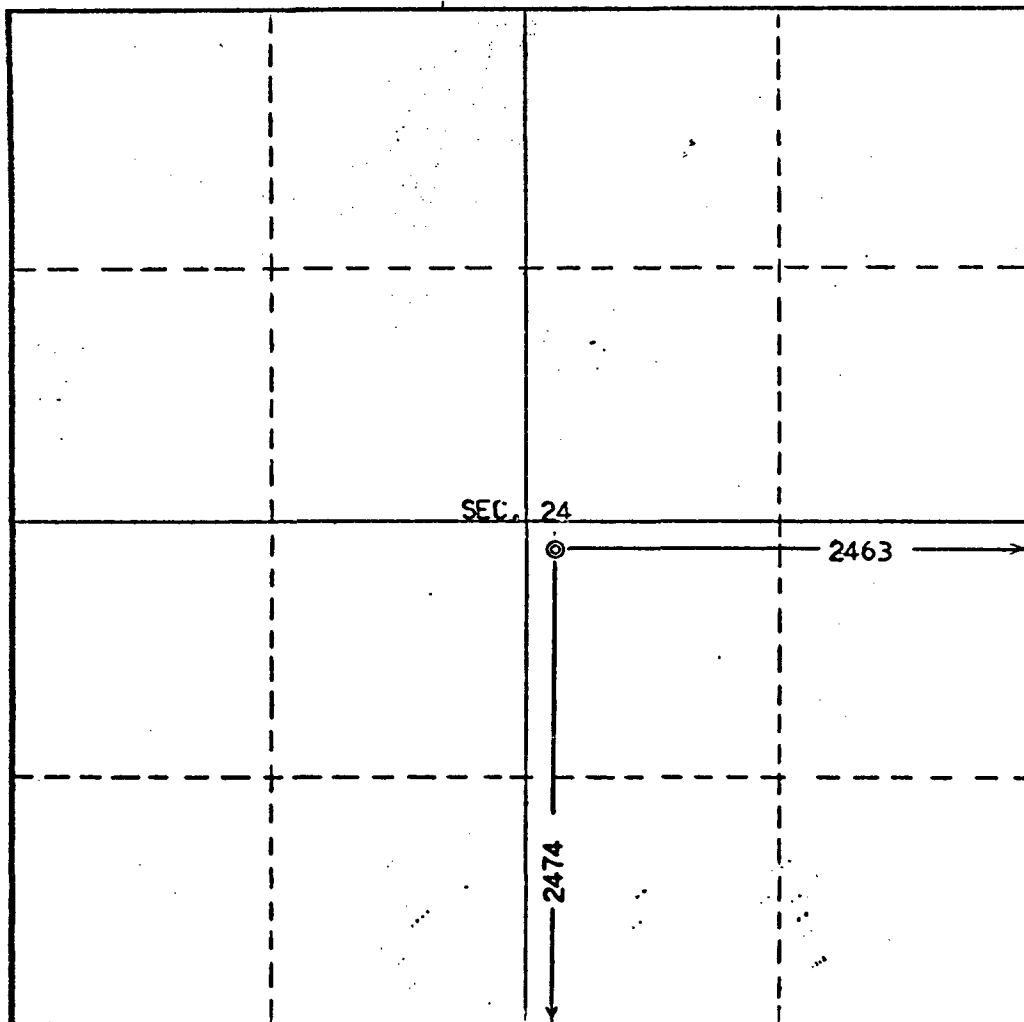

CERTIFICATION

I hereby certify that the information contained herein is true and complete to the best of my knowledge and belief.

Name W. A. Walther, Jr.
Position W. A. Walther, Jr.
Operations Manager
Company ATLANTIC RICHFIELD COMPANY
Date _____

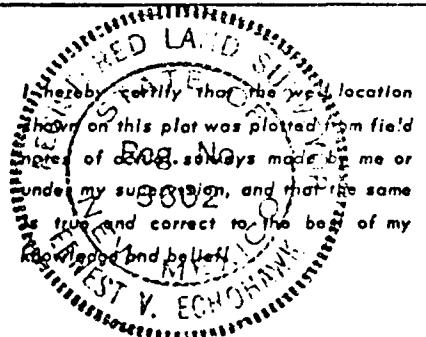

Date Surveyed May 21, 1976
Registered Professional Engineer and/or Land Surveyor
E. V. Echoshawk
Certificate No. 3602
E.V. Echoshawk LS

Elevation 5707' - GL, Ungraded

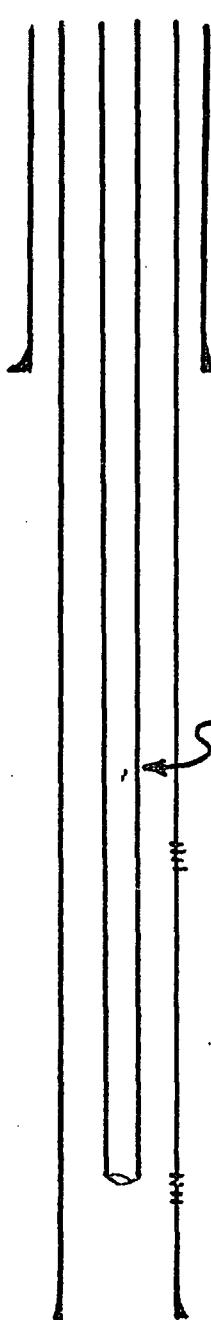

8-5/8" OD Casing set at 120' and cemented to surface

2-3/8" OD EUE tubing

Upper Gallup - Perforated as indicated from logs.

Lower Gallup - Perforated as indicated from logs.

5-1/2" OD casing set at total depth with sufficient cement to protect all zones.

1530' Estimated total depth.

HORSESHOE GALLUP UNIT, Well No. 292
Unit "J" - 2474' f/South & 2463' f/East lines
Section 24-31N-17W
San Juan County, New Mexico

UNITED STATES
DEPARTMENT OF THE INTERIOR
GEOLOGICAL SURVEY

APPLICATION FOR PERMIT TO DRILL, DEEPEN, OR PLUG BACK

1. TYPE OF WORK

DRILL ☒DEEPEN ☐PLUG BACK ☐

2. TYPE OF WELL

OIL
WELL ☒GAS
WELL ☐OTHER ☐

3. NAME OF OPERATOR

Atlantic Richfield Company

4. ADDRESS OF OPERATOR

501 Lincoln Tower Bldg., 1860 Lincoln St., Denver, Colo. 80203

5. LOCATION OF WELL (Report location clearly and in accordance with any State requirements.)*

At surface

Unit "C" - 1260' f/North & 1470' f/West lines Sec. 30

At proposed prod. zone

Approx. same

6. DISTANCE IN MILES AND DIRECTION FROM NEAREST TOWN OR POST OFFICE*

See attached maps

7. DISTANCE FROM PROPOSED* LOCATION TO NEAREST PROPERTY OR LEASE LINE, FT.
(Also to nearest drlg. unit line, if any)

1260' f/Tr.12 line

8. DISTANCE FROM PROPOSED LOCATION* TO NEAREST WELL, DRILLING, COMPLETED, OR APPLIED FOR, ON THIS LEASE, FT. in NE NW Sec.30

814' f/#48

9. NO. OF ACRES IN LEASE
Tr.12 - 2644.14 Ac
Unit - 13,527.80 Ac

10. PROPOSED DEPTH

1510'

11. NO. OF ACRES ASSIGNED TO THIS WELL

N/A - Unit

12. ROTARY OR CABLE TOOLS

Rotary tools

13. ELEVATIONS (Show whether DF, RT, GR, etc.)

5625' GL, Ungr.

14. APPROX. DATE WORK WILL START*

When appl rec'd.

Ad & loc est 7/1/76.

Drlg after #292

15. PROPOSED CASING AND CEMENTING PROGRAM

SIZE OF HOLE	SIZE OF CASING	WEIGHT PER FOOT	SETTING DEPTH	QUANTITY OF CEMENT
12-1/4"	8-5/8"	24#	120'	120 sx (Omt to surface)
7-7/8"	5-1/2"	14#	T.D.	225 sx

Propose to drill well to depth sufficient to test the Gallup Formation. Est. tops: Upper Gallup 1300', Lower Gallup 1400'. Will set 8-5/8" surface casing at approx 120' and cement to surface; drill 7-7/8" hole to T.D.; log; if productive, set 5-1/2" OD casing with sufficient cement to protect all zones. Productive zone(s) will be perforated, treated if necessary, and well completed.

Re: New Mexico Oil Conservation Commission Order No. R-2210 & R-2210-A

Attachments: Certified Location Plat
Pertinent Drilling Information
Development Plan for Surface Use w/ att.
Archaeological Clearance Report

IN ABOVE SPACE DESCRIBE PROPOSED PROGRAM: If proposal is to deepen or plug back, give data on present productive zone and proposed new productive zone. If proposal is to drill or deepen directionally, give pertinent data on subsurface locations and measured and true vertical depths. Give blowout preventer program, if any.

24.

SIGNED

W A Walther Jr
W. A. Walther, Jr.
(This space for Federal or State office use)

TITLE Operations Manager

DATE 6/4/76

PERMIT NO.

APPROVAL DATE

APPROVED BY

TITLE

DATE

CONDITIONS OF APPROVAL, IF ANY:

*See Instructions On Reverse Side

**NEW MEXICO OIL CONSERVATION COMMISSION
WELL LOCATION AND ACREAGE DEDICATION PLAT**

Form C-102
Supersedes C-128
Effective 1-1-65

All distances must be from the outer boundaries of the Section.

Operator Atlantic Richfield Company			Lease		Well No. 293
Unit Letter C	Section 30	Township 31	Range 16	County San Juan	
Actual Footage Location of Well: 1260 feet from the North line and 1470 feet from the West line					
Ground Level Elev. 5625	Producing Formation Gallup	Pool Horseshoe Gallup		Dedicated Acreage NA - Unitized	

1. Outline the acreage dedicated to the subject well by colored pencil or hachure marks on the plat below.
2. If more than one lease is dedicated to the well, outline each and identify the ownership thereof (both as to working interest and royalty).
3. If more than one lease of different ownership is dedicated to the well, have the interests of all owners been consolidated by communitization, unitization, force-pooling, etc?

☒ Yes ☐ No If answer is "yes," type of consolidation Unitization

If answer is "no," list the owners and tract descriptions which have actually been consolidated. (Use reverse side of this form if necessary.) _____

No allowable will be assigned to the well until all interests have been consolidated (by communitization, unitization, forced-pooling, or otherwise) or until a non-standard unit, eliminating such interests, has been approved by the Commission.

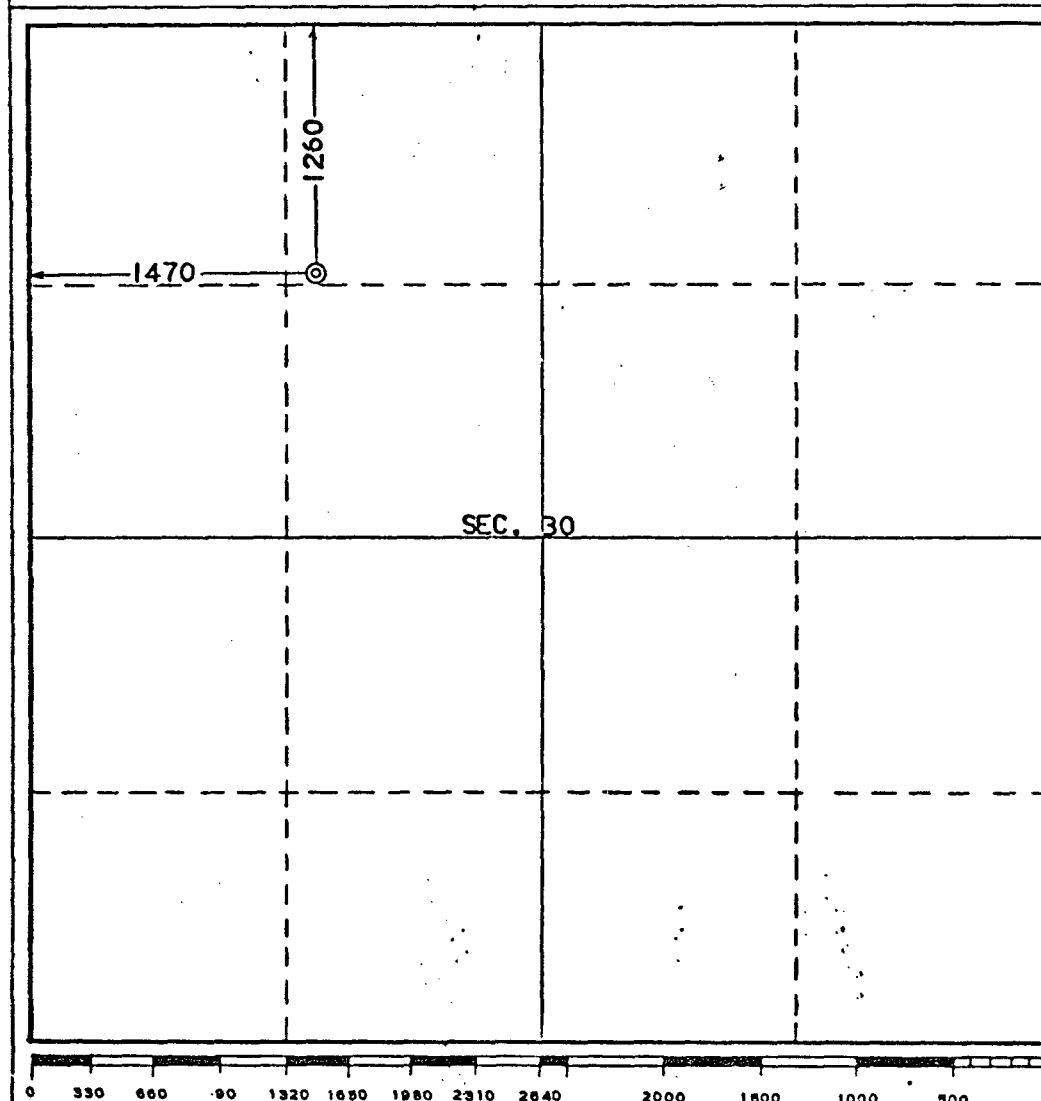

CERTIFICATION

I hereby certify that the information contained herein is true and complete to the best of my knowledge and belief.

Name
W. A. Walther, Jr.
Position W. A. Walther, Jr.
Operations Manager
Company
ATLANTIC RICHFIELD COMPANY
Date

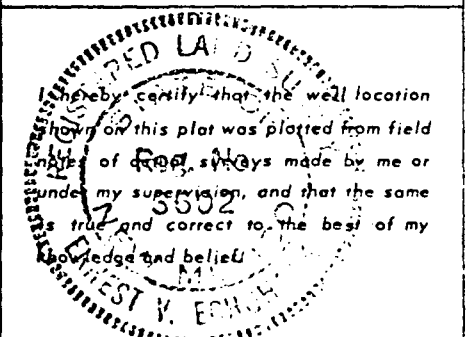

Date Surveyed
May 20, 1976
Registered Professional Engineer
and/or Land Surveyor
E. V. Echohawk
Certificate No. **3602**
E. V. Echohawk LS

Elevation 5625' GL - Ungraded



8-5/8" OD Casing set at 120' and cemented to surface

2-3/8" OD EUE tubing

Upper Gallup - Perforated as indicated from logs.

Lower Gallup - Perforated as indicated from logs.

5-1/2" OD casing set at total depth with sufficient cement to protect all zones.

1510' Estimated total depth.

HORSESHOE GALLUP UNIT, Well No. 293
Unit "C" - 1260' f/North & 1470' f/West lines
Section 30-31N-16W
San Juan County, New Mexico

UNITED STATES
DEPARTMENT OF THE INTERIOR

GEOLOGICAL SURVEY

APPLICATION FOR PERMIT TO DRILL, DEEPEN, OR PLUG BACK

1a. TYPE OF WORK

DRILL ☒DEEPEN ☐PLUG BACK ☐

b. TYPE OF WELL

OIL
WELL ☒GAS
WELL ☐OTHER ☐SINGLE
ZONE ☒MULTIPLE
ZONE ☐

2. NAME OF OPERATOR

Atlantic Richfield Company

3. ADDRESS OF OPERATOR

501 Lincoln Tower Bldg., 1860 Lincoln St., Denver, Colo. 80203

4. LOCATION OF WELL (Report location clearly and in accordance with any State requirements.)*

At surface

Unit "J" - 1378' f/South & 1325' f/East lines Sec. 30

At proposed prod. zone

Approx same

14. DISTANCE IN MILES AND DIRECTION FROM NEAREST TOWN OR POST OFFICE*

See attached maps

15. DISTANCE FROM PROPOSED* 3902' f/Tr.12 line
LOCATION TO NEAREST
PROPERTY OR LEASE LINE, FT.
(Also to nearest drlg. unit line, if any)16. NO. OF ACRES IN LEASE
Tr.12 - 2644.14 Ac
Unit - 13,527.80 Ac17. NO. OF ACRES ASSIGNED
TO THIS WELL
N/A - Unit18. DISTANCE FROM PROPOSED LOCATION* 890' f/#6 in
TO NEAREST WELL, DRILLING, COMPLETED,
OR APPLIED FOR, ON THIS LEASE, FT. NW SE Sec.3019. PROPOSED DEPTH
1390'

20. ROTARY OR CABLE TOOLS

Rotary

21. ELEVATIONS (Show whether DF, RT, GR, etc.)

5477' GL, Ungr.

22. APPROX. DATE WORK WILL START*

When appl rec'd.

Est 7/1/76 - Ad & lee

Drlg after #293

23.

PROPOSED CASING AND CEMENTING PROGRAM

SIZE OF HOLE	SIZE OF CASING	WEIGHT PER FOOT	SETTING DEPTH	QUANTITY OF CEMENT
12-1/4"	8-5/8"	24#	120	120 sx (Cmt to surface)
7-7/8"	5-1/2"	14#	T.D.	225 sx

Propose to drill well to depth sufficient to test the Gallup Formation. Est. tops: Upper Gallup 1180', Lower Gallup 1290'. Will set 8-5/8"OD surface casing at approx 120' and cement to surface; drill 7-7/8" hole to T.D.; log; if productive, set 5-1/2"OD casing w/ sufficient cement to protect all zones. Productive zone(s) will be perforated, treated if necessary and well completed.

Re: New Mexico Oil Conservation Commission Order No. R-2210 & R-2210-A

Attachments: Certified Location Plat
Pertinent Drilling Information
Development Plan for Surface Use w/ att.
Archaeological Clearance Report

IN ABOVE SPACE DESCRIBE PROPOSED PROGRAM: If proposal is to deepen or plug back, give data on present productive zone and proposed new productive zone. If proposal is to drill or deepen directionally, give pertinent data on subsurface locations and measured and true vertical depths. Give blowout preventer program, if any.

24.

SIGNED

W A Walther Jr.

TITLE

Operations Manager

DATE

6/17/76

(This space for Federal or State office use)

PERMIT NO.

APPROVAL DATE

APPROVED BY

TITLE

DATE

CONDITIONS OF APPROVAL, IF ANY:

*See Instructions On Reverse Side

**NEW MEXICO OIL CONSERVATION COMMISSION
WELL LOCATION AND ACREAGE DEDICATION PLAT**

Form C-102
Supersedes C-128
Effective 1-1-65

All distances must be from the outer boundaries of the Section.

Operator Atlantic Richfield Company				Lease		Well No. 294	
Section J	Section 30	Township 31	Range 16	County San Juan			
Actual Footage Location of Well:							
1378 feet from the South line and		1330 feet from the East line					
Ground Level Elev. 5477	Producing Formation Gallup		Pool Horseshoe Gallup		Dedicated Acreage: NA - Unitized		

1. Outline the acreage dedicated to the subject well by colored pencil or hachure marks on the plat below.
2. If more than one lease is dedicated to the well, outline each and identify the ownership thereof (both as to working interest and royalty).
3. If more than one lease of different ownership is dedicated to the well, have the interests of all owners been consolidated by communitization, unitization, force-pooling, etc?

☒ Yes ☐ No If answer is "yes," type of consolidation Unitization

If answer is "no," list the owners and tract descriptions which have actually been consolidated. (Use reverse side of this form if necessary.) _____

No allowable will be assigned to the well until all interests have been consolidated (by communitization, unitization, forced-pooling, or otherwise) or until a non-standard unit, eliminating such interests, has been approved by the Commission.

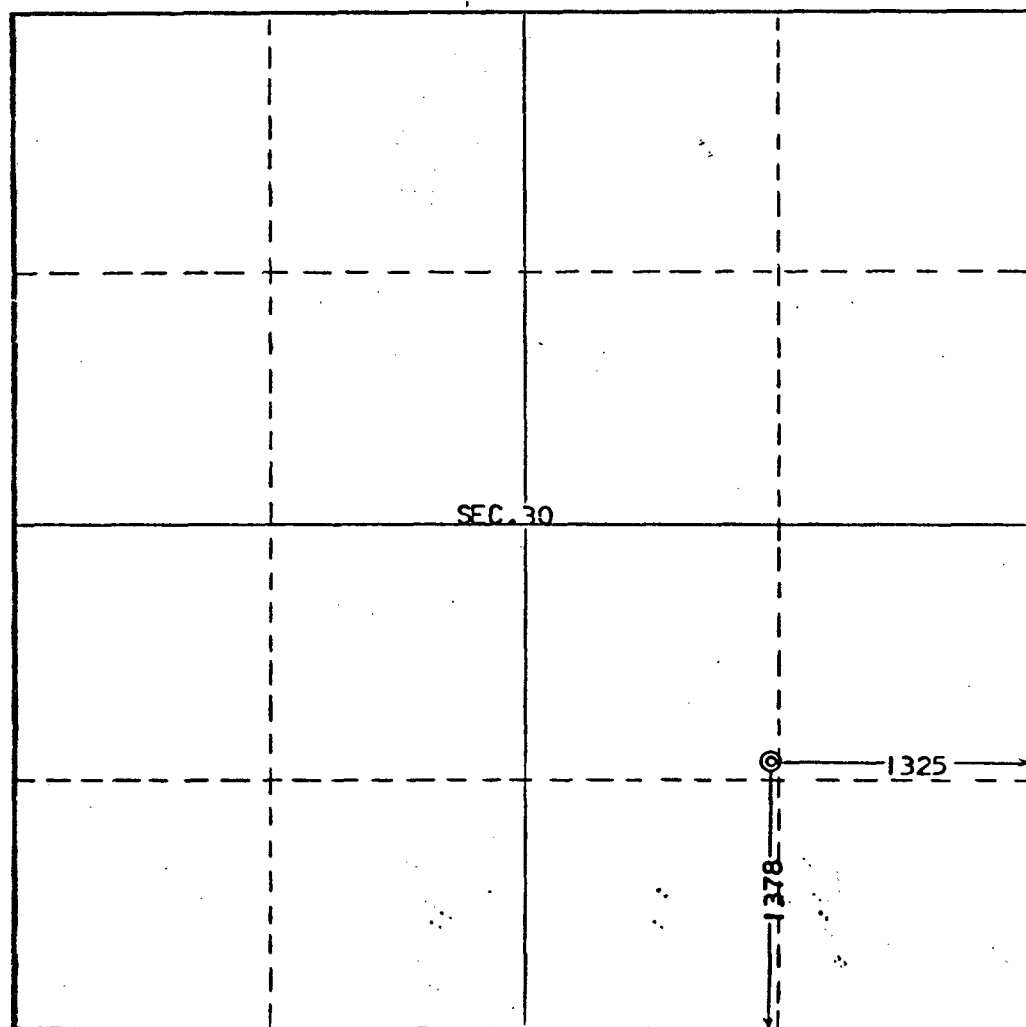

CERTIFICATION

I hereby certify that the information contained herein is true and complete to the best of my knowledge and belief.

Name
W. A. Walther Jr.
Position **W. A. Walther, Jr.**
Operations Manager
Company
ATLANTIC RICHFIELD COMPANY
Date

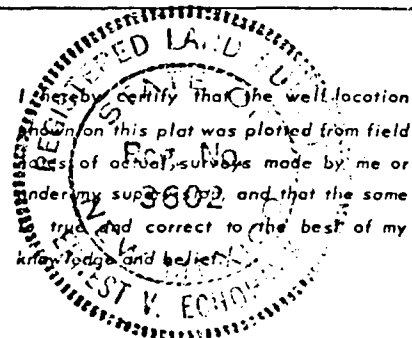

Date Surveyed
May 20, 1976
Registered Professional Engineer
and/or Land Surveyor
E. V. Echohawk
Certificate No. **3602**
E. V. Echohawk LS

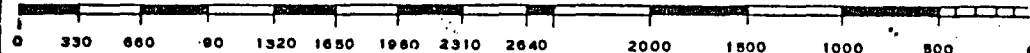

Elevation 5477' GL - Ungraded

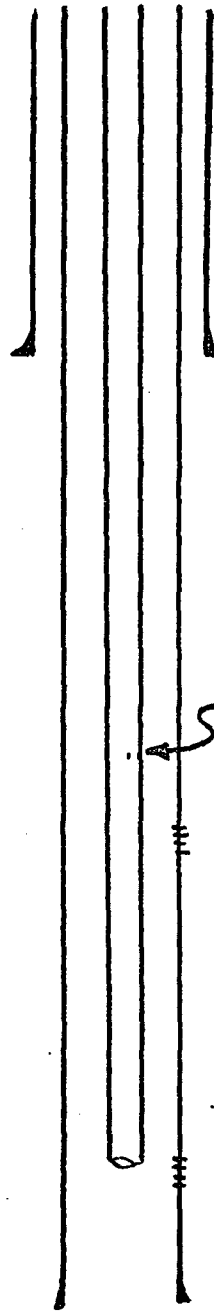

8-5/8" OD Casing set at 120' and cemented to surface

2-3/8" OD EUE tubing

Upper Gallup - Perforated as indicated from logs.

Lower Gallup - Perforated as indicated from logs.

5-1/2" OD casing set at total depth with sufficient cement to protect all zones.

1390' Estimated total depth.

HORSESHOE GALLUP UNIT, Well No. 294
Unit "J" - 1378' f/South & 1325' f/East lines
Section 30-31N-16W
San Juan County, New Mexico

UNITED STATES
DEPARTMENT OF THE INTERIOR
GEOLOGICAL SURVEY

APPLICATION FOR PERMIT TO DRILL, DEEPEN, OR PLUG BACK

1a. TYPE OF WORK

DRILL ☒DEEPEN ☐PLUG BACK ☐

b. TYPE OF WELL

OIL
WELL ☒GAS
WELL ☐OTHER ☐SINGLE
ZONE ☒MULTIPLE
ZONE ☐

2. NAME OF OPERATOR

Atlantic Richfield Company

3. ADDRESS OF OPERATOR

501 Lincoln Tower Bldg., 1860 Lincoln St., Denver, Colo. 80203

4. LOCATION OF WELL (Report location clearly and in accordance with any State requirements.)*

At surface

Unit "A" - 50' f/North & 50' f/East lines Sec. 31

At proposed prod. zone

Approx same

14. DISTANCE IN MILES AND DIRECTION FROM NEAREST TOWN OR POST OFFICE*

See attached maps

15. DISTANCE FROM PROPOSED* LOCATION TO NEAREST PROPERTY OR LEASE LINE, FT.
(Also to nearest drlg. unit line, if any)

5230' f/Tr. 12 line

18. DISTANCE FROM PROPOSED LOCATION* TO NEAREST WELL, DRILLING, COMPLETED, OR APPLIED FOR, ON THIS LEASE, FT.

862' f/#52 in NE NE Sec. 31

16. NO. OF ACRES IN LEASE TO THIS WELL

Tr. 12 - 2644.14 Ac

Unit - 13,527.80 Ac

19. PROPOSED DEPTH

1370'

17. NO. OF ACRES ASSIGNED TO THIS WELL

N/A - Unit

20. ROTARY OR CABLE TOOLS

Rotary

21. ELEVATIONS (Show whether DF, RT, GR, etc.)

5430' GL, Ungr.

22. APPROX. DATE WORK WILL START*

When appl rec'd.

Est 7/1/76 - Ad & lee.

Drlg after #294

23. PROPOSED CASING AND CEMENTING PROGRAM

SIZE OF HOLE	SIZE OF CASING	WEIGHT PER FOOT	SETTING DEPTH	QUANTITY OF CEMENT
12-1/4"	8-5/8"	24#	120'	120 Sx (Cmt to surface)
7-7/8"	5-1/2"	14#	T.D.	225 sx

Propose to drill well to depth sufficient to test the Gallup Formation. Est. tops: Upper Gallup 1155', Lower Gallup 1265'. Will set 8-5/8"OD surface casing at approx 120' and cement to surface; drill 7-7/8" hole to TD; log; if productive, set 5-1/2"OD casing w/ sufficient cement to protect all zones. Productive zone(s) will be perforated, treated if necessary, and well completed.

Re: New Mexico Oil Conservation Commission Order No. R-2210 & R-2210-A

Attachments: Certified Location Plat
Pertinent Drilling Information
Development Plan for Surface Use
Archaeological Clearance Report

IN ABOVE SPACE DESCRIBE PROPOSED PROGRAM: If proposal is to deepen or plug back, give data on present productive zone and proposed new productive zone. If proposal is to drill or deepen directionally, give pertinent data on subsurface locations and measured and true vertical depths. Give blowout preventer program, if any.

24.

SIGNED

W. A. Walther, Jr.
W. A. Walther, Jr.

TITLE Operations Manager

DATE 6/1/76

(This space for Federal or State office use)

PERMIT NO.

APPROVAL DATE

APPROVED BY

TITLE

DATE

CONDITIONS OF APPROVAL, IF ANY:

*See Instructions On Reverse Side

**NEW MEXICO OIL CONSERVATION COMMISSION
WELL LOCATION AND ACREAGE DEDICATION PLAT**

Form C-102
Supersedes C-128
Effective 1-1-65

All distances must be from the outer boundaries of the Section.

Operator Atlantic Richfield Company			Lease		Well No. 295
Unit Letter A	Section 31	Township 31	Range 16	County San Juan	

Actual Footage Location of Well: 50 feet from the North line and 50 feet from the East line					
Ground Level Elev. 5430	Producing Formation Gallup	Pool Horseshoe Gallup	Dedicated Acreage NA - Unitized		

1. Outline the acreage dedicated to the subject well by colored pencil or hachure marks on the plat below.
2. If more than one lease is dedicated to the well, outline each and identify the ownership thereof (both as to working interest and royalty).
3. If more than one lease of different ownership is dedicated to the well, have the interests of all owners been consolidated by communitization, unitization, force-pooling, etc?

☒ Yes ☐ No If answer is "yes," type of consolidation Unitization

If answer is "no," list the owners and tract descriptions which have actually been consolidated. (Use reverse side of this form if necessary.) _____

No allowable will be assigned to the well until all interests have been consolidated (by communitization, unitization, forced-pooling, or otherwise) or until a non-standard unit, eliminating such interests, has been approved by the Commission.

CERTIFICATION

I hereby certify that the information contained herein is true and complete to the best of my knowledge and belief.

Name W. A. Walther, Jr.
Position W. A. Walther, Jr.
Operations Manager

Company
ATLANTIC RICHFIELD COMPANY

Date _____

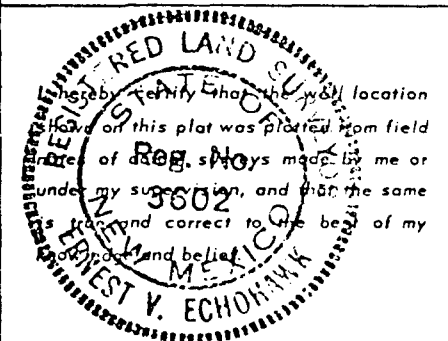

Date Surveyed
May 20, 1976

Registered Professional Engineer and/or Land Surveyor

E. V. Echoshawk

Certificate No. **3602**
E.V. Echoshawk LS

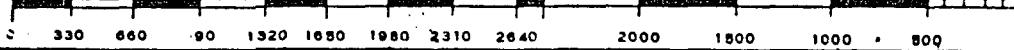

Elevation 5430' GL - Ungraded

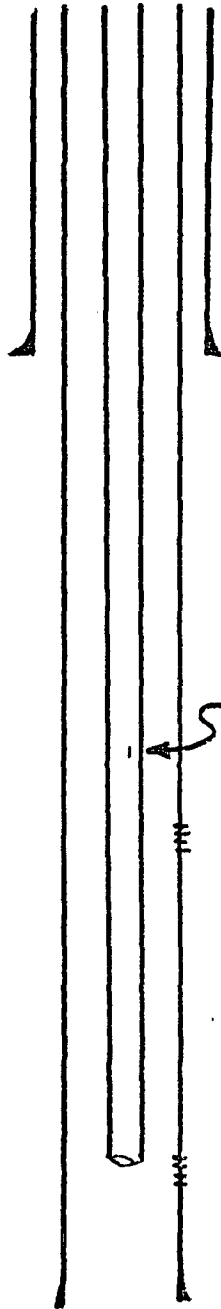

8-5/8"OD Casing set at 120' and cemented to surface

2-3/8"OD EUE tubing

Upper Gallup - Perforated as indicated from logs.

Lower Gallup - Perforated as indicated from logs.

5-1/2"OD casing set at total depth with sufficient cement to protect all zones.

1370' Estimated total depth.

HORSESHOE GALLUP UNIT, Well No. 295
Unit "A" - 50' f/North & 50' f/East lines
Section 31-31N-16W
San Juan County, New Mexico

UNITED STATES
DEPARTMENT OF THE INTERIOR
GEOLOGICAL SURVEY

APPLICATION FOR PERMIT TO DRILL, DEEPEN, OR PLUG BACK

1a. TYPE OF WORK

DRILL ☒DEEPEN ☐PLUG BACK ☐

b. TYPE OF WELL

OIL
WELL ☒GAS
WELL ☐OTHER ☐

2. NAME OF OPERATOR

Atlantic Richfield Company

3. ADDRESS OF OPERATOR

501 Lincoln Tower Bldg., 1860 Lincoln St., Denver, Colo. 80203

4. LOCATION OF WELL (Report location clearly and in accordance with any State requirements.)*

At surface

Unit I - 1350' f/South & 1250' f/East lines Sec. 32

At proposed prod. zone

Approx same

14. DISTANCE IN MILES AND DIRECTION FROM NEAREST TOWN OR POST OFFICE*

See attached maps

15. DISTANCE FROM PROPOSED* 1350' f/Tr. 12 line
LOCATION TO NEAREST
PROPERTY OR LEASE LINE, FT.
(Also to nearest drlg. unit line, if any)18. DISTANCE FROM PROPOSED LOCATION* 1011' f/#2 in
TO NEAREST WELL, DRILLING, COMPLETED, IN SE & #49
OR APPLIED FOR, ON THIS LEASE, FT. in SW SE, Sec. 3216. NO. OF ACRES IN LEASE
Tr. 12 - 2644.14 Ac
Unit - 13,527.80 Ac19. PROPOSED DEPTH
1350'17. NO. OF ACRES ASSIGNED
TO THIS WELL
N/A - Unit20. ROTARY OR CABLE TOOLS
Rotary

21. ELEVATIONS (Show whether DF, RT, GR, etc.)

5336' GL, Ungr.

22. APPROX. DATE WORK WILL START*

When appl rec'd
Est. 7/1/76 - Rd & loc.

23.

PROPOSED CASING AND CEMENTING PROGRAM

Drlg after #295

SIZE OF HOLE	SIZE OF CASING	WEIGHT PER FOOT	SETTING DEPTH	QUANTITY OF CEMENT
12-1/4"	8-5/8"	24#	120'	120 sx (Cnt to surface)
7-7/8"	5-1/2"	14#	T.D.	225 sx

Propose to drill well to depth sufficient to test the Gallup Formation. Est. tops: Upper Gallup 1090', Lower Gallup 1200'. Will set 8-5/8" OD surface casing at approx. 120' and cement to surface; drill 7-7/8" hole to TD; log; if productive, set 5-1/2" OD casing w/ sufficient cement to protect all zones. Productive zone(s) will be perforated, treated if necessary, and well completed.

Re: New Mexico Oil Conservation Commission Order No. R-2210 & R-2210-A

Attachments: Certified Location Plat
Pertinent Drilling Information
Development Plan for Surface Use
Archaeological Clearance Report

IN ABOVE SPACE DESCRIBE PROPOSED PROGRAM: If proposal is to deepen or plug back, give data on present productive zone and proposed new productive zone. If proposal is to drill or deepen directionally, give pertinent data on subsurface locations and measured and true vertical depths. Give blowout preventer program, if any.

24.

SIGNED

W. A. Walther, Jr.

TITLE

Operations Manager

DATE

6/4/76

(This space for Federal or State office use)

PERMIT NO.

APPROVAL DATE

APPROVED BY

TITLE

DATE

CONDITIONS OF APPROVAL, IF ANY:

*See Instructions On Reverse Side

**NEW MEXICO OIL CONSERVATION COMMISSION
WELL LOCATION AND ACREAGE DEDICATION PLAT**

Form C-102
Supersedes C-128
Effective 1-1-65

All distances must be from the outer boundaries of the Section.

Operator Atlantic Richfield Company			Lease		Well No. 296
Unit Letter 1	Section 32	Township 31	Range 16	County San Juan	
Actual Footage Location of Well:					
1350 feet from the South line and		1250 feet from the East line			
Ground Level Elev. 5336	Producing Formation Gallup	Pool Horseshoe Gallup	Dedicated Acreage NA - Unitized		

1. Outline the acreage dedicated to the subject well by colored pencil or hachure marks on the plat below. Reg. Order No. R-2210-
2. If more than one lease is dedicated to the well, outline each and identify the ownership thereof (both as to working interest and royalty).
3. If more than one lease of different ownership is dedicated to the well, have the interests of all owners been consolidated by communitization, unitization, force-pooling, etc?

☒ Yes ☐ No If answer is "yes," type of consolidation Unitization

If answer is "no," list the owners and tract descriptions which have actually been consolidated. (Use reverse side of this form if necessary.) _____

No allowable will be assigned to the well until all interests have been consolidated (by communitization, unitization, forced-pooling, or otherwise) or until a non-standard unit, eliminating such interests, has been approved by the Commission.

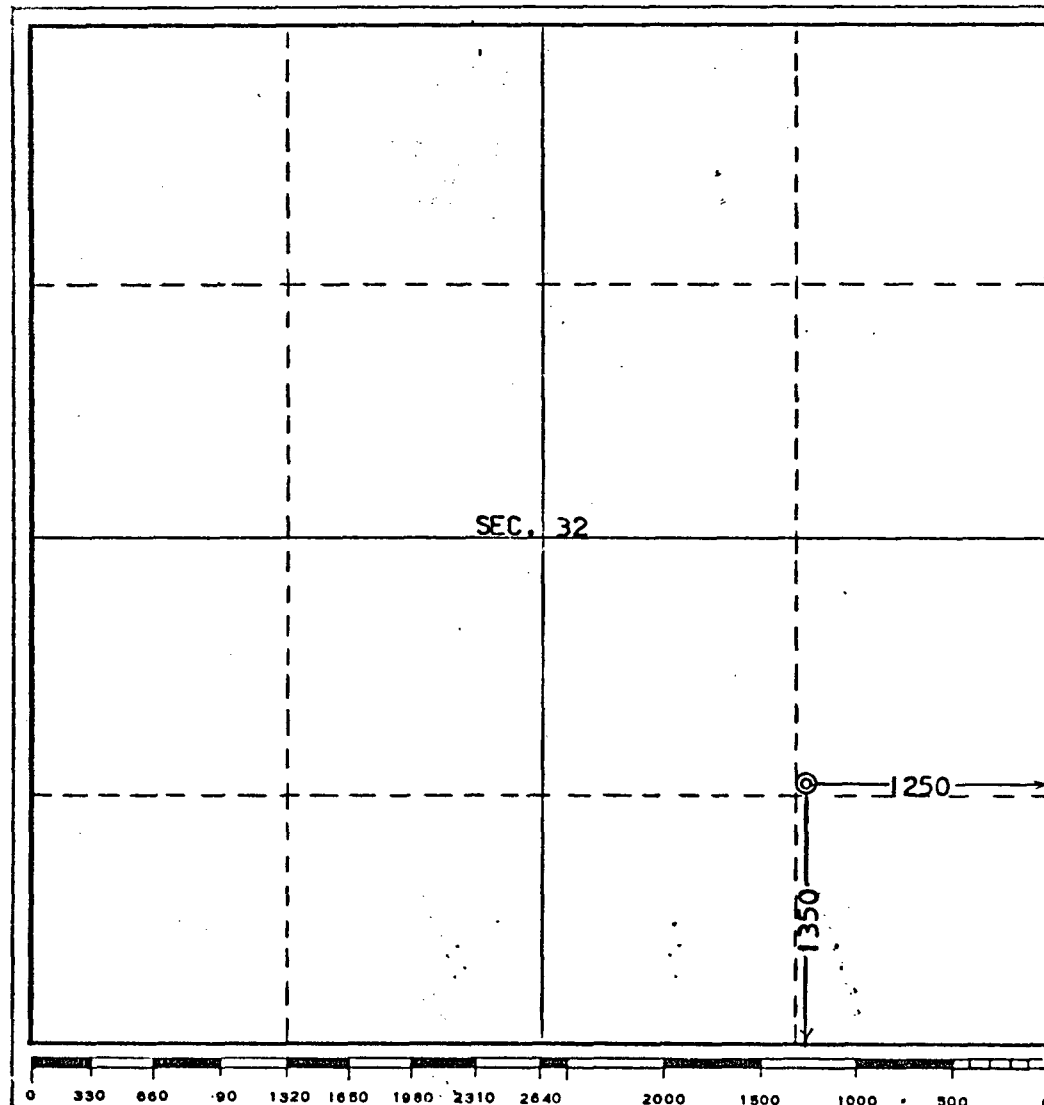

CERTIFICATION

I hereby certify that the information contained herein is true and complete to the best of my knowledge and belief.

Name W. A. Walther, Jr.
Position W. A. Walther, Jr.
Operations Manager
Company ATLANTIC RICHFIELD COMPANY
Date _____

I hereby certify that the well location shown on this plat was plotted from field notes of actual surveys made by me or under my supervision and that the same is true and correct to the best of my knowledge and belief.

Date Surveyed May 20, 1976

Registered Professional Engineer and/or Land Surveyor

E. V. Echahawk
Certificate No. 3602
E.V. Echahawk LS

Elevation 5336' GL, Ungraded

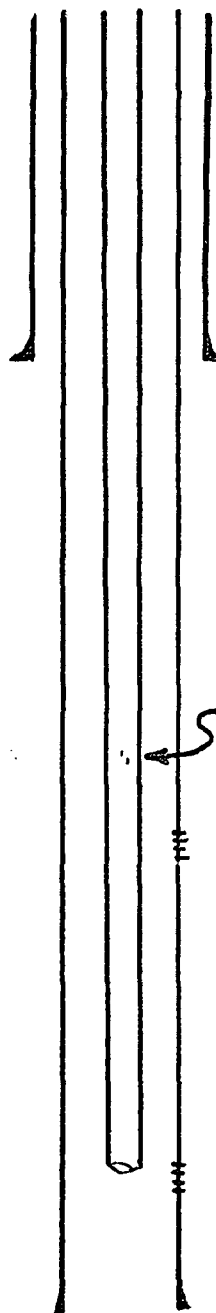

8-5/8"OD Casing set at 120' and cemented to surface

2-3/8"OD EUE tubing

Upper Gallup - Perforated as indicated from logs.

Lower Gallup - Perforated as indicated from logs.

5-1/2"OD casing set at total depth with sufficient
cement to protect all zones.

1350' Estimated total depth.

HORSESHOE GALLUP UNIT, Well No. 296
Unit "I" - 1350' f/South & 1250' f/East lines
Section 32-31N-16W
San Juan County, New Mexico

UNITED STATES
DEPARTMENT OF THE INTERIOR
GEOLOGICAL SURVEY

APPLICATION FOR PERMIT TO DRILL, DEEPEN, OR PLUG BACK

1a. TYPE OF WORK

DRILL ☒DEEPEN ☐PLUG BACK ☐

b. TYPE OF WELL

OIL WELL ☒GAS WELL ☐OTHER ☐

2. NAME OF OPERATOR

Atlantic Richfield Company

3. ADDRESS OF OPERATOR

501 Lincoln Tower Bldg., 1860 Lincoln St., Denver, Colo. 80203

4. LOCATION OF WELL (Report location clearly and in accordance with any State requirements.)*

At surface

Unit I - 1550' f/South & 1250' f/East lines Sec. 4

At proposed prod. zone

Approx same

14. DISTANCE IN MILES AND DIRECTION FROM NEAREST TOWN OR POST OFFICE*

See attached maps

15. DISTANCE FROM PROPOSED* LOCATION TO NEAREST PROPERTY OR LEASE LINE, FT.
(Also to nearest drlg. unit line, if any)

70' f/Tr.33 line

18. DISTANCE FROM PROPOSED LOCATION* TO NEAREST WELL, DRILLING, COMPLETED, OR APPLIED FOR, ON THIS LEASE, FT. in

731' f/#245

in NE SE Sec. 4

16. NO. OF ACRES IN LEASE

Tr.33 - 515.50 Ac

Unit - 13,527.80 Ac

19. PROPOSED DEPTH

1360'

17. NO. OF ACRES ASSIGNED TO THIS WELL

N/A - Unit

20. ROTARY OR CABLE TOOLS

Rotary

21. ELEVATIONS (Show whether DF, RT, GR, etc.)

5359' GI, Ungr.

22. APPROX. DATE WORK WILL START*

When appl rec'd

Est 7/1/76 - rd & lcc

Drlg after #296

23.

PROPOSED CASING AND CEMENTING PROGRAM

SIZE OF HOLE	SIZE OF CASING	WEIGHT PER FOOT	SETTING DEPTH	QUANTITY OF CEMENT
12-1/4"	8-5/8"	21#	120'	120 sx (Gmt to surf)
7-7/8"	5-1/2"	11#	T.D.	225 sx

Propose to drill well to depth sufficient to test the Gallup Formation. Est. tops: Upper Gallup 1145', Lower Gallup 1255'. Will set 8-5/8" OD surface casing at approx 120' and cement to surface; drill 7-7/8" hole to T.D.; log; if productive, set 5-1/2" OD casing w/ sufficient cement to protect all zones. Productive zone(s) will be perforated, treated if necessary, and well completed.

Re: New Mexico Oil Conservation Commission Order No. R-2210 & R-2210-A

Attachments: Certified Location Plat
Pertinent Drilling Information
Development Plan for Surface Use w/ att.
Archaeological Clearance Report.

IN ABOVE SPACE DESCRIBE PROPOSED PROGRAM: If proposal is to deepen or plug back, give data on present productive zone and proposed new productive zone. If proposal is to drill or deepen directionally, give pertinent data on subsurface locations and measured and true vertical depths. Give blowout preventer program, if any.

24.

SIGNED

W. A. Walther, Jr.
W. A. Walther, Jr.
(This space for Federal or State office use)

TITLE

Operations Manager

DATE

6/1/76

PERMIT NO.

APPROVAL DATE

APPROVED BY

TITLE

DATE

CONDITIONS OF APPROVAL, IF ANY:

*See Instructions On Reverse Side

**NEW MEXICO OIL CONSERVATION COMMISSION
WELL LOCATION AND ACREAGE DEDICATION PLAT**

Form C-102
Supersedes C-128
Effective 1-1-65

All distances must be from the outer boundaries of the Section.

Operator AtlanticRichfieldCompany			Lease		Well No. 297
Unit Letter I	Section 4	Township 30 North	Range 16 West	County San Juan	
Actual Footage Location of Well: 1550 feet from the South line and 1250 feet from the East line					
Ground Level Elev. 5359	Producing Formation Gallup	Pool Horseshoe Gallup	Dedicated Acreage: NA - Unitized Acres		

1. Outline the acreage dedicated to the subject well by colored pencil or hachure marks on the plat below. Re: Order No. R-2210-
2. If more than one lease is dedicated to the well, outline each and identify the ownership thereof (both as to working interest and royalty).
3. If more than one lease of different ownership is dedicated to the well, have the interests of all owners been consolidated by communitization, unitization, force-pooling, etc?

☒ Yes ☐ No If answer is "yes," type of consolidation Unitization

If answer is "no," list the owners and tract descriptions which have actually been consolidated. (Use reverse side of this form if necessary.) _____

No allowable will be assigned to the well until all interests have been consolidated (by communitization, unitization, forced-pooling, or otherwise) or until a non-standard unit, eliminating such interests, has been approved by the Commission.

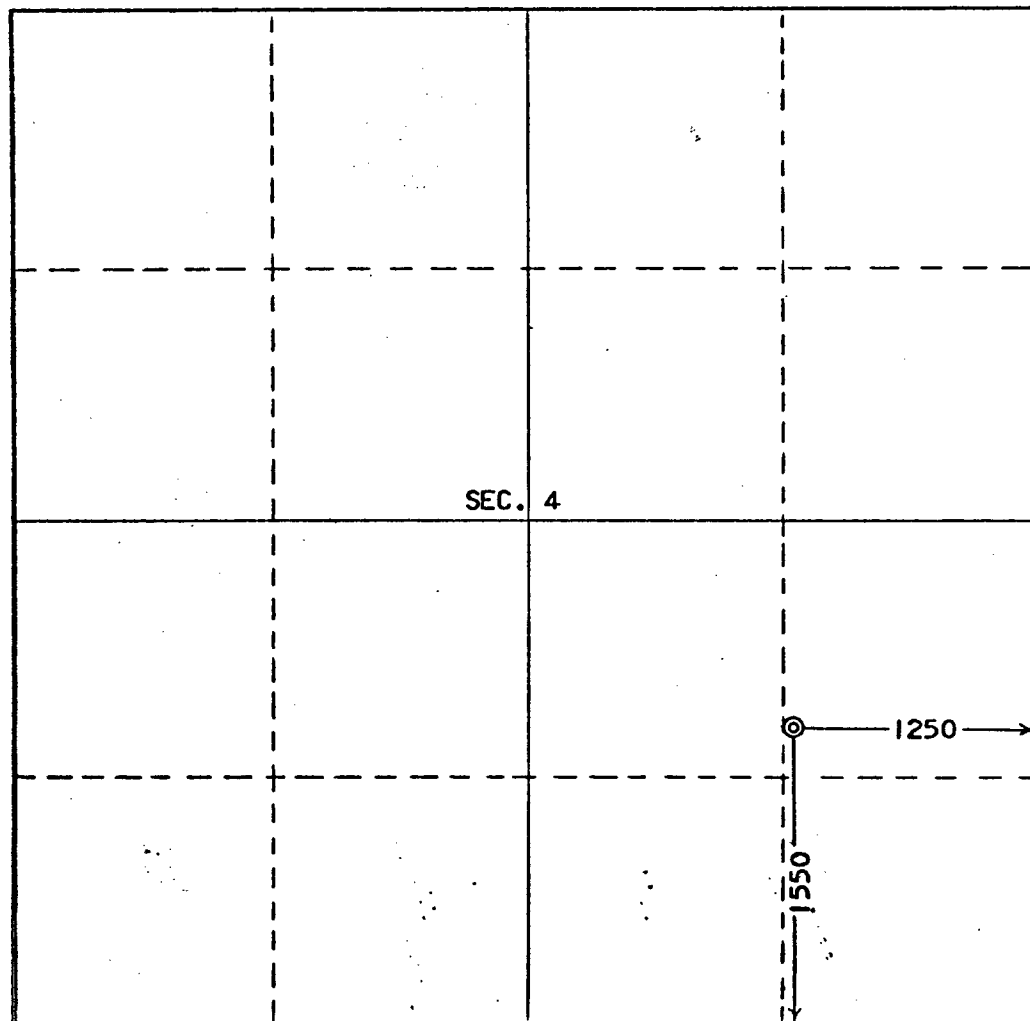

CERTIFICATION

I hereby certify that the information contained herein is true and complete to the best of my knowledge and belief.

Name W. A. Walther, Jr.
 Position W. A. Walther, Jr.
Operations Manager
 Company ATLANTIC RICHFIELD COMPANY
 Date _____

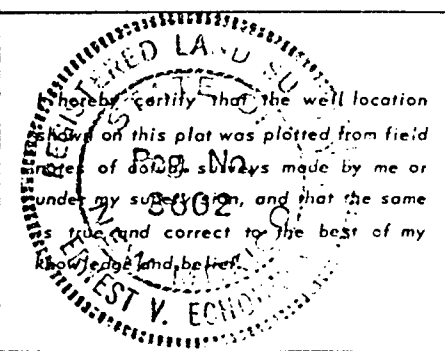

Date Surveyed **May 20, 1976**
 Registered Professional Engineer
 and/or Land Surveyor

E. V. Echohawk
 Certificate No. **3602**
E. V. Echohawk LS

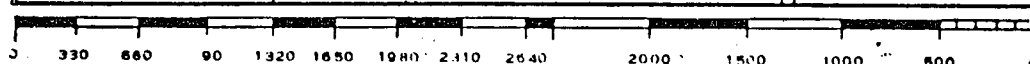

Elevation 5359' GL - Ungraded

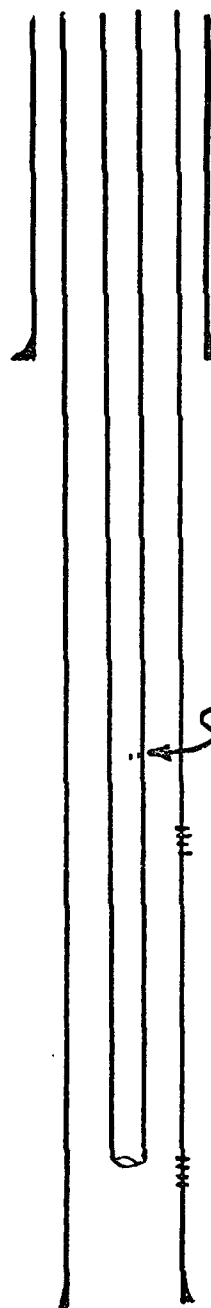

8-5/8" OD Casing set at 120' and cemented to surface

2-3/8" OD EUE tubing

Upper Gallup - Perforated as indicated from logs.

Lower Gallup - Perforated as indicated from logs.

5-1/2" OD casing set at total depth with sufficient cement to protect all zones.

1360' Estimated total depth.

HORSESHOE GALLUP UNIT, Well No. 297
Unit "I" - 1550' f/South & 1250' f/East lines
Section 4-30N-16W
San Juan County, New Mexico

UNITED STATES
DEPARTMENT OF THE INTERIOR
GEOLOGICAL SURVEY

APPLICATION FOR PERMIT TO DRILL, DEEPEN, OR PLUG BACK

1a. TYPE OF WORK DRILL <input checked="" type="checkbox"/> DEEPEN <input type="checkbox"/> PLUG BACK <input type="checkbox"/>		5. LEASE DESIGNATION AND SERIAL NO. SF - 081226	
b. TYPE OF WELL OIL WELL <input checked="" type="checkbox"/> GAS WELL <input type="checkbox"/> OTHER <input type="checkbox"/>		6. IF INDIAN, ALLOTTEE OR TRIBE NAME	
2. NAME OF OPERATOR Atlantic Richfield Company		7. UNIT AGREEMENT NAME Horseshoe Gallup Unit	
3. ADDRESS OF OPERATOR 501 Lincoln Tower Bldg., 1860 Lincoln St., Denver, Colo. 80203		8. FARM OR LEASE NAME Horseshoe Gallup Unit	
4. LOCATION OF WELL (Report location clearly and in accordance with any State requirements.) At surface Unit I - 1550' f/South & 1250' f/East lines Sec. 4 At proposed prod. zone Approx same		9. WELL NO. 297	
14. DISTANCE IN MILES AND DIRECTION FROM NEAREST TOWN OR POST OFFICE* See attached maps		10. FIELD AND POOL, OR WILDCAT Horseshoe Gallup	
15. DISTANCE FROM PROPOSED* LOCATION TO NEAREST PROPERTY OR LEASE LINE, FT. (Also to nearest drlg. unit line, if any) 70' f/Tr.33 line		11. SEC., T., R., M., OR BLK. AND SURVEY OR AREA Sec. 4-30N-16W	
16. NO. OF ACRES IN LEASE Tr.33 - 515.50 Ac Unit - 13,527.80 Ac		12. COUNTY OR PARISH San Juan	
17. NO. OF ACRES ASSIGNED TO THIS WELL N/A - Unit		13. STATE New Mexico	
18. DISTANCE FROM PROPOSED LOCATION* TO NEAREST WELL, DRILLING, COMPLETED, OR APPLIED FOR, ON THIS LEASE, FT. in NE SE Sec. 4 731' f/#245		19. PROPOSED DEPTH 1360'	
20. ROTARY OR CABLE TOOLS Rotary		21. APPROX. DATE WORK WILL START* When appl rec'd Est 7/1/76 - rd & loc Drlg after #296	

22. APPROX. DATE WORK WILL START* When appl rec'd Est 7/1/76 - rd & loc Drlg after #296				
23. PROPOSED CASING AND CEMENTING PROGRAM				
SIZE OF HOLE	SIZE OF CASING	WEIGHT PER FOOT	SETTING DEPTH	QUANTITY OF CEMENT
12-1/4"	8-5/8"	24#	120'	120 sx (Cmt to surf)
7-7/8"	5-1/2"	14#	T.D.	225 sx

Propose to drill well to depth sufficient to test the Gallup Formation. Est. tops: Upper Gallup 1145', Lower Gallup 1255'. Will set 8-5/8" OD surface casing at approx 120' and cement to surface; drill 7-7/8" hole to T.D.; log; if productive, set 5-1/2" OD casing w/ sufficient cement to protect all zones. Productive zone(s) will be perforated, treated if necessary, and well completed.

Re: New Mexico Oil Conservation Commission Order No. R-2210 & R-2210-A

Attachments: Certified Location Plat
Pertinent Drilling Information
Development Plan for Surface Use w/ att.
Archaeological Clearance Report.

IN ABOVE SPACE DESCRIBE PROPOSED PROGRAM: If proposal is to deepen or plug back, give data on present productive zone and proposed new productive zone. If proposal is to drill or deepen directionally, give pertinent data on subsurface locations and measured and true vertical depths. Give blowout preventer program, if any.

24. SIGNED W. A. Walther, Jr. TITLE Operations Manager DATE 6/1/76
(This space for Federal or State office use)

PERMIT NO. _____ APPROVAL DATE _____

APPROVED BY _____ TITLE _____ DATE _____
CONDITIONS OF APPROVAL, IF ANY:

*See Instructions On Reverse Side

NSL-776

OIL CONSERVATION COMMISSION
Alto DISTRICT

OIL CONSERVATION COMMISSION
BOX 2088
SANTA FE, NEW MEXICO

DATE

RE:

Proposed MC

Proposed DHC

Proposed NSL

Proposed SWD

Proposed WFX

Proposed PMX

Jim Kapteina

Gentlemen:

I have examined the application dated _____
for the Atlantic Richfield Horseshoe Gulch Unit # 294
Operator Lease and Well No. Unit, S-T-R

and my recommendations are as follows:

*This is one of six or seven wells
on one application. It now complies
with Order R-2210-A.*

approve

Yours very truly,

AR Kendrick

NEW MEXICO OIL CONSERVATION COMMISSION
WELL LOCATION AND ACREAGE DEDICATION PLAT

Form C-102
Supersedes C-128
Effective 1-1-65

All distances must be from the outer boundaries of the Section.

Operator Atlantic Richfield Company			Lease Horseshoe Gallup Unit		Well No. 294
Unit Letter J	Section 30	Township 31 North	Range 16 West	County San Juan	
Actual Footage Location of Well: 1378 feet from the South line and 1330 feet from the East line					
Ground Level Elev. 5477	Producing Formation Gallup		Pool Horseshoe Gallup		Dedicated acreage: NA - Unitized

1. Outline the acreage dedicated to the subject well by colored pencil or hachure marks on the plat below.
2. If more than one lease is dedicated to the well, outline each and identify the ownership thereof (both as to working interest and royalty).
3. If more than one lease of different ownership is dedicated to the well, have the interests of all owners been consolidated by communitization, unitization, force-pooling, etc?

☒ Yes ☐ No If answer is "yes," type of consolidation Unitization

If answer is "no," list the owners and tract descriptions which have actually been consolidated. (Use reverse side of this form if necessary.)

No allowable will be assigned to the well until all interests have been consolidated (by communitization, unitization, forced-pooling, or otherwise) or until a non-standard unit, eliminating such interests, has been approved by the Commission.

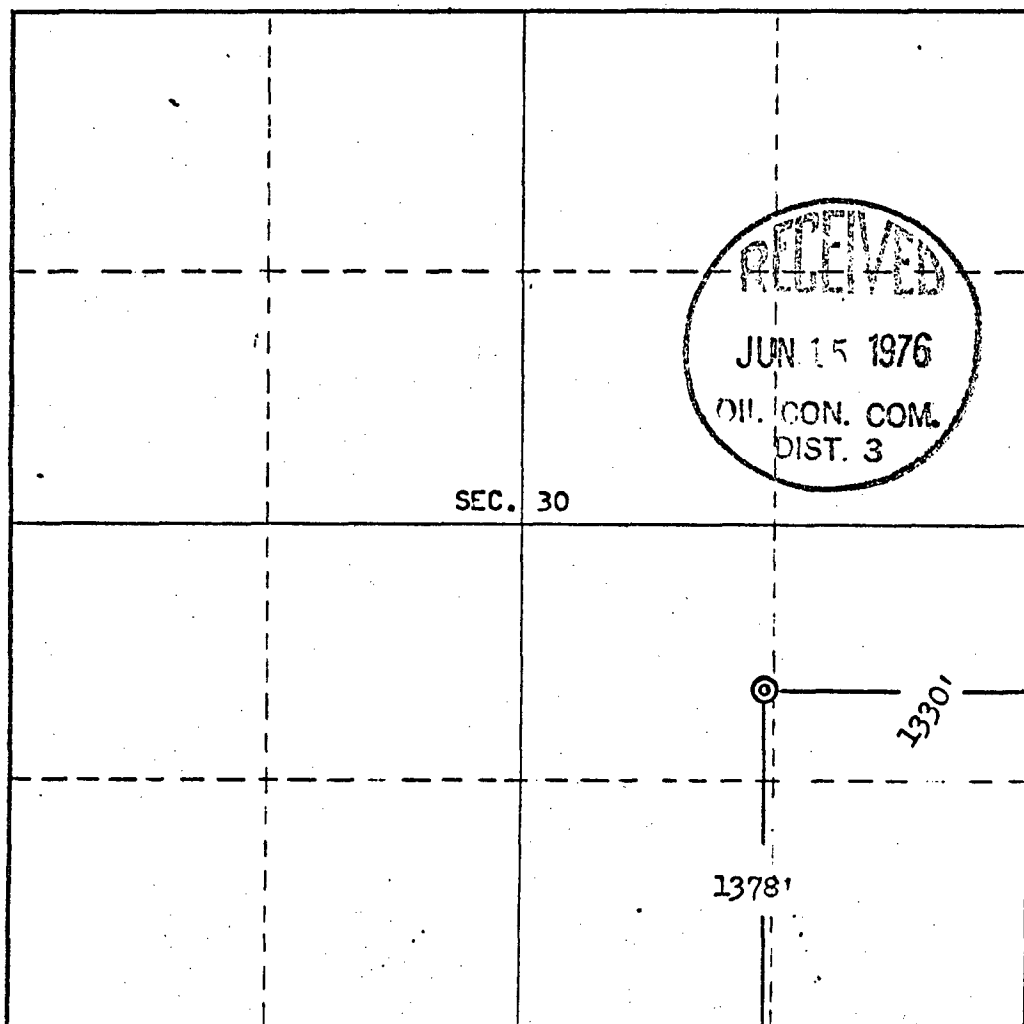

CERTIFICATION

I hereby certify that the information contained herein is true and complete to the best of my knowledge and belief.

Name W. A. Walther, Jr.
Operations Manager

Position
ATLANTIC RICHFIELD COMPANY

Company
June 11, 1976

Date

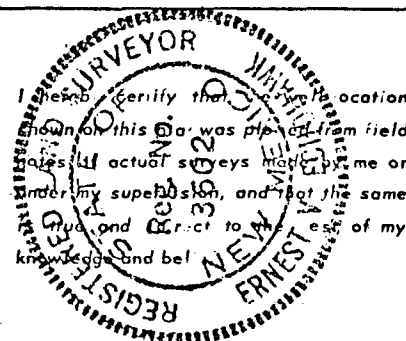

Date Surveyed
May 20, 1976

Registered Professional Engineer
and/or Land Surveyor

E. V. Echoshawk

Certificate No. 3602
E. V. Echoshawk LS

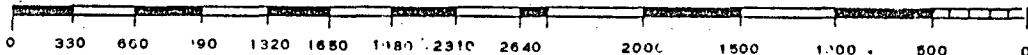

AtlanticRichfieldCompany

North American Producing Division
Rocky Mountain District
1860 Lincoln St. — Suite 501
Denver, Colorado 80203
Telephone 303 573-4049

W. A. Walther, Jr.
Operations Manager

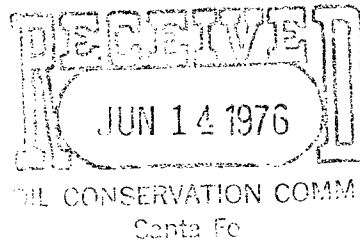

June 11, 1976

Mr. Joe D. Ramey, Director
State of New Mexico Oil Conservation Comm.
P. O. Box 2088
Santa Fe, New Mexico 87501

Re: Horseshoe Gallup Unit
San Juan County, New Mexico

Dear Mr. Ramey:

As an amendment to our June 7, 1976 letter, requesting administrative approval to drill seven (7) unorthodox located Horseshoe Gallup Unit wells, please make the attached copy of the Sundry Notice and Certified Location plat, changing the location of Well No. 294, a part of the June 7, 1976 letter. This revised location will comply with the provisions of Order No. R-2210-A.

Very truly yours,

W A Walther Jr
W. A. Walther, Jr.

Encls.

UNITED STATES
DEPARTMENT OF THE INTERIOR
GEOLOGICAL SURVEY

SUBMIT IN TRIPPLICATE*
(Other instructions on reverse side)

Form approved.
Budget Bureau No. 42-R1424.

SUNDRY NOTICES AND REPORTS ON WELLS

(Do not use this form for proposals to drill or to deepen or plug back to a different reservoir.
Use "APPLICATION FOR PERMIT—" for such proposals.)

1. OIL WELL <input checked="" type="checkbox"/> GAS WELL <input type="checkbox"/> OTHER <input type="checkbox"/>		5. LEASE DESIGNATION AND SERIAL NO. 14-20-603-734	
2. NAME OF OPERATOR Atlantic Richfield Company		6. IF INDIAN, ALLOTTEE OR TRIBE NAME Navajo	
3. ADDRESS OF OPERATOR 501 Lincoln Tower Bldg., 1860 Lincoln St., Denver, Colo. 80203		7. UNIT AGREEMENT NAME Horseshoe Gallup Unit	
4. LOCATION OF WELL (Report location clearly and in accordance with any State requirements.* See also space 17 below.) At surface 1378' f/South and 1330' f/East lines Sec. 30		8. FARM OR LEASE NAME Horseshoe Gallup Unit	
14. PERMIT NO.		9. WELL NO. 294	
15. ELEVATIONS (Show whether DF, RT, GR, etc.) 5477'		10. FIELD AND POOL, OR WILDCAT Horseshoe Gallup	
		11. SEC., T., R., M., OR BLK. AND SURVEY OR AREA Section 30-31N-16W	
		12. COUNTY OR PARISH San Juan	13. STATE New Mexico

16. Check Appropriate Box To Indicate Nature of Notice, Report, or Other Data

NOTICE OF INTENTION TO:		SUBSEQUENT REPORT OF:	
TEST WATER SHUT-OFF <input type="checkbox"/>	PULL OR ALTER CASING <input type="checkbox"/>	WATER SHUT-OFF <input type="checkbox"/>	REPAIRING WELL <input type="checkbox"/>
FRACTURE TREAT <input type="checkbox"/>	MULTIPLE COMPLETE <input type="checkbox"/>	FRACTURE TREATMENT <input type="checkbox"/>	ALTERING CASING <input type="checkbox"/>
SHOOT OR ACIDIZE <input type="checkbox"/>	ABANDON* <input type="checkbox"/>	SHOOTING OR ACIDIZING <input type="checkbox"/>	ABANDONMENT* <input type="checkbox"/>
REPAIR WELL <input type="checkbox"/>	CHANGE PLANS <input type="checkbox"/>	(Other) <input type="checkbox"/>	
(Other) <input type="checkbox"/>	Change location <input checked="" type="checkbox"/>	(NOTE: Report results of multiple completion on Well Completion or Recompletion Report and Log form.)	

17. DESCRIBE PROPOSED OR COMPLETED OPERATIONS (Clearly state all pertinent details, and give pertinent dates, including estimated date of starting any proposed work. If well is directionally drilled, give subsurface locations and measured and true vertical depths for all markers and zones pertinent to this work.)*

Initially proposed 1378' f/South and 1325' f/East lines of Section 30-31N-16W.
This location did not meet the provisions of New Mexico Oil Conservation Commission Order No. R-2210-A, regarding unorthodox locations. Propose to move location 5' West to the above designated location to comply with Order No. R-2210-A.

Certified Location Plat attached.

18. I hereby certify that the foregoing is true and correct

SIGNED <u>W. A. Walther, Jr.</u>	TITLE <u>Operations Manager</u>	DATE <u>June 11, 1976</u>
(This space for Federal or State office use)		
APPROVED BY _____	TITLE _____	DATE _____
CONDITIONS OF APPROVAL, IF ANY:		

**NEW MEXICO OIL CONSERVATION COMMISSION
WELL LOCATION AND ACREAGE DEDICATION PLAT**

Form C-102
Supersedes C-128
Effective 1-1-65

All distances must be from the outer boundaries of the Section

JUN 14 1976

Operator Atlantic Richfield Company			Lease Horseshoe Gallup Unit		Well No. 294
Unit Letter J	Section 30	Township 31 North	Range 16 West	County Santa Fe	
Actual Footage Location of Well: 1378. feet from the South line and 1330 feet from the East line					
Ground Level Elev. 5477	Producing Formation Gallup		Pool Horseshoe Gallup		Dedicated Acreage: NA - Unitized

1. Outline the acreage dedicated to the subject well by colored pencil or hachure marks on the plat below.
2. If more than one lease is dedicated to the well, outline each and identify the ownership thereof (both as to working interest and royalty).
3. If more than one lease of different ownership is dedicated to the well, have the interests of all owner- been consolidated by communitization, unitization, force-pooling, etc?

Re. Order No. R-2210-A

☒ Yes ☐ No If answer is "yes," type of consolidation **Unitization**

If answer is "no," list the owners and tract descriptions which have actually been consolidated. (Use reverse side of this form if necessary.) _____

No allowable will be assigned to the well until all interests have been consolidated (by communitization, unitization, forced-pooling, or otherwise) or until a non-standard unit, eliminating such interests, has been approved by the Commission.

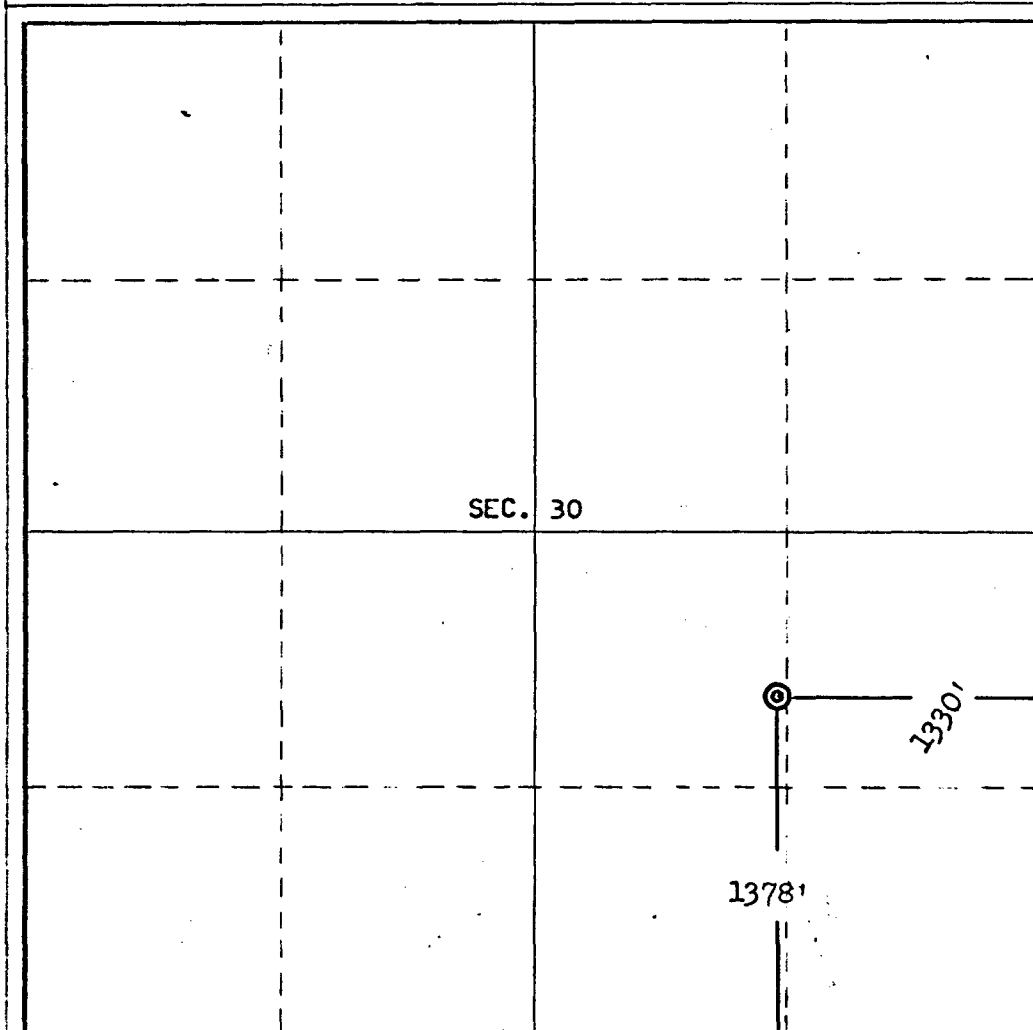

CERTIFICATION

I hereby certify that the information contained herein is true and complete to the best of my knowledge and belief.

W. A. Walther, Jr.
Name **W. A. Walther, Jr.**
Position **Operations Manager**

Company **ATLANTIC RICHFIELD COMPANY**

Date **June 11, 1976**

Date

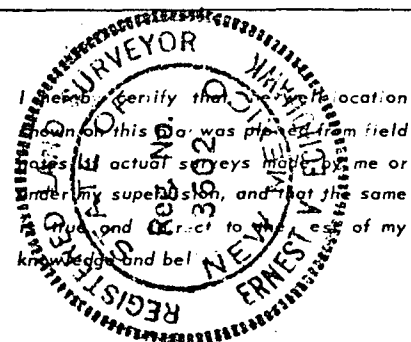

Date Surveyed **May 20, 1976**

Registered Professional Engineer and/or Land Survey

E. V. Echoshawk

Certificate No. **3602**
E.V. Echoshawk LS



UNITED STATES
DEPARTMENT OF THE INTERIOR
GEOLOGICAL SURVEY

APPLICATION FOR PERMIT TO DRILL, DEEPEN, OR PLUG BACK

1. TYPE OF WORK

DRILL ☒DEEPEN ☐PLUG BACK ☐

2. TYPE OF WELL

OIL
WELL ☒GAS
WELL ☐OTHER ☐SINGLE
ZONE ☒MULTIPLE
ZONE ☐

3. NAME OF OPERATOR

Atlantic Richfield Company

4. ADDRESS OF OPERATOR

501 Lincoln Tower Bldg., 1860 Lincoln St., Denver, Colo. 80203

5. LOCATION OF WELL (Report location clearly and in accordance with any State requirements.)*

At surface

Unit A - 50' f/North & 50' f/East lines Sec. 23

At proposed prod. zone

Approx. Same

6. DISTANCE IN MILES AND DIRECTION FROM NEAREST TOWN OR POST OFFICE*

See attached maps

7. DISTANCE FROM PROPOSED*

2590' f/Tr. 13 line

LOCATION TO NEAREST

PROPERTY OR LEASE LINE, FT.

(Also to nearest drlg. unit line, if any)

8. DISTANCE FROM PROPOSED LOCATION*

812' f/#84 in

TO NEAREST WELL, DRILLING, COMPLETED,

OR APPLIED FOR, ON THIS LEASE, FT. NE NE Sec. 23

9. NO. OF ACRES IN LEASE

Tr. 13, 1442.28 Ac.

Unit 13, 527.80 Ac.

10. PROPOSED DEPTH

1650'

11. NO. OF ACRES ASSIGNED

TO THIS WELL

N/A Unit

12. ROTARY OR CABLE TOOLS

Rotary

13. ELEVATIONS (Show whether DF, RT, GR, etc.)

5873' GL, Ungr.

14. APPROX. DATE WORK WILL START*

When appls rec'd.

15.

Est. 7/1/76

PROPOSED CASING AND CEMENTING PROGRAM

SIZE OF HOLE	SIZE OF CASING	WEIGHT PER FOOT	SETTING DEPTH	QUANTITY OF CEMENT
12-1/4"	8-5/8"	21#	120'	120 sx (Cmt to surface)
7-7/8"	5-1/2"	11#	T.D.	225 sx

Propose to drill well to depth sufficient to test the Gallup Formation. Est. tops: Upper Gallup 1424', Lower Gallup 1534'. Will set 8-5/8" surface casing at approx. 120' and cement to surface; drill 7-7/8" hole to T.D.; log; if productive, set 5-1/2" casing with sufficient cement to protect all zones. Productive zone(s) will be perforated, treated if necessary, and well completed.

Re: New Mexico Oil Conservation Commission Order No. R-2210 & R-2210-A

Attachments: Certified Location Plat
Pertinent Drilling Information
Development Plan for Surface Use w/ att.
Archaeological Clearance Report

IN ABOVE SPACE DESCRIBE PROPOSED PROGRAM: If proposal is to deepen or plug back, give data on present productive zone and proposed new productive zone. If proposal is to drill or deepen directionally, give pertinent data on subsurface locations and measured and true vertical depths. Give blowout preventer program, if any.

24.

SIGNED

W. A. Walther, Jr.
W. A. Walther, Jr.

TITLE

Operations Manager

DATE

6/4/76

(This space for Federal or State office use)

PERMIT NO.

APPROVAL DATE

APPROVED BY

TITLE

DATE

CONDITIONS OF APPROVAL, IF ANY:

*See Instructions On Reverse Side

**NEW MEXICO OIL CONSERVATION COMMISSION
WELL LOCATION AND ACREAGE DEDICATION PLAT**

Form C-102
Supersedes C-128
Effective 1-1-65

All distances must be from the outer boundaries of the Section.

Operator Atlantic Richfield Company			Lease		Well No. 291
Unit Letter A	Section 23	Township 31	Range 17	County San Juan	
Actual Footage Location of Well: <div style="display: flex; justify-content: space-between;"> 50 feet from the North line and 50 feet from the East line </div>					
Ground Level Elev. 5873	Producing Formation Gallup	Pool Horseshoe Gallup	Dedicated Acreage: NA - Unitized Acres		

Re: Order No. R-2210

1. Outline the acreage dedicated to the subject well by colored pencil or hatchure marks on the plat below.
2. If more than one lease is dedicated to the well, outline each and identify the ownership thereof (both as to working interest and royalty).
3. If more than one lease of different ownership is dedicated to the well, have the interests of all owners been consolidated by communitization, unitization, force-pooling, etc?

☒ Yes ☐ No If answer is "yes," type of consolidation Unitization

If answer is "no," list the owners and tract descriptions which have actually been consolidated. (Use reverse side of this form if necessary.) _____

No allowable will be assigned to the well until all interests have been consolidated (by communitization, unitization, forced-pooling, or otherwise) or until a non-standard unit, eliminating such interests, has been approved by the Commission.

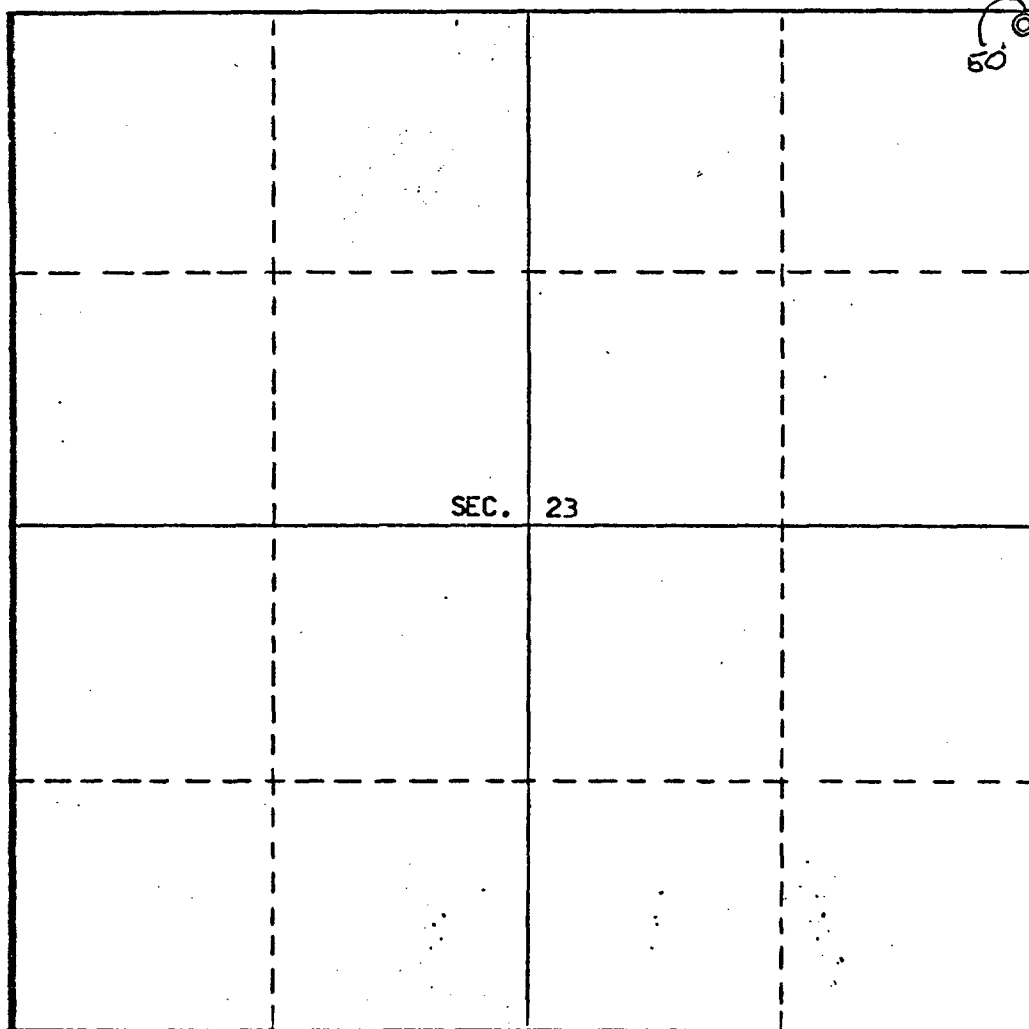

CERTIFICATION

I hereby certify that the information contained herein is true and complete to the best of my knowledge and belief.

Name W. A. Walther Jr.
 Position W. A. Walther Jr.
Operations Manager
 Company ATLANTIC RICHFIELD COMPANY
 Date _____

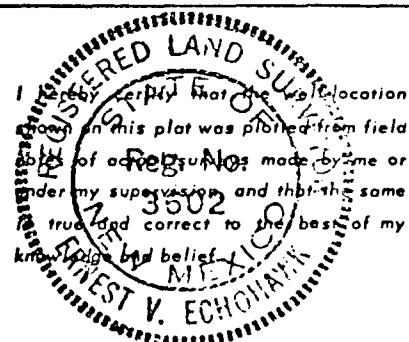

Date Surveyed
May 21, 1976
 Registered Professional Engineer and/or Land Surveyor
E. V. Echohawk
 Certificate No. **3602**
E. V. Echohawk LS

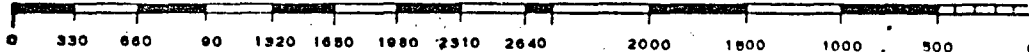

Elevation 5873' - GL, Ungraded

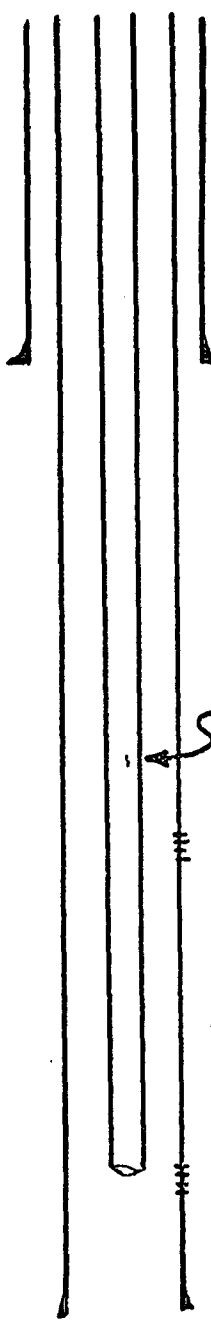

8-5/8"OD Casing set at 120' and cemented to surface

2-3/8"OD EUE tubing

Upper Gallup - Perforated as indicated from logs.

Lower Gallup - Perforated as indicated from logs.

5-1/2"OD casing set at total depth with sufficient cement to protect all zones.

1650' Estimated total depth.

HORSESHOE GALLUP UNIT, Well No. 291

Unit "A" - 50' f/North & 50' f/East lines

Section 23-31N-17W

San Juan County, New Mexico

UNITED STATES
DEPARTMENT OF THE INTERIOR
GEOLOGICAL SURVEY

APPLICATION FOR PERMIT TO DRILL, DEEPEN, OR PLUG BACK

1. TYPE OF WORK

DRILL ☒DEEPEN ☐PLUG BACK ☒

2. TYPE OF WELL

OIL
WELL ☒GAS
WELL ☐OTHER ☐SINGLE
ZONE ☒MULTIPLE
ZONE ☐

3. NAME OF OPERATOR

Atlantic Richfield Company

4. ADDRESS OF OPERATOR

501 Lincoln Tower Bldg., 1860 Lincoln St., Denver, Colo. 80203

5. LOCATION OF WELL (Report location clearly and in accordance with any State requirements.)*

At surface

Unit "J" - 2474' f/South & 2463' f/East lines Sec. 24

At proposed prod. zone

Approx. same

6. DISTANCE IN MILES AND DIRECTION FROM NEAREST TOWN OR POST OFFICE*

See attached maps

7. DISTANCE FROM PROPOSED* 166' f/Tr. 15 line

LOCATION TO NEAREST
PROPERTY OR LEASE LINE, FT.
(Also to nearest drlg. unit line, if any)

8. DISTANCE FROM PROPOSED LOCATION* 822' f/#99 in

TO NEAREST WELL, DRILLING, COMPLETED,
OR APPLIED FOR, ON THIS LEASE, FT. N/4 SE Sec. 24

9. NO. OF ACRES IN LEASE

Tr. 15 - 880.00 Ac.
Unit - 13,527.80 Ac.

10. PROPOSED DEPTH

1530'

11. NO. OF ACRES ASSIGNED
TO THIS WELL

N/A Unit

12. ROTARY OR CABLE TOOLS

Rotary

13. ELEVATIONS (Show whether DF, RT, GR, etc.)

5707' GL, Ungr.

14. APPROX. DATE WORK WILL START*

When appls rec'd.

Rd & loc est 7/1/76.

Drlg after #291

15. PROPOSED CASING AND CEMENTING PROGRAM

SIZE OF HOLE	SIZE OF CASING	WEIGHT PER FOOT	SETTING DEPTH	QUANTITY OF CEMENT
12-1/4"	8-5/8"	21#	120'	125 sx (Cmt to surface)
7-7/8"	5-1/2"	11#	T.D.	225 sx

Propose to drill well to depth sufficient to test the Gallup Formation. Est tops: Upper Gallup 1305', Lower Gallup 1415'. Will set 8-5/8" OD surface casing at approx. 120' and cement to surface; drill 7-7/8" hole to T.D.; log; if productive, set 5-1/2" OD casing w/ sufficient cement to protect all zones. Productive zone(s) will be perforated, treated if necessary, and well completed.

Re: New Mexico Oil Conservation Commission Order No. R-2210 and R-2210-A

Attachments: Certified Location Plat
Pertinent Drilling Information
Development Plan for Surface Use w/ att.
Archaeological Clearance Report

IN ABOVE SPACE DESCRIBE PROPOSED PROGRAM: If proposal is to deepen or plug back, give data on present productive zone and proposed new productive zone. If proposal is to drill or deepen directionally, give pertinent data on subsurface locations and measured and true vertical depths. Give blowout preventer program, if any.

24.

SIGNED

W. A. Walther, Jr.

TITLE Operations Manager

DATE 6/4/76

(This space for Federal or State office use)

PERMIT NO.

APPROVAL DATE

APPROVED BY

TITLE

DATE

CONDITIONS OF APPROVAL, IF ANY:

**NEW MEXICO OIL CONSERVATION COMMISSION
WELL LOCATION AND ACREAGE DEDICATION PLAT**

Form C-102
Supersedes C-128
Effective 1-1-65

All distances must be from the outer boundaries of the Section.

Operator Atlantic Richfield Company			Lease		Well No. 292
Unit Letter J	Section 24	Township 31	Range 17	County San Juan	
Actual Footage Location of Well: 2474 feet from the South line and 2463 feet from the East line					
Ground Level Elev. 5707	Producing Formation Gallup		Pool Horseshoe Gallup		Dedicated Acreage: NA - Unitized Acres

Re: Order No. R-2210-

1. Outline the acreage dedicated to the subject well by colored pencil or hachure marks on the plat below.
2. If more than one lease is dedicated to the well, outline each and identify the ownership thereof (both as to working interest and royalty).
3. If more than one lease of different ownership is dedicated to the well, have the interests of all owners been consolidated by communitization, unitization, force-pooling, etc?

☒ Yes ☐ No If answer is "yes," type of consolidation Unitization

If answer is "no," list the owners and tract descriptions which have actually been consolidated. (Use reverse side of this form if necessary.) _____

No allowable will be assigned to the well until all interests have been consolidated (by communitization, unitization, forced-pooling, or otherwise) or until a non-standard unit, eliminating such interests, has been approved by the Commission.

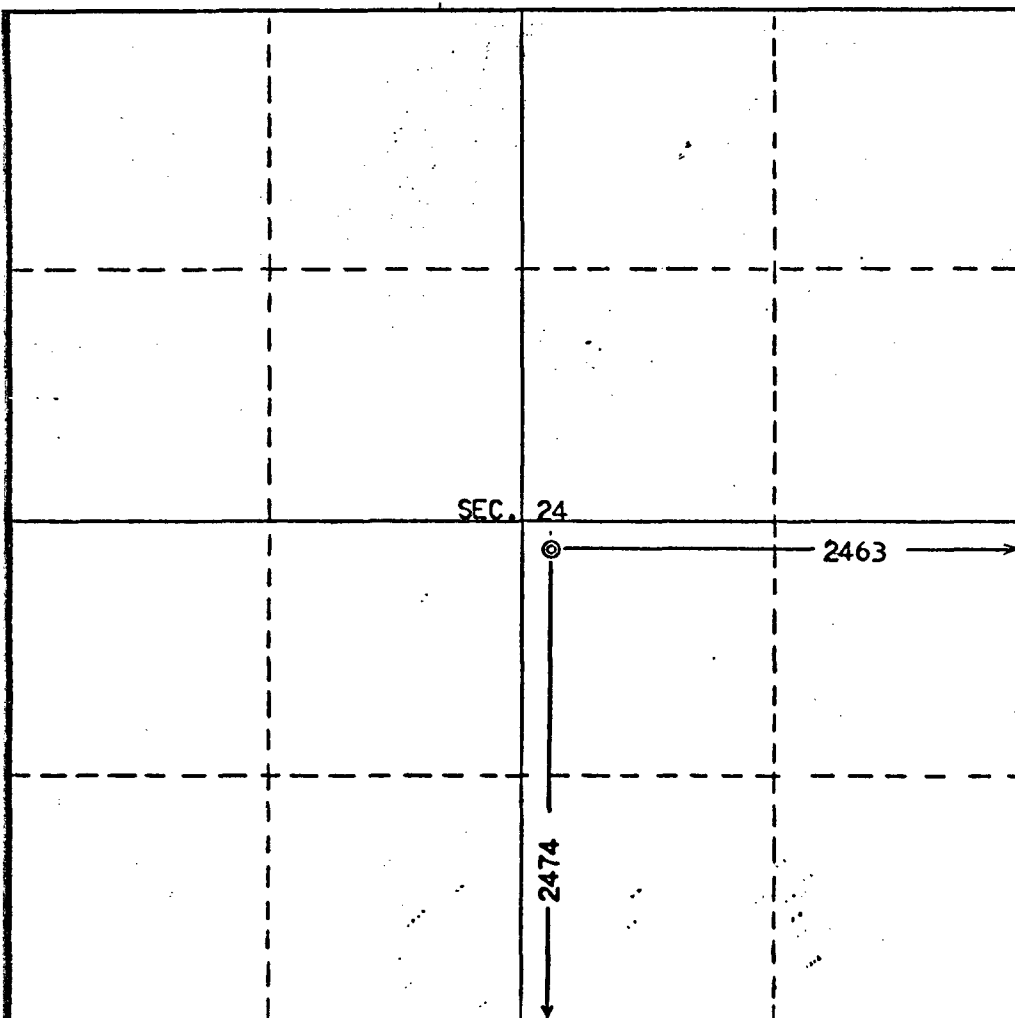

CERTIFICATION

I hereby certify that the information contained herein is true and complete to the best of my knowledge and belief.

Name W. A. Walther, Jr.
Position W. A. Walther, Jr.
Operations Manager
Company ATLANTIC RICHFIELD COMPANY
Date _____

I hereby certify that the well location shown on this plat was plotted from field notes of surveys made by me or under my supervision, and that the same are true and correct to the best of my knowledge and belief.

E. V. ECHOHAWK

Date Surveyed
May 21, 1976
Registered Professional Engineer and/or Land Surveyor

E. V. Echohawk
Certificate No. **3602**
E.V. Echohawk LS

Elevation 5707' = GL, Ungraded



8-5/8" OD Casing set at 120' and cemented to surface

2-3/8" OD EUE tubing

Upper Gallup - Perforated as indicated from logs.

Lower Gallup - Perforated as indicated from logs.

5-1/2" OD casing set at total depth with sufficient cement to protect all zones.

1530' Estimated total depth.

HORSESHOE GALLUP UNIT, Well No. 292
Unit "J" - 2474' f/South & 2463' f/East lines
Section 24-31N-17W
San Juan County, New Mexico

UNITED STATES
DEPARTMENT OF THE INTERIOR
GEOLOGICAL SURVEY

APPLICATION FOR PERMIT TO DRILL, DEEPEN, OR PLUG BACK

1a. TYPE OF WORK

DRILL ☒DEEPEN ☐PLUG BACK ☐

b. TYPE OF WELL

OIL
WELL ☒GAS
WELL ☐OTHER ☐SINGLE
ZONE ☒MULTIPLE
ZONE ☐

2. NAME OF OPERATOR

Atlantic Richfield Company

3. ADDRESS OF OPERATOR

501 Lincoln Tower Bldg., 1860 Lincoln St., Denver, Colo. 80203

4. LOCATION OF WELL (Report location clearly and in accordance with any State requirements.)*

At surface

Unit "C" - 1260' f/North & 1470' f/West lines Sec. 30

At proposed prod. zone

Approx. same

14. DISTANCE IN MILES AND DIRECTION FROM NEAREST TOWN OR POST OFFICE*

See attached maps

15. DISTANCE FROM PROPOSED*
LOCATION TO NEAREST
PROPERTY OR LEASE LINE, FT.
(Also to nearest drig. unit line, if any)

1260' f/Tr.12 line

18. DISTANCE FROM PROPOSED LOCATION*
TO NEAREST WELL, DRILLING, COMPLETED,
OR APPLIED FOR, ON THIS LEASE, FT. in NE NW Sec.30

814' f/#48

16. NO. OF ACRES IN LEASE
Tr.12 - 2644.14 Ac
Unit - 13,527.80 Ac

19. PROPOSED DEPTH

1510'

17. NO. OF ACRES ASSIGNED
TO THIS WELL

N/A - Unit

20. ROTARY OR CABLE TOOLS

Rotary tools

21. ELEVATIONS (Show whether DF, RT, GR, etc.)

5625' GL, Ungr.

22. APPROX. DATE WORK WILL START*

When appl rec'd.

ad & loc est 7/1/76.

Drilg after #292

23.

PROPOSED CASING AND CEMENTING PROGRAM

SIZE OF HOLE	SIZE OF CASING	WEIGHT PER FOOT	SETTING DEPTH	QUANTITY OF CEMENT
12-1/4"	8-5/8"	24#	120'	120 sx (Cmt to surface)
7-7/8"	5-1/2"	14#	T.D.	225 sx

Propose to drill well to depth sufficient to test the Gallup Formation. Est. tops: Upper Gallup 1300', Lower Gallup 1400'. Will set 8-5/8" surface casing at approx 120' and cement to surface; drill 7-7/8" hole to T.D.; log; if productive, set 5-1/2" CD casing with sufficient cement to protect all zones. Productive zone(s) will be perforated, treated if necessary, and well completed.

Re: New Mexico Oil Conservation Commission Order No. R-2210 & R-2210-A

Attachments: Certified Location Plat
Pertinent Drilling Information
Development Plan for Surface Use w/ att.
Archaeological Clearance Report

IN ABOVE SPACE DESCRIBE PROPOSED PROGRAM: If proposal is to deepen or plug back, give data on present productive zone and proposed new productive zone. If proposal is to drill or deepen directionally, give pertinent data on subsurface locations and measured and true vertical depths. Give blowout preventer program, if any.

24.

SIGNED

W A Walther Jr.
W. A. Walther, Jr.
(This space for Federal or State office use)

TITLE

Operations Manager

DATE

6/4/76

PERMIT NO.

APPROVAL DATE

APPROVED BY

TITLE

DATE

CONDITIONS OF APPROVAL, IF ANY:

*See Instructions On Reverse Side

**NEW MEXICO OIL CONSERVATION COMMISSION
WELL LOCATION AND ACREAGE DEDICATION PLAT**

Form C-102
Supersedes C-128
Effective 1-1-65

All distances must be from the outer boundaries of the Section.

Operator Atlantic Richfield Company			Lease		Well No. 293
Unit Letter C	Section 30	Township 31	Range 16	County San Juan	
Actual Footage Location of Well: <div style="display: flex; justify-content: space-between;"> 1260 feet from the North line and 1470 feet from the West line </div>					
Ground Level Elev. 5625	Producing Formation Gallup	Pool Horseshoe Gallup		Dedicated Acreage NA - Unitized	

1. Outline the acreage dedicated to the subject well by colored pencil or hachure marks on the plat below. Re: Order No. R-2210-
2. If more than one lease is dedicated to the well, outline each and identify the ownership thereof (both as to working interest and royalty).
3. If more than one lease of different ownership is dedicated to the well, have the interests of all owners been consolidated by communitization, unitization, force-pooling, etc?

☒ Yes ☐ No If answer is "yes," type of consolidation Unitization

If answer is "no," list the owners and tract descriptions which have actually been consolidated. (Use reverse side of this form if necessary.) _____

No allowable will be assigned to the well until all interests have been consolidated (by communitization, unitization, forced-pooling, or otherwise) or until a non-standard unit, eliminating such interests, has been approved by the Commission.

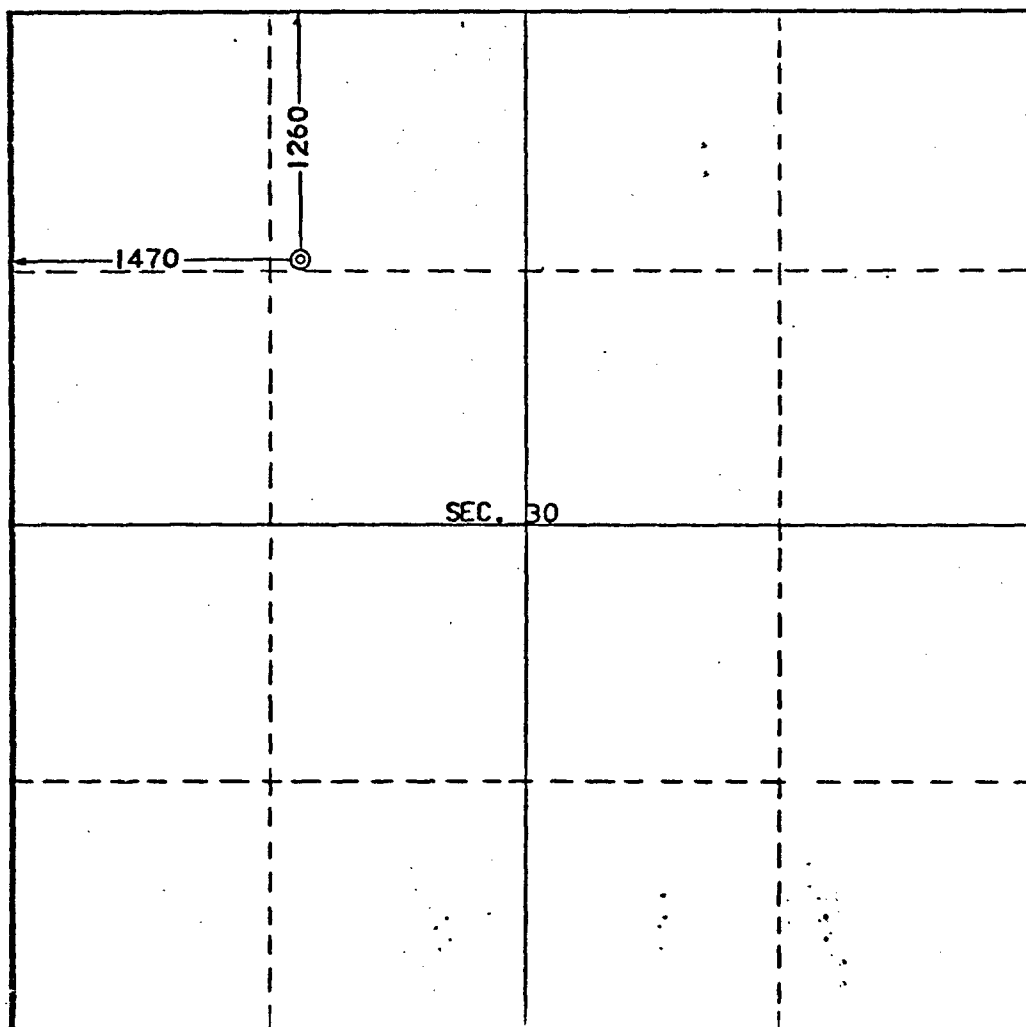

CERTIFICATION

I hereby certify that the information contained herein is true and complete to the best of my knowledge and belief.

Name
W. A. Walther, Jr.
Position **W. A. Walther, Jr.**
Operations Manager
Company
ATLANTIC RICHFIELD COMPANY
Date

I hereby certify that the well location shown on this plat was plotted from field notes of ~~actual~~ surveys made by me or under my supervision, and that the same is true and correct to the best of my knowledge and belief.
E.V. ECHHAWK

Date Surveyed
May 20, 1976
Registered Professional Engineer and/or Land Surveyor
E.V. Echhawk
Certificate No. **3602**
E.V. Echhawk LS



Elevation 5625' GL - Ungraded

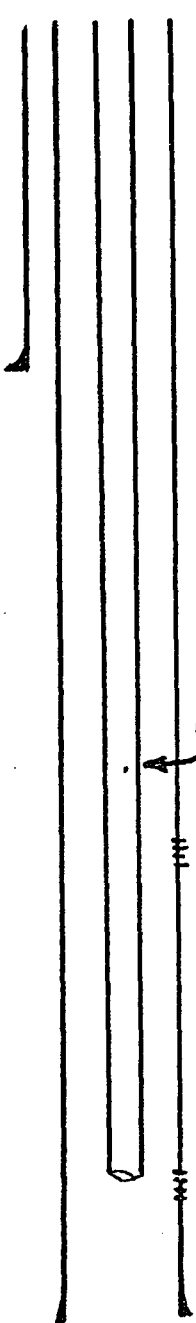

8-5/8" OD Casing set at 120' and cemented to surface

2-3/8" OD EUE tubing

Upper Gallup - Perforated as indicated from logs.

Lower Gallup - Perforated as indicated from logs.

5-1/2" OD casing set at total depth with sufficient cement to protect all zones.

1510' Estimated total depth.

HORSESHOE GALLUP UNIT, Well No. 293
Unit "C" - 1260' f/North & 1470' f/West lines
Section 30-31N-16W
San Juan County, New Mexico

UNITED STATES
DEPARTMENT OF THE INTERIOR
GEOLOGICAL SURVEY

APPLICATION FOR PERMIT TO DRILL, DEEPEN, OR PLUG BACK

1a. TYPE OF WORK

DRILL ☒DEEPEN ☐PLUG BACK ☐

b. TYPE OF WELL

OIL
WELL ☒GAS
WELL ☐

OTHER

SINGLE
ZONE ☒MULTIPLE
ZONE ☐

2. NAME OF OPERATOR

Atlantic Richfield Company

3. ADDRESS OF OPERATOR

501 Lincoln Tower Bldg., 1860 Lincoln St., Denver, Colo. 80203

4. LOCATION OF WELL (Report location clearly and in accordance with any State requirements.)

At surface

Unit "J" - 1378' f/South & 1325' f/East lines Sec. 30

At proposed prod. zone

Approx same

14. DISTANCE IN MILES AND DIRECTION FROM NEAREST TOWN OR POST OFFICE*

See attached maps

15. DISTANCE FROM PROPOSED* 3902' f/Tr.12 line
LOCATION TO NEAREST
PROPERTY OR LEASE LINE, FT.
(Also to nearest drlg. unit line, if any)16. NO. OF ACRES IN LEASE
Tr.12 - 2644.14 Ac
Unit - 13,527.80 Ac17. NO. OF ACRES ASSIGNED
TO THIS WELL
N/A - Unit18. DISTANCE FROM PROPOSED LOCATION* 890' f/#6 in
TO NEAREST WELL, DRILLING, COMPLETED,
OR APPLIED FOR, ON THIS LEASE, FT. NW SE Sec.3019. PROPOSED DEPTH
1390'20. ROTARY OR CABLE TOOLS
Rotary

21. ELEVATIONS (Show whether DF, RT, GR, etc.)

5477' GL, Ungr.

22. APPROX. DATE WORK WILL START*

When appl rec'd.
Est 7/1/76 - rd & loc.
Drlg after #293

23.

PROPOSED CASING AND CEMENTING PROGRAM

SIZE OF HOLE	SIZE OF CASING	WEIGHT PER FOOT	SETTING DEPTH	QUANTITY OF CEMENT
12-1/4"	8-5/8"	24#	120	120 sx (Cmt to surface)
7-7/8"	5-1/2"	14#	T.D.	225 sx

Propose to drill well to depth sufficient to test the Gallup Formation. Est. tops: Upper Gallup 1180', Lower Gallup 1290'. Will set 8-5/8"OD surface casing at approx 120' and cement to surface; drill 7-7/8" hole to T.D.; log; if productive, set 5-1/2"OD casing w/ sufficient cement to protect all zones. Productive zone(s) will be perforated, treated if necessary and well completed.

Re: New Mexico Oil Conservation Commission Order No. R-2210 & R-2210-A

Attachments: Certified Location Plat
Pertinent Drilling Information
Development Plan for Surface Use w/ att.
Archaeological Clearance Report

IN ABOVE SPACE DESCRIBE PROPOSED PROGRAM: If proposal is to deepen or plug back, give data on present productive zone and proposed new productive zone. If proposal is to drill or deepen directionally, give pertinent data on subsurface locations and measured and true vertical depths. Give blowout preventer program, if any.

24.

SIGNED

W. A. Walther, Jr.

TITLE

Operations Manager

DATE

6/17/76

(This space for Federal or State office use)

PERMIT NO.

APPROVAL DATE

APPROVED BY

TITLE

DATE

CONDITIONS OF APPROVAL, IF ANY:

*See Instructions On Reverse Side

**NEW MEXICO OIL CONSERVATION COMMISSION
WELL LOCATION AND ACREAGE DEDICATION PLAT**

Form C-102
Supersedes C-128
Effective 1-1-65

All distances must be from the outer boundaries of the Section.

Operator Atlantic Richfield Company			Lease			Well No. 294		
Unit Location J	Section 30	Township 31	Range 16	County San Juan				
Actual Footage Location of Well:								
1378 feet from the South line and			1325 feet from the East line					
Ground Level Elev. 5477		Producing Formation Gallup		Pool Horseshoe Gallup			Dedicated Acreage: NA - Unitized Acres	

Reg. Order No. R-2210-

1. Outline the acreage dedicated to the subject well by colored pencil or hatchure marks on the plat below.
2. If more than one lease is dedicated to the well, outline each and identify the ownership thereof (both as to working interest and royalty).
3. If more than one lease of different ownership is dedicated to the well, have the interests of all owners been consolidated by communitization, unitization, force-pooling, etc?

☒ Yes ☐ No If answer is "yes," type of consolidation Unitization

If answer is "no," list the owners and tract descriptions which have actually been consolidated. (Use reverse side of this form if necessary.) _____

No allowable will be assigned to the well until all interests have been consolidated (by communitization, unitization, forced-pooling, or otherwise) or until a non-standard unit, eliminating such interests, has been approved by the Commission.

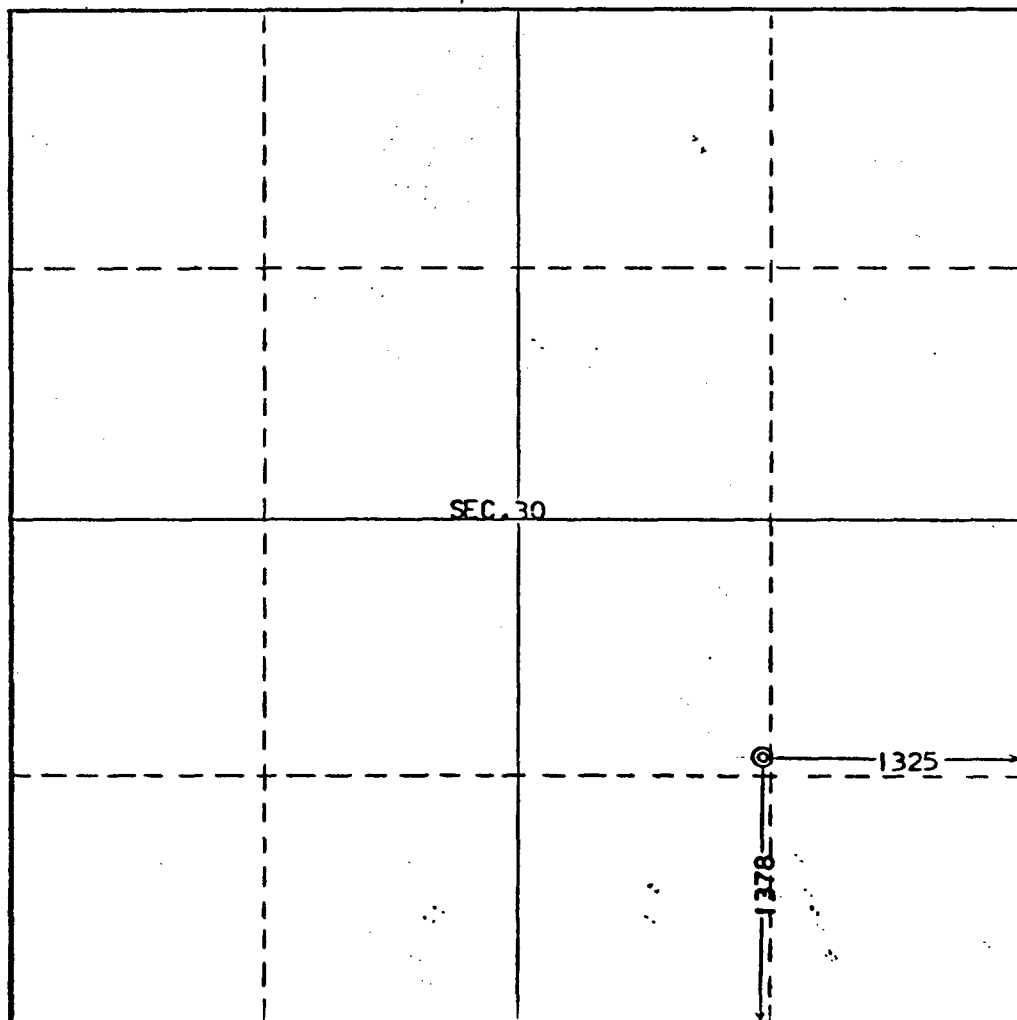

CERTIFICATION

I hereby certify that the information contained herein is true and complete to the best of my knowledge and belief.

Name W. A. Walther, Jr.
Position W. A. Walther, Jr.
Operations Manager
Company ATLANTIC RICHFIELD COMPANY
Date _____

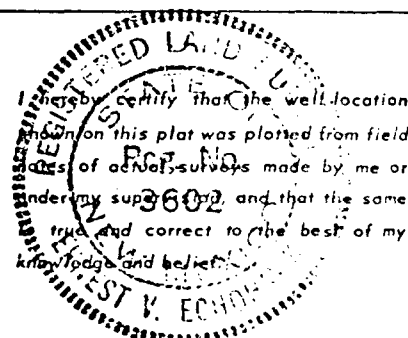

Date Surveyed **May 20, 1976**
Registered Professional Engineer
and/or Land Surveyor
E.V. Echobawk
Certificate No. **3602**
E.V. Echobawk LS

0 330 660 990 1320 1650 1980 2310 2640 2000 1500 1000 500 0

Elevation 5477' GL - Ungraded

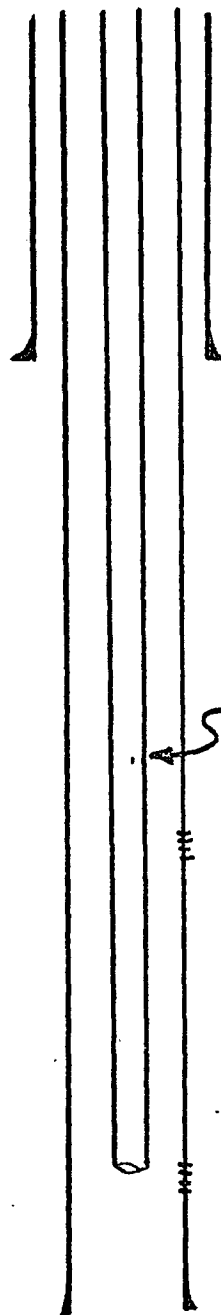

8-5/8" OD Casing set at 120' and cemented to surface

2-3/8" OD EUE tubing

Upper Gallup - Perforated as indicated from logs.

Lower Gallup - Perforated as indicated from logs.

5-1/2" OD casing set at total depth with sufficient cement to protect all zones.

1390' Estimated total depth.

HORSESHOE GALLUP UNIT, Well No. 294
Unit "J" - 1378' f/South & 1325' f/East lines
Section 30-31N-16W
San Juan County, New Mexico

UNITED STATES
DEPARTMENT OF THE INTERIOR
GEOLOGICAL SURVEY

APPLICATION FOR PERMIT TO DRILL, DEEPEN, OR PLUG BACK

1. TYPE OF WORK

DRILL ☒DEEPEN ☐PLUG BACK ☐

2. TYPE OF WELL

OIL
WELL ☒GAS
WELL ☐OTHER ☐SINGLE
ZONE ☒MULTIPLE
ZONE ☐

3. NAME OF OPERATOR

Atlantic Richfield Company

4. ADDRESS OF OPERATOR

501 Lincoln Tower Bldg., 1860 Lincoln St., Denver, Colo. 80203

5. LOCATION OF WELL (Report location clearly and in accordance with any State requirements.)*

At surface

Unit "A" - 50' f/North & 50' f/East lines Sec. 31

At proposed prod. zone

Approx same

6. DISTANCE IN MILES AND DIRECTION FROM NEAREST TOWN OR POST OFFICE*

See attached maps

7. DISTANCE FROM PROPOSED* LOCATION TO NEAREST PROPERTY OR LEASE LINE, FT.

5230' f/Tr. 12 line
(Also to nearest drlg. unit line, if any)

8. DISTANCE FROM PROPOSED LOCATION* TO NEAREST WELL, DRILLING, COMPLETED, OR APPLIED FOR, ON THIS LEASE, FT.

862' f/#52 in
NE NE Sec. 31

9. NO. OF ACRES IN LEASE

Tr. 12 - 2644.14 Ac
Unit - 13,527.80 Ac

10. PROPOSED DEPTH

1370'

11. NO. OF ACRES ASSIGNED TO THIS WELL

N/A - Unit

12. ROTARY OR CABLE TOOLS

Rotary

13. ELEVATIONS (Show whether DF, RT, GR, etc.)

5430' GL, Ungr.

14. APPROX. DATE WORK WILL START*

When appl rec'd.

Est 7/1/76 - Ad & loc.

Drlg after #294

15. PROPOSED CASING AND CEMENTING PROGRAM

SIZE OF HOLE	SIZE OF CASING	WEIGHT PER FOOT	SETTING DEPTH	QUANTITY OF CEMENT
12-1/4"	8-5/8"	24#	120'	120 Sx (Cmt to surface)
7-7/8"	5-1/2"	11#	T.D.	225 sx

Propose to drill well to depth sufficient to test the Gallup Formation. Est. tops: Upper Gallup 1155', Lower Gallup 1265'. Will set 8-5/8"OD surface casing at approx 120' and cement to surface; drill 7-7/8" hole to TD; log; if productive, set 5-1/2"OD casing w/ sufficient cement to protect all zones. Productive zone(s) will be perforated, treated if necessary, and well completed.

Re: New Mexico Oil Conservation Commission Order No. R-2210 & R-2210-A

Attachments: Certified Location Plat
Pertinent Drilling Information
Development Plan for Surface Use
Archaeological Clearance Report

IN ABOVE SPACE DESCRIBE PROPOSED PROGRAM: If proposal is to deepen or plug back, give data on present productive zone and proposed new productive zone. If proposal is to drill or deepen directionally, give pertinent data on subsurface locations and measured and true vertical depths. Give blowout prevention program, if any.

24.

SIGNED

W. A. Walther, Jr.
W. A. Walther, Jr.

TITLE

Operations Manager

DATE

6/1/76

(This space for Federal or State office use)

PERMIT NO.

APPROVAL DATE

APPROVED BY

TITLE

DATE

CONDITIONS OF APPROVAL, IF ANY:

*See Instructions On Reverse Side

**NEW MEXICO OIL CONSERVATION COMMISSION
WELL LOCATION AND ACREAGE DEDICATION PLAT**

Form C-102
Supersedes C-128
Effective 1-1-65

All distances must be from the outer boundaries of the Section.

Operator Atlantic Richfield Company			Lease		Well No. 295
Unit Letter A	Section 31	Township 31	Range 16	County San Juan	

Actual Footage Location of Well: 50 feet from the North line and 50 feet from the East line					
Ground Level Elev. 5430	Producing Formation Gallup		Pool Horseshoe Gallup	Dedicated Acreage NA - Unitized	

1. Outline the acreage dedicated to the subject well by colored pencil or hachure marks on the plat below.
2. If more than one lease is dedicated to the well, outline each and identify the ownership thereof (both as to working interest and royalty).
3. If more than one lease of different ownership is dedicated to the well, have the interests of all owners been consolidated by communitization, unitization, force-pooling, etc?

☒ Yes ☐ No If answer is "yes," type of consolidation Unitization

If answer is "no," list the owners and tract descriptions which have actually been consolidated. (Use reverse side of this form if necessary.) _____

No allowable will be assigned to the well until all interests have been consolidated (by communitization, unitization, forced-pooling, or otherwise) or until a non-standard unit, eliminating such interests, has been approved by the Commission.

CERTIFICATION	
I hereby certify that the information contained herein is true and complete to the best of my knowledge and belief.	
Name	<i>W. A. Walther, Jr.</i>
Position	W. A. Walther, Jr. Operations Manager
Company	ATLANTIC RICHFIELD COMPANY
Date	
Date Surveyed May 20, 1976	
Registered Professional Engineer and/or Land Surveyor <i>E. V. Echohawk</i>	
Certificate No. 3602 E.V. Echohawk LS	



Elevation 5430' GL - Ungraded

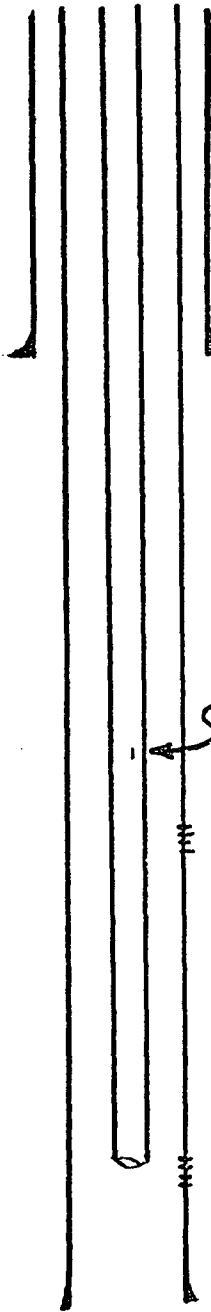

8-5/8" OD Casing set at 120' and cemented to surface

2-3/8" OD EUE tubing

Upper Gallup - Perforated as indicated from logs.

Lower Gallup - Perforated as indicated from logs.

5-1/2" OD casing set at total depth with sufficient cement to protect all zones.

1370' Estimated total depth.

HORSESHOE GALLUP UNIT, Well No. 295
Unit "A" - 50' f/North & 50' f/East lines
Section 31-31N-16W
San Juan County, New Mexico

UNITED STATES
DEPARTMENT OF THE INTERIOR
GEOLOGICAL SURVEY

JUN - 9 1976

APPLICATION FOR PERMIT TO DRILL, DEEPEN, OR PLUG BACK

1a. TYPE OF WORK DRILL <input checked="" type="checkbox"/> DEEPEN <input type="checkbox"/> PLUG BACK <input type="checkbox"/>		1b. TYPE OF WELL OIL WELL <input checked="" type="checkbox"/> GAS WELL <input type="checkbox"/> OTHER <input type="checkbox"/>		SINGLE ZONE <input checked="" type="checkbox"/> MULTIPLE ZONE <input type="checkbox"/>	
2. NAME OF OPERATOR Atlantic Richfield Company					
3. ADDRESS OF OPERATOR 501 Lincoln Tower Bldg., 1860 Lincoln St., Denver, Colo. 80203					
4. LOCATION OF WELL (Report location clearly and in accordance with any State requirements.) At surface Unit I - 1350' f/South & 1250' f/East lines Sec. 32 At proposed prod. zone Approx same					
14. DISTANCE IN MILES AND DIRECTION FROM NEAREST TOWN OR POST OFFICE* See attached maps					
15. DISTANCE FROM PROPOSED* LOCATION TO NEAREST PROPERTY OR LEASE LINE, FT. (Also to nearest drlg. unit line, if any) 1350' f/Tr.12 line		16. NO. OF ACRES IN LEASE Tr.12 - 2644.14 Ac Unit - 13,527.80 Ac		17. NO. OF ACRES ASSIGNED TO THIS WELL N/A - Unit	
18. DISTANCE FROM PROPOSED LOCATION* TO NEAREST WELL, DRILLING, COMPLETED, IN SE & #49 OR APPLIED FOR, ON THIS LEASE, FT. 1011' f/#2 in in SW SE, Sec.32		19. PROPOSED DEPTH 1350'		20. ROTARY OR CABLE TOOLS Rotary	
21. ELEVATIONS (Show whether DF, RT, GR, etc.) 5336' GL, Ungr.				22. APPROX. DATE WORK WILL START* When appl rec'd Est. 7/1/76 - Rd & loc. Drlg after #295	
23. PROPOSED CASING AND CEMENTING PROGRAM					
SIZE OF HOLE	SIZE OF CASING	WEIGHT PER FOOT	SETTING DEPTH	QUANTITY OF CEMENT	
12-1/4"	8-5/8"	24#	120'	120 sx (Cmt to surface)	
7-7/8"	5-1/2"	14#	T.D.	225 sx	

Propose to drill well to depth sufficient to test the Gallup Formation. Est. tops: Upper Gallup 1090', Lower Gallup 1200'. Will set 8-5/8" OD surface casing at approx. 120' and cement to surface; drill 7-7/8" hole to TD; log; if productive, set 5-1/2" OD casing w/ sufficient cement to protect all zones. Productive zone(s) will be perforated, treated if necessary, and well completed.

Re: New Mexico Oil Conservation Commission Order No. R-2210 & R-2210-A

Attachments: Certified Location Plat
Pertinent Drilling Information
Development Plan for Surface Use
Archaeological Clearance Report

IN ABOVE SPACE DESCRIBE PROPOSED PROGRAM: If proposal is to deepen or plug back, give data on present productive zone and proposed new productive zone. If proposal is to drill or deepen directionally, give pertinent data on subsurface locations and measured and true vertical depths. Give blowout preventer program, if any.

24.

SIGNED W. A. Walther, Jr. TITLE Operations Manager DATE 6/4/76

(This space for Federal or State office use)

PERMIT NO. _____ APPROVAL DATE _____

APPROVED BY _____ TITLE _____ DATE _____

CONDITIONS OF APPROVAL, IF ANY:

*See Instructions On Reverse Side

**NEW MEXICO OIL CONSERVATION COMMISSION
WELL LOCATION AND ACREAGE DEDICATION PLAT**

Form C-102
Supersedes C-128
Effective 1-1-65

All distances must be from the outer boundaries of the Section.

Operator Atlantic Richfield Company			Lease		Well No. 296
Unit Letter I	Section 32	Township 31	Range 16	County San Juan	
Actual Footage Location of Well:					
1350 feet from the South line and		1250 feet from the East line			
Ground Level Elev. 5336	Producing Formation Gallup	Pool Horseshoe Gallup	Dedicated Acreage NA - Unitized		

1. Outline the acreage dedicated to the subject well by colored pencil or hachure marks on the plat below. Re: Order No. R-2210-
2. If more than one lease is dedicated to the well, outline each and identify the ownership thereof (both as to working interest and royalty).
3. If more than one lease of different ownership is dedicated to the well, have the interests of all owners been consolidated by communitization, unitization, force-pooling, etc?

☒ Yes ☐ No If answer is "yes," type of consolidation Unitization

If answer is "no," list the owners and tract descriptions which have actually been consolidated. (Use reverse side of this form if necessary.) _____

No allowable will be assigned to the well until all interests have been consolidated (by communitization, unitization, forced-pooling, or otherwise) or until a non-standard unit, eliminating such interests, has been approved by the Commission.

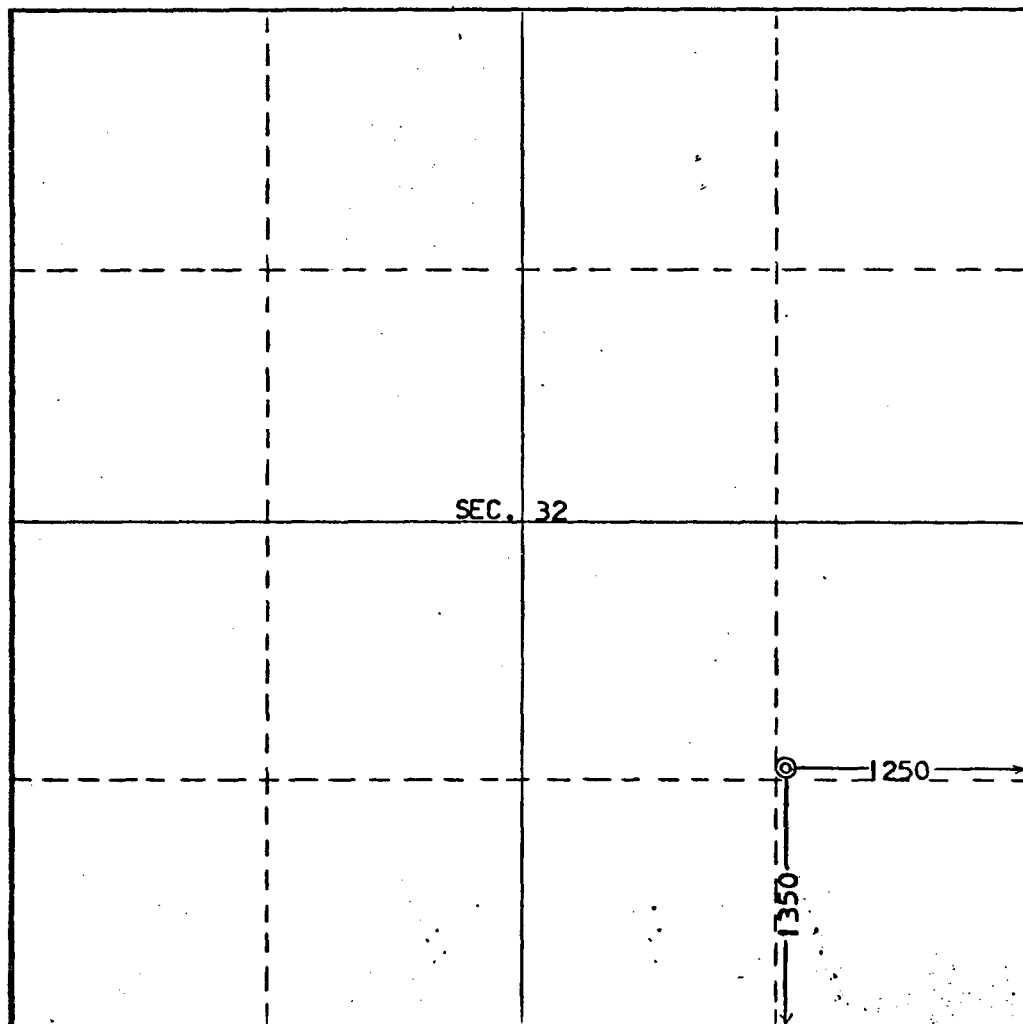

CERTIFICATION

I hereby certify that the information contained herein is true and complete to the best of my knowledge and belief.

Name W. A. Walther, Jr.
 Position W. A. Walther, Jr.
Operations Manager
 Company ATLANTIC RICHFIELD COMPANY
 Date _____

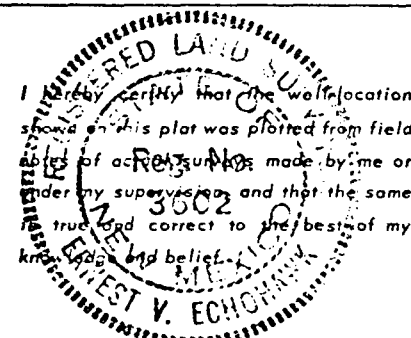

Date Surveyed May 20, 1976
 Registered Professional Engineer and/or Land Surveyor
E. V. Echoshawk
 Certificate No. 3602
E.V. Echoshawk LS

0 330 660 990 1320 1650 1980 2310 2640 2000 1800 1000 500 0

Elevation 5336' GL, Ungraded

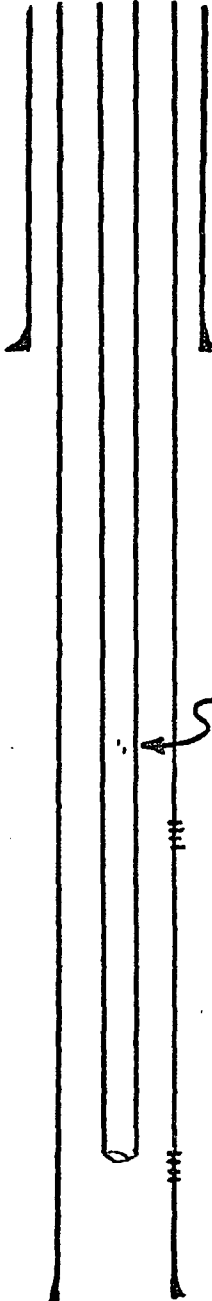

8-5/8" OD Casing set at 120' and cemented to surface

2-3/8" OD EUE tubing

Upper Gallup - Perforated as indicated from logs.

Lower Gallup - Perforated as indicated from logs.

5-1/2" OD casing set at total depth with sufficient
cement to protect all zones.

1350' Estimated total depth.

HORSESHOE GALLUP UNIT, Well No. 296
Unit "I" - 1350' f/South & 1250' f/East lines
Section 32-31N-16W
San Juan County, New Mexico

UNITED STATES
DEPARTMENT OF THE INTERIOR
GEOLOGICAL SURVEY

APPLICATION FOR PERMIT TO DRILL, DEEPEN, OR PLUG BACK

1a. TYPE OF WORK

DRILL ☒DEEPEN ☐PLUG BACK ☐

b. TYPE OF WELL

OIL
WELL ☒GAS
WELL ☐

OTHER

SINGLE
ZONE ☒MULTIPLE
ZONE ☐

2. NAME OF OPERATOR

Atlantic Richfield Company

3. ADDRESS OF OPERATOR

501 Lincoln Tower Bldg., 1860 Lincoln St., Denver, Colo. 80203

4. LOCATION OF WELL (Report location clearly and in accordance with any State requirements.)*

At surface

Unit I - 1550' f/South & 1250' f/East lines Sec. 4

At proposed prod. zone

Approx same

14. DISTANCE IN MILES AND DIRECTION FROM NEAREST TOWN OR POST OFFICE*

See attached maps

13. DISTANCE FROM PROPOSED*
LOCATION TO NEAREST
PROPERTY OR LEASE LINE, FT.
(Also to nearest drlg. unit line, if any)

70' f/Tr.33 line

18. DISTANCE FROM PROPOSED LOCATION*
TO NEAREST WELL, DRILLING, COMPLETED,
OR APPLIED FOR, ON THIS LEASE, FT. in NE SE Sec. 4

731' f/#245

16. NO. OF ACRES IN LEASE
Tr.33 - 515.50 Ac
Unit - 13,527.80 Ac

19. PROPOSED DEPTH

1360'

17. NO. OF ACRES ASSIGNED
TO THIS WELL

N/A - Unit

20. ROTARY OR CABLE TOOLS

Rotary

21. ELEVATIONS (Show whether DF, RT, GR, etc.)

5359' GL, Ungr.

22. APPROX. DATE WORK WILL START*

When appl rec'd
Est 7/1/76 - rd & loc
Drlg after #296

23. PROPOSED CASING AND CEMENTING PROGRAM

SIZE OF HOLE	SIZE OF CASING	WEIGHT PER FOOT	SETTING DEPTH	QUANTITY OF CEMENT
12-1/4"	8-5/8"	24#	120'	120 sx (Cnt to surf)
7-7/8"	5-1/2"	14#	T.D.	225 sx

Propose to drill well to depth sufficient to test the Gallup Formation. Est. tops: Upper Gallup 1145', Lower Gallup 1255'. Will set 8-5/8" OD surface casing at approx 120' and cement to surface; drill 7-7/8" hole to T.D.; log; if productive, set 5-1/2" OD casing w/ sufficient cement to protect all zones. Productive zone(s) will be perforated, treated if necessary, and well completed.

Re: New Mexico Oil Conservation Commission Order No. R-2210 & R-2210-A

Attachments: Certified Location Plat
Pertinent Drilling Information
Development Plan for Surface Use w/ att.
Archaeological Clearance Report.

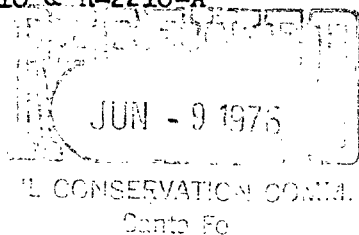

IN ABOVE SPACE DESCRIBE PROPOSED PROGRAM: If proposal is to deepen or plug back, give data on present productive zone and proposed new productive zone. If proposal is to drill or deepen directionally, give pertinent data on subsurface locations and measured and true vertical depths. Give blowout preventer program, if any.

24.

SIGNED

W. A. Walther, Jr.
W. A. Walther, Jr.

TITLE

Operations Manager

DATE

6/1/76

(This space for Federal or State office use)

PERMIT NO.

APPROVAL DATE

APPROVED BY

TITLE

DATE

CONDITIONS OF APPROVAL, IF ANY:

*See Instructions On Reverse Side

**NEW MEXICO OIL CONSERVATION COMMISSION
WELL LOCATION AND ACREAGE DEDICATION PLAT**

Form C-102
Supersedes C-128
Effective 1-1-65

All distances must be from the outer boundaries of the Section.

Operator Atlantic Richfield Company			Lease		Well No. 297
Unit Letter I	Section 4	Township 30 North	Range 16 West	County San Juan	
Actual Footage Location of Well: 1550 feet from the South line and 1250 feet from the East line					
Ground Level Elev. 5359	Producing Formation Gallup	Pool Horseshoe Gallup		Dedicated Acreage: NA - Unitized Acres	

Re: Order No. R-2210

1. Outline the acreage dedicated to the subject well by colored pencil or hatchure marks on the plat below.
2. If more than one lease is dedicated to the well, outline each and identify the ownership thereof (both as to working interest and royalty).
3. If more than one lease of different ownership is dedicated to the well, have the interests of all owners been consolidated by communitization, unitization, force-pooling, etc?

☒ Yes ☐ No If answer is "yes," type of consolidation Unitization

If answer is "no," list the owners and tract descriptions which have actually been consolidated. (Use reverse side of this form if necessary.) _____

No allowable will be assigned to the well until all interests have been consolidated (by communitization, unitization, forced-pooling, or otherwise) or until a non-standard unit, eliminating such interests, has been approved by the Commission.

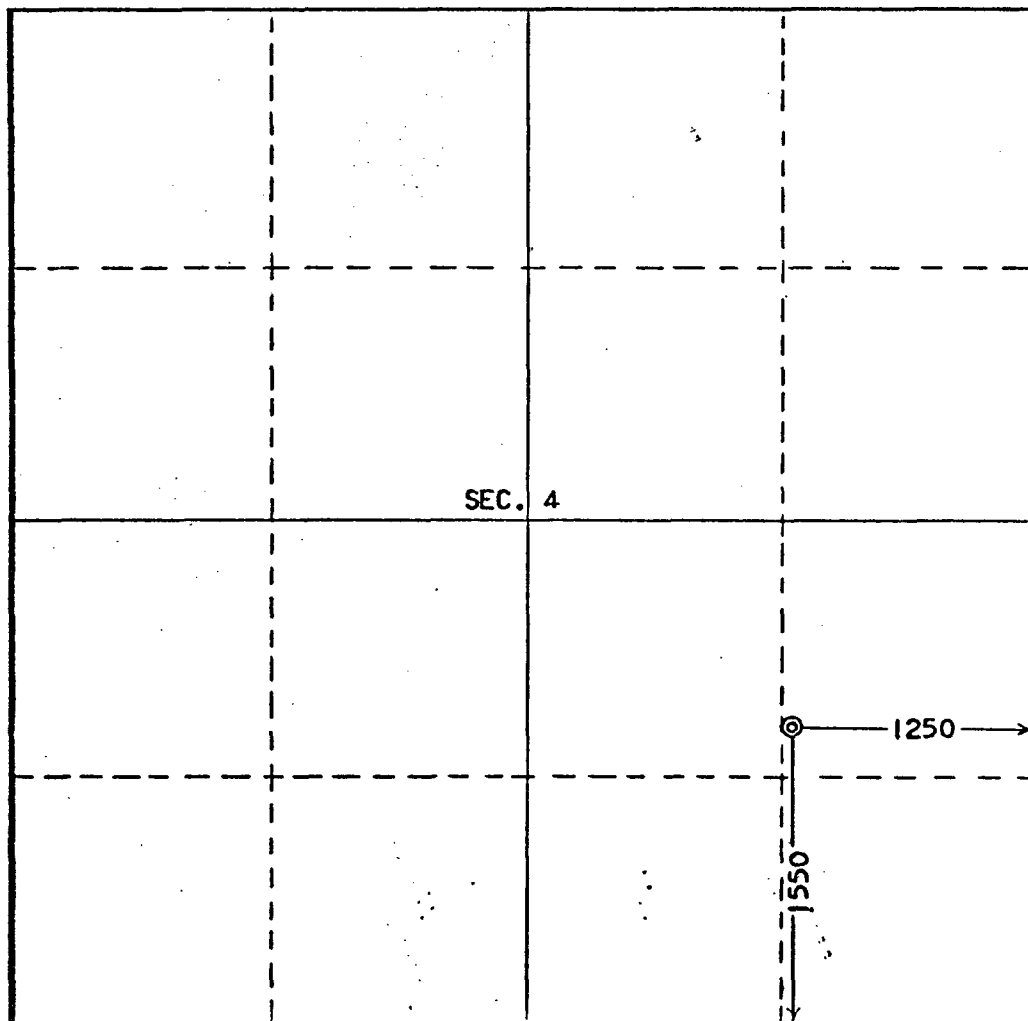

CERTIFICATION

I hereby certify that the information contained herein is true and complete to the best of my knowledge and belief.

Name W. A. Walther, Jr.
 Position Operations Manager
 Company ATLANTIC RICHFIELD COMPANY
 Date _____

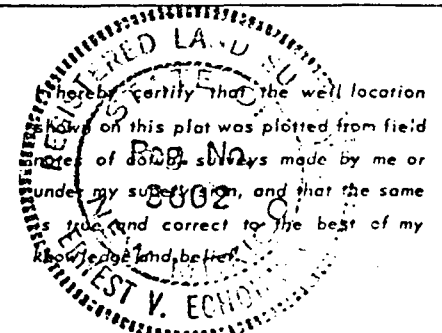

Date Surveyed
May 20, 1976
 Registered Professional Engineer
 and/or Land Surveyor
E.V. Echohawk
 Certificate No. **3602**
E.V. Echohawk LS

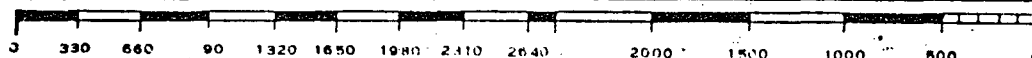

Elevation 5359' GL - Ungraded

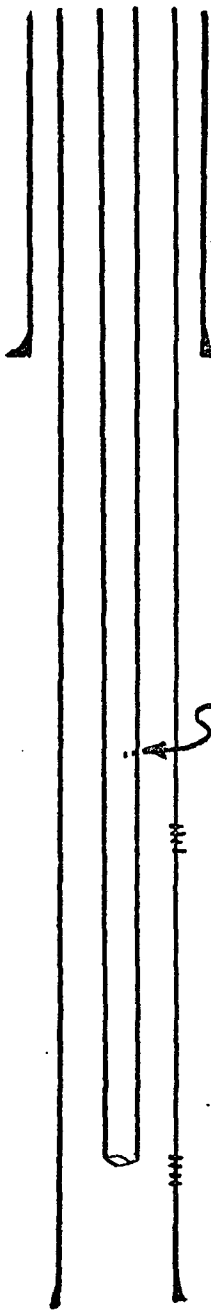

8-5/8" OD Casing set at 120' and cemented to surface

2-3/8" OD EUE tubing

Upper Gallup - Perforated as indicated from logs.

Lower Gallup - Perforated as indicated from logs.

5-1/2" OD casing set at total depth with sufficient
cement to protect all zones.

1360' Estimated total depth.

HORSESHOE GALLUP UNIT, Well No. 297
Unit "I" - 1550' f/South & 1250' f/East lines
Section 4-30N-16W
San Juan County, New Mexico

OIL CONSERVATION COMMISSION

Alto DISTRICTOIL CONSERVATION COMMISSION
BOX 2088
SANTA FE, NEW MEXICO

DATE

June 11, 1976

RE:

Proposed MC

Proposed DHC

Proposed NSL

Proposed SWD

Proposed WFX

Proposed PMX

Jim Kapteina

Gentlemen:

I have examined the application dated June 7, 1976
for the Atlantic Richfield
Operator Lease and Well No. Unit, S-T-R

and my recommendations are as follows:

Horseshoe Gallup Unit # 291, 292, 293, 294
295, 296 & 297.

Approve: All wells are inside locations.
#294 does not identify it to be 10 feet from
the 40-acre line as required by Order-2210-1.

Yours very truly,

MR. Kendrick