

**Manana Gas, Inc.**

1301 SIGMA-CH, N.E.  
ALBUQUERQUE, NEW MEXICO 87106

DEC - 8 1977

CONSERVATION COM.

TEL. (505) 842-9313

EDWARD M. HARTMAN, PRES.

P. O. Box 2487  
Farmington, New Mexico 87401  
December 7, 1977

Mr. Joe D. Ramey, Director  
Oil Conservation Commission  
State of New Mexico  
P.O. Box 2088  
Santa Fe, New Mexico 87501

**APPLICATION FOR ADMINISTRATIVE  
APPROVAL**

Re: Unorthodox Location  
Aztec Pictured Cliffs Gas Field  
1850' FSL & 690' FEL  
Section 7, T 30N, R 11W  
San Juan County, New Mexico

Dear Sir:

Enclosed are triplicate plats showing ownership of all leases and Pictured Cliffs wells offsetting our proration unit and a survey plat of the proposed location.

Approval for this unorthodox location is requested in order to avoid unnecessary damage to fee surface land owned by Mr. & Mrs. Charles Jones of Aztec, New Mexico. Mr. Jones requested the drillsite be located at the edge of his irrigated pasture for his arabian horses, as close as possible to the existing road and his fence line.

Manana Gas, Inc. has notified all offsetting operators of this application.

Very truly yours  
MANANA GAS, INC.

By Ed Hartman  
President

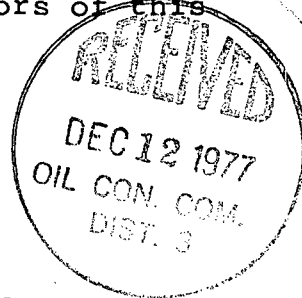

pc: El Paso Natural Gas Company  
Attn: John Ahlm, Farmington  
W. P. Carr - Bradley Keyes

TOWNSHIP 30 North RANGE 11 West COUNTY San Juan STATE N.M.

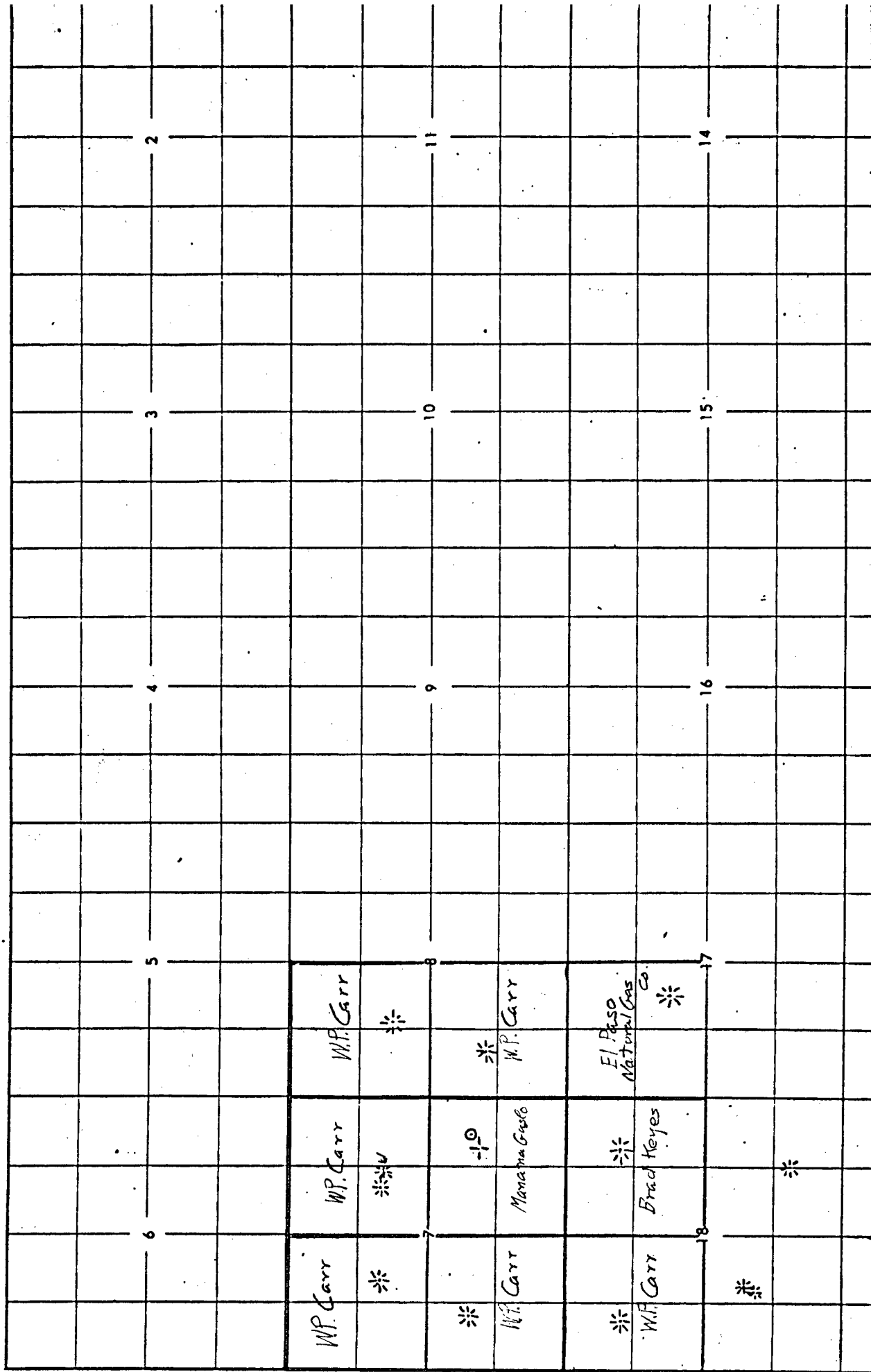

WELL LOCATION AND ACREAGE DEDICATION PLAT

Supersedes C-128  
Effective 1-1-65

All distances must be from the outer boundaries of the Section.

Operator <b>Manana Gas, Inc.</b>		Lease <b>Charlie</b>		Well No. <b>1</b>
Unit Letter <b>1</b>	Section <b>7</b>	Township <b>30 North</b>	Range <b>11 West</b>	County <b>San Juan</b>
Actual Footage Location of Well: <b>1850</b> feet from the <b>South</b> line and <b>690</b> feet from the <b>East</b> line				
Ground Level Elev. <b>5610</b>	Producing Formation <b>Pictured Cliffs</b>	Pool <b>Aztec Pictured Cliffs Gas</b>	Dedicated Acreage: <b>160</b> Acres	

- Outline the acreage dedicated to the subject well by colored pencil or hachure marks on the plat below.
- If more than one lease is dedicated to the well, outline each and identify the ownership thereof (both as to working interest and royalty).
- If more than one lease of different ownership is dedicated to the well, have the interests of all owners been consolidated by communitization, unitization, force-pooling, etc?

☒ Yes ☐ No If answer is "yes," type of consolidation Communitization

If answer is "no," list the owners and tract descriptions which have actually been consolidated. (Use reverse side of this form if necessary.)

No allowable will be assigned to the well until all interests have been consolidated (by communitization, unitization, forced-pooling, or otherwise) or until a non-standard unit, eliminating such interests, has been approved by the Commission.

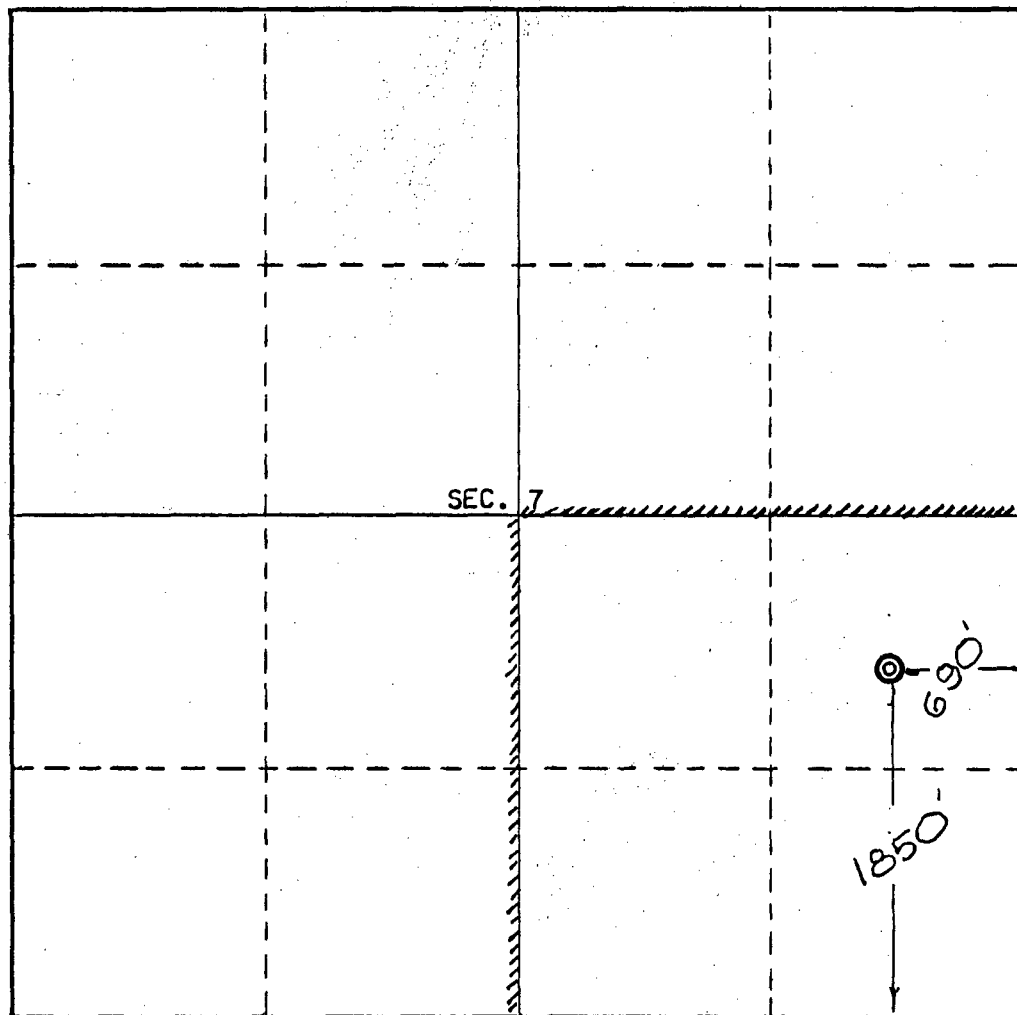

CERTIFICATION

I hereby certify that the information contained herein is true and complete to the best of my knowledge and belief.

*Ed Hartman*

Name

Ed Hartman

Position

President

Company

Manana Gas, Inc.

Date

July 25, 1977

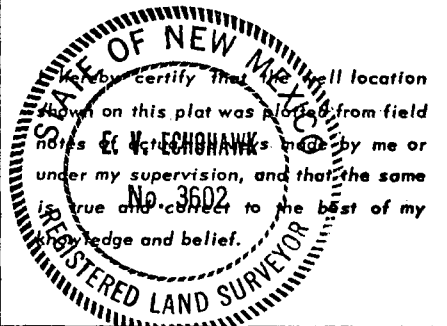

Date Surveyed

June 30, 1977

Registered Professional Engineer and/or Land Surveyor

*E.V. Echohawk*

Certificate No. 3602

E.V. Echohawk LS

CURTIS J. LITTLE

PETROLEUM GEOLOGIST

TELEPHONE (505) ~~266-7906~~ 327-6176

POST OFFICE BOX ~~80068~~ 2487

~~5000 MARBLE AVENUE, N.E.~~

~~ALBUQUERQUE, NEW MEXICO 87108~~

Farmington, ~~87401~~

DEC - 8 1977

December 7, 1977

CONSERVATION COMMISSION  
Santa Fe

Mr. W. P. Carr  
6700 Forest Lane  
Dallas, Texas 75230

El Paso Natural Gas Company  
P. O. Box 900  
Farmington, N. M. 87401

Mr. Bradley Keyes  
103 N. Main  
Aztec, N. M. 87410

Re: Application for Administrative Approval  
Unorthodox Location, Aztec Pictured Cliffs Gas Field  
1850'FSL and 690'FEL, Section 7 T30N R11W  
San Juan County, New Mexico

Gentlemen:

We have requested approval of the subject location in order to satisfy surface requirements by the fee owner, Mr. and Mrs. Charles Jones of Aztec, New Mexico. The location was placed on the edge of an irrigated pasture and near an existing road and fence line.

It would be greatly appreciated, if you have no objections to the location, your advising the New Mexico Oil Conservation Commission, P. O. Box 2088, Santa Fe, New Mexico 87501, of your approval of the request.

Thank you very much.

MANANA GAS, INC.

By

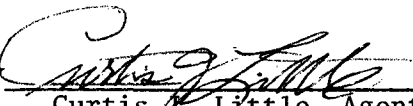
  
Curtis J. Little, Agent

CJL/ss

NEW MEXICO LAND COMMISSION  
WELL LOCATION AND ACREAGE DEDICATION PLAT

Supersedes C-128  
Effective 1-1-65

All distances must be from the outer boundaries of the Section.

Operator <b>Manana Gas, Inc.</b>			Lease <b>Charlie</b>			Well No. <b>1</b>
Unit Letter <b>1</b>	Section <b>7</b>	Township <b>30 North</b>	Range <b>11 West</b>	County <b>San Juan</b>		
Actual Footage Location of Well: <b>1850</b> feet from the <b>South</b> line and <b>690</b> feet from the <b>East</b> line						
Ground Level Elev. <b>5610</b>	Producing Formation <b>Pictured Cliffs</b>		Pool <b>Aztec Pictured Cliffs Gas</b>		Dedicated Acreage: <b>160</b> Acres	

1. Outline the acreage dedicated to the subject well by colored pencil or hachure marks on the plat below.
2. If more than one lease is dedicated to the well, outline each and identify the ownership thereof (both as to working interest and royalty).
3. If more than one lease of different ownership is dedicated to the well, have the interests of all owners been consolidated by communitization, unitization, force-pooling, etc?

☒ Yes ☐ No If answer is "yes," type of consolidation Communitization

If answer is "no," list the owners and tract descriptions which have actually been consolidated. (Use reverse side of this form if necessary.)

No allowable will be assigned to the well until all interests have been consolidated (by communitization, unitization, forced-pooling, or otherwise) or until a non-standard unit, eliminating such interests, has been approved by the Commission.

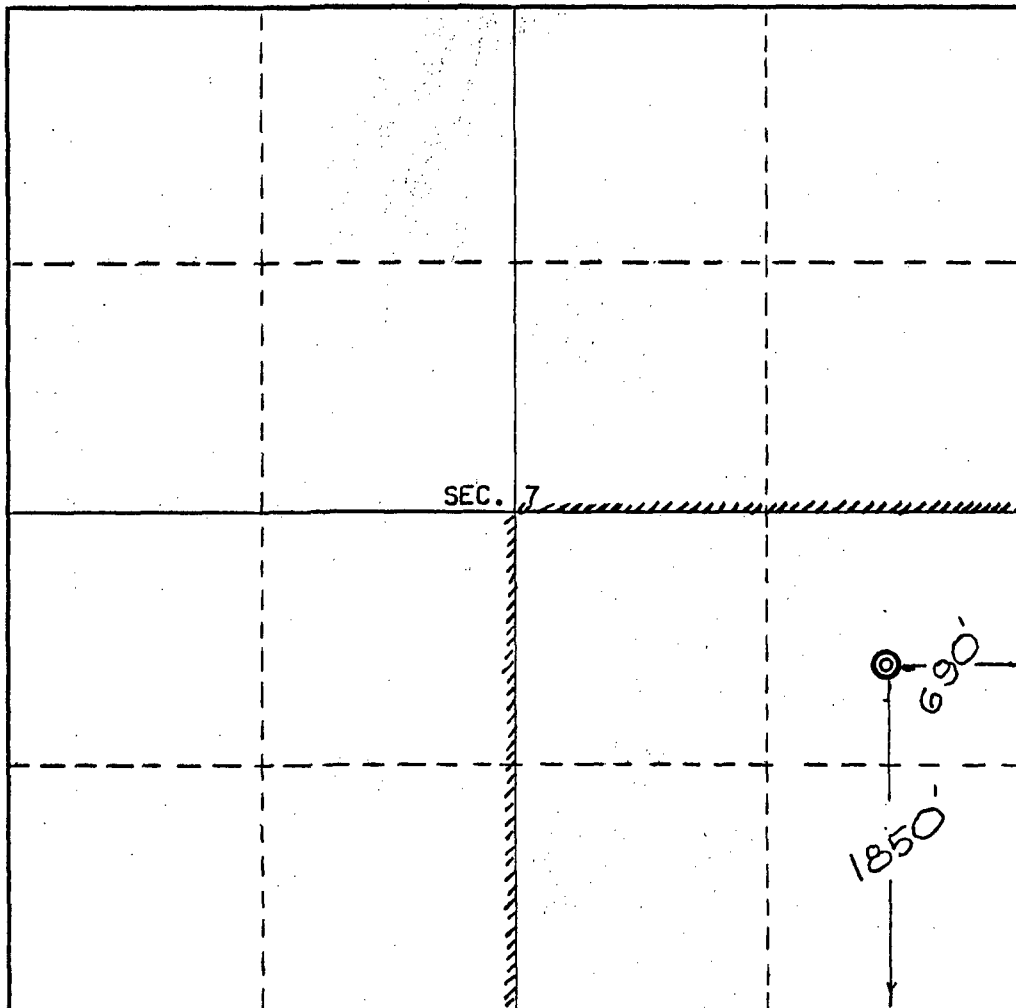

CERTIFICATION

I hereby certify that the information contained herein is true and complete to the best of my knowledge and belief.

*Ed Hartman*

Name

Ed Hartman

Position

President

Company

Manana Gas, Inc.

Date

July 25, 1977

I hereby certify that the well location shown on this plat was obtained from field notes of E. V. ECHOHAWK made by me or under my supervision, and that the same is true and correct to the best of my knowledge and belief.

Date Surveyed

June 30, 1977

Registered Professional Engineer and/or Land Surveyor

*E. V. Echohawk*

Certificate No. 3602

E. V. Echohawk LS

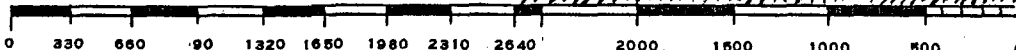

Hand-drawn site plan showing property boundaries, roads, and proposed well site. The plan includes labels for 'PRIVATE ROAD', 'CHARLES JONES PROP.', 'IRRIGATION DITCHES', 'PROPOSED TEMPORARY FENCE TO ENCLOSE DRILLING OPERATIONS', 'LOCATION STAKED 12' WEST OF FENCE LINE', 'PROPOSED EL PASO N.G. METER HOUSE', 'METER HOUSE TO BE AT FENCE LINE, ACCESS DOOR FACING EAST', 'EXISTING PRIVATE ACCESS ROAD', and 'WELL SITE TO BE CONSTRUCTED TO A SURE CONDITION. THE TEMPORARY FENCE TO BE REMOVED AT THAT TIME.' Dimensions include 142', 100', 120', 100', 690', 1850', 7, 8, 18, and 17.

15" CULVERT TO BE PLACED  
IN MAIN IRRIGATION DITCH  
AT ENTRANCE TO WELL.

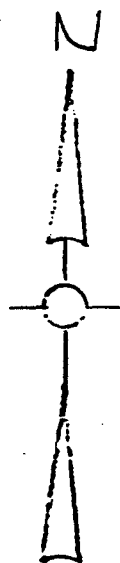

MANANA GAS, INC.

SURVEY OF WELL LOC,  
"CHARLIE NO. 1, IN THE  
NESE OF SEC. 7, T30N,  
R11W., "SAN JUAN CO.,  
NEW MEXICO.

6-30-77

SCALE 1" = 100'



**El Paso** NATURAL GAS  
COMPANY

P. O. BOX 990  
FARMINGTON, NEW MEXICO 87401  
PHONE: 505-325-2841

DEC - 8 1977

CONSERVATION COMMISSION

December 7, 1977

NEW MEXICO OIL CONSERVATION COMMISSION  
Post Office Box 2088  
Santa Fe, New Mexico 87501

Re: Application for Administrative Approval  
Unorthodox Location, Aztec PC Gas Field  
1850'FSL & 690'FEL, Sec. 7, T30N, R11W  
San Juan County, New Mexico.

Gentlemen:

This is to advise that El Paso Natural Gas Company, as an offset owner of acreage, has no objection to referenced dual completion.

Yours very truly,



John A. Ahlm  
Regional Land Manager  
Energy Resource Development

JAA:ld

cc: Mr. Curtis J. Little *copy*  
Manana Gas, Inc., Ed Hartman-President *copy*  
New Mexico Oil Conservation Commission-Aztec, NM

OIL CONSERVATION COMMISSION  
Cyler DISTRICT

DEC 22 1977

OIL CONSERVATION COMMISSION  
BOX 2088  
SANTA FE, NEW MEXICO

DATE 12-19-77

RE: Proposed MC \_\_\_\_\_  
Proposed DHC \_\_\_\_\_  
Proposed NSL ✓ \_\_\_\_\_  
Proposed SWD \_\_\_\_\_  
Proposed WFX \_\_\_\_\_  
Proposed PMX \_\_\_\_\_

Gentlemen:

I have examined the application dated 12-7-77  
for the Manana Gas, Inc. Charlie #1 I-7-30N-11W  
Operator Lease and Well No. Unit, S-T-R

and my recommendations are as follows:

Approve  
\_\_\_\_\_  
\_\_\_\_\_  
\_\_\_\_\_  
\_\_\_\_\_  
\_\_\_\_\_

Yours very truly,

AR Stendick



WILLIAM PLACK CARR

6700 FOREST LANE  
DALLAS, TEXAS 75230  
368-6968

NSK-909

December 30, 1977

New Mexico Oil & Gas Commission  
Box 2308  
Santa Fe, New Mexico 87501

Gentlemen:

I would like to state that I have no objection to the unorthodox location in the Aztec Pictured Cliffs Gas Field requested by Manana Gas Inc. for a Picture Cliff well to be drilled 1850' FSL and 690' FEL of Section 7, Township 3 North, Range 11 West, San Juan County, New Mexico.

Yours very truly,



W. P. Carr

WPC/nsf