

ROBERT L. BAYLESS

PETROLEUM CLUB PLAZA BUILDING

P. O. BOX 1541

FARMINGTON, NEW MEXICO 87401

NOV 23 1977

NSL - 9/2
Operator Name on C-101 attached
Rule 104 F
Dec 18

November 23, 1977

New Mexico Oil Conservation Commission
P.O. Box 2088
Santa Fe, New Mexico 87501

RE: Bimson #2

~~Aztec - Fruitland Test Pool~~

1980 FNL 1850 FNL

NW/4 17, T28N, R10W
San Juan County, N.M.

Gentlemen:

Please accept this as our application for administrative approval of an unorthodox location for the above well as shown on the attached survey plat. You will note that we have moved the location 100 feet south from the orthodox location to remove it from a wash.

We are sending a copy of this application to the offset acreage holders along with a request for waiver on their part if they have no objection.

Yours very truly,

MERRION & BAYLESS

By Robert L. Bayless
ROBERT L. BAYLESS

RLB/eh

Enclosure: Intent to Drill
Survey Plat
Topo Sheet

cc: 2 copies - Aztec
1 copy to each offset acreage holder



UNITED STATES
DEPARTMENT OF THE INTERIOR
GEOLOGICAL SURVEY

APPLICATION FOR PERMIT TO DRILL, DEEPEN, OR PLUG BACK

1a. TYPE OF WORK

DRILL ☒DEEPEN ☐PLUG BACK ☐

b. TYPE OF WELL

OIL
WELL ☐GAS
WELL ☒

OTHER

SINGLE
ZONE ☒MULTIPLE
ZONE ☐

2. NAME OF OPERATOR

J. Gregory Merrion and Robert L. Bayless

3. ADDRESS OF OPERATOR

P.O. Box 1541, Farmington, NM 87401

4. LOCATION OF WELL (Report location clearly and in accordance with any State requirements.)

At surface

1950 FNL and 1850 FWL

At proposed prod. zone

same

14. DISTANCE IN MILES AND DIRECTION FROM NEAREST TOWN OR POST OFFICE*

15. DISTANCE FROM PROPOSED*

LOCATION TO NEAREST
PROPERTY OR LEASE LINE, FT.
(Also to nearest drlg. unit line, if any)

16. NO. OF ACRES IN LEASE

160

17. NO. OF ACRES ASSIGNED
TO THIS WELL

160

18. DISTANCE FROM PROPOSED LOCATION*
TO NEAREST WELL, DRILLING, COMPLETED,
OR APPLIED FOR, ON THIS LEASE, FT.

19. PROPOSED DEPTH

2090 ft.

20. ROTARY OR CABLE TOOLS

Rotary

21. ELEVATIONS (Show whether DF, RT, GR, etc.)

5910' G.L.

22. APPROX. DATE WORK WILL START*

As soon as possible

23.

PROPOSED CASING AND CEMENTING PROGRAM

SIZE OF HOLE	SIZE OF CASING	WEIGHT PER FOOT	SETTING DEPTH	QUANTITY OF CEMENT
9"	7"	20#	60'	25 sax
5"	2-7/8"	6.5#	2090'	150 sax

Fruitland Test Well:

Will drill 9" hole and set 60 ft. of 7", 20 lb. surface casing with 25 sax cement. Will drill 5" hole to 2090 ft. to test Fruitland. Will run 2-7/8", 6.5 lb., J-55 casing with 150 sax cement if appears productive. Will perforate and test.

DEC - 3 1977

IN ABOVE SPACE DESCRIBE PROPOSED PROGRAM: If proposal is to deepen or plug back, give data on present productive zone and proposed new productive zone. If proposal is to drill or deepen directionally, give pertinent data on subsurface locations and measured and true vertical depths. Give blowout preventer program, if any.

24.

SIGNED

Robert L. Bayless

TITLE

Co-Owner

DATE

Nov. 23, 1977

(This space for Federal or State office use)

PERMIT NO.

APPROVAL DATE

APPROVED BY

TITLE

DATE

CONDITIONS OF APPROVAL, IF ANY:

**NEW MEXICO OIL CONSERVATION COMMISSION
WELL LOCATION AND ACREAGE DEDICATION PLAT**

Form C-102
Supersedes C-128
Effective 1-1-65

All distances must be from the outer boundaries of the Section.

Operator Merrion & Bayless			Lease Bimson		Well No. 2
Unit Letter F	Section 17	Township 28N	Range 10W	County San Juan	
Actual Footage Location of Well:					
1950 feet from the North line and		1850 feet from the West line			
Ground Level Elev. 5910	Producing Formation Fruitland	Pool Aztec Fruitland		Dedicated Acreage: 160 Acres	

1. Outline the acreage dedicated to the subject well by colored pencil or hachure marks on the plat below.
2. If more than one lease is dedicated to the well, outline each and identify the ownership thereof (both as to working interest and royalty).
3. If more than one lease of different ownership is dedicated to the well, have the interests of all owners been consolidated by communitization, unitization, force-pooling, etc?

☐ Yes ☐ No If answer is "yes," type of consolidation _____

If answer is "no," list the owners and tract descriptions which have actually been consolidated. (Use reverse side of this form if necessary.) _____

No allowable will be assigned to the well until all interests have been consolidated (by communitization, unitization, forced-pooling, or otherwise) or until a non-standard unit, eliminating such interests, has been approved by the Commission.

SF 047039B

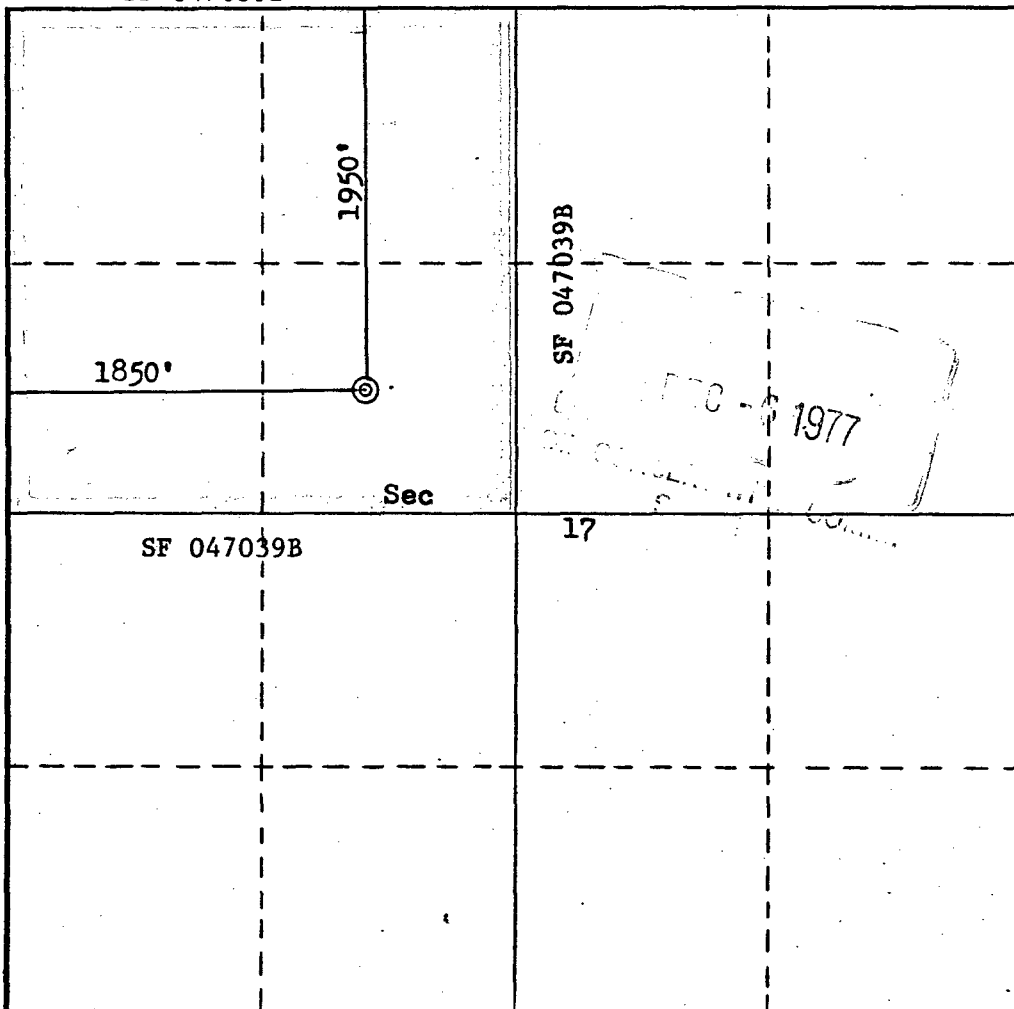

CERTIFICATION

I hereby certify that the information contained herein is true and complete to the best of my knowledge and belief.

Name

Robert L. Bayless

Position

Co-Owner

Company

MERRION & BAYLESS

Date

November 23, 1977

I hereby certify that the well location shown on this plat was plotted from field notes of actual surveys made by me or under my supervision, and that the same is true and correct to the best of my knowledge and belief.

Date Surveyed

November 22, 1977

Registered Professional Engineer and/or Land Surveyor

Fred B. Kerr Jr.

Certificate No.

3950

SF 047039B

0 330 660 990 1320 1650 1980 2310 2640 2000 1500 1000 500 0

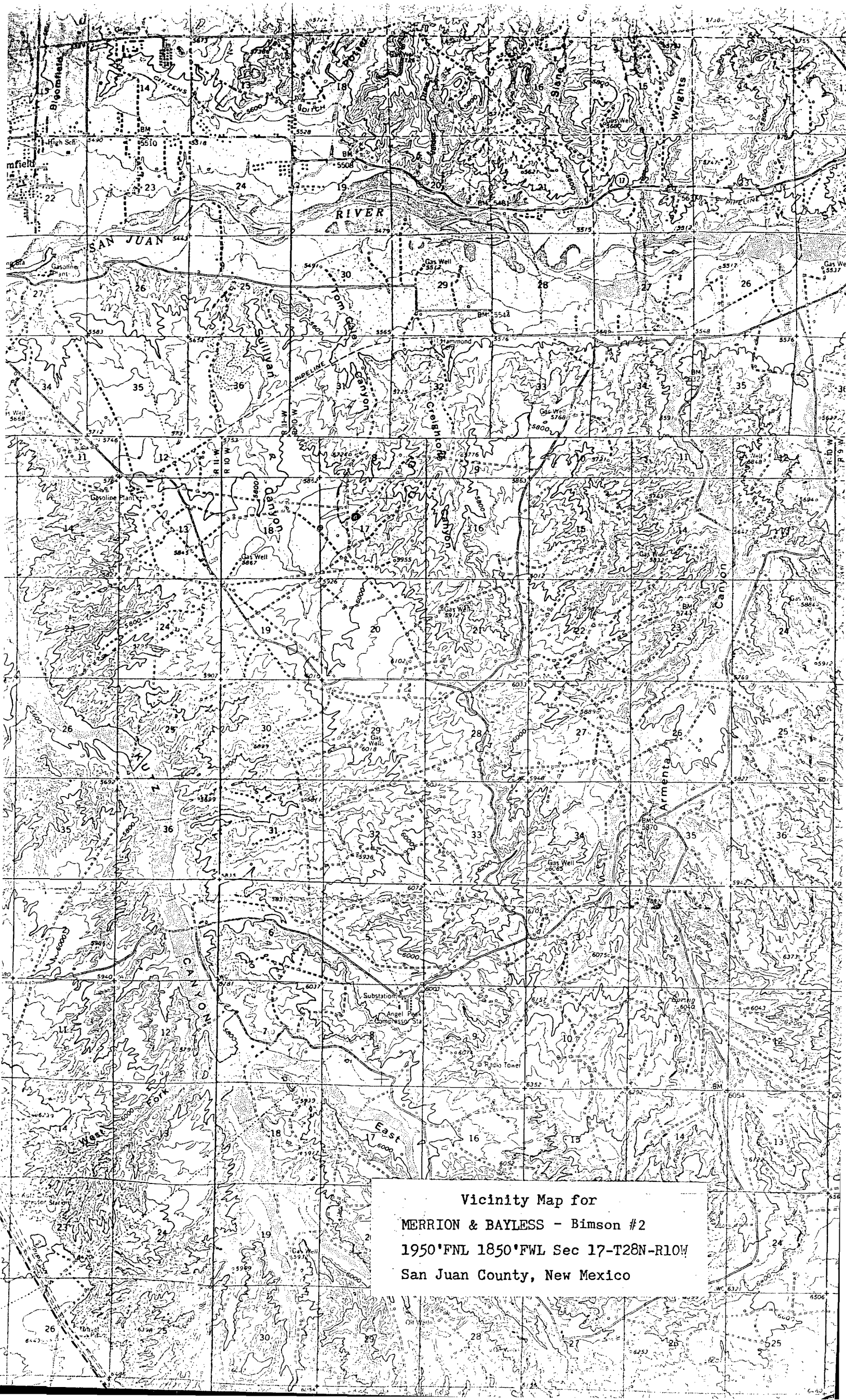

Vicinity Map for
MERRION & BAYLESS - Bimson #2
1950°FNL 1850°FWL Sec 17-T28N-R10W
San Juan County, New Mexico

OIL CONSERVATION COMMISSION
Cuyler DISTRICT

NSL-912

OIL CONSERVATION COMMISSION
BOX 2088
SANTA FE, NEW MEXICO

DATE 12-2-77

RE: Proposed MC _____
Proposed DHC _____
Proposed NSL ✓ _____
Proposed SWD _____
Proposed WFX _____
Proposed PMX _____

Gentlemen:

I have examined the application dated 11-23-77
J. Gregory Merriam #
for the Robert L. Bayless Bimson R F-17-28N-10W
Operator Lease and Well No. Unit, S-T-R

and my recommendations are as follows:

Approve

Yours very truly,

AR Kendrick

DEC -3 1977
OIL CONSERVATION COMMISSION