

Rec'd Jan 16, 1978 RLS

NSL-916

El Paso NATURAL GAS
COMPANY

P. O. BOX 990
FARMINGTON, NEW MEXICO 87401
PHONE: 505-325-2841

December 19, 1977

NSL
F. 65, 1978
Rule 104 F

Mr. Joe Ramey
New Mexico Oil Conservation Commission
Post Office Box 2088
Santa Fe, New Mexico 87501

Dear Mr. Ramey:

This is a request for administrative approval for an unorthodox gas well location in the Blanco Mesa Verde pool.

It is intended to locate the El Paso Natural Gas Company's San Juan 29-7 Unit #71A at 2170' from the South line and 790' from the East line of Section 24, T-29-N, R-7-W, NMPM, Rio Arriba County, New Mexico.

This location has been changed due to topographical reasons. Large cliffs and rock outcropping make an orthodox well location impossible to build.

All operators of proration units offsetting the proposed unorthodox location have been notified of this application by certified mail.

Plats showing the proposed well location and an ownership plat are attached.

Yours truly,

EL PASO NATURAL GAS CO.

L. A. Aimes

L. A. Aimes
Senior Drilling Engineer

LAA:jm

attachments

El Paso NATURAL GAS
COMPANY

NORTHWEST PIPELINE CORPORATION

P.O. BOX 990
FARMINGTON, NEW MEXICO 87401
PHONE: 505-325-2841

December 19, 1977

PRODUCTION AND DRILLING

NORTHWEST PIPELINE CORPORATION

JAN 17 1978

PRODUCTION AND DRILLING

Re: Unorthodox Gas Well Location

Gentlemen:

El Paso Natural Gas Company has requested administrative approval for an unorthodox gas well location in the Blanco Mesa Verde pool.

It is intended to locate the El Paso Natural Gas Company's San Juan 29-7 Unit #71A at 2170' from the South line and 790' from the East line of Sec. 24, T-29-N, R-7-W, NMPM Survey, Rio Arriba County, New Mexico.

This location has been changed due to topographical reasons. Large cliffs and rock outcroppings make this well site impossible to build at orthodox footages prescribed by law.

In compliance with New Mexico Oil Conservation Commission rules, we are notifying you, as operators of an offsetting proration unit, of our application for administrative approval for the aforementioned unorthodox gas well location. Enclosed are three copies of this letter. If there is no objection to this location, please sign and return one copy to the New Mexico Oil Conservation Commission, Post Office Box 2088, Santa Fe, New Mexico 87501; one copy to El Paso Natural Gas Company; and keep one copy for your files.

A plat showing the proposed well location and offsetting Mesa Verde ownership is attached.

Yours truly,

EL PASO NATURAL GAS CO.

L. A. Aimes

L. A. Aimes
Senior Drilling Engineer

LAA:jm

Approved: NORTHWEST PIPELINE CORPORATION
E. H. Wood, Manager - Prod. & Drlg.

E. H. Wood

Date: 1-18-78

EL PASO NATURAL GAS COMPANY

Well Name... San Juan 29-7 Unit #71 A

Footage----- 2170' FSL, 790' FEL

APPLICATION FOR NON-STANDARD LOCATION

County Rio Arriba State New Mexico

Section 24

Township 29N

Range 7W

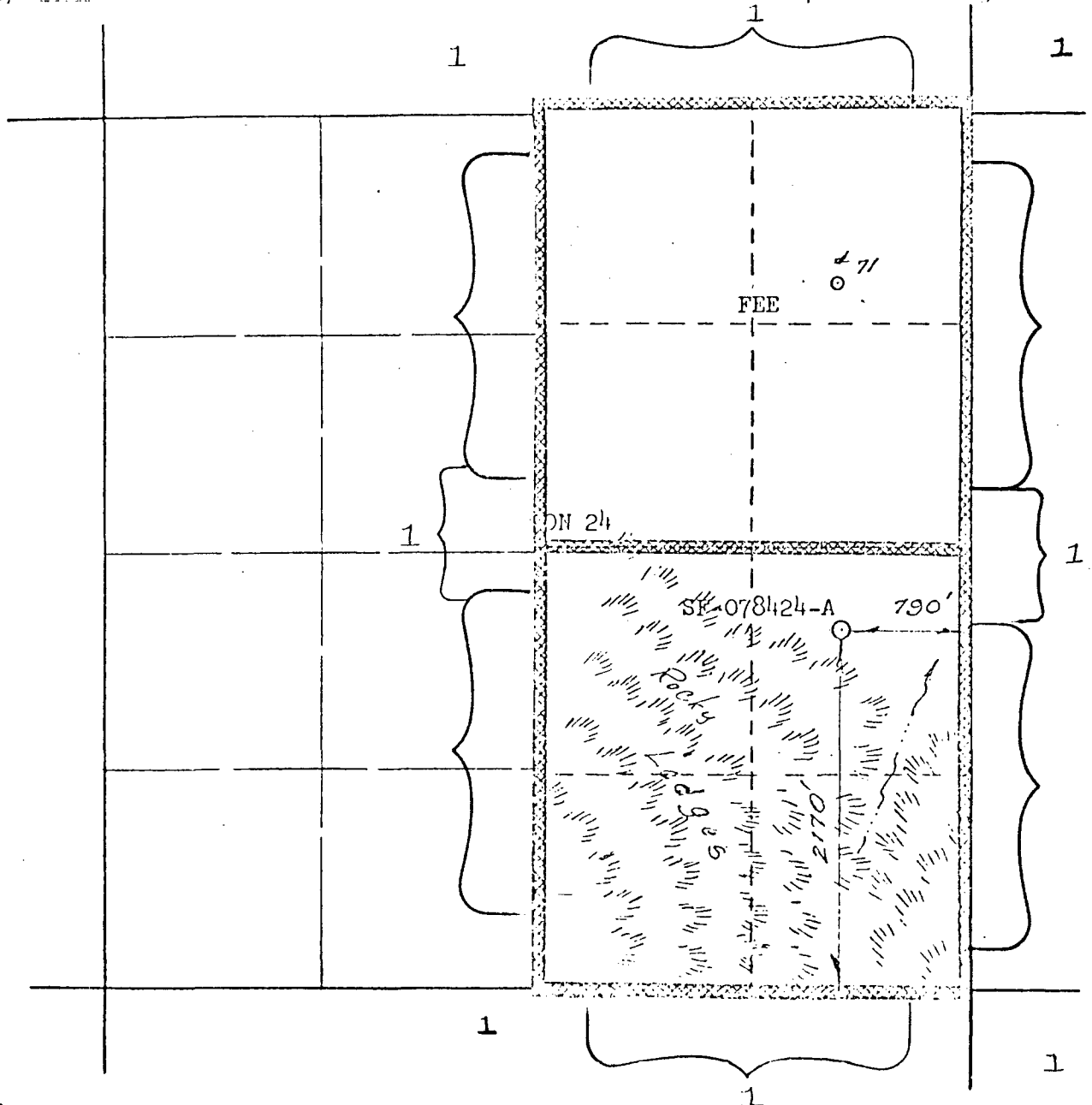

REMARKS:

(1) Northwest Pipeline Corporation

UNITED STATES
DEPARTMENT OF THE INTERIOR
GEOLOGICAL SURVEY

APPLICATION FOR PERMIT TO DRILL, DEEPEN, OR PLUG BACK

1a. TYPE OF WORK DRILL <input checked="" type="checkbox"/> DEEPEN <input type="checkbox"/> PLUG BACK <input type="checkbox"/>			5. LEASE DESIGNATION AND SERIAL NO. SF 078424-A	
b. TYPE OF WELL OIL WELL <input type="checkbox"/> GAS WELL <input checked="" type="checkbox"/> OTHER <input type="checkbox"/>			6. IF INDIAN, ALLOTTEE OR TRIBE NAME	
2. NAME OF OPERATOR El Paso Natural Gas Company			7. UNIT AGREEMENT NAME San Juan 29-7 Unit	
3. ADDRESS OF OPERATOR PO Box 990, Farmington, NM 87401			8. FARM OR LEASE NAME San Juan 29-7 Unit	
4. LOCATION OF WELL (Report location clearly and in accordance with any State requirements.)* At surface 2170'S, 790'E At proposed prod. zone			9. WELL NO. 71A	
14. DISTANCE IN MILES AND DIRECTION FROM NEAREST TOWN OR POST OFFICE* approx. 20 miles E of Blanco, NM			10. FIELD AND POOL, OR WILDCAT Blanco Mesa Verde	
15. DISTANCE FROM PROPOSED* LOCATION TO NEAREST PROPERTY OR LEASE LINE, FT. (Also to nearest drlg. unit line, if any) 790'			11. SEC., T., R., M., OR BLK. AND SURVEY OR AREA Sec. 24, T-29-N, R-7-W NMPM	
16. NO. OF ACRES IN LEASE Unit			12. COUNTY OR PARISH 13. STATE Rio Arriba NM	
17. NO. OF ACRES ASSIGNED TO THIS WELL 320.00			18. DISTANCE FROM PROPOSED LOCATION* TO NEAREST WELL, DRILLING, COMPLETED, OR APPLIED FOR, ON THIS LEASE, FT. 2000'	
19. PROPOSED DEPTH 5720'			20. ROTARY OR CABLE TOOLS Rotary	
21. ELEVATIONS (Show whether DF, RT, GR, etc.) 6247' GL			22. APPROX. DATE WORK WILL START*	

PROPOSED CASING AND CEMENTING PROGRAM				
SIZE OF HOLE	SIZE OF CASING	WEIGHT PER FOOT	SETTING DEPTH	QUANTITY OF CEMENT
13 3/4"	9 5/8"	32.3#	200'	224 cu.ft. to circulate
8 3/4"	7"	20.0#	3430'	276 cu.ft. to cover Ojo Alamo
6 1/4"	4 1/2" liner	10.5#	3280-5720'	426 cu.ft. to fill to 3280'

Selectively perforate and sandwater fracture the Mesa Verde formation.

A 3000 psi WP and 6000 psi test double gate preventer equipped with blind and pipe rams will be used for blow out prevention on this well.

This gas is dedicated.

The E/2 of Section 24 is dedicated to this well.

IN ABOVE SPACE DESCRIBE PROPOSED PROGRAM: If proposal is to deepen or plug back, give data on present productive zone and proposed new productive zone. If proposal is to drill or deepen directionally, give pertinent data on subsurface locations and measured and true vertical depths. Give blowout preventer program, if any.

24. SIGNED A. G. Duesen TITLE Drilling Clerk DATE 1-12-78
(This space for Federal or State office use)

PERMIT NO. _____ APPROVAL DATE _____

APPROVED BY _____ TITLE _____ DATE _____
CONDITIONS OF APPROVAL, IF ANY:

**NEW MEXICO OIL CONSERVATION COMMISSION
WELL LOCATION AND ACREAGE DEDICATION PLAT**

Form C-102
Supersedes C-128
Effective 1-1-65

All distances must be from the outer boundaries of the Section.

Operator EL PASO NATURAL GAS COMPANY			Lease SAN JUAN 29-7 UNIT (SF-078424-A)		Well No. 71A
Unit Letter I	Section 24	Township 29-N	Range 7-W	County RIO ARriba	
Actual Footage Location of Well: 2170 feet from the SOUTH line and 790 feet from the EAST line					
Ground Level Elev. 6247	Producing Formation MESA VERDE		Pool BLANCO MESA VERDE		Dedicated Acreage: 320.00 Acres

1. Outline the acreage dedicated to the subject well by colored pencil or hachure marks on the plat below.
2. If more than one lease is dedicated to the well, outline each and identify the ownership thereof (both as to working interest and royalty).
3. If more than one lease of different ownership is dedicated to the well, have the interests of all owners been consolidated by communitization, unitization, force-pooling, etc?

☒ Yes ☐ No If answer is "yes," type of consolidation Unitization

If answer is "no," list the owners and tract descriptions which have actually been consolidated. (Use reverse side of this form if necessary.) _____

No allowable will be assigned to the well until all interests have been consolidated (by communitization, unitization, forced-pooling, or otherwise) or until a non-standard unit, eliminating such interests, has been approved by the Commission.

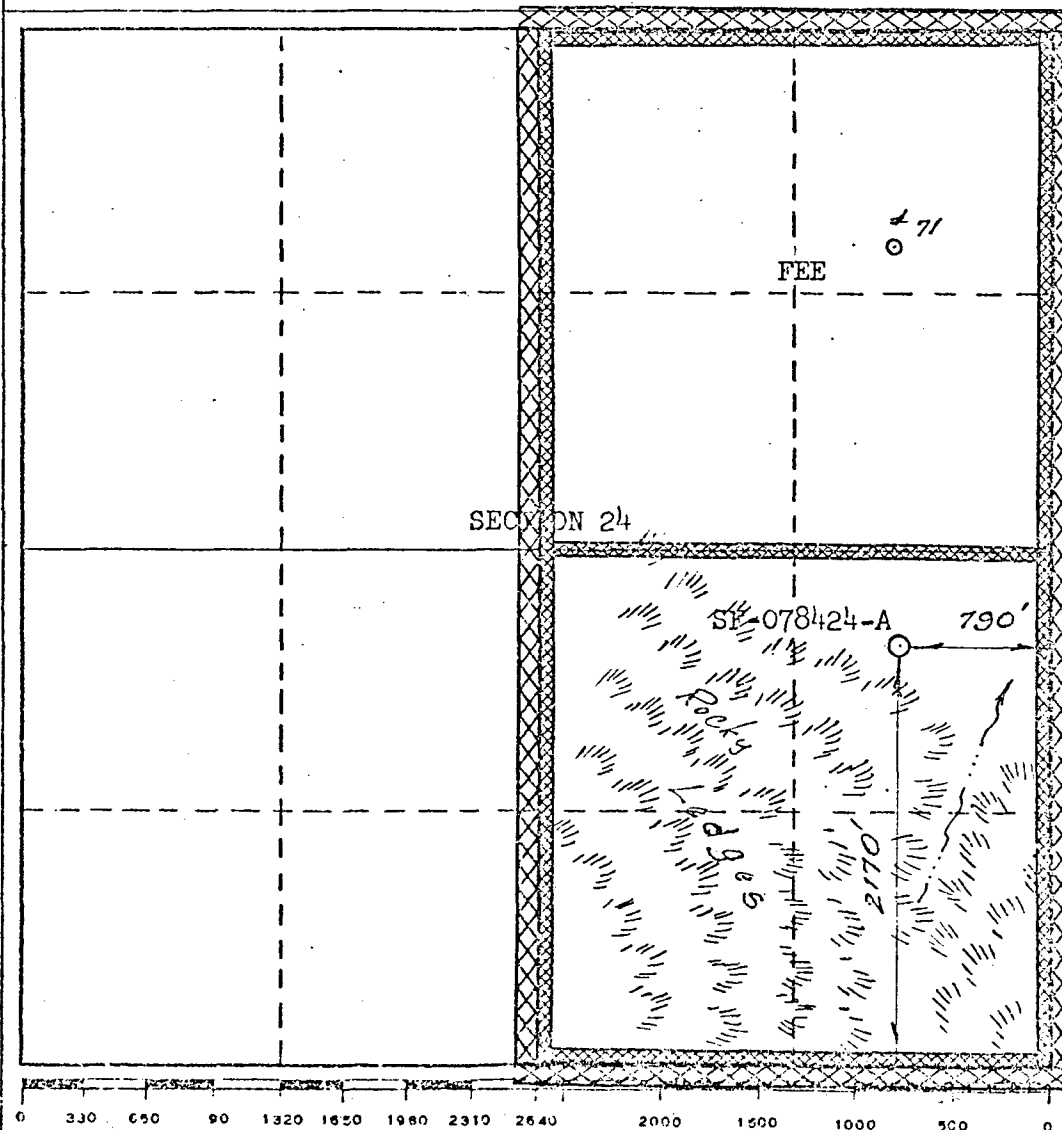

CERTIFICATION

I hereby certify that the information contained herein is true and complete to the best of my knowledge and belief.

A. G. Duesco

Name

Drilling Clerk

Position

El Paso Natural Gas

Company

January 12, 1978

Date

I hereby certify that the well location shown on this plat was plotted from field notes of actual surveys made by me or under my supervision, and that the same is true and correct to the best of my knowledge and belief.

Date Surveyed

OCTOBER 10, 1977

Registered Professional Engineer and/or Land Surveyor

David W. Green

Certificate No. **1760**

OIL CONSERVATION COMMISSION
Albuquerque DISTRICT

JAN 31 1978
OIL CONSERVATION COMMISSION

OIL CONSERVATION COMMISSION
BOX 2088
SANTA FE, NEW MEXICO

DATE 1-27-78

RE: Proposed MC _____
Proposed DHC _____
Proposed NSL ☒ _____
Proposed SWD _____
Proposed WFX _____
Proposed PMX _____

R. L. Stamets

Gentlemen:

I have examined the application dated 12-19-77
for the El Paso Natural Gas Co. San Juan 29-7 Unit # 71A
Operator Lease and Well No. Unit, S-T-R
I-24-29N-7W
and my recommendations are as follows:

Approve

Yours very truly,

AR Kendrick