

915-684-0100

November 16, 1978

NOV 20 1978

Santa Fe

Energy & Minerals Department
Oil Conservation Division
P. O. Box 2088
Santa Fe, New Mexico 87501

Attn: Mr. Joe D. Ramey

Re: Request for a change in Administrative
Order NSL-937, dated April 26, 1978,
and amended August 21, 1978.
Non-standard drilling locations within
the project area of ARCO-Empire Abo Unit
Eddy County, New Mexico

Gentlemen:

Atlantic Richfield Company, as operator of the
Empire Abo Unit Pressure Maintenance Project,
acting on behalf of itself and other working interest
owners, requests an amendment of administrative
order NSL-937 dated April 26, 1978, and amended
August 21, 1978, inasmuch as the following:

- amend. NSL
937*
- a) Unit well J-212 located 1900' FNL & 100' FWL
Section 6, T-18S, R-28E, is deleted.
 - b) Unit well J-213, located 2450' FNL & 400' FWL
Section 6, T-18S, R-28E, will be renamed
"J-212".

New NSL-998c) Unit well I-251 will be added at a location
660' FNL & 150' FWL, Section 5, T-18S, R-28E.

*Rule 14 R-4549-B
Dec 10, 1978*

The above changes meet all requirements of Order
R-4549-B, Rule 14, said wells being located "no
closer than 660 feet to the outer boundary of
said unit, nor closer than 10 feet to any quarter-
quarter section or subdivision inner boundary."

Energy & Minerals Department
Oil Conservation Commission
November 16, 1978
Page 2

The proposed drilling of these wells is necessary in order to complete a more efficient producing pattern to conserve reservoir energy, promote the greatest ultimate recovery of unit reserves, prevent waste, and protect correlative rights.

Very truly yours,



J. L. Tweed

IJN/agp

cc: Mr. Bill Gressett
Energy & Minerals Dept.
Oil Conservation Div.
Artesia, New Mexico

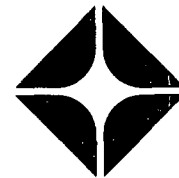

November 16, 1978

Energy & Minerals Department
Oil Conservation Division
P. O. Box 2088
Santa Fe, New Mexico 87501

Attn: Mr. Joe Ramey

Re: Notification of offset operators
to proposed change in the non-
standard drilling locations within
the project area of the
ARCO-Empire Abo Unit
Eddy County, New Mexico

Gentlemen:

Atlantic Richfield Company, as operator of the
Empire Abo Unit pressure maintenance project,
in accordance with Order No. R-4549-B, Rule 14(3),
under "Special Rules and Regulations for the
Empire Abo Pressure Maintenance Project," has
notified all offset operators of the proposed
change in the non-standard locations with a
complete application.

Attached is a list of the offset operators and
the date they were notified.

Very truly yours,

J. L. Tweed

IJN/agp

cc: Mr. Bill Gressett
Energy & Minerals Dept.
Oil Conservation Division
Artesia, New Mexico

ALL OFFSET OPERATORS
to the
PROPOSED NON-STANDARD DRILLING LOCATIONS
WITHIN THE PROJECT AREA OF THE ARCO-EMPIRE
ABO UNIT PRESSURE MAINTENANCE PROJECT

All the following offset operators were notified
by mail November 16, 1978

DEPCO, Inc.
800 Central
Odessa, TX 79761

C. E. LaRue &
B. N. Muncy, Jr.
P. O. Box 196
Artesia, N. M. 88210

C. O. Fulton
P. O. Box 1121
Artesia, N. M. 88210

Herman Ledbetter
874 Amarillo
Abilene, TX 79602

J. B. Adamson
P. O. Box 727
Artesia, N. M. 88210

American Petrofina Co of Texas
P. O. Box 1311
Big Spring, TX

Brunhan and Company
P. O. Box 257
Artesia, N. M. 88210

Franklin, Aston, and Fair, Inc.
P. O. Box 1090
Roswell, N. M. 88201

Kincaid & Watson Drlg Co.
P. O. Box 498
Artesia, N. M. 88210

William E. Jeffers
P. O. Box 65
Artesia, N. M. 88210

B & D Oil Company
P. O. Box 804
Hobbs, N. M.

Yates Drilling Company
207 South Fourth
Artesia, N. M. 88210

Marbob Energy Corporation
Artesia, N. M. 88210

Aminoil USA - Inc.
600 Western United Life Bldg
Midland, TX 79701

PROPOSED PRODUCING WELL DIAGRAM

ATLANTIC RICHFIELD COMPANY

Empire Abo Unit Well J-212
2450' FNL & 400' FWL, Sec. 6, T-18S, R-28E
Eddy County, New Mexico

8-5/8" casing
set @ 550'
(cmt. circ.)

5-1/2" casing
set @ 6250'
(cmt. circ.)

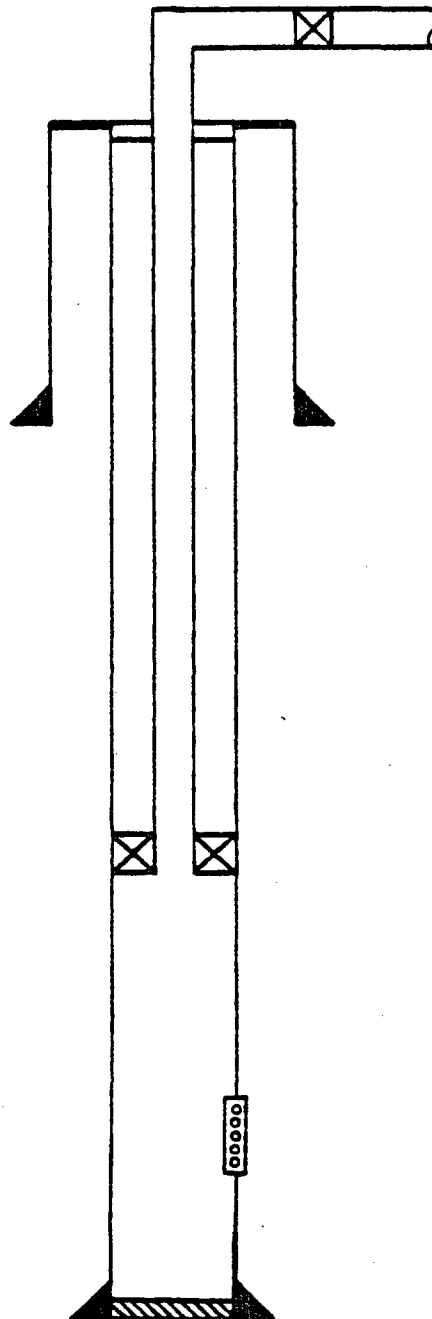

2-3/8" OD tubing

Pkr set @ approx.
5600'

Proposed perforations
5650'-6250'

TD @ 6250'

PROPOSED PRODUCING WELL DIAGRAM

ATLANTIC RICHFIELD COMPANY

Empire Abo Unit Well 1-251

660' FNL & 150' FWL, Sec. 5, T-18S, R-28E

Eddy County, New Mexico

8-5/8" casing
set @ 600'
(cmt. circ.)

5-1/2" casing
set @ 6250'
(cmt. circ.)

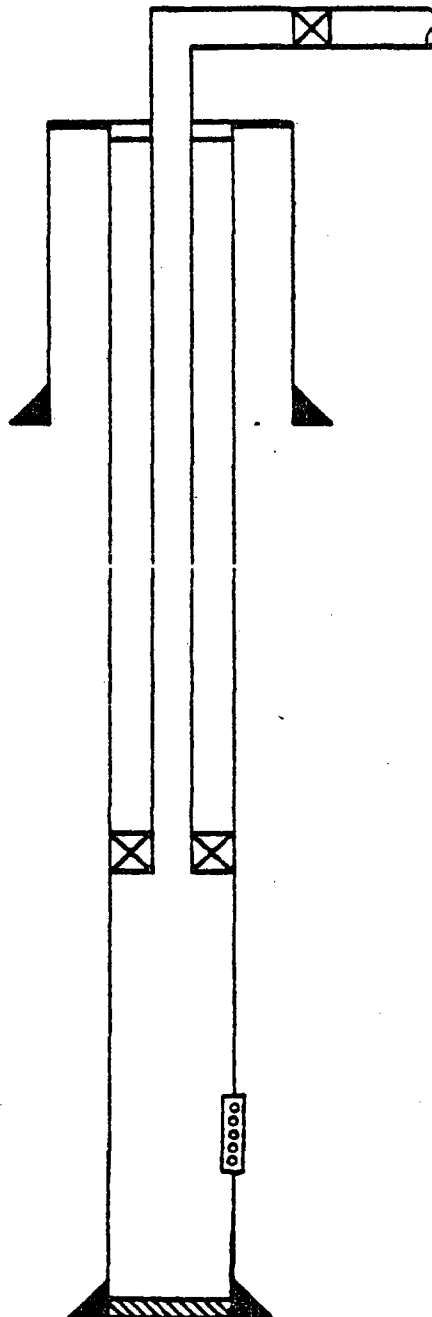

2-3/8" OD tubing

Pkr set @ approx.
5750'

Proposed perforations
5800'-6250'

TD @ 6250'

NEW MEXICO OIL CONSERVATION COMMISSION
WELL LOCATION AND ACREAGE DEDICATION PLAT

Form C-122
Supersedes C-128
Effective 1-1-65

All distances must be from the outer boundaries of the Section

Operator Atlantic Richfield Co.		Lease Empire Abo Unit # J		Acres 212*	
Section E	Section 6	Township 18 South	Range 28 East	County Eddy	
Actual Well Location of Well:					
2450	feet from the	North	line and	400	feet from the
					West
Ground Level Elev. 3650.1	Producing Formation		Pool	Estimated Acreage:	
Acres					

1. Outline the acreage dedicated to the subject well by colored pencil or hachure marks on the plat below.
2. If more than one lease is dedicated to the well, outline each and identify the ownership thereof (both as to working interest and royalty).
3. If more than one lease of different ownership is dedicated to the well, have the interests of all owners been consolidated by communitization, unitization, force-pooling, etc?

☒ Yes ☐ No If answer is "yes," type of consolidation Unitization

If answer is "no," list the owners and tract descriptions which have actually been consolidated. (Use reverse side of this form if necessary.)

No allowable will be assigned to the well until all interests have been consolidated (by communitization, unitization, forced-pooling, or otherwise) or until a non-standard unit, eliminating such interests, has been approved by the Commission.

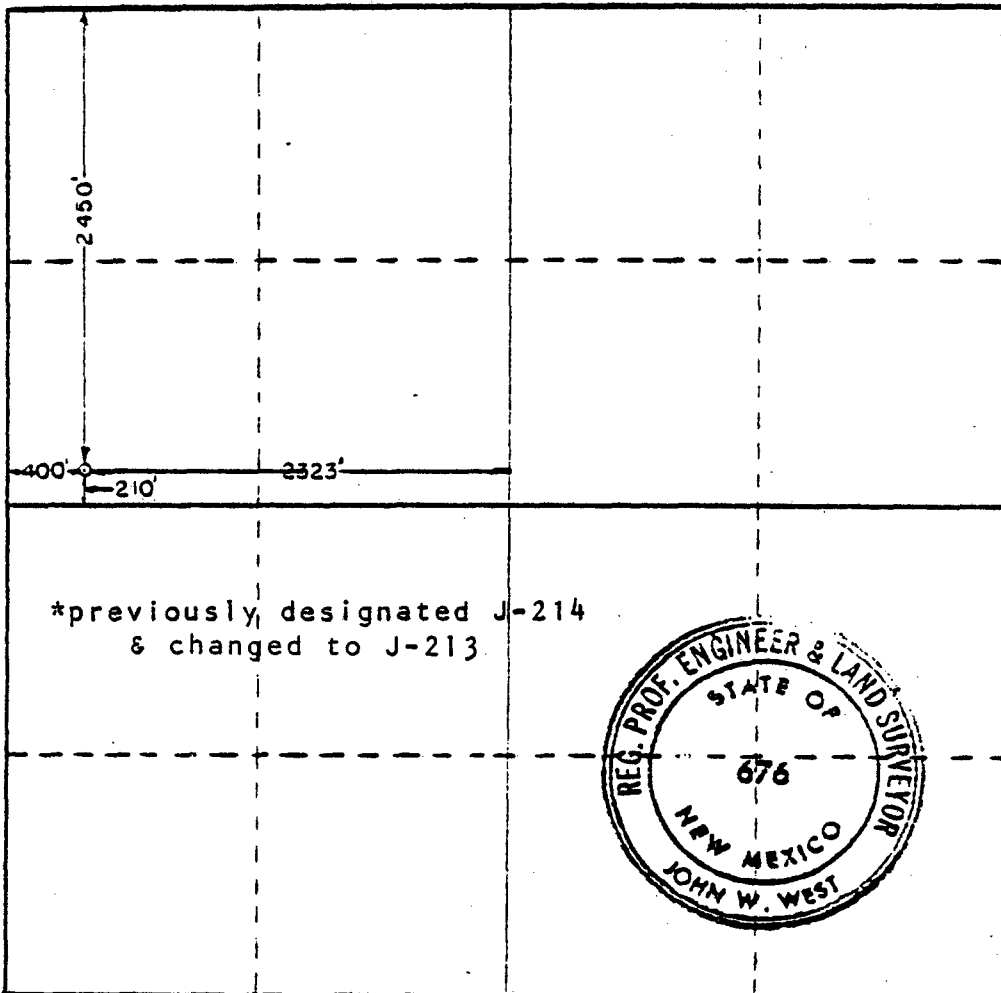

CERTIFICATION

I hereby certify that the information contained herein is true and complete to the best of my knowledge and belief.

I. J. Natour

Name

I. J. Natour

Position

Operations Engineer

Company

Atlantic Richfield Company

Date

March 22, 1978

I hereby certify that the well location shown on this plat was plotted from field notes of actual surveys made by me or under my supervision, and that the same is true and correct to the best of my knowledge and belief.

March 16, 1978

Date Surveyed

Registered Professional Engineer and/or Land Surveyor

John W. West

Certificate No. **John W. West**

676

Ronald J. Eidson 3239

330 660 990 1320 1650 1980 2310 2640 2970 3300 3630 3960 4290 4620 4950 5280 5610 5940 6270 6600 6930 7260 7590 7920 8250 8580 8910 9240 9570 9900

**NEW MEXICO OIL CONSERVATION COMMISSION
WELL LOCATION AND ACREAGE DEDICATION PLAT**

Form C-102
Supersedes C-128
Effective 1-1-65

All distances must be from the outer boundaries of the Section

Operator Atlantic Richfield Co.			Lease Empire Abo Unit 1		Well No. 251
Lot Letter D	Section 5	Township 18-S	Range 28-E	County Eddy	
Actual Footage Location of Well:					
660	feet from the North	line and	150	feet from the West	line
Ground Level Elev. 3673.8	Producing Formation		Pool	Dedicated Acreage: Acres	

1. Outline the acreage dedicated to the subject well by colored pencil or hachure marks on the plat below.
2. If more than one lease is dedicated to the well, outline each and identify the ownership thereof (both as to working interest and royalty).
3. If more than one lease of different ownership is dedicated to the well, have the interests of all owners been consolidated by communitization, unitization, force-pooling, etc?
☒ Yes ☐ No If answer is "yes," type of consolidation Unitization

If answer is "no," list the owners and tract descriptions which have actually been consolidated. (Use reverse side of this form if necessary.) _____

No allowable will be assigned to the well until all interests have been consolidated (by communitization, unitization, forced-pooling, or otherwise) or until a non-standard unit, eliminating such interests, has been approved by the Commission.

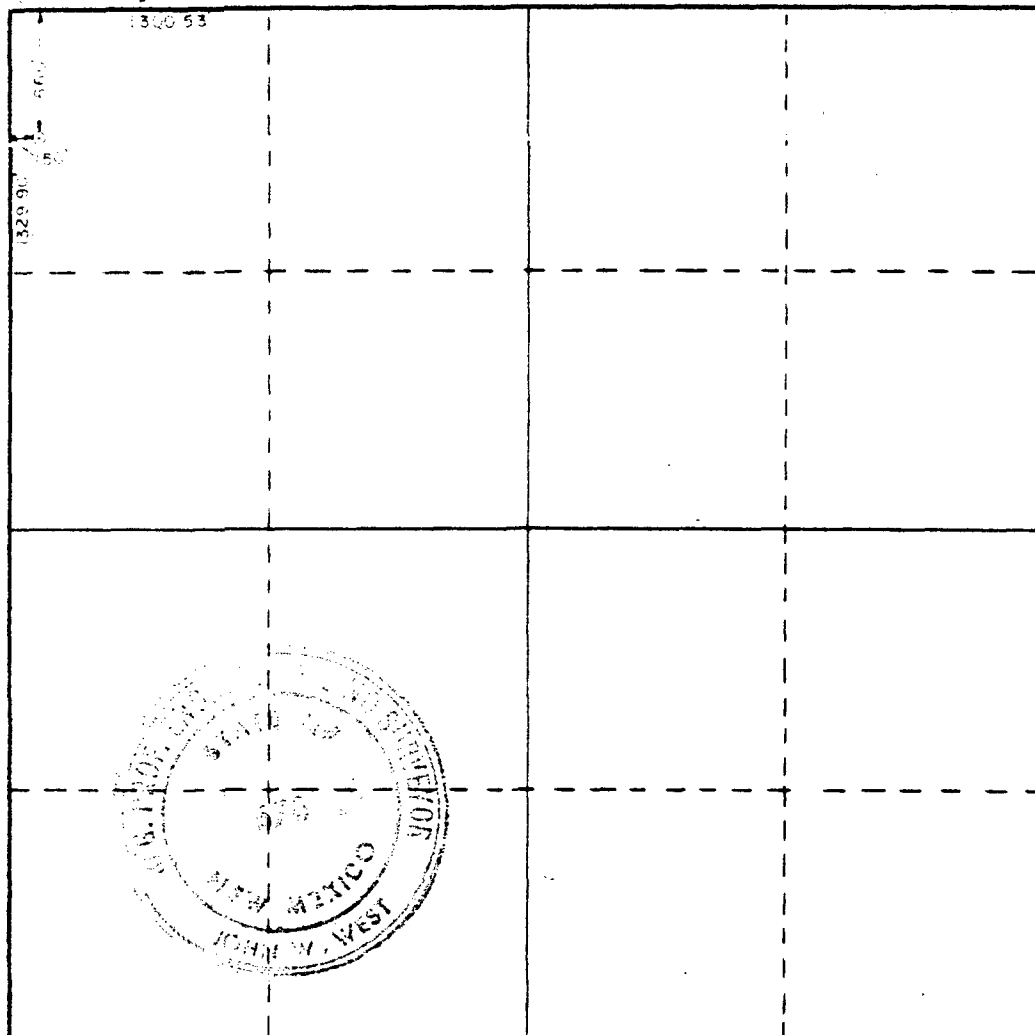

CERTIFICATION

I hereby certify that the information contained herein is true and complete to the best of my knowledge and belief

I. J. Natour

Name
I. J. Natour

Position
Operations Engineer

Company
Atlantic Richfield Co.

Date
November 15, 1978

I hereby certify that the well location shown on this plat was plotted from field notes of actual surveys made by me or under my supervision, and that the same is true and correct to the best of my knowledge and belief.

Date Surveyed

Registered Professional Engineer and/or Land Surveyor

John W. West

Certificate No. **John W. West 676**
Ronald J. Eide 2270

