

*Recd  
2-6-79*

**El Paso** NATURAL GAS  
COMPANY

P. O. BOX 990  
FARMINGTON, NEW MEXICO 87401  
PHONE: 505-325-2841

February 1, 1979

Mr. Joe Ramey  
New Mexico Oil Conservation Commission  
Post Office Box 2088  
Santa Fe, New Mexico 87501

*NSL-1010  
Rule 104F  
2-25-79*

Dear Mr. Ramey:

This is a request for administrative approval for an unorthodox gas well location in the Blanco Mesa Verde pool.

It is intended to locate the El Paso Natural Gas Company's Randlemon #1A at 2200' from the North line and 1140' from the West line of Section 26, T-31-N, R-11-W, San Juan County, New Mexico.

The Animas River and irrigated fields cover most of the northwest corner of this section and this makes it impossible to build an orthodox gas well location.

All operators of proration units offsetting the proposed unorthodox location have been notified of this application by certified mail.

Plats showing the proposed well location and the terrain of Section 26, along with an ownership plat, are attached.

Yours truly,

*L. A. Aimes*

L. A. Aimes  
Project Drilling Engineer

LAA:pb

# EL PASO NATURAL GAS COMPANY

Well Name Randlemon #1 A, Blanco Mesaverde

Footage---- 2200' FNL, 1140' FWL

APPLICATION FOR NON-STANDARD LOCATION

County San Juan

State New Mexico

Section 26 Township 31N

Range 11W

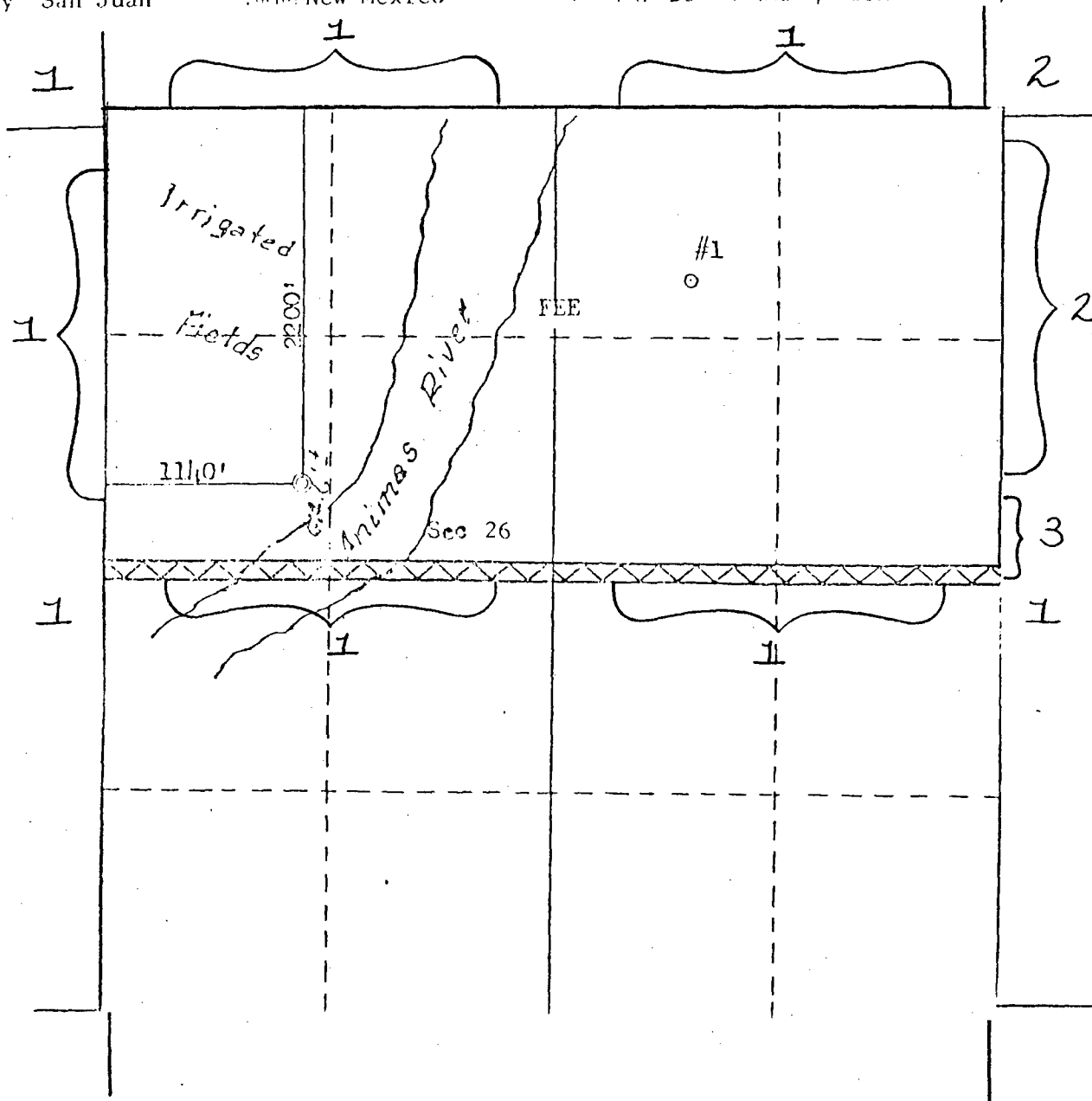

## REMARKS:

- (1) El Paso Natural Gas Company
- (2) Southland Royalty Company
- (3) Supron Energy Corporation

ld

**NEW MEXICO OIL CONSERVATION COMMISSION  
WELL LOCATION AND ACREAGE DEDICATION PLAT**

Form C-102  
Supersedes C-128  
Effective 1-1-65

All distances must be from the outer boundaries of the Section.

Operator <b>EL PASO NATURAL GAS COMPANY</b>			Lease <b>RANDLEMON</b>		(FEE)	Well No. <b>1A</b>
Unit Letter <b>E</b>	Section <b>26</b>	Township <b>31N</b>	Range <b>11W</b>	County <b>San Juan</b>		

Actual Footage Location of Well:  
**2200** feet from the **North** line and **1140** feet from the **West** line

Ground Level Elev. <b>5681</b>	Producing Formation <b>Mesa Verde</b>	Pool <b>Blanco Mesa Verde</b>	Dedicated Acreage: <b>320.00</b> Acres
-----------------------------------	--	----------------------------------	---

1. Outline the acreage dedicated to the subject well by colored pencil or hatchure marks on the plat below.
2. If more than one lease is dedicated to the well, outline each and identify the ownership thereof (both as to working interest and royalty).
3. If more than one lease of different ownership is dedicated to the well, have the interests of all owners been consolidated by communitization, unitization, force-pooling, etc?

☐ Yes    ☐ No    If answer is "yes," type of consolidation \_\_\_\_\_

If answer is "no," list the owners and tract descriptions which have actually been consolidated. (Use reverse side of this form if necessary.) \_\_\_\_\_

No allowable will be assigned to the well until all interests have been consolidated (by communitization, unitization, forced-pooling, or otherwise) or until a non-standard unit, eliminating such interests, has been approved by the Commission.

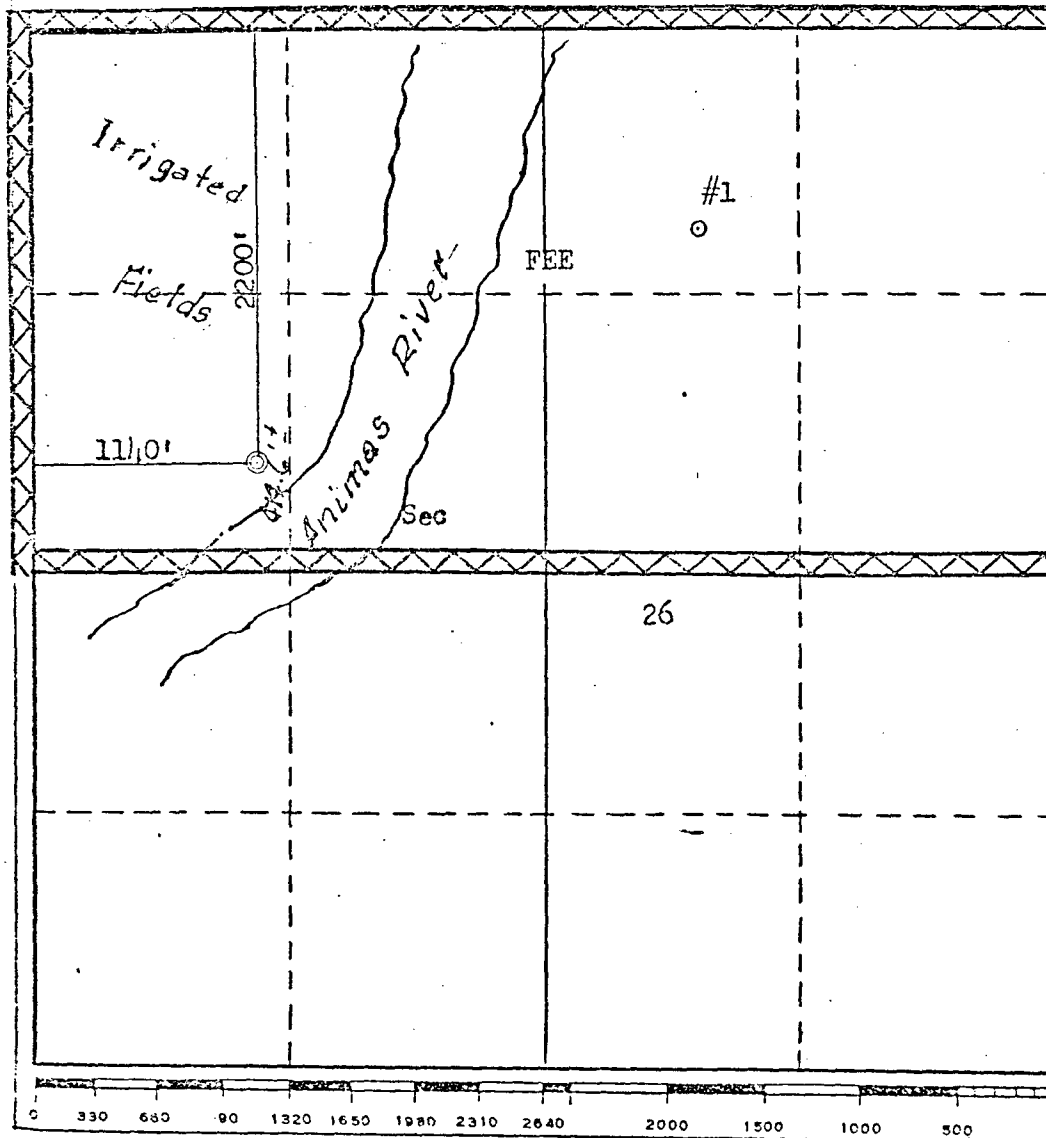

**CERTIFICATION**

I hereby certify that the information contained herein is true and complete to the best of my knowledge and belief.

*D. G. Briggs*  
Name  
**Drilling Clerk**

Position  
**El Paso Natural Gas Co.**

Date  
**January 29, 1979**

Date

I hereby certify that the well location shown on this plat was plotted from field notes of actual surveys made by me or under my supervision, and that the same is true and correct to the best of my knowledge and belief.

Date Surveyed  
**October 17, 1978**

Registered Professional Engineer  
and/or Land Surveyor

*Fred B. Kern Jr.*  
**Fred B. Kern Jr.**

Certificate No.  
**3950**



**Southland Royalty Company**

February 8, 1979

Oil Conservation Commission  
P. O. Box 2088  
Santa Fe, New Mexico 87501

Re: Unorthodox Gas Well Location  
El Paso Natural Gas Company  
Randlemon #1A  
NW/4, Sec. 26, T31N, R11W  
San Juan County, New Mexico

Gentlemen:

Southland Royalty Company does not object to the subject unorthodox location for an infill Mesaverde well. Enclosed is a signed copy of El Paso's request for approval.

Yours truly,

L. O. Van Ryan  
District Production Manager

LOVR/dg

OK  
RECEIVED

FEB - 7 1979

FARMINGTON DISTRICT

**El Paso** NATURAL GAS  
COMPANY

P. O. BOX 990  
FARMINGTON, NEW MEXICO 87401  
PHONE: 505-325-2841

February 1, 1979

Southland Royalty  
Supron Energy Corporation

Re: Unorthodox Gas Well Location

Gentlemen:

El Paso Natural Gas Company has requested administrative approval for an unorthodox location for a well in the Blanco Mesa Verde pool.

It is intended to locate the El Paso Natural Gas Company's Randlemon #1A at 2200' from the North line and 1140' from the West line of Section 26, T-31-N, R-11-W, San Juan County, New Mexico.

The Animas River and irrigated fields cover most of the northwest corner of this section and this makes it impossible to build an orthodox location.

In compliance with New Mexico Oil Conservation Commission rules, we are notifying you, as operators of an offsetting proration unit, of our application for administrative approval for the aforementioned unorthodox gas well location. Enclosed are three copies of this letter. If there is no objection to this location, please sign and return one copy to the New Mexico Oil Conservation Commission, Post Office Box 2088, Santa Fe, New Mexico 87501; one copy to El Paso Natural Gas Company; and keep one copy for your files.

A plat showing the proposed well location and offsetting Mesa Verde lease ownership is attached.

Yours truly,

*L. A. Aimes*

L. A. Aimes  
Project Drilling Engineer

Approved: *[Signature]*

Date: 2-9-79

District Production Mgr.

SOUTHLAND ROYALTY CO.

**El Paso** NATURAL GAS  
COMPANY

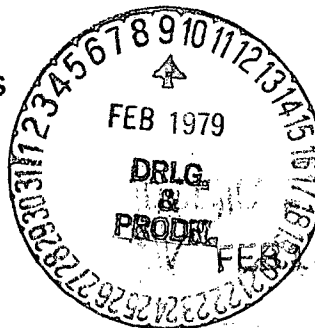

P. O. BOX 990  
FARMINGTON, NEW MEXICO 87401  
PHONE: 505-325-2841

February 1, 1979

Southland Royalty  
Supron Energy Corporation

Re: Unorthodox Gas Well Location

Gentlemen:

El Paso Natural Gas Company has requested administrative approval for an unorthodox location for a well in the Blanco Mesa Verde pool.

It is intended to locate the El Paso Natural Gas Company's Randlemon #1A at 2200' from the North line and 1140' from the West line of Section 26, T-31-N, R-11-W, San Juan County, New Mexico.

The Animas River and irrigated fields cover most of the northwest corner of this section and this makes it impossible to build an orthodox location.

In compliance with New Mexico Oil Conservation Commission rules, we are notifying you, as operators of an offsetting proration unit, of our application for administrative approval for the aforementioned unorthodox gas well location. Enclosed are three copies of this letter. If there is no objection to this location, please sign and return one copy to the New Mexico Oil Conservation Commission, Post Office Box 2088, Santa Fe, New Mexico 87501; one copy to El Paso Natural Gas Company; and keep one copy for your files.

A plat showing the proposed well location and offsetting Mesa Verde lease ownership is attached.

Yours truly,

*L. A. Aimes*

L. A. Aimes  
Project Drilling Engineer

Approved: SUPRON ENERGY CORPORATION  
*Haskell Fleetwood*  
Haskell Fleetwood, Vice President

Date: February 9, 1979

Release Immed.  
no offsets

84 Dec

**El Paso**  
Exploration Company

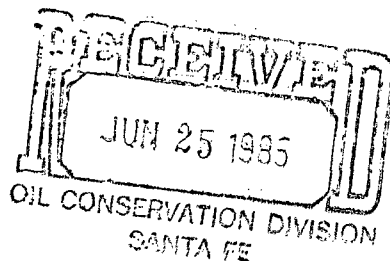

P. O. BOX 4289  
FARMINGTON, NEW MEXICO 87499-4289  
PHONE: 505-325-2841

June 19, 1985

Mr. Richard Stamets  
New Mexico Oil Conservation Division  
Post Office Box 2088  
Santa Fe, New Mexico 87501

Dear Mr. Stamets:

On February 26, 1979, NSL Order #1010 was issued to cover El Paso Natural Gas Company's Randleman #1A well. This Mesa Verde completion was located 2200' from the North line and 1140' from the West line of Section 26, T-31-N, R-11-W, San Juan County, New Mexico.

Currently, it is intended to complete the well in the Aztec Pictured Cliffs Ext. Pool, thus making the well a Pictured Cliffs - Mesa Verde dual completion. It is requested that the current non-standard location approval be amended to include the Pictured Cliffs formation so the proposed workover may be done.

Attached is a copy of our proposed workover, a well location plat showing the terrain of Section 26, and an offset ownership plat.

Thank you for your help in this matter.

Sincerely yours,

A handwritten signature in dark ink, appearing to read "G. W. Brink". The signature is written in a cursive style with a large, sweeping "G" and "B".

G. W. Brink  
Project Drilling Engineer

encl.

# OIL LOCATION AND ACREAGE DEDICATION PLAT

Form C-102  
Supersedes C-1  
Effective 1-1-65

All distances must be from the outer boundaries of the Section.

Operator <b>EL PASO NATURAL GAS COMPANY</b>			Lease <b>Randleman</b> (FEE)		Well No. <b>1A</b>
Unit Letter <b>E</b>	Section <b>26</b>	Township <b>31N</b>	Range <b>11W</b>	County <b>San Juan</b>	

Actual Footage Location of Wells:

2200	feet from the North	line and	1140	feet from the West	line
Ground Level Elev. <b>5681</b>	Producing Formation <b>Mesa Verde / Pic. Cliffs</b>	Pool <b>Aztec Pic. Cliffs Ext. Blanco Mesa Verde</b>	Dedicated Acreage: <b>160</b> & <b>320.00</b> Acres		

1. Outline the acreage dedicated to the subject well by colored pencil or hachure marks on the plat below.
2. If more than one lease is dedicated to the well, outline each and identify the ownership thereof (both as to working interest and royalty).
3. If more than one lease of different ownership is dedicated to the well, have the interests of all owners been consolidated by communitization, unitization, force-pooling, etc?

☐ Yes ☐ No If answer is "yes," type of consolidation \_\_\_\_\_

If answer is "no," list the owners and tract descriptions which have actually been consolidated. (Use reverse side of this form if necessary.) \_\_\_\_\_

No allowable will be assigned to the well until all interests have been consolidated (by communitization, unitization, forced-pooling, or otherwise) or until a non-standard unit, eliminating such interests, has been approved by the Commission.

This plat reissued to show Pictured Cliffs dedication 6-12-85

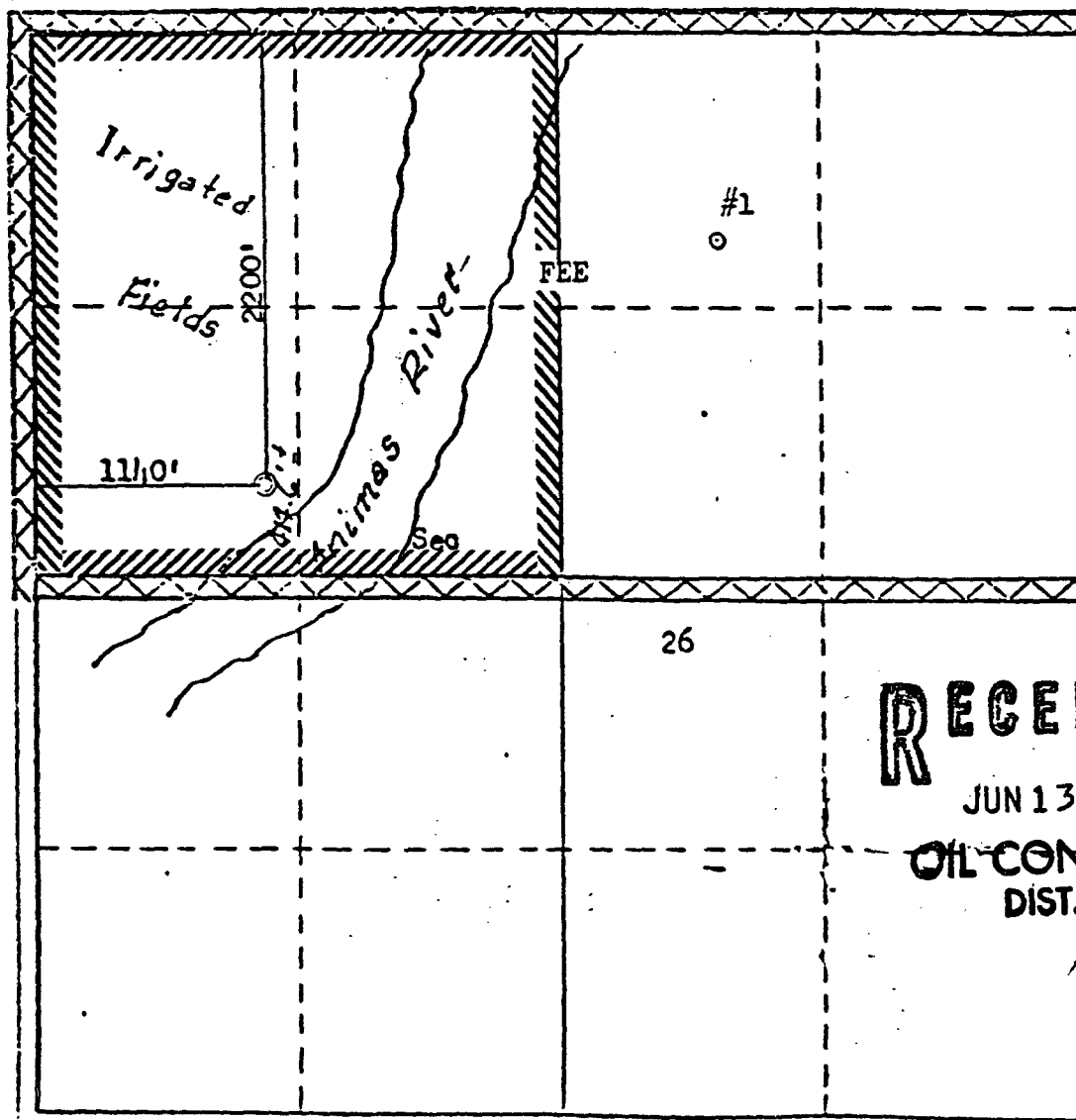

## CERTIFICATION

I hereby certify that the information contained herein is true and complete to the best of my knowledge and belief.

*Peggy Doah*  
Name  
Drilling Clerk

Position  
El Paso Natural Gas Co.

Signature  
June 12, 1985

Date

I hereby certify that the well location on this plat was plotted from field notes, actual surveys made by me or under my supervision, and that the same is true and correct to the best of my knowledge and belief.

RECEIVED

JUN 13 1985

OIL CON. DIV.  
DIST. 3

Date Surveyed  
October 17, 1978  
Registered Professional Engineer  
and/or Land Surveyor  
*Fred B. K...*  
Fred B. K...



**Well Name** Randlemon #1A, Aztec PC Ext.

Footage---- 2200' FNL, 1140' FWL

County Rio Arriba State New Mexico Section 26 Township 31N Range 11W

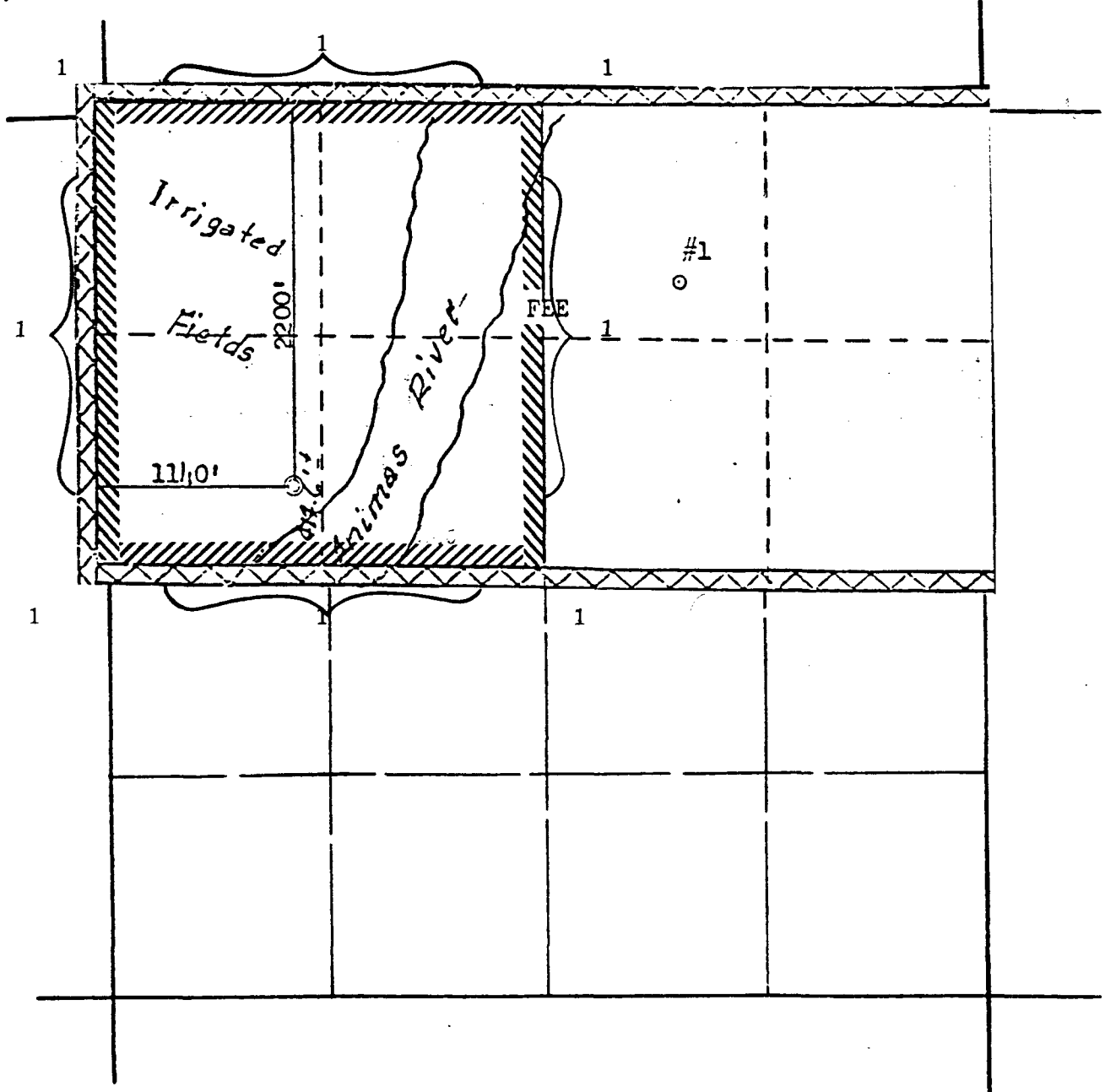

(1) El Paso Natural Gas Company ---Operator

2



STATE OF NEW MEXICO  
ENERGY AND MINERALS DEPARTMENT

OIL CONSERVATION DIVISION  
AZTEC DISTRICT OFFICE

1000 RIO BRAZOS ROAD  
AZTEC, NEW MEXICO 87410  
(505) 334-6178

OIL CONSERVATION DIVISION  
BOX 2088  
SANTA FE, NEW MEXICO 87501

DATE 6-24-85

RE: Proposed MC \_\_\_\_\_  
Proposed DHC \_\_\_\_\_  
Proposed NSL ☒ \_\_\_\_\_  
Proposed SWD \_\_\_\_\_  
Proposed WFX \_\_\_\_\_  
Proposed PMX \_\_\_\_\_

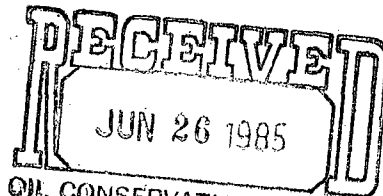

OIL CONSERVATION DIVISION  
SANTA FE

Gentlemen:

I have examined the application dated 6-21-85  
for the El Paso Natural Gas Co. Randleman #1A E-26-31N-11W  
Operator Lease and Well No. Unit, S-T-R

and my recommendations are as follows:

Approve  
\_\_\_\_\_  
\_\_\_\_\_  
\_\_\_\_\_  
\_\_\_\_\_

Yours truly,

Em Randal