



POWERS ELEVATION

December 10, 1979

*NS L
Rule 104 F
Immediate*

OIL WELL ELEVATIONS AND LOCATIONS
CHERRY CREEK PLAZA, SUITE 1201
600 SOUTH CHERRY STREET
DENVER, COLORADO 80222
PHONE NO. 303/321-2217

Joe D. Ramey, Director
New Mexico Oil & Gas Conservation Commission
P.O. Box 2088
Santa Fe, New Mexico 87501

RE: Application for Spacing Exception
John H. Hill & Gordon L. Llewellyn
Foster #4A
SW NW Sec. 4 T26N R8W
2130' FNL & 660' FWL
San Juan County, New Mexico



Dear Sir:

Application is herewith made for an exception to the New Mexico spacing rule that applies to oil and gas wells. Although the above-referenced well location has not been officially inspected, the U.S.G.S. and the B.L.M. both looked at it on November 13, 1979 (the day they inspected some other Hill & Llewellyn wells) and they are of the opinion that, because of topography, this is the best possible location, and that a New Mexico spacing exception would be in order. The pre-drill inspection has been set for December 12, 1979.

Enclosed are duplicate copies of the location and elevation plat (showing offset ownership) and the applicable topographic map (showing location and access road).

Appropriate waivers will be sent under separate cover by Gabriel Bjerke (landman, Supron Energy Corporation in Dallas), who confirmed this matter with me in telephone conversations November 29, 1979 and December 3, 1979, and John Ahlm, who confirmed this matter with me in telephone conversations November 30, 1979 and December 3, 1979.

In a telephone conversation today, I discussed the spacing exception with Larry Van Ryan of Southland Royalty Company. We agreed on the procedure of sending notification per certified mail (return receipt will be sent to the New Mexico Oil & Gas Conservation Commission, Santa Fe).

Should you require any additional information in order to approve this Application for Spacing Exception, please advise.

Please note that the above-referenced well location involves federal minerals, thus Farmington U.S. Geological Survey requires a copy of your approval of the spacing exception.

Very truly yours,

POWERS ELEVATION

Jacqueline E. LaSasso

Jacqueline E. LaSasso

JEL:vg

Enclosures

cc: (2) New Mexico Oil & Gas Conservation Commission, Aztec District Office
Gabriel Bjerke, Supron Energy Corporation, Dallas, Texas
John Ahlm, El Paso Exploration Company, Farmington, New Mexico
✓ Larry Van Ryan, Southland Royalty Company, Farmington, New Mexico
Gordon L. Llewellyn, Dallas, Texas
Leon Wiederkehr, Esperanza Energy Corporation, Austin, Texas

OIL CONSERVATION DIVISION

STATE OF NEW MEXICO
ENERGY AND MINERALS DEPARTMENTP. O. BOX 2088
SANTA FE, NEW MEXICO 87501Form C-102
Revised 10-1-78

All distances must be from the outer boundaries of the Section.

Operator John H. Hill & Gordon L. Llewellyn			Lease NM-02901			Well No. Foster #4A		
Section E	Section 4	Township 26N	Range 8W	County San Juan	Dedicated Acreage: 321.2 Acres			
Tool Footage Location of Well: 2130' feet from the North line and 660' feet from the West line								
Ground Level Elev. 6389'		Producing Formation Ballard P.C./Blanco Mesa Verde				Pool		

1. Outline the acreage dedicated to the subject well by colored pencil or hachure marks on the plat below.
2. If more than one lease is dedicated to the well, outline each and identify the ownership thereof (both as to working interest and royalty).
3. If more than one lease of different ownership is dedicated to the well, have the interests of all owners been consolidated by communitization, unitization, force-pooling, etc?

☐ Yes ☐ No If answer is "yes," type of consolidation _____

If answer is "no," list the owners and tract descriptions which have actually been consolidated. (Use reverse side of this form if necessary.) _____

No allowable will be assigned to the well until all interests have been consolidated (by communitization, unitization, forced-pooling, or otherwise) or until a non-standard unit, eliminating such interests, has been approved by the Division.

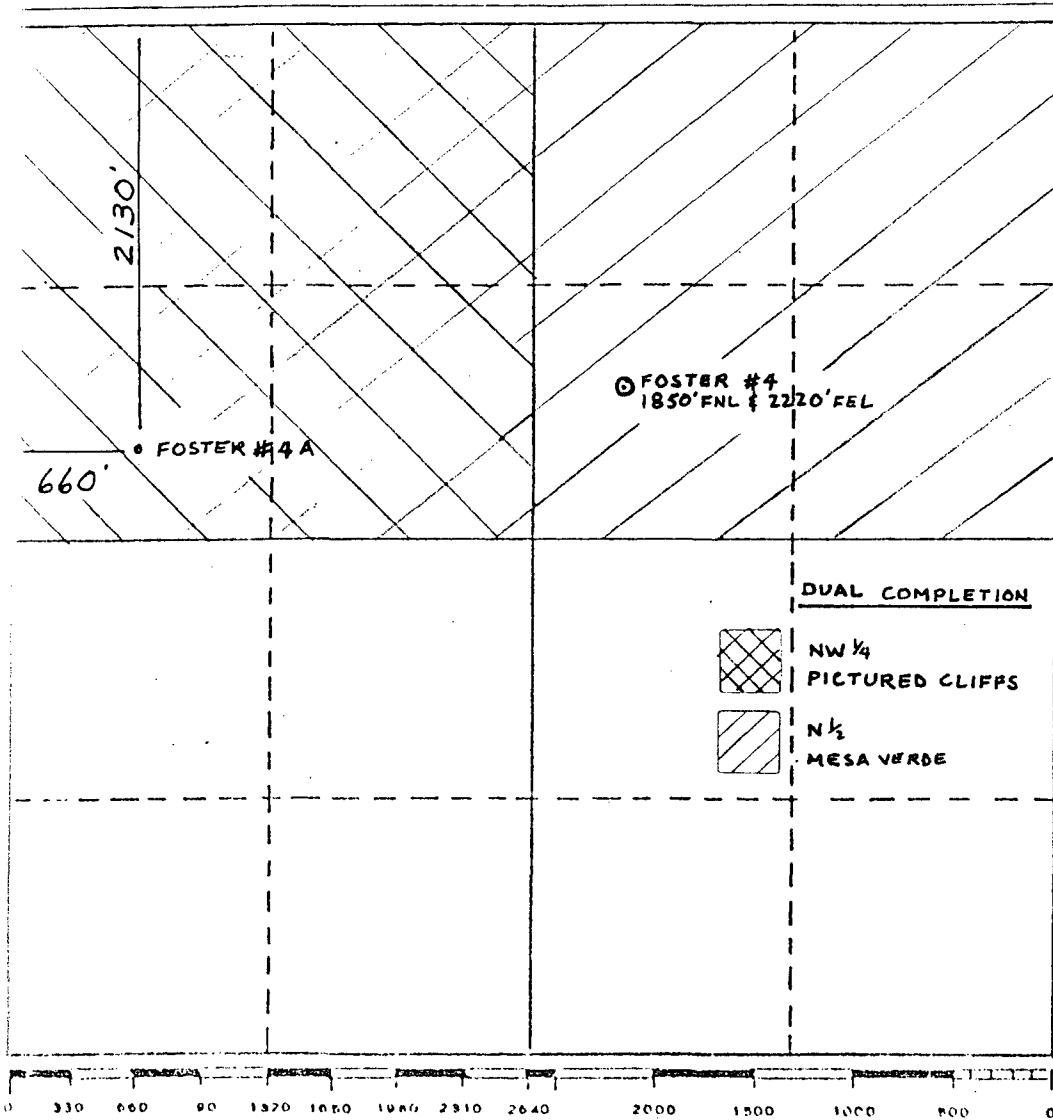

CERTIFICATION

I hereby certify that the information contained herein is true and complete to the best of my knowledge and belief.

George Lapaseotes
Name George Lapaseotes

V. Pres. Powers Elevation

Position Agent Consultant for

Company John H. Hill & Gordon L. Llewellyn

Date November 21, 1979

I hereby certify that the well location shown on this plat was plotted from field notes of actual surveys made by me or under my supervision, and that the same is true and correct to the best of my knowledge and belief.

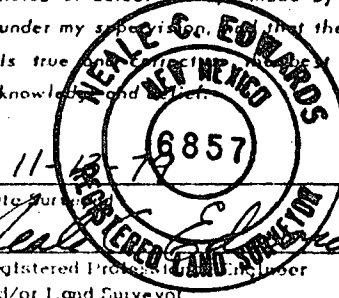

Date Surveyed
Registered Professional Engineer
and/or Land Surveyor

6857

Certificate No.

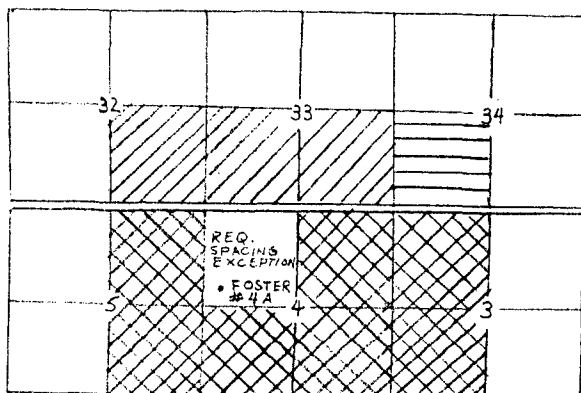
OFFSET MINERAL OWNERSHIP
(DESIGNATED OPERATOR)

- ☒ SUPRON ENERGY CORPORATION
(ICTURED CLIFFS & MESAVERDE)
- ☒ EL PASO EXPLORATION COMPANY
(ICTURED CLIFFS & MESAVERDE)
- ☒ SOUTHLAND ROYALTY COMPANY
(ICTURED CLIFFS & MESAVERDE)

EXHIBIT "E"
Access Road to Location

LEGEND
County Road
Existing Oil Field Road

John H. Hill & Gordon L. Llewellyn
Foster #4A
SW NW Sec. 4 T26N R8W
San Juan County, New Mexico

Closest Dwelling

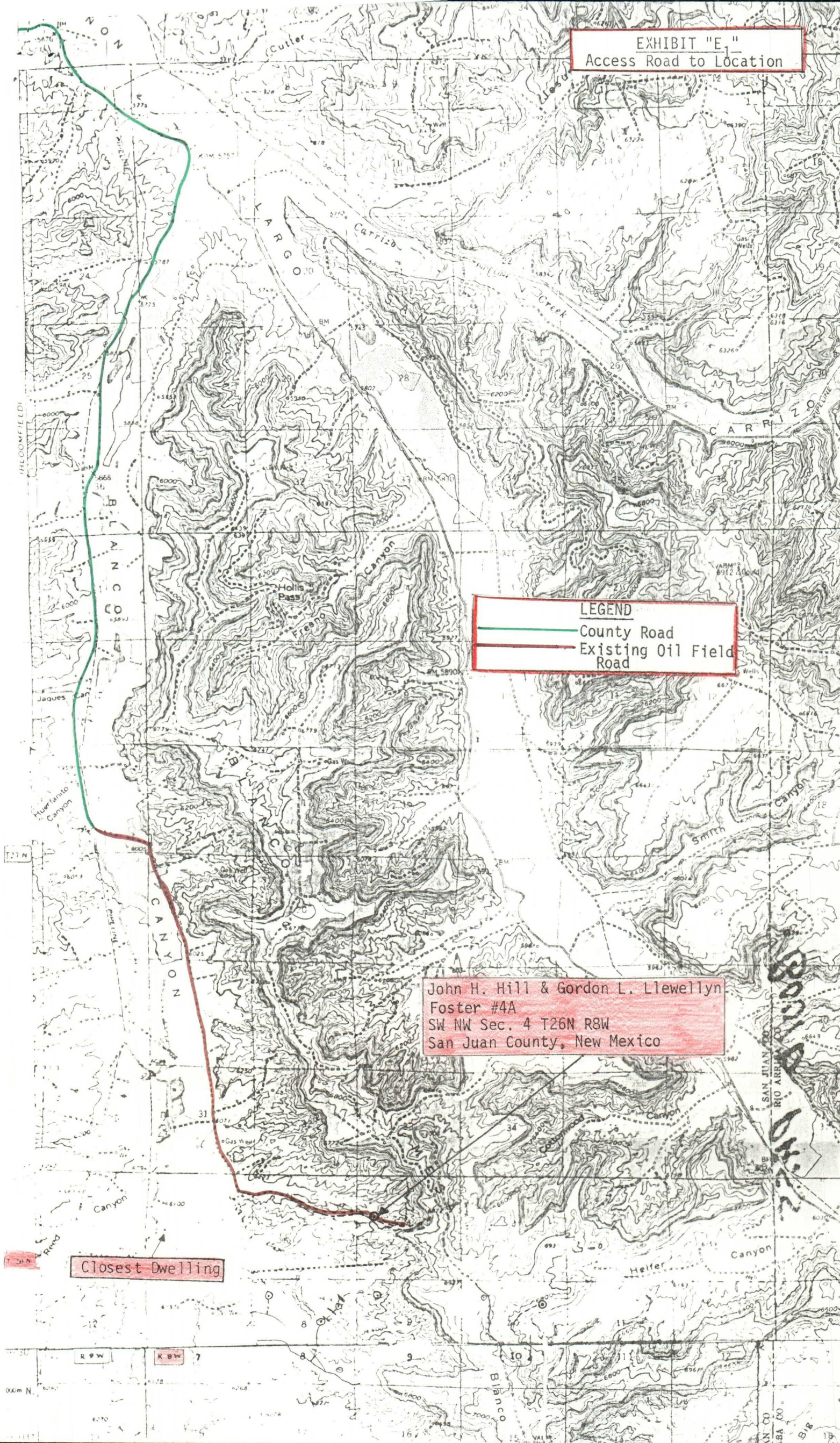

SUPRON ENERGY CORPORATION

BLDG. V, FIFTH FLOOR
10300 NORTH CENTRAL EXPRESSWAY
DALLAS, TEXAS 75231

TELEPHONE (214) 691-9141
TWX: (910) 861-9117
SUPCO-DAL.

November 28, 1979

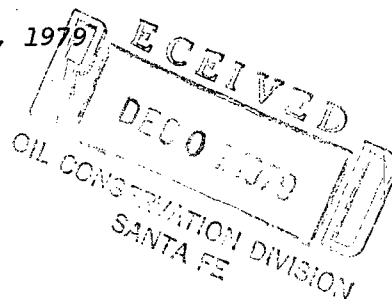

New Mexico Oil Conservation Commission
P. O. Box 2088
Santa Fe, New Mexico

Attention: Mr. Joe D. Ramey
State Petroleum Engineer
Secretary-Director

Dear Sir:

John H. Hill has filed an application for a non-standard location to be 2130' FNL and 660' FWL (NW/4) of Section 4, Township 26 North, Range 8 West in San Juan County, New Mexico. Supron Energy Corporation has no objection to this non-standard location.

If you require additional information in this matter, please contact us at the above address.

Yours very truly,

Jerry L. Lee, Engineer
Drilling and Production

JLL/mc



Southland Royalty Company

December 18, 1979

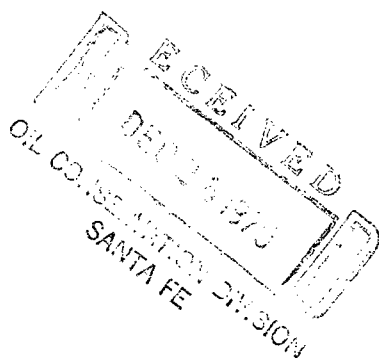

New Mexico Oil & Gas Conservation Commission
P. O. Box 2088
Santa Fe, New Mexico 87501

Attention: Mr. Joe D. Ramey

Re: Unorthodox Location
John H. Hill & Gordon L. Llewellyn
Foster #4A
SWNW Section 4, T26N, R8W
San Juan County, New Mexico

Dear Mr. Ramey:

Southland Royalty Company, as offset operator of the subject well, does not object to the unorthodox location at 2130' FNL and 660' FWL.

Yours truly,

L. O. Van Ryan
District Production Manager

LOVR/dg

El Paso EXPLORATION
COMPANY



P. O. BOX 289
FARMINGTON, NEW MEXICO 87401
PHONE 505-325-2841

December 18, 1979

NEW MEXICO OIL AND GAS CONSERVATION COMMISSION
Attention: Mr. J. D. Ramey
Post Office Box 2088
Santa Fe, New Mexico 87501

Re: Powers Elevation Request on
Application for Spacing Exception
John H. Hill & Gordon L. Llewellyn
Foster #4 A, SW NW Sec. 4, T26N, R8W
2130' FNL, & 660' FWL
San Juan County, New Mexico

Dear Mr. Ramey:

This is to advise that El Paso Exploration Company, as owner of offset acreage to the above captioned request, has no objection to the non-standard location as proposed.

Yours very truly,

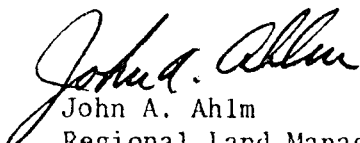
John A. Ahlm
Regional Land Manager
Exploration-Land

JAA:ld

cc: New Mexico Oil & Gas Conservation Commission-Aztec, NM
Powers Elevation