

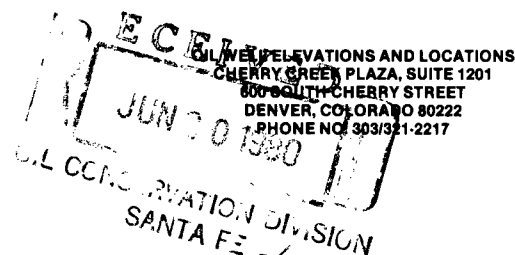

POWERS ELEVATION

NSL - 1222



June 17, 1980

New Mexico Oil and Gas Conservation Commission
Joe D. Ramey, Director
P.O. Box 2088
Santa Fe, New Mexico 87501

RE: Filing Exception to Rule 104F
Supron Energy Corporation
Hodges #17
NE SE Sec. 21 T26N R8W San Juan County, New Mexico

NSL - 1222
Rule 104F
see Form C-102
for detail
No off sets
Immediate

Dear Mr. Ramey:

Supron Energy Corporation requests an exception to Rule 104F for the above-captioned well location. Enclosed is a location and elevation plat and a topographic map.

The location was staked at the above coordinates due to extreme topographic difficulties and was observed personally by Mr. Frank Chavez with your office in Aztec, New Mexico.

Supron Energy Corporation has the operating rights on the surrounding acreages, so no other leaseholders are involved.

Should you require any additional information in order to approve this application, please call.

Thank you.

Sincerely,

Darryl Cooper

POWERS ELEVATION

Darryl Cooper

DC/ln

Enclosures

cc: (2) New Mexico Oil and Gas Commission, Aztec, New Mexico
Frances Cooper, Dallas, Texas
Haskell Fleetwood, Dallas, Texas
Rudy Motto, Farmington, New Mexico



POWERS ELEVATION

File
NSL-1222

OIL WELL ELEVATIONS AND LOCATIONS
CHERRY CREEK PLAZA, SUITE 1201
600 SOUTH CHERRY STREET
DENVER, COLORADO 80222
PHONE NO. 303/321-2217

June 16, 1980

Mr. James Sims, District Engineer
U.S. Geological Survey
P.O. Box 959
Farmington, New Mexico 87401

RE: 200' Stipulation
Supron Energy Corporation
Hodges #17
NE SE Sec. 21 T26N R8W
San Juan County, New Mexico

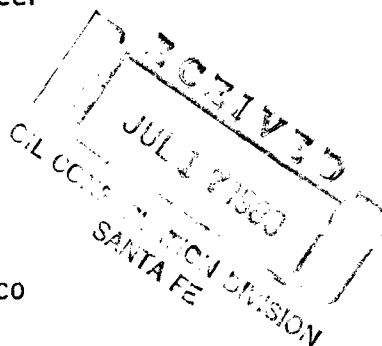

Dear Mr. Sims:

The above-captioned well location was staked at 1420' FSL & 1030' FEL and is only 100 feet from the south line of the NE $\frac{1}{4}$ SE $\frac{1}{4}$. The location was staked there due to topographic difficulties.

An exception to Rule 104F is being filed with the New Mexico Oil & Gas Conservation Commission.

Thank you.

Sincerely,

POWERS ELEVATION

Darryl Cooper
Darryl Cooper

DC/k1k

cc: (2) New Mexico Oil & Gas Conservation Commission, Aztec, New Mexico
Frances Cooper, Esperanza Energy Corporation, Dallas, Texas
Haskell Fleetwood, Supron Energy Corporation, Dallas, Texas
Rudy Motto, Supron Energy Corporation, Farmington, New Mexico



OIL CONSERVATION COMMISSION
8th DISTRICT

OIL CONSERVATION COMMISSION
BOX 2088
SANTA FE, NEW MEXICO

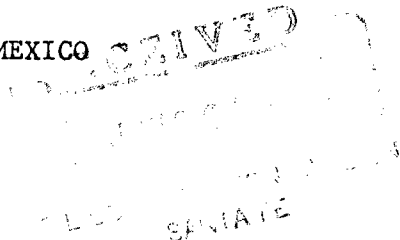

DATE June 19, 1980

RE: Proposed MC _____
Proposed DHC _____
Proposed NSL x _____
Proposed SWD _____
Proposed WFX _____
Proposed PMX _____

Gentlemen:

I have examined the application dated June 19, 1980
for the Superior Energy Corp Nudge #13 I-21-26N-EW
Operator Lease and Well No. Unit, S-T-R

and my recommendations are as follows:

Approve

Yours very truly,

Frank S. Chang

NEW MEXICO OIL CONSERVATION COMMISSION
WELL LOCATION AND ACREAGE DEDICATION PLAT

EXHIBIT "A"

Location & Elevation Plat

All distances must be from the outer boundaries of the Section

RECEIVED
JUN 17 1980
SANTA FE

Form C-102
Supersedes C-120
Effective 1-1-65

Operator Supron Energy Corporation		Lease SF-078432		Well No. Hodges #17	
Section I	Section 21	Township 26 North	Range 8 West	County Santa Fe	

Footage Location of Well: 1420 feet from the South line and 1030 feet from the East line			
Ground Level Elev. 6521	Producing Formation PICTURED CLIFFS	Pool BALLARD PICTURED CLIFFS	Dedicated Acreage 160

1. Outline the acreage dedicated to the subject well by colored pencil or hatchure marks on the plat below.
2. If more than one lease is dedicated to the well, outline each and identify the ownership thereof (both as to working interest and royalty).
3. If more than one lease of different ownership is dedicated to the well, have the interests of all owners been consolidated by communitization, unitization, force-pooling, etc?

☐ Yes ☐ No If answer is "yes," type of consolidation _____

If answer is "no," list the owners and tract descriptions which have actually been consolidated. (Use reverse side of this form if necessary.) _____

No allowable will be assigned to the well until all interests have been consolidated (by communitization, unitization, forced-pooling, or otherwise) or until a non-standard unit, eliminating such interests, has been approved by the Commission.

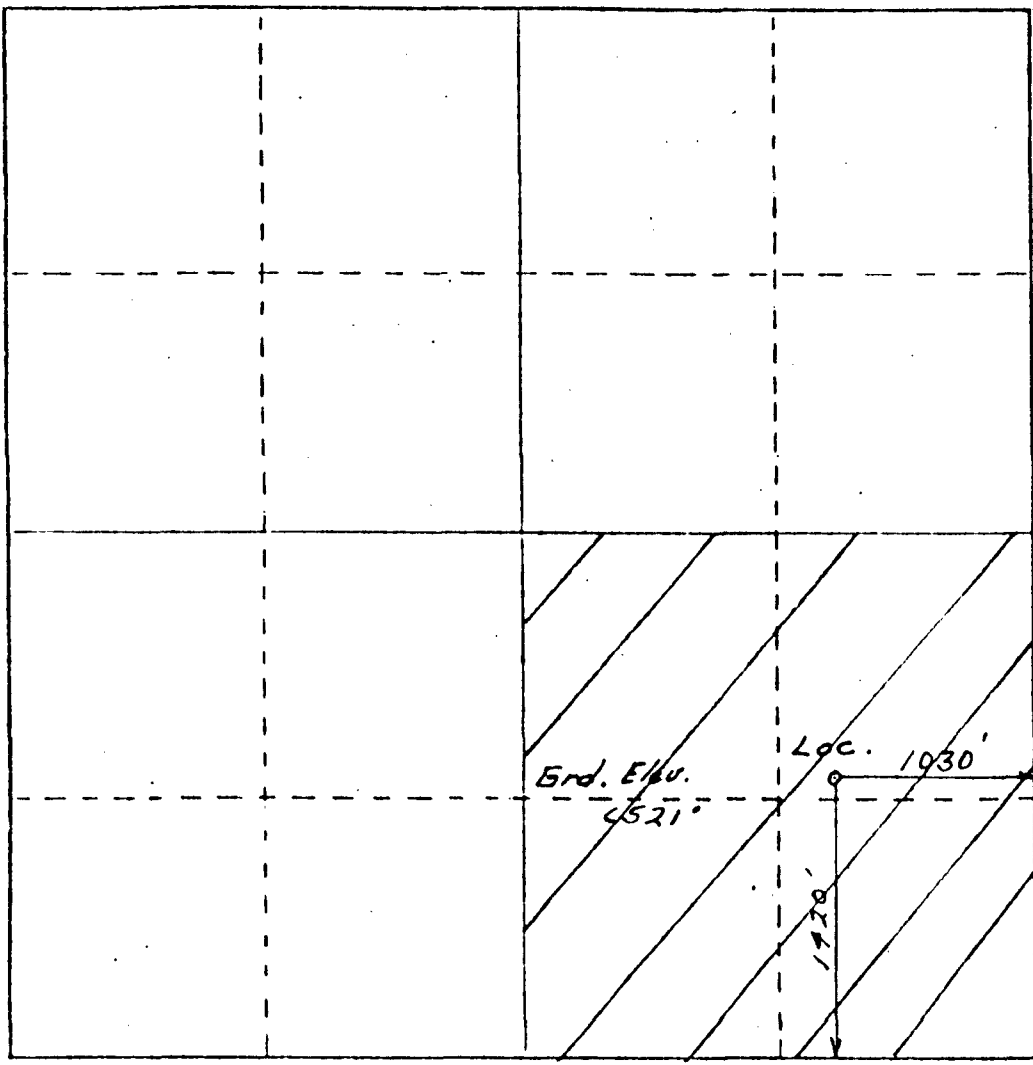

CERTIFICATION	
I hereby certify that the information contained herein is true and complete to the best of my knowledge and belief.	
<i>George Lapaseotes</i>	
Name	George Lapaseotes
Position	V. President Powers Elevation
Company	Supron Energy Corporation
Date	May 15, 1980
I hereby certify that the well location shown on this plat was plotted from field notes of actual surveys made by me or under my supervision, and that the same is true and correct to the best of my knowledge and belief.	
Date Surveyed	6844
Responsible Professional Engineer and/or Land Surveyor	<i>Gerald G. Nuddleston</i>
Certificate No.	6844

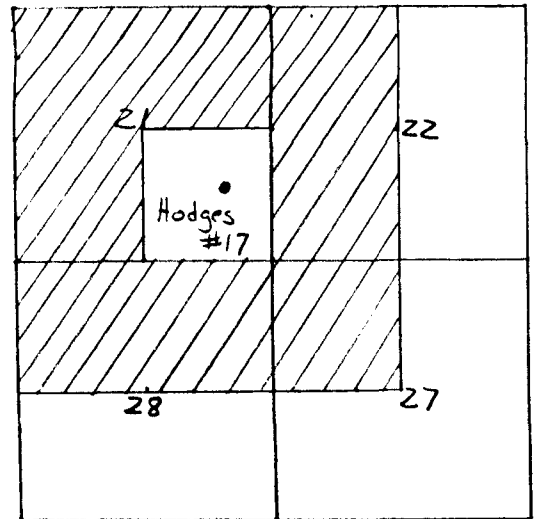

- Supron Energy Corporation

STATES
THE INTERIOR
SURVEY

BLANCO 1" MI
3m. E. 8 W

70,000 FEET (CENTRAL)

407

R. W. (GOULD PASS) R. 7 W

20 MI (10 N ME 12

