



**PHILLIPS PETROLEUM COMPANY**

ODESSA, TEXAS 79762  
4001 PENBROOK

NATURAL RESOURCES GROUP  
Exploration and Production

July 8, 1980

Unorthodox Locations--

East Vacuum Grayburg-San Andres Unit,  
Vacuum Grayburg-San Andres Pool,  
Lea County, New Mexico

Oil Conservation Division (3)  
The New Mexico Dept. of Energy and Minerals  
P. O. Box 2088  
Santa Fe, New Mexico 87501

Attention: Mr. Joe D. Ramey  
Division Director

Gentlemen:

We respectfully request administrative approval of the unorthodox locations of the below listed wells. Administrative approval is provided by Order No. R-5897, Section 4, Rule 8. All contiguous proration units are within the interior of the subject waterflood unit, or the well is farther than 330 feet from the waterflood unit boundary. Therefore, waiver of the waiting period and immediate action is requested. Individual well proration plats and a unit plat are attached.

Tract 2913--Well No. 010...Unit J,  
2320' from South and 2450' from East Lines, Section 29, T-17-S, R-35-E

Tract 2738, Well No. 009...Unit E,  
1400' from North and 50' from West Lines, Section 27, T-17-S, R-35-E

Tract 2622, Well No. 006...Unit F,  
1500' from North and 2450' from West Lines, Section 26, T-17-S, R-35-E

Your early consideration and advice will be appreciated.

Yours very truly,

T. Harold McLemore  
Area Regulation and Proration Analyst

THM:skm  
Attachments

cc: Oil Conservation Division--Hobbs

Attachments



*NSL-1236  
Rule 8 5897  
Immediate*

**NEW MEXICO OIL CONSERVATION COMMISSION  
WELL LOCATION AND ACREAGE DEDICATION PLAT**

All distances must be from the outer boundaries of the Section

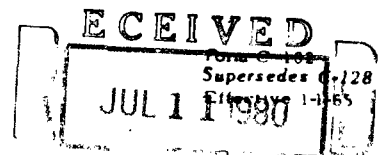

Operator <b>Phillips Petroleum Co.</b>			Lease <b>EVGSAU Tract 2913</b>			OIL CONSERVATION DIVISION <b>SANTA FE 010</b>	
Unit Letter <b>J</b>	Section <b>29</b>	Township <b>17 South</b>	Range <b>35 East</b>	County <b>Lea</b>			
Actual Footage Location of Well: <b>2320</b> feet from the <b>South</b> line and <b>2450</b> feet from the <b>East</b> line							
Ground Level Elev. <b>3972.1</b>	Producing Formation <b>Grayburg/San Andres</b>		Pool <b>Vacuum Gb/San Andres</b>	Dedicated Acreage: <b>40</b> Acres			

- (unprepared)
- Outline the acreage dedicated to the subject well by colored pencil or hatchure marks on the plat below.
  - If more than one lease is dedicated to the well, outline each and identify the ownership thereof (both as to working interest and royalty).
  - If more than one lease of different ownership is dedicated to the well, have the interests of all owners been consolidated by communitization, unitization, force-pooling, etc?

☐ Yes ☐ No If answer is "yes," type of consolidation \_\_\_\_\_

If answer is "no," list the owners and tract descriptions which have actually been consolidated. (Use reverse side of this form if necessary.) \_\_\_\_\_

No allowable will be assigned to the well until all interests have been consolidated (by communitization, unitization, forced-pooling, or otherwise) or until a non-standard unit, eliminating such interests, has been approved by the Commission.

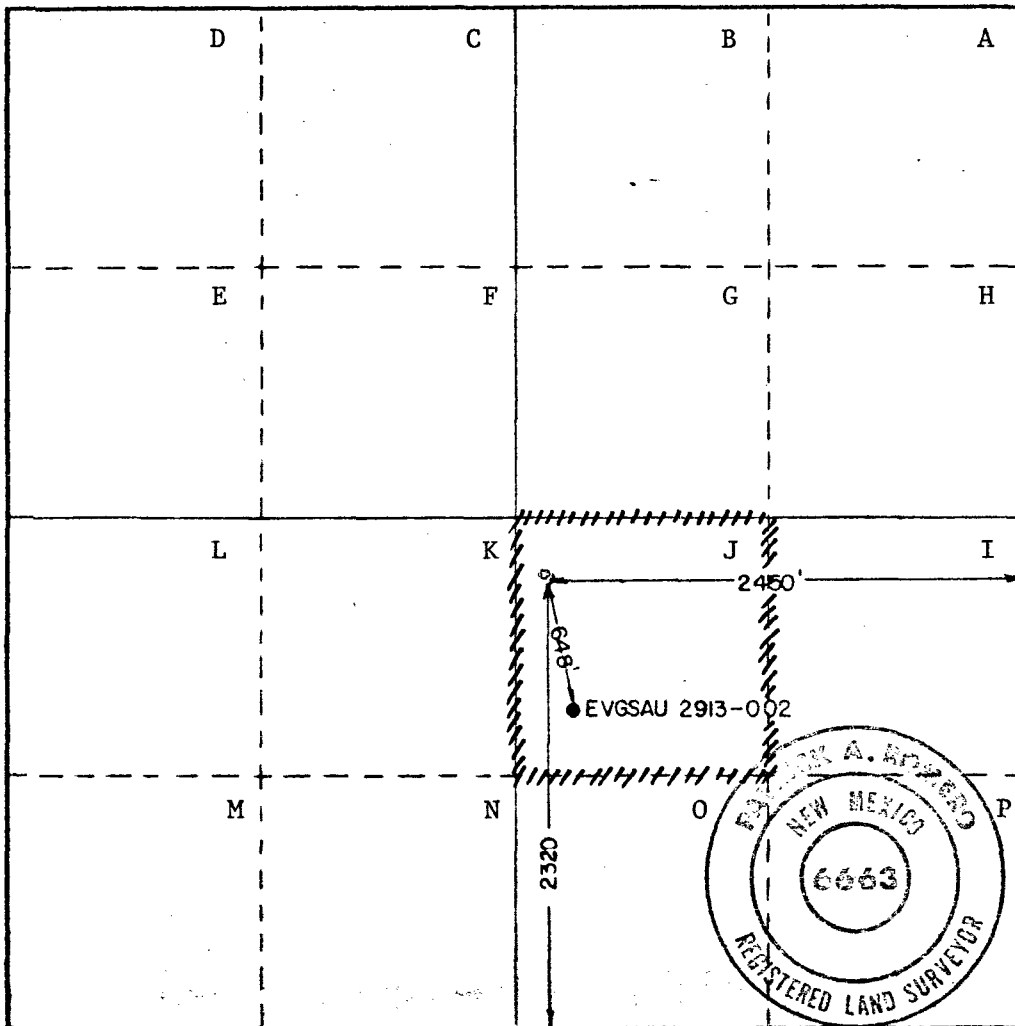

**CERTIFICATION**

I hereby certify that the information contained herein is true and complete to the best of my knowledge and belief.

Name  
**W. J. Mueller**

Position  
**Sr. Engineering Specialist**

Company  
**Phillips Petroleum Company**

Date  
**July 9, 1980**

I hereby certify that the well location shown on this plat was plotted from field notes of actual surveys made by me or under my supervision, and that the same is true and correct to the best of my knowledge and belief.

Date Surveyed  
**June 25, 1980**

Registered Professional Engineer and/or Land Surveyor  
**Patrick A. Romero**

Certificate No. **JOHN E. WEST 878**  
**PATRICK A. ROMERO 6663**  
**Ronald J. Eidson 3239**

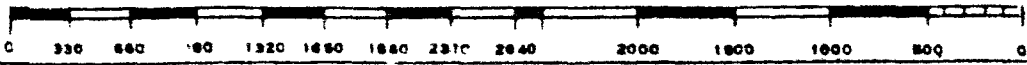

**NEW MEXICO OIL CONSERVATION COMMISSION  
WELL LOCATION AND ACREAGE DEDICATION PLAT**

**RECEIVED**  
Form C-102  
Supersedes C-128  
Effective 1-1-65  
**JUL 11 1980**

All distances must be from the outer boundaries of the Section.

Operator <b>Phillips Petroleum Company</b>			Lease <b>E.V.G.S.A.U. Tract 2738</b>		Well No. <b>009</b>
Unit Letter <b>E</b>	Section <b>27</b>	Township <b>17 South</b>	Range <b>35 East</b>	County <b>Lea</b>	<b>SANTA FE</b>
Actual Footage Location of Well: <b>1400</b> feet from the <b>North</b> line and <b>50</b> feet from the <b>West</b> line					
Ground Level Elev. <b>3944.7</b> (unprepared)	Producing Formation <b>Grayburg/San Andres</b>		Pool <b>Vacuum Gb/San Andres</b>	Dedicated Acreage: <b>40</b> Acres	

1. Outline the acreage dedicated to the subject well by colored pencil or hachure marks on the plat below.
2. If more than one lease is dedicated to the well, outline each and identify the ownership thereof (both as to working interest and royalty).
3. If more than one lease of different ownership is dedicated to the well, have the interests of all owners been consolidated by communitization, unitization, force-pooling, etc?

☐ Yes    ☐ No    If answer is "yes," type of consolidation \_\_\_\_\_

If answer is "no," list the owners and tract descriptions which have actually been consolidated. (Use reverse side of this form if necessary.) \_\_\_\_\_

No allowable will be assigned to the well until all interests have been consolidated (by communitization, unitization, forced-pooling, or otherwise) or until a non-standard unit, eliminating such interests, has been approved by the Commission.

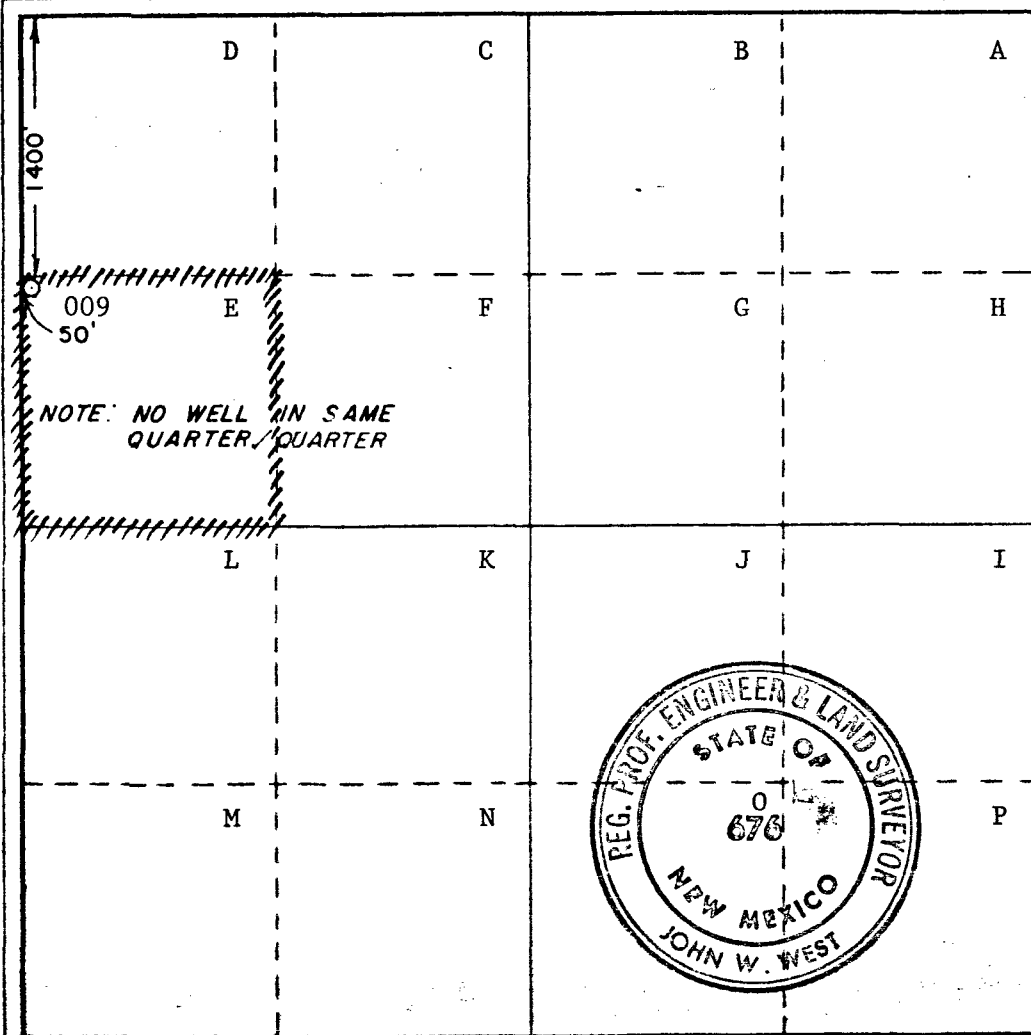

**CERTIFICATION**

I hereby certify that the information contained herein is true and complete to the best of my knowledge and belief.

Name  
**W. J. Mueller**  
Position  
**Sr. Engineering Specialist**  
Company  
**Phillips Petroleum Company**  
Date

I hereby certify that the well location shown on this plat was plotted from field notes of actual surveys made by me or under my supervision, and that the same is true and correct to the best of my knowledge and belief.

Date Surveyed  
**June 20, 1980**  
Registered Professional Engineer and/or Land Surveyor  
**John W. West**  
Certificate No. **JOHN W. WEST 676**  
**PATRICK A. ROMERO 6665**  
**Ronald J. Eidson 3239**

**NEW MEXICO OIL CONSERVATION COMMISSION  
WELL LOCATION AND ACREAGE DEDICATION PLAT**

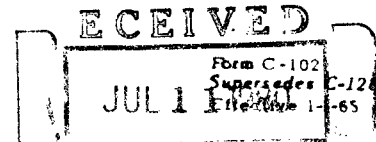

All distances must be from the outer boundaries of the Section.

Operator <b>Phillips Petroleum Co.</b>			Lease <b>EVGSAU</b>		Tract 2622	OIL CONSERVATION DIVISION WELL NO. <b>SANTA FE 006</b>
Unit Letter <b>F</b>	Section <b>26</b>	Township <b>17 South</b>	Range <b>35 East</b>	County <b>Lea</b>		
Actual Footage Location of Well: <b>1500</b> feet from the <b>North</b> line and <b>2450</b> feet from the <b>West</b> line						
Ground Level Elev. <b>3906.6</b>	Producing Formation <b>Grayburg/San Andres</b>		Pool <b>Vacuum Gb/San Andres</b>		Dedicated Acreage: <b>40</b> Acres	

- (unprepared)
1. Outline the acreage dedicated to the subject well by colored pencil or hatchure marks on the plat below.
  2. If more than one lease is dedicated to the well, outline each and identify the ownership thereof (both as to working interest and royalty).
  3. If more than one lease of different ownership is dedicated to the well, have the interests of all owners been consolidated by communitization, unitization, force-pooling, etc?

☐ Yes ☐ No If answer is "yes," type of consolidation \_\_\_\_\_

If answer is "no," list the owners and tract descriptions which have actually been consolidated. (Use reverse side of this form if necessary.) \_\_\_\_\_

No allowable will be assigned to the well until all interests have been consolidated (by communitization, unitization, forced-pooling, or otherwise) or until a non-standard unit, eliminating such interests, has been approved by the Commission.

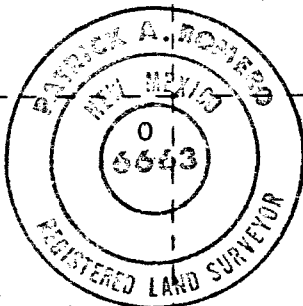
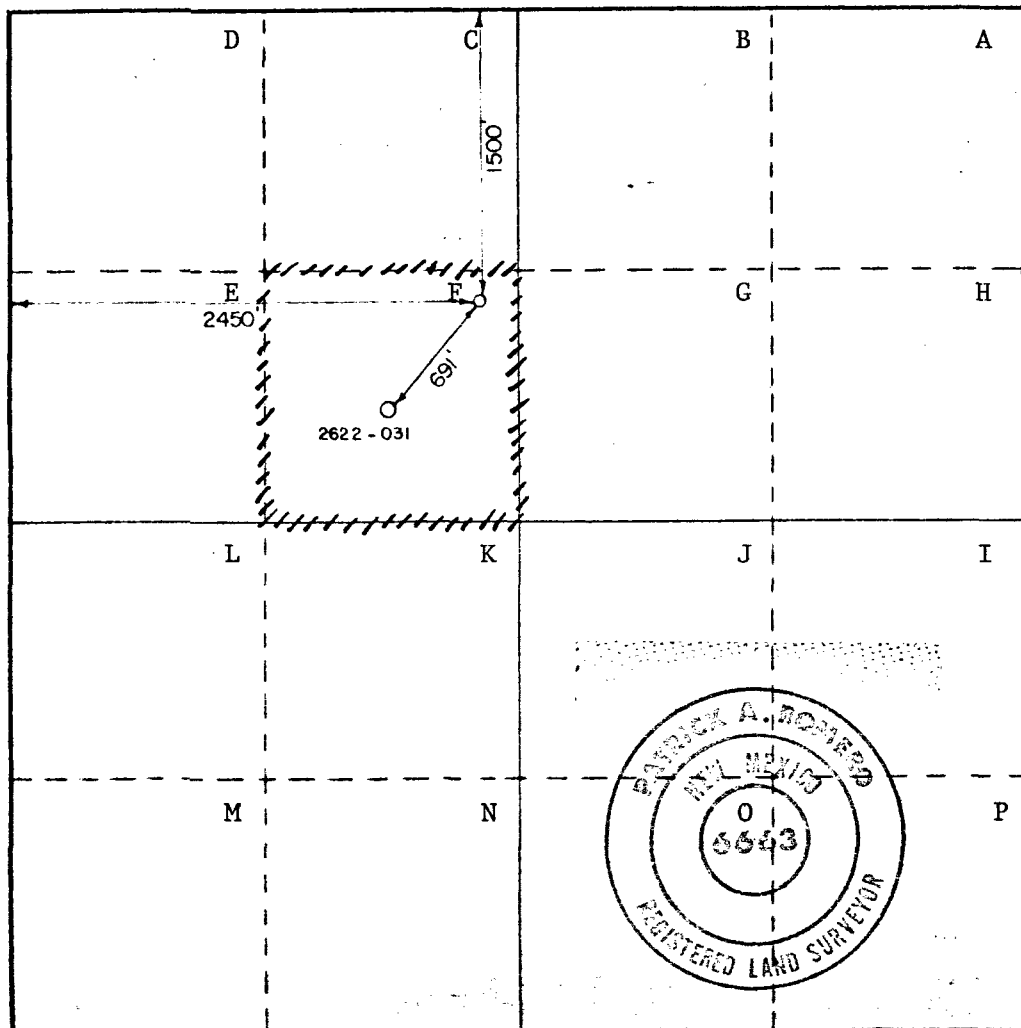

**CERTIFICATION**

I hereby certify that the information contained herein is true and complete to the best of my knowledge and belief.

*[Signature]*  
Name

**W. J. Mueller**

Position

**Sr. Engineering Specialist**

Company

**Phillips Petroleum Company**

Date

**July 9, 1980**

I hereby certify that the well location shown on this plat was plotted from field notes of actual surveys made by me or under my supervision, and that the same is true and correct to the best of my knowledge and belief.

Date Surveyed

**6-20-1980**

Registered Professional Engineer and/or Land Surveyor.

*[Signature]*  
Certificate No. **JOHN W. WEST 678**  
**PATRICK A. ROMERO 6643**  
**Ronald J. Eldson 3239**

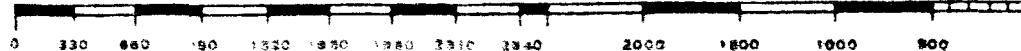

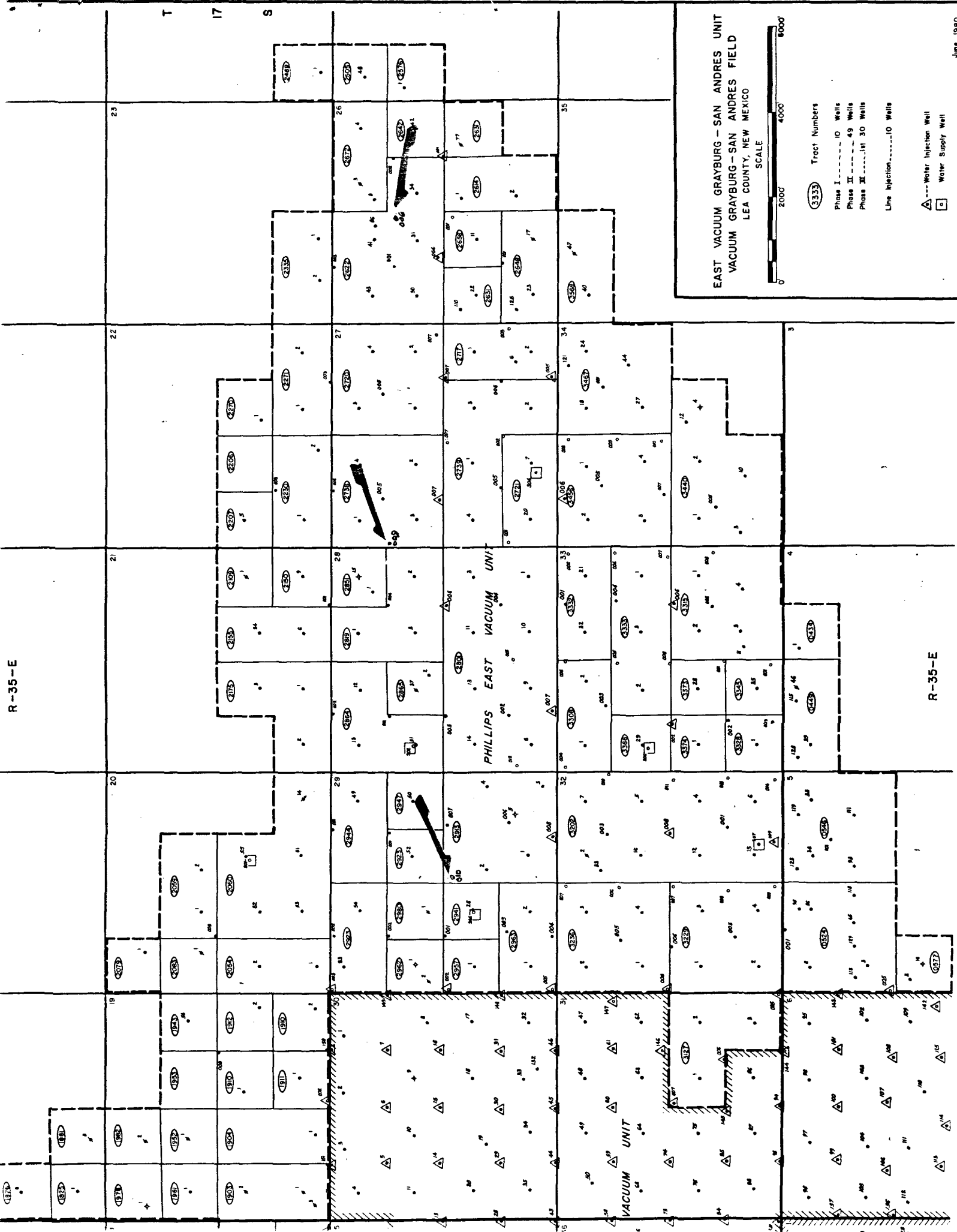

EAST VACUUM GRAYBURG-SAN ANDRES UNIT  
VACUUM GRAYBURG-SAN ANDRES FIELD  
LEA COUNTY, NEW MEXICO



- Tract Numbers  
Phase I ----- 10 Wells  
Phase II ----- 49 Wells  
Phase III ----- 30 Wells  
Line Injection ----- 10 Wells
- Water Injection Well  
Water Supply Well