



NSL-1252

Amoco Production Company

Post Office Box 68
Hobbs, New Mexico 88240

S. J. Okerson
District Superintendent

August 1, 1980

File: SJO-986.51 x WF-989

Re: Request for Administrative Approval
Unorthodox Location
State "IM" Com Well No. 1
Eddy County, New Mexico

NSL-1252
Rule 104F
See Form C-102 for Pool
8-31-80

The State of New Mexico
Energy and Minerals Department
Oil Conservation Division
P. O. Box 2088
Santa Fe, NM 87501

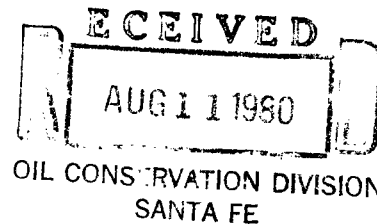

Gentlemen:

Amoco Production Company requests administrative approval of an unorthodox location due to topographical reasons on our State "IM" Com Well No. 1 located 1880' FSL and 660' FEL, Section 16, T-22-S, R-26-E, Eddy County, New Mexico. The subject well location was moved 100' south to an unorthodox location due to a steep grade, of 45° or more, 50' north of the nearest orthodox location of 1980' FSL x 660' FEL. We could not move the location north to an orthodox location due to the severity of the slope. Attached is a plat, a map and certified mail receipts from letters to the offset operators.

Yours very truly,

S. J. Okerson

cc: E. D. Newman
Houston, TX

J. C. Allen
Houston, TX

NMOCD
Artesia, NM

**NEW MEXICO OIL CONSERVATION COMMISSION
WELL LOCATION AND ACREAGE DEDICATION PLAT**

Form C-102
Supersedes C-128
Effective 1-1-65

All distances must be from the outer boundaries of the Section

Operator AMOCO Production Co.			Lease State IM		Well No. 1
Unit Letter I	Section 16	Township 22 South	Range 26 East	County Eddy	
Actual Footage Location of Well: 1880 feet from the South line and 660 feet from the East line.					
Ground Level Elev. 3580.2	Producing Formation Morrow	Pool Und. Happy Valley Morrow		Dedicated Acreage 320	Acres

1. Outline the acreage dedicated to the subject well by colored pencil or hatchure marks on the plat below.
2. If more than one lease is dedicated to the well, outline each and identify the ownership thereof (both as to working interest and royalty).
3. If more than one lease of different ownership is dedicated to the well, have the interests of all owners been consolidated by communitization, unitization, force-pooling, etc?

☐ Yes ☐ No If answer is "yes," type of consolidation Communitization

If answer is "no," list the owners and tract descriptions which have actually been consolidated. (Use reverse side of this form if necessary.) _____

No allowable will be assigned to the well until all interests have been consolidated (by communitization, unitization, forced-pooling, or otherwise) or until a non-standard unit, eliminating such interests, has been approved by the Commission.

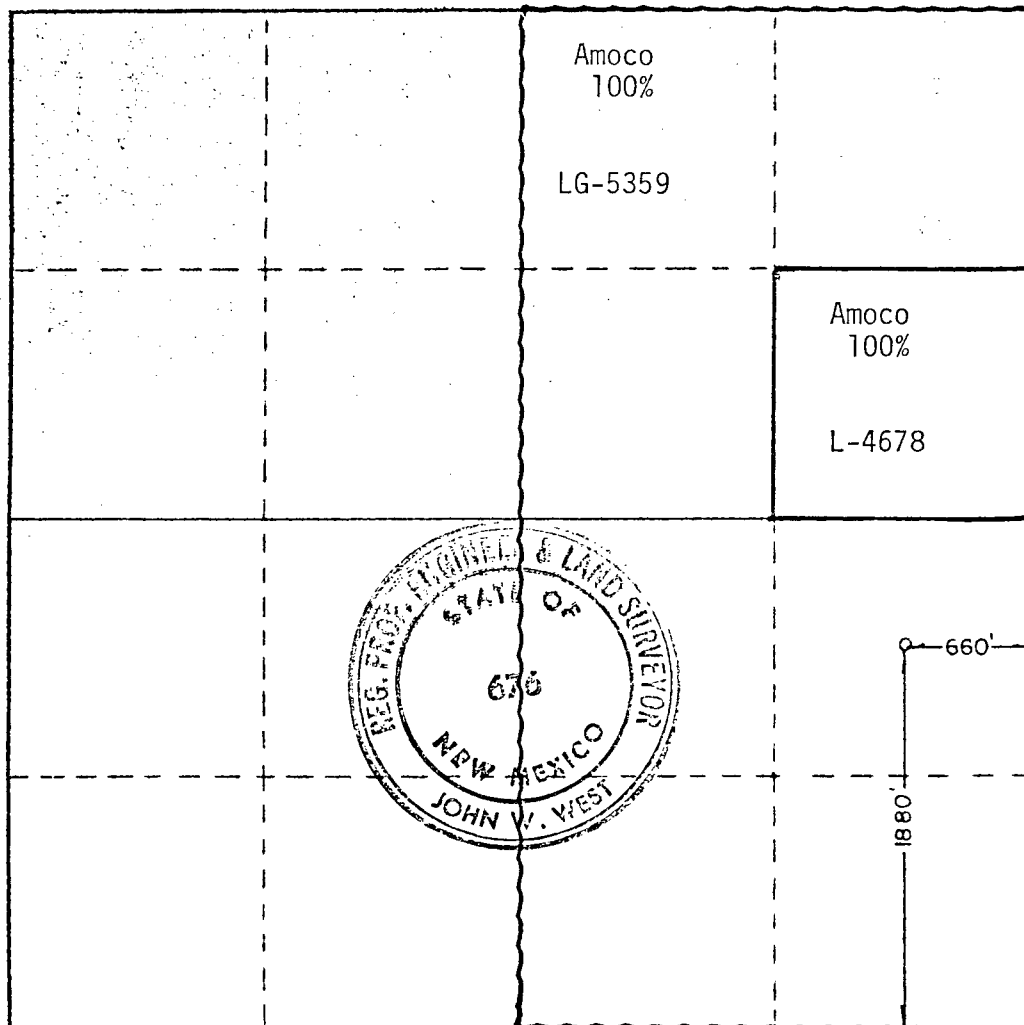

CERTIFICATION

I hereby certify that the information contained herein is true and complete to the best of my knowledge and belief.

Name Bob Davis
 Position Admin. Analyst
 Company Amoco Production Company
 Date 7-31-80

I hereby certify that the well location shown on this plat was plotted from field notes of actual surveys made by me or under my supervision, and that the same is true and correct to the best of my knowledge and belief.

Date Surveyed July 16, 1980
 Registered Professional Engineer and/or Land Surveyor

John W. West
 Certificate No. JOHN W. WEST 676
PATRICK A. ROMERO 6663
Ronald J. Eidson 3239

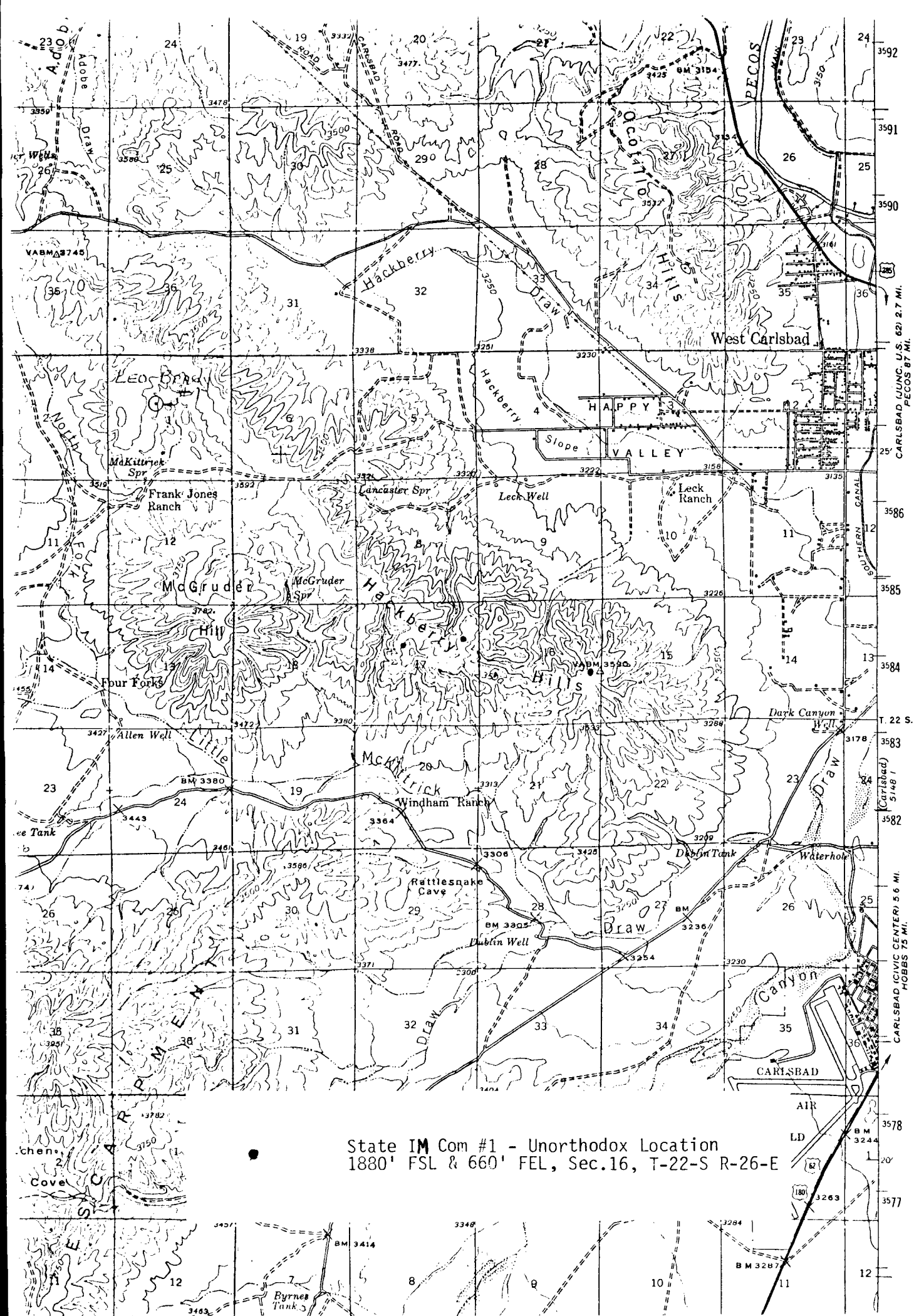

CAR

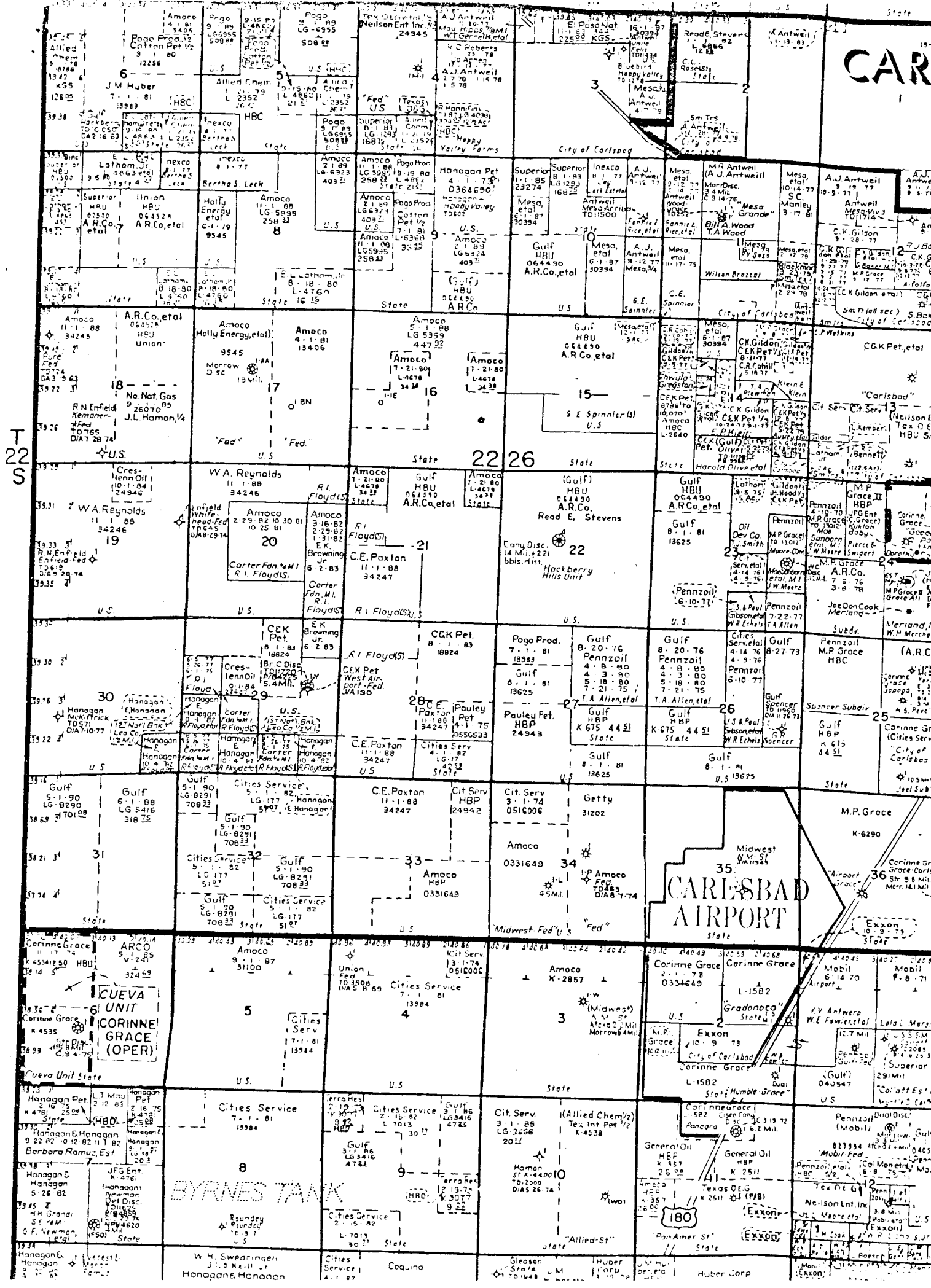

P08 3839553

RECEIPT FOR CERTIFIED MAIL

NO INSURANCE COVERAGE PROVIDED—
NOT FOR INTERNATIONAL MAIL
(See Reverse)

PS Form 3800, Apr. 1976

SENT TO STREET AND NO. P.O. BOX 670 HOBBS, NM 88240		GULF OIL CORP.	
POSTAGE		CERTIFIED FEE	\$.28
		SPECIAL DELIVERY	\$.80
		RESTRICTED DELIVERY	
		RETURN RECEIPT SERVICE	\$.45
		SHOW TO WHOM AND DATE DELIVERED	
		SHOW TO WHOM AND DATE AND ADDRESS OF DELIVERY	
		SHOW TO WHOM AND DATE DELIVERED WITH RESTRICTED DELIVERY	
		SHOW TO WHOM AND DATE AND ADDRESS OF DELIVERY WITH RESTRICTED DELIVERY	
TOTAL POSTAGE AND FEES			\$ 1.53
POSTMARK OR DATE			



P08 3839553

RECEIPT FOR CERTIFIED MAIL

NO INSURANCE COVERAGE PROVIDED—
NOT FOR INTERNATIONAL MAIL
(See Reverse)

PS Form 3800, Apr. 1976

SENT TO STREET AND NO. P.O. BOX 2504 HOUSTON, TEXAS 77001		POGO PRODUCING CO.	
POSTAGE		CERTIFIED FEE	\$.28
		SPECIAL DELIVERY	\$.80
		RESTRICTED DELIVERY	
		RETURN RECEIPT SERVICE	\$.45
		SHOW TO WHOM AND DATE DELIVERED	
		SHOW TO WHOM AND DATE AND ADDRESS OF DELIVERY	
		SHOW TO WHOM AND DATE DELIVERED WITH RESTRICTED DELIVERY	
		SHOW TO WHOM AND DATE AND ADDRESS OF DELIVERY WITH RESTRICTED DELIVERY	
TOTAL POSTAGE AND FEES			\$ 1.53
POSTMARK OR DATE			

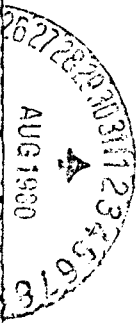



Amoco Production Company

Post Office Box 68
Hobbs, New Mexico 88240

S. J. Okerson
District Superintendent

August 1, 1980

File: SJ0-986.51 x WF-976

Re: Waivers Consent
Unorthodox Location
State "IM" Com Well No. 1
Eddy County, New Mexico

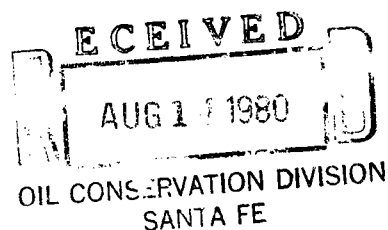

Pogo Producing Company
P. O. Box 2504
Houston, TX 77001

Gentlemen:

We are requesting your approval, as an offset operator, for the unorthodox location of our State "IM" Com Well No. 1. Subject well is located 1880' FSL and 660' FEL, Section 16, T-22-S, R-26-E, Eddy County, New Mexico. The subject well location was moved 100' south to an unorthodox location due to a steep grade, of 45° or more, 50' north of the closest orthodox location. We could not move the location north to an orthodox location due to the severity of the slope. We request that you approve and return a signed copy of this letter to this office and one to the NMOCD in Santa Fe. Self-addressed envelopes are enclosed.

Yours very truly,

ORIGINAL SIGNED BY S. J. OKERSON

cc: E. D. Newman
Houston, TX

NMOCD
Santa Fe, NM

Approved: *E. D. Newman*

By: *W. T. Harlow*

Date: *8-7-80*