

NSL - 1296

|||  
dp  
|||

# dugan production corp.

December 3, 1980

NSL - 1296  
Rule 3 R-1676  
See page 3 for detail  
12-25-80

Joe D. Ramey  
Division Director  
New Mexico Oil Conservation Division  
P. O. Box 2088  
Santa Fe, NM 87501

Re: Application for Administrative Approval of  
Unorthodox Location for Pioneer Production Corporation's  
Farmington B #1E Well located SW/4 SE/4 Sec 15 T29N R13W,  
San Juan County, NM

Dear Mr. Ramey:

Enclosed please find three copies of the Application for Administrative Approval of the Unorthodox Location for the above-referenced well, which application includes a plat showing the ownership of all leases offsetting this spacing unit for which the unorthodox location is sought, and all wells completed thereon, and a plat showing the existent topographical conditions of the well location. Also enclosed are copies of the dedicated acreage plat.

Copies of this application are being submitted to all offsetting operators by certified mail with a request that they furnish your office with a waiver of objection.

Please advise if you need further information.

Sincerely,

*Jerome P. McHugh Jr.*

Jerome P. McHugh Jr.  
Agent for Applicant

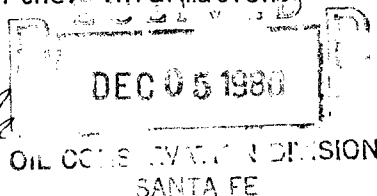

fp

Enclosures

Joe D. Ramey  
December 3, 1980  
Page 2

Pioneer Production Corp.  
Farmington B #1E

xc: Frank Chavez  
New Mexico Oil Conservation Division  
1000 Rio Brazos Road  
Aztec, NM 87410

James Sims  
U.S. Geological Survey  
P O Box 959  
Farmington, NM 87401

Amoco Production Company  
501 Airport Drive  
Farmington, NM 87401

APPLICATION FOR ADMINISTRATIVE APPROVAL  
OF UNORTHODOX LOCATION

DEC 22 1980  
OIL CONSERVATION DIVISION  
SANTA FE

Applicant:

Pioneer Production Corp.  
P O Box 208  
Farmington, NM 87041

Name of Well:

Farmington B #1E

Land Dedicated to the Well:

T29N, R13W, NMPM  
Section 15 SE/4  
San Juan County, NM

Proposed Unorthodox Location:

T29N, R13W, NMPM  
Sec 15 655' FSL - 1725' FEL  
Unit Letter O  
San Juan County, NM

Reason for Unorthodox Location:

Located within light industrial zone  
in Farmington, NM city limits. No  
standard location available because  
of man-made structures in the area.  
See Exhibit "D" attached hereto and  
incorporated herein (Zoning plat)

Offsetting Leases and Operators  
and Well Completions:

See Exhibit "A" attached hereto and  
incorporated herein by reference.

Existent Topographical Conditions:

See Exhibit "B" attached hereto and  
incorporated herein by reference.

New Mexico Oil Conservation Division  
Rule Authorizing Application:

Rule 104F

See Exhibit "C" (Surveyor's Plat) attached hereto and incorporated herein.

BY:

Thomas A. Dugan, Agent

Waiver:

Amoco Production Co. hereby acknowledges receipt of the  
Application for Administrative Approval of Unorthodox Location filed by  
Pioneer Production Corp. herein and hereby waives objection to  
Pioneer Production Corp. Application for Administrative  
Approval of Unorthodox Location for their Farmington B #1E  
Well as proposed herein.

BY:

William D. Pierce

DATE:

12-19-80

OIL CONSERVATION COMMISSION  
Alto DISTRICT

OIL CONSERVATION COMMISSION  
BOX 2088  
SANTA FE, NEW MEXICO

DATE Dec. 9, 1980

RE: Proposed MC \_\_\_\_\_  
Proposed DHC \_\_\_\_\_  
Proposed NSL α \_\_\_\_\_  
Proposed SWD \_\_\_\_\_  
Proposed WFX \_\_\_\_\_  
Proposed PMX \_\_\_\_\_

Gentlemen:

I have examined the application dated Dec. 5, 1980  
for the Pioneer Prod. Corp. Farmington B#1E 0-15-29N-13W  
Operator Lease and Well No. Unit, S-T-R

and my recommendations are as follows:

Approve  
\_\_\_\_\_  
\_\_\_\_\_  
\_\_\_\_\_  
\_\_\_\_\_  
\_\_\_\_\_

Yours very truly,

Frank J. Chang

APPLICATION FOR ADMINISTRATIVE APPROVAL  
OF UNORTHODOX LOCATION

DEC 05 1987

Applicant:

OIL & GAS DIVISION  
SANTA FE

Pioneer Production Corp.  
P O Box 208  
Farmington, NM 87041

Name of Well:

Farmington B #1E

Land Dedicated to the Well:

T29N, R13W, NMPM  
Section 15 ~~SE/4~~ E/2  
San Juan County, NM

*Basin Dakota*

Proposed Unorthodox Location:

T29N, R13W, NMPM  
Sec 15 655' FSL - 1725' FEL  
Unit Letter O  
San Juan County, NM

Reason for Unorthodox Location:

Located within light industrial zone  
in Farmington, NM city limits. No  
standard location available because  
of man-made structures in the area.  
See Exhibit "D" attached hereto and  
incorporated herein (Zoning plat)

Offsetting Leases and Operators  
and Well Completions:

See Exhibit "A" attached hereto and  
incorporated herein by reference.

Existent Topographical Conditions:

See Exhibit "B" attached hereto and  
incorporated herein by reference.

New Mexico Oil Conservation Division  
Rule Authorizing Application:

Rule 104F

See Exhibit "C" (Surveyor's Plat) attached hereto and incorporated herein.

BY:

*Thomas A. Dugan*  
Thomas A. Dugan, Agent

Waiver:

\_\_\_\_\_ hereby acknowledges receipt of the  
Application for Administrative Approval of Unorthodox Location filed by  
Pioneer Production Corp. \_\_\_\_\_ herein and hereby waives objection to  
Pioneer Production Corp. Application for Administrative  
Approval of Unorthodox Location for their Farmington B #1E  
Well as proposed herein.

BY: \_\_\_\_\_

DATE: \_\_\_\_\_

EXHIBIT "A"

PIONEER PRODUCTION CORP.  
Farmington B #1E

1. Amoco Production Co.  
501 Airport Drive  
Farmington, NM 87401  
T29N R13W Sec 22 E/2, W/2  
T29N R13W Sec 23 N/2

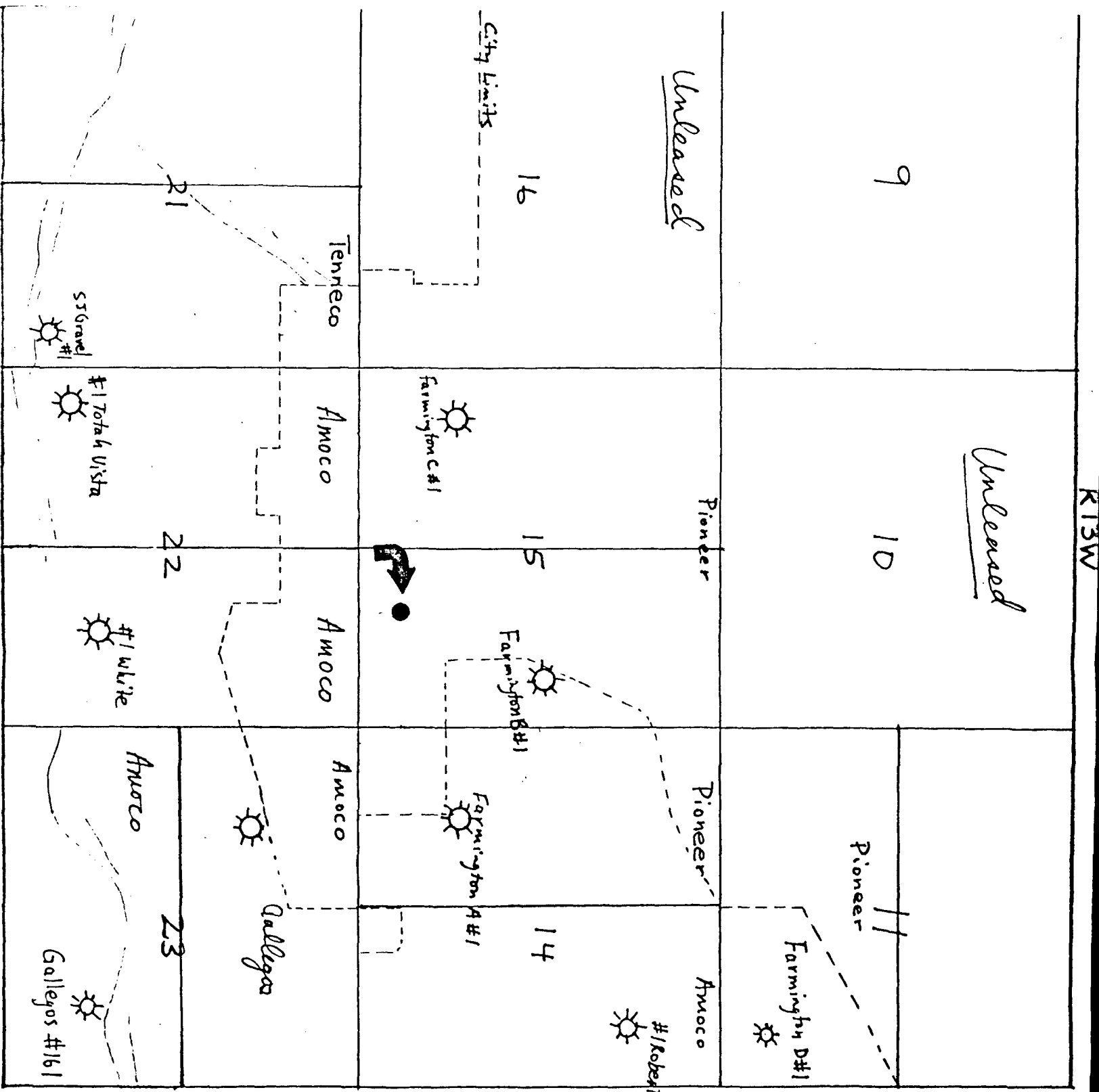
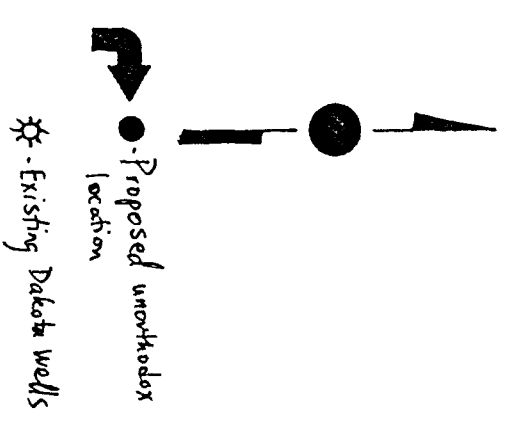

T 29 N

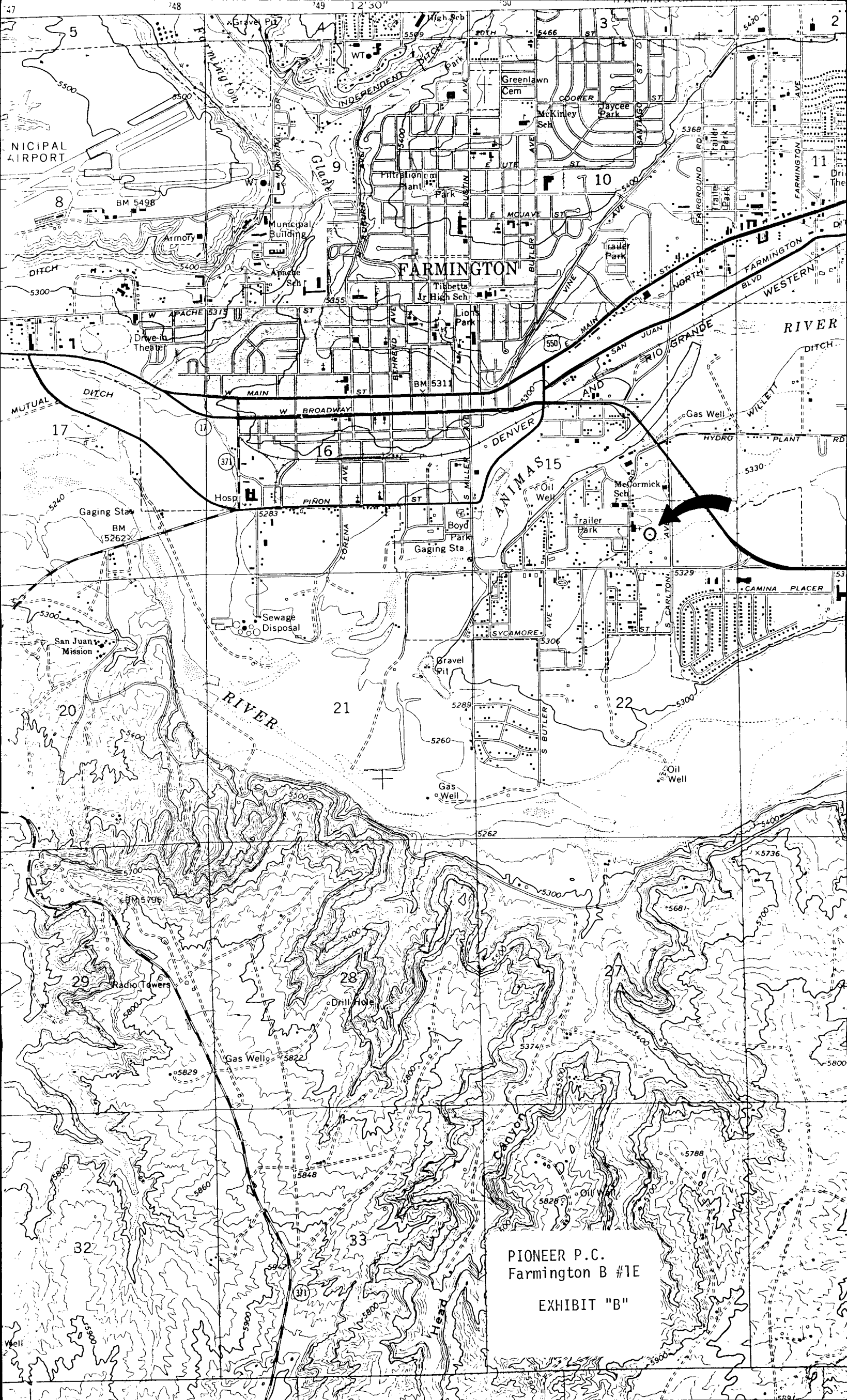

PIONEER P.C.  
Farmington B #1E

EXHIBIT "B"

**NEW MEXICO OIL CONSERVATION COMMISSION  
WELL LOCATION AND ACREAGE DEDICATION PLAT**

Form C-102  
Supersedes C-128  
Effective 1-1-65

All distances must be from the outer boundaries of the Section.

Operator <b>Pioneer Production Corp.</b>			Lease <b>Farmington B</b>		Well No. <b>#1E</b>
Unit Letter <b>0</b>	Section <b>15</b>	Township <b>29 North</b>	Range <b>13 West</b>	County <b>San Juan</b>	
Actual Footage Location of Well: <div style="display: flex; justify-content: space-between;"> <span><b>655</b> feet from the <b>South</b> line and</span> <span><b>1725</b> feet from the <b>East</b> line</span> </div>					
Ground Level Elev. <b>5321'</b>	Producing Formation <b>Dakota</b>	Pool	Dedicated Acreage: <b>160</b> Acres		

1. Outline the acreage dedicated to the subject well by colored pencil or hachure marks on the plat below.
2. If more than one lease is dedicated to the well, outline each and identify the ownership thereof (both as to working interest and royalty).
3. If more than one lease of different ownership is dedicated to the well, have the interests of all owners been consolidated by communitization, unitization, force-pooling, etc?

☐ Yes    ☐ No    If answer is "yes," type of consolidation \_\_\_\_\_

If answer is "no," list the owners and tract descriptions which have actually been consolidated. (Use reverse side of this form if necessary.) \_\_\_\_\_

No allowable will be assigned to the well until all interests have been consolidated (by communitization, unitization, forced-pooling, or otherwise) or until a non-standard unit, eliminating such interests, has been approved by the Commission.

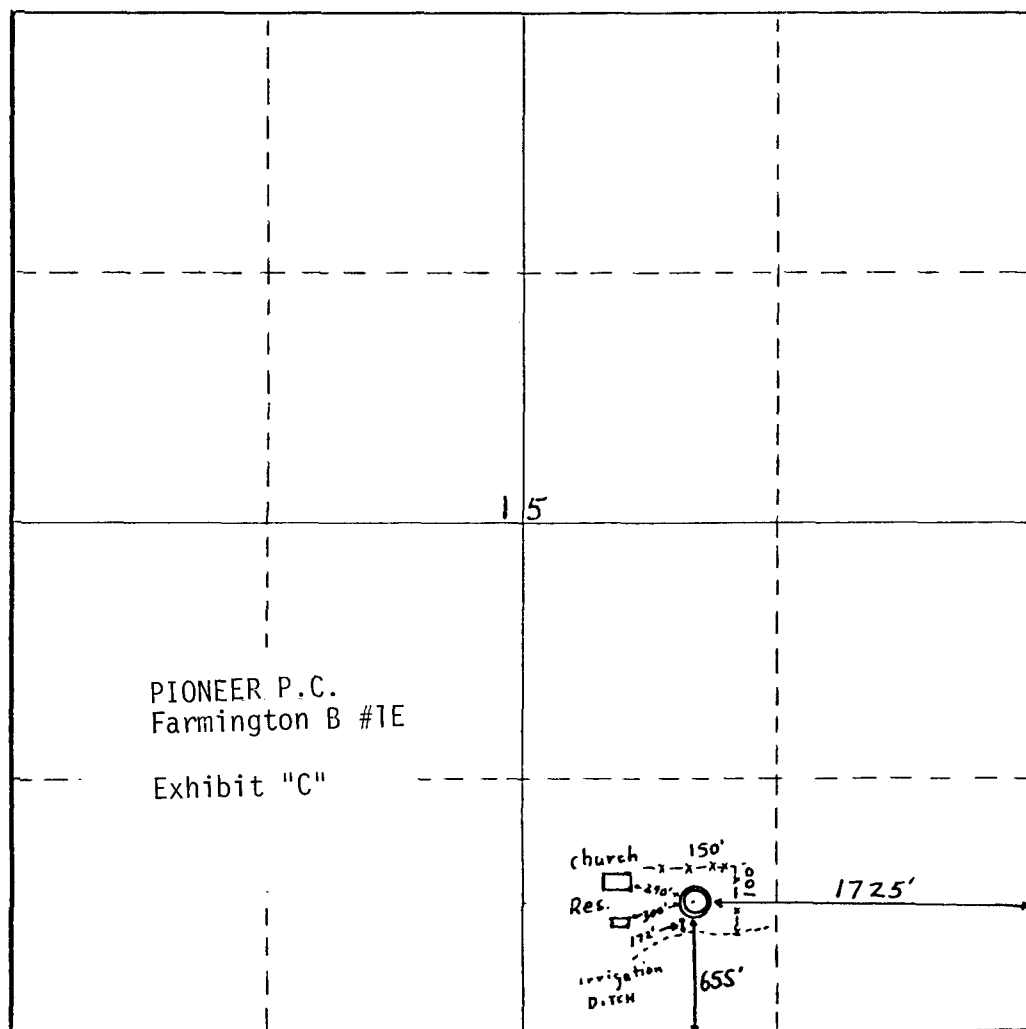

**CERTIFICATION**

I hereby certify that the information contained herein is true and complete to the best of my knowledge and belief.

*Jerome P. McHugh Jr.*  
Name

**Jerome P. McHugh Jr.**

Position  
**Landman**

Company  
**Dugan Production Corp.**

Date  
**12-2-80**

I hereby certify that the well location shown on this plat was plotted from field notes of actual surveys made by me or under my supervision, and that the same is true and correct to the best of my knowledge and belief.

*Thomas A. Dugan*  
Date Surveyed

**12-2-80**

Registered Professional Engineer  
and/or Land Surveyor

**Thomas A. Dugan**

Certificate No.

**2373**

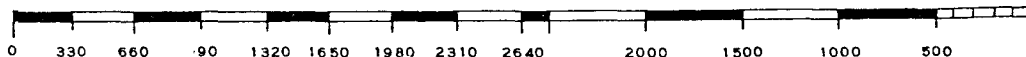



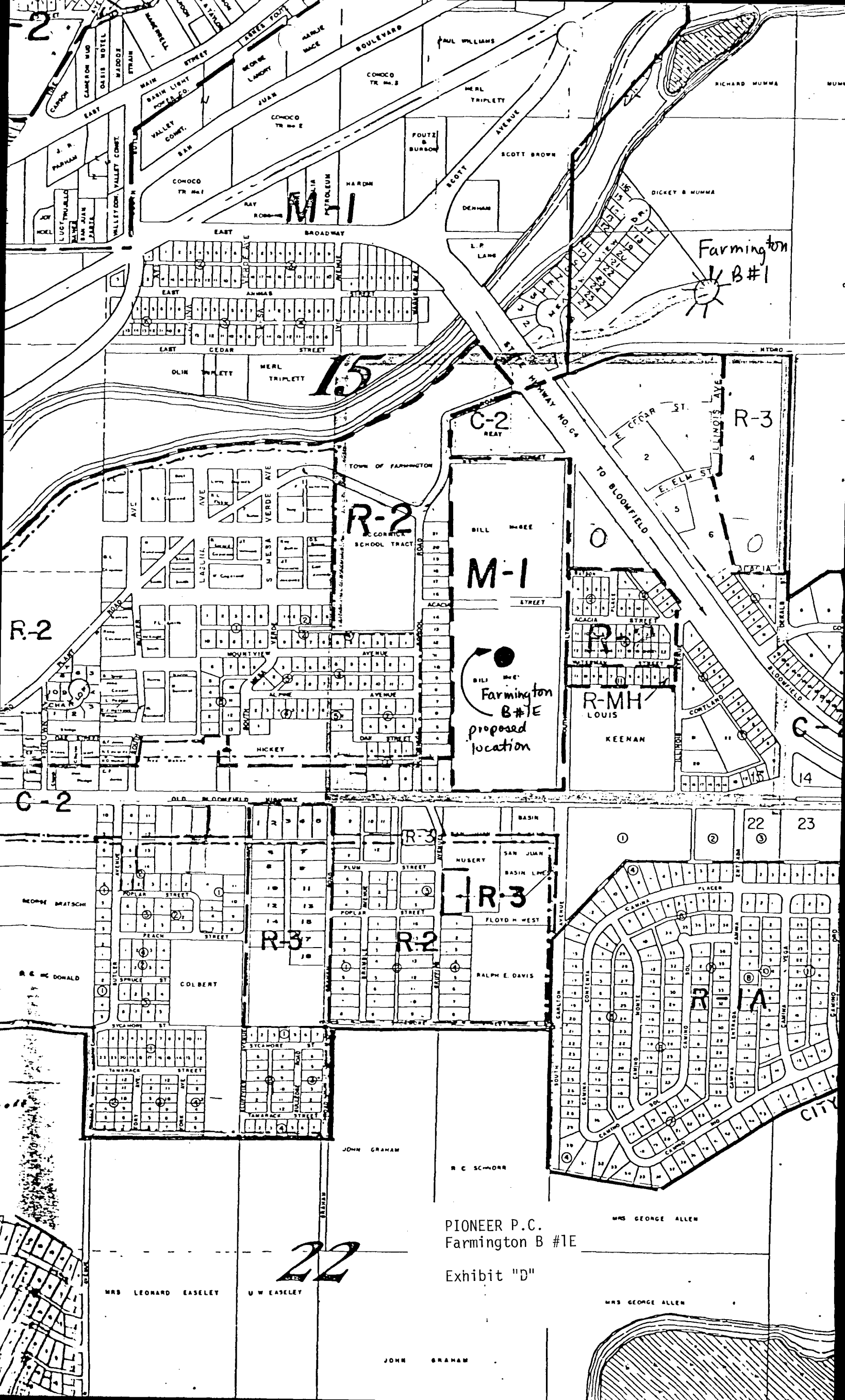

Farmington  
B #1

Farmington  
B #1E  
proposed  
location

PIONEER P.C.  
Farmington B #1E  
Exhibit "D"

22