



PHILLIPS PETROLEUM COMPANY

ODESSA, TEXAS 79762
4001 PENBROOK

NATURAL RESOURCES GROUP
Exploration and Production

March 30, 1981

Unorthodox Locations
East Vacuum Grayburg-San Andres Unit
Vacuum Grayburg-San Andres Pool
Lea County, New Mexico

New Mexico Department of Energy and Minerals (3)
Oil Conservation Division
P. O. Box 2088
Santa Fe, New Mexico, 87501

Attention: Mr. Joe D. Ramey
Division Director

Gentlemen:

We respectfully request administrative approval of the unorthodox locations for the below listed wells. Administrative action is provided by Special Order No. R-5897, Section 4, Rule 8, provided the proposed locations exceed 330 feet from the nearest unit boundary. The locations for these wells meet that condition. A location plat for each well and a plat of the entire unit is enclosed.

Tract 1910--Well No. 004 (a proposed water injection well.)
1200 feet from south and 1200 feet from east lines,
(Unit P), Section 19, Township 17 South, Range 35 East,
NMPPM, Lea County.

Tract 1912--Well No. 004 (a proposed water injection well.)
2600 feet from south and 200 feet from east lines,
(Unit I), Section 19, Township 17 South, Range 35 East,
NMPPM, Lea County.

Tract 1953--Well No. 002 (a proposed water injection well.)
2600 feet from north and 2575 feet from east lines,
(Unit G), Section 19, Township 17 South, Range 35 East,
NMPPM, Lea County.

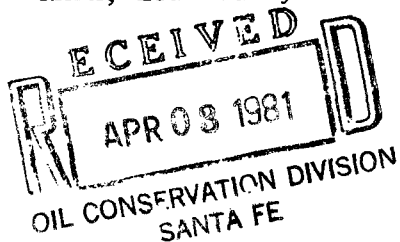

NSL-1349
Rule 8 R5897
Immediate

Unorthodox Locations
East Vacuum Grayburg-San Andres Unit
Vacuum Grayburg-San Andres Pool
Lea County, New Mexico
Page: 2

Tract 1978--Well No. 002 (a proposed water injection well.)
1300 feet from north and 1200 feet from west lines,
(Unit D), Section 19, Township 17 South, Range 35 East,
NMPM, Lea County.

Tract 2054--Well No. 003 (a proposed water injection well.)
1000 feet from south and 150 feet from west lines,
(Unit M), Section 20, Township 17 South, Range 35 East,
NMPM, Lea County.

Tract 2060--Well No. 001 (a proposed water injection well.)
1325 feet from south and 2525 feet from west lines,
(Unit K), Section 20, Township 17 South, Range 35 East,
NMPM, Lea County.

Tract 2416--Well No. 002 (a proposed water injection well.)
1350 feet from south and 150 feet from east lines,
(Unit I), Section 24, Township 17 South, Range 34 East,
NMPM, Lea County.

Tract 2622--Well No. 007 (a proposed water injection well.)
50 feet from north and 200 feet from west lines,
(Unit D), Section 26, Township 17 South, Range 35 East,
NMPM, Lea County.

Tract 2720--Well No. 008 (a proposed water injection well.)
50 feet from north and 2500 feet from east lines,
(Unit B), Section 27, Township 17 South, Range 35 East,
NMPM, Lea County.

Your early consideration and advice will be appreciated.

Very truly yours,

PHILLIPS PETROLEUM COMPANY



T. Harold McLemore
Regulation and Proration Supervisor

THM:ehg
Attachments

cc: Oil Conservation Division, Hobbs
w/attachments



**NEW MEXICO OIL CONSERVATION COMMISSION
WELL LOCATION AND ACREAGE DEDICATION PLAT**

Form C-102
Supersedes C-128
Effective 1-1-65

All distances must be from the outer boundaries of the Section.

Operator Phillips Petroleum Co.			Lease EVGSAU Tract 1910		Well No. 004
Unit Letter P	Section 19	Township 17 South	Range 35 East	County Lea	

Actual Footage Location of Well:

1200 feet from the **South** line and **1200** feet from the **East** line

Ground Level Elev. 3977.8 (unprepared)	Producing Formation Grayburg/San Andres	Pool Vacuum Gb/San Andres	Dedicated Acreage: water injection Acres
--	---	-------------------------------------	--

1. Outline the acreage dedicated to the subject well by colored pencil or hachure marks on the plat below.
2. If more than one lease is dedicated to the well, outline each and identify the ownership thereof (both as to working interest and royalty).
3. If more than one lease of different ownership is dedicated to the well, have the interests of all owners been consolidated by communitization, unitization, force-pooling, etc?

☐ Yes ☐ No If answer is "yes," type of consolidation _____

If answer is "no," list the owners and tract descriptions which have actually been consolidated. (Use reverse side of this form if necessary.) _____

No allowable will be assigned to the well until all interests have been consolidated (by communitization, unitization, forced-pooling, or otherwise) or until a non-standard unit, eliminating such interests, has been approved by the Commission.

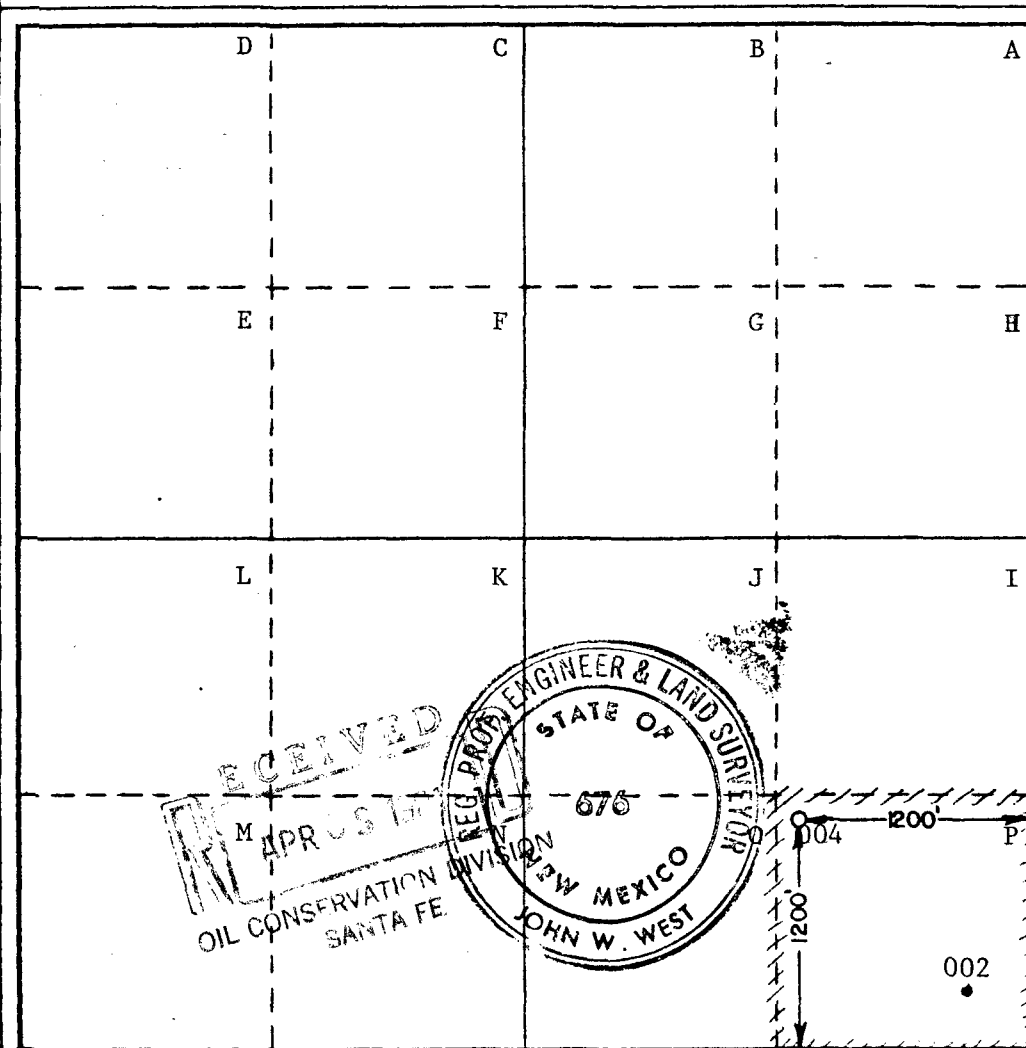

CERTIFICATION

I hereby certify that the information contained herein is true and complete to the best of my knowledge and belief.

[Signature]
Name **W. J. Mueller**
Position **Sr. Engineering Specialist**
Phillips Petroleum Company
Company

Date **MAR 30 1981**

I hereby certify that the well location shown on this plat was plotted from field notes of actual surveys made by me or under my supervision, and that the same is true and correct to the best of my knowledge and belief.

Date Surveyed **3-5-81**

Registered Professional Engineer and/or Land Surveyor

[Signature]
Certificate No. **JOHN W. WEST 676**
PATRICK A. ROMERO 668
Ronald J. Eidson 3239

0 330 660 990 1320 1650 1980 2310 2640 2000 1500 1000 500 0

**NEW MEXICO OIL CONSERVATION COMMISSION
WELL LOCATION AND ACREAGE DEDICATION PLAT**

Form C-102
Supersedes C-128
Effective 1-1-65

All distances must be from the outer boundaries of the Section.

Operator Phillips Petroleum Co.			Lease EVGSAU		Tract 1912	Well No. 004
Unit Letter I	Section 19	Township 17 South	Range 35 East	County Lea		

Actual Footage Location of Well:
2600 feet from the **South** line and **200** feet from the **East** line

Ground Level Elev. 3977.0 (unprepared)	Producing Formation Grayburg/San Andres	Pool Vacuum Gb/San Andres	Dedicated Acreage: water injection Acres
--	---	-------------------------------------	--

1. Outline the acreage dedicated to the subject well by colored pencil or hatchure marks on the plat below.
2. If more than one lease is dedicated to the well, outline each and identify the ownership thereof (both as to working interest and royalty).
3. If more than one lease of different ownership is dedicated to the well, have the interests of all owners been consolidated by communitization, unitization, force-pooling, etc?

☐ Yes ☐ No If answer is "yes," type of consolidation _____

If answer is "no," list the owners and tract descriptions which have actually been consolidated: (Use reverse side of this form if necessary.) _____

No allowable will be assigned to the well until all interests have been consolidated (by communitization, unitization, forced-pooling, or otherwise) or until a non-standard unit, eliminating such interests, has been approved by the Commission.

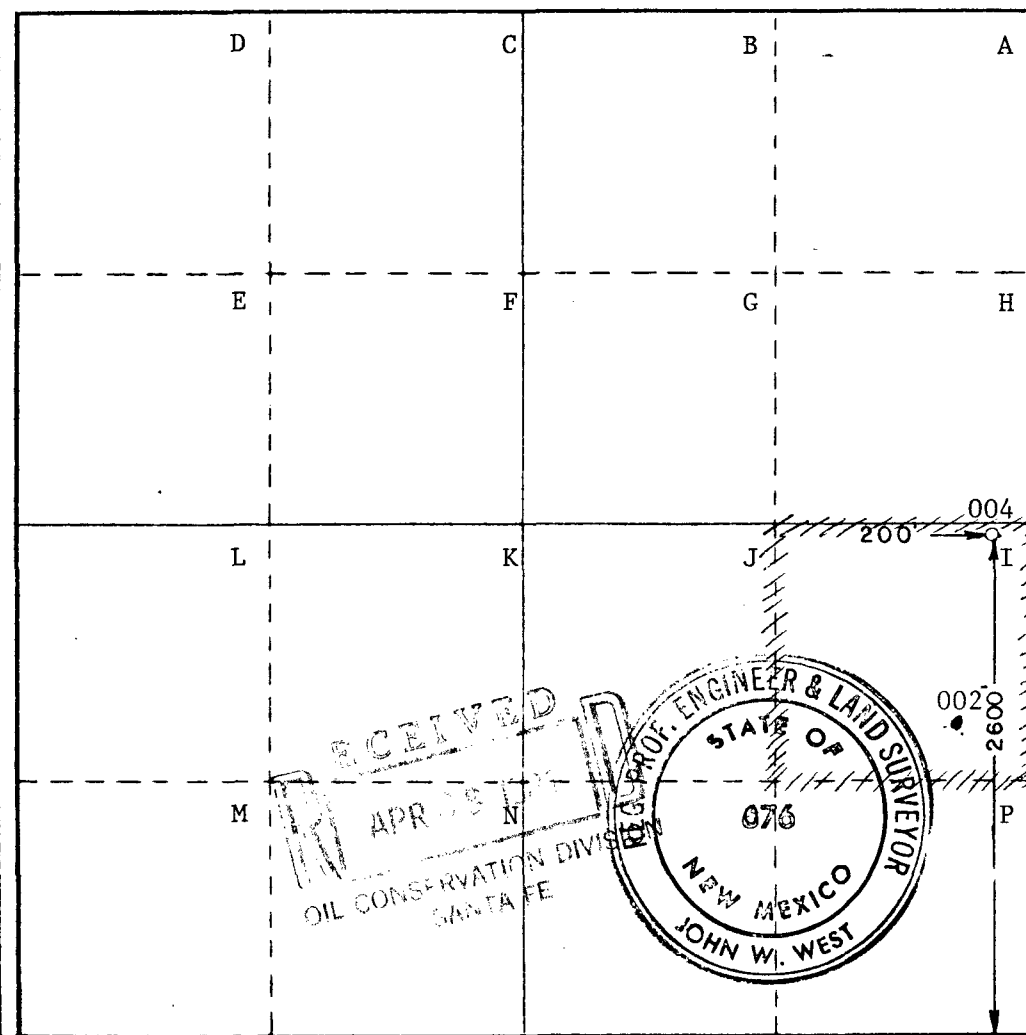

CERTIFICATION

I hereby certify that the information contained herein is true and complete to the best of my knowledge and belief.

[Signature]
W. J. Mueller
 Sr. Engineering Specialist
 Position
 Phillips Petroleum Company
 Company

Date
3/30/81

I hereby certify that the well location shown on this plat was plotted from field notes of actual surveys made by me or under my supervision, and that the same is true and correct to the best of my knowledge and belief.

Date Surveyed
3-5-81

Registered Professional Engineer
 and/or Land Surveyor

[Signature]
John W. West

Certificate No. **JOHN W. WEST 076**
PATRICK A. ROMERO 0603
Ronald J. Eidson 3239

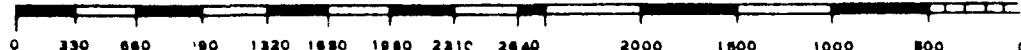

**NEW MEXICO OIL CONSERVATION COMMISSION
WELL LOCATION AND ACREAGE DEDICATION PLAT**

Form C-102
Supersedes C-128
Effective 1-1-65

All distances must be from the outer boundaries of the Section.

Operator Phillips Petroleum Co.			Lease EVGSAU		Tract 1953	Well No. 002
Unit Letter G	Section 19	Township 17 South	Range 35 East	County Lea		
Actual Footage Location of Well:						
2600 feet from the North line and		2575 feet from the East line				
Ground Level Elev. 3983.9 (unprepared)	Producing Formation Grayburg/San Andres		Pool Vacuum Gb/San Andres	Dedicated Acreage: water injection Acres		

1. Outline the acreage dedicated to the subject well by colored pencil or hatchure marks on the plat below.
2. If more than one lease is dedicated to the well, outline each and identify the ownership thereof (both as to working interest and royalty).
3. If more than one lease of different ownership is dedicated to the well, have the interests of all owners been consolidated by communitization, unitization, force-pooling, etc?

☐ Yes ☐ No If answer is "yes," type of consolidation _____

If answer is "no," list the owners and tract descriptions which have actually been consolidated. (Use reverse side of this form if necessary.) _____

No allowable will be assigned to the well until all interests have been consolidated (by communitization, unitization, forced-pooling, or otherwise) or until a non-standard unit, eliminating such interests, has been approved by the Commission.

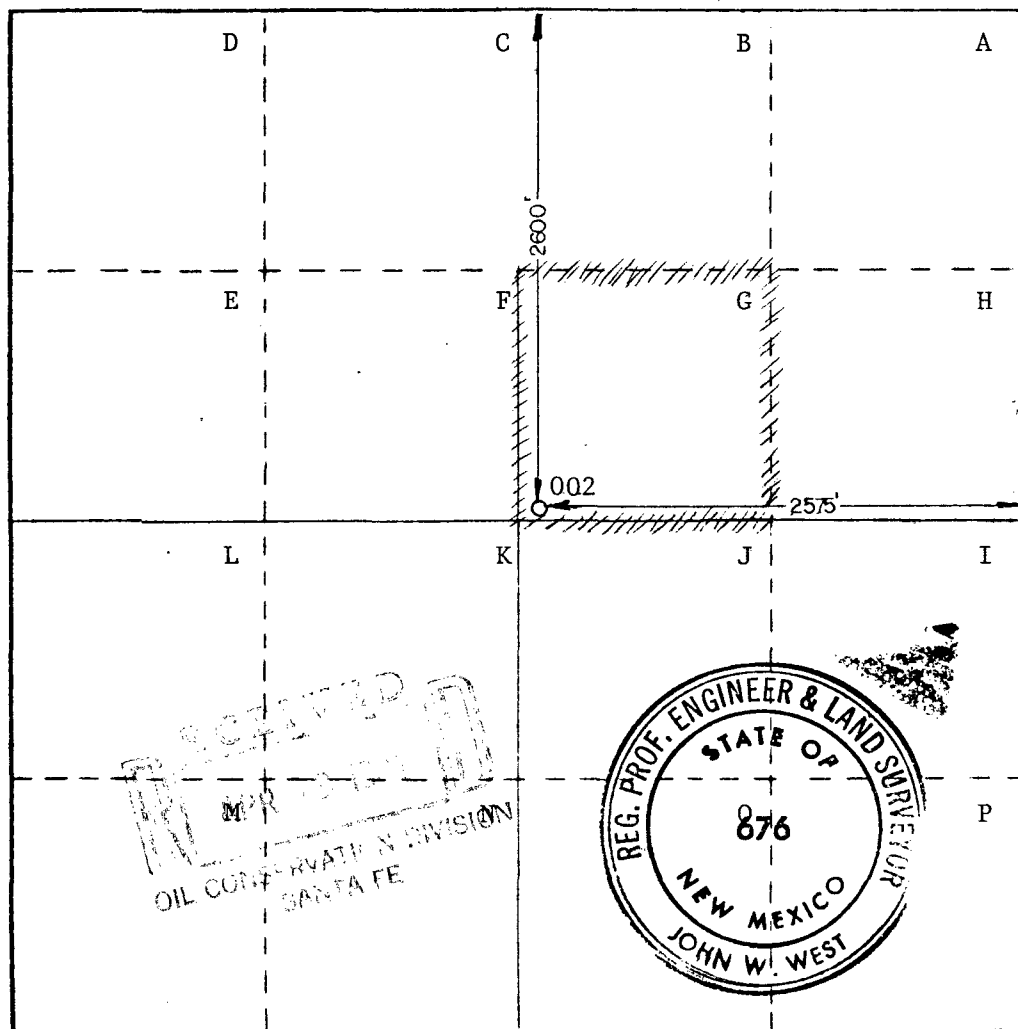

CERTIFICATION

I hereby certify that the information contained herein is true and complete to the best of my knowledge and belief.

[Signature]
Name **W. J. Mueller**
Position **Sr. Engineering Specialist**
Phillips Petroleum Company
Company

Date **MAR 30 1981**

I hereby certify that the well location shown on this plat was plotted from field notes of actual surveys made by me or under my supervision, and that the same is true and correct to the best of my knowledge and belief.

Date Surveyed **3-16-81**

Registered Professional Engineer and/or Land Surveyor

[Signature]
Certificate No. **JOHN W. WEST 876**
PATRICK A. ROMERO 8863
Ronald J. Eidson 3239

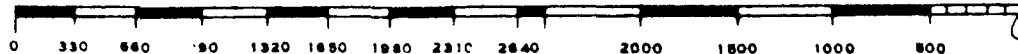

**NEW MEXICO OIL CONSERVATION COMMISSION
WELL LOCATION AND ACREAGE DEDICATION PLAT**

Form C-102
Supersedes C-128
Effective 1-1-65

All distances must be from the outer boundaries of the Section.

Operator Phillips Petroleum Co.			Lease EVGSAU		Tract 1978		Well No. 002
Unit Letter D	Section 19	Township 17 South	Range 35 East	County Lea			
Actual Footage Location of Well: 1300 feet from the North line and 1200 feet from the West line							
Ground Level Elev. Advise Later	Producing Formation Grayburg/San Andres		Pool Vacuum Gb/San Andres		Dedicated Acreage: water injection acres		

1. Outline the acreage dedicated to the subject well by colored pencil or hatchure marks on the plat below.
2. If more than one lease is dedicated to the well, outline each and identify the ownership thereof (both as to working interest and royalty).
3. If more than one lease of different ownership is dedicated to the well, have the interests of all owners been consolidated by communitization, unitization, force-pooling, etc?

☐ Yes ☐ No If answer is "yes," type of consolidation _____

If answer is "no," list the owners and tract descriptions which have actually been consolidated. (Use reverse side of this form if necessary.) _____

No allowable will be assigned to the well until all interests have been consolidated (by communitization, unitization, forced-pooling, or otherwise) or until a non-standard unit, eliminating such interests, has been approved by the Commission.

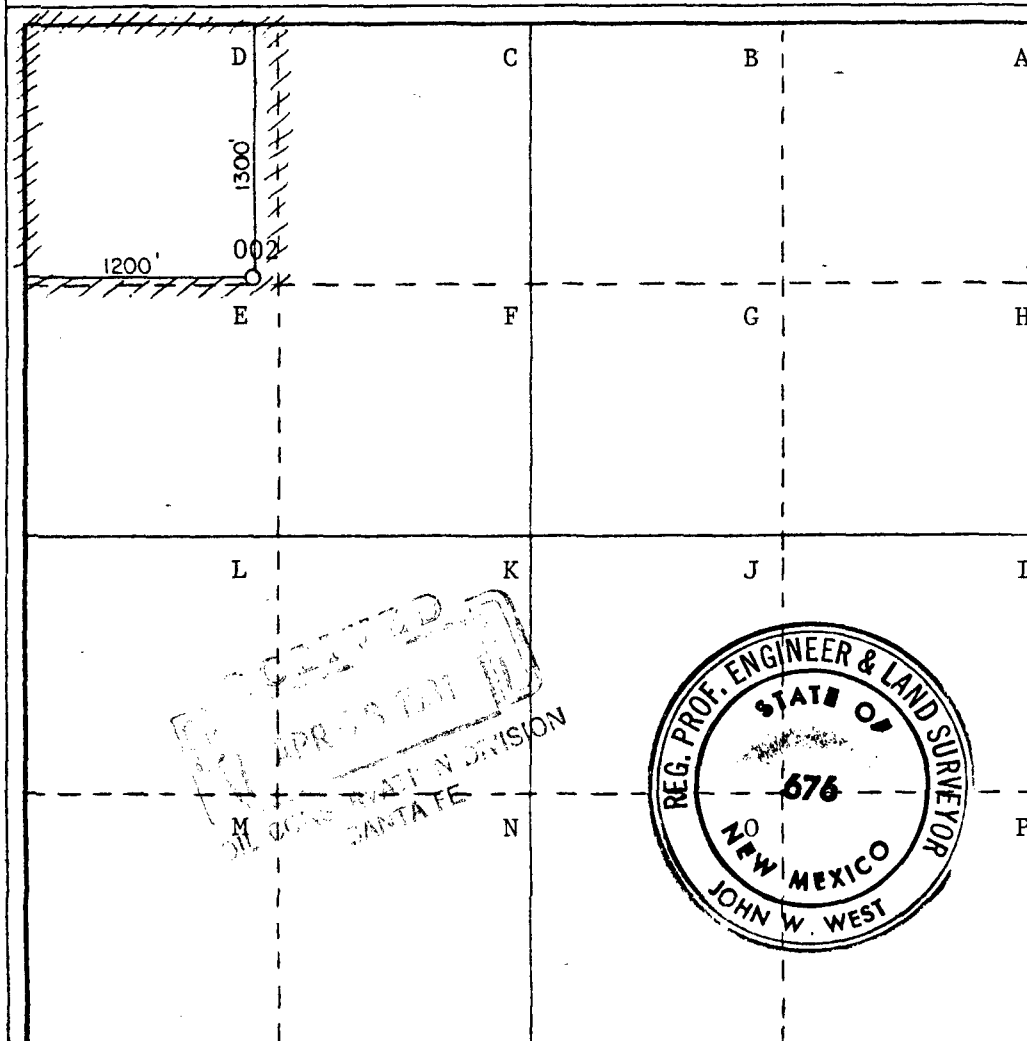

CERTIFICATION

I hereby certify that the information contained herein is true and complete to the best of my knowledge and belief.

[Signature]
Name **W. J. Mueller**
Position **Sr. Engineering Specialist**

Company **Phillips Petroleum Company**

Date _____

March 30, 1981

Date _____

I hereby certify that the well location shown on this plat was plotted from field notes of actual surveys made by me or under my supervision, and that the same is true and correct to the best of my knowledge and belief.

Date Surveyed
3-16-81

Registered Professional Engineer
and/or Land Surveyor

[Signature]
Certificate No. **JOHN W. WEST 676**
PATRICK A. ROMERO 6463
Ronald J. Eidson 3239

0 330 660 990 1320 1650 1980 2310 2640 2000 1800 1600 1400 1200 1000 800 600 400 200 0

**NEW MEXICO OIL CONSERVATION COMMISSION
WELL LOCATION AND ACREAGE DEDICATION PLAT**

Form C-102
Supersedes C-128
Effective 1-1-65

All distances must be from the outer boundaries of the Section.

Operator Phillips Petroleum Co.			Lease EVGSAU Tract 2054		Well No. 003
Unit Letter M	Section 20	Township 17 South	Range 35 East	County Lea	

Actual Footage Location of Well:

1000 feet from the South line and 150 feet from the West line	
Ground Level Elev. 3976.1 (unprepared)	Producing Formation Grayburg/San Andres
Pool Vacuum Gb/San Andres	Dedicated Acreage: water injection Acres

1. Outline the acreage dedicated to the subject well by colored pencil or hachure marks on the plat below.
2. If more than one lease is dedicated to the well, outline each and identify the ownership thereof (both as to working interest and royalty).
3. If more than one lease of different ownership is dedicated to the well, have the interests of all owners been consolidated by communitization, unitization, force-pooling, etc?

☐ Yes ☐ No If answer is "yes," type of consolidation _____

If answer is "no," list the owners and tract descriptions which have actually been consolidated. (Use reverse side of this form if necessary.) _____

No allowable will be assigned to the well until all interests have been consolidated (by communitization, unitization, forced-pooling, or otherwise) or until a non-standard unit, eliminating such interests, has been approved by the Commission.

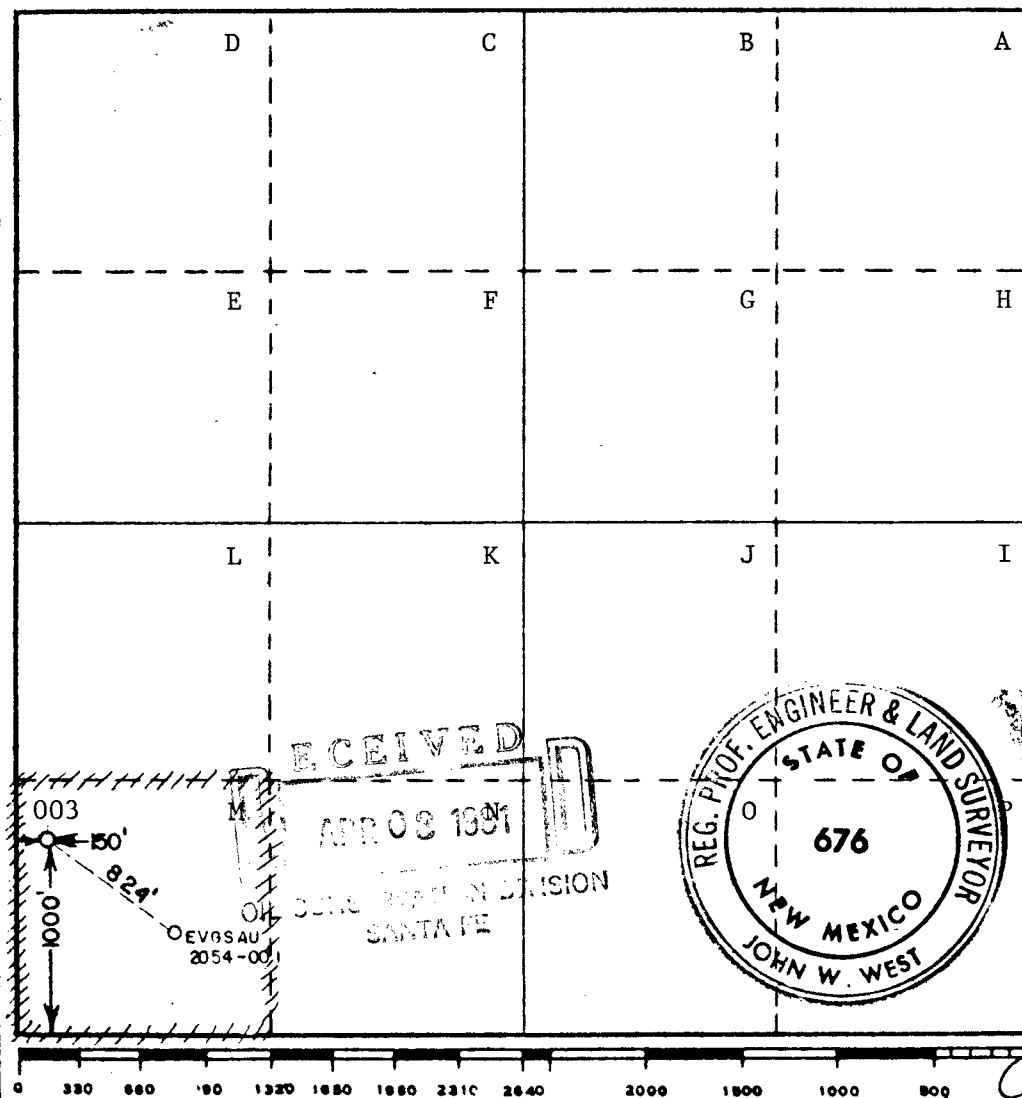

CERTIFICATION

I hereby certify that the information contained herein is true and complete to the best of my knowledge and belief.

Name **J. Mueller**
Position **Sr. Engineering Specialist**
Company **Phillips Petroleum Company**

Date **MAR 30 1981**

I hereby certify that the well location shown on this plat was plotted from field notes of actual surveys made by me or under my supervision, and that the same is true and correct to the best of my knowledge and belief.

Date Surveyed **3-16-81**

Registered Professional Engineer and/or Land Surveyor

Certificate No. **JOHN W. WEST 676**
PATRICK A. ROMERO 6663
Ronald J. Eldson 3239

**NEW MEXICO OIL CONSERVATION COMMISSION
WELL LOCATION AND ACREAGE DEDICATION PLAT**

Form C-102
Supersedes C-128
Effective 1-1-65

All distances must be from the outer boundaries of the Section.

Operator Phillips Petroleum Co.			Lease EVGSAU		Tract 2060	Well No. 001
Unit Letter K	Section 20	Township 17 South	Range 35 East	County Lea		

Actual Footage Location of Well:

1325 feet from the **South** line and **2525** feet from the **West** line

Ground Level Elev. 3963.4 (unprepared)	Producing Formation Grayburg/San Andres	Pool Vacuum Gb/San Andres	Dedicated Acreage: water injection Acres
--	---	-------------------------------------	--

1. Outline the acreage dedicated to the subject well by colored pencil or hatchure marks on the plat below.
2. If more than one lease is dedicated to the well, outline each and identify the ownership thereof (both as to working interest and royalty).
3. If more than one lease of different ownership is dedicated to the well, have the interests of all owners been consolidated by communitization, unitization, force-pooling, etc?

☐ Yes ☐ No If answer is "yes," type of consolidation _____

If answer is "no," list the owners and tract descriptions which have actually been consolidated. (Use reverse side of this form if necessary.) _____

No allowable will be assigned to the well until all interests have been consolidated (by communitization, unitization, forced-pooling, or otherwise) or until a non-standard unit, eliminating such interests, has been approved by the Commission.

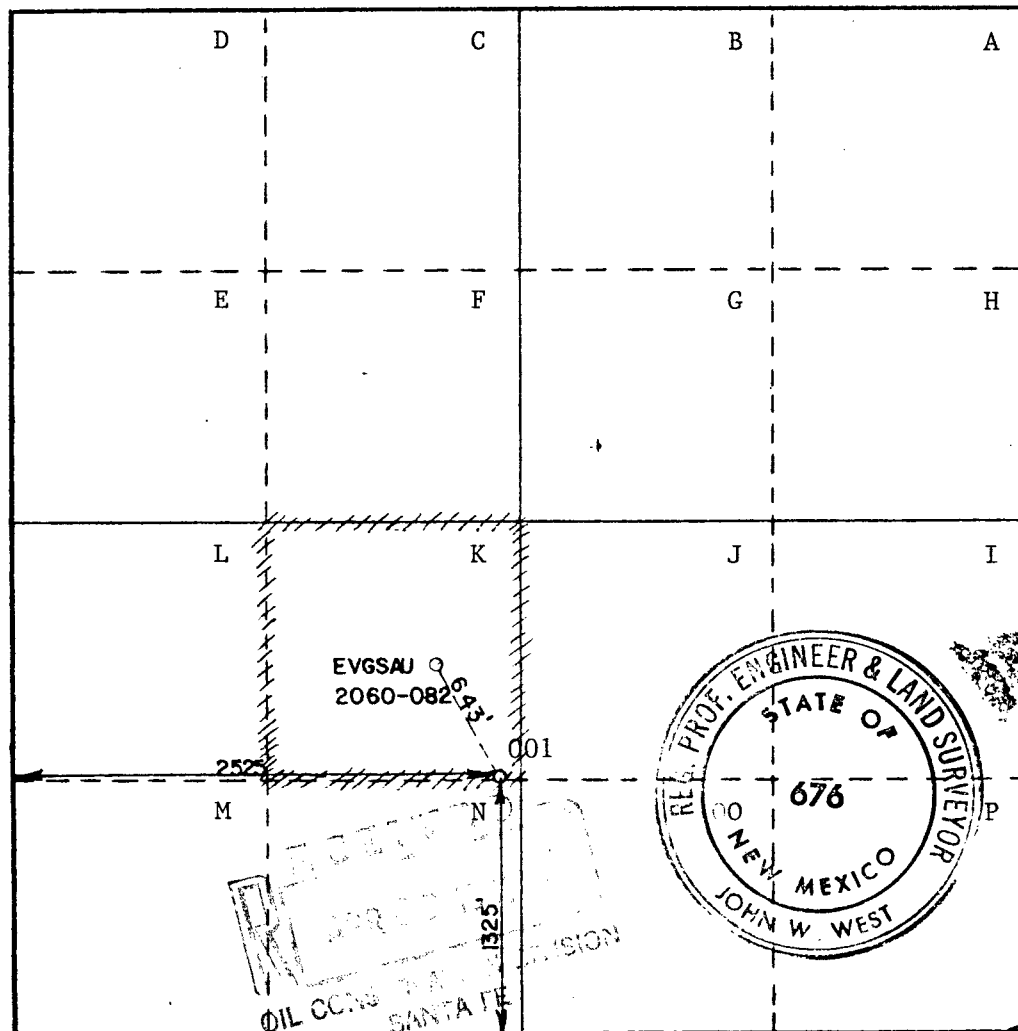

CERTIFICATION

I hereby certify that the information contained herein is true and complete to the best of my knowledge and belief.

[Signature]
Name **W. J. Mueller**
Position **Sr. Engineering Specialist**
Company **Phillips Petroleum Company**

Date **MAR 30 1981**

I hereby certify that the well location shown on this plat was plotted from field notes of actual surveys made by me or under my supervision, and that the same is true and correct to the best of my knowledge and belief.

Date Surveyed **3-16-81**

Registered Professional Engineer and/or Land Surveyor

[Signature]
Certificate No. **JOHN W. WEST 676**
PATRICK A. ROMERO 8863
Ronald J. Eidson 3239

NEW MEXICO OIL CONSERVATION COMMISSION
WELL LOCATION AND ACREAGE DEDICATION PLAT

Form O-112
Supersedes O-128
Effective 1-1-55

All distances must be from the outer boundaries of the Section

Operator Phillips Petroleum Co.			Lease EVGSAU Tract 2416		Well No. 002
Unit Letter I	Section 24	Township 17 South	Range 34 East	County Lea	
Actual Footage Location of Well: 1350 feet from the South line and 150 feet from the East line					
Ground Level Elev. 3895.1 (Unprepared)	Producing Formation Grayburg/San Andres		Pool Vaeuum Gb/San Andres	Dedicated Acreage: water injection Acres	

1. Outline the acreage dedicated to the subject well by colored pencil or hatchure marks on the plat below.
2. If more than one lease is dedicated to the well, outline each and identify the ownership thereof (both as to working interest and royalty).
3. If more than one lease of different ownership is dedicated to the well, have the interests of all owners been consolidated by communitization, unitization, force-pooling, etc?

☐ Yes ☐ No If answer is "yes," type of consolidation _____

If answer is "no," list the owners and tract descriptions which have actually been consolidated (Use reverse side of this form if necessary.) _____

No allowable will be assigned to the well until all interests have been consolidated (by communitization, unitization, forced-pooling, or otherwise) or until a non-standard unit, eliminating such interests, has been approved by the Commission.

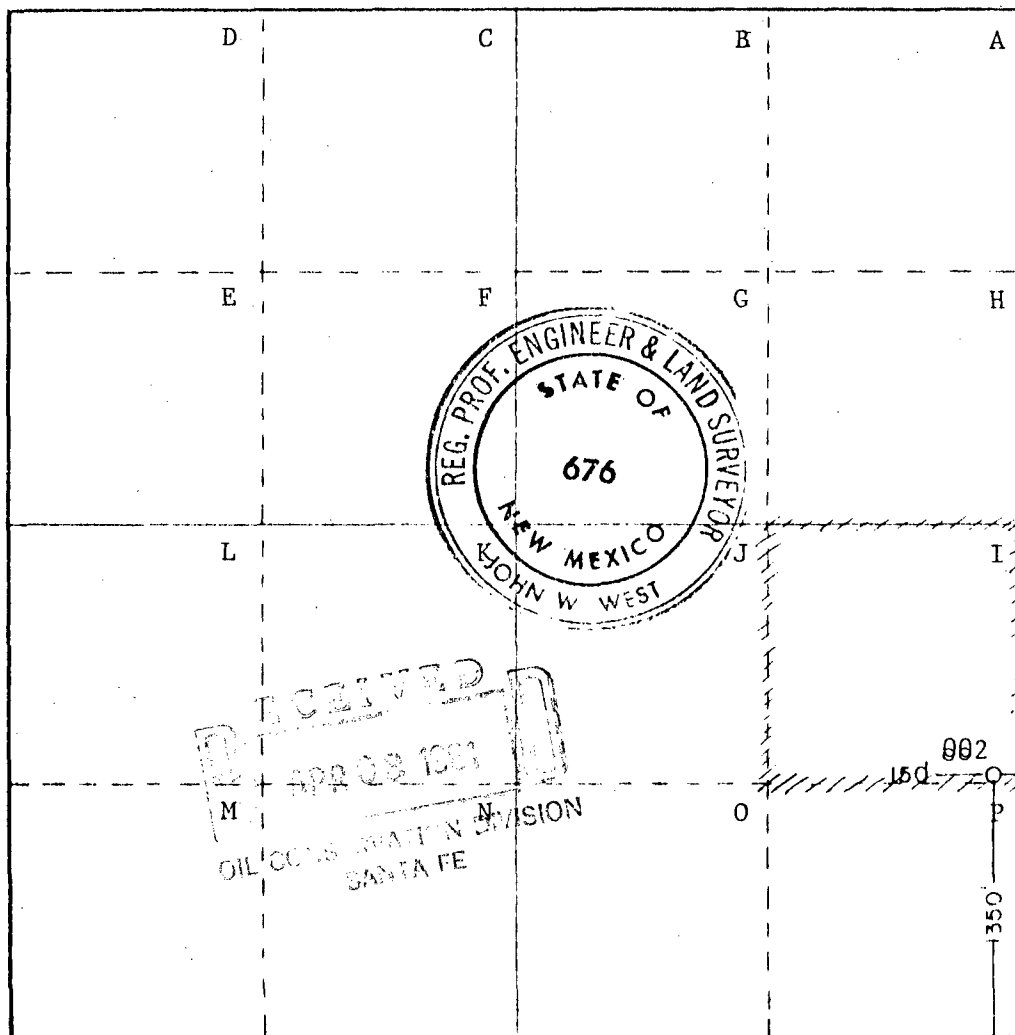

CERTIFICATION

I hereby certify that the information contained herein is true and complete to the best of my knowledge and belief

W.J. Mueller
W.J. Mueller
Sr. Engineering Specialist

Employer
Phillips Petroleum Company

Company

Date

MAR 30 1981

I hereby certify that the well location shown on this plat was plotted from field notes of actual surveys made by me or under my supervision, and that the same is true and correct to the best of my knowledge and belief.

Date Surveyed

3-9-81

Registered Professional Engineer
in Land and Surveying

John W. West
Certificate No. JOHN W. WEST 676
PATRICK A. ROMERO 6868
Ronald J. Eidson 3239

0 330 660 990 1320 1650 1980 2310 2640 2970 3300 3630 3960 4290 4620 4950 5280 5610 5940 6270 6600 6930 7260 7590 7920 8250 8580 8910 9240 9570 9900

**NEW MEXICO OIL CONSERVATION COMMISSION
WELL LOCATION AND ACREAGE DEDICATION PLAT**

Form C-102
Supersedes C-128
Effective 1-1-65

All distances must be from the outer boundaries of the Section.

Operator Phillips Petroleum Co.			Lease EVGSAU Tract 2622		Well No. 007
Unit Letter D	Section 26	Township 17 South	Range 35 East	County Lea	
Actual Footage Location of Well: <div style="display: flex; justify-content: space-between;"> 50 feet from the North line and 200 feet from the West line </div>					
Ground Level Elev. 3926.2 (unprepared)	Producing Formation Grayburg/San Andres	Pool Vacuum Gb/San Andres	Dedicated Acreage: water injection Acres		

1. Outline the acreage dedicated to the subject well by colored pencil or hatchure marks on the plat below.
2. If more than one lease is dedicated to the well, outline each and identify the ownership thereof (both as to working interest and royalty).
3. If more than one lease of different ownership is dedicated to the well, have the interests of all owners been consolidated by communitization, unitization, force-pooling, etc?

☐ Yes ☐ No If answer is "yes," type of consolidation _____

If answer is "no," list the owners and tract descriptions which have actually been consolidated. (Use reverse side of this form if necessary.) _____

No allowable will be assigned to the well until all interests have been consolidated (by communitization, unitization, forced-pooling, or otherwise) or until a non-standard unit, eliminating such interests, has been approved by the Commission.

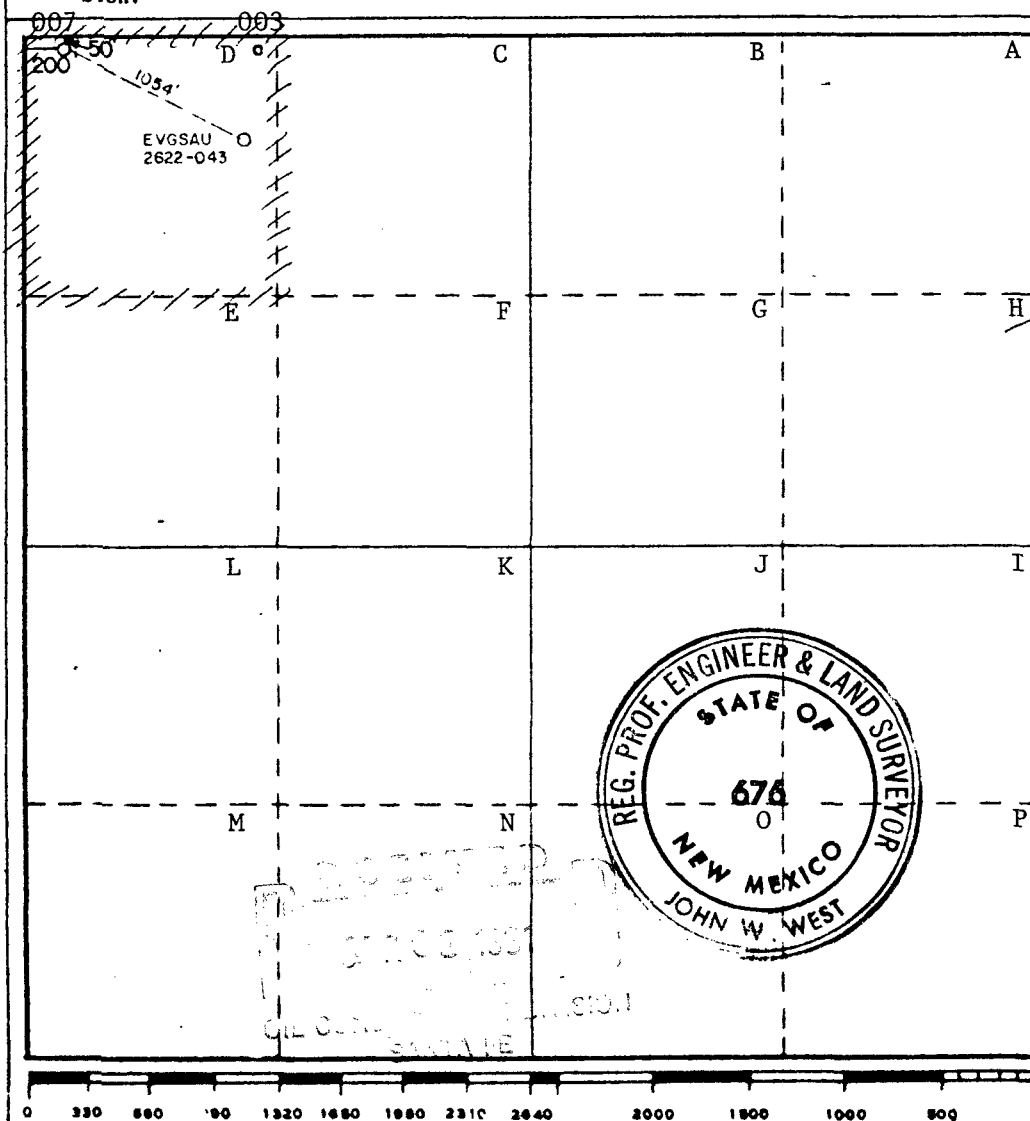

CERTIFICATION

I hereby certify that the information contained herein is true and complete to the best of my knowledge and belief.

W. J. Mueller
W. J. Mueller
 Sr. Engineering Specialist
 Position
 Phillips Petroleum Company
 Company
 March 30, 1981
 Date

I hereby certify that the well location shown on this plat was plotted from field notes of actual surveys made by me or under my supervision, and that the same is true and correct to the best of my knowledge and belief.

Date Surveyed
3-4-81
 Registered Professional Engineer and/or Land Surveyor

John W. West
 Certificate No. **JOHN W. WEST 676**
PATRICK A. ROMERO 6865
Ronald J. Eidson 3239

**NEW MEXICO OIL CONSERVATION COMMISSION
WELL LOCATION AND ACREAGE DEDICATION PLAT**

Form C-102
Supersedes C-128
Effective 1-1-65

All distances must be from the outer boundaries of the Section.

Operator Phillips Petroleum Co.			Lease EVGSAU Tract 2720		Well No. 008
Unit Letter B	Section 27	Township 17 South	Range 35 East	County Lea	
Actual Footage Location of Well: 50 feet from the North line and 2500 feet from the East line					
Ground Level Elev. 3937.2 (unprepared)	Producing Formation Grayburg/San Andres	Pool Vacuum Gb/San Andres		Dedicated Acreage: water injection Acres	

1. Outline the acreage dedicated to the subject well by colored pencil or hachure marks on the plat below.
2. If more than one lease is dedicated to the well, outline each and identify the ownership thereof (both as to working interest and royalty).
3. If more than one lease of different ownership is dedicated to the well, have the interests of all owners been consolidated by communitization, unitization, force-pooling, etc?

☐ Yes ☐ No If answer is "yes," type of consolidation _____

If answer is "no," list the owners and tract descriptions which have actually been consolidated. (Use reverse side of this form if necessary.) _____

No allowable will be assigned to the well until all interests have been consolidated (by communitization, unitization, forced-pooling, or otherwise) or until a non-standard unit, eliminating such interests, has been approved by the Commission.

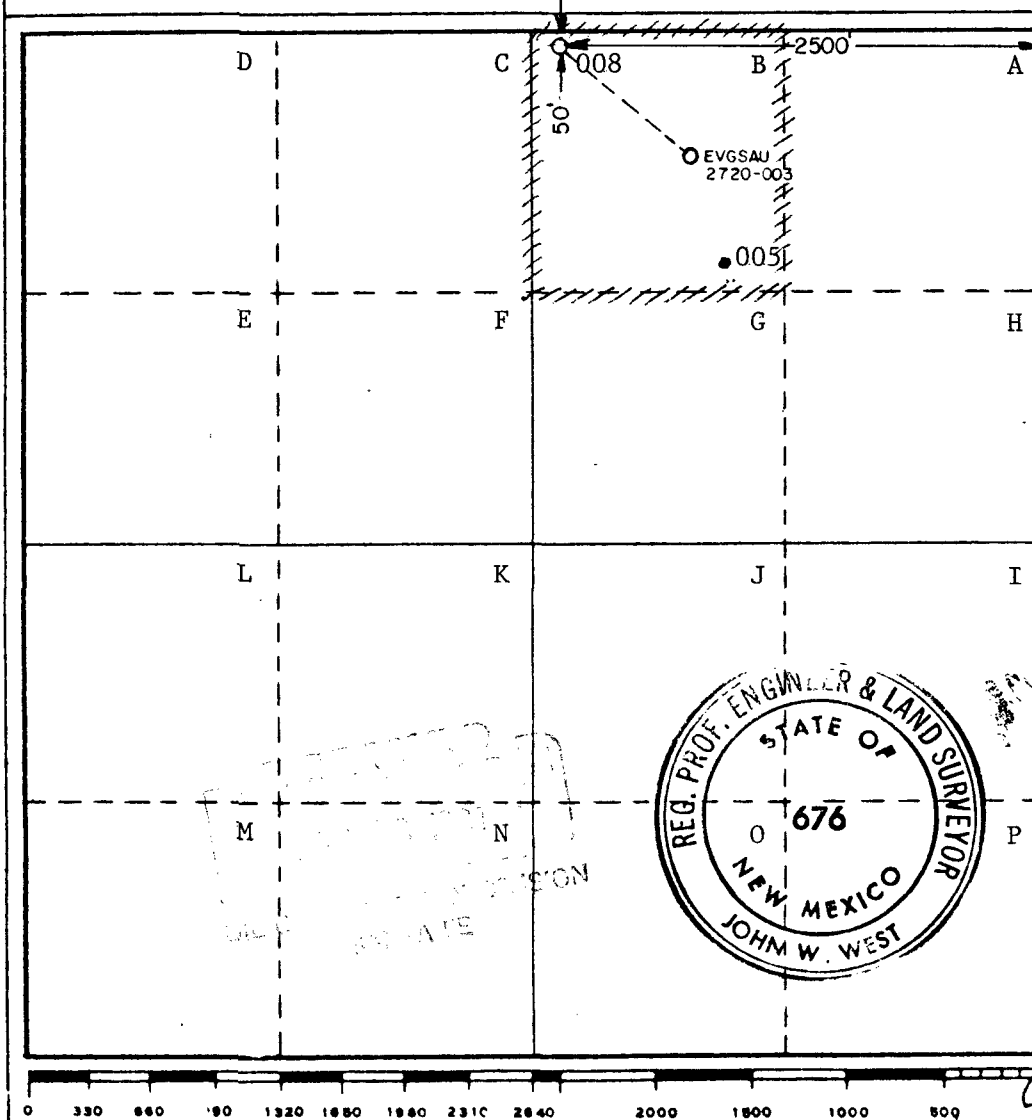

CERTIFICATION

I hereby certify that the information contained herein is true and complete to the best of my knowledge and belief.

[Signature]
Name **W. J. Mueller**
Position **Sr. Engineering Specialist**
Phillips Petroleum Company
Company

Date **MAR 30 1981**

I hereby certify that the well location shown on this plat was plotted from field notes of actual surveys made by me or under my supervision, and that the same is true and correct to the best of my knowledge and belief.

Date Surveyed
3-4-81

Registered Professional Engineer and/or Land Surveyor

[Signature]
Certificate No. **JOHN W. WEST 676**
PATRICK A. ROMERO 6868
Ronald J. Eidson 3239

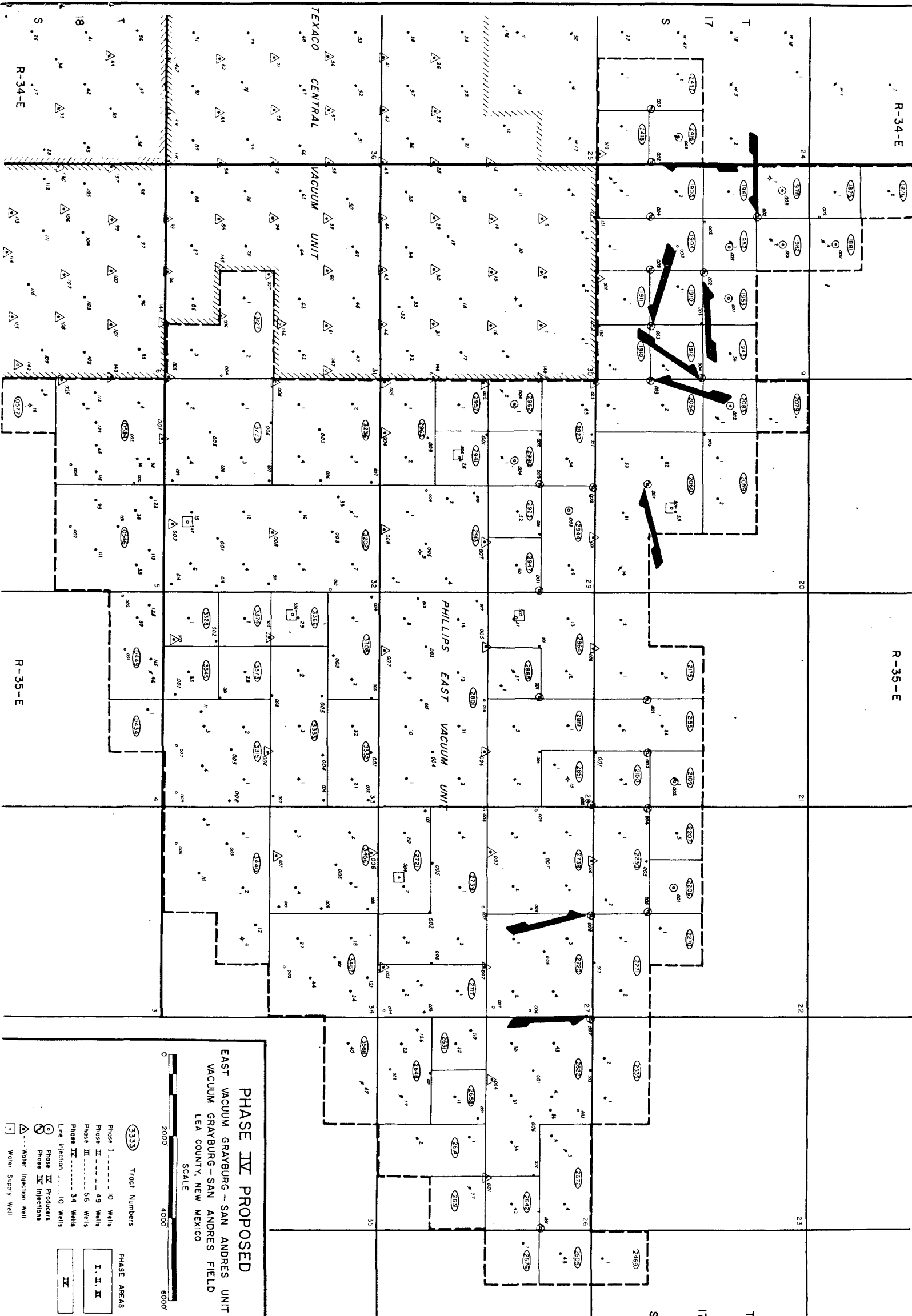

PHASE IV PROPOSED
EAST VACUUM GRAYBURG-SAN ANDRES UNIT
VACUUM GRAYBURG-SAN ANDRES FIELD
LEA COUNTY, NEW MEXICO
SCALE

- 3333 Tract Numbers
- Phase I - 10 Wells
Phase II - 49 Wells
Phase III - 56 Wells
Phase IV - 34 Wells
Line Injection - 10 Wells
Phase IV Producers
Phase IV Injections
Water Injection Well
Water Supply Well
- PHASE AREAS
I, II, III
IV