

SUPRON ENERGY CORPORATION

POST OFFICE BOX 808

FARMINGTON, NEW MEXICO 87401

April 6, 1981

NSL - 1352
Rule 3 R 1670
4-28-81
Basin Dakota Pool

Energy and Minerals Department
Oil Conservation Division
P.O. Box 2088
Santa Fe, New Mexico 87501

Attention: Mr. Joe D. Ramey

Dear Sir:

It is respectfully requested that Supron Energy Corporation be granted administrative approval to drill the Navajo Indian No. 6-E well in the Basin Dakota formation, in a non-standard location due to the topography.

This proposed well would be located 2380 feet from the South line and 925 feet from the West line of Section 6, Township 26 North, Range 8 West, N.M.P.M., San Juan County, New Mexico.

Attached are the following copies:

1. C-102 "Acreage Dedication Plat"
2. Topographical Map of Section
3. Offset Operator's Plat
4. Letters to offset operator's

SUPRON ENERGY CORPORATION

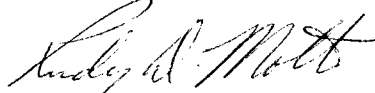

Rudy D. Motto
Area Superintendent

RDM:bjs
Attachments

cc: Haskell Fleetwood
Oil Conservation Division - Aztec
Texas Oil & Gas
Robert K. Bass
U.S.G.S.

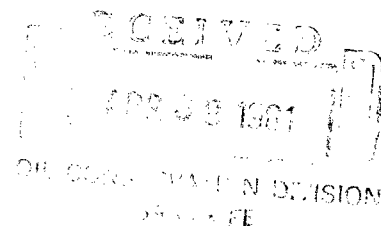

All distances must be from the outer boundaries of the Section.

Operator SUPRON ENERGY CORPORATION			Lease NAVAJO INDIAN		Well No. 6E
Unit Letter L	Section 6	Township 26 NORTH	Range 8 WEST	County SAN JUAN	
Actual Footage Location of Well: 2380 feet from the SOUTH line and 925 feet from the WEST line					
Ground Level Elev. 6103	Producing Formation DAKOTA		Pool BASIN		Dedicated Acreage: W/2 323.03 Acres

1. Outline the acreage dedicated to the subject well by colored pencil or hatchure marks on the plat below.
2. If more than one lease is dedicated to the well, outline each and identify the ownership thereof (both as to working interest and royalty).
3. If more than one lease of different ownership is dedicated to the well, have the interests of all owners been consolidated by communitization, unitization, force-pooling, etc?

☒ Yes ☐ No If answer is "yes," type of consolidation Communitization Agreement

If answer is "no," list the owners and tract descriptions which have actually been consolidated. (Use reverse side of this form if necessary.)

No allowable will be assigned to the well until all interests have been consolidated (by communitization, unitization, forced-pooling, or otherwise) or until a non-standard unit, eliminating such interests, has been approved by the Division

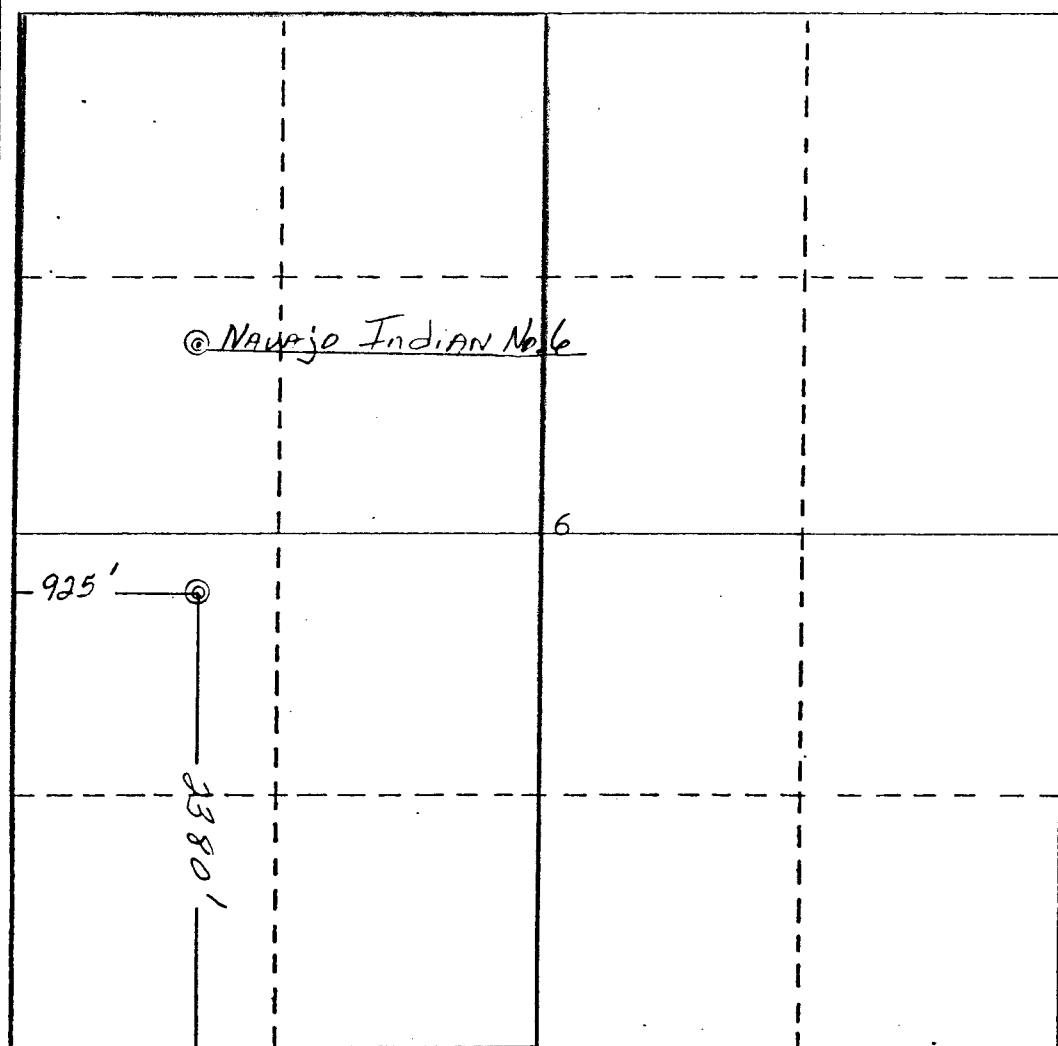

CERTIFICATION

I hereby certify that the information contained herein is true and complete to the best of my knowledge and belief.

Rudy D. Motto
Name

Rudy D. Motto

Position

Area Superintendent

Company

Supron Energy Corporation

Date



I hereby certify that the well location shown on this plat was obtained from field notes and actual survey made by me or under my supervision and that the same is true and correct to the best of my knowledge and belief.

Michael Daly
Date Surveyed

March 31, 1981

Registered Professional Engineer
and/or Land Surveyor

Michael Daly

Certificate No.

#5992

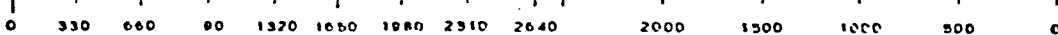

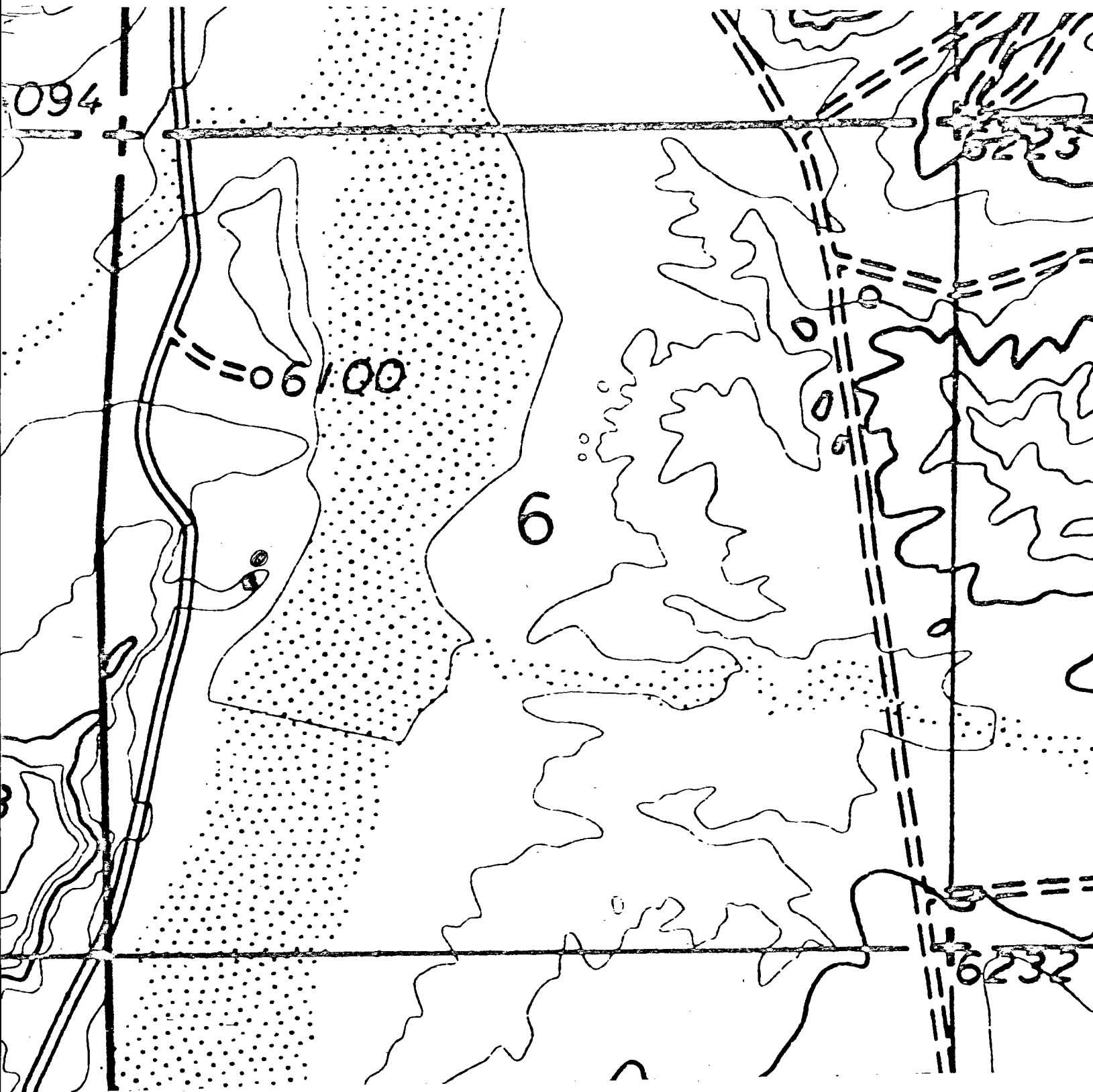

Navajo Indian #6-E
SW/4, Sec. 6, T-26N, R-8W
San Juan County, New Mexico

NAVAJO INDIAN NO. 6-E

R — 8 — W



▽

Q

Mesaverde - Pictured Cliffs

April 6, 1981

Austrial Oil Company, Inc.
P.O. Box 259
Lamesa, Texas 79331

Gentlemen:

Supron Energy Corporation proposes to drill their Navajo Indian No. 6-E in the Basin Dakota formation, located 2380 feet from the South and 925 feet from the West line, Section 6, Township 26 North, Range 8 West, N.M.P.M., San Juan County, New Mexico. This well is located in a non-standard location due to the topography.

Our records indicate that you are the owner and operator of acreage which adjoins this drilling block. If you have no objections to this proposed non-standard location, we would appreciate your signing the attached two (2) copies of this letter and returning same to this office.

Your prompt consideration of this will be greatly appreciated.

SUPRON ENERGY CORPORATION

Original Signed By

Rudy D. Motto

Rudy D. Motto
Area Superintendent

RDM:bjs

This above non-standard location
well is hereby approved.

BY: _____

TITLE: _____

DATE: _____

April 6, 1981

Consolidated Oil & Gas Company
Suite 1300
1840 Lincoln Street
Denver, Colorado 80295

Gentlemen:

Supron Energy Corporation proposes to drill their Navejo Indian No. 6-E in the Basin Dakota formation, located 2380 feet from the South and 925 feet from the West, Section 6, Township 26 North, Range 8 West, N.M.P.M., San Juan County, New Mexico. This well is located in a non-standard location due to the topography.

Our records indicate that you are the owner and operator of acreage which adjoins this drilling block. If you have no objections to this proposed non-standard location, we would appreciate your signing the attached two (2) copies of this letter and returning same to this office.

Your prompt consideration of this will be greatly appreciated.

SUPRON ENERGY CORPORATION

Original Signed By

Rudy D. Motto

Rudy D. Motto

Area Superintendent

RDH:bjs

This above non-standard location
well is hereby approved.

BY: _____

TITLE: _____

DATE: _____

April 6, 1981

Tenneco Inc.
720 S. Colorado Blvd.
Denver, Colorado 80222

Gentlemen:

Supron Energy Corporation proposes to drill their Navajo Indian No. 6-E in the Basin Dakota formation, located 2380 feet from the South and 925 feet from the West, Section 6, Township 26 North, Range 8 West, N.M.P.M., San Juan County, New Mexico. This well is located in a non-standard location due to the topography.

Our records indicate that you are the owner and operator of acreage which adjoins this drilling block. If you have no objections to this proposed non-standard location, we would appreciate your signing the attached two (2) copies of this letter and returning same to this office.

Your prompt consideration of this will greatly appreciated.

SUPRON ENERGY CORPORATION
Original Signed By
Rudy D. Motto
Rudy D. Motto
Area Superintendent

RDM:bjs

This above non-standard location
well is hereby approved.

BY: _____

TITLE: _____

DATE: _____

April 6, 1981

El Paso Exploration Company
P.O. Box 289
Farmington, New Mexico 87401

Gentlemen:

Supron Energy Corporation proposes to drill their Navajo Indian No. 6-E in the Basin Dakota formation, located 1380 feet from the South and 923 feet from the West line of Section 6, Township 26 North, Range 8 West, N.M.P.M., San Juan County, New Mexico. This well is located in a non-standard location due to the topography.

Our records indicate that you are the owner and operator of acreage which adjoins this drilling block. If you have no objections to this proposed non-standard location, we would appreciate your signing the attached two (2) copies of this letter and returning same to this office.

Your prompt consideration of this will be greatly appreciated.

SUPRON ENERGY CORPORATION

Original Signed By

Rudy D. Motto

Rudy D. Motto

Area Superintendent

RDM:bjs

This above non-standard location well is hereby approved.

BY: _____

TITLE: _____

DATE: _____

P21 7086567

RECEIPT FOR CERTIFIED MAIL

NO INSURANCE COVERAGE PROVIDED—
NOT FOR INTERNATIONAL MAIL

Nav. Ind. 6-8 (See Reverse)

SENT TO		El Paso Exploration Co.	
STREET AND NO.		P.O. Box 289	
P.O., STATE AND ZIP CODE		Farmington, N.M. 87401	
POSTAGE		\$ 1.80	
CONSULT POSTMASTER FOR FEES	OPTIONAL SERVICES	CERTIFIED FEE	75¢
		SPECIAL DELIVERY	60¢
		RESTRICTED DELIVERY	¢
	RETURN RECEIPT SERVICE	SHOW TO WHOM AND DATE DELIVERED	¢
		SHOW TO WHOM, DATE, AND ADDRESS OF DELIVERY	¢
		SHOW TO WHOM AND DATE DELIVERED WITH RESTRICTED DELIVERY	¢
SHOW TO WHOM, DATE AND ADDRESS OF DELIVERY WITH RESTRICTED DELIVERY		¢	
TOTAL POSTAGE AND FEES		\$ 1.80	
POSTMARK OR DATE		BLOOMFIELD, N.M. APR 1976	

PS Form 3800, Apr. 1976

P21 7086568

RECEIPT FOR CERTIFIED MAIL

NO INSURANCE COVERAGE PROVIDED—
NOT FOR INTERNATIONAL MAIL

Nav. Ind. 6-8 (See Reverse)

SENT TO		Austrial Oil Co., Inc.	
STREET AND NO.		P.O. Box 259	
P.O., STATE AND ZIP CODE		Lamesa, Texas 79331	
POSTAGE		\$ 1.80	
CONSULT POSTMASTER FOR FEES	OPTIONAL SERVICES	CERTIFIED FEE	75¢
		SPECIAL DELIVERY	60¢
		RESTRICTED DELIVERY	¢
	RETURN RECEIPT SERVICE	SHOW TO WHOM AND DATE DELIVERED	¢
		SHOW TO WHOM, DATE, AND ADDRESS OF DELIVERY	¢
		SHOW TO WHOM AND DATE DELIVERED WITH RESTRICTED DELIVERY	¢
SHOW TO WHOM, DATE AND ADDRESS OF DELIVERY WITH RESTRICTED DELIVERY		¢	
TOTAL POSTAGE AND FEES		\$ 1.80	
POSTMARK OR DATE		BLOOMFIELD, N.M. APR 1976	

PS Form 3800, Apr. 1976

P21 7086569

RECEIPT FOR CERTIFIED MAIL

NO INSURANCE COVERAGE PROVIDED—
NOT FOR INTERNATIONAL MAIL
Nav. Ind. 6-8 (See Reverse)

SENT TO		Consolidated Oil & Gas	
STREET AND NO.		Suite 1300, 1860 Lincoln ST	
P.O., STATE AND ZIP CODE		Denver, Colo. 80295	
POSTAGE		\$ 1.80	
CONSULT POSTMASTER FOR FEES	OPTIONAL SERVICES	CERTIFIED FEE	75¢
		SPECIAL DELIVERY	60¢
		RESTRICTED DELIVERY	¢
	RETURN RECEIPT SERVICE	SHOW TO WHOM AND DATE DELIVERED	¢
		SHOW TO WHOM, DATE, AND ADDRESS OF DELIVERY	¢
		SHOW TO WHOM AND DATE DELIVERED WITH RESTRICTED DELIVERY	¢
SHOW TO WHOM, DATE AND ADDRESS OF DELIVERY WITH RESTRICTED DELIVERY		¢	
TOTAL POSTAGE AND FEES		\$ 1.80	
POSTMARK OR DATE		BLOOMFIELD, N.M. APR 1976	

PS Form 3800, Apr. 1976

P21 7086570

RECEIPT FOR CERTIFIED MAIL

NO INSURANCE COVERAGE PROVIDED—
NOT FOR INTERNATIONAL MAIL
Nav. Ind. 6-8 (See Reverse)

SENT TO		Tenneco Inc.	
STREET AND NO.		720 S. Colorado Blvd.	
P.O., STATE AND ZIP CODE		Denver, Colo. 80222	
POSTAGE		\$ 1.80	
CONSULT POSTMASTER FOR FEES	OPTIONAL SERVICES	CERTIFIED FEE	75¢
		SPECIAL DELIVERY	60¢
		RESTRICTED DELIVERY	¢
	RETURN RECEIPT SERVICE	SHOW TO WHOM AND DATE DELIVERED	¢
		SHOW TO WHOM, DATE, AND ADDRESS OF DELIVERY	¢
		SHOW TO WHOM AND DATE DELIVERED WITH RESTRICTED DELIVERY	¢
SHOW TO WHOM, DATE AND ADDRESS OF DELIVERY WITH RESTRICTED DELIVERY		¢	
TOTAL POSTAGE AND FEES		\$ 1.80	
POSTMARK OR DATE		BLOOMFIELD, N.M. APR 1976	

PS Form 3800, Apr. 1976