

|||  
dp  
|||

dugan production corp.

June 24, 1981

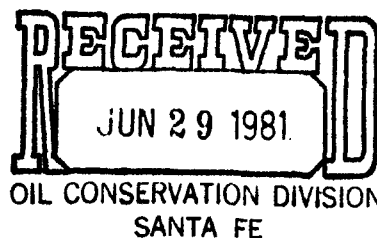

Joe D. Ramey  
Division Director  
New Mexico Oil Conservation Division  
P. O. Box 2088  
Santa Fe, NM 87501

Re: Application for Administrative Approval of  
Unorthodox Location for Pioneer Production Corp.  
Salmon #1E, Sec 30, T29N R11W  
San Juan County, NM

Dear Mr. Ramey:

Enclosed please find three copies of the Application for Administrative Approval of the Unorthodox Location for the above-referenced well, which application includes a plat showing the ownership of all leases offsetting this spacing unit for which the unorthodox location is sought, and all wells completed thereon, and a plat showing the existent topographical conditions of the well location. Also enclosed are copies of the dedicated acreage plat.

Copies of this application are being submitted to all offsetting operators by certified mail with a request that they furnish your office with a waiver of objection.

Please advise if you need further information.

Sincerely,

*Jerome P. McHugh Jr.*

Jerome P. McHugh Jr.  
Agent for Applicant

fp

Enclosures

cc: Pioneer Production Corp.

NSL 1382  
Rule 3 Basin Dakota  
July 19, 1981  
see spec for detail

Joe D. Ramey  
June 24, 1981  
Page 2

xc: Frank Chavez  
New Mexico Oil Conservation Division  
1000 Rio Brazos Road  
Aztec, NM 87410

James Sims  
U.S. Geological Survey  
P O Drawer 600  
Farmington, NM 87401

Mobil Oil Corp.  
Attn: Exploratrion Manager  
P O Box 5444  
Denver, CO 80217

Southland Royalty Co.  
P O Drawer 570  
Farmington, NM 87401

Supron Energy Corp.  
Box 808  
Farmington, NM 87401

Pioneer Production Corp.  
Box 2542  
Amarillo, TX 79189

APPLICATION FOR ADMINISTRATIVE  
OF UNORTHODOX LOCATION

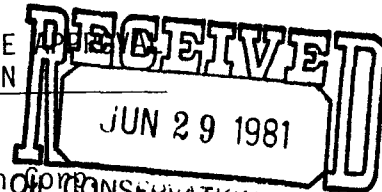

Applicant:

Pioneer Production Corp.  
P O Box 208  
Farmington, NM 87401

NEW MEXICO OIL CONSERVATION DIVISION  
SANTA FE

Name of Well:

Salmon #1E

Land Dedicated to the Well:

Township 29 North Range 11 West Section 30 E/2  
San Juan County, NM 320 acres

Proposed Unorthodox Location:

580' FNL - 1440' FEL  
Sec 30 T29N R11W  
San Juan County, NM

*Basin Dakota Pool*

Reason for Unorthodox Location: Topographical conditions in the NE/4 of Section 30: The marshy area north of the San Juan River, cultivated farmland, the steep ridge running through unit letter B; in addition, Salmon Ruins and residential dwellings prohibit an orthodox location.

Offsetting Leases and Operators  
and Well Completions:

See Exhibit "A", attached hereto and incorporated herein by reference.

Existent Topographical Conditions:

See Exhibits "B" & "C", attached hereto and incorporated herein by reference.

New Mexico Oil Conservation Division

Rule Authorizing Application:

Rule 104-F

BY: Jim L. Jacobs

Jim L. Jacobs, Agent

OFFSETTING OPERATORS

Southland Royalty Co.  
Sec 19 T29N R17W S/2

Supron Energy Corp.  
Sec 20 T29N R17W SW/4

Mobil Oil Corp.  
Sec 30 T29N R17W W/2

Pioneer Production Corp.  
Salmon #1E  
San Juan County, NM

Application for Administrative  
Approval of Unorthodox Location

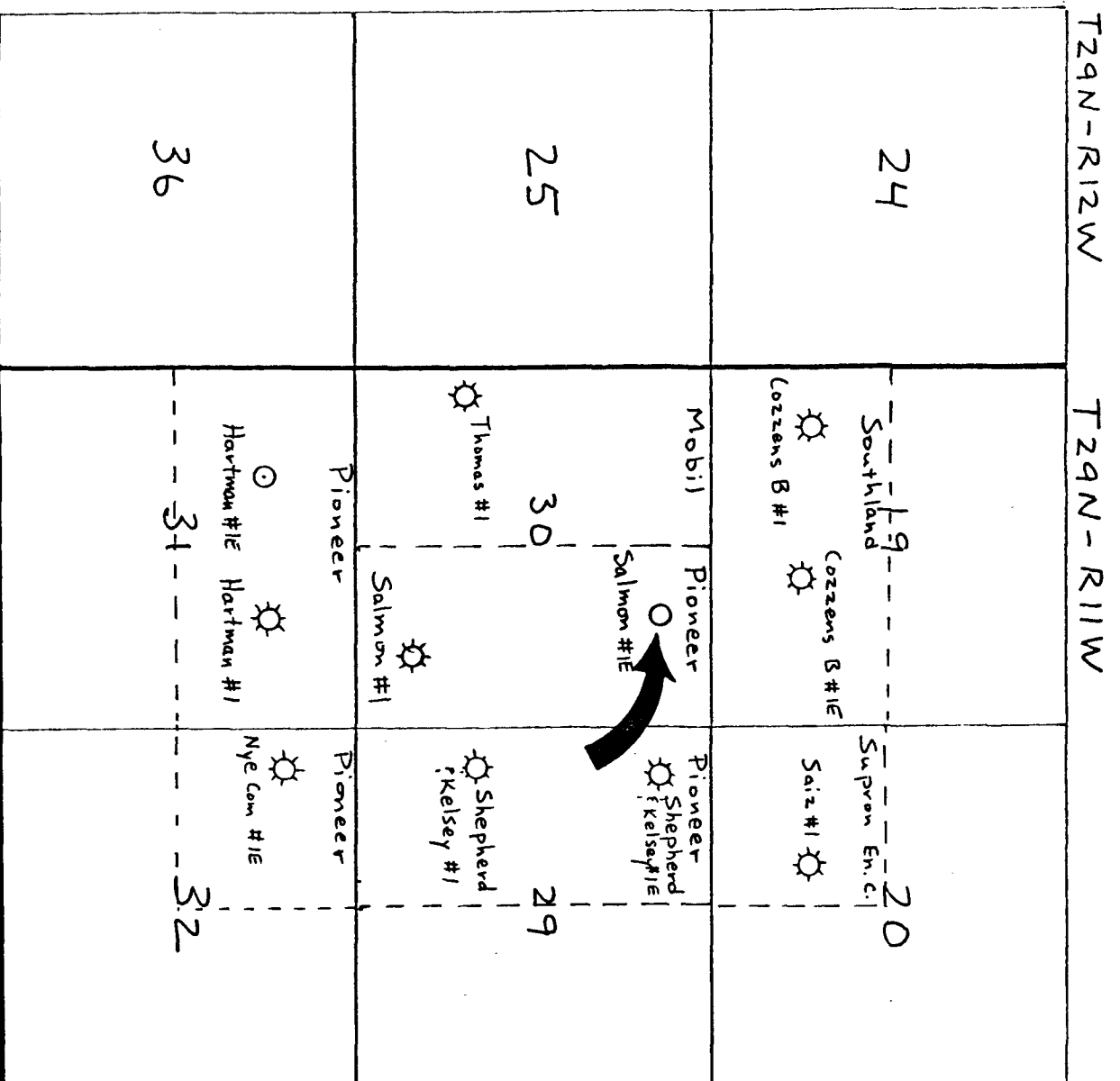

EXHIBIT "A"

## OIL CONSERVATION DIVISION

STATE OF NEW MEXICO  
ENERGY AND MINERALS DEPARTMENTP. O. BOX 2088  
SANTA FE, NEW MEXICO 87501Form C-102  
Revised 10-1-78

All distances must be from the outer boundaries of the Section.

Operator Pioneer Production		Lease Salmon		Well No. 1E	
Unit Letter B	Section 30	Township 29 North	Range 11 West	County San Juan	
Actual Footage Location of Well:					
580	feet from the	North	line and	1440	feet from the East line
Ground Level Elev. 5462	Producing Formation Dakota		Pool Basin Dakota		Dedicated Acreage: 320 Acres

1. Outline the acreage dedicated to the subject well by colored pencil or hachure marks on the plat below.
2. If more than one lease is dedicated to the well, outline each and identify the ownership thereof (both as to working interest and royalty).  
NA
3. If more than one lease of different ownership is dedicated to the well, have the interests of all owners been consolidated by communitization, unitization, force-pooling, etc?

☐ Yes ☐ No If answer is "yes," type of consolidation \_\_\_\_\_

If answer is "no," list the owners and tract descriptions which have actually been consolidated. (Use reverse side of this form if necessary.) \_\_\_\_\_

No allowable will be assigned to the well until all interests have been consolidated (by communitization, unitization, forced-pooling, or otherwise) or until a non-standard unit, eliminating such interests, has been approved by the Division.

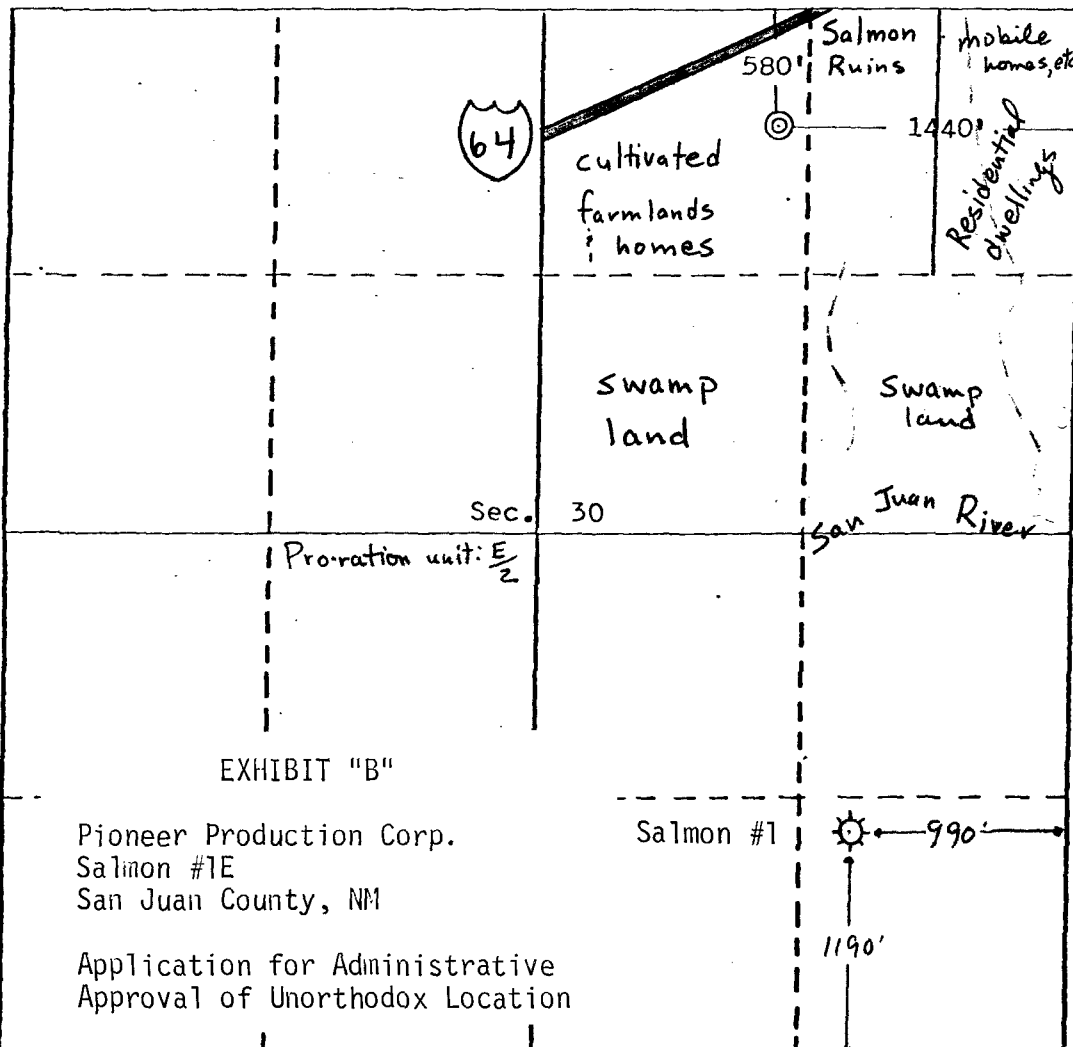

## CERTIFICATION

I hereby certify that the information contained herein is true and complete to the best of my knowledge and belief.

*Jerome P. McHugh Jr.*  
None  
Jerome P. McHugh Jr.

Position  
Landman

Company  
Dugan Production Corp.

Date  
6-24-81

I hereby certify that the location shown on this plat is from field notes of actual survey made by me or under my supervision, and that the same is true and correct to the best of my knowledge and belief.

Date Surveyed  
June 5, 1981

Registered Professional Engineer  
and/or Land Surveyor

*Edgar L. Risenhoover*

Certificate No. 5979  
Edgar L. Risenhoover, L.S.



*Waiver*

APPLICATION FOR ADMINISTRATIVE APPROVAL  
OF UNORTHODOX LOCATION

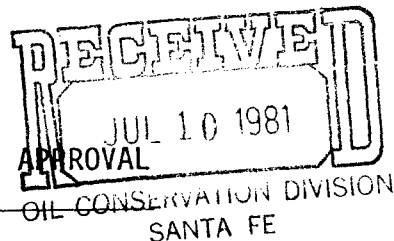

Applicant: Pioneer Production Corp.  
P O Box 208  
Farmington, NM 87401

Name of Well: Salmon #1E

Land Dedicated to the Well: Township 29 North Range 11 West Section 30 E/2  
San Juan County, NM 320 acres

Proposed Unorthodox Location: 580' FNL - 1440' FEL  
Sec 30 T29N R11W  
San Juan County, NM

Reason for Unorthodox Location: Topographical conditions in the NE/4 of  
Section 30: The marshy area north of the San Juan River, cultivated  
farmland, the steep ridge running through unit letter B; in addition,  
Salmon Ruins and residential dwellings prohibit an orthodox location.

Offsetting Leases and Operators  
and Well Completions: See Exhibit "A", attached hereto and incorporated  
herein by reference.

Existent Topographical Conditions:  
See Exhibits "B" & "C", attached hereto and  
incorporated herein by reference.

New Mexico Oil Conservation Division  
Rule Authorizing Application:  
Rule 104-F

BY: Jim L. Jacobs  
Jim L. Jacobs, Agent

Waiver:

Supron Energy Corporation hereby acknowledges receipt of the  
Application for Administrative Approval of Unorthodox Location filed by  
Pioneer Production Corporation herein and hereby waives objection to  
Pioneer Production Corporation's Application for Administrative  
Approval of Unorthodox Location for their Salmon 1-E  
Well as proposed herein.

BY: Aug. A. Lee  
DATE: 5/6/81

APPLICATION FOR ADMINISTRATIVE APPROVAL  
OF UNORTHODOX LOCATION

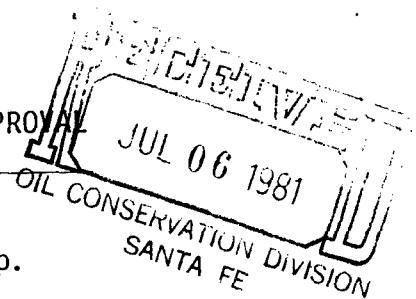

Applicant: Pioneer Production Corp.  
P O Box 208  
Farmington, NM 87401

Name of Well: Salmon #1E

Land Dedicated to the Well: Township 29 North Range 11 West Section 30 E/2  
San Juan County, NM 320 acres

Proposed Unorthodox Location: 580' FNL - 1440' FEL  
Sec 30 T29N R11W  
San Juan County, NM

Reason for Unorthodox Location: Topographical conditions in the NE/4 of Section 30: The marshy area north of the San Juan River, cultivated farmland, the steep ridge running through unit letter B; in addition, Salmon Ruins and residential dwellings prohibit an orthodox location.

Offsetting Leases and Operators  
and Well Completions: See Exhibit "A", attached hereto and incorporated herein by reference.

Existent Topographical Conditions:  
See Exhibits "B" & "C", attached hereto and incorporated herein by reference.

New Mexico Oil Conservation Division  
Rule Authorizing Application:  
Rule 104-F

BY: Jim L. Jacobs  
Jim L. Jacobs, Agent

Waiver:

MOBILE PETROLEUM PRODUCTS & SERVICES  
Application for Administrative Approval of Unorthodox Location filed by above hereby acknowledges receipt of the  
their Application for Administrative Approval of Unorthodox Location for their #1E Well as proposed herein.

BY: J. A. Morris  
DATE: 7/2/81





STATE OF NEW MEXICO  
ENERGY AND MINERALS DEPARTMENT

OIL CONSERVATION DIVISION  
AZTEC DISTRICT OFFICE

1000 RIO BRAZOS ROAD  
AZTEC, NEW MEXICO 87410  
(505) 334-6178

OIL CONSERVATION DIVISION  
BOX 2088  
SANTA FE, NEW MEXICO 87501

DATE July 17, 1981

RE: Proposed MC \_\_\_\_\_  
Proposed DHC \_\_\_\_\_  
Proposed NSL ✓ \_\_\_\_\_  
Proposed SWD \_\_\_\_\_  
Proposed WFX \_\_\_\_\_  
Proposed PMX \_\_\_\_\_

Gentlemen:

I have examined the application dated June 29, 1981

for the Pioneer Production Co.  
Operator

Salmon #1E  
Lease and Well No.

B-30-29N-11W  
Unit, S-T-R

and my recommendations are as follows:

Approve

Yours truly,

Jeff A. Schuster

