

July 27, 1981



NS ✓ - 1412 ✓  
Rule 104 F  
Abso Gas  
9-2-81

Joe D. Ramey, Director  
New Mexico Oil Conservation Division  
P. O. Box 2088  
Santa Fe, New Mexico 87501

Dear Mr. Ramey:

Subject: Mesa Petroleum Co.  
Alkalai Federal #1  
660' FSL & 400' FWL  
SEC 33, T5S, R25E  
Chaves County, New Mexico

Application is hereby made for administrative approval of an unorthodox location for subject well due to the presence of archaeological material at the 660' X 660' location and points North and East thus preventing moving of the well to alternate orthodox locations.

Exhibit I is an area land map showing offset operators and Exhibit II is the Archeological report outlining the necessity for moving the location. Offset Operators have been provided with a copy of this letter.

Expeditious handling of this request and issuance of appropriate administrative order is appreciated.

Yours truly,

A handwritten signature in cursive script that reads 'R. E. Mathis'.

R. E. Mathis  
Regulatory Coordinator

REM/pm

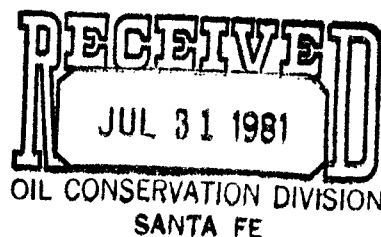

XC: YATES, MC CLELLAN, PLE, USGS, TLS, MEC, ROSWELL, LAND, FILE

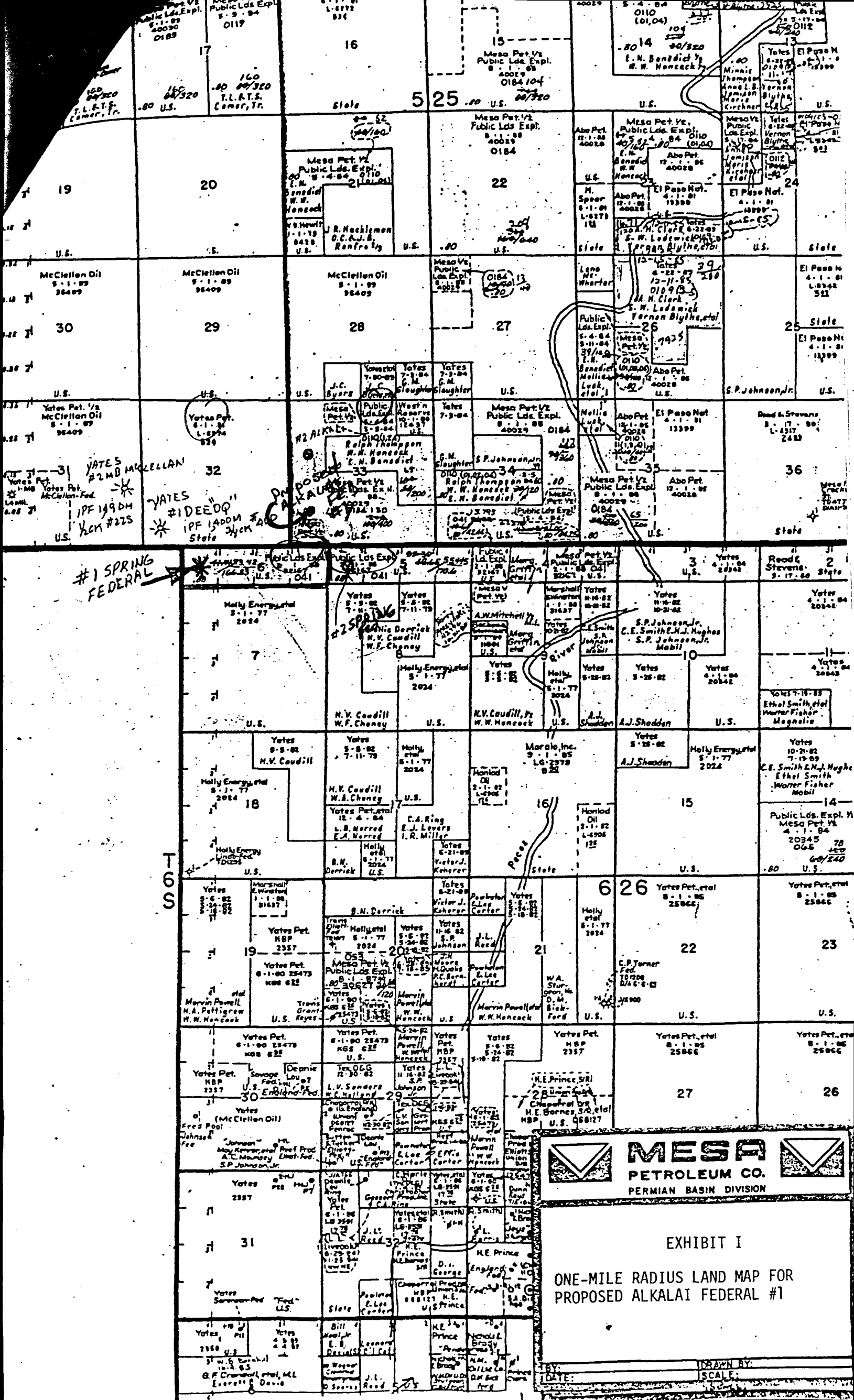



# NMAS

## New Mexico Archaeological Services, Inc.

P. O. Box 1341  
Carlsbad, New Mexico 88220  
(505) 887-7646

23 July 1981

Reconnaissance  
Excavation  
Analysis  
Explanation  
Curation

Mr. R.E. Mathis  
Regulatory Coordinator  
MESA PETROLEUM CO.  
1000 Vaughn Building  
Midland, Texas 79701

Dear Mr. Mathis:

Enclosed please find NMAS' Archaeological Clearance Report for MESA PETROLEUM CO.'s Alkali Federal Com. Well No. 1 and its associated access road in Chaves County, New Mexico. One archaeological site, NMAS 5158, was recorded during this reconnaissance. NMAS is *suggesting* clearance for this project *provided the archaeologically sensitive area is avoided*.

If you have any questions pertaining to this report, please call my office. Thank you for asking NMAS to do this reconnaissance.

Yours sincerely,

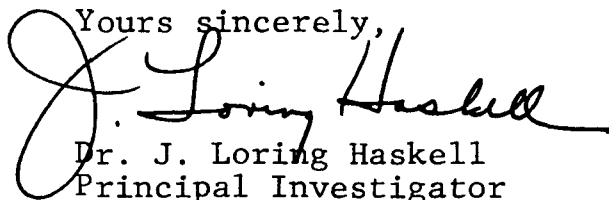
  
Dr. J. Loring Haskell  
Principal Investigator

Enclosure

cc: Ms. Ann Ramage, BLM, Roswell  
Mr. George Stewart, USGS, Roswell  
Mr. Curtis Schaafsma, Laboratory of Anthropology,  
Santa Fe  
Mr. Thomas W. Verlan, SHPO, Santa Fe

as

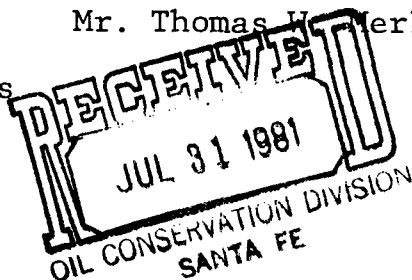

EXHIBIT II

Archaeological Clearance Report

for

MESA PETROLEUM CO.

Alkali Federal Com. Well No. 1

Prepared

By

Dr. J. Loring Haskell

Submitted

By

Dr. J. Loring Haskell  
Principal Investigator  
New Mexico Archaeological Services, Inc.  
Carlsbad, New Mexico

23 July 1981

Permit No. 80-NM-193

## ABSTRACT

New Mexico Archaeological Services, Inc., representing MESA PETROLEUM CO., Midland, an archaeological reconnaissance of Bureau of Land Management lands scheduled to be impacted by the construction of a drill location and its accompanying access road. The investigated areas are situated in Section 33, T5S, R25E, NMPM, Chaves County, New Mexico. One archaeological site, NMAS 5158, was recorded during this reconnaissance. Clearance is *suggested provided the archaeologically sensitive area is avoided.*

## Introduction

On 10 July 1981, New Mexico Archaeological Services, Inc., (NMAS), Carlsbad, undertook for MESA PETROLEUM CO., Midland, an archaeological reconnaissance of federal lands administered by the Bureau of Land Management in Chaves County, New Mexico. The reconnoitered area will be impacted by the construction of a drill location and its associated access road. This project was advanced by Mr. Lloyd Reed, Regulatory Coordinator, MESA PETROLEUM CO., and administered by Dr. J. Loring Haskell, Principal Investigator, NMAS, Inc. This reconnaissance was undertaken by Dr. Haskell, and Mr. Rodric McLean.

## Survey Technique

For this investigation, MESA PETROLEUM's proposed location was reconnoitered for evidence of man's past activities by walking it in a series of 25 ft wide, close interval (15° or less), zigzag transects. In addition an added zone embracing to 20 ft on each side of the staked 400 X 400 ft location, and hence lying outside the bounds of the proposed work area, was reconnoitered by a similar means. As for the access road, it was walked in two 25 ft wide transects. Methodologically, this procedure served to promote optimal conditions for the visual examination of areas to be impacted by construction-related activities.

Alkali Federal Com. Well No. 1

## Location

The proposed location will measure 400 X 400 ft on federal lands and will be situated 660 ft from the south line and 400 ft from the west line of:

Section 33, T5S, R25E, NMPM, Chaves County, NM

Thus it will be situated in the:

SW $\frac{1}{4}$ SW $\frac{1}{4}$ , Section 33, T5S, R25E, NMPM, Chaves County, NM

The associated access road will measure 20 X 1700 ft and will be situated in the:

SW $\frac{1}{4}$ SW $\frac{1}{4}$ , Section 33, T5S, R25E, NMPM, Chaves County, NM

SE $\frac{1}{4}$ SE $\frac{1}{4}$ , Section 32, T5S, R25E, NMPM, Chaves County, NM

Map Reference: USGS COTTONWOOD QUADRANGLE, 7.5 Minute Series, 1967.

### Terrain

MESA's proposed location will be situated near the crest of a generally east-west oriented ridge system overlain by a veneer of silty clay loams and clay loams. Soil individuals have developed from limestone and gypsum parent material. Overall, this landform is subject to ephemeral sheetwash. Chert and quartzite cobbles and gravels are present on a sporadic bases. Pedons belong to the Calcic Gypsiorthid subgroup and its intergrades.

### Floristics

Principal plants making up the floral community's overstory are *Prosopis juliflora* and *Yucca glauca*. Associated forbs include *Gutierrezia sarothrae*, *Croton* sp., *Lesquerella* sp., *Perezia nana*, *Penstemon* sp., and *Sartwellia* sp. The Gamineae is represented by *Aristida* sp., *Hilaria mutica*, and *Tridens pulchellus*.

### Cultural Resources

During the course of this reconnaissance, one archaeological site, NMAS 5158, was recorded.

NMAS 5158

Location: W $\frac{1}{2}$ NE $\frac{1}{4}$ SW $\frac{1}{4}$ SW $\frac{1}{4}$ : NW $\frac{1}{4}$ SE $\frac{1}{4}$ SW $\frac{1}{4}$ SW $\frac{1}{4}$ : NE $\frac{1}{4}$ SW $\frac{1}{4}$ SW $\frac{1}{4}$ SW $\frac{1}{4}$ : E $\frac{1}{2}$ NW $\frac{1}{4}$ SW $\frac{1}{4}$ SW $\frac{1}{4}$ ,  
Section 33, T5S, R25E, NMPM, Chaves County, NM

UTM: Zone 13, N3,742,480; E562,100

Map Reference: USGS COTTONWOOD DRAW QUADRANGLE, 7.5 Minute Series,  
1967.

Ownership: Bureau of Land Management Administration

Dimension of Resources: 90 X 180 m

Typological Designation: Task Locus

Temporality: Unknown

Nature of Cultural Resources: NMAS 5158, a large task locus, is situated immediately below the crest of a prominent ridge overlain by fine-textured soils. Within the bounds of the area embraced by the site's universal, sheetwash has exposed a rich scree of potentially knappable chert and quartzite lithic material. Observed resources consist of large numbers of chert and quartzite primary and secondary decortication flakes, numerous chert and quartzite cores, primary and secondary basalt decortication flakes, chert and quartzite exhausted cores, chert and quartzite hammerstones, a chert scraper, three piles of chert and quartzite cobbles (deliberately collected), and numerous chert and quartzite spalls. Resources are concentrated and hence this site has been termed a task locus. Tasks performed at NMAS 5158 focused exclusively on flaked-tool manufacture. Owing to the large amount of detritus, repeated usage is certain. Its temporal parameters cannot be established owing to an absence of diagnostic artifactual remains. This site is of obvious importance owing to its size and the intensity of its usage.

If examined further, this site should illuminate our understanding of flaked-tool manufacturing in the Middle Pecos Valley, i.e., preferences, if any, of material actually utilized, the means of flake detachment, and whether or not it functioned primarily as a site

for roughing out tools, finishing them, or a combination of these tasks.

Recommendations

NMAS recommends clearance for MESA PETROLEUM's proposed Alkali Federal Com. Well No. 1 *provided the archaeologically sensitive area lying to the east and northeast and north is avoided.* Clearance, of course, is granted by the Bureau of Land Management.

R-25-E

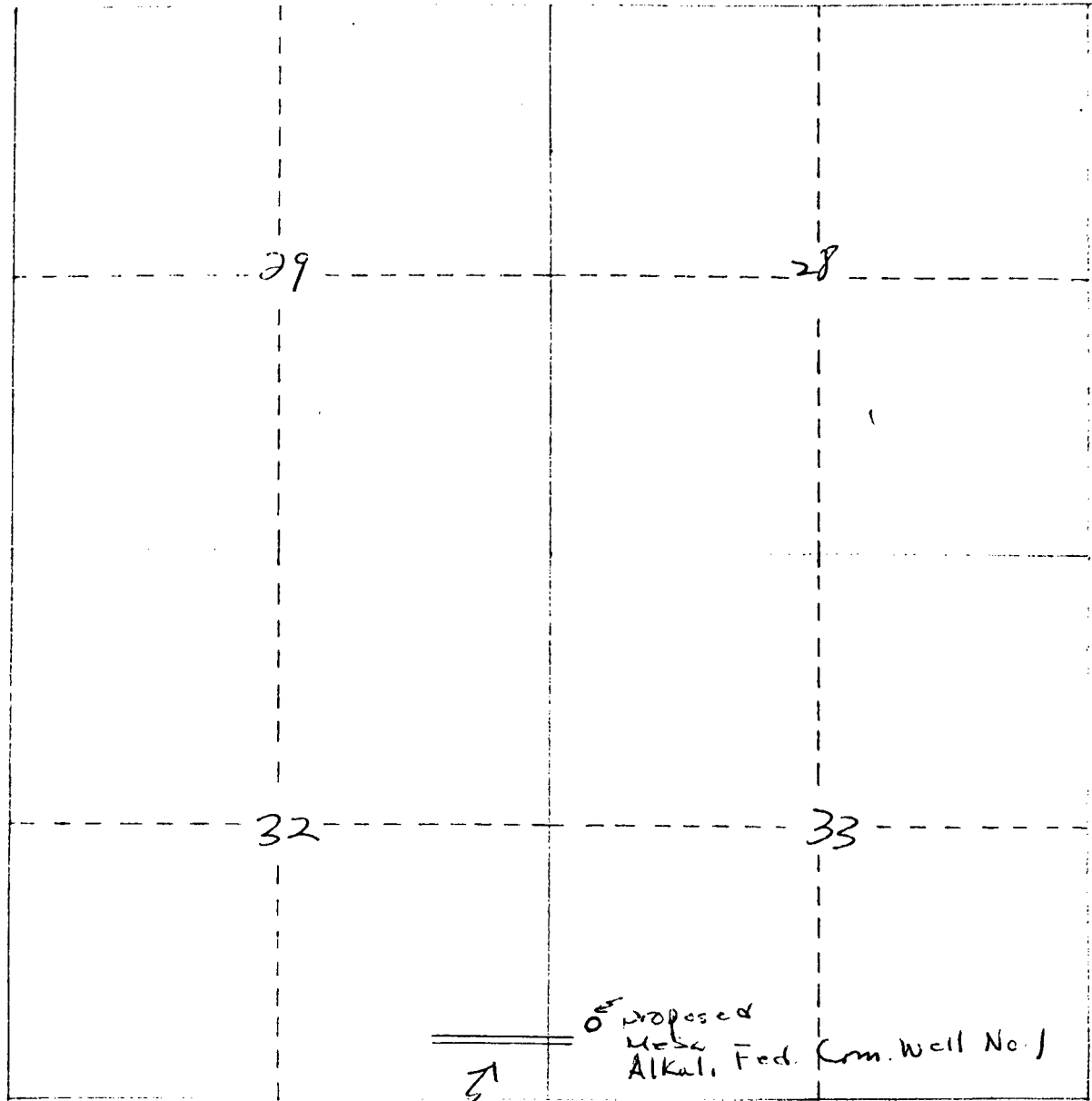

T-5-S

Proposed  
Access Road

August 12, 1981



R. L. Stamets, Technical Support Chief  
New Mexico Oil Conservation Division  
P. O. Box 2088  
Santa Fe, New Mexico 87501

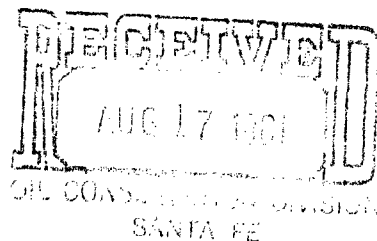

Gentlemen:

Subject: ALKALI FEDERAL #1  
SEC 33, T5S, R25E  
CHAVES COUNTY, NEW MEXICO

Per your request dated 8-3-81, attached are copies of certified mail receipts to Offset Operators of subject well notifying them of the unorthodox location.

Subject well is an Abo development well and 160 acres from the SW/4 of Sec. 33 are dedicated to it.

Yours truly,

A handwritten signature in cursive script, appearing to read 'R. E. Mathis', followed by a horizontal line.

R. E. Mathis  
Regulatory Coordinator

REM/pm

No. 655858

# RECEIPT FOR CERTIFIED MAIL—30¢ (plus postage)

SENT TO YATES PETROLEUM CO.		POSTMARK OR DATE  8-12-81
STREET AND NO. 207 SOUTH 4TH		
P.O., STATE AND ZIP CODE ARTESIA NM 88210		
OPTIONAL SERVICES FOR ADDITIONAL FEES		
RETURN RECEIPT SERVICES	<div>▶</div> <div>1. Shows to whom and date delivered ..... 15¢ With restricted delivery ..... 65¢ 2. Shows to whom, date and where delivered ... 35¢ With restricted delivery ..... 85¢</div>	
RESTRICTED DELIVERY ..... 50¢		
SPECIAL DELIVERY (extra fee required) .....		

PS Form 3800 Aug. 1975 NO INSURANCE COVERAGE PROVIDED— (See other side)  
NOT FOR INTERNATIONAL MAIL ☆ GPO: 1975—O-591-452

No. 909946

# RECEIPT FOR CERTIFIED MAIL

SENT TO PUBLIC LANDS EXPLORATION INC		POSTMARK OR DATE 8-12-81
STREET AND NO. 4835 LBJ FREEWAY SUITE 635		
P.O., STATE AND ZIP CODE DALLAS TX 75234		
OPTIONAL SERVICES FOR ADDITIONAL FEES		
RETURN RECEIPT SERVICES	<div>▶</div> <div>1. Shows to whom and date delivered ..... With restricted delivery ..... 2. Shows to whom, date and where delivered ..... With restricted delivery .....</div>	CONSULT POSTMASTER FOR FEES
RESTRICTED DELIVERY .....		
SPECIAL DELIVERY (extra fee required) .....		

PS Form 3800 Jan. 1976 NO INSURANCE COVERAGE PROVIDED— (See other side)  
NOT FOR INTERNATIONAL MAIL ☆ GPO: 1975—O-591-452

No. 909945

# RECEIPT FOR CERTIFIED MAIL

SENT TO MCCLELLAND OIL COMPANY		POSTMARK OR DATE 8-12-81
STREET AND NO. P O DRAWER 730		
P.O., STATE AND ZIP CODE ROSWELL NM 88201		
OPTIONAL SERVICES FOR ADDITIONAL FEES		
RETURN RECEIPT SERVICES	<div>▶</div> <div>1. Shows to whom and date delivered ..... With restricted delivery ..... 2. Shows to whom, date and where delivered ..... With restricted delivery .....</div>	CONSULT POSTMASTER FOR FEES
RESTRICTED DELIVERY .....		
SPECIAL DELIVERY (extra fee required) .....		

PS Form 3800 Jan. 1976 NO INSURANCE COVERAGE PROVIDED— (See other side)  
NOT FOR INTERNATIONAL MAIL ☆ GPO: 1975—O-591-452



STATE OF NEW MEXICO  
ENERGY AND MINERALS DEPARTMENT  
OIL CONSERVATION DIVISION

August 3, 1981

BRUCE KING  
GOVERNOR  
LARRY KEHOE  
SECRETARY

POST OFFICE BOX 2088  
STATE LAND OFFICE BUILDING  
SANTA FE, NEW MEXICO 87501  
(505) 827-2434

Mesa Petroleum Co.  
Vaughn Building  
Suite 1000  
Midland, Texas 79701

Re: Application for Non-Standard  
Location: Alkalai Federal No. 1  
Sec. 33, T-5-S, R-25-E, Chaves  
County, New Mexico

We may not process the subject application for non-standard location until the required information or plats checked below (is) (are) submitted.

- ☐ A plat must be submitted clearly showing the ownership of the offsetting leases.
- ☒ A statement must be submitted that offset owners have been notified of the application by certified mail.
- ☐ A plat must be submitted fully identifying the topography necessitating the non-standard location.
- ☒ Other: Please show the dedicated acreage and proposed completion formation(s).

Very truly yours,

R. L. STAMETS  
Technical Support Chief

RLS/dr