

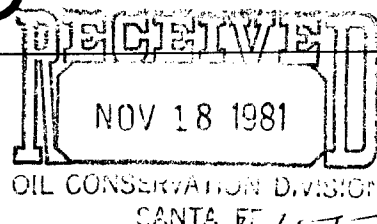

Mark K. Mosley
Division Manager
Production Department
Hobbs Division
North American Production

Conoco Inc.
P.O. Box 460
726 E. Michigan
Hobbs, NM 88240
(505) 393-4141



November 16, 1981

New Mexico Oil Conservation Division
P.O. Box 2088
Santa Fe, New Mexico 87501

Attention Mr. Dan Nutter

Gentlemen:

Unorthodox Location - Penney Federal Com. Well No. 2, Section 23, T-20S, R-24E, Eddy County, New Mexico

Order No. R-6515 authorized Conoco Inc. to drill the subject well at an unorthodox location 1650' FNL and 1980' FEL of Section 23, T-20S, R-24E, Eddy County, New Mexico. It has now been determined that the approved location is near a 6" gas line which is part of a gas gathering system in the area.

It is respectfully requested that Order No. R-6515 be amended to permit drilling this well at a location 1650' FNL and 1780' FEL of the above named section, with the E/2 still being dedicated to the well. The acreage surrounding this well is federally owned and the BLM has approved the new location.

Very truly yours,

HAI:rej
CC + enc:
Monsanto Company
1330 Midland Nat'l Bank Tower
500 West Texas
Midland, Texas 79701

Harold E. Kortz, Jr.
1605 Clover Lane
Fort Worth, Texas 76107

Belco Petroleum
411 Petroleum Bldg.
204 West Texas
Midland, Texas 79701

Roy L. McKay
P. O. Box 2014
Roswell, New Mexico 88201

Talked to Hugh Ingram 11-23-81
need topo plate, better offset map,
and certified notice. Received 12-1-81

NEW MEXICO OIL CONSERVATION COMMISSION
WELL LOCATION AND ACREAGE DEDICATION PLAT

Form C-102
Supersedes C-128
Effective 1-1-65

NOV 18 1981

All distances must be from the outer boundaries of the Section

Operator CONOCO, INC.			Lease PENNY FEDERAL			Well No. 2		
Unit Letter G	Section 23	Township 20 South	Range 24 East	County Eddy				
Actual Footage Location of Well:								
1650 feet from the North line and			1780 feet from the East line					
Ground Level Elev. 3625.1	Producing Formation Cisco Morrow	Pool South Dagger Draw Upper Penn Undesignated Cementery Morrow Gas	Dedicated Acreage: 320			320^{-res}		

1. Outline the acreage dedicated to the subject well by colored pencil or hachure marks on the plat below.
2. If more than one lease is dedicated to the well, outline each and identify the ownership thereof (both as to working interest and royalty).
3. If more than one lease of different ownership is dedicated to the well, have the interests of all owners been consolidated by communitization, unitization, force-pooling, etc?

☐ Yes ☐ No If answer is "yes," type of consolidation _____

If answer is "no," list the owners and tract descriptions which have actually been consolidated. (Use reverse side of this form if necessary.) _____

No allowable will be assigned to the well until all interests have been consolidated (by communitization, unitization, forced-pooling, or otherwise) or until a non-standard unit, eliminating such interests, has been approved by the Commission.

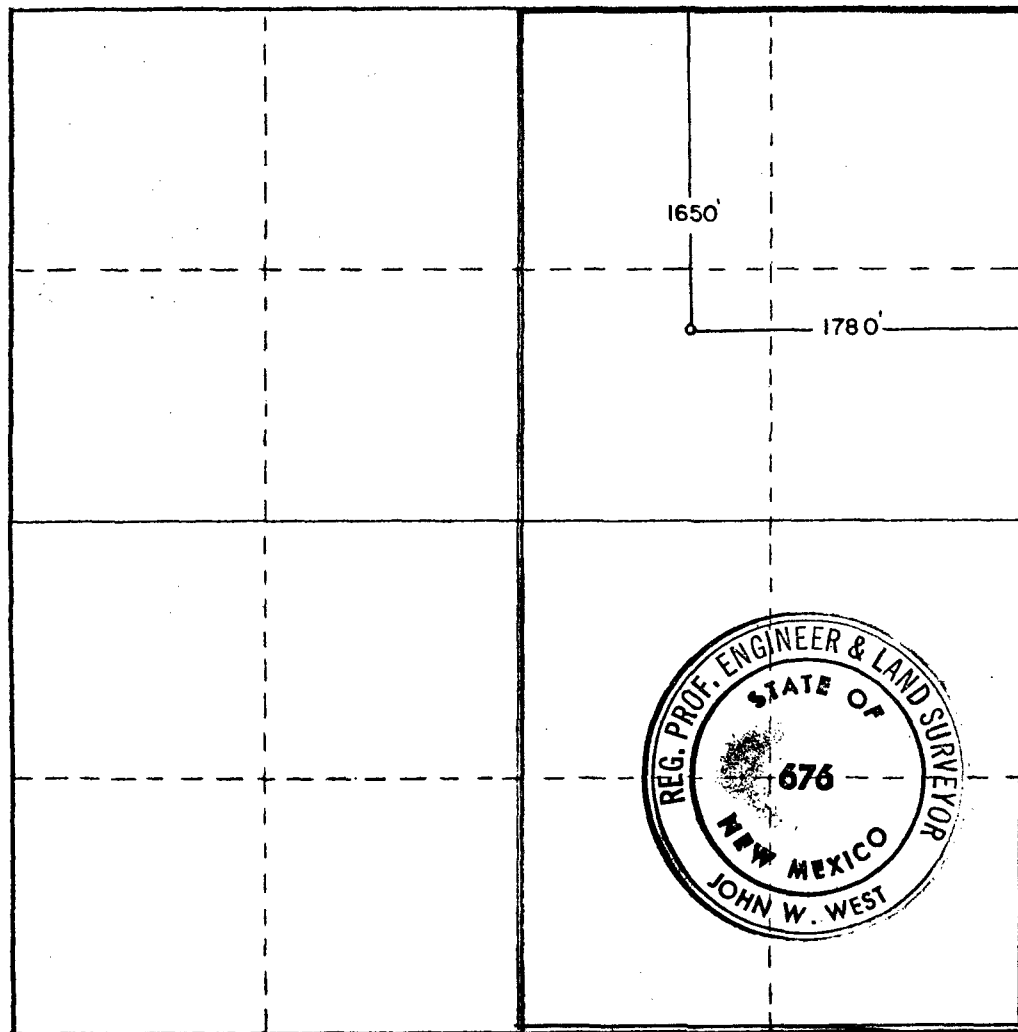

CERTIFICATION

I hereby certify that the information contained herein is true and complete to the best of my knowledge and belief.

H. A. Ingram
Name

H. A. Ingram

Position

Conservation Coordinator

Company

CONOCO INC.

Date

November 16, 1981

I hereby certify that the well location shown on this plat was plotted from field notes of actual surveys made by me or under my supervision, and that the same is true and correct to the best of my knowledge and belief.

Date Surveyed

10/10/81

Registered Professional Engineer and/or Land Surveyor

John W. West

Certificate No. **JOHN W. WEST 676**
PATRICK A. BOMER

J. Curtis 1/2
R. Nix 1/8
E. Hannigan 1/8

215934-001-003
29.688 3/4

212561
3/4

Griff.
Bura.
7-14

211134
3/4

212561
3/4

H.T. Armstrong

212561
3/4

211200
3/4

211200
3/4

211200
3/4

Com. 060
211200
3/4

HBP
HNG Oil, etal

C-40583 Com. Agr.
W/2 Sec.

C-40924 Com. Agr.
E/2 Sec.

Monsanto



Belco
11-10-80

22

23

24

Roberts, etal
4-1-82
Harold E. Kurtz, Jr.

HBP-Yates

212561
3/4

H.T. Armstrong

Open
U.S.

211200
3/4

212561
3/4

211200
3/4

211200
3/4

215951-000

Full



C-40581 Com. Agr.
W/2 Sec.

212561
3/4

211134
3/4

Roy L. McKay

212561
3/4

211134
3/4



27

26

25

211134
3/4

212561
3/4

211134
3/4

212810-
001 3/4

212810-001
3/4

(C-40916 JOA)

TXO HBP

212797-
000-3/4

211162
3/4

212810-
001 3/4

211162
3/4

C-40908-F/O N/2 Sec
C-40908-1 Com. Agr. W/2 Sec
212797-000
3/4



34

35

36

212797-000 3/4
C-40909-F/O S/2 Sec.
C-40909-1 Com. Agr. 3/2

TXO HBP

211162
3/4



R 24 E

Addressee List

Monsanto Company
1330 Midland Nat'l Bank Tower
500 West Texas
Midland, Texas 79701

Belco Petroleum
411 Petroleum Building
204 West Texas
Midland, Texas 79701

Dorothy Langley
7777 Forest Lane
Suite 309
Dallas, Texas 75230

Ralph Nix
Box 617
101 South 7th
Artesia, New Mexico 88210

United States Geological Survey
Drawer 1857
Roswell, New Mexico 88201

Harold E. Kurtz, Jr.
1605 Clover Lane
Fort Worth, Texas 76107

Roy L. McKay
P.O. Box 2014
Roswell, New Mexico 88201

Hepburn T. Armstrong
31877 Del Obisto Street
No. 212D
San Juan Capistrano, CA 92675

Texas Oil & Gas Corporation
900 Wilco Building
Midland, Texas 79701

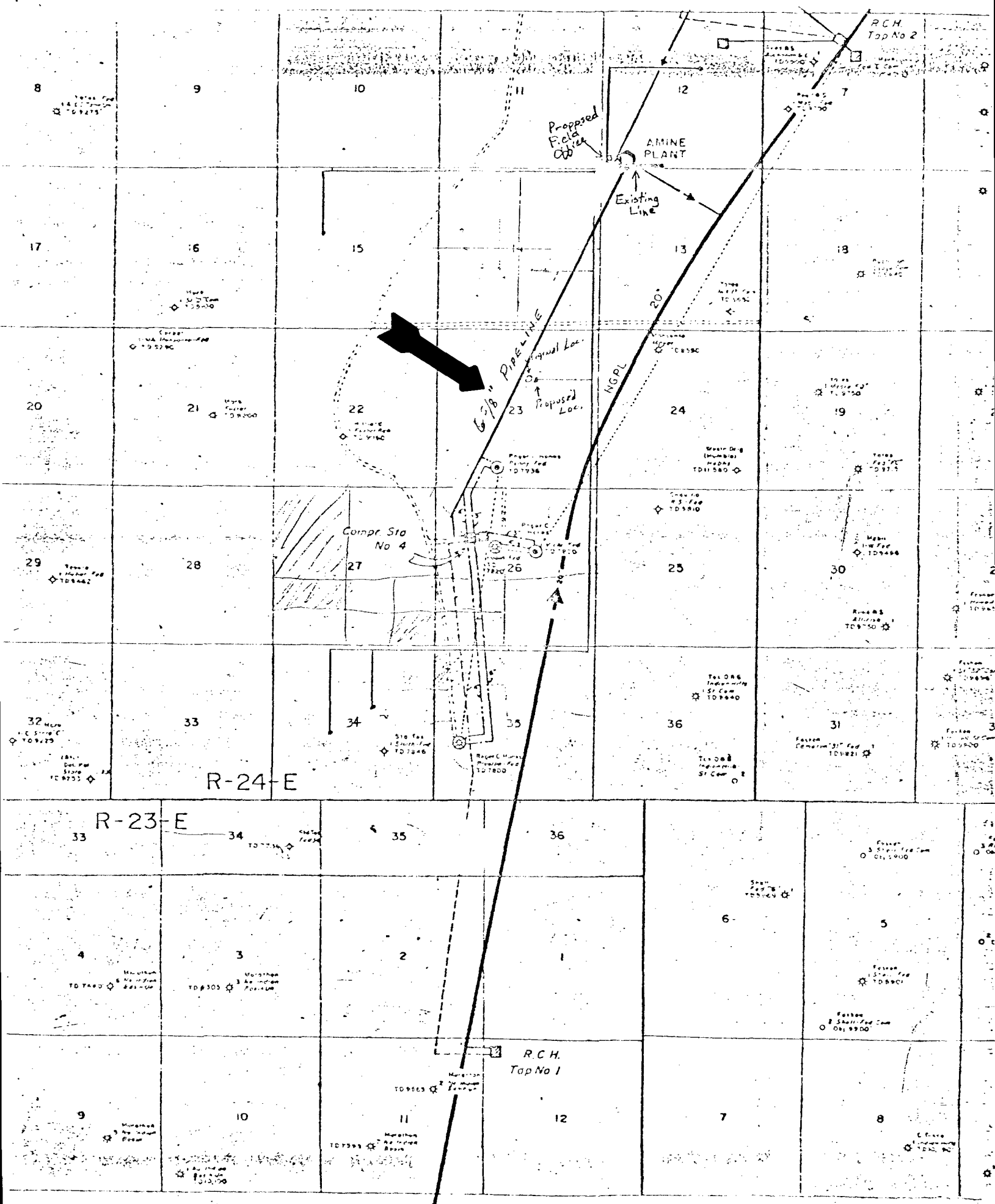

No. 419751

RECEIPT FOR CERTIFIED MAIL—30¢ (plus postage)

SENT TO <i>Texas Oil & Gas Corp.</i>		POSTMARK OR DATE <i>11/24/81</i>
STREET AND NO. <i>900 Wilco Bldg</i>		
P.O., STATE AND ZIP CODE <i>Midland, TX 79701</i>		
OPTIONAL SERVICES FOR ADDITIONAL FEES		
RETURN RECEIPT SERVICES	1. Shows to whom and date delivered 15¢ With delivery to addressee only 65¢ 2. Shows to whom, date and where delivered .. 35¢ With delivery to addressee only 85¢	
DELIVER TO ADDRESSEE ONLY 50¢		
SPECIAL DELIVERY (extra fee required)		

PS Form 3800
Apr. 1971NO INSURANCE COVERAGE PROVIDED—
NOT FOR INTERNATIONAL MAIL

(See other side)

* GPO : 1972 O - 460-743

No. 419750

RECEIPT FOR CERTIFIED MAIL—30¢ (plus postage)

SENT TO <i>Hedburn T. Armstrong</i>		POSTMARK OR DATE <i>11/24/81</i>
STREET AND NO. <i>31877 Del Obispo St. # 212 W</i>		
P.O., STATE AND ZIP CODE <i>San Juan Capistrano, CA 92675</i>		
OPTIONAL SERVICES FOR ADDITIONAL FEES		
RETURN RECEIPT SERVICES	1. Shows to whom and date delivered 15¢ With delivery to addressee only 65¢ 2. Shows to whom, date and where delivered .. 35¢ With delivery to addressee only 85¢	
DELIVER TO ADDRESSEE ONLY 50¢		
SPECIAL DELIVERY (extra fee required)		

PS Form 3800
Apr. 1971NO INSURANCE COVERAGE PROVIDED—
NOT FOR INTERNATIONAL MAIL

(See other side)

* GPO : 1972 O - 460-743

No. 419744

RECEIPT FOR CERTIFIED MAIL—30¢ (plus postage)

SENT TO <i>Belco Petroleum</i>		POSTMARK OR DATE <i>11/24/81</i>
STREET AND NO. <i>411 Petroleum Bldg</i>		
P.O., STATE AND ZIP CODE <i>Midland, TX 79701</i>		
OPTIONAL SERVICES FOR ADDITIONAL FEES		
RETURN RECEIPT SERVICES	1. Shows to whom and date delivered 15¢ With delivery to addressee only 65¢ 2. Shows to whom, date and where delivered .. 35¢ With delivery to addressee only 85¢	
DELIVER TO ADDRESSEE ONLY 50¢		
SPECIAL DELIVERY (extra fee required)		

PS Form 3800
Apr. 1971NO INSURANCE COVERAGE PROVIDED—
NOT FOR INTERNATIONAL MAIL

(See other side)

* GPO : 1972 O - 460-743

No. 419749

RECEIPT FOR CERTIFIED MAIL—30¢ (plus postage)

SENT TO <i>Roy L. McKay</i>		POSTMARK OR DATE <i>11/24/81</i>
STREET AND NO. <i>P.O. Box 2014</i>		
P.O., STATE AND ZIP CODE <i>Roswell, NM 88201</i>		
OPTIONAL SERVICES FOR ADDITIONAL FEES		
RETURN RECEIPT SERVICES	1. Shows to whom and date delivered 15¢ With delivery to addressee only 65¢ 2. Shows to whom, date and where delivered .. 35¢ With delivery to addressee only 85¢	
DELIVER TO ADDRESSEE ONLY 50¢		
SPECIAL DELIVERY (extra fee required)		

PS Form 3800
Apr. 1971NO INSURANCE COVERAGE PROVIDED—
NOT FOR INTERNATIONAL MAIL

(See other side)

* GPO : 1972 O - 460-743

RECEIPT FOR CERTIFIED MAIL—30¢ (plus postage)

SENT TO <i>Dorothy Langley</i>		POSTMARK OR DATE <i>11/24/81</i>
STREET AND NO. <i>7777 Forest Lane - Suite 309</i>		
P.O., STATE AND ZIP CODE <i>Dallas, TX 75230</i>		
OPTIONAL SERVICES FOR ADDITIONAL FEES		
RETURN RECEIPT SERVICES	1. Shows to whom and date delivered 15¢ With delivery to addressee only 65¢ 2. Shows to whom, date and where delivered .. 35¢ With delivery to addressee only 85¢	
DELIVER TO ADDRESSEE ONLY 50¢		
SPECIAL DELIVERY (extra fee required)		
PS Form 3900 Apr. 1971		NO INSURANCE COVERAGE PROVIDED— NOT FOR INTERNATIONAL MAIL (See other side) * GPO : 1972 O - 460-743

No. 419745

RECEIPT FOR CERTIFIED MAIL—30¢ (plus postage)

SENT TO <i>Harold E. Kurb, Jr.</i>		POSTMARK OR DATE <i>11/24/81</i>
STREET AND NO. <i>1605 Clover Lane</i>		
P.O., STATE AND ZIP CODE <i>Fort Worth, TX 76107</i>		
OPTIONAL SERVICES FOR ADDITIONAL FEES		
RETURN RECEIPT SERVICES	1. Shows to whom and date delivered 15¢ With delivery to addressee only 65¢ 2. Shows to whom, date and where delivered .. 35¢ With delivery to addressee only 85¢	
DELIVER TO ADDRESSEE ONLY 50¢		
SPECIAL DELIVERY (extra fee required)		
PS Form 3900 Apr. 1971		NO INSURANCE COVERAGE PROVIDED— NOT FOR INTERNATIONAL MAIL (See other side) * GPO : 1972 O - 460-743

No. 419748

RECEIPT FOR CERTIFIED MAIL—30¢ (plus postage)

SENT TO <i>Ralph Nix</i>		POSTMARK OR DATE <i>11/24/81</i>
STREET AND NO. <i>Box 617</i>		
P.O., STATE AND ZIP CODE <i>Actesia, NM 88210</i>		
OPTIONAL SERVICES FOR ADDITIONAL FEES		
RETURN RECEIPT SERVICES	1. Shows to whom and date delivered 15¢ With delivery to addressee only 65¢ 2. Shows to whom, date and where delivered .. 35¢ With delivery to addressee only 85¢	
DELIVER TO ADDRESSEE ONLY 50¢		
SPECIAL DELIVERY (extra fee required)		
PS Form 3900 Apr. 1971		NO INSURANCE COVERAGE PROVIDED— NOT FOR INTERNATIONAL MAIL (See other side) * GPO : 1972 O - 460-743

No. 419746

RECEIPT FOR CERTIFIED MAIL—30¢ (plus postage)

SENT TO <i>Monsanto Company</i>		POSTMARK OR DATE <i>11/24/81</i>
STREET AND NO. <i>1330 Midland Natl Bank Tower</i>		
P.O., STATE AND ZIP CODE <i>Midland, TX 79701</i>		
OPTIONAL SERVICES FOR ADDITIONAL FEES		
RETURN RECEIPT SERVICES	1. Shows to whom and date delivered 15¢ With delivery to addressee only 65¢ 2. Shows to whom, date and where delivered .. 35¢ With delivery to addressee only 85¢	
DELIVER TO ADDRESSEE ONLY 50¢		
SPECIAL DELIVERY (extra fee required)		
PS Form 3900 Apr. 1971		NO INSURANCE COVERAGE PROVIDED— NOT FOR INTERNATIONAL MAIL (See other side) * GPO : 1972 O - 460-743

No. 419743

RECEIPT FOR CERTIFIED MAIL—30¢ (plus postage)

No. 419747

SENT TO <i>United States Geological Survey</i>		POSTMARK OR DATE <i>11/24/81</i>
STREET AND NO. <i>Drawer 1857</i>		
P.O., STATE AND ZIP CODE <i>Roswell, Nm 88201</i>		
OPTIONAL SERVICES FOR ADDITIONAL FEES		
RETURN RECEIPT SERVICES	<div> <div>1. Shows to whom and date delivered</div> <div>With delivery to addressee only</div> </div> <div> <div>2. Shows to whom, date and where delivered ..</div> <div>With delivery to addressee only</div> </div>	<div>15¢</div> <div>65¢</div> <div>35¢</div> <div>85¢</div>
DELIVER TO ADDRESSEE ONLY		50¢
SPECIAL DELIVERY (extra fee required)		

P5 Form 3800 NO INSURANCE COVERAGE PROVIDED— (See other side)
 Apr. 1971 NOT FOR INTERNATIONAL MAIL * GPO : 1972 O - 460-740

1453-
Mark K. Mosley
Division Manager
Production Department
Hobbs Division
North American Production



Conoco Inc.
P.O. Box 460
726 E. Michigan
Hobbs, NM 88240
(505) 393-4141

November 19, 1981

Monsanto Company
1330 Midland Nat'l Bank Tower
500 West Texas
Midland, Texas 79701

Harold E. Kurtz, Jr.
1605 Clover Lane
Fort Worth, Texas 76107

Belco Petroleum
411 Petroleum Building
204 West Texas
Midland, Texas 79701

Roy L. McKay
P.O. Box 2014
Roswell, New Mexico 88201

Gentlemen:

Unorthodox Location - Penny Federal Com. No. 2, Section 23, T-20S,
R-24E, Eddy County, New Mexico

By authority of New Mexico Oil Conservation Division Order No. R-6515, Conoco Inc. was authorized to drill and complete a well in the Dagger Draw, South, Upper Penn Pool at a location 1650' FNL & 1930' FEL of the above named section. This location falls within a few feet of a gas line in the area and we have requested a revision to Order R-6515 permitting the movement of the location 200' east, being 1650' FNL & 1780' FEL of Section 23.

The purpose of this letter ballot is to request your waiving any objection to the requested new location. If you have no objection, please sign below and forward one copy to the NMOCD in the enclosed envelope and return one copy to this office.

Very truly yours,

M K Mosley

HAI:rej

Approved: _____
MONSANTO COMPANY

Date: _____

Approved: _____
BELCO PETROLEUM

Date: _____

Approved: _____
Harold E. Kurtz, Jr.

Date: _____

Approved: _____
Roy L. McKay

Date: 11-23-81

1455
Mark K. Mosley
Division Manager
Production Department
Hobbs Division
North American Production

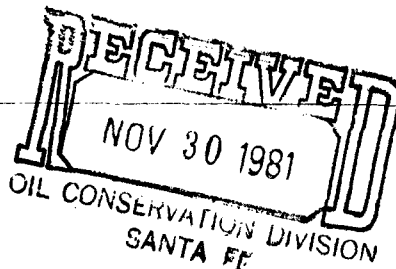

Conoco Inc.
P.O. Box 460
726 E. Michigan
Hobbs, NM 88240
(505) 393-4141

November 19, 1981

Monsanto Company
1330 Midland Nat'l Bank Tower
500 West Texas
Midland, Texas 79701

✓ Harold E. Kurtz, Jr.
1605 Clover Lane
Fort Worth, Texas 76107

Belco Petroleum
411 Petroleum Building
204 West Texas
Midland, Texas 79701

Roy L. McKay
P.O. Box 2014
Roswell, New Mexico 88201

Gentlemen:

Unorthodox Location - Penny Federal Com. No. 2, Section 23, T-20S,
R-24E, Eddy County, New Mexico

By authority of New Mexico Oil Conservation Division Order No. R-6515, Conoco Inc. was authorized to drill and complete a well in the Dagger Draw, South, Upper Penn Pool at a location 1650' FNL & 1980' FEL of the above named section. This location falls within a few feet of a gas line in the area and we have requested a revision to Order R-6515 permitting the movement of the location 200' east, being 1650' FNL & 1780' FEL of Section 23.

The purpose of this letter ballot is to request your waiving any objection to the requested new location. If you have no objection, please sign below and forward one copy to the NMOCD in the enclosed envelope and return one copy to this office.

Very truly yours,

M K Mosley

HAI:rej

Approved: _____
MONSANTO COMPANY

Date: _____

Approved: _____
BELCO PETROLEUM

Date: _____

Approved: *Harold E. Kurtz, Jr.*
Harold E. Kurtz, Jr.

Date: *Nov 25 1981*

Approved: _____
Roy L. McKay

Date: _____

Mark K. Mosley
Division Manager
Production Department
Hobbs Division
North American Production

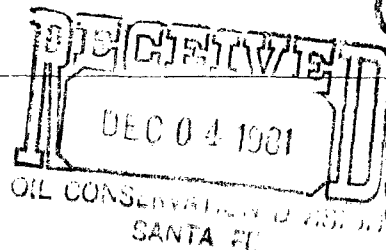

Conoco Inc.
P.O. Box 460
726 E. Michigan
Hobbs, NM 88240
(505) 393 4141

755
455

November 19, 1981

Monsanto Company
1330 Midland Nat'l Bank Tower
500 West Texas
Midland, Texas 79701

Harold E. Kurtz, Jr.
1605 Clover Lane
Fort Worth, Texas 76107

Belco Petroleum
411 Petroleum Building
204 West Texas
Midland, Texas 79701

Roy L. McKay
P.O. Box 2014
Roswell, New Mexico 88201

Gentlemen:

Unorthodox Location - Penny Federal Com. No. 2, Section 23, T-20S,
R-24E, Eddy County, New Mexico

By authority of New Mexico Oil Conservation Division Order No. R-6515, Conoco Inc. was authorized to drill and complete a well in the Dagger Draw, South, Upper Penn Pool at a location 1650' FNL & 1980' FEL of the above named section. This location falls within a few feet of a gas line in the area and we have requested a revision to Order R-6515 permitting the movement of the location 200' east, being 1650' FNL & 1780' FEL of Section 23.

The purpose of this letter ballot is to request your waiving any objection to the requested new location. If you have no objection, please sign below and forward one copy to the NMOCD in the enclosed envelope and return one copy to this office.

Very truly yours,

M K Mosley

HAT:rej

Approved: _____

[Signature]
MONSANTO COMPANY

Date: _____

11/29/81

Approved: _____

BELCO PETROLEUM

Date: _____

Approved: _____

Harold E. Kurtz, Jr.

Date: _____

Approved: _____

Roy L. McKay

Date: _____

MSV
145



Mark K. Mosley
Division Manager
Production Department
Hobbs Division
North American Production

Conoco Inc.
P.O. Box 460
726 E. Michigan
Hobbs, NM 88240
(505) 393-4141

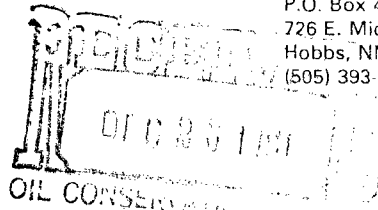

November 19, 1981

Monsanto Company
1330 Midland Nat'l Bank Tower
500 West Texas
Midland, Texas 79701

Harold E. Kurtz, Jr.
1605 Clover Lane
Fort Worth, Texas 76107

Belco Petroleum
411 Petroleum Building
204 West Texas
Midland, Texas 79701

Roy L. McKay
P.O. Box 2014
Roswell, New Mexico 88201

Gentlemen:

Unorthodox Location - Penny Federal Com. No. 2, Section 23, T-20S,
R-24E, Eddy County, New Mexico

By authority of New Mexico Oil Conservation Division Order No. R-6515, Conoco Inc. was authorized to drill and complete a well in the Dagger Draw, South, Upper Pean Pool at a location 1650' FNL & 1930' FEL of the above named section. This location falls within a few feet of a gas line in the area and we have requested a revision to Order R-6515 permitting the movement of the location 200' east, being 1650' FNL & 1780' FEL of Section 23.

The purpose of this letter ballot is to request your waiving any objection to the requested new location. If you have no objection, please sign below and forward one copy to the NMOCD in the enclosed envelope and return one copy to this office.

Very truly yours,

Mark K. Mosley

HAI:rej

Approved: _____
MONSANTO COMPANY

Date: _____

Approved: *[Signature]*
BELCO PETROLEUM
DIVISION ARMY.

Date: 12-12-81

Approved: _____
Harold E. Kurtz, Jr.

Date: _____

RECEIVED

Approved: _____
Roy L. McKay

Date: _____

NOV 24 1981

E

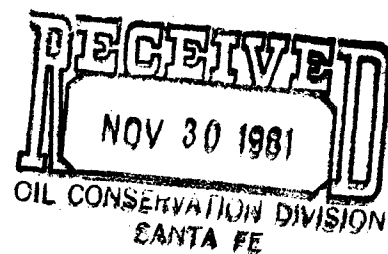

November 24, 1981

(See Attached List for Addressees)

Gentlemen:

Unorthodox Location - Penny Federal Com. No. 2, Section 23, T-20S,
R-24E, Eddy County, New Mexico

By authority of New Mexico Oil Conservation Division Order No. R-6515, Conoco Inc. was authorized to drill and complete a well in the Dagger Draw, South, Upper Penn Pool at a location 1650' FNL & 1980' FEL of the above named section. This location falls within a few feet of a gas line in the area and we have requested a revision to Order R-6515 permitting the movement of the location 200' east, being 1650' FNL & 1780' FEL of Section 23.

The purpose of this letter is to inform you, as offset operator or owner, of our requested change in location and to advise that any objection should be filed with the New Mexico Oil Conservation Division in Santa Fe within twenty days from November 20, 1981. Also enclosed for your information is a copy of our application letter and plats showing the reason for the proposed move. The 6 5/8" pipeline would interfere with the building of the location at the original site and create unnecessary risks in operations conducted on the lease.

Very truly yours,

HAI:rej
Enc
CC:
Mr. R. L. Stamets
NMOCD
P.O. Box 2088
Santa Fe, New Mexico 87501

(Blind Note to RLS:

The above is a letter to offset operators. Also attached is plat showing pipeline which necessitated location change. This letter was sent via certified mail.)