

NSL - 1501
Rule 104F
4-10-82



BTA OIL PRODUCERS

104 SOUTH PECOS

MIDLAND, TEXAS 79701-9988

AC 915-682-3753

March 18, 1982

PARTNERS
CARLTON BEAL
CARLTON BEAL, JR.
BARRY BEAL
SPENCER BEAL
KELLY BEAL

Re: Application for Administrative Approval of an Unorthodox Location;
Antelope, 8006 JV-P, Well No. 2
Antelope Ridge (Morrow) Field
1500' FWL & 1980' FNL of Sec. 2, Twp. 23-S, Rge. 34-E,
Lea County, New Mexico

STATE OF NEW MEXICO
DEPARTMENT OF ENERGY AND MINERALS
Oil Conservation Division
Box 2088
Santa Fe, New Mexico 87501

Gentlemen:

Please accept the attached application in lieu of the one submitted February 25, 1982. The amended location is 1500 feet from the West line and 1980 feet from the North line of the referenced section. The new spacing represents the only change in the previous application. The amended location is 190 feet East of the previous location and closer to the pipeline.

If you have any questions regarding this application, please contact me directly.

Sincerely,

BOB K. NEWLAND
For BTA Oil Producers

BKN/dh

Attachments: Supporting Data

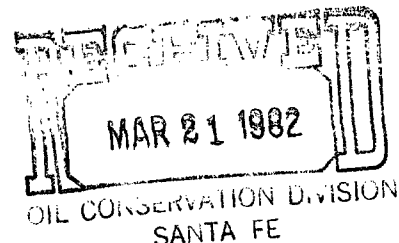



BTA OIL PRODUCERS

PARTNERS
CARLTON BEAL
CARLTON BEAL, JR.
BARRY BEAL
SPENCER BEAL
KELLY BEAL

104 SOUTH PECOS
MIDLAND, TEXAS 79701-9988
AC 915-682-3753

February 25, 1982

Re: Application for Administrative Approval of an Unorthodox Location;
Antelope, 8006 JV-P, Well No. 2
Antelope Ridge (Morrow) Field
1310' FWL & 1980' FNL of Sec. 2, Twp. 23-S, Rge. 34-E,
Lea County, New Mexico

STATE OF NEW MEXICO
DEPARTMENT OF ENERGY AND MINERALS
Oil Conservation Division
Box 2088
Santa Fe, New Mexico 87501

Gentlemen:

BTA Oil Producers (BTA) respectfully request administrative approval to drill the referenced well at an unorthodox location as provided for in Rule 104-F, paragraphs I and II, Order No. R-6870. The proposed location is necessary for two reasons, first of all, pipelines in the immediate area preclude locating the well 1980 feet from the West and North lines of Section 2. Secondly, BTA desires not to drill the well down dip which would be East of BTA's Antelope No. 1. Our reason for not drilling the well at a down dip location is that in the event of water encroachment, BTA would be unable to capture and produce the majority of reserves underlying the property West of the BTA Antelope No. 1.

All offset operators have been notified of the application by certified mail on February 25, 1982.

If you have any questions regarding this application, please contact me directly.

Sincerely,

BOB K. NEWLAND
For BTA Oil Producers

BKN/dh

Attachments: Supporting Data

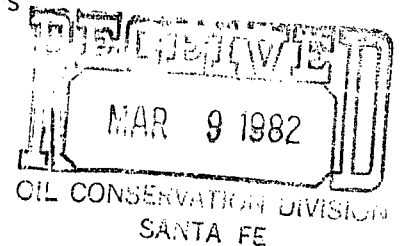



BTA OIL PRODUCERS

104 SOUTH PECOS

MIDLAND, TEXAS 79701-9988

AC 915-682-3753

PARTNERS
CARLTON BEAL
CARLTON BEAL, JR.
BARRY BEAL
SPENCER BEAL
KELLY BEAL

February 25, 1982

Re: Application for Administrative Approval of an Unorthodox Location;
Antelope, 8006 JV-P, Well No. 2
Antelope Ridge (Morrow) Field
1310' FWL & 1980' FNL of Sec. 2, Twp. 23-S, Rge. 34-E,
Lea County, New Mexico

DOW CHEMICAL
1123 Wilco Bldg.
Midland, Texas 79701

Gentlemen:

BTA Oil Producers (BTA) propose to drill the referenced well at an unorthodox location. This location is necessary for two reasons, first of all, pipelines in the immediate area preclude locating the well 1980 feet from the West and North lines of Section 2. Secondly, BTA desires not to drill the subject well down dip which would be East of BTA's Antelope No. 1. Our reason for not drilling the well at a down dip location is that in the event of water encroachment, BTA would be unable to capture and produce the majority of reserves underlying the property West of the BTA Antelope No. 1.

BTA solicits your waiver of objection to the proposed location. Should this application meet with your approval, please sign and return two copies of the attached waiver to BTA in the envelope enclosed.

Should you have any questions regarding the application, please contact me directly.

Sincerely,

BOB K. NEWLAND
For BTA Oil Producers

BKN/dh

Attachments: NM Forms C-101 & C-102

NO. OF COPIES RECEIVED		
DISTRIBUTION		
SANTA FE		
FILE		
U.S.G.S.		
LAND OFFICE		
OPERATOR		

NEW MEXICO OIL CONSERVATION COMMISSION

Form C-101
Revised 1-1-65

5A. Indicate Type of Lease STATE <input checked="" type="checkbox"/> FEE <input type="checkbox"/>
5. State Oil & Gas Lease No. L-5113

APPLICATION FOR PERMIT TO DRILL, DEEPEN, OR PLUG BACK

1a. Type of Work b. Type of Well OIL WELL <input type="checkbox"/> GAS WELL <input checked="" type="checkbox"/> OTHER <input type="checkbox"/> DRILL <input checked="" type="checkbox"/> DEEPEN <input type="checkbox"/> PLUG BACK <input type="checkbox"/> SINGLE ZONE <input checked="" type="checkbox"/> MULTIPLE ZONE <input type="checkbox"/>	2. Name of Operator BTA OIL PRODUCERS	3. Address of Operator 104 South Pecos Midland, Texas 79701	4. Location of Well UNIT LETTER 'E' LOCATED 1980 FEET FROM THE North LINE AND 1500 FEET FROM THE West LINE OF SEC. 2 TWP. 23-S RGE. 34-E NMPM	7. Unit Agreement Name	8. Farm or Lease Name Antelope, 8006 JV-P	9. Well No. 2	10. Field and Pool, or Wildcat Antelope Ridge (Morrow)	12. County Lea	19. Proposed Depth 13,550'	19A. Formation Morrow	20. Rotary or C.T. Rotary	21. Elevations (Show whether D/F, K/I, etc.) 3886' GR	21A. Kind & Status Plug. Bond Blanket	21B. Drilling Contractor Parker Drlg Co.	22. Approx. Date Work will start June 1, 1982
--	--	--	---	------------------------	--	------------------	---	-------------------	-------------------------------	--------------------------	------------------------------	--	--	---	--

23. PROPOSED CASING AND CEMENT PROGRAM

SIZE OF HOLE	SIZE OF CASING	WEIGHT PER FOOT	SETTING DEPTH	SACKS OF CEMENT	EST. TOP
26"	20"	94#	1500'	3000	Circ.
17 1/2"	13-3/8"	68#	5000'	3000	Circ.
12 1/4"	9-5/8"	47 & 53.5#	11900'	5000	- -
Liner 8 1/2"	7-5/8"	39#	13550'	400	- -

13-3/8" BOP - 12" - 3000# Double Ram & Annular Hydraulic
9-5/8" BOP - 11" - 10000# One Double Ram - One Single Ram & Annular Hydraulic

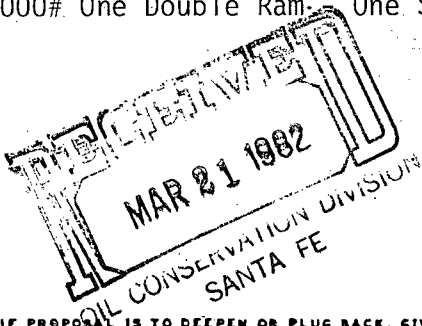

IN ABOVE SPACE DESCRIBE PROPOSED PROGRAM: IF PROPOSAL IS TO DEEPEN OR PLUG BACK, GIVE DATA ON PRESENT PRODUCTIVE ZONE AND PROPOSED NEW PRODUCTIVE ZONE. GIVE BLOWOUT PREVENTER PROGRAM, IF ANY.

I hereby certify that the information above is true and complete to the best of my knowledge and belief.

Signed Bob K. Newland Title Regulatory Administrator Date 3/19/82
BOB K. NEWLAND
(This space for State Use)

APPROVED BY _____ TITLE _____ DATE _____
CONDITIONS OF APPROVAL, IF ANY:

**NEW MEXICO OIL CONSERVATION COMMISSION
WELL LOCATION AND ACREAGE DEDICATION PLAT**

Form C-102
Supersedes C-128
Effective 1-1-65

All distances must be from the outer boundaries of the Section.

Operator BTA OIL PRODUCERS			Lease 8006 JV-P ANTELOPE		Well No. 2
Unit Letter	Section 2	Township 23-S	Range 34-E	County LEA	
Actual Footage Location of Well: 1980 feet from the NORTH line and 1500 feet from the WEST line					
Ground Level Elev. 3382'	Producing Formation Morrow		Pool Antelope Ridge (Morrow)		Dedicated Acreage: 320 Acres

1. Outline the acreage dedicated to the subject well by colored pencil or hachure marks on the plat below.
2. If more than one lease is dedicated to the well, outline each and identify the ownership thereof (both as to working interest and royalty).
3. If more than one lease of different ownership is dedicated to the well, have the interests of all owners been consolidated by communitization, unitization, force-pooling, etc?

☐ Yes ☐ No If answer is "yes," type of consolidation _____

If answer is "no," list the owners and tract descriptions which have actually been consolidated. (Use reverse side of this form if necessary.) _____

No allowable will be assigned to the well until all interests have been consolidated (by communitization, unitization, forced-pooling, or otherwise) or until a non-standard unit, eliminating such interests, has been approved by the Commission.

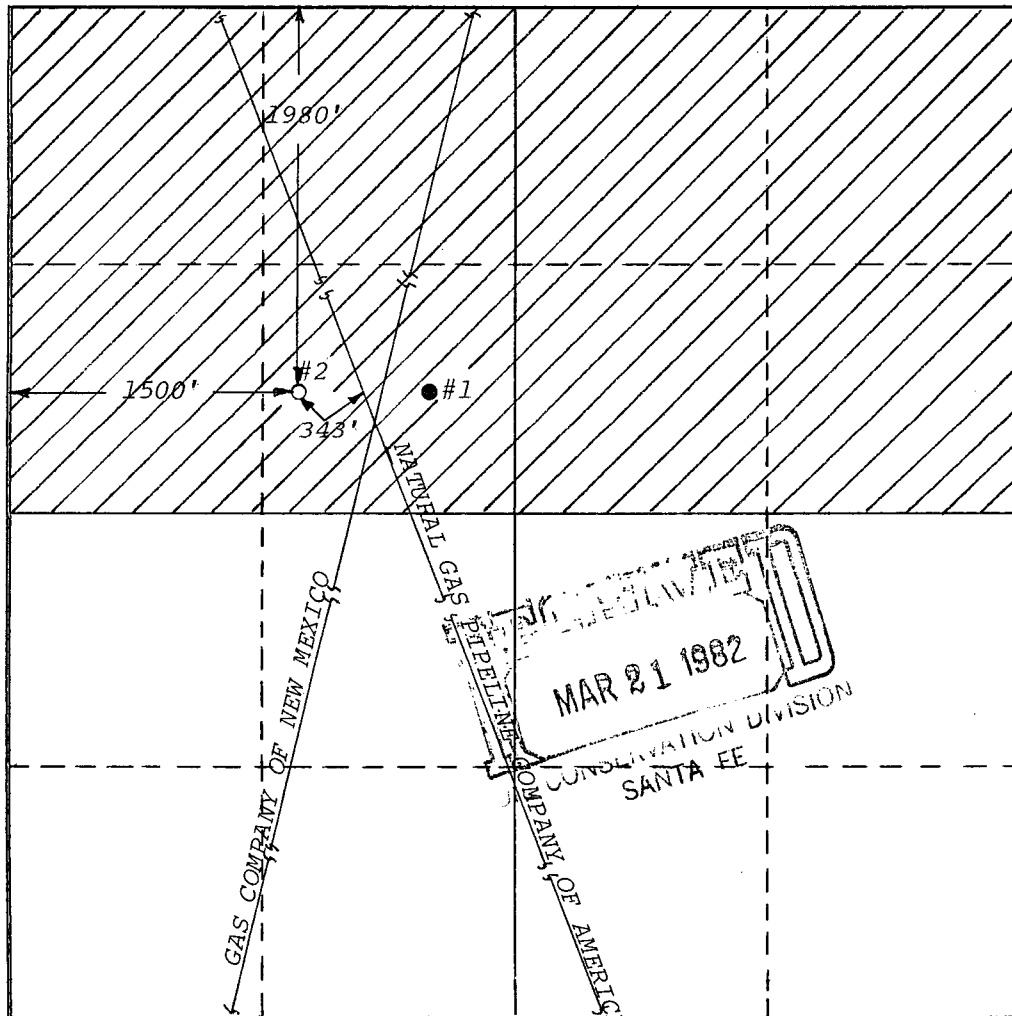

CERTIFICATION

I hereby certify that the information contained herein is true and complete to the best of my knowledge and belief.

Bob K. Newland

Name
BOB K. NEWLAND

Position
Regulatory Administrator

Company
BTA OIL PRODUCERS

Date
March 19, 1982

I hereby certify that the well location shown on this plat was plotted from field notes of actual surveys made by me or under my supervision, and that the same is true and correct to the best of my knowledge and belief.

Date Surveyed
MARCH 15, 1982

Registered Professional Engineer and/or Land Surveyor

Gary D. Boswell

Certificate No.

6689

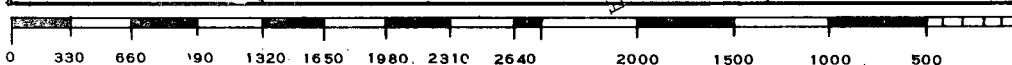



STATE OF NEW MEXICO
ENERGY AND MINERALS DEPARTMENT
OIL CONSERVATION DIVISION

March 10, 1982

BRUCE KING
GOVERNOR

LARRY KEHOE
SECRETARY

POST OFFICE BOX 2088
STATE LAND OFFICE BUILDING
SANTA FE, NEW MEXICO 87501
(505) 827-2434

BTA Oil Producers
104 South Pecos
Midland, Texas 79701-9988

Re: Application for Non-Standard
Location: Antelope 8006JV-P
Well No. 2, Sec. 2, T-23-S, R-34-E,
Lea County, New Mexico

We may not process the subject application for non-standard location until the required information or plats checked below (is)(are) submitted.

- ☒ A plat must be submitted clearly showing the ownership of the offsetting leases.
- ☐ A statement must be submitted that offset owners have been notified of the application by certified mail.
- ☐ A plat must be submitted fully identifying the topography necessitating the non-standard location.
- ☐ Other:

Very truly yours

R. L. STAMETS
Technical Support Chief

RLS/dr



Amoco Production Company (USA)

Houston Region-West
500 Jefferson Building
Post Office Box 3092
Houston, Texas 77001

R. G. Smith
Regional Engineering
Manager-West

March 12, 1982

File: JCA-986.51NM-064

Re: Request for Waiver - Unorthodox Location
Antelope, 8006 JV-P, Well No. 2
Antelope Ridge (Morrow) Field
1310' FWL & 1980' FNL of Sec. 2, Twp. 23-S,
Rge. 34-E,
Lea County, New Mexico

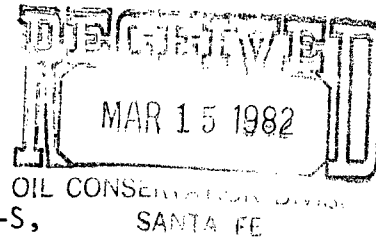

BTA Oil Producers
104 South Pecos
Midland, Texas 79701-9988

Gentlemen:

In reference to your letter of February 25, 1982 requesting a waiver for an unorthodox location 1310' FWL X 1980' FNL, Sec. 2, T-23-S, R-34-E, Lea County, New Mexico, for the Antelope 8006 JV-P Well No. 2, Amoco Production Company cannot grant such a request. Our examination of your plat indicates that topographical considerations do not require a move toward the west lease line to obtain an orthodox location. Amoco Production Company is opposed to crowding of our lease lines when alternative orthodox locations appear to be available.

Yours very truly,

ORIGINAL SIGNED
R. G. SMITH
BY aa

AA/lrd

cc: State of New Mexico
Department of Energy and Minerals
Oil Conservation Division
Box 2088
Santa Fe, New Mexico 87501

R-34-E

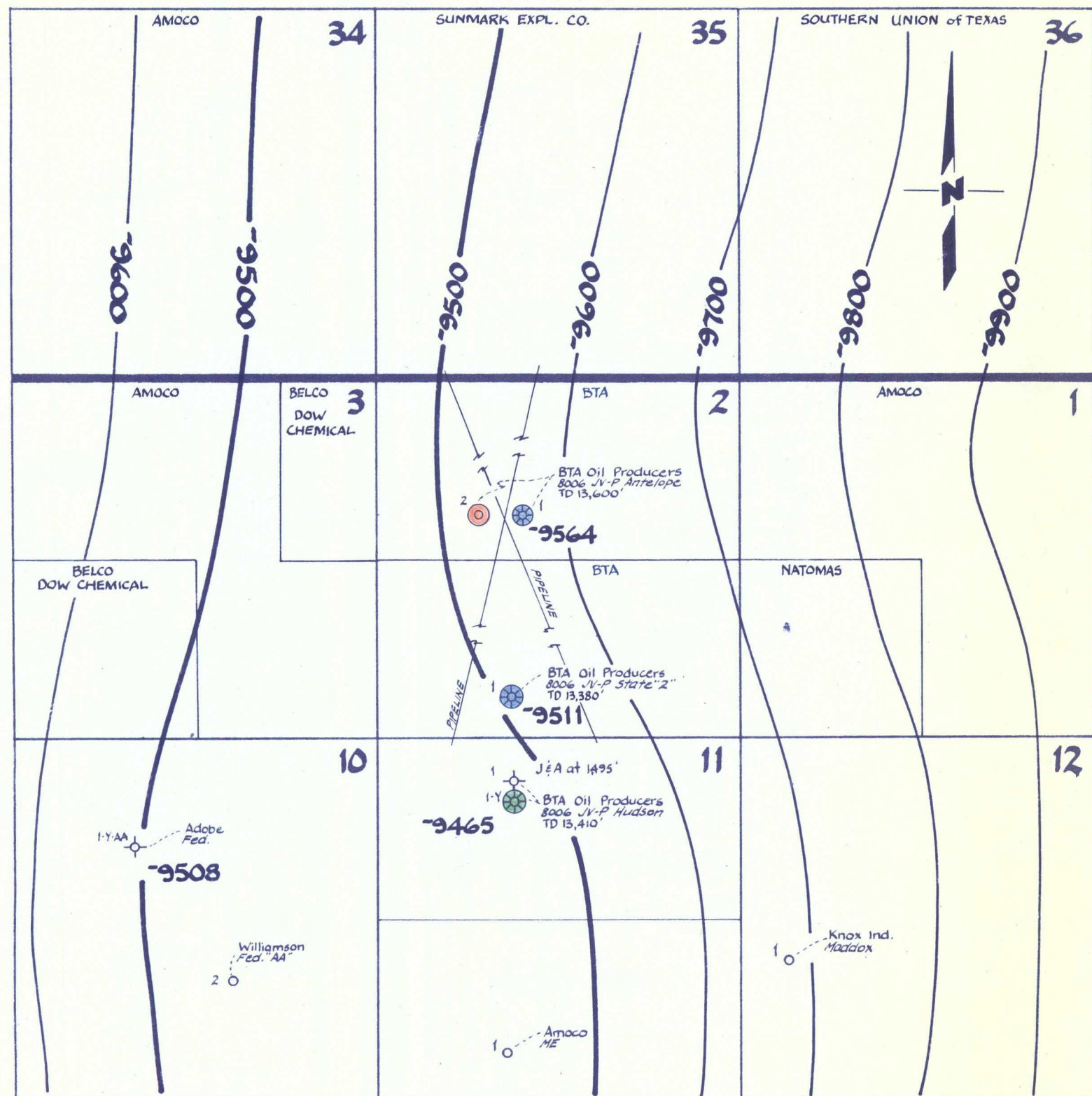

T
22
S

T
23
S

LEGEND

- PROPOSED DRILLSITE
- Atoka Gas Well
- Morrow Gas Well
- ⊕ Dry Hole
- Drilling Well or Location

BTA OIL PRODUCERS 8006 JV-P ANTELOPE N°2

LEA CO., NEW MEXICO

STRUCTURAL MAP TOP MORROW SHALE

C.S. = 100'
SCALE: 1" = 2000'

BY: VSS & MAW
DATE: 3-18-82

February 25, 1982

Re: Waiver of Objection for an Unorthodox Location;
Antelope, 8006 JV-P, Well No. 2
Antelope Ridge (Morrow) Field
1310' FWL & 1980' FNL of Sec. 2, Twp 23-S, Rge. 34-E,
Lea County, New Mexico

STATE OF NEW MEXICO
DEPARTMENT OF ENERGY AND MINERALS
Oil Conservation Division
Box 2088
Santa Fe, New Mexico 87501

Gentlemen:

I have been advised by BTA Oil Producers of their application to drill the referenced well at an unorthodox location. Please be advised that the undersigned hereby waives objection to the application.

Sincerely,

DOW CHEMICAL

By: _____

Date: _____

February 25, 1982

Re: Waiver of Objection for an Unorthodox Location;
Antelope, 8006 JV-P, Well No. 2
Antelope Ridge (Morrow) Field
1310' FWL & 1980' FNL of Sec. 2, Twp 23-S, Rge. 34-E,
Lea County, New Mexico

STATE OF NEW MEXICO
DEPARTMENT OF ENERGY AND MINERALS
Oil Conservation Division
Box 2088
Santa Fe, New Mexico 87501

Gentlemen:

I have been advised by BTA Oil Producers of their application to drill the referenced well at an unorthodox location. Please be advised that the undersigned hereby waives objection to the application.

Sincerely,

BELCO PETROLEUM COMPANY

By: _____

Date: _____

February 25, 1982

Re: Waiver of Objection for an Unorthodox Location;
Antelope, 8006 JV-P, Well No. 2
Antelope Ridge (Morrow) Field
1310' FWL & 1980' FNL of Sec. 2, Twp 23-S, Rge. 34-E,
Lea County, New Mexico

STATE OF NEW MEXICO
DEPARTMENT OF ENERGY AND MINERALS
Oil Conservation Division
Box 2088
Santa Fe, New Mexico 87501

Gentlemen:

I have been advised by BTA Oil Producers of their application to drill the referenced well at an unorthodox location. Please be advised that the undersigned hereby waives objection to the application.

Sincerely,

NATOMAS NORTH AMERICA, INC.

By: _____

Date: _____

February 25, 1982

Re: Waiver of Objection for an Unorthodox Location;
Antelope, 8006 JV-P, Well No. 2
Antelope Ridge (Morrow) Field
1310' FWL & 1980' FNL of Sec. 2, Twp 23-S, Rge. 34-E,
Lea County, New Mexico

STATE OF NEW MEXICO
DEPARTMENT OF ENERGY AND MINERALS
Oil Conservation Division
Box 2088
Santa Fe, New Mexico 87501

Gentlemen:

I have been advised by BTA Oil Producers of their application to drill the referenced well at an unorthodox location. Please be advised that the undersigned hereby waives objection to the application.

Sincerely,

SOUTHERN UNION EXPLORATION OF TEXAS

By: _____

Date: _____

February 25, 1982

Re: Waiver of Objection for an Unorthodox Location;
Antelope, 8006 JV-P, Well No. 2
Antelope Ridge (Morrow) Field
1310' FWL & 1980' FNL of Sec. 2, Twp 23-S, Rge. 34-E,
Lea County, New Mexico

STATE OF NEW MEXICO
DEPARTMENT OF ENERGY AND MINERALS
Oil Conservation Division
Box 2088
Santa Fe, New Mexico 87501

Gentlemen:

I have been advised by BTA Oil Producers of their application to drill the referenced well at an unorthodox location. Please be advised that the undersigned hereby waives objection to the application.

Sincerely,

SUNMARK EXPLORATION COMPANY

By: _____

Date: _____

February 25, 1982

Re: Waiver of Objection for an Unorthodox Location;
Antelope, 8006 JV-P, Well No. 2
Antelope Ridge (Morrow) Field
1310' FWL & 1980' FNL of Sec. 2, Twp 23-S, Rge. 34-E,
Lea County, New Mexico

STATE OF NEW MEXICO
DEPARTMENT OF ENERGY AND MINERALS
Oil Conservation Division
Box 2088
Santa Fe, New Mexico 87501

Gentlemen:

I have been advised by BTA Oil Producers of their application to drill the referenced well at an unorthodox location. Please be advised that the undersigned hereby waives objection to the application.

Sincerely,

AMOCO PRODUCTION COMPANY

By: _____

Date: _____