

NORTHWEST PIPELINE CORPORATION

PRODUCTION & DRILLING
P.O. BOX 90
FARMINGTON, NEW MEXICO 87401
5110.1-049-82

MAR 30 1982
March 26, 1982
OIL CONSERVATION DIVISION
SANTA FE

Mr. R.L. Stamets
NMOCD
P.O. Box 2088
Santa Fe, New Mexico 87501

Re: Application for Non-Standard Location

Natani #20

2035 FNL & 1105 FEL

Section 34, T22N, R6W

Busty Chacra Poo

*NSL 15
Rule 104 F
H-25-82*

Dear Mr. Stamets:

Northwest Exploration Company requests permission to drill the above captioned well in a non-standard location. This well was moved to its present location at the request of the BLM to avoid drilling too close to an occupied house. The land north of the house is unsuitable due to a large wash and a cultivated field.

Dome Petroleum is the only offset operator to this well. Other lands offsetting this well are Navajo Indian Allotment or un-leased Federal acreage. Dome has been notified of this well's non-standard location by certified mail. A copy of this letter along with the receipt for certified mail is enclosed.

Thank you,

Paul C. Thompson

Paul C. Thompson
Drilling Engineer

PCT:djb
Enclosure

NORTHWEST PIPELINE CORPORATION

PRODUCTION & DRILLING
P.O. BOX 90
FARMINGTON, NEW MEXICO 87401

5110.1-050-82

March 26, 1982

H.D. Hollingsworth
Dome Petroleum
3600 Southside River Rd.
Farmington, N.M. 87401

Dear Mr. Hollingsworth:

Northwest Exploration has requested permission from the New Mexico Oil Conservation Division to drill the well described below in a non-standard location. The well was moved to its present location at the request of the BLM to avoid drilling too close to an occupied house. Our records show you are an offset operator. Please notify R.L. Stamets, with the NMOCD in Santa Fe, if you have any objections to this well within 20 days. This letter is being sent by certified mail in accordance with NMOCD regulations.

Natani #20 - 2035 FNL & 1105 FEL - Sec 34, T22N, R6W.

Sincerely,

Paul C. Thompson

Paul C. Thompson
Drilling Engineer

PCT:djb

OIL CONSERVATION DIVISION

P. O. BOX 2088

SANTA FE, NEW MEXICO 87501

STATE OF NEW MEXICO
ENERGY AND MINERALS DEPARTMENTForm C-102
Revised 10-1-78

All distances must be from the outer boundaries of the Section

Operator NORTHWEST Exploration Company		Lease NATANI		Well No. 20	
Unit Letter H	Section 34	Township 22N	Range 6W	County Sandoval	
Actual Footage Location of Well: 2035 feet from the North line and 1105 feet from the East line					
Ground Level Elev. 7008	Producing Formation Chacra		Pool Undesignated Rusty Chacra		Dedicated Acreage: 161.48 Acres

1. Outline the acreage dedicated to the subject well by colored pencil or hachure marks on the plat below.
2. If more than one lease is dedicated to the well, outline each and identify the ownership thereof (both as to working interest and royalty).
3. If more than one lease of different ownership is dedicated to the well, have the interests of all owners been consolidated by communitization, unitization, force-pooling, etc?

☐ Yes ☒ No If answer is "yes," type of consolidation _____

If answer is "no," list the owners and tract descriptions which have actually been consolidated. (Use reverse side of this form if necessary.) _____

No allowable will be assigned to the well until all interests have been consolidated (by communitization, unitization, forced-pooling, or otherwise) or until a non-standard unit, eliminating such interests, has been approved by the Commission.

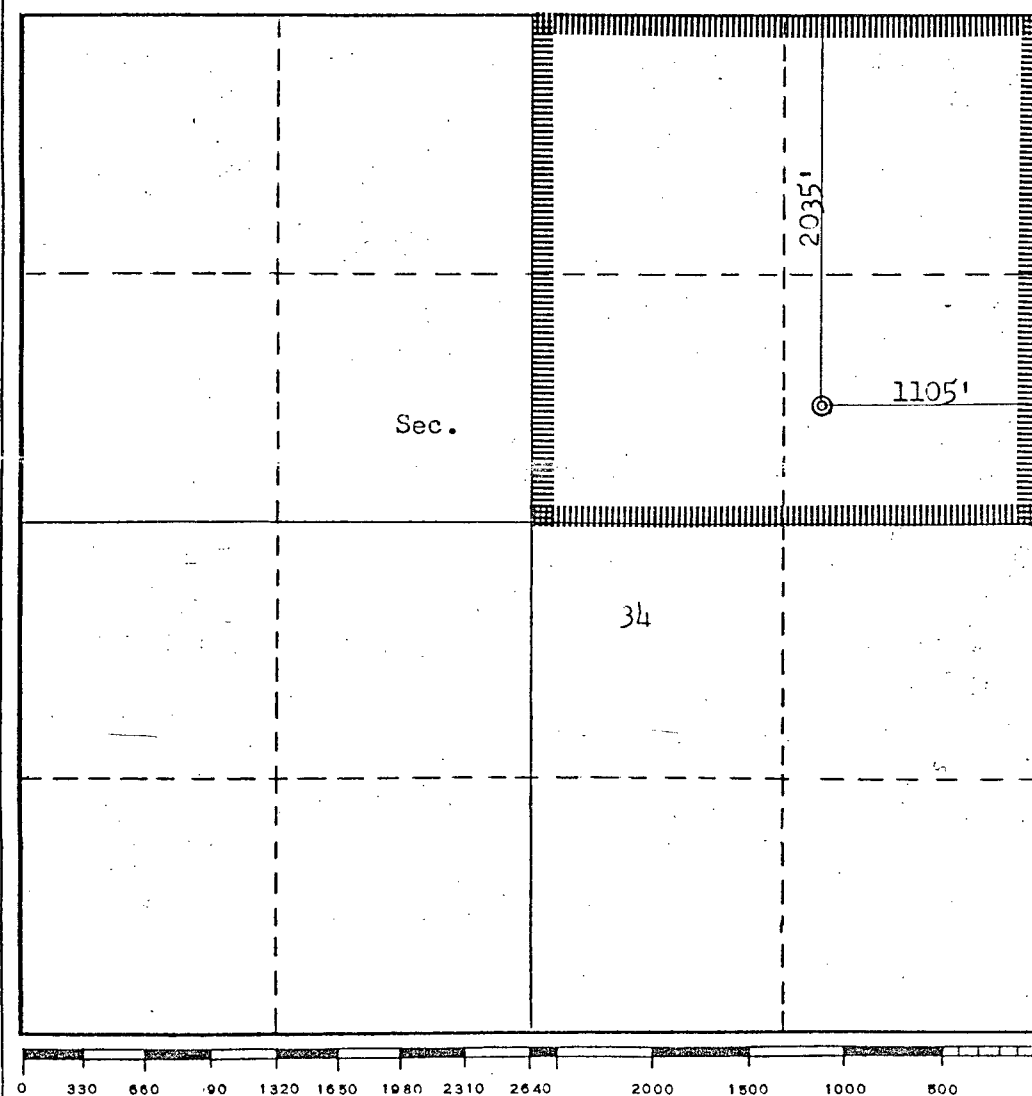

CERTIFICATION

I hereby certify that the information contained herein is true and complete to the best of my knowledge and belief.

Paul C. Thompson

Name
Paul C. Thompson

Position
Drilling Engineer

Company
Northwest Exploration Company

Date
March 26, 1982

I hereby certify that the well location shown on this plat was plotted from field notes of actual surveys made by me or under my supervision, and that the same is true and correct to the best of my knowledge and belief.

Date Surveyed

March 26, 1982

Registered Professional Engineer
and/or Land Surveyor

Fred B. Kerr Jr.
Fred B. Kerr Jr.

Certificate No.

3950

PLAT FOR NWE NATANI #20

T22N

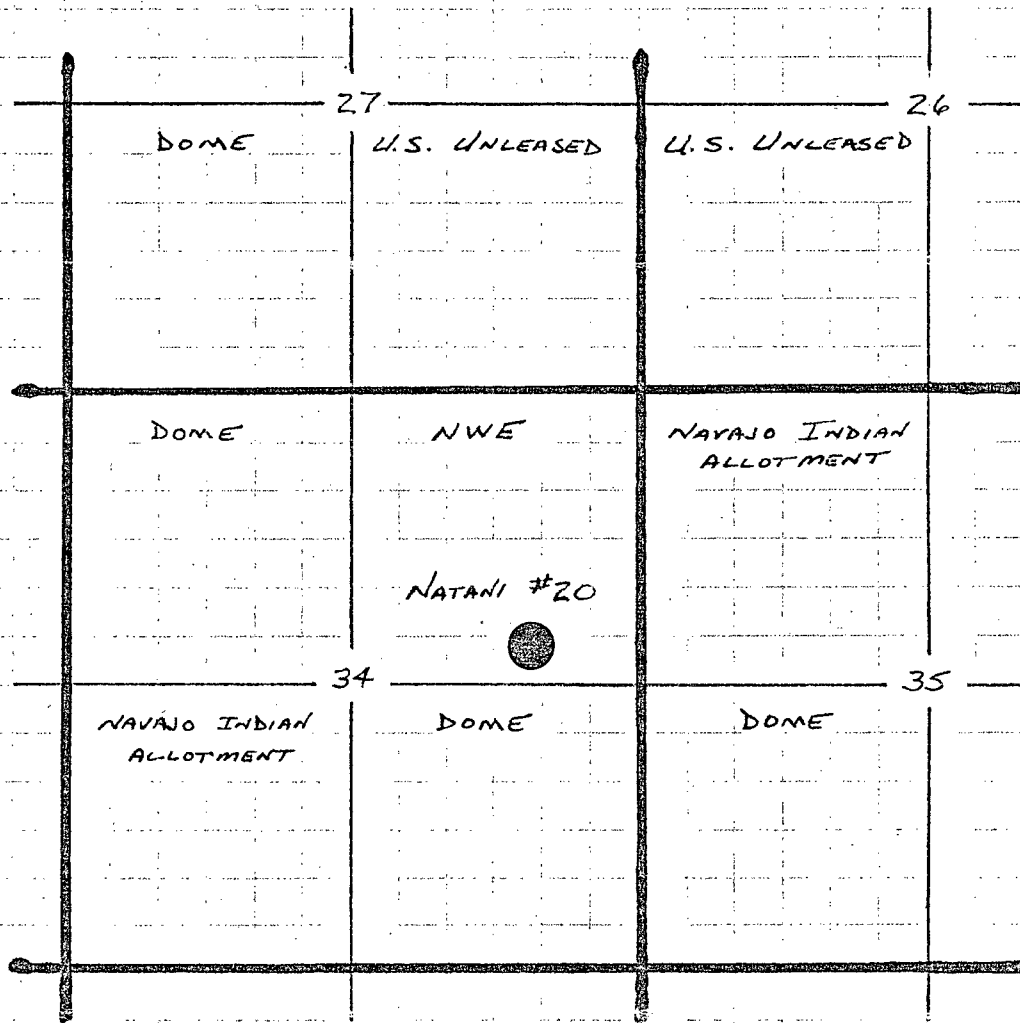

P22 0273451

RECEIPT FOR CERTIFIED MAIL

NO INSURANCE COVERAGE PROVIDED —
NOT FOR INTERNATIONAL MAIL

(See Reverse)

SENT TO
Dome Petroleum
STREET AND NO.
3600 Southside River Rd
P.O., STATE AND ZIP CODE
Farmington, N.M. 87401
POSTAGE \$.20

Natani #20

CONSULT POSTMASTER FOR FEES	
CERTIFIED FEE	.75 ^c
SPECIAL DELIVERY	^c
RESTRICTED DELIVERY	^c
SHOW TO WHOM AND DATE DELIVERED	^c
SHOW TO WHOM, DATE, AND ADDRESS OF DELIVERY	^c
SHOW TO WHOM AND DATE DELIVERED WITH RESTRICTED DELIVERY	^c
SHOW TO WHOM, DATE AND ADDRESS OF DELIVERY WITH RESTRICTED DELIVERY	^c

TOTAL POSTAGE FEES \$.95

PS Form 3800, Apr. 1976

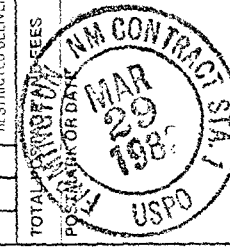



BRUCE KING
GOVERNOR

LARRY KEHOE
SECRETARY

STATE OF NEW MEXICO
ENERGY AND MINERALS DEPARTMENT
OIL CONSERVATION DIVISION

March 30, 1982

POST OFFICE BOX 2088
STATE LAND OFFICE BUILDING
SANTA FE, NEW MEXICO 87501
(505) 827-2434

Northwest Pipeline Corporation
P. O. Box 90
Farmington, New Mexico 87401

Re: Application for Non-Standard
Location: Natani No. 20
Sec. 34, T-22-N, R-6-W
Sandoval County

We may not process the subject application for non-standard location until the required information or plats checked below (is)(are) submitted.

- ☐ A plat must be submitted clearly showing the ownership of the offsetting leases.
- ☐ A statement must be submitted that offset owners have been notified of the application by certified mail.
- ☐ A plat must be submitted fully identifying the topography necessitating the non-standard location.
- ☒ Other: In the absence of a leasee, notice must be given to the mineral interest owner.

Very truly yours

R. L. STAMETS
Technical Support Chief

RLS/dr

NORTHWEST PIPELINE CORPORATION

PRODUCTION & DRILLING
P.O. BOX 90
FARMINGTON, NEW MEXICO 87401
5110.1-56-82

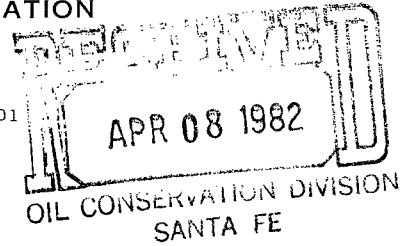

April 6, 1982

Mr. R.L. Stamets
NMOCD
P.O. Box 2088
Santa Fe, New Mexico 87501

Re: Application for Non-Standard location
Natani #20
2035 FNL & 1105 FEL
Sec 34, T22N, R6W

Dear Mr. Stamets:

Please include the two enclosed registered letters with my request for a non-standard location which I submitted in my letter dated March 26, 1982. These letters are addressed to the mineral interest owners of the unleased offsetting acreage.

Sincerely,

Paul C. Thompson

Paul C. Thompson
Drilling Engineer

PCT:djb
enclosure

P22 0273452

RECEIPT FOR CERTIFIED MAIL

NO INSURANCE COVERAGE PROVIDED—
NOT FOR INTERNATIONAL MAIL
(See Reverse)

SENT TO
Minerals Management Serv

STREET AND NO.

P.O. Drawer 600
P.O. STATE AND ZIP CODE

Farmington, N.M. 87401

POSTAGE

CERTIFIED FEE \$.20
#20

CONSULT POSTMASTER FOR FEES

OPTIONAL SERVICES

RETURN RECEIPT SERVICE

SPECIAL DELIVERY	
RESTRICTED DELIVERY	
SHOW TO WHOM AND DATE DELIVERED	
SHOW TO WHOM, DATE AND ADDRESS OF DELIVERY	
SHOW TO WHOM, DATE AND ADDRESS OF DELIVERY WITH RESTRICTED DELIVERY	

TOTAL POSTAGE AND FEES \$.95

POSTMARK DATE



P22 0273453

RECEIPT FOR CERTIFIED MAIL

NO INSURANCE COVERAGE PROVIDED—
NOT FOR INTERNATIONAL MAIL
(See Reverse)

SENT TO

BIA

STREET AND NO.

Navajo Area Office

P.O. STATE AND ZIP CODE

Window Rock, Arizona 86519

POSTAGE

CERTIFIED FEE \$.20
#20

CONSULT POSTMASTER FOR FEES

OPTIONAL SERVICES

RETURN RECEIPT SERVICE

SPECIAL DELIVERY	
RESTRICTED DELIVERY	
SHOW TO WHOM AND DATE DELIVERED	
SHOW TO WHOM, DATE AND ADDRESS OF DELIVERY	
SHOW TO WHOM, DATE AND ADDRESS OF DELIVERY WITH RESTRICTED DELIVERY	

TOTAL POSTAGE AND FEES \$.95

POSTMARK DATE

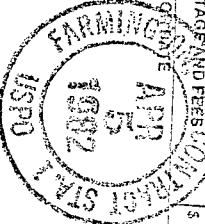

NORTHWEST PIPELINE CORPORATION

PRODUCTION & DRILLING
P.O. BOX 90
FARMINGTON, NEW MEXICO 87401
5110.1-53-82

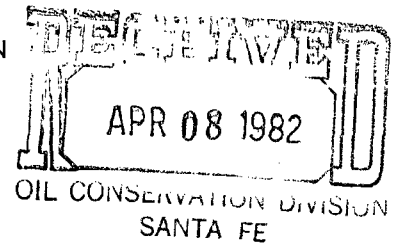

April 5, 1982

Mr. James F. Sims
Minerals Management Service
P.O. Drawer 600
Farmington, New Mexico 87401

Dear Mr. Sims:

Northwest Exploration has requested permission from the New Mexico Oil Conservation Division to drill the well described below in a non-standard location. The well was moved to its present location at the request of the BLM to avoid drilling too close to an occupied house. Our records show you to be an offsetting mineral interest owner. Please notify R.L. Stamets, with the NMOCD in Santa Fe, if you have any objections to this well within 20 days. This letter is being sent by certified mail in accordance with NMOCD regulations.

Natani #20 - 2035 FNL & 1105 FEL - Sec 34, T22N, R6W

Sincerely,

Paul C. Thompson

Paul C. Thompson
Drilling Engineer

PCT:djb