

May 5, 1982

Mr. R. L. Stamets
Technical Support Chief
New Mexico Oil Conservation Division
P. O. Box 2088
Santa Fe, New Mexico 87501

Subject: Mesa Petroleum Co.
Helen Fed Com #2
2310' FNL & 968' FEL
Section 1, T7S, R25E
Chaves County, New Mexico

*Ab
Gos*

*NSL-1528
Rule 104F
5-30-82*

Dear Mr. Stamets:

In response to your letter of April 20, 1982, please find attached Exhibit I the archaeological report from NMAS, Inc., the statement by the BLM archaeologist, and Exhibit II the topographic plat, Exhibit III the C102 showing mineral ownership of the proration unit proposed for this well, and Exhibit IV the land map showing offset operators and mineral owners notified by certified letter of this request.

It is hoped that this information will be sufficient for issuance of the appropriate administrative order for an unorthodox location due to archaeology per Rule 104F.

Expeditious handling of this request is greatly appreciated.

Respectfully,
Mesa Petroleum Co.

R. E. Mathis
Regulatory Coordinator
Permian Basin Division

XC: GETTY OIL CO., YATES PETROLEUM CORP., STEVENS OIL CO.

*Reid
6-2-82*

44-1110-1

Roswell District Office
P. O. Box 1191
Roswell, NM 88201

April 13, 1981

Oil Conservation Division
P. O. Box 1088
Santa Fe, NM 87501
Attention: Mr. Dick Slawetz

Dear Mr. Slawetz,

Several trips were made by BLM personnel to find a location for Mesa Petroleum's Nelson Federal Camp #1. The density of archeological sites within the NE $\frac{1}{4}$, Section 1, T. 1 N., R. 26 E., is very high. It is so high that we could not find a location for both the pad and road which did not impact an archeological site.

The presently proposed location consists of a previously bladed road and pad. The construction of this original pad and road impacted another archeological site. However, this location would have impact on the archeology of the area.

We have consulted with the State Historic Preservation Officer and he agrees that this is the location which should have minimal impact on the archeological sites of the area.

cc: Richard MacNeil
Mesa Petroleum Co.
1000 Tupper Building
Midland, TX 79701

Tom Marlan
Historic Preservation Bureau
105 Don Gasper Avenue
Santa Fe, NM 87501

Sincerely yours,

John H. [Signature]

District Manager

44-1110-1

AMMAGZ: DRC

Archaeological Clearance Report

For

MESA PETROLEUM CO.

Addendum to Report Dated 26 February 1982
Helen Federal Com. Well No. 2

Prepared

By

Dr. J. Loring Haskell

and

John C. Haight
Senior Research Assistant



Submitted

By

Dr. J. Loring Haskell
Principal Investigator
New Mexico Archaeological Services, Inc.
Carlsbad, New Mexico

15 April 1982

Permit No. 81-NM-306

	MESA PETROLEUM CO. PERMAN BASIN DIVISION	
EXHIBIT I		
ARCHAEOLOGICAL REPORT FOR PROPOSED HELEN FEDERAL COM #2		
BY:	DRAWN BY:	
DATE:	SCALE:	

Abstract

New Mexico Archaeological Services, Inc., representing MESA PETROLEUM CO., Midland, undertook an additional archaeological reconnaissance of Bureau of Land Management lands for the purpose of recording additional archaeological data on the route to be taken by the proposed access road to the Helen Federal Well No. 2. The investigated areas are situated in Section 1, T7S, R25E, NMPM, Chaves County, New Mexico. Three additional isolated cultural resources (CR) and one instance of burned cobbles (BC) were recorded during the reconnaissance. Additionally, one previously recorded site, NMAS 5271, was further expanded to the north and west during this reconnaissance. Clearance is not suggested for the road.

Introduction

On 30 March 1981, New Mexico Archaeological Services, Inc., (NMAS), Carlsbad, undertook for MESA PETROLEUM CO., Midland, an additional archaeological reconnaissance of federal lands for the purpose of recording new archaeological data on/and near the vicinity of the Helen Federal Well No. 2's access road. This project was advanced by Mr. Lloyd Reed, Regulatory Agent, MESA PETROLEUM CO., Roswell, and administered by Dr. J. Loring Haskell, Principal Investigator, NMAS, Inc. This reconnaissance was undertaken by Dr. Haskell and Mr. John C. Haight, Senior Research Assistant and Field Coordinator, NMAS.

Survey Technique

For this investigation, the access road was walked in two 25 ft wide transects. Methodologically, this procedure served to promote optimal conditions for the visual examination of areas to be impacted by construction-related activities.

Access Road
(Helen Federal Well No. 2)

Location

The proposed access road will measure 20 x 3250 ft. on federal lands and will be situated in the:

NW $\frac{1}{4}$ NE $\frac{1}{4}$, Section 1, T7S, R25E, NMPM, Chaves County, NM
SW $\frac{1}{4}$ NE $\frac{1}{4}$, Section 1, T7S, R25E, NMPM, Chaves County, NM
SE $\frac{1}{4}$ NW $\frac{1}{4}$, Section 1, T7S, R25E, NMPM, Chaves County, NM
SW $\frac{1}{4}$ NW $\frac{1}{4}$, Section 1, T7S, R25E, NMPM, Chaves County, NM

Map Reference: USGS EIGHTMILE DRAW QUADRANGLE, 7.5 Minute Series, 1962.

Cultural Resources

One previously recorded archaeological site, NMAS 5271, three

isolated cultural resources (CR) and one instance of burned limestone cobbles (BC) were encountered during the course of this reconnaissance.

CR1 consists of one quartzite primary decortication flake at a point approximately 500 ft. east of the beginning point of the access road. It is situated in the:

NE $\frac{1}{4}$ NW $\frac{1}{4}$ SW $\frac{1}{4}$ NW $\frac{1}{4}$, Section 1, T7S, R25E, NMPM, Chaves Co., NM

UTM: Zone 13, N3,733,360; E559,200

Map Reference: USGS EIGHTMILE DRAW QUADRANGLE, 7.5 Minute Series, 1962.

CR2 consists of one quartzite core at a point approximately 850 ft east of the beginning point of the access road. It is situated in the:

NW $\frac{1}{4}$ NE $\frac{1}{4}$ SW $\frac{1}{4}$ NW $\frac{1}{4}$, Section 1, T7S, R25E, NMPM, Chaves Co., NM

UTM: Zone 13, N3,733,350; E559,300

Map Reference: USGS EIGHTMILE DRAW QUADRANGLE, 7.5 Minute Series, 1962.

CR3 consists of one chert primary decortication flake at a point approximately 950 ft east of the beginning point of the access road. It is situated in the:

NW $\frac{1}{4}$ NE $\frac{1}{4}$ SW $\frac{1}{4}$ NW $\frac{1}{4}$, Section 1, T7S, R25E, NMPM, Chaves Co., NM

UTM: Zone 13, N3,733,350; E559,330

Map Reference: USGS EIGHTMILE DRAW QUADRANGLE, 7.5 Minute Series, 1962.

The BC, consisting of one burned limestone cobble is situated at a point approximately 450 ft east of the beginning point of the access road.

NMAS 5271

Location: W $\frac{1}{2}$ NW $\frac{1}{4}$ NE $\frac{1}{4}$, Section 1, T7S, R25E
NW $\frac{1}{4}$, Section 1, T7S, R25E, NMPM, Chaves County, NM

UTM: Zone 13, N3,733,420; E559,680

Map Reference: USGS EIGHTMILE DRAW QUADRANGLE, 7.5 Minute Series, 1962.

Ownership: Bureau of Land Management

Dimension of Resources: 366 X 519 m

Typological Designation: Occupation Zone

Temporality: Unknown

Nature of Cultural Resources: NMAS 5271, a large occupation zone, is situated on a gently sloping landform on the edge of a prominent escarpment overlooking Fivemile Draw to the north and east. Observed resources consist of an extensive scatter of chert and quartzite cores and exhausted cores, quartzite hammerstones, chert and quartzite bifaces, a vesicular basalt chopper, chert, quartzite, and chalcedony primary-secondary-tertiary decortication flakes, and an occasional burned-and fire-cracked limestone cobble and gravel. Although several minor concentrations were observed, the overall density of material is not uniform, thus the term occupation zone has been applied. Very little debris occurs at the base of the escarpment on the Fivemile Draw floodplain. The types of artifacts encountered at this site indicate that quarrying knappable material for lithic tool fabrication was the primary activity. No diagnostic artifacts were observed, hence authorship and temporality cannot be established.

Owing to the size of NMAS 5271, occupation by social groups at any one time was probably measurable in terms of a day or two or less. However, the site was probably re-occupied on numerous occasions during the Late Archaic

(A.D. 750-950) and Jornada Mogollon (A.D. 950-1350) times.

Further investigation of this site should shed light on the nature of lithic tool technologies. Excavation should yield functionally specific areas, i.e. knapping stations, furthering our understanding of occupation zones west of the Pecos River. Temporality and authorship may be established as well.

Recommendations

NMAS does not recommend clearance for the proposed road.

[illegible]

USGS Eightmile Draw Quad.
7.5 minute Series, 1962

UNITED STATES
DEPARTMENT OF THE INTERIOR
GEOLOGICAL SURVEY

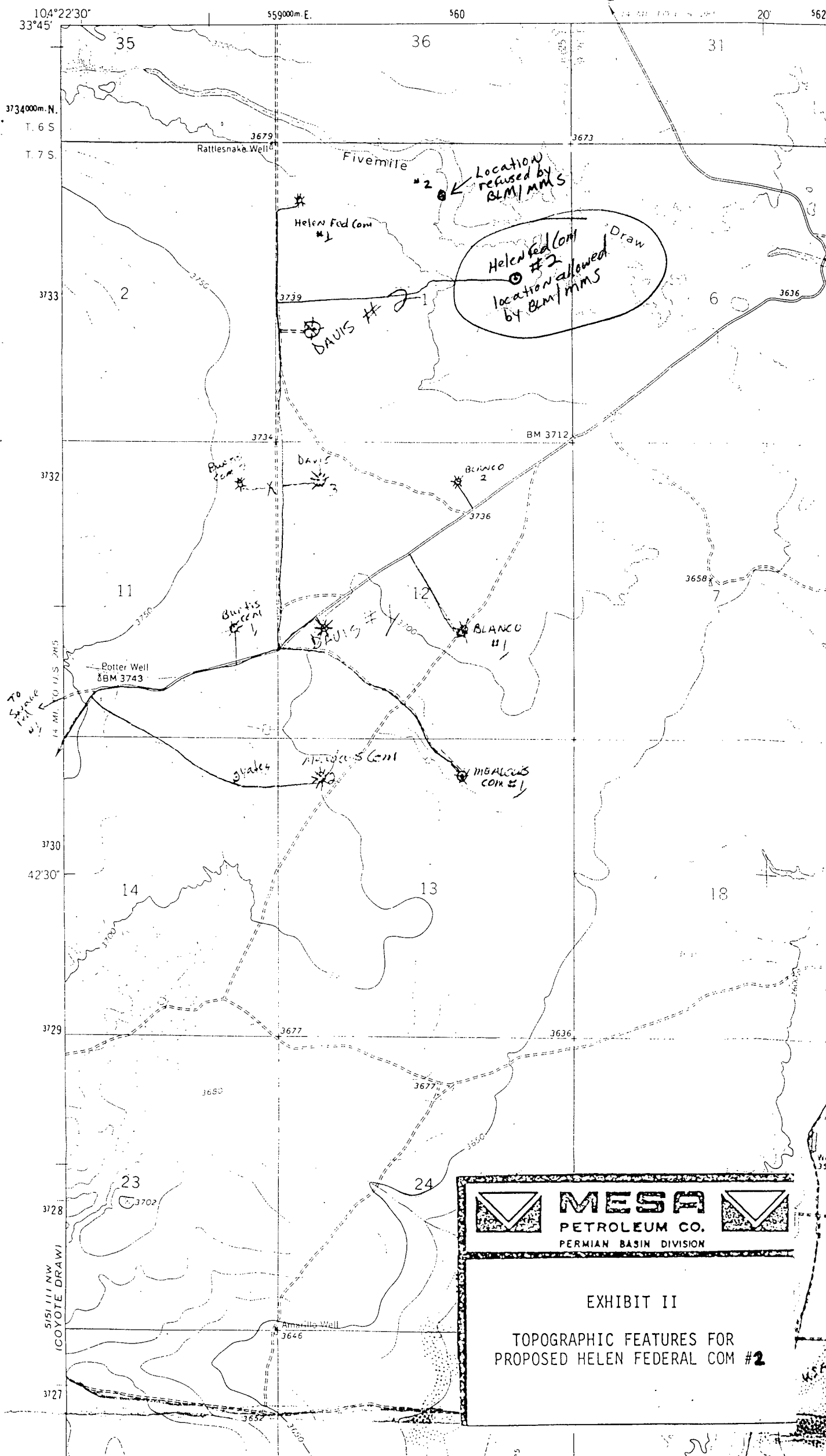



**MESA**
PETROLEUM CO.
PERMIAN BASIN DIVISION

EXHIBIT II

TOPOGRAPHIC FEATURES FOR
PROPOSED HELEN FEDERAL COM #2

All distances must be from the outer boundaries of the Section.

Operator Mesa Petroleum Co.		Lease Helen Federal Com		Well No. 2	
Unit Letter H	Section 1	Township 7 South	Range 25 East	County Chaves	
Actual Postage Location of Well: 2310 feet from the North line and 968 feet from the East line					
Ground Level Elev. 3676	Producing Formation ABO		Pool Pecos Slope ABO	Dedicated Acreage: NE 1/4 160 Acres	

1. Outline the acreage dedicated to the subject well by colored pencil or hatchure marks on the plat below.
2. If more than one lease is dedicated to the well, outline each and identify the ownership thereof (both as to working interest and royalty).
3. If more than one lease of different ownership is dedicated to the well, have the interests of all owners been consolidated by communitization, unitization, force-pooling, etc?

☐ Yes ☐ No If answer is "yes," type of consolidation Communitization in progress

If answer is "no," list the owners and tract descriptions which have actually been consolidated. (Use reverse side of this form if necessary.)

No allowable will be assigned to the well until all interests have been consolidated (by communitization, unitization, forced-pooling, or otherwise) or until a non-standard unit, eliminating such interests, has been approved by the Division.

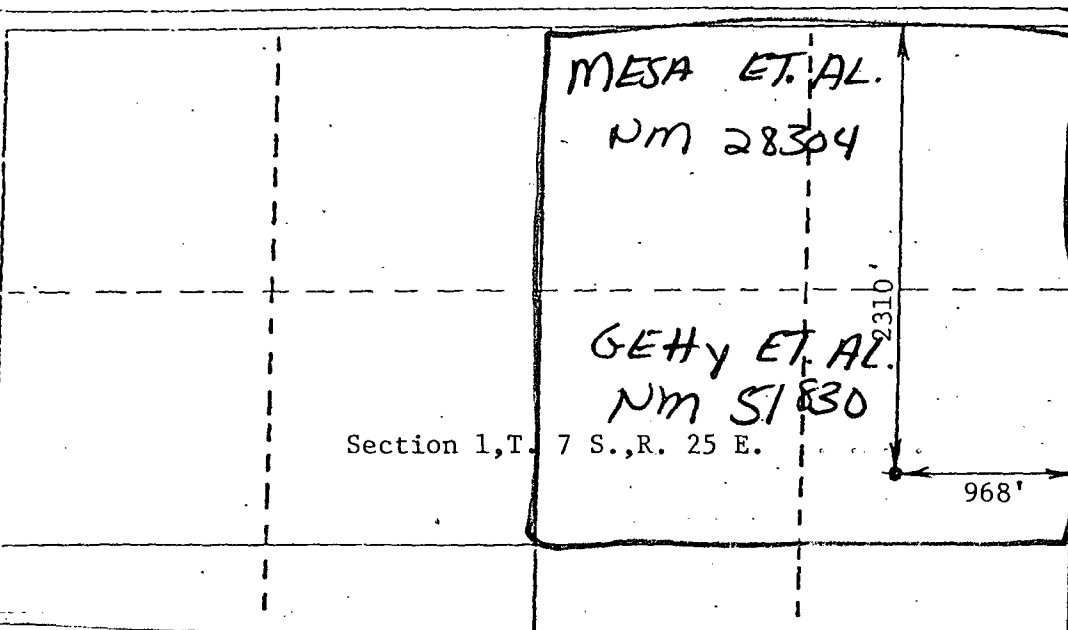

CERTIFICATION

I hereby certify that the information contained herein is true and complete to the best of my knowledge and belief.

Name
Lloyd Reed
Position
Regulatory Agent
Company
Mesa Petr. Co.

Date
4-2-82

I hereby certify that the well location shown on this plat was plotted from field notes of actual surveys made by me or under my supervision, and that the same is true and correct to the best of my knowledge and belief.

Date Surveyed
April 1, 1982
Registered Professional Engineer and/or Land Surveyor
John D. Jaques
Professional P.E. & L.S.
Certificate No.
6290

MESA
PETROLEUM CO.
PERMAN BASIN DIVISION

EXHIBIT III

MINERAL OWNERSHIP FOR
PROPOSED HELEN FEDERAL COM #2

SCALE:
3000 1500 1000 500 0

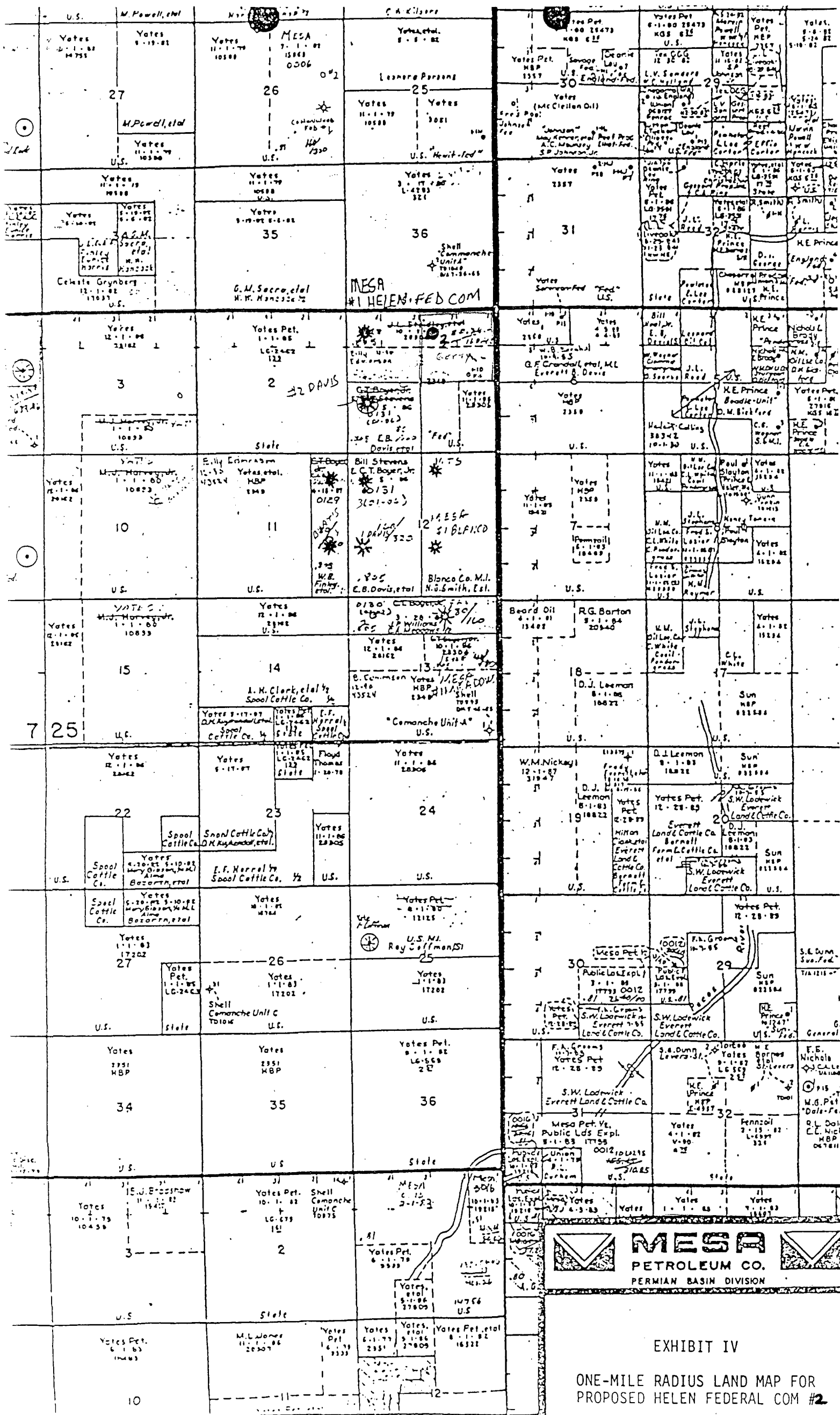

EXHIBIT IV

ONE-MILE RADIUS LAND MAP FOR PROPOSED HELEN FEDERAL COM #2