



Sun Production Division
Southwestern District

NSL 1729
Rule 104 F
Waivers in
Immediate
see C-101's for
locations

July 25, 1983

Sun Exploration and
Production Company
901 W Wall
Post Office Box 1861
Midland Texas 79702
915 685 0300

State of New Mexico
Energy & Minerals Dept.
P. O. Box 2088
Santa Fe, New Mexico 87501

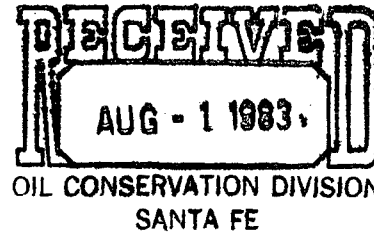

688 0300

Copy: State of New Mexico
Energy & Mineral Dept.
P. O. Box 1980
Hobbs, New Mexico 88240

RE: State "A" A/C 2
Wells #64, 65, 66, 67, 68, 69, 70, 71 & 72
Eunice Seven Rivers Queen South
Lea County, New Mexico

Gentlemen:

Sun Exploration & Production Company request administrative approval for an unorthodox location for the referenced wells. The unorthodox locations are less than 330 feet to the quarter quarter section. Offset operators were not notified since the wells are located in the center of the lease. Attached are copies of the C-101, C-102 forms and lease plat showing the locations.

If you have any questions or need additional information please contact me at (915) 688-0374.

very truly yours,
Dee Ann Kemp

DeeAnn Kemp
Senior Accounting Assistant

Enclosures

DAK:sm

*Called
Dee Ann Kemp
8-2-83
re notice
to offset*

WAIVER

New Mexico Oil Conservation Commission
P. O. Box 2088
Santa Fe, New Mexico 87501
Attn:

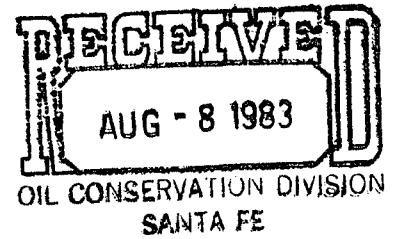

RE: State "A" A/C 2
Wells #64,66,67,68,71 & 72,65,69,70
Eunice Seven Rivers Queen South
Lea County, New Mexico

The undersigned, an offset operator having been informed of Sun Exploration & Production Company's application for administrative approval for unorthodox locations, hereby waives objection to their application.

ARCO Oil and Gas Co.

COMPANY

Craig L. Payton

BY

4 August, 1983

DATE

WAIVER

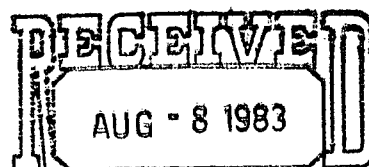

OIL CONSERVATION DIVISION
SANTA FE

New Mexico Oil Conservation Commission
P. O. Box 2088
Santa Fe, New Mexico 87501
Attn:

RE: State "A" A/C 2
Wells #64,66,67,68,71 & 72,65,69,70
Eunice Seven Rivers Queen South
Lea County, New Mexico

The undersigned, an offset operator having been informed of Sun Exploration & Production Company's application for administrative approval for unorthodox locations, hereby waives objection to their application.

Cities Service Oil & Gas Corp.

COMPANY

BY 

8-4-83
DATE

WAIVER

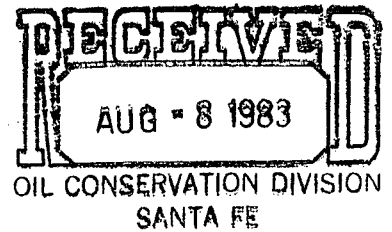

New Mexico Oil Conservation Commission
P. O. Box 2088
Santa Fe, New Mexico 87501
Attn:

RE: State "A" A/C 2
Wells #64,66,67,68,71 & 72,65,69,70
Eunice Seven Rivers Queen South
Lea County, New Mexico

The undersigned, an offset operator having been informed of Sun Exploration & Production Company's application for administrative approval for unorthodox locations, hereby waives objection to their application.

Campbell Le Hedrick
COMPANY

OF Hedrick
BY

Aug 4, 1983
DATE

WAIVER

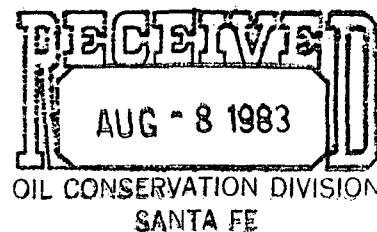

New Mexico Oil Conservation Commission
P. O. Box 2088
Santa Fe, New Mexico 87501
Attn:

RE: State "A" A/C 2
Wells #64,66,67,68,71 & 72,65,69,70
Eunice Seven Rivers Queen South
Lea County, New Mexico

The undersigned, an offset operator having been informed of Sun Exploration & Production Company's application for administrative approval for unorthodox locations, hereby waives objection to their application.

Getley
COMPANY

John Howard
BY

8/4/83
DATE

WAIVER

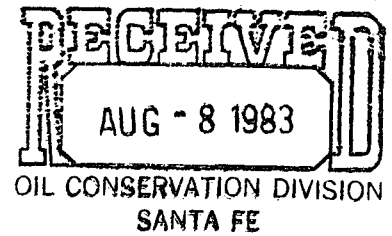

New Mexico Oil Conservation Commission
P. O. Box 2088
Santa Fe, New Mexico 87501
Attn:

RE: State "A" A/C 2
Wells #64,66,67,68,71 & 72,65,69,70
Eunice Seven Rivers Queen South
Lea County, New Mexico

The undersigned, an offset operator having been informed of Sun Exploration & Production Company's application for administrative approval for unorthodox locations, hereby waives objection to their application.

Gulf Oil Corporation
COMPANY

J. R. Frank
BY J. R. Frank
Chief Proration Engineer

August 4, 1983
DATE

The well locations are:

<u>Well No.</u>	<u>Location</u>
64	1250' FNL & 1250' FEL of Unit A, Sec. 8, T-22-N, R-36-E
65	1345' FNL & 25' FWL of Unit E, Sec. 9, T-22-S, R-36-E
66	1345' FNL & 1345' FWL of Unit F, Sec. 9, T-22-S, R-36-E
67	2615' FSL & 1345' FWL of Unit K, Sec. 9, T-22-S, R-36-E
68	2570' FNL & 70' FWL of Unit E, Sec. 9, T-22-S, R-36-E
69	2615' FSL & 1295' FEL of Unit I, Sec. 8, T-22-S, R-36-E
70	1295' FSL & 1295' FEL of Unit P, Sec. 8, T-22-S, R-36-E
71	1295' FSL & 25' FWL of Unit M, Sec. 9, T-22-S, R-36-E
72	1410' FSL & 1440' FWL of Unit K, Sec. 9, T-22-S, R-36-E

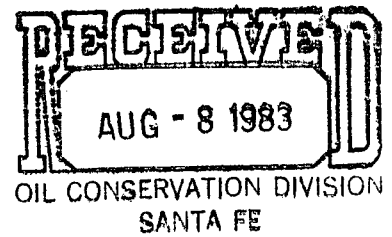

WAIVER

New Mexico Oil Conservation Commission
P. O. Box 2088
Santa Fe, New Mexico 87501
Attn:

RE: State "A" A/C 2
Wells #64,66,67,68,71 & 72,65,69,70
Eunice Seven Rivers Queen South
Lea County, New Mexico

The undersigned, an offset operator having been informed of Sun Exploration & Production Company's application for administrative approval for unorthodox locations, hereby waives objection to their application.

INTEGRATION OIL CO
COMPANY

BY Clifford A. Miller

DATE 8-4-83

WAIVER

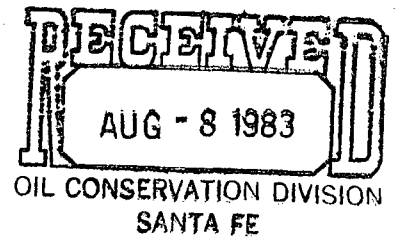

New Mexico Oil Conservation Commission
P. O. Box 2088
Santa Fe, New Mexico 87501
Attn:

RE: State "A" A/C 2
Wells #64,66,67,68,71 & 72,65,69,70
Eunice Seven Rivers Queen South
Lea County, New Mexico

The undersigned, an offset operator having been informed of Sun-
Exploration & Production Company's application for administrative
approval for unorthodox locations, hereby waives objection to their
application.

The Wiser Oil Company
COMPANY

BY Wm J. Cooke

DATE 8-5-83

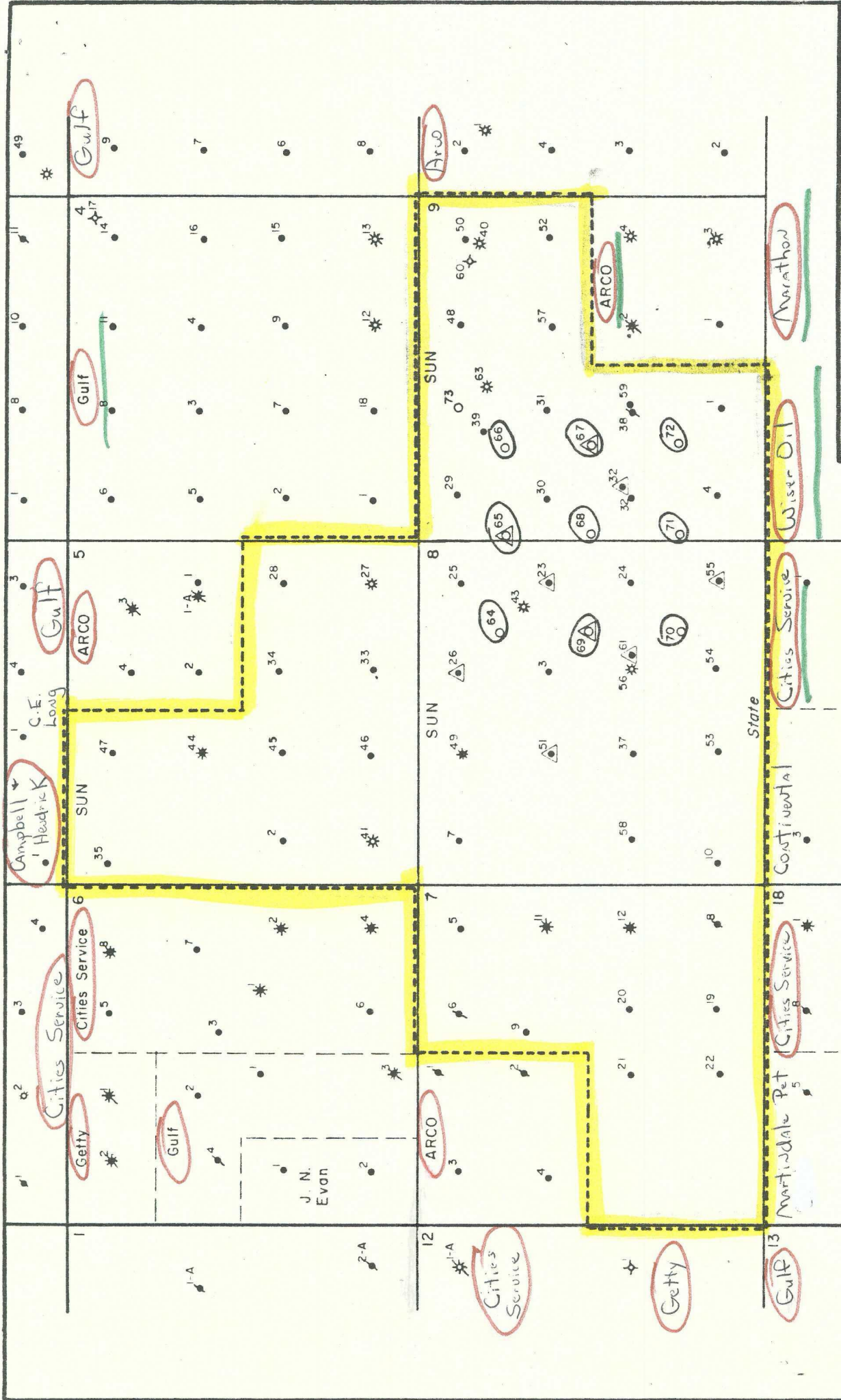

The operations circled in red are operations that the waivers are enclosed.

SUN PRODUCTION CO.

STATE "A" ACCT. NO. 2
T-22-S R-36-E
Lea County, New Mexico

NO. OF COPIES RECEIVED	
DISTRIBUTION	
SANTA FE	
FILE	
U.S.G.S.	
LAND OFFICE	
OPERATOR	

NEW MEXICO OIL CONSERVATION COMMISSION

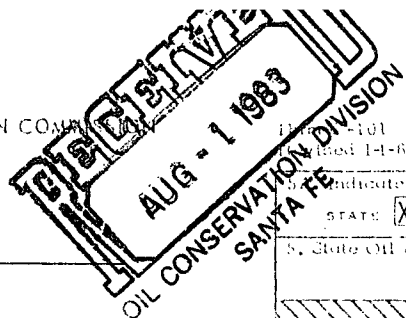

API NO. _____

Form 14-8a
Indicate Type of Lease

STATE ☒ FEDERAL ☐

State Oil & Gas Lease No. _____

APPLICATION FOR PERMIT TO DRILL, DEEPEN, OR PLUG BACK

1a. Type of Work		7. Unit Agreement Name	
b. Type of Well DRILL <input checked="" type="checkbox"/> DEEPEN <input type="checkbox"/> PLUG BACK <input type="checkbox"/> OIL WELL <input checked="" type="checkbox"/> GAS WELL <input type="checkbox"/> OTHER <input type="checkbox"/> SINGLE ZONE <input checked="" type="checkbox"/> MULTIPLE ZONE <input type="checkbox"/>		8. Firm or Lease Name State "A" A/C 2	
2. Name of Operator Sun Exploration & Production Co.		9. Well No. 64	
3. Address of Operator P. O. Box 1861 - Midland, Texas 79702		10. Field and Pool, or Wildcat Eunice Seven Rivers	
4. Location of Well UNIT LETTER A LOCATED 1250 FEET FROM THE North LINE AND 1250 FEET FROM THE East LINE OF SEC. 8 TWP. 22-N RGE. 36-E N40PM		11. County Lea	
15. Proposed Depth 4000		19A. Formation *	
21. Elevation (show whether D.F., K.I., etc.) 3564.4' GR		22. Approx. Date Work will start ASAP	
21A. Kind & Status Plug. Bond Blanket on file		21B. Drilling Contractor N/A	
21C. Rotary or C.T.R. Rotary			

23.

PROPOSED CASING AND CEMENT PROGRAM

SIZE OF HOLE	SIZE OF CASING	WEIGHT PER FOOT	SETTING DEPTH	SACKS OF CEMENT	EST. TOP
12 1/4	8-5/8	24#	550	375sxs	Surface
7-7/8	5-1/2	14#	3900	1100sxs	Surface

Blowout preventer: 10" Hydraulic

* 19A. Primary Reservoir - Queen
Secondary Reservoir - Seven Rivers

IN ABOVE SPACE DESCRIBE PROPOSED PROGRAM; IF PROPOSAL IS TO DEEPEN OR PLUG BACK, GIVE DATA ON PRESENT PRODUCTIVE ZONE AND PROPOSED NEW PRODUCTIVE ZONE. GIVE BLOWOUT PREVENTER PROGRAM, IF ANY.

I hereby certify that the information above is true and complete to the best of my knowledge and belief.

Signed Dee Ann Kemp Title Senior Accounting Assistant Date 7-12-83

(This space for State Use)

APPROVED BY _____ TITLE _____ DATE _____

CONDITIONS OF APPROVAL, IF ANY:

NEW MEXICO OIL CONSERVATION COMMISSION
WELL LOCATION AND ACREAGE DEDICATION PLAT

AUG - 1 1983
Form O-102
Supersedes C-128
Effective 1-1-65
OIL CONSERVATION DIVISION
SANTA FE

All distances must be from the outer boundaries of the Section

Operator Sun Exploration & Producing Company			Lease State "A" A/C 2		Well No. 64
Section Letter A	Section 8	Township 22 South	Range 36 East	County Lea County	

Well Footage Location of Well:					
1250 feet from the	North	line and	1250 feet from the	East	line
Point Elev. 3564.4	Producing Formation Queen	Pool Eunice Seven Rivers Queen South	Dedicated Acreage 40 Acres		

- Outline the acreage dedicated to the subject well by colored pencil or hachure marks on the plat below.
- If more than one lease is dedicated to the well, outline each and identify the ownership thereof (both as to working interest and royalty).
- If more than one lease of different ownership is dedicated to the well, have the interests of all owners been consolidated by communitization, unitization, force-pooling, etc?

☐ Yes ☐ No If answer is "yes," type of consolidation _____

If answer is "no," list the owners and tract descriptions which have actually been consolidated. (Use reverse side of this form if necessary.) _____

No allowable will be assigned to the well until all interests have been consolidated (by communitization, unitization, forced-pooling, or otherwise) or until a non-standard unit, eliminating such interests, has been approved by the Commission.

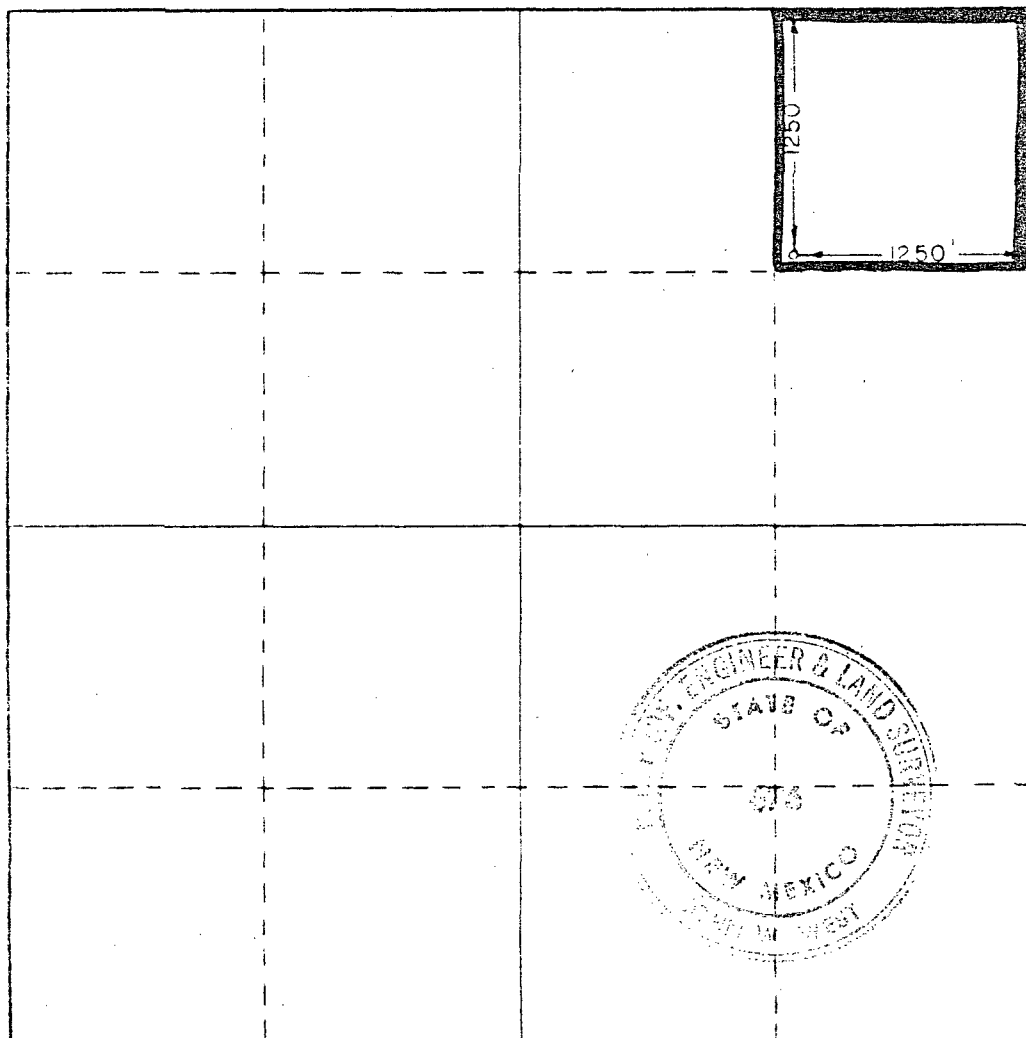

CERTIFICATION

I hereby certify that the information contained herein is true and complete to the best of my knowledge and belief.

Name
Dee Ann Kemp
Position
Senior Acct. Asst.
Company
Sun Exploration & Production Co.
Date
7-12-83

I hereby certify that the well location shown on this plat was plotted from field notes of actual surveys made by me or under my supervision, and that the same is true and correct to the best of my knowledge and belief.

Date Surveyed
June 30, 1983
Registered Professional Engineer and/or Land Surveyor

John W. West
Certificate No. JOHN W. WEST, 676
RONALD J. EIDSON, 3239



RECEIVED		
DISTRIBUTION		
SANTA FE		
FILE		
U.S.G.S.		
LAND OFFICE		
OPERATOR		

NEW MEXICO OIL CONSERVATION COMMISSION

Form O-101
Revised 1-4-65

API NO.

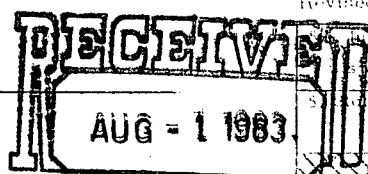
State ☒ SANTA FE ☐ FREE
Oil & Gas Lease No.

APPLICATION FOR PERMIT TO DRILL, DEEPEN, OR PLUG BACK

1a. Type of Work DRILL <input checked="" type="checkbox"/> DEEPEN <input type="checkbox"/> PLUG BACK <input type="checkbox"/>		SANTA FE		7. Unit Agreement Name	
5. Type of Well OIL WELL <input type="checkbox"/> GAS WELL <input type="checkbox"/> OTHER <input type="checkbox"/> WIW		SINGLE ZONE <input checked="" type="checkbox"/> MULTIPLE ZONE <input type="checkbox"/>		8. Firm or Lease Name State "A" A/C 2	
2. Name of Operator Sun Exploration & Production Co.				9. Well No. 65	
3. Address of Operator P. O. Box 1861 - Midland, Texas 79702				10. Field and Pool, or District Eunice Seven Rivers Queen South	
4. Location of Well UNIT LETTER <u>E</u> LOCATED <u>1345</u> FEET FROM THE <u>North</u> LINE AND <u>25</u> FEET FROM THE <u>West</u> LINE 1/4 SEC. <u>9</u> TWP. <u>22-S</u> RGE. <u>36-E</u> NMPM				12. County Lea	
19. Proposed Depth 4000		19A. Formation *		20. Rotary or C.T. Rotary	
21. Deviations (show whether DE, RT, etc.) 3559' GR		21A. Kind & Status Plug Bond Blanket on file		21B. Drilling Contractor N/A	
				22. Approx. Date Work will start ASAP	

23. PROPOSED CASING AND CEMENT PROGRAM

SIZE OF HOLE	SIZE OF CASING	WEIGHT PER FOOT	SETTING DEPTH	SACKS OF CEMENT	EST. TOP
12 1/4	8-5/8	24#	550	375 sxs	Surface
7-7/8	5-1/2	14#	3900	1100 sxs	Surface

Blowout preventer 10' Hydraulic

*19A. Primary Reservoir - Queen
Secondary Reservoir - Seven Rivers

IN ABOVE SPACE DESCRIBE PROPOSED PROGRAM: IF PROPOSAL IS TO DEEPEN OR PLUG BACK, GIVE DATA ON PRESENT PRODUCTIVE ZONE AND PROPOSED NEW PRODUCTIVE ZONE. GIVE BLOWOUT PREVENTER PROGRAM, IF ANY.

I hereby certify that the information above is true and complete to the best of my knowledge and belief.

Signed DuAnn Kemp Title Senior Accounting Assistant Date 7-12-83

(This space for State Use)

APPROVED BY _____ TITLE _____ DATE _____

CONDITIONS OF APPROVAL, IF ANY:

NEW MEXICO OIL CONSERVATION COMMISSION
WELL LOCATION AND ACREAGE DEDICATION PLAT

All distances must be from the outer boundaries of the Section

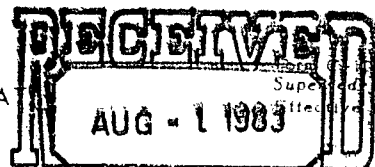

Supersedes C-128
Effective 1-1-85

Operator Sun Exploration & Producing Company			Lease State "A" A/C 2		OIL CONSERVATION DIVISION SANTA FE W/W	
Grid Letter E	Section 9	Township 22 South	Range 36 East	County Lea County		

A. Well Footage Location of Well:

1345 feet from the **North** line and **25** feet from the **West** line

Ground Level Elev. 3559.0	Producing Formation Queen / Sewer Rivers	Pool Eunice Sewer Rivers Queen South	Dedicated Acreage —
-------------------------------------	--	--	-------------------------------

1. Outline the acreage dedicated to the subject well by colored pencil or hatchure marks on the plat below.
2. If more than one lease is dedicated to the well, outline each and identify the ownership thereof (both as to working interest and royalty).
3. If more than one lease of different ownership is dedicated to the well, have the interests of all owners been consolidated by communitization, unitization, force-pooling, etc?

☐ Yes ☐ No If answer is "yes," type of consolidation _____

If answer is "no," list the owners and tract descriptions which have actually been consolidated. (Use reverse side of this form if necessary.) _____

No allowable will be assigned to the well until all interests have been consolidated (by communitization, unitization, forced-pooling, or otherwise) or until a non-standard unit, eliminating such interests, has been approved by the Commission.

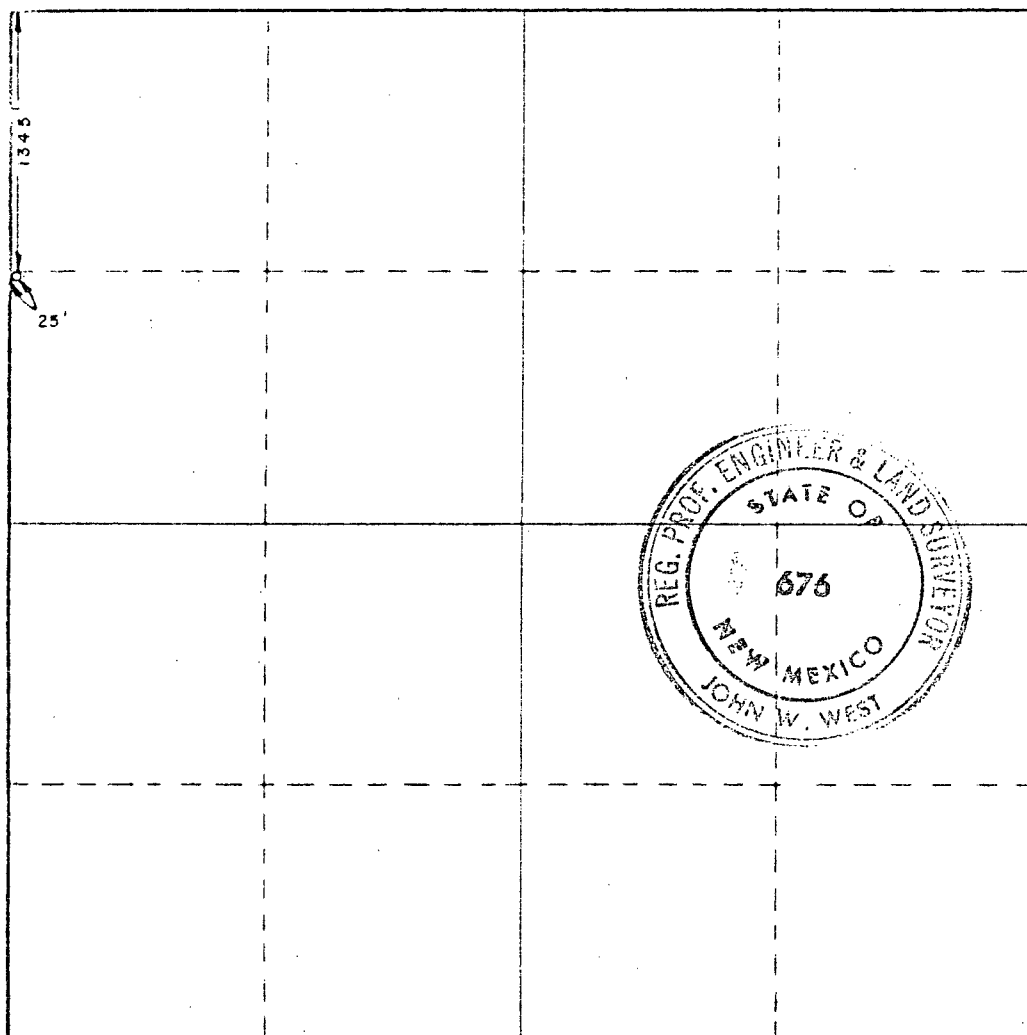

CERTIFICATION

I hereby certify that the information contained herein is true and complete to the best of my knowledge and belief.

Dee Ann Kemp
Name

Dee Ann Kemp
Position

Sr. Acct. Asst.
Company

Sun Exploration & Production Co.
Date

7-12-83

I hereby certify that the well location shown on this plat was plotted from field notes of actual surveys made by me or under my supervision, and that the same is true and correct to the best of my knowledge and belief.

Date Surveyed

June 23 & 24, 1983

Registered Professional Engineer
and/or Land Surveyor

John W. West

Certificate No. **JOHN W. WEST, 676**

RONALD J. EIDSON, 3239

0 330 660 990 1320 1650 1980 2310 2640 2970 3300 3630 3960 4290 4620 4950 5280 5610 5940 6270 6600

COPIES RECEIVED	
DISTRIBUTION	
SANTA FE	
FILE	
U.S.G.S.	
LAND OFFICE	
OPERATOR	

NEW MEXICO OIL CONSERVATION COMMISSION

API NO. _____

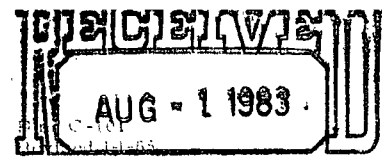

OIL CONSERVATION DIVISION
STATE SANTA FE

5. State Oil & Gas Lease No.

APPLICATION FOR PERMIT TO DRILL, DEEPEN, OR PLUG BACK

6a. Type of Work DRILL <input checked="" type="checkbox"/> DEEPEN <input type="checkbox"/> PLUG BACK <input type="checkbox"/>		7. Unit Agreement Name
6b. Type of Well OIL WELL <input checked="" type="checkbox"/> GAS WELL <input type="checkbox"/> OTHER <input type="checkbox"/> SINGLE ZONE <input checked="" type="checkbox"/> MULTIPLE ZONE <input type="checkbox"/>		8. Firm or Lease Name State "A" A/C 2
9. Name of Operator Sun Exploration & Production Co.		9. Well No. 66
10. Address of Operator P. O. Box 1861 - Midland, Texas 79702		10. Field and Pool, or Wildcat Eunice Seven Rivers Queen South
11. Location of Well UNIT LETTER <u>F</u> LOCATED <u>1345</u> FEET FROM THE <u>North</u> LINE AND <u>1345</u> FEET FROM THE <u>WEST</u> LINE OF SEC. <u>9</u> TWP. <u>22-S</u> RGE. <u>36-E</u> NMPM		12. County Lea
13. Proposed Depth 4000		13A. Formation *
13B. Drilling Contractor N/A		13C. Rotary or C.T.F. Rotary
14. Elevations (Show whether DF, RL, etc.) 3565.4' GR	15. Kind & Status Plug. Bond Blanket on file	16. Approx. Date Work will start ASAP

PROPOSED CASING AND CEMENT PROGRAM

SIZE OF HOLE	SIZE OF CASING	WEIGHT PER FOOT	SETTING DEPTH	SACKS OF CEMENT	EST. TOP
12 1/4	8-5/8	24#	550	375 sxs	Surface
7-7/8	5 1/2	14#	3900	1100 sxs	Surface

Blowout preventer: 10" Hydraulic

*19A. Primary Reservoir - Queen
Secondary Reservoir - Seven Rivers

IN ABOVE SPACE DESCRIBE PROPOSED PROGRAM: IF PROPOSAL IS TO DEEPEN OR PLUG BACK, GIVE DATA ON PRESENT PRODUCTIVE ZONE AND PROPOSED NEW PRODUCTIVE ZONE. GIVE BLOWOUT PREVENTER PROGRAM, IF ANY.

I hereby certify that the information above is true and complete to the best of my knowledge and belief.

Signed P. Ann Kemp Title Senior Accounting Assistant Date 7-12-83

(This space for State Use)

APPROVED BY _____ TITLE _____ DATE _____

CONDITIONS OF APPROVAL, IF ANY:

NEW MEXICO OIL CONSERVATION COMMISSION
WELL LOCATION AND ACREAGE DEDICATION PLAT

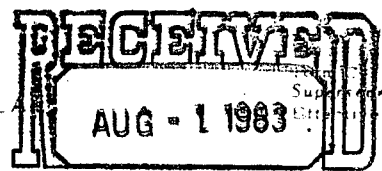

All distances must be from the outer boundaries of the Section

Lessor Sun Exploration & Producing Company			Lessee State A A/C 2			OIL CONSERVATION DIVISION	
						SANTA FE 66	
Well Letter F	Section 9	Township 22 South	Range 36 East	County Lea County			
Actual Footage Location of Well:							
1345 feet from the North		1345 feet from the West					
Drum Level Elev. 3565.4	Producing Formation Queen		Pool Euwice Seven Rivers Queen South		Estimated Acreage 40 Acres		

1. Outline the acreage dedicated to the subject well by colored pencil or hatchure marks on the plat below.
2. If more than one lease is dedicated to the well, outline each and identify the ownership thereof (both as to working interest and royalty).
3. If more than one lease of different ownership is dedicated to the well, have the interests of all owners been consolidated by communitization, unitization, force-pooling, etc?

☐ Yes ☐ No If answer is "yes," type of consolidation _____

If answer is "no," list the owners and tract descriptions which have actually been consolidated. (Use reverse side of this form if necessary.) _____

No allowable will be assigned to the well until all interests have been consolidated (by communitization, unitization, forced-pooling, or otherwise) or until a non-standard unit, eliminating such interests, has been approved by the Commission.

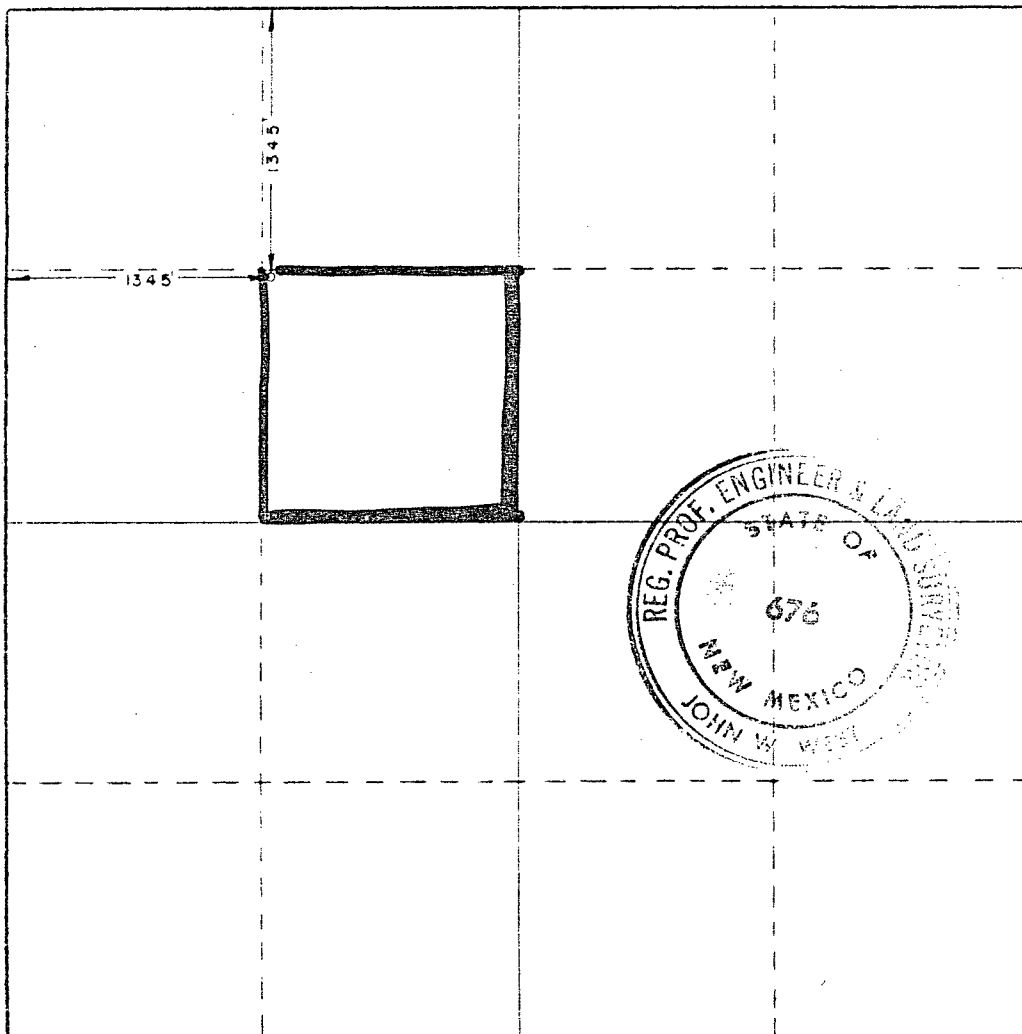

CERTIFICATION

I hereby certify that the information contained herein is true and complete to the best of my knowledge and belief.

Dee Ann Kemp

Dee Ann Kemp

Sr. Acct. Asst.

Sun Exploration & Production Co.

7-13-83

I hereby certify that the well location shown on this plat was plotted from field notes of actual surveys made by me or under my supervision, and that the same is true and correct to the best of my knowledge and belief.

Date Surveyed

June 23 & 24, 1983

Registered Professional Engineer and/or Land Surveyor

John W. West

Certificate No. **JOHN W. WEST, 676**
RONALD J. EIDSON, 3239



COPIES RECEIVED		
DISTRIBUTION		
SANTA FE		
FILE		
U.S.G.S.		
LAND OFFICE		
OPERATOR		

NEW MEXICO OIL CONSERVATION COMMISSION

API NO.

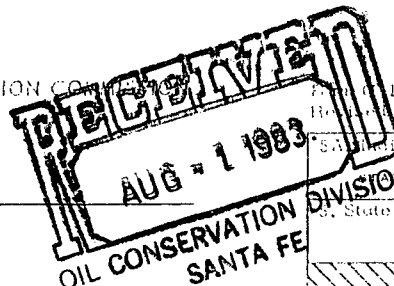
Form 101
Revised 11-4-85

State Oil & Gas Lease No.

State Type of Lease ☒ ☐

State Oil & Gas Lease No.

APPLICATION FOR PERMIT TO DRILL, DEEPEN, OR PLUG BACK

1a. Type of Work DRILL <input checked="" type="checkbox"/> DEEPEN <input type="checkbox"/> PLUG BACK <input type="checkbox"/>		7. Unit Agreement Name
b. Type of Well OIL WELL <input type="checkbox"/> GAS WELL <input type="checkbox"/> OTHER <u>WIW</u> SINGLE ZONE <input checked="" type="checkbox"/> MULTIPLE ZONE <input type="checkbox"/>		8. Firm or Lease Name State "A" A/C 2
c. Name of Operator Sun Exploration & Production Co.		9. Well No. 67
d. Address of Operator P. O. Box 1861 - Midland, Texas 79702		10. Field and Pool, or Wildcat Eunice Seven Rivers Queen South
4. Location of Well UNIT LETTER <u>K</u> LOCATED <u>2615</u> FEET FROM THE <u>South</u> LINE AND <u>1345</u> FEET FROM THE <u>West</u> LINE OF SEC. <u>9</u> TWP. <u>22-S</u> RGE. <u>36-E</u> NMPM		11. County Lea
19. Proposed Depth 4000		19A. Formation *
20. Rotary or C.M. Rotary		
21. Elevations (show whether DE, RT, etc.) 3579.8' GR	21A. Kind & Status Plat. Bond Blanket on file	21B. Drilling Contractor N/A
22. Approx. Date Work will start ASAP		

23.

PROPOSED CASING AND CEMENT PROGRAM

SIZE OF HOLE	SIZE OF CASING	WEIGHT PER FOOT	SETTING DEPTH	SACKS OF CEMENT	EST. TOP
12 1/4	8-5/8	24#	550	375 sxs	Surface
7-7/8	5-1/2	14#	3900	1100 sxs	Surface

Blowout preventer: 10" Hydraulic

*19A. Primary Reservoir - Queen
Secondary Reservoir - Seven Rivers

IN ABOVE SPACE DESCRIBE PROPOSED PROGRAM: IF PROPOSAL IS TO DEEPEN OR PLUG BACK, GIVE DATA ON PRESENT PRODUCTIVE ZONE AND PROPOSED NEW PRODUCTIVE ZONE. GIVE BLOWOUT PREVENTER PROGRAM, IF ANY.

I hereby certify that the information above is true and complete to the best of my knowledge and belief.

Signed Dee Ann Kemp Title Senior Accounting Assistant Date 7-12-83

(This space for State Use)

APPROVED BY _____ TITLE _____ DATE _____

CONDITIONS OF APPROVAL, IF ANY:

NEW MEXICO OIL CONSERVATION COMMISSION
WELL LOCATION AND ACREAGE DEDICATION PLAT

Form O-128
AUG - 1 1983
Effective 1-1-83
OIL CONSERVATION DIVISION

All distances must be from the outer boundaries of the Section

Operator Sun Exploration & Producing Company			Lease State "A" A/C 2		SANTA FE 67 W/W	
Unit Letter K	Section 9	Township 22 South	Range 36 East	County Lea County		
Actual Footage Location of Well: 2615 feet from the South line and 1345 feet from the West line						
Ground Level Elev. 3579.8	Producing Formation Queen		Pool Euire Sevo Rivers Queen South		Dedicated Acreage: Acres	

- Outline the acreage dedicated to the subject well by colored pencil or hachure marks on the plat below.
- If more than one lease is dedicated to the well, outline each and identify the ownership thereof (both as to working interest and royalty).
- If more than one lease of different ownership is dedicated to the well, have the interests of all owners been consolidated by communitization, unitization, force-pooling, etc?

☐ Yes ☐ No If answer is "yes," type of consolidation _____

If answer is "no," list the owners and tract descriptions which have actually been consolidated. (Use reverse side of this form if necessary.) _____

No allowable will be assigned to the well until all interests have been consolidated (by communitization, unitization, forced-pooling, or otherwise) or until a non-standard unit, eliminating such interests, has been approved by the Commission.

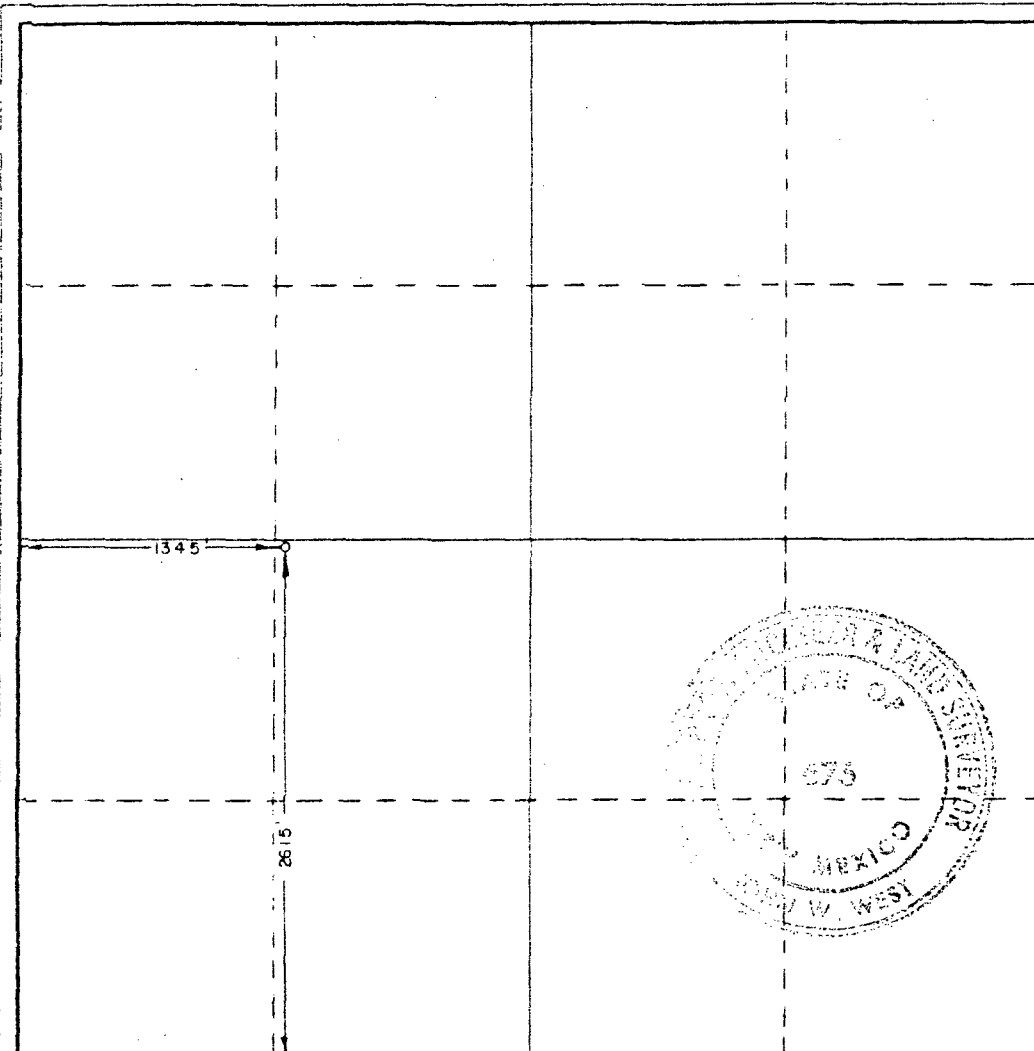

CERTIFICATION

I hereby certify that the information contained herein is true and complete to the best of my knowledge and belief.

Dee Ann Kemp
Dee Ann Kemp
Senior Acct. Asst.
Sun Exploration & Production Co.
Date 7-12-83

I hereby certify that the well location shown on this plat was plotted from field notes of actual surveys made by me or under my supervision, and that the same is true and correct to the best of my knowledge and belief.

Date Surveyed
June 25, 1983

Registered Professional Engineer
and/or Land Surveyor

John W. West

Certificate No. JOHN W. WEST, 676
RONALD J. EIDSON, 3239

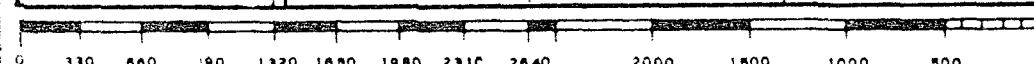

NO. OF COPIES RECEIVED	
DISTRIBUTION	
SANTA FE	
FILE	
U.S.G.S.	
LAND OFFICE	
OPERATOR	

NEW MEXICO OIL CONSERVATION COMMISSION

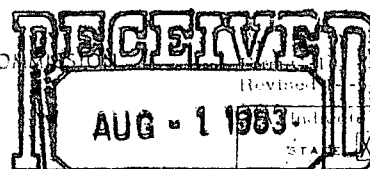

API NO.

OIL CONSERVATION DIVISION
SANTA FE

Revised	
Unit Agreement Name	
Firm or Lease Name	
State "A" A/C 2	
Well No.	
Field and Pool, or wildcat	
Eunice Seven Rivers	
Queen South	
County	
Lea	

APPLICATION FOR PERMIT TO DRILL, DEEPEN, OR PLUG BACK			
1a. Type of Work DRILL <input checked="" type="checkbox"/> DEEPEN <input type="checkbox"/> PLUG BACK <input type="checkbox"/>		7. Unit Agreement Name	
b. Type of Well OIL WELL <input checked="" type="checkbox"/> GAS WELL <input type="checkbox"/> OTHER <input type="checkbox"/>		8. Firm or Lease Name	
2. Name of Operator Sun Exploration & Production Co.		State "A" A/C 2	
3. Address of Operator P. O. Box 1861 - Midland, Texas 79702		9. Well No. 68	
4. Location of Well UNIT LETTER E LOCATED 2570 FEET FROM THE North LINE AND 70 FEET FROM THE West LINE OF SEC. 9 TWP. 22-S RGE. 36-E NMPM		10. Field and Pool, or wildcat Eunice Seven Rivers Queen South	
18. Proposed Depth 4000		19A. Formation *	
20. Rotary or C.R. Rotary		21. Elevations (Show whether DE, RT, etc.) 3585.0' GR	
21A. Kind & Status Plug. Bond Blanket on file		21B. Drilling Contractor N/A	
22. Approx. Date Work will start ASAP			

PROPOSED CASING AND CEMENT PROGRAM

SIZE OF HOLE	SIZE OF CASING	WEIGHT PER FOOT	SETTING DEPTH	SACKS OF CEMENT	EST. TOP
12 1/4	8-5/8	24#	550	375 sxs	Surface
7-7/8	5-1/2	14#	3900	1100 sxs	Surface

Blowout preventer 10" hydraulic

*19A. Primary Reservoir - Queen
Secondary Reservoir - Seven Rivers

IN ABOVE SPACE DESCRIBE PROPOSED PROGRAM: IF PROPOSAL IS TO DEEPEN OR PLUG BACK, GIVE DATA ON PRESENT PRODUCTIVE ZONE AND PROPOSED NEW PRODUCTIVE ZONE. GIVE BLOWOUT PREVENTER PROGRAM, IF ANY.

I hereby certify that the information above is true and complete to the best of my knowledge and belief.

Signed Dee Ann Long Title Senior Accounting Assistant Date 7-12-83

(This space for State Use)

APPROVED BY _____ TITLE _____ DATE _____

CONDITIONS OF APPROVAL, IF ANY:

**NEW MEXICO OIL CONSERVATION COMMISSION
WELL LOCATION AND ACREAGE DEDICATION PLAT**

Form C-102
Supersedes C-128
Effective 1-1-65

All distances must be from the outer boundaries of the Section.

Operator Sun Exploration & Producing Company			Lease State "A" A/C 2		Well No. 68
Unit Letter E	Section 9	Township 22 South	Range 36 East	County Lea County	
Actual Footage Location of Well: <div style="display: flex; justify-content: space-between; align-items: center;"> 2570 feet from the North line and 70 feet from the West line </div>					
Ground Level Elev. 3585.0	Producing Formation Quercu		Pool Enrico Seven Rivers Quercu South		Dedicated Acreage: 40 Acres

1. Outline the acreage dedicated to the subject well by colored pencil or hatchure marks on the plat below.
2. If more than one lease is dedicated to the well, outline each and identify the ownership thereof (both as to working interest and royalty).
3. If more than one lease of different ownership is dedicated to the well, have the interests of all owners been consolidated by communitization, unitization, force-pooling, etc?

☐ Yes ☐ No If answer is "yes," type of consolidation _____

If answer is "no," list the owners and tract descriptions which have actually been consolidated. (Use reverse side of this form if necessary.) _____

No allowable will be assigned to the well until all interests have been consolidated (by communitization, unitization, forced-pooling, or otherwise) or until a non-standard unit, eliminating such interests, has been approved by the Commission.

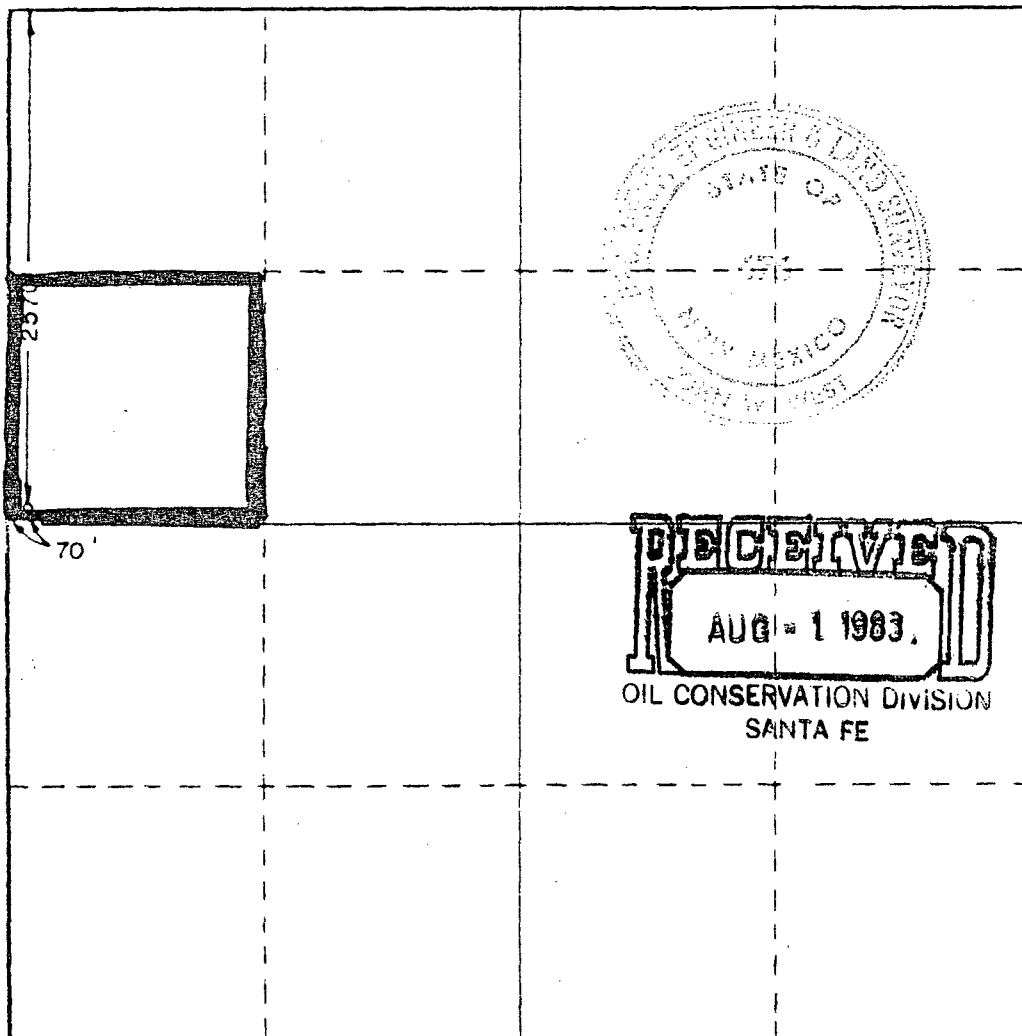

CERTIFICATION

I hereby certify that the information contained herein is true and complete to the best of my knowledge and belief.

Dec Ann Kemp

Dec Ann Kemp

Position
Sr. Acct. Asst.

Company
Sun Exploration & Production Co.

Date
7-13-83

I hereby certify that the well location shown on this plat was plotted from field notes of actual surveys made by me or under my supervision, and that the same is true and correct to the best of my knowledge and belief.

Date Surveyed
June 30, 1983

Registered Professional Engineer and/or Land Surveyor

[Signature]

Certificate No. **JOHN W. WEST, 676**
RONALD J. EIDSON, 3239

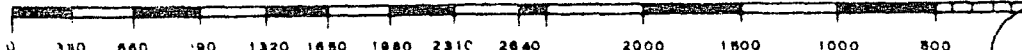

NO. OF COPIES RECEIVED		
DISTRIBUTION		
SANTA FE		
FILE		
U.S.G.S.		
LAND OFFICE		
OPERATOR		

NEW MEXICO OIL CONSERVATION COMMISSION

API NO. _____

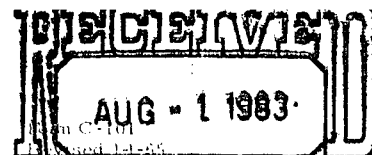

OIL CONSERVATION DIVISION
STATE SANTA FE FEE ☐

State Oil & Gas Lease No. _____

APPLICATION FOR PERMIT TO DRILL, DEEPEN, OR PLUG BACK

1a. Type of Work b. Type of Well OIL WELL <input type="checkbox"/> GAS WELL <input type="checkbox"/> OTHER <u>WIW</u> c. Name of Operator <u>Sun Exploration & Production Co.</u> d. Address of Operator <u>P. O. Box 1861 - Midland, Texas 79702</u> e. Location of Well UNIT LETTER <u>I</u> LOCATED <u>2615</u> FEET FROM THE <u>South</u> LINE AND <u>1295</u> FEET FROM THE <u>East</u> LINE OF SEC. <u>8</u> TWP. <u>22-S</u> RGE. <u>36-E</u> NMPM 19. Proposed Depth <u>4000</u> 19A. Formation <u>*</u> 20. Rotary or C.T. <u>Rotary</u> 21. Test Notes (Show whether DE, RT, etc.) <u>3550.3' GR</u> 21A. Kind & Status Plug Bond <u>Blanket on file</u> 21B. Drilling Contractor <u>N/A</u> 22. Approx. Date Work will start <u>ASAP-</u>				7. Unit Agreement Name 8. Farm or Lease Name <u>State "A" A/C 2</u> 9. Well No. <u>69</u> 10. Field and Pool, or Wildcat <u>Eunice Seven Rivers</u> <u>Queen South</u> 12. County <u>Lea</u>	
---	--	--	--	---	--

23.

PROPOSED CASING AND CEMENT PROGRAM

SIZE OF HOLE	SIZE OF CASING	WEIGHT PER FOOT	SETTING DEPTH	SACKS OF CEMENT	EST. TOP
12 1/4	8-5/8	24#	550	375 sxs	Surface
7-7/8	5-1/2	14#	3900	1100 sxs	Surface

Blowout preventer 10" Hydraulic

*19A. Primary Reservoir - Queen
Secondary Reservoir - Seven Rivers

IN ABOVE SPACE DESCRIBE PROPOSED PROGRAM: IF PROPOSAL IS TO DEEPEN OR PLUG BACK, GIVE DATA ON PRESENT PRODUCTIVE ZONE AND PROPOSED NEW PRODUCTIVE ZONE. GIVE BLOWOUT PREVENTER PROGRAM, IF ANY.

I hereby certify that the information above is true and complete to the best of my knowledge and belief.

Signed DeAnn Kemp Title Senior Accounting Assistant Date 7-12-83
(This space for State Use)

APPROVED BY _____ TITLE _____ DATE _____

CONDITIONS OF APPROVAL, IF ANY:

NEW MEXICO OIL CONSERVATION COMMISSION
WELL LOCATION AND ACREAGE DEDICATION PLAT

AUG - 1 1983

All distances must be from the outer boundaries of the Section OIL CONSERVATION DIVISION

Operator Sun Exploration & Producing Company			Lease State "A" A/C 2		SANTA FE Well # 69 W/W
Unit Letter I	Section 8	Township 22 South	Range 36 East	County Lea County	

Actual Footage Location of Well:

2615 feet from the South line and		1295 feet from the East line	
Ground Level Elev. 3550.3	Producing Formation Queen	Pool Elmwood Sp. Res. Rivers Queen South	Dedicated Acreage —

1. Outline the acreage dedicated to the subject well by colored pencil or hatchure marks on the plat below.
2. If more than one lease is dedicated to the well, outline each and identify the ownership thereof (both as to working interest and royalty).
3. If more than one lease of different ownership is dedicated to the well, have the interests of all owners been consolidated by communitization, unitization, force-pooling, etc?

☐ Yes ☐ No If answer is "yes," type of consolidation _____

If answer is "no," list the owners and tract descriptions which have actually been consolidated. (Use reverse side of this form if necessary.) _____

No allowable will be assigned to the well until all interests have been consolidated (by communitization, unitization, forced-pooling, or otherwise) or until a non-standard unit, eliminating such interests, has been approved by the Commission.

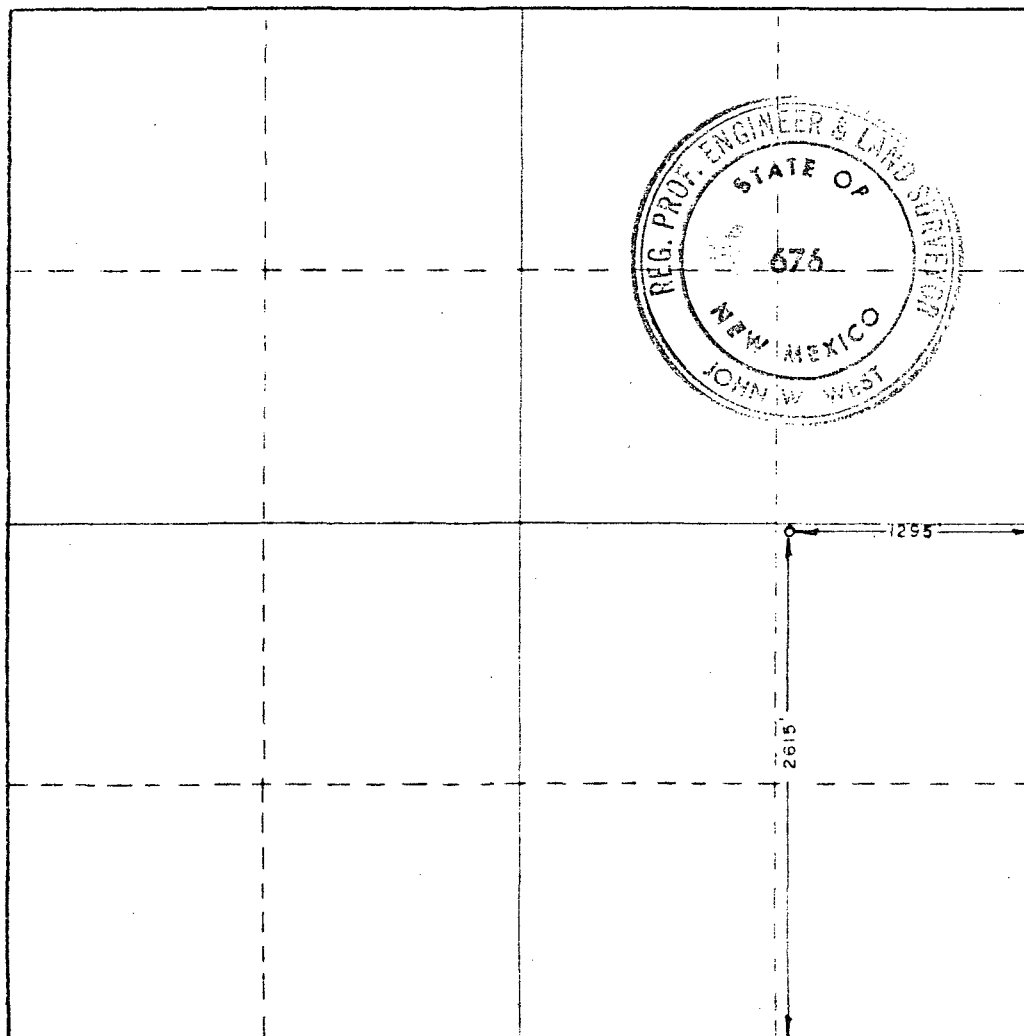

CERTIFICATION

I hereby certify that the information contained herein is true and complete to the best of my knowledge and belief.

Dee Ann Kemp

Dee Ann Kemp

Sr. Acct. Asst.

Sun Exploration & Production Co.

7-13-83

I hereby certify that the well location shown on this plat was plotted from field notes of actual surveys made by me or under my supervision, and that the same is true and correct to the best of my knowledge and belief.

Date Surveyed

June 23 & 24, 1983

Registered Professional Engineer
and/or Land Surveyor

John W. West

Certificate No. **JOHN W. WEST, 676**

RONALD J. EIDSON, 3239

0 330 660 990 1320 1650 1980 2310 2640 2970 3300 3630 3960 4290 4620 4950 5280 5610 5940 6270 6600

AUG - 1 1983

OIL CONSERVATION DIVISION
Revised 1-1-65

NEW MEXICO OIL CONSERVATION COMMISSION

NO. OF COPIES RECEIVED	
DISTRIBUTION	
SANTA FE	
FILE	
U.S.G.S.	
LAND OFFICE	
OPERATOR	

API NO. _____

5A. Indicate Type of Lease
STATE ☒ FEE ☐
5. State Oil & Gas Lease No.

APPLICATION FOR PERMIT TO DRILL, DEEPEN, OR PLUG BACK

1a. Type of Work
b. Type of Well
DRILL ☒ DEEPEN ☐ PLUG BACK ☐
OIL WELL ☒ GAS WELL ☐ OTHER ☐
SINGLE ZONE ☒ MULTIPLE ZONE ☐

7. Unit Agreement Name

2. Name of Operator
Sun Exploration & Production Co.

8. Form or Lease Name
State "A" A/C 2

3. Address of Operator
P. O. Box 1861 - Midland, Texas 79702

9. Well No.
70

4. Location of Well
UNIT LETTER P LOCATED 1295 FEET FROM THE South LINE
AND 1295 FEET FROM THE East LINE OF SEC. 8 TWP. 22-S RGE. 36-E NADEN

10. Field and Pool, or Wildcat
Eunice Seven Rivers
Queen South

12. County
Lea

19. Proposed Depth 4000	19A. Formation *	20. Rotary or C.T. Rotary
21. Elevations (Show whether D.P., R.P., etc.) 3560.6' GR	21A. Kind & Status of Top of Hole Blanket on file	21B. Drilling Contractor N/A
		22. Approx. Date Work will start ASAP

PROPOSED CASING AND CEMENT PROGRAM

SIZE OF HOLE	SIZE OF CASING	WEIGHT PER FOOT	SETTING DEPTH	SACKS OF CEMENT	EST. TOP
12 1/4	8-5/8	24#	550	375 sxs	Surface
7-7/8	5 1/2	14#	3900	1100 sxs	Surface

Blowout preventer: 10" Hydraulic

*19A. Primary Reservoir - Queen
Secondary Reservoir - Seven Rivers

4. ABOVE SPACE DESCRIBE PROPOSED PROGRAM. IF PROPOSAL IS TO DEEPEN OR PLUG BACK, GIVE DATA ON PRESENT PRODUCTIVE ZONE AND PROPOSED NEW PRODUCTIVE ZONE. GIVE BLOWOUT PREVENTER PROGRAM, IF ANY.

I hereby certify that the information above is true and complete to the best of my knowledge and belief.

Signed DeAnn Kemp Title Senior Accounting Assistant Date 7-12-83
(This space for State Use)

APPROVED BY _____ TITLE _____ DATE _____
CONDITIONS OF APPROVAL, IF ANY:

NEW MEXICO OIL CONSERVATION COMMISSION
WELL LOCATION AND ACREAGE DEDICATION PLAT

All distances must be from the outer boundaries of the Section

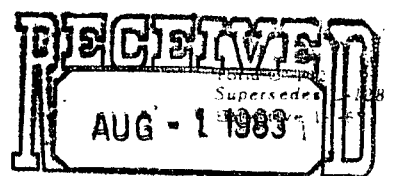

Operator Sun Exploration & Producing Company			Lease State "A" A/C 2			OIL CONSERVATION DIVISION SANTA FE		
Well Letter P	Section 8	Township 22 South	Range 36 East	County Lea County				
Actual Footage Location of Well:								
1295 feet from the South line and			1295 feet from the East line					
Ground Level Elev. 3560.6	Producing Formation Queen		Foot Eunice Sewer Rivers Queen South			Estimated Acreage 40 Acres		

1. Outline the acreage dedicated to the subject well by colored pencil or hatchure marks on the plat below.
2. If more than one lease is dedicated to the well, outline each and identify the ownership thereof (both as to working interest and royalty).
3. If more than one lease of different ownership is dedicated to the well, have the interests of all owners been consolidated by communitization, unitization, force-pooling, etc?

☐ Yes ☐ No If answer is "yes," type of consolidation _____

If answer is "no," list the owners and tract descriptions which have actually been consolidated (Use reverse side of this form if necessary.) _____

No allowable will be assigned to the well until all interests have been consolidated (by communitization, unitization, forced-pooling, or otherwise) or until a non-standard unit, eliminating such interests, has been approved by the Commission.

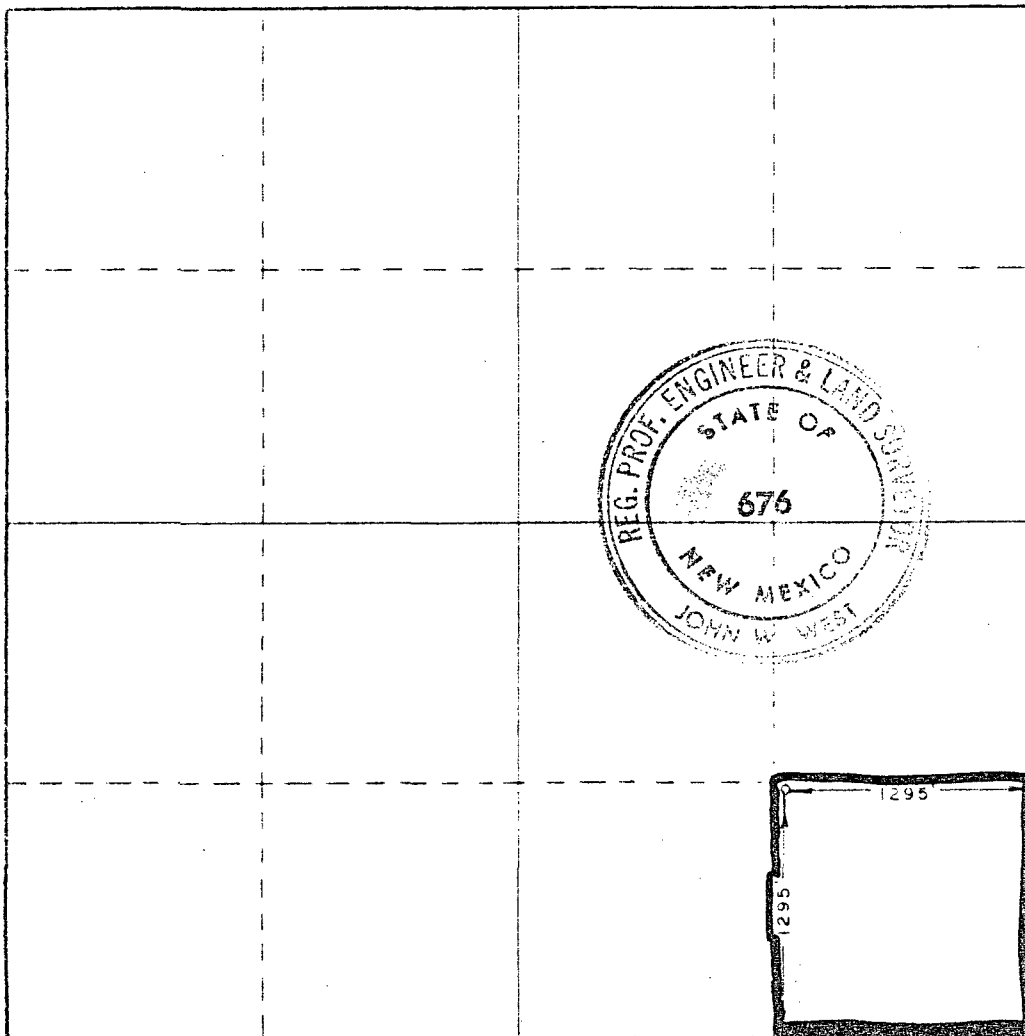

CERTIFICATION

I hereby certify that the information contained herein is true and complete to the best of my knowledge and belief.

Dee Ann Kemp

Dee Ann Kemp

Sr. Asst. Asst.

Sun Exploration & Production Co

7-13-83

I hereby certify that the well location shown on this plat was plotted from field notes of actual surveys made by me or under my supervision, and that the same is true and correct to the best of my knowledge and belief.

Date Surveyed

June 25, 1983

Registered Professional Engineer
in Oil and Gas Surveying

John W. West

Certificate No. **JOHN W. WEST, 676**
RONALD J. EIDSON, 3239

0 330 660 990 1320 1650 1980 2310 2640 2970 3300 3630 3960 4290 4620 4950 5280 5610 5940 6270 6600

NO. OF COPIES RECEIVED	
DISTRIBUTION	
SANTA FE	
FILE	
U.S.G.S.	
LAND OFFICE	
OPERATOR	

NEW MEXICO OIL CONSERVATION COMMISSION

API NO. _____

AUG - 1 1983

OIL CONSERVATION DIVISION
Form C-101
Revised 7-1-83
SANTA FE

5A. Indicate Type of Lease
STATE ☒ FEE ☐

5. State Oil & Gas Lease No.

APPLICATION FOR PERMIT TO DRILL, DEEPEN, OR PLUG BACK

1a. Type of Work		7. Unit Agreement Name	
b. Type of Well OIL WELL <input type="checkbox"/> GAS WELL <input type="checkbox"/> OTHER WIW <input type="checkbox"/> DRILL <input checked="" type="checkbox"/> DEEPEN <input type="checkbox"/> PLUG BACK <input type="checkbox"/> SINGLE ZONE <input checked="" type="checkbox"/> MULTIPLE ZONE <input type="checkbox"/>		8. Farm or Lease Name	
2. Name of Operator		State "A" A/C 2	
3. Address of Operator		9. Well No.	
P. O. Box 1361 - Midland, Texas 79702		71	
4. Location of Well UNIT LETTER <u>M</u> LOCATED <u>1295</u> FEET FROM THE <u>South</u> LINE AND <u>25</u> FEET FROM THE <u>West</u> LINE OF SEC. <u>9</u> TWP. <u>22-S</u> RGF. <u>36-E</u> NMPM		10. Field and Pool, or Wildcat	
		Eunice Seven Rivers Queen South	
		12. County	
		Lea	
		13. Proposed Depth	
		4000	
		14A. Formation	
		*	
		20. Rotary or C.T.	
		Rotary	
21. Elevation (Show whether HP, RL, etc.)		21A. Acre & Status (Plug, Blanket)	
3568.7' GR		Blanket on file	
		21B. Drilling Contractor	
		N/A	
		22. Approx. Date Work will start	
		ASAP -	

PROPOSED CASING AND CEMENT PROGRAM

SIZE OF HOLE	SIZE OF CASING	WEIGHT PER FOOT	SETTING DEPTH	SACKS OF CEMENT	EST. TOP
12 1/4	8-5/8	24#	550	375 sxs	Surface
7-7/8	5-1/2	14#	3900	1100 sxs	Surface

Blowout preventer: 10" Hydraulic

*19A. Primary Reservoir - Queen
Secondary Reservoir - Seven Rivers

IN ABOVE SPACE DESCRIBE PROPOSED PROGRAM; IF PROPOSAL IS TO DEEPEN OR PLUG BACK, GIVE DATA ON PRESENT PRODUCTIVE ZONE AND PROPOSED NEW PRODUCTIVE ZONE, GIVE BLOWOUT PREVENTER PROGRAM, IF ANY.

I hereby certify that the information above is true and complete to the best of my knowledge and belief.

Signed Dee Ann Kemp Title Sr. Accounting Assistant Date 7-12-83

(This space for State Use)

APPROVED BY _____ TITLE _____ DATE _____

CONDITIONS OF APPROVAL, IF ANY:

NEW MEXICO OIL CONSERVATION COMMISSION
WELL LOCATION AND ACREAGE DEDICATION PLAT

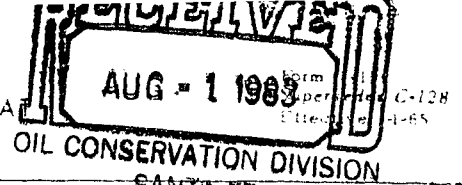

All distances must be from the outer boundaries of the Section

Operator Sun Exploration and Producing Company		Lease State "A" A/C 2		County SANTA FE	
Well Letter M	Section 9	Township 22 South	Range 36 East	County Lea County	

Actual Footage Location of Well:

1295 feet from the South line and 25 feet from the West line

Ground Level Elev. 3568.7	Producing Formation Queen	Foot Twice Seven Rivers Queen South	Estimated Acreage —
-------------------------------------	-------------------------------------	---	-------------------------------

1. Outline the acreage dedicated to the subject well by colored pencil or hatchure marks on the plat below.
2. If more than one lease is dedicated to the well, outline each and identify the ownership thereof (both as to working interest and royalty).
3. If more than one lease of different ownership is dedicated to the well, have the interests of all owners been consolidated by communitization, unitization, force-pooling, etc?

☐ Yes ☐ No If answer is "yes," type of consolidation _____

If answer is "no," list the owners and tract descriptions which have actually been consolidated. (Use reverse side of this form if necessary.) _____

No allowable will be assigned to the well until all interests have been consolidated (by communitization, unitization, forced-pooling, or otherwise) or until a non-standard unit, eliminating such interests, has been approved by the Commission.

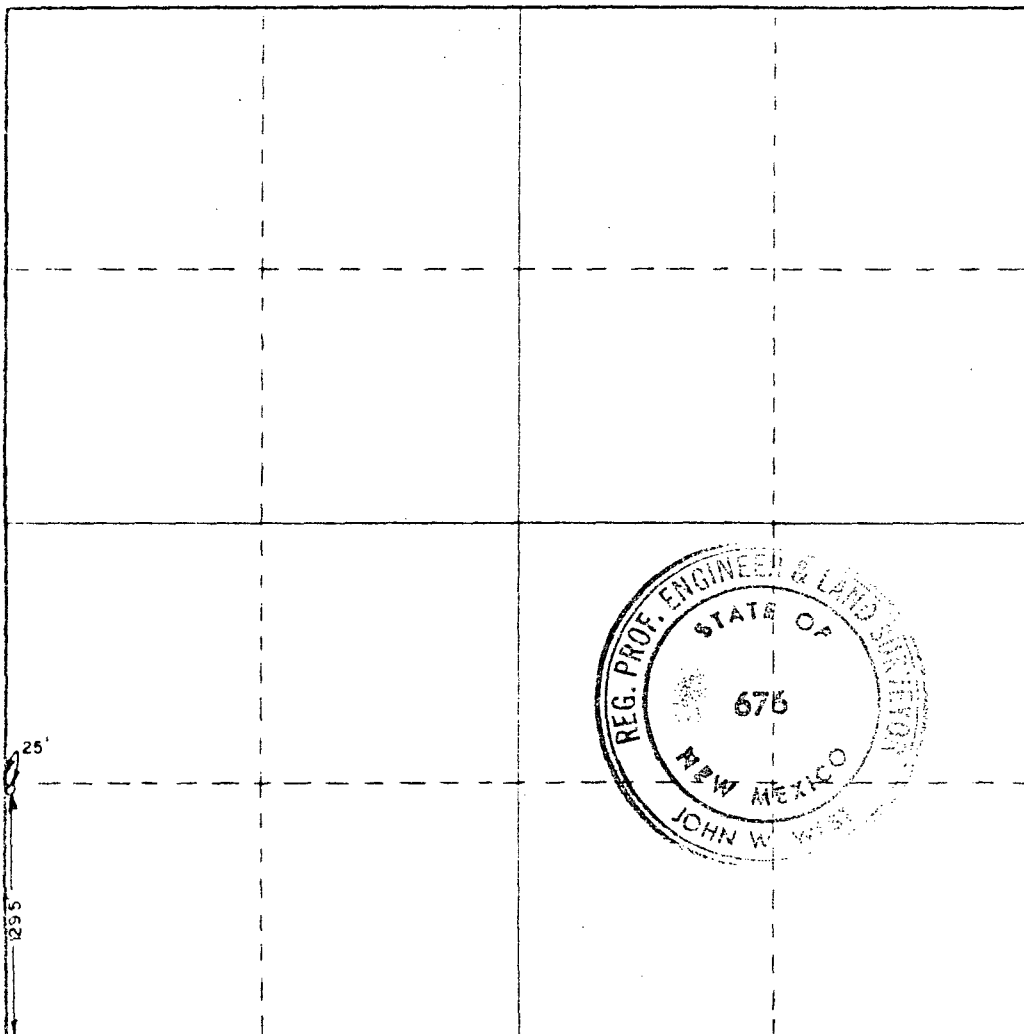

CERTIFICATION

I hereby certify that the information contained herein is true and complete to the best of my knowledge and belief.

Dee Ann Kemp

Dee Ann Kemp

Sr. Acct. Asst.

Sun Exploration & Production Co.

Date *7-12-83*

I hereby certify that the well location shown on this plat was plotted from field notes of actual surveys made by me or under my supervision, and that the same is true and correct to the best of my knowledge and belief.

Date Surveyed
June 25, 1983

Registered Professional Engineer
and/or Land Surveyor

John W. West

Certificate No **JOHN W. WEST, 676**
RONALD J. EIDSON, 3239

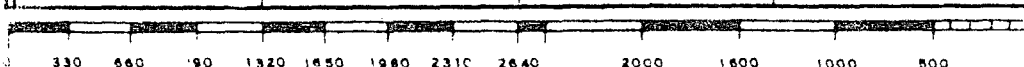

NO. OF COPIES RECEIVED	
DISTRIBUTION	
SANTA FE	
FILE	
U.S.G.S.	
LAND OFFICE	
OPERATOR	

NEW MEXICO OIL CONSERVATION COMMISSION

Form C-101
Revised 1-1-65

API NO. _____

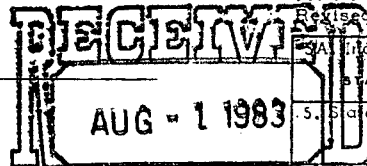

3A. Indicate Type of Lease

STATE ☒ FEE ☐

5. State Oil & Gas Lease No. _____

OIL CONSERVATION DIVISION

APPLICATION FOR PERMIT TO DRILL, DEEPEN, OR PLUG BACK SANTA FE

1a. Type of Work		7. Unit Agreement Name	
b. Type of Well DRILL <input checked="" type="checkbox"/> DEEPEN <input type="checkbox"/> PLUG BACK <input type="checkbox"/> OIL WELL <input checked="" type="checkbox"/> GAS WELL <input type="checkbox"/> OTHER <input type="checkbox"/> SINGLE ZONE <input checked="" type="checkbox"/> MULTIPLE ZONE <input type="checkbox"/>		8. Farm or Lease Name	
2. Name of Operator		State "A" A/C 2	
3. Address of Operator		9. Well No.	
Sun Exploration & Production Co.		72	
4. Location of Well		10. Field and Pool, or Wildcat	
UNIT LETTER <u>K</u> LOCATED <u>1410</u> FEET FROM THE <u>South</u> LINE		Eunice Seven Rivers	
AND <u>1440</u> FEET FROM THE <u>West</u> LINE OF SEC. <u>9</u> TWP. <u>22-S</u> RCP. <u>36-E</u> NMRM		Queen South	
		12. County	
		Lea	
		19. Proposed Depth	
		4000	
		19A. Formation	
		*	
		20. Rotary or C.T.	
		Rotary	
21. Elevations (Show whether DP, RT, etc.)		21B. Drilling Contractor	
3577.0' GR		Blanket on file	
		N/A	
		22. Approx. Date Work will start -	
		ASAP -	

23.

PROPOSED CASING AND CEMENT PROGRAM

SIZE OF HOLE	SIZE OF CASING	WEIGHT PER FOOT	SETTING DEPTH	SACKS OF CEMENT	EST. TOP
12 1/4	8-5/8	24#	550	375 sxs	Surface
7-7/8	5-1/2	14#	3900	1100 sxs	Surface

Blowout preventer: 10" Hydraulic

*19A. Primary Reservoir - Queen
Secondary Reservoir - Seven Rivers

IN ABOVE SPACE DESCRIBE PROPOSED PROGRAM; IF PROPOSAL IS TO DEEPEN OR PLUG BACK, GIVE DATA ON PRESENT PRODUCTIVE ZONE AND PROPOSED NEW PRODUCTIVE ZONE, GIVE BLOWOUT PREVENTER PROGRAM, IF ANY.

I hereby certify that the information above is true and complete to the best of my knowledge and belief.

Signed Dee Ann Kemp Title Senior Accounting Assistant Date 7-12-83

(This space for State Use)

APPROVED BY _____ TITLE _____ DATE _____

CONDITIONS OF APPROVAL, IF ANY:

NEW MEXICO OIL CONSERVATION COMMISSION
WELL LOCATION AND ACREAGE DEDICATION PLAT

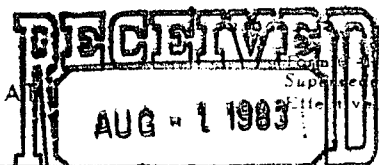

All distances must be from the outer boundaries of the Section.

Lessor Sun Exploration & Producing Company		Lease State "A" A/C 2		OIL CONSERVATION DIVISION SANTA FE 2	
Tract Letter K	Section 9	Township 22 South	Range 36 East	County Lea County	

Actual Footage Location of Well:

1410 feet from the South line and	1440 feet from the West line
Ground Level Elev. 3577.0	Producing Formation Queen
Pool Eunice Seven Rivers Queen South	Dedicated Acreage: 40 Acres

1. Outline the acreage dedicated to the subject well by colored pencil or hachure marks on the plat below.
2. If more than one lease is dedicated to the well, outline each and identify the ownership thereof (both as to working interest and royalty).
3. If more than one lease of different ownership is dedicated to the well, have the interests of all owners been consolidated by communitization, unitization, force-pooling, etc?

☐ Yes ☐ No If answer is "yes," type of consolidation _____

If answer is "no," list the owners and tract descriptions which have actually been consolidated. (Use reverse side of this form if necessary.) _____

No allowable will be assigned to the well until all interests have been consolidated (by communitization, unitization, forced-pooling, or otherwise) or until a non-standard unit, eliminating such interests, has been approved by the Commission.

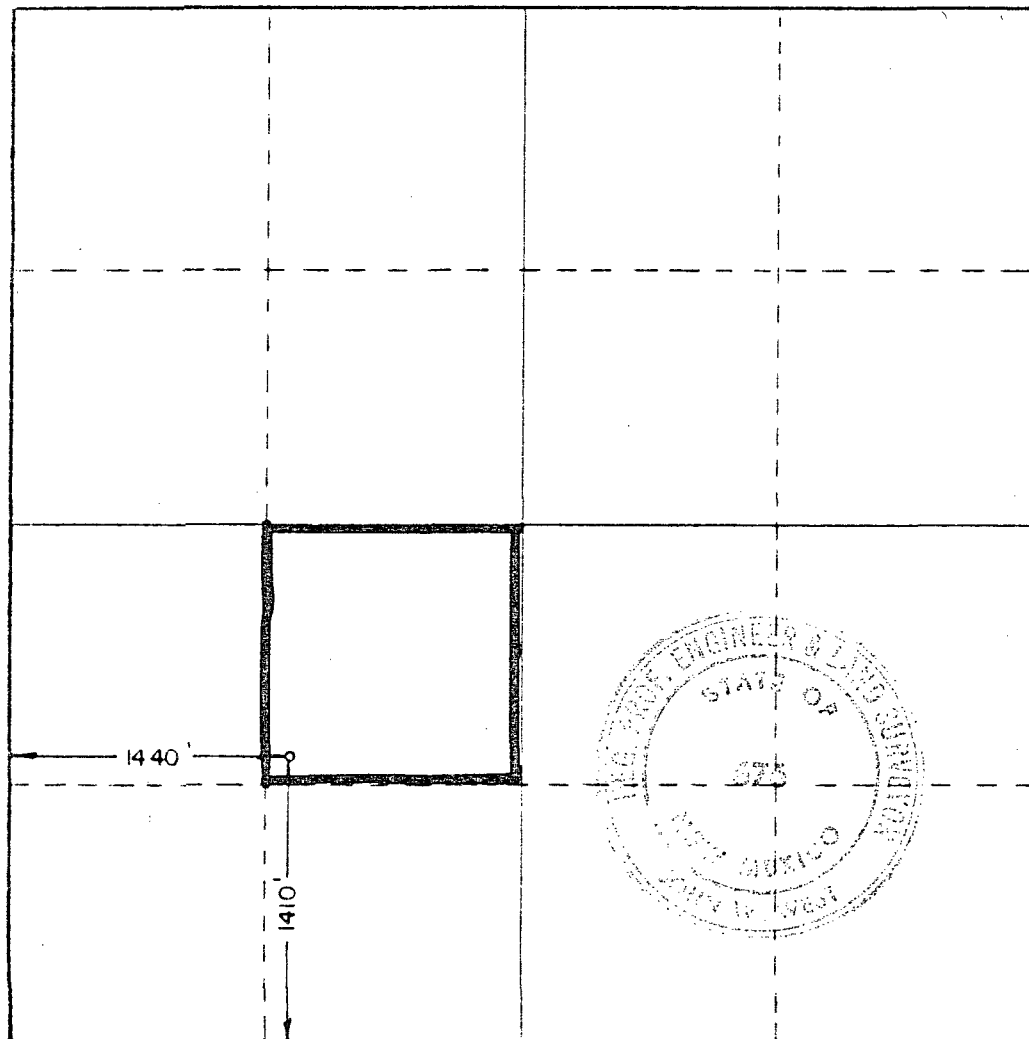

CERTIFICATION

I hereby certify that the information contained herein is true and complete to the best of my knowledge and belief.

De Ann Kemp

De Ann Kemp

Sr. Acct. Asst.

Company
Sun Exploration & Production Co

Date
7-13-83

I hereby certify that the well location shown on this plat was plotted from field notes of actual surveys made by me or under my supervision, and that the same is true and correct to the best of my knowledge and belief.

Date Surveyed
June 30, 1983

Registered Professional Engineer
and/or Land Surveyor

John W. West

Certificate No. JOHN W. WEST, 676
RONALD J. EIDSON, 3239



STATE OF NEW MEXICO
ENERGY AND MINERALS DEPARTMENT
OIL CONSERVATION DIVISION

July 20, 1983

TONY ANAYA
GOVERNOR

POST OFFICE BOX 2088
STATE LAND OFFICE BUILDING
SANTA FE, NEW MEXICO 87501
(505) 827-5800

Sun Exploration & Production Company
901 W. Wall
P. O. Box 1861
Midland, TX 79702

Re: Application for Non-Standard
Location: State "A" A/C 2 Wells
#65, 68, & 71, Unice Seven Rivers
Queen South

We may not process the subject application for non-standard location until the required information or plats checked below (is)(are) submitted.

- ☐ A plat must be submitted clearly showing the ownership of the offsetting leases.
- ☐ A statement must be submitted that offset owners have been notified of the application by certified mail.
- ☐ A plat must be submitted fully identifying the topography necessitating the non-standard location.
- ☒ Other: A plat of the waterflood project showing the locations of the wells must be submitted.

Very truly yours,

R. L. STAMETS
Technical Support Chief

RLS/dr

The above three well plus 6 more wells
are being refiled for ~~an~~ administrative approval
an unworked location.