

NSL-1772
Rule 104 F II
Immediate

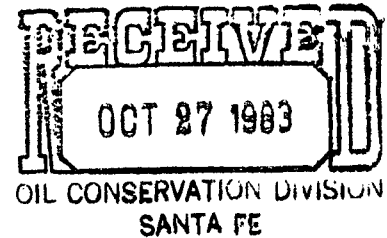

October 24, 1983

State of New Mexico
Energy and Minerals Department
Oil Conservation Division
P. O. Box 2088
Santa Fe, New Mexico 87501
Attn: Joe D. Ramey; Division Director



Dear Sir:

Anadarko Production Company requests administrative approval to drill two infield producers at unorthodox locations within the unit boundaries of the Langlie-Mattix Penrose Sand Unit, T22S-R37E, Lea County, New Mexico. The legal description of each of the proposed wells is as follows:

- 1) LMPSU #13C-12, 110' FNL & 2580' FWL, Sec 27, T22S-R37E
- 2) LMPSU #21-9, 1425' FNL & 1425' FWL, Sec 34, T22S-R37E.

Langlie-Mattix
Penrose Pool

Each of the two locations are further than 330 feet from a lease boundary but are closer than 330 feet from a quarter-quarter line and/or a section line.

Anadarko Production Company is currently active in developing the Langlie-Mattix Unit and believes that the drilling of two wells at the proposed locations will recover commercial quantities of secondary oil otherwise not recoverable at current operations. Two additional wells, one penrose producer and one flood observation well, are also being permitted at this time. Because of orthodox locations for each of the above mentioned wells, applications for permits to drill have not been included with this correspondence.

Enclosed is a copy of notification sent to offset operators as well as confirmation of receipt of such notice. Also included are certified C-102 forms for each well mentioned, and a plat of the Langlie-Mattix Penrose Sand Unit with proposed locations for each well indicated. Should any additional information be required to process this request, please contact me at (915) 682-1666.

Thank you for your time and consideration into this matter.

Sincerely,

Tommy W. Thompson
Production Engineer

TWT/dkn

enclosures

Form 3811, Dec. 1980

SENDER: Complete items 1, 2, 3, and 4.
Add your address in the "RETURN TO" space
on reverse.

(CONSULT POSTMASTER FOR FEES)

1. The following service is requested (check one).

- ☒ Show to whom and date delivered 60¢
☐ Show to whom, date, and address of delivery .. —¢

2. ☐ **RESTRICTED DELIVERY**

(The restricted delivery fee is charged in addition to
the return receipt fee.)

TOTAL \$ 60

3. **ARTICLE ADDRESSED TO:**

Getty Oil Company
Drawer DD
Leveland, Texas 79336

4. **TYPE OF SERVICE:**

- ☐ REGISTERED ☐ INSURED
☒ CERTIFIED ☐ COD
☐ EXPRESS MAIL

ARTICLE NUMBER

P 402614 884

(Always obtain signature of addressee or agent)

I have received the article described above.

SIGNATURE ☐ Addressee ☐ Authorized agent

DATE OF DELIVERY

6. **ADDRESSEE'S ADDRESS** (Only if requested)

7. **UNABLE TO DELIVER BECAUSE:**

EMPLOYEE'S
INITIALS

RETURN RECEIPT, REGISTERED, INSURED AND CERTIFIED MAIL

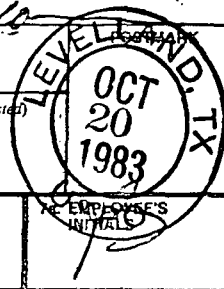

PS Form 3811, Dec. 1980

● **SENDER:** Complete items 1, 2, 3, and 4.
Add your address in the "RETURN TO" space
on reverse.

(CONSULT POSTMASTER FOR FEES)

1. The following service is requested (check one).

☒ Show to whom and date delivered 60¢

☐ Show to whom, date, and address of delivery.. —¢

2. ☐ **RESTRICTED DELIVERY**

(The restricted delivery fee is charged in addition to
the return receipt fee.)

TOTAL \$ 60

3. **ARTICLE ADDRESSED TO:**

Howell Petroleum Corp
1010 Lamar, Suite 1800
Houston, Texas 77002

4. **TYPE OF SERVICE:**

☐ REGISTERED ☐ INSURED

☒ **CERTIFIED** ☐ COD

☐ EXPRESS MAIL

ARTICLE NUMBER

P 402614 799

(Always obtain signature of addressee or agent)

I have received the article described above.

SIGNATURE ☐ Addressee ☒ Authorized agent

Abbie F. Taylor

5. **DATE OF DELIVERY**

10-21-83

6. **ADDRESSEE'S ADDRESS** (Only if requested)

7. **UNABLE TO DELIVER BECAUSE:**

7a. **EMPLOYEE'S
INITIALS**

RETURN RECEIPT, REGISTERED, INSURED AND CERTIFIED MAIL

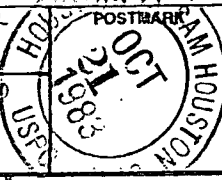

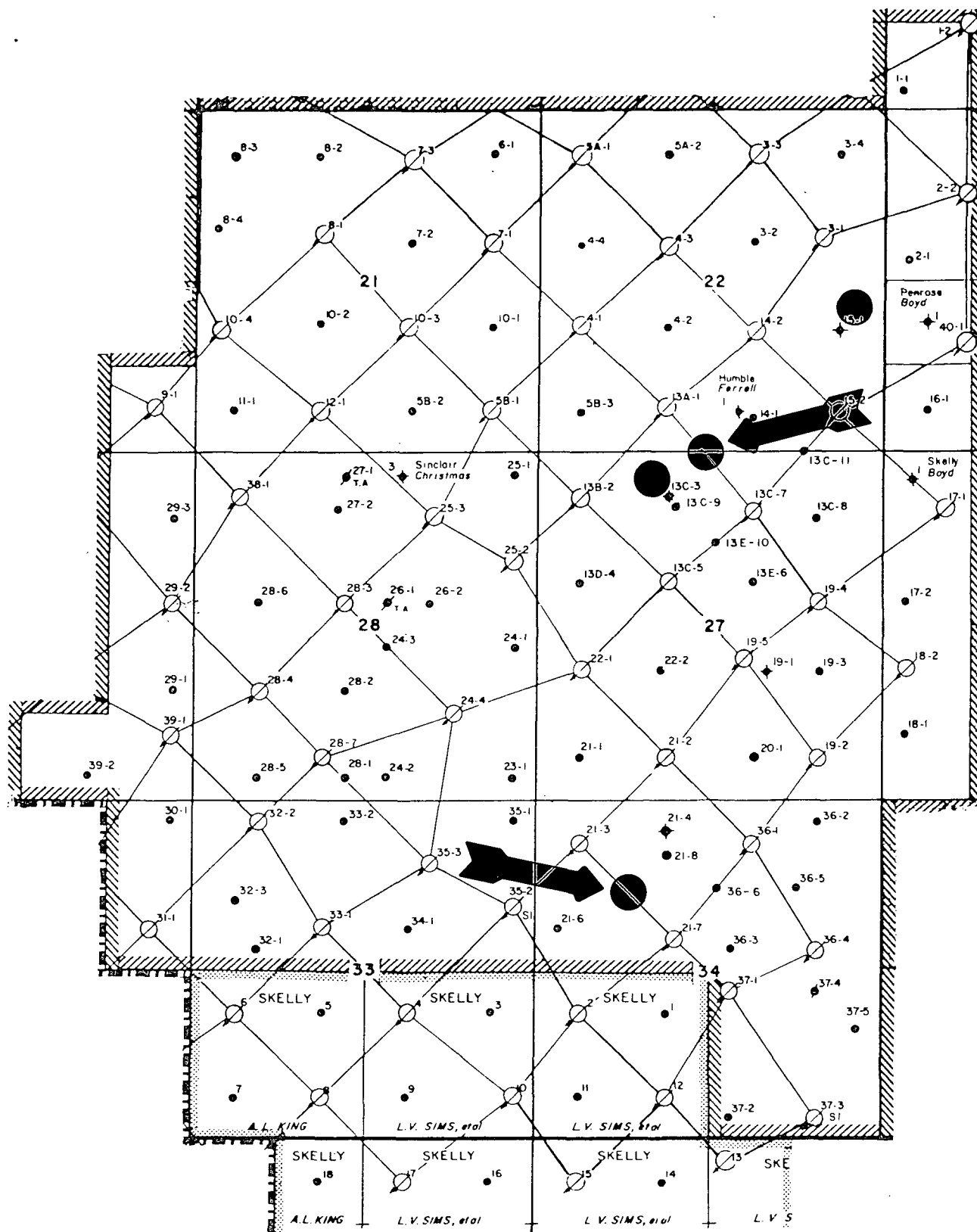

ANADARKO PRODUCTION COMPANY
MIDLAND DIVISION

LANGLIE MATTIX PENROSE
SAND UNIT
LEA COUNTY, NEW MEXICO

SCALE: 1" = 2500'

DATE: 8/83

**NEW MEXICO OIL CONSERVATION COMMISSION
WELL LOCATION AND ACREAGE DEDICATION PLAT**

Form C-102
Supersedes C-128
Effective 1-1-65

All distances must be from the outer boundaries of the Section

Operator ANADARKO PRODUCTION CO.			Lease LMPSU TRACT 13-C		Well No. 12
Unit Letter C	Section 27	Township 22 SOUTH	Range 37 EAST	County LEA	
Actual Footage Location of Well: 110 feet from the NORTH line and 2580 feet from the WEST line					
Ground Level Elev. 3340.4	Producing Formation	Pool		Dedicated Acreage: Acres	

1. Outline the acreage dedicated to the subject well by colored pencil or hachure marks on the plat below.
2. If more than one lease is dedicated to the well, outline each and identify the ownership thereof (both as to working interest and royalty).
3. If more than one lease of different ownership is dedicated to the well, have the interests of all owners been consolidated by communitization, unitization, force-pooling, etc?

☐ Yes ☐ No If answer is "yes," type of consolidation _____

If answer is "no," list the owners and tract descriptions which have actually been consolidated. (Use reverse side of this form if necessary.) _____

No allowable will be assigned to the well until all interests have been consolidated (by communitization, unitization, forced-pooling, or otherwise) or until a non-standard unit, eliminating such interests, has been approved by the Commission.

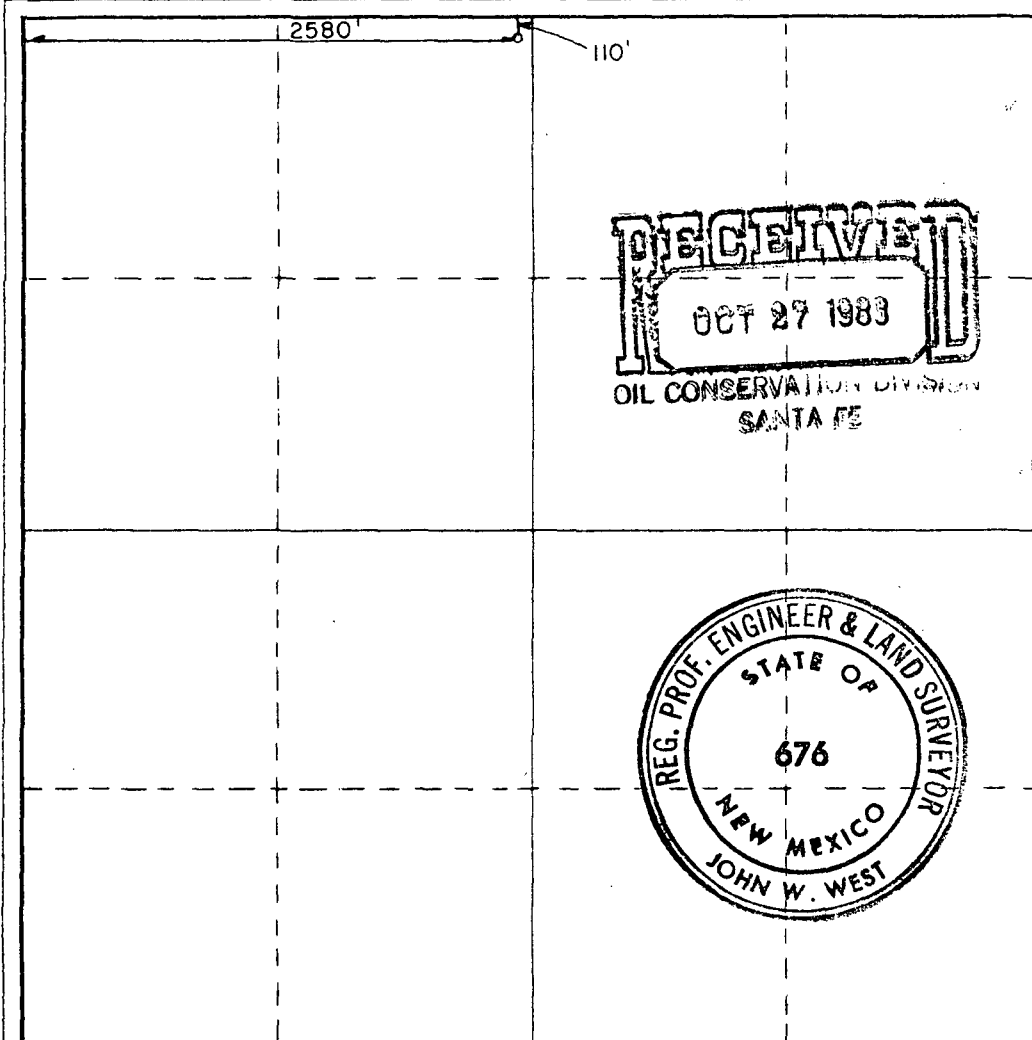

CERTIFICATION

I hereby certify that the information contained herein is true and complete to the best of my knowledge and belief.

Name _____

Position _____

Company _____

Date _____

I hereby certify that the well location shown on this plat was plotted from field notes of actual surveys made by me or under my supervision, and that the same is true and correct to the best of my knowledge and belief.

Date Surveyed

OCTOBER 13, 1983

Registered Professional Engineer and/or Land Surveyor

Certificate No. **JOHN W. WEST, 676**

RONALD J. EIDSON, 3239

0 330 660 990 1320 1650 1980 2310 2640 2000 1500 1000 500

**NEW MEXICO OIL CONSERVATION COMMISSION
WELL LOCATION AND ACREAGE DEDICATION PLAT**

Form C-102
Supersedes C-128
Effective 1-1-65

All distances must be from the outer boundaries of the Section.

Operator ANADARKO PRODUCTION CO.			Lease LMPSU TRACT 15		Well No. 3
Unit Letter I	Section 22	Township 22 SOUTH	Range 37 EAST	County LEA	
Actual Footage Location of Well: 2025 feet from the SOUTH line and 550 feet from the EAST line					
Ground Level Elev. 3337.5	Producing Formation		Pool	Dedicated Acreage: <div style="text-align: right;">Acres</div>	

1. Outline the acreage dedicated to the subject well by colored pencil or hachure marks on the plat below.
2. If more than one lease is dedicated to the well, outline each and identify the ownership thereof (both as to working interest and royalty).
3. If more than one lease of different ownership is dedicated to the well, have the interests of all owners been consolidated by communitization, unitization, force-pooling, etc?

☐ Yes ☐ No If answer is "yes," type of consolidation _____

If answer is "no," list the owners and tract descriptions which have actually been consolidated. (Use reverse side of this form if necessary.) _____

No allowable will be assigned to the well until all interests have been consolidated (by communitization, unitization, forced-pooling, or otherwise) or until a non-standard unit, eliminating such interests, has been approved by the Commission.

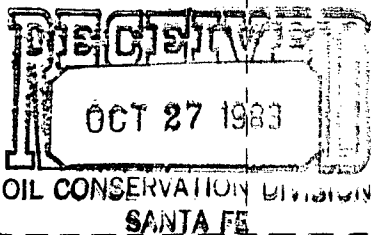
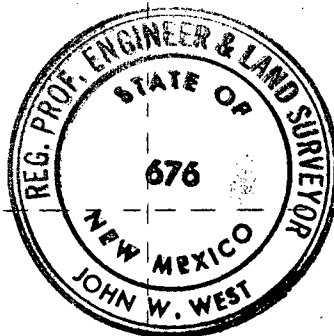

CERTIFICATION

I hereby certify that the information contained herein is true and complete to the best of my knowledge and belief.

Name _____

Position _____

Company _____

Date _____

I hereby certify that the well location shown on this plat was plotted from field notes of actual surveys made by me or under my supervision, and that the same is true and correct to the best of my knowledge and belief.

Date Surveyed

OCTOBER 13, 1983

Registered Professional Engineer
and/or Land Surveyor

Certificate No. **JOHN W. WEST, 676**
RONALD J. EIDSON, 3239



**NEW MEXICO OIL CONSERVATION COMMISSION
WELL LOCATION AND ACREAGE DEDICATION PLAT**

Form C-102
Supersedes C-128
Effective 1-1-65

All distances must be from the outer boundaries of the Section.

Operator ANADARKO PRODUCTION CO.			Lease LMPSU TRACT 21		Well No. 9
Unit Letter F	Section 34	Township 22 SOUTH	Range 37 EAST	County LEA	
Actual Footage Location of Well:					
1425 feet from the NORTH line and		1425 feet from the WEST line			
Ground Level Elev. 3330.7	Producing Formation		Pool	Dedicated Acreage: Acres	

1. Outline the acreage dedicated to the subject well by colored pencil or hachure marks on the plat below.
2. If more than one lease is dedicated to the well, outline each and identify the ownership thereof (both as to working interest and royalty).
3. If more than one lease of different ownership is dedicated to the well, have the interests of all owners been consolidated by communitization, unitization, force-pooling, etc?

☐ Yes ☐ No If answer is "yes," type of consolidation _____

If answer is "no," list the owners and tract descriptions which have actually been consolidated. (Use reverse side of this form if necessary.) _____

No allowable will be assigned to the well until all interests have been consolidated (by communitization, unitization, forced-pooling, or otherwise) or until a non-standard unit, eliminating such interests, has been approved by the Commission.

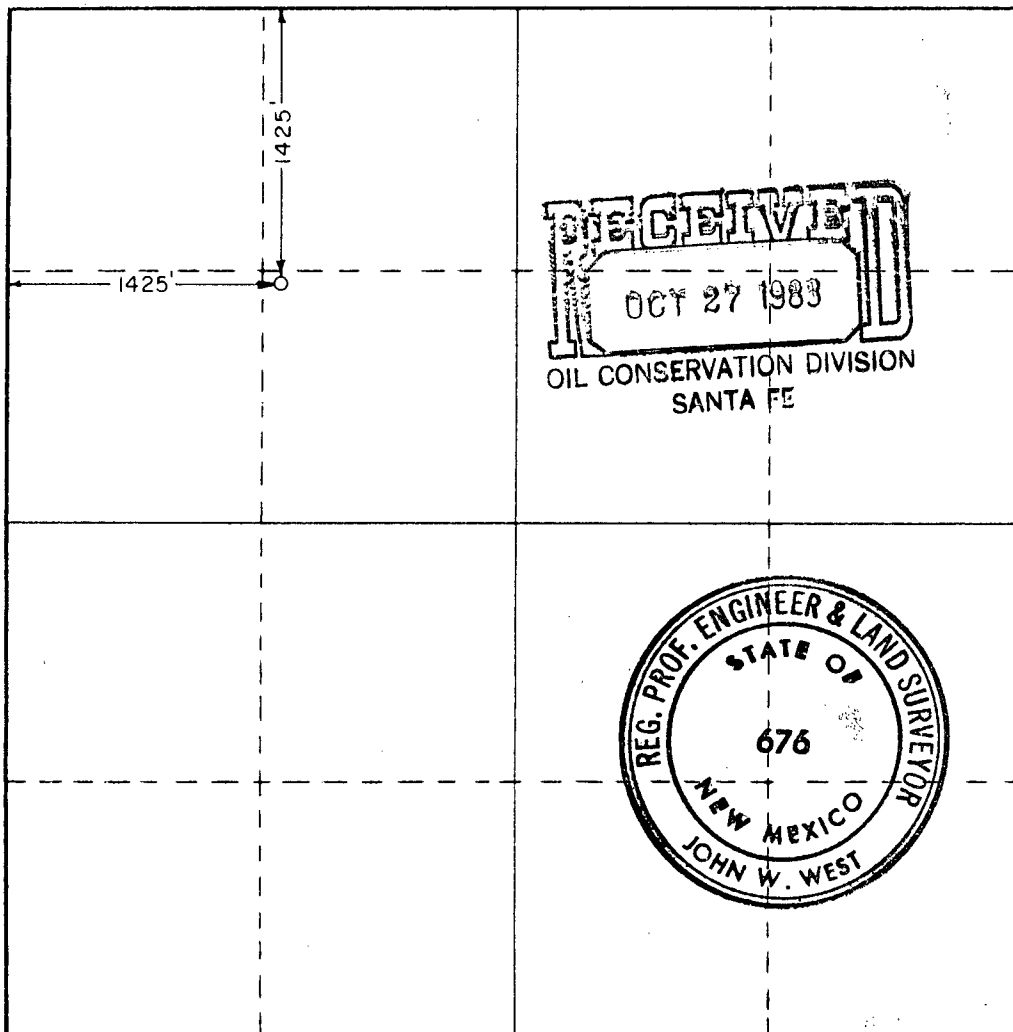

CERTIFICATION

I hereby certify that the information contained herein is true and complete to the best of my knowledge and belief.

Name _____

Position _____

Company _____

Date _____

I hereby certify that the well location shown on this plat was plotted from field notes of actual surveys made by me or under my supervision, and that the same is true and correct to the best of my knowledge and belief.

Date Surveyed

OCTOBER 13, 1983

Registered Professional Engineer
and/or Land Surveyor

John W. West

Certificate No. **JOHN W. WEST,** 676

RONALD J. EIDSON, 3239