

DATE IN 9/18/03	SUSPENSE 9/29/03	ENGINEER DRC	LOGGED IN LR	TYPE SWD	APP NO. PLR0325128810
-----------------	------------------	--------------	--------------	----------	-----------------------

ABOVE THIS LINE FOR DIVISION USE ONLY

**NEW MEXICO OIL CONSERVATION DIVISION**  
**- Engineering Bureau -**  
 1220 South St. Francis Drive, Santa Fe, NM 87505



892

**ADMINISTRATIVE APPLICATION CHECKLIST**

THIS CHECKLIST IS MANDATORY FOR ALL ADMINISTRATIVE APPLICATIONS FOR EXCEPTIONS TO DIVISION RULES AND REGULATIONS WHICH REQUIRE PROCESSING AT THE DIVISION LEVEL IN SANTA FE

**Application Acronyms:**

**[NSL-Non-Standard Location] [NSP-Non-Standard Proration Unit] [SD-Simultaneous Dedication]**  
**[DHC-Downhole Commingling] [CTB-Lease Commingling] [PLC-Pool/Lease Commingling]**  
**[PC-Pool Commingling] [OLS - Off-Lease Storage] [OLM-Off-Lease Measurement]**  
**[WFX-Waterflood Expansion] [PMX-Pressure Maintenance Expansion]**  
**[SWD-Salt Water Disposal] [IPI-Injection Pressure Increase]**  
**[EOR-Qualified Enhanced Oil Recovery Certification] [PPR-Positive Production Response]**

**[1] TYPE OF APPLICATION - Check Those Which Apply for [A]**

[A] Location - Spacing Unit - Simultaneous Dedication  
☐ NSL ☐ NSP ☐ SD

Check One Only for [B] or [C]

[B] Commingling - Storage - Measurement  
☐ DHC ☐ CTB ☐ PLC ☐ PC ☐ OLS ☐ OLM

[C] Injection - Disposal - Pressure Increase - Enhanced Oil Recovery  
☐ WFX ☐ PMX ☒ SWD ☐ IPI ☐ EOR ☐ PPR

[D] Other: Specify \_\_\_\_\_

**[2] NOTIFICATION REQUIRED TO: - Check Those Which Apply, or ☐ Does Not Apply**

[A] ☐ Working, Royalty or Overriding Royalty Interest Owners

[B] ☒ Offset Operators, Leaseholders or Surface Owner

[C] ☒ Application is One Which Requires Published Legal Notice

[D] ☐ Notification and/or Concurrent Approval by BLM or SLO  
U.S. Bureau of Land Management - Commissioner of Public Lands, State Land Office

[E] ☒ For all of the above, Proof of Notification or Publication is Attached, and/or,

[F] ☐ Waivers are Attached

**[3] SUBMIT ACCURATE AND COMPLETE INFORMATION REQUIRED TO PROCESS THE TYPE OF APPLICATION INDICATED ABOVE.**

**[4] CERTIFICATION:** I hereby certify that the information submitted with this application for administrative approval is **accurate and complete** to the best of my knowledge. I also understand that **no action** will be taken on this application until the required information and notifications are submitted to the Division.

**Note: Statement must be completed by an individual with managerial and/or supervisory capacity.**

MICHAEL S. PRICHARD  
 Print or Type Name

*Michael S. Prichard*  
 Signature

AGENT  
 Title

06/17/2003  
 Date

michaelsprichard@hotmail.com  
 e-mail Address

JRC  
Goodson SWD L.L.C.  
PO Box 513  
Hobbs, New Mexico 88241

August 15, 2003

David Catanach  
New Mexico Oil Conservation Division  
Engineering Bureau  
1220 South St. Francis Drive  
Santa Fe, New Mexico 87505

**RECEIVED**

SEP 04 2003

**OIL CONSERVATION  
DIVISION**

Dear Mr. Catanach,

Please find enclosed a copy of NMOCD form C108(Application for Authority Inject) for the Keach # 1 located in Unit "O" of Section 4, T20S, R38E, Lea County, New Mexico. The attached C108 is for disposal to the Nadine Paddock-Blinbry

Should you have any questions, please feel free to contact Michael Prichard at 505-361-9100.

Sincerely,



Michael Prichard  
Agent

Submit 3 Copies To Appropriate District  
Office

District I

1625 N. French Dr., Hobbs, NM 88240

District II

1301 W. Grand Ave., Artesia, NM 88210

District III

1000 Rio Brazos Rd., Aztec, NM 87410

District IV

1220 S. St. Francis Dr., Santa Fe, NM  
87505

State of New Mexico  
Energy, Minerals and Natural Resources

OIL CONSERVATION DIVISION  
1220 South St. Francis Dr.  
Santa Fe, NM 87505

Form C-103  
Revised June 10, 2003

<b>SUNDRY NOTICES AND REPORTS ON WELLS</b> (DO NOT USE THIS FORM FOR PROPOSALS TO DRILL OR TO DEEPEN OR PLUG BACK TO A DIFFERENT RESERVOIR. USE "APPLICATION FOR PERMIT" (FORM C-101) FOR SUCH PROPOSALS.)		WELL API NO. <b>30-025-34565</b>
1. Type of Well: Oil Well <input checked="" type="checkbox"/> Gas Well <input type="checkbox"/> Other <input type="checkbox"/>		5. Indicate Type of Lease STATE <input type="checkbox"/> FEE <input type="checkbox"/> X
2. Name of Operator <b>Goodson SWD L.L.C.</b>		6. State Oil & Gas Lease No.
3. Address of Operator <b>PO Box 513 Hobbs, New Mexico 88241</b>		7. Lease Name or Unit Agreement Name <b>Keach</b>
4. Well Location Unit Letter <b>O</b> : <b>467</b> feet from the <b>South</b> line and <b>2310</b> feet from the <b>East</b> line Section <b>4</b> Township <b>20S</b> Range <b>38E</b> NMPM <b>Lea</b> County		8. Well Number <b># 1</b>
11. Elevation (Show whether DR, RKB, RT, GR, etc.) <b>3576 GR</b>		9. OGRID Number <b>220044</b>
		10. Pool name or Wildcat <b>Nadine;Paddock-Blinebry</b>

12. Check Appropriate Box to Indicate Nature of Notice, Report or Other Data  
**NOTICE OF INTENTION TO:**

PERFORM REMEDIAL WORK ☐ PLUG AND ABANDON ☐  
TEMPORARILY ABANDON ☐ CHANGE PLANS ☐  
PULL OR ALTER CASING ☐ MULTIPLE COMPLETION ☐  
OTHER: **Convert San Andres producer to Paddock-Blinebry SWD** ☐ X

**SUBSEQUENT REPORT OF:**

REMEDIAL WORK ☐ ALTERING CASING ☐  
COMMENCE DRILLING OPNS. ☐ PLUG AND ABANDONMENT ☐  
CASING TEST AND CEMENT JOB ☐  
OTHER: ☐

13. Describe proposed or completed operations. (Clearly state all pertinent details, and give pertinent dates, including estimated date of starting any proposed work). SEE RULE 1103. For Multiple Completions: Attach wellbore diagram of proposed completion or recompletion.

**Move in service unit and pull production equipment**

**Run 4 3/4" bit and drill collars and drill out CIBP at 4280ft, Run bit and tag CIBP at 4500ft. Circulate clean and pull tools**

**Run 5 1/2" cement retainer and set at 4175ft.**

**Cement squeeze perfs 4224-4294ft with 75 sacks Class "C" cement. Displace cement to 4160ft**

**Sting out of retainer, pull tubing and setting tool. WOC**

**Run 4 3/4" bit and drill collars and drill out cement retainer and cement until fall out of cement**

**Pressure test squeeze to 350 psi for 30 minutes. If squeeze test Ok. Run bit and drill out CIBP at 4500ft.**

**Run bit to 6100ft. Pull out of hole with tubing, drill collars and bit**

**Run plastic coated packer and 2 7/8" plastic coated tubing. Load casing annulus with pkr fluid and set packer at 5825ft**

**Call NMOCD(505-393-6161 ext 112) to witness test. Test casing tubing annulus to 350 psig for 15 minutes**

**Turn well to disposal**

I hereby certify that the information above is true and complete to the best of my knowledge and belief.

SIGNATURE Michael S Prichard TITLE Agent DATE 08/18/2003

Type or print name Michael Prichard E-mail address: michaelsprichard@hotmail.com Telephone No. 505-799-6092

(This space for State use)

APPROVED BY \_\_\_\_\_ TITLE \_\_\_\_\_ DATE \_\_\_\_\_

Conditions of approval, if any:

**C-103 sent to NMOCD  
District 1 office in Hobbs,NM**

**C-108 Application for Authorization to Inject  
Goodson SWD L.L.C.  
Keach # 1  
467' FSL X 2310' FEL  
UL O, Section 4, T20S, R38E  
Lea County, New Mexico**

- 1. The purpose of this application is to convert the Keach # 1 Currently a San Andres oil well to a commercial Paddock-Blinebry salt water disposal well..**
- 2. Goodson SWD LLC. Ogrid # 220044  
PO Box 513  
Hobbs, New Mexico 88241  
Terry Wallace (505) 393-8352**
- 3 Well Data: See Attachment A**
- 4. This is not an expansion of existing project**
- 5. See attached map, Attachment B.**
- 6. There are "4" wells in the area of review that penetrate the proposed injection interval. There are 2 plugged and abandoned well that penetrate the interval in the area of review. There are 2 active producers that penetrate the interval in the area of review. See attached list and wellbore schematics. Attachment C**
- 7. Proposed average daily injection volumes approximately 1500 BWPD  
Maximum daily injection volume approximately 2000 BWPD**
- 8. This will be a open system.**
- 9. Proposed average injection pressure 1000 psig  
Proposed maximum injection pressure 1175 psig**
- 10. Sources of disposed water would be produced water from numerous producing intervals of SE New Mexico. See attached water analysis of several producing fields. Attachment D**
- 11. Disposal interval is Paddock-Blinebry 5884-6070 ft.**
- 12. Underground water sources of drinking water are the alluvial fill from surface to 350ft.  
A. There were no active water wells found in the 1 mile AOR.**

**13. The disposal interval may be acidized during conversion operations with 15% HCL acid**

Capataz Operating Inc.  
Keach #1  
API: 3002534565  
Prior to Conversion to SWD

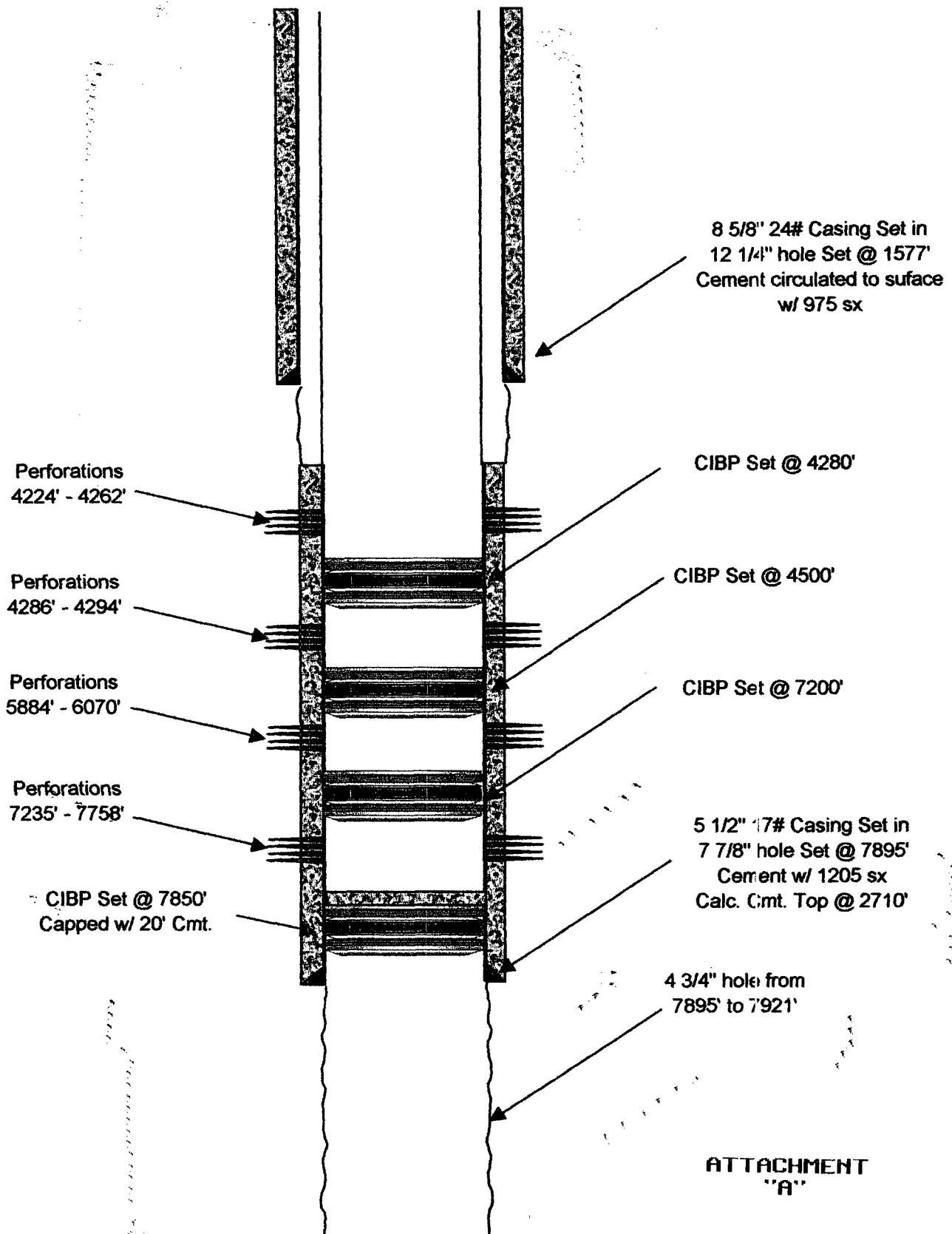

ATTACHMENT  
"B"

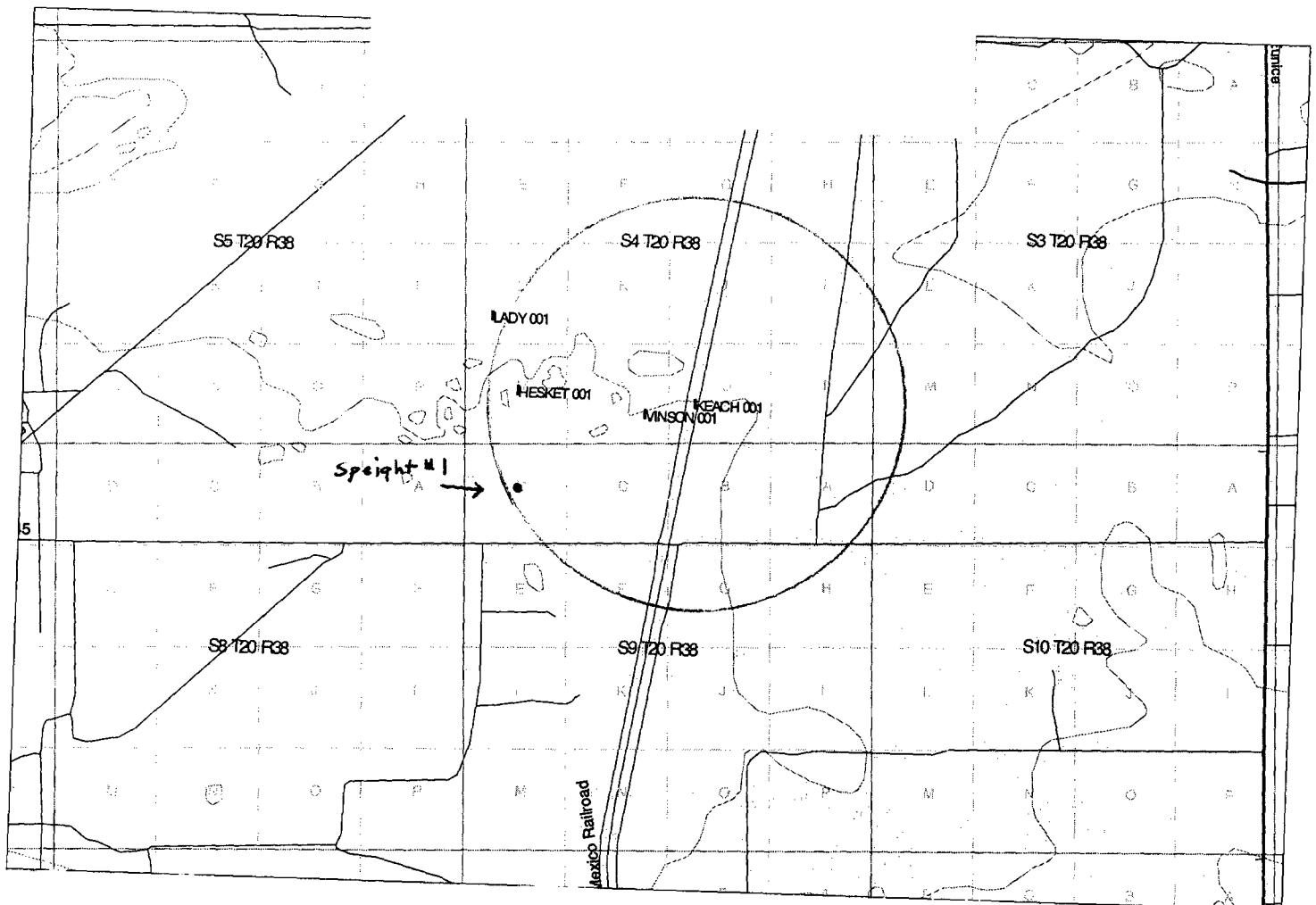

## Wells in AOR

**Well:**VINSON **No.:** 001

**Operator:** AMERADA HESS CORP

**API:** 3002533540 **Township:** 20.0S **Range:** 38E

**Section:** 4 **Unit:** N

**Land Type:** P **County:** Lea **Total Acreage:** Unknow

**Number of Completion with Acreage:** Unknown

Well is plugged and abandoned

**Well:** HESKET **No.:** 001

**Operator:** TAMARACK PETROLEUM CO INC

**API:** 3002527415 **Township:** 20.0S **Range:** 38E

**Section:** 4 **Unit:** M

**Land Type:** P **County:** Lea **Total Acreage:** 40

**Number of Completion with Acreage:** 1

Currently producing from the NADINE;PADDOCK-BLINEBRY, WEST

**Well:** KORNEGAY A **No.:** 001

**Operator:** TAMARACK PETROLEUM CO INC

**API:** 3002527703 **Township:** 20.0S **Range:** 38E

**Section:** 9 **Unit:** F

**Land Type:** P **County:** Lea **Total Acreage:** Unknow

**Number of Completion with Acreage:** Unknown

Well is plugged and abandoned

**Well:** SPEIGHT **No.:** 001

**Operator:** TAMARACK PETROLEUM CO INC

**API:** 3002527006 **Township:** 20.0S **Range:** 38E

**Section:** 9 **Unit:** D

**Land Type:** P **County:** Lea **Total Acreage:** 40

**Number of Completion with Acreage:** 1

Well is currently producing from the NADINE;PADDOCK-BLINEBRY, WEST



3002533540

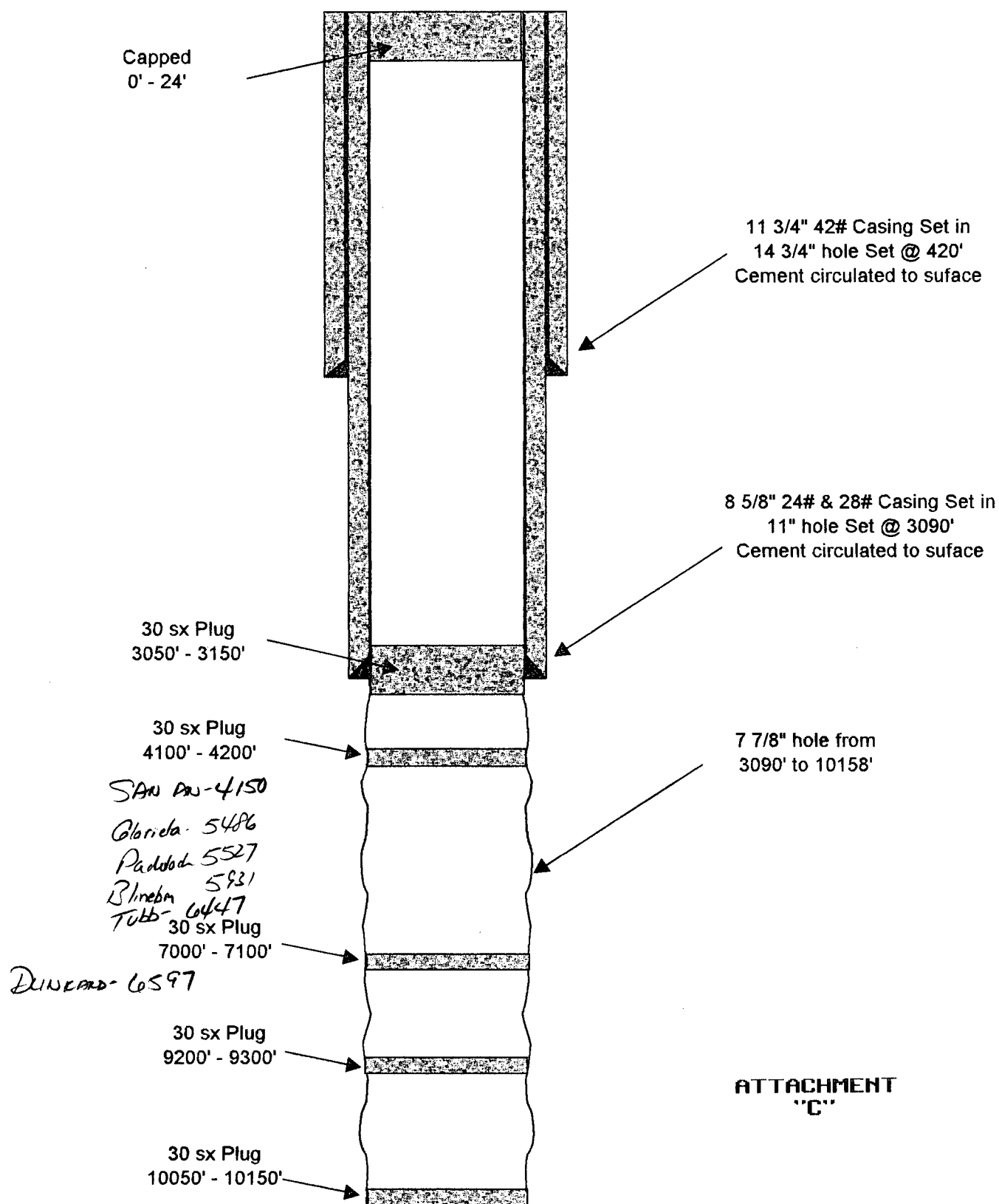

Tamarack Petroleum Co Inc.  
Hesket #1  
API: 3002527415

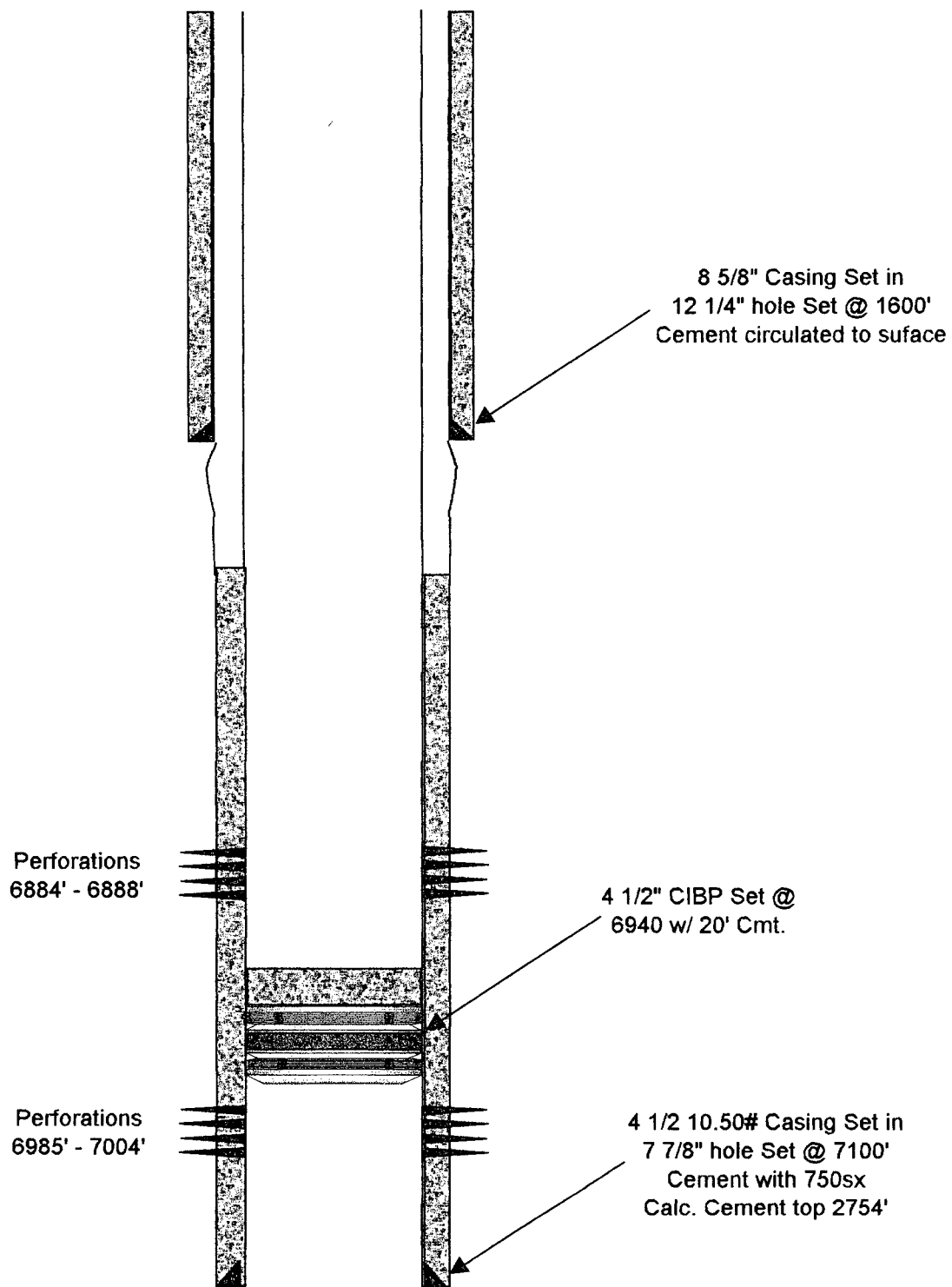

ATTACHMENT  
"C"

Tamarack Petroleum Co Inc.  
Kornegay A #1  
API: 3002527703

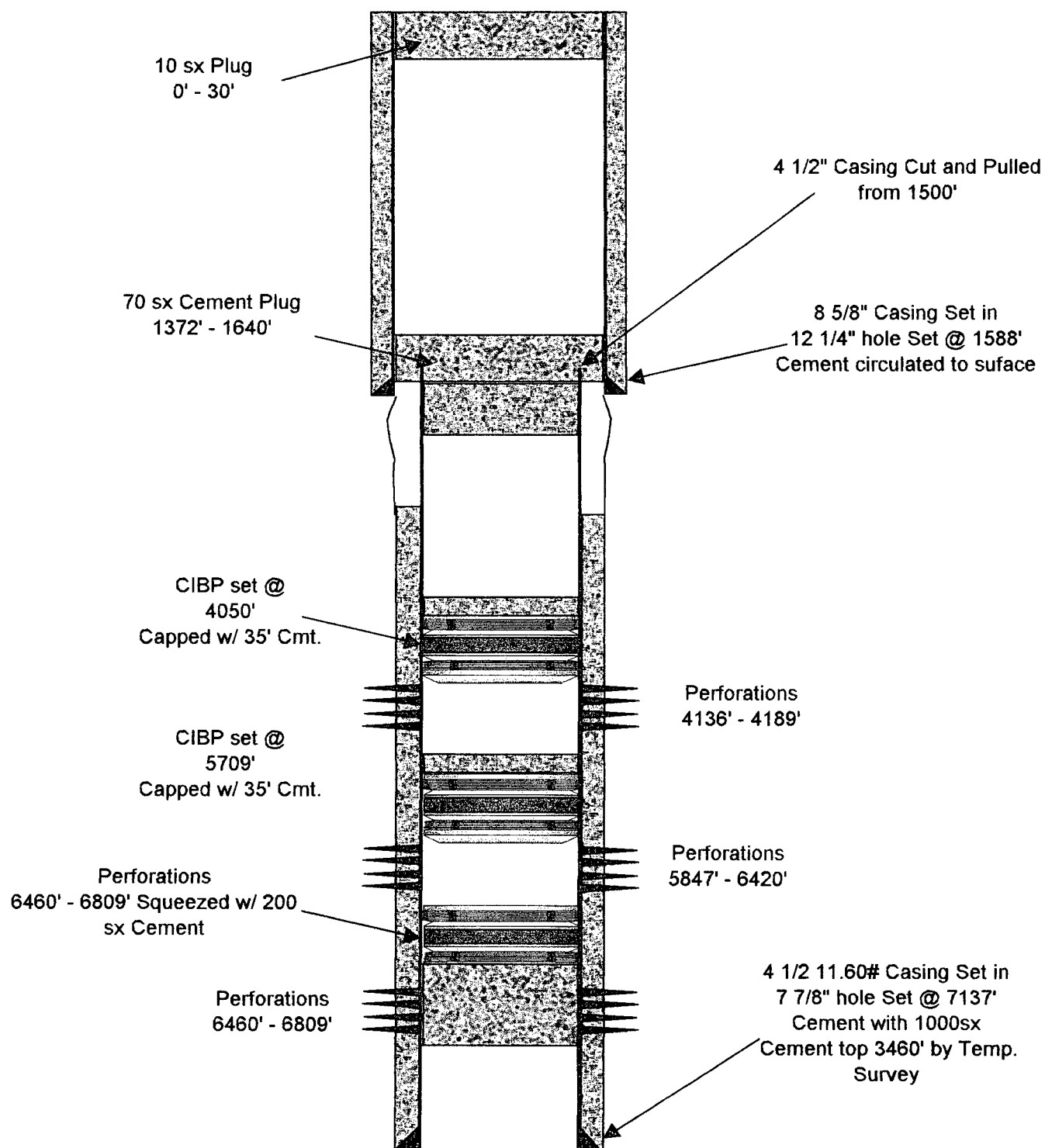

ATTACHMENT  
"C"

Tamarack Petroleum Co Inc.  
Speight #1  
API: 3002527006

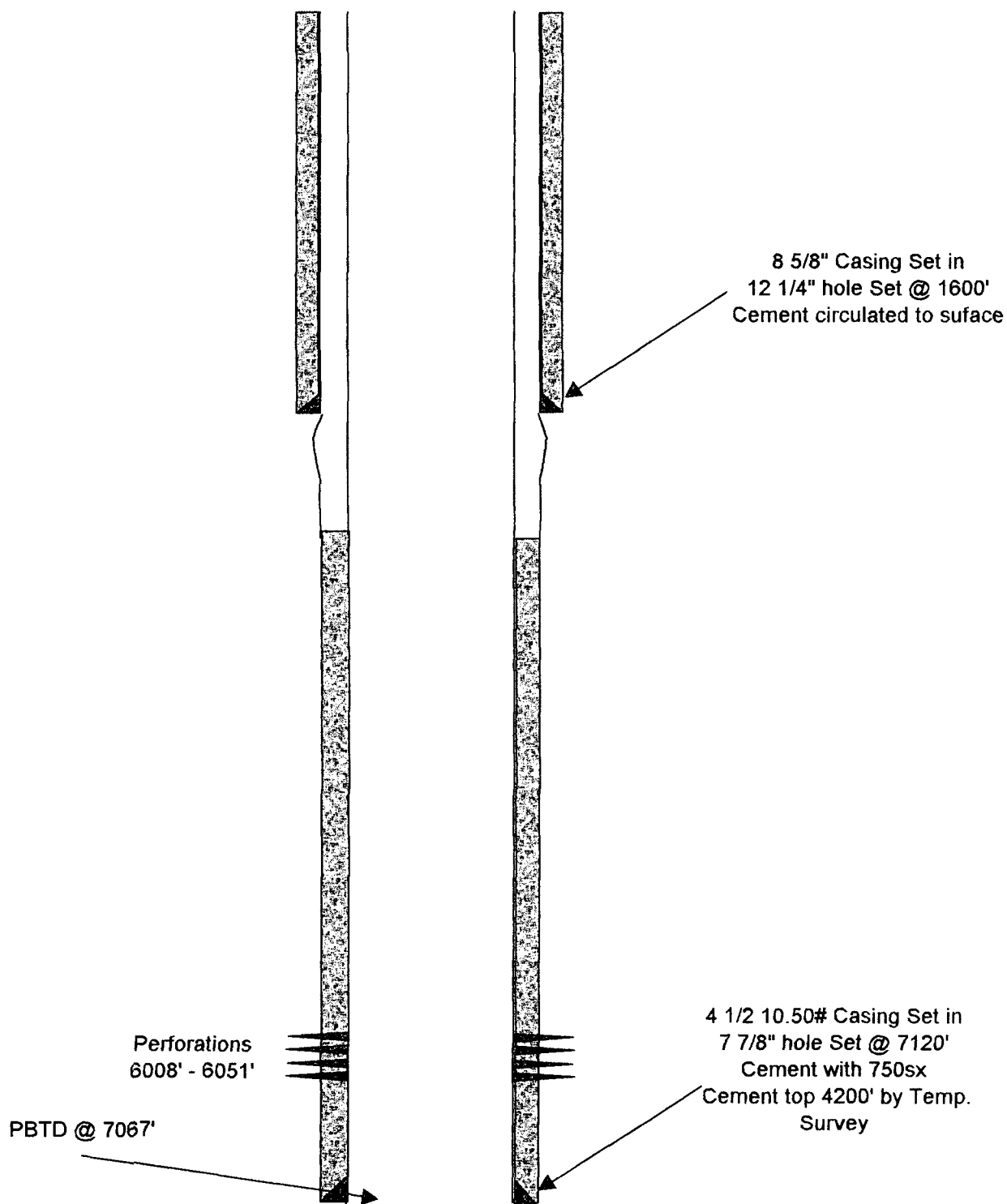

ATTACHMENT  
"C"

Capataz Operating Inc.  
Keach #1  
API: 3002534565  
After Conversion to SWD

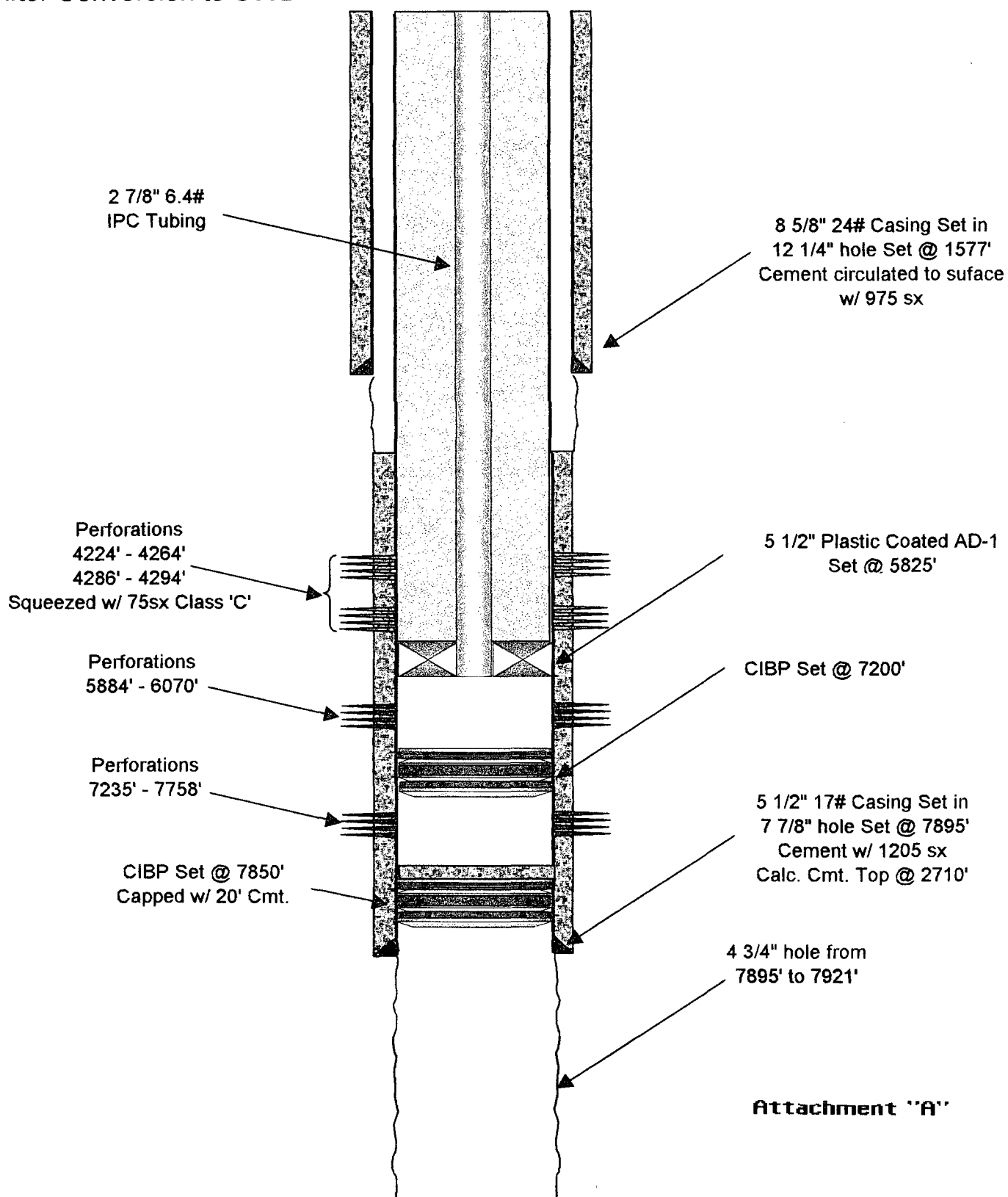

**Water Sample Analysis**

<b>Pool</b>	<b>Location</b>		<b>Range</b>	<b>Chlorides</b>
	<b>Section</b>	<b>Township</b>		
North Justis Montoya	2	25S	37E	45440
North Justis McKee	2	25S	37E	58220
North Justis Fusselman	2	25S	37E	68533
North Justis Ellenburger	2	25S	37E	34151
Fowler Blinebry	22	24S	37E	116085
Skaggs Grayburg	18	20S	38E	84845
Warren McKee	18	20S	38E	85910
Warren Abo	19	20S	39E	91600
DK Drinkard	30	20S	39E	106855
Littman San Andres	8	21S	38E	38695
East Hobbs grayburg	29	18S	39E	6461
Halfway Yates	16	20S	32E	14768
Arkansas Junction San Andres	12	18S	36E	7171
Pearl Queen	28	19S	35E	114310
Midway Abo	17	17S	37E	36494
Lovinton Abo	31	16S	37E	22933
Lovington San Andres	3	16S	37E	4899
Lovington Paddock	31	16S	37E	93720
Mesa Queen	17	16S	32E	172530
Kemnitz Wolfcamp	27	16S	34E	49345
Hume Queen	9	16S	34E	124960
Anderson Ranch Wolfcamp	2	16S	32E	11040
Anderson Ranch Devonian	11	16S	32E	25702
Anderson Ranch Unit	11	16S	32E	23786
Caudill Devonian	9	15S	36E	20874
Townsend Wolfcamp	6	16S	36E	38695
Dean Permo Penn	5	16S	37E	44730
Dean Devonian	35	15S	36E	19525
South Denton Wolfcamp	26	15S	37E	54315
South Denton Devonian	36	15S	37E	34080
Medicine Rock Devonian	15	15S	38E	39760
Little Lucky Lake Devonian	29	15S	30E	23288
Wantz Abo	26	21S	37E	132770
Crosby Devonian	18	25S	37E	58220
Scarborough Yates Seven Rivers	7	26S	37E	3443(Reef)
Teague Simpson	34	23S	37E	114665
Teague Ellenburger	34	23S	37E	120345
Rhodes Yates 7 Rivers	27	26S	37E	144485
House SA	11	20S	38E	93365
House Drinkard	12	20S	38E	49700
South Leonard Queen	24	26S	37E	115375
Elliot Abo	2	21S	38E	55380
Scharb Bone Springs	5	19S	35E	30601
EK Queen	13	18S	34E	41890
East EK Queen	22	18S	34E	179630
Maljamar Grayburg SA	22	17S	32E	46079
Maljamar Paddock	27	17S	32E	115375
Maljamar Devonian	22	17S	32E	25418

**1 mile AOR**

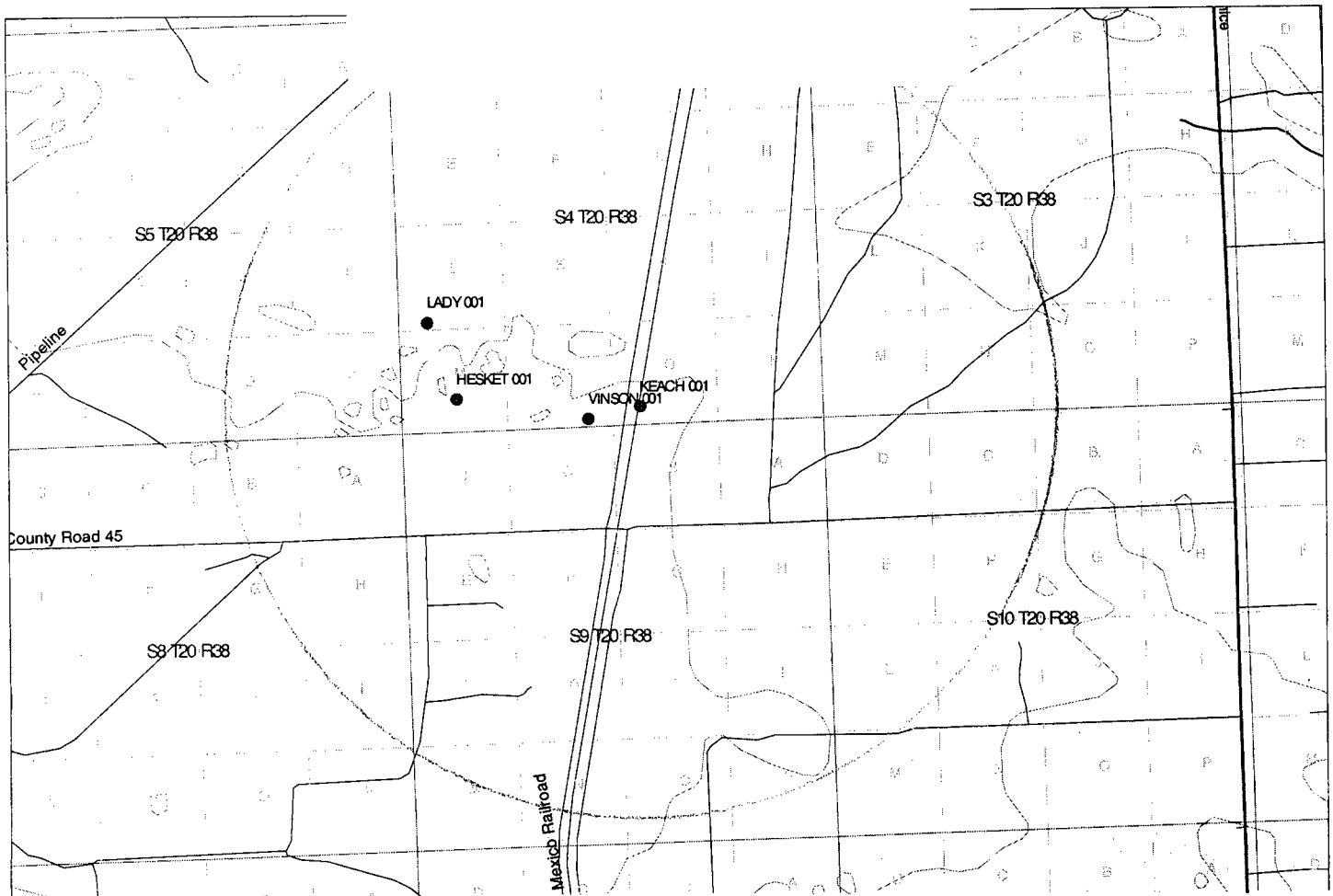

**Offset operator in the AOR**

**Tamarack Petroleum Company Inc.  
500 W. Texas # 1485  
Midland, Tx 79701**

**Surface Owner  
Section 4, T20S, R38E**

**Lee M. Roberts  
PO Box 356  
Hobbs, New Mexico 88240**



### **Legal Notice**

Goodson SWD L.L.C., PO Box 513, Hobbs, NM 88241, has filed form C-108 (Application for Authorization to Inject) with the New Mexico Oil Conservation Division seeking administrative approval for a commercial salt water disposal well. The proposed well is the Keach # 1 located 467' FSL & 2310' FEL of Section 4, Township 20 South, Range 38 East of Lea County, New Mexico, will be used for salt water disposal. Produced waters from numerous producing formations will be disposed into the Paddock-Blinbry at a depth of 5884' to 6070' with a maximum pressure of 1175 psi and a maximum rate of 2000 BWPD.

All interested parties opposing the aforementioned must file objections or requests for a hearing with the Oil Conservation Division, 1220 South Francis Drive, Santa Fe, New Mexico 87505-5472, within 15 days. Additional information can be obtained by contacting Michael Prichard at (505) 392-9100

Publish in the Hobbs Daily News Sun on August 19, 2003

U.S. Postal Service  
**CERTIFIED MAIL RECEIPT**  
 (Domestic Mail Only; No Insurance Coverage Provided)

Article Sent To:

*Tammy Anne Refinomidland TX 79701*

Postage \$ 1.06 UNIT ID: 0640

Certified Fee 2.30

Return Receipt Fee (Endorsement Required) 1.75

Restricted Delivery Fee (Endorsement Required) .00

Total Postage & Fees \$ 5.11

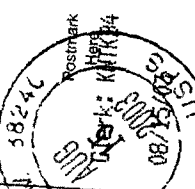

Name (Please Print Clearly) (To be completed by mailer)  
*Pueblo West*

Street, Apt. No.; or PO Box No.  
*1218 W Pueblo*

City, State, ZIP+4  
*Hobbs, NM 88240*

PS Form 3800, July 1999 See Reverse for Instructions

U.S. Postal Service  
**CERTIFIED MAIL RECEIPT**  
 (Domestic Mail Only; No Insurance Coverage Provided)

Article Sent To:

*Lee Roberts Box 356 Hobbs NM 88240*

Postage \$ 1.06 UNIT ID: 0640

Certified Fee 2.30

Return Receipt Fee (Endorsement Required) 1.75

Restricted Delivery Fee (Endorsement Required) .00

Total Postage & Fees \$ 5.11

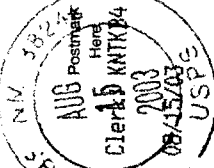

Name (Please Print Clearly) (To be completed by mailer)  
*Pueblo West LLC*

Street, Apt. No.; or PO Box No.  
*1218 W Pueblo*

City, State, ZIP+4  
*Hobbs, NM 88241*

PS Form 3800, July 1999 See Reverse for Instructions

AFFIDAVIT OF PUBLICATION

State of New Mexico,  
County of Lea.

I, KATHI BEARDEN

Publisher

of the Hobbs News-Sun, a  
newspaper published at  
Hobbs, New Mexico, do solemnly  
swear that the clipping attached  
hereto was published once a  
week in the regular and entire  
issue of said paper, and not a  
supplement thereof for a period.

of 1  
\_\_\_\_\_ weeks.

Beginning with the issue dated

August 19 2003

and ending with the issue dated

August 19 2003

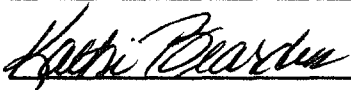

Publisher

Sworn and subscribed to before

me this 19th day of

August 2003

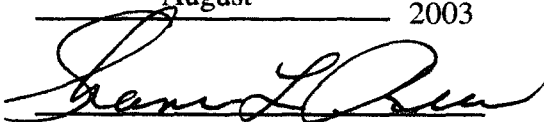

Notary Public.

My Commission expires

(Seal)

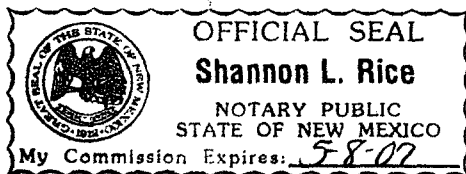

This newspaper is duly qualified  
to publish legal notices or adver-  
tisements within the meaning of  
Section 3, Chapter 167, Laws of  
1937, and payment of fees for  
said publication has been made.

LEGAL NOTICE  
August 19, 2003

Goodson SWD L.L.C., PO Box 513, Hobbs, NM 88241, has filed form C-106 (Application for Authorization to Inject) with the New Mexico Oil Conservation Division seeking administrative approval for a commercial salt water disposal well. The proposed well is the Keach #1 located 467' ESL & 2310' FEL of Section 4, Township 20 South, Range 38 East of Lea County, New Mexico, will be used for salt water disposal. Produced waters from numerous producing formations will be disposed into the Paddock Blinbry at a depth of 5884' to 6070' with a maximum pressure of 1175 psi and a maximum rate of 2000 BWPD.

All interested parties opposing the aforementioned must file objections or request for a hearing with the Oil Conservation Division, 1220 South Francis Drive, Santa Fe, New Mexico 87505-5472, within 15 days. Additional information can be obtained by contacting Michael Prichard at (505) 392-9100 #20049

67100757000

67515995

Pueblo West LLC  
1218 W. Pueblo  
Hobbs, NM 88240

**C-108 Application for Authorization to Inject  
Goodson SWD L.L.C.  
Keach # 1  
UL O, Section 4, T20S,R38E  
Lea County, New Mexico**

**Available engineering and geologic data have been examined and no evidence of open faults of hydrologic connection between the disposal zone and any underground sources of drinking water have been found.**

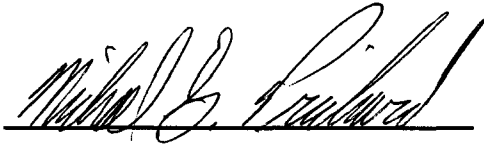
A handwritten signature in black ink, appearing to read "Michael Prichard", written over a horizontal line.

**Michael Prichard  
Agent  
Goodson SWD L.L.C.**

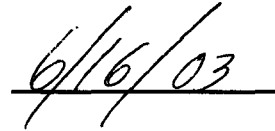
A handwritten date "6/16/03" in black ink, written over a horizontal line.

**Date**