

Release February 20, 1988

By DC

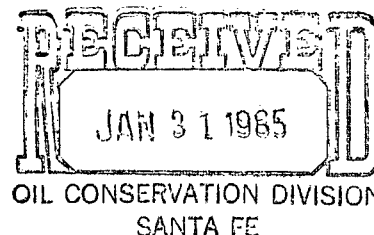

McClellan Oil Corporation



January 28, 1985

NCL-1989
RULE-104FI

Mr. Dick Stamets, Director
New Mexico Oil Conservation Division
P.O. Box 2088
Santa Fe, NM 87501

Re: Non-Standard Location
MOC White Fed. No. 1
Sec. 9-T4S-R27E
Chaves County, N.M.

Dear Mr. Stamets:

McClellan Oil Corporation would appreciate an administrative approval for a non-standard Mississippian gas well location as provided for under NMOCD Rule 104F.

The MOC White Fed. No. 1 is a re-entry of the Leonard Oil Company White Fed. No. 1 drilled in 1958. We are requesting administrative approval for this location based on the fact that this well is a re-entry of a dry hole.

The enclosed lease map shows the offset operators who have been notified by certified mail of our request.

We will appreciate your expeditious approval and issuance of the administrative order.

Sincerely yours,

Mark McClellan

Mark McClellan
Geologist

cc: ✓ Harper Oil
✓ Inexco
✓ Read & Stevens
✓ CCW Interests
✓ A. W. Rutter, Jr.
✓ Cities Service

Location 320 Acre dedication
660 FSL
660 FWL
S/2 of Section 9

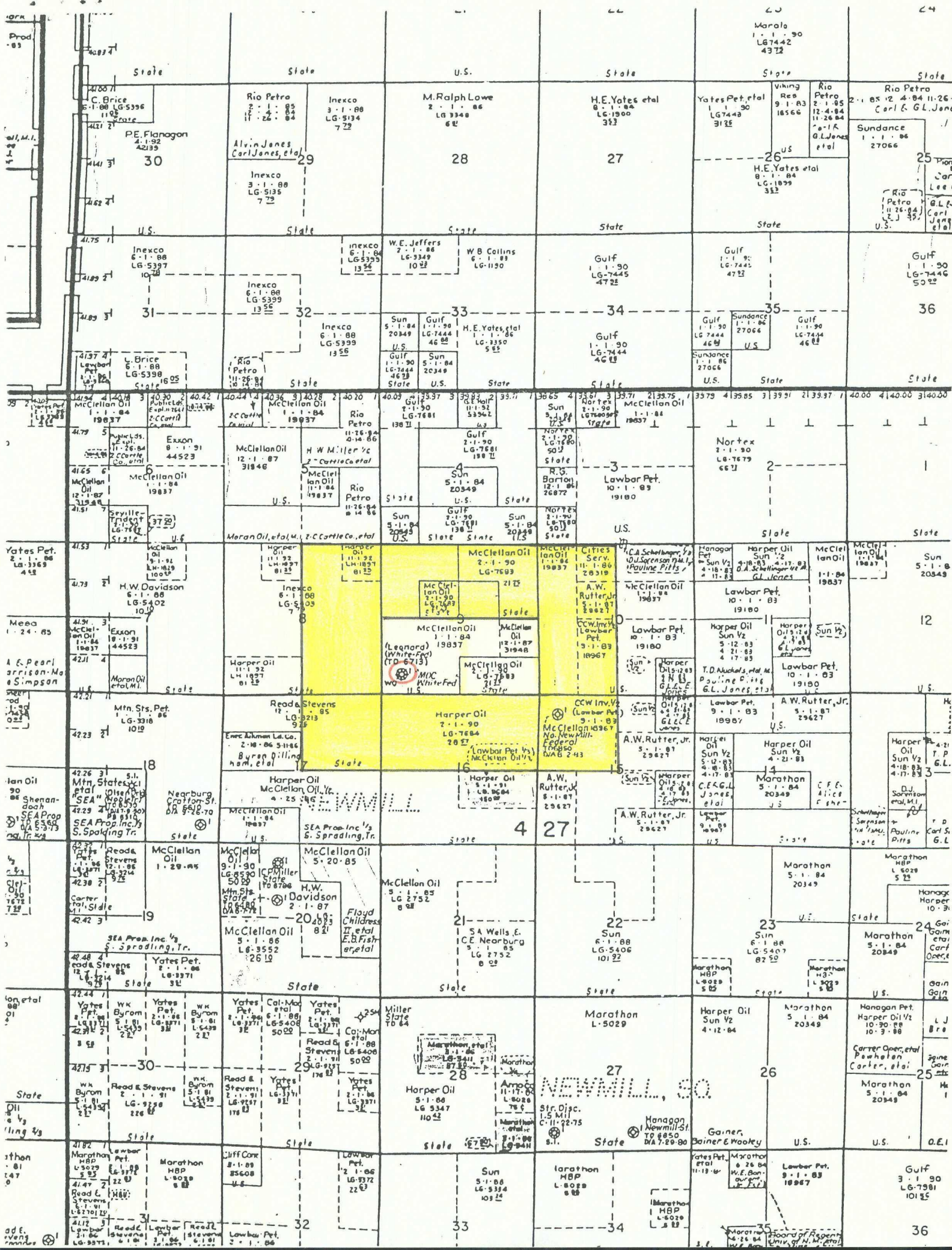

INEXCO
OIL COMPANY

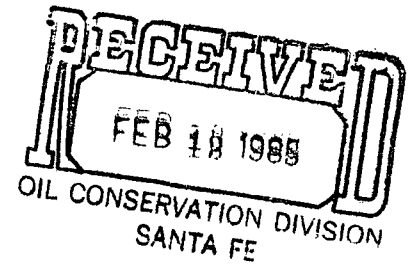

February 5, 1985

Mr. Dick Stamets, Director
New Mexico Oil Conservation Division
P.O. Box 2088
Santa Fe, New Mexico 87501

Re: Non-Standard Location
MOC White Fed. No. 1
Sec. 9-T4S, R27E
Chaves County, New Mexico
S.E. New Mexico Treads NM143

Dear Mr. Stamets:

Inexco Oil Company supported the re-entry by McClellan Oil Corporation of the White Federal No. 1 Well in Section 9-T4S, R27E, Chaves County, New Mexico with an Optional Farmout Agreement and has no objection to the issuance by the Commission of an Administrative order granting approval to the non standard Mississippian gas well location at your earliest convenience.

Very truly yours,

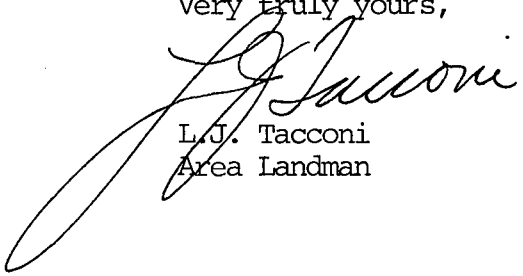

L.J. Tacconi
Area Landman

LJT/hd

cc: McClellan Oil Corp.
Roswell, New Mexico