

Pogo Producing Company

Western Division

600 United Bank Building • Post Office Box 10340 • Midland, Texas 79702-7340 • 915/682-6822

Received 3/24/86
Release 3/26/86

72.5

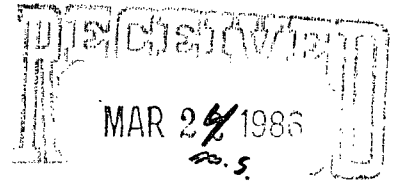

TO: FE

March 13, 1986

Oil Conservation Division
Attn: Mr. Mike Stogner
P.O. Box 2088
Santa Fe, New Mexico 87501

NSL-2241

Rule 104F(1)

RE: Rule 104F, ^{Well} State V-492 No. 1
760' FNL & 810' FFL
Section 27, T-24-S, R-28-E
Eddy County, New Mexico

*Undesignated Malaga Morrow Gas
Pool*

Gentlemen:

stan. 320-acre 1/2 of 27

The captioned well is submitted for your approval to drill under Rule 104F for all zones from the surface to include the Morrow formation at 13,100 feet.

A standard location would be situated in Willow Lake. The proposed site is located as close to the east edge of Willow Lake as feasible to allow drilling and completion operations to prevent damage to the lake environment. Form C-102 depicts the topographical conditions.

Exhibit A is a list of offset lease owners and the operator of one offset well. Waivers were sent to each party listed by certified mail and their executed waivers are attached.

Exhibit B is a lease plat showing the proposed well and offset ownership by section.

Your prompt attention to this application will be appreciated.

Yours very truly,

B. O. Williams

B. O. Williams
Division Operations Manager

BJW/sj

Enclosure

4/1/86
M.S.

STATE OF NEW MEXICO
ENERGY AND MINERALS DEPARTMENT

OIL CONSERVATION DIVISION

P. O. BOX 2088

SANTA FE, NEW MEXICO 87501

Form C-101
Revised 10-1-78

NO. OF COPIES RECEIVED	
DISTRIBUTION	
SANTA FE	
FILE	
U.S.G.S.	
LAND OFFICE	
OPERATOR	

5A. Indicate Type of Lease
STATE ☒ FEE ☐

5. State Oil & Gas Lease No.
V-492

APPLICATION FOR PERMIT TO DRILL, DEEPEN, OR PLUG BACK

1a. Type of Work
b. Type of Well
OIL WELL ☐ GAS WELL ☒ OTHER ☐
DRILL ☒ DEEPEN ☐ PLUG BACK ☐
SINGLE ZONE ☐ MULTIPLE ZONE ☐

7. Unit Agreement Name

8. Farm or Lease Name

State V-492

9. Well No.
1

10. Field and Pool, or Wildcat
Malaga Morrow

2. Name of Operator
Pogo Producing Company

3. Address of Operator
P.O. Box 10340 Midland, Texas 79702

4. Location of Well
UNIT LETTER A LOCATED 760 FEET FROM THE North LINE
AND 810 FEET FROM THE East LINE OF SEC. 27 TWP. 24-S RGE. 28-E NMPM

12. County
Eddy

19. Proposed Depth
13,100'

19A. Formation
Morrow

20. Rotary or C.T.
Rotary

21. Elevations (Show whether DF, KT, etc.)
2961.6' GR

21A. Kind & Status Plug. Bond
Blanket on file

21B. Drilling Contractor
Unknown

22. Approx. Date Work will start
April 1, 1986

23. PROPOSED CASING AND CEMENT PROGRAM

SIZE OF HOLE	SIZE OF CASING	WEIGHT PER FOOT	SETTING DEPTH	SACKS OF CEMENT	EST. TOP
26	20	94	620	1600	Circulate
17 1/2	13 3/8	54.50 & 61	2560	2600	Circulate
12 1/4	9 5/8	40 & 43.50	9800	2000	7000'
8 1/2	7	29 & 32	12,015	600	9400'
6	5	15	13,100	300	11,800'

Proposal is to drill to the Barnett and test the Morrow. Cement will be circulated to the surface on the 20" and 13 3/8" casing strings.

Possible zones for DST are the Delaware, Bone Springs, Wolfcamp, Strawn, Atoka and Morrow. Adequate logs will be run to evaluate all zones from the Delaware to total depth.

Mud Program: Spud mud to 620'. Brine to 2560'. Cut brine to 9800'. Brine and KCL Polymer to total depth.

BOP Program: 600' to 9800', 3000# WP. 9800' to total depth, 10,000# WP.

Gas on the lease is not dedicated

IN ABOVE SPACE DESCRIBE PROPOSED PROGRAM; IF PROPOSAL IS TO DEEPEN OR PLUG BACK, GIVE DATA ON PRESENT PRODUCTIVE ZONE AND PROPOSED NEW PRODUCTIVE ZONE. GIVE BLOWOUT PREVENTER PROGRAM, IF ANY.

I hereby certify that the information above is true and complete to the best of my knowledge and belief.

Signed [Signature] Title Division Operations Manager Date 3/7/86

(This space for State Use)

APPROVED BY _____ TITLE _____ DATE _____

CONDITIONS OF APPROVAL, IF ANY:

NEW MEXICO OIL CONSERVATION COMMISSION
WELL LOCATION AND ACREAGE DEDICATION PLAT

RECEIVED

Form 7-1
Supersedes 6-12-78
Effective 1-1-84

All distances must be from the outer boundaries of the Section

MAR 6 1986

Operator POGO PRODUCING COMPANY		Lease STATE V-492		Midland	
Unit Letter A	Section 27	Township 24 SOUTH	Range 28 EAST	County EDDY	
Actual Footage Location of Well: 760 feet from the NORTH line and 810 feet from the EAST line					
Ground Level Elev. 2961.6'	Producing Formation Morrow	Pool Malaga Morrow	Dedicated Acreage 320		

1. Outline the acreage dedicated to the subject well by colored pencil or hatchure marks on the plat below
2. If more than one lease is dedicated to the well, outline each and identify the ownership thereof (both as to working interest and royalty).
3. If more than one lease of different ownership is dedicated to the well, have the interests of all owners been consolidated by communitization, unitization, force-pooling, etc?

☐ Yes ☒ No If answer is "yes," type of consolidation _____

If answer is "no," list the owners and tract descriptions which have actually been consolidated. (Use reverse side of this form if necessary.) Communitization Agreement is being prepared

No allowable will be assigned to the well until all interests have been consolidated (by communitization, unitization, forced-pooling, or otherwise) or until a non-standard unit, eliminating such interests, has been approved by the Commission.

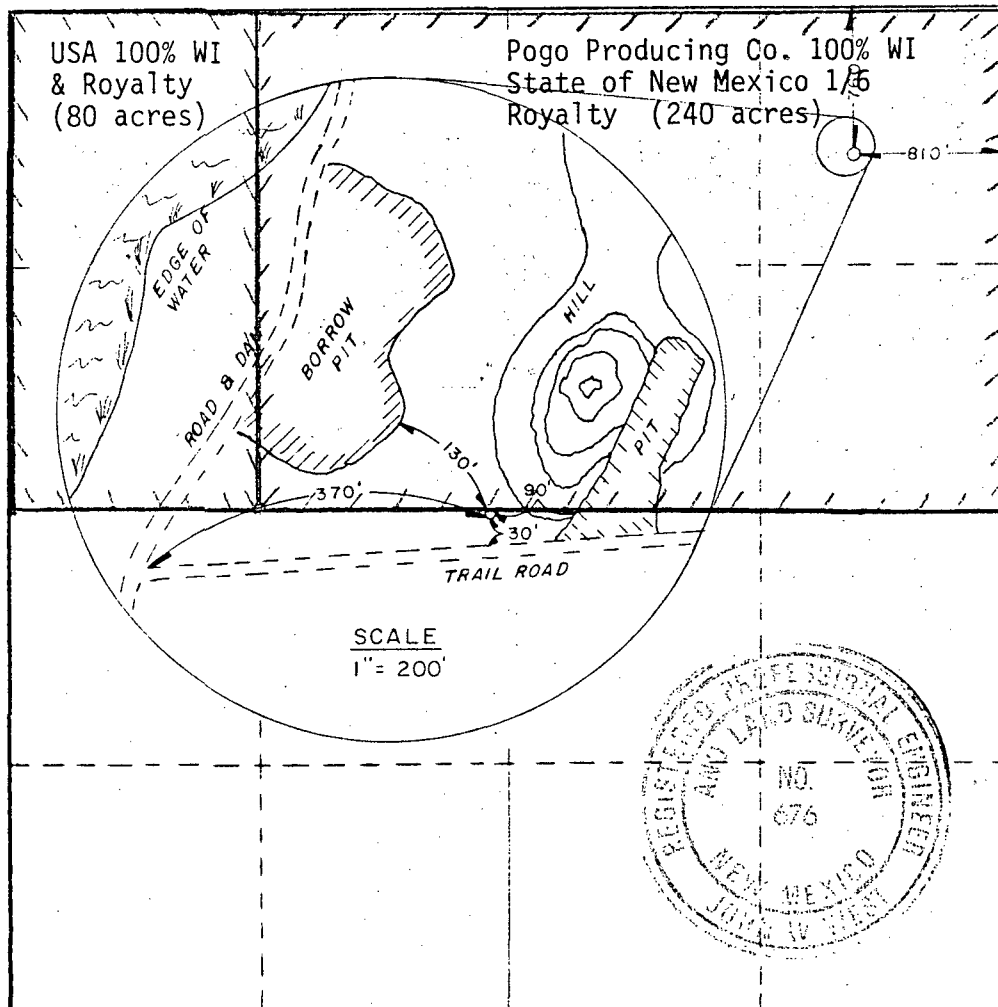

CERTIFICATION

I hereby certify that the information contained herein is true and complete to the best of my knowledge and belief.

B. J. Williams
B. J. Williams

Position
Division Operations Manager

Company
Pogo Producing Company

Date
March 6, 1986

I hereby certify that the well location shown on this plat was plotted from field notes of actual surveys made by me or under my supervision, and that the same is true and correct to the best of my knowledge and belief.

Date Surveyed
FEBRUARY 28, 1986

Registered Professional Engineer and or Land Surveyor

John W. West
Certificate No. JOHN W. WEST, 676
RONALD J. EIDSON, 3239

TYPICAL BOP SKETCH
Pogo Producing Company
State V-492 No. 1
760' FNL & 810' FEL
Sec. 27, T-24-S, R-28-E
Eddy County, New Mexico

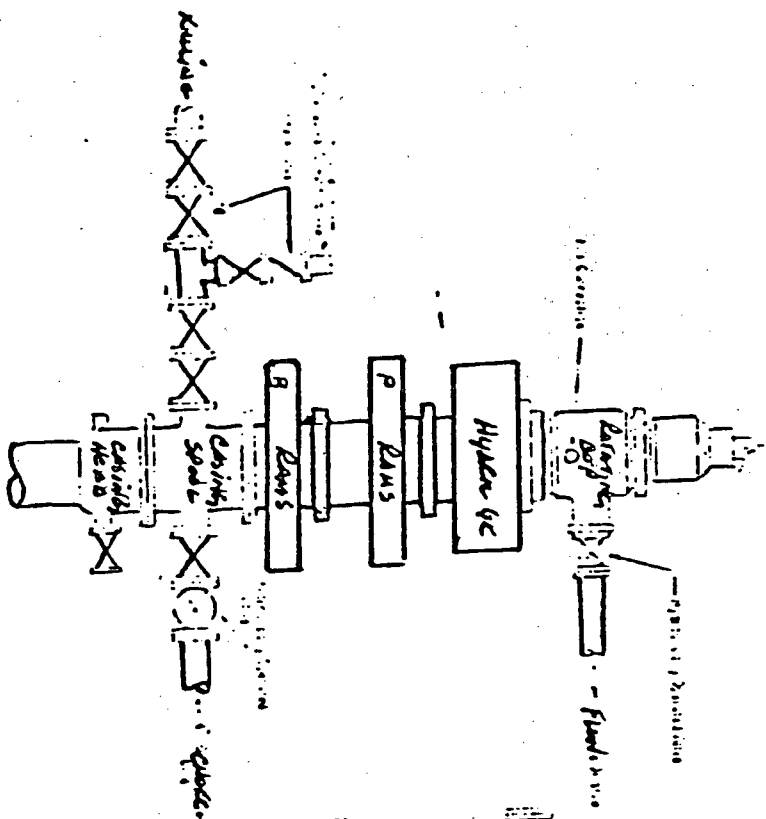

5000 PSI WORKING PRESSURE
DYNADUT PREVENTER HOOK UP

5000# STACK

13 5/8" 10,000# HYDRIL BOP
PIPE & BLIND RAMS (2)

13 5/8" 5,000# HYDRIL ANNULAR

10,000# STACK

13 5/8" 10,000# HYDRIL BOP

3 RAMS
3½ PIPE RAMS
4½ PIPE RAMS
BLIND RAMS

13 5/8" 10,000# HYDRIL ANNULAR

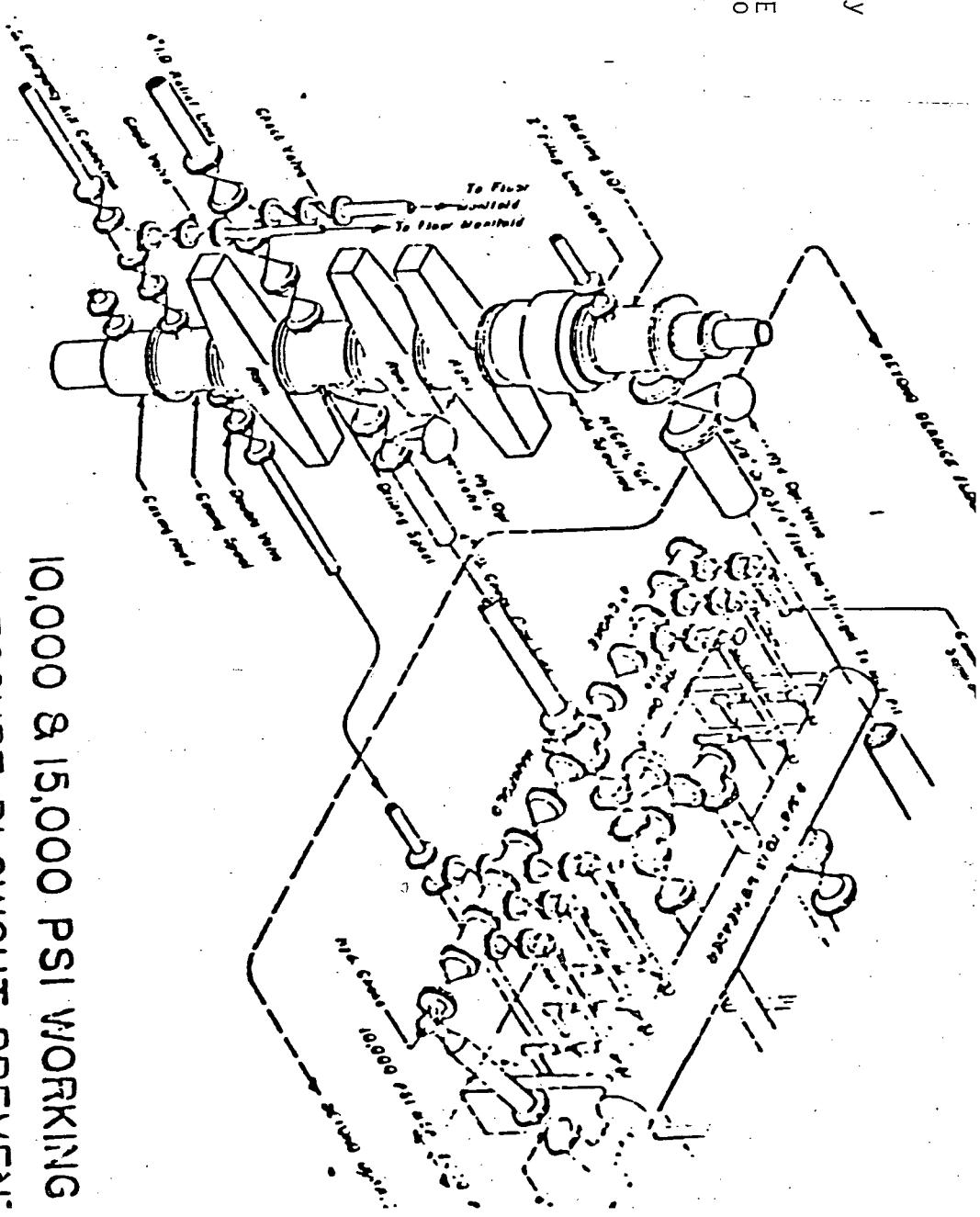

10,000 & 15,000 PSI WORKING
PRESSURE BLOWOUT PREVENT
& CHOKE MANIFOLD HOOK-UP

POGO PRODUCING COMPANY
EXHIBIT A
Offset Operator and Lessees
N/2 Section 27, T-24-S, R-28-E
Eddy County, New Mexico

S/2 Section 21 &
Section 28 :

Lessees: ✓ Amoco Production Company
P.O. Box 3090
Houston, Texas 77253

✓ HNG Oil Company
P.O. Box 2267
Midland, Texas 79702

✓ M. Brad Bennett
P.O. Box 2062
Midland, Texas 79702

S/2 Section 22:

Operator of Aminoil Federal No. 1
✓ Dinero Operating Company
P.O. Drawer 10505
Midland, Texas 79702

SW/4 SW/4 Section 23:

Lessee: Pogo Producing Company
P.O. Box 10340
Midland, Texas 79702

W/2 Section 26:

Lessees: Pogo Producing Company
P.O. Box 10340
Midland, Texas 79702

✓ HNG Oil Company
P.O. Box 2267
Midland, Texas 79702

S/2 Section 27:

Lessee: Pogo Producing Company
P.O. Box 10340
Midland, Texas 79702

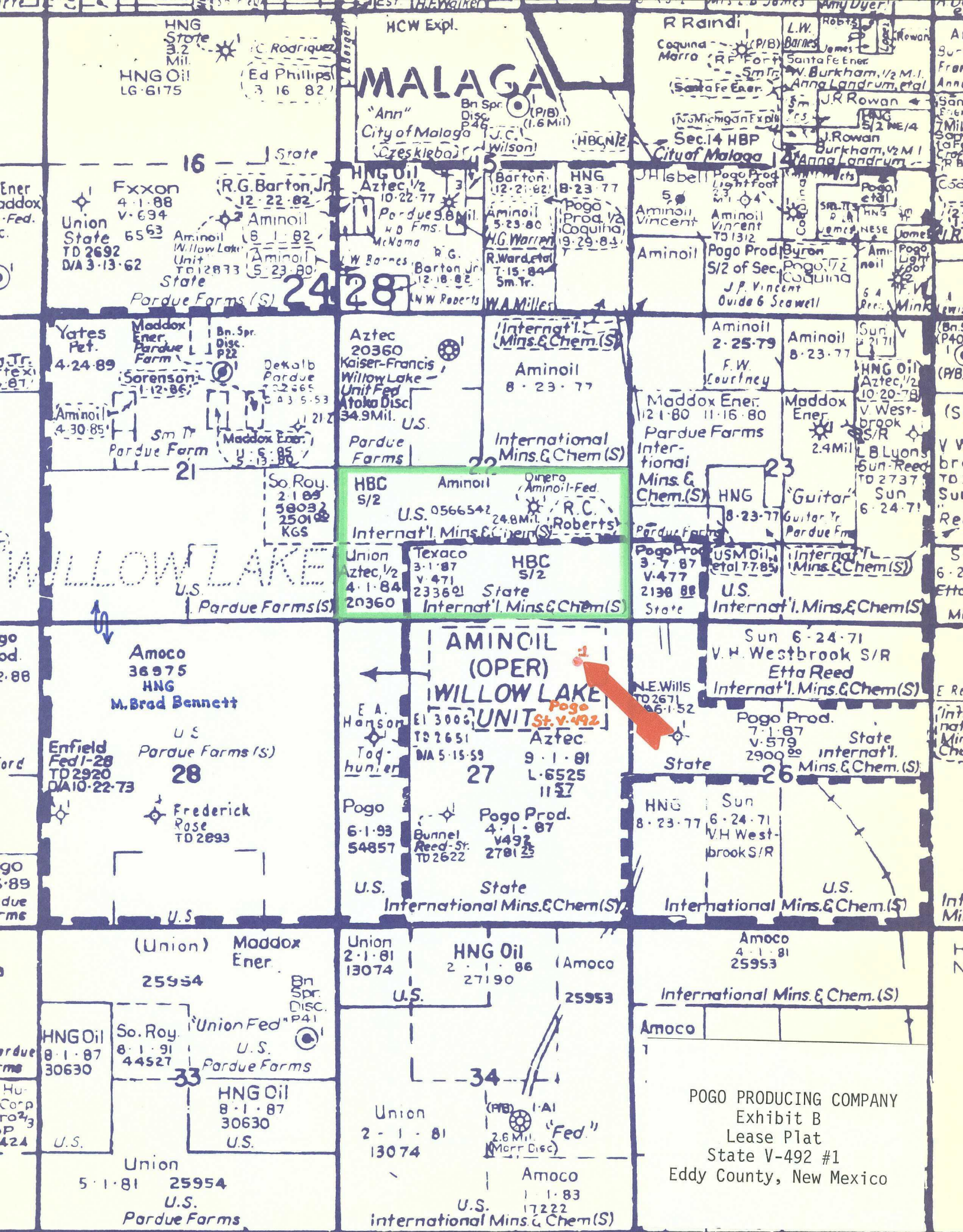



CERTIFIED MAIL - P 167 342 002 - RETURN RECEIPT REQUESTED

Pogo Producing Company

Western Division

600 United Bank Building • Post Office Box 10340 • Midland, Texas 79702-7340 • 915/682-6822

March 5, 1986

Sun Exploration and Production Company
#24 Smith Road, Sun Tower, Suite 600
Midland, Texas 79705

Attention: Mr. Rick Everett

Re: Waiver of Objection to Unorthodox Location
from Offset Operators, 760' FNL & 810' FEL
Section 27, T-24-S, R-28-E, Eddy County, NM
Pogo's NM-571

Gentlemen:

Pogo Producing Company ("Pogo") desires to drill a well to test the Atoka and Morrow formations at a location of 760' FNL and 810' FEL of Section 27, T-24-S, R-28-E, Eddy County, New Mexico. Since the proration unit for said well will be 320 acres, being the $N\frac{1}{2}$ of said Section 27, the proposed location is unorthodox and requires approval by the Oil Conservation Division of the State of New Mexico. To obtain approval, Pogo has made application to the Commission by correspondence, a copy of which is attached.

The subject location is being proposed due to topographical restrictions in the $N\frac{1}{2}$ of said Section 27. Therefore, if you have no objection to our proposed location, we request that you execute and return two (2) copies of this letter advising us of same at your earliest convenience. Your cooperation in handling this matter will be greatly appreciated. Should you have any questions, please contact our office.

Yours very truly,

POGO PRODUCING COMPANY

Jerry A. Weant
Landman - Western Division

JAW:mo
Enclosures

The undersigned has no objection to the location specified hereinabove.

Dated this 10th day of MARCH, 1986

Sun Exploration and Production Company

By:



CERTIFIED MAIL - P 167 341 997 - RETURN RECEIPT REQUESTED

Pogo Producing Company

Western Division

600 United Bank Building • Post Office Box 10340 • Midland, Texas 79702-7340 • 915/682-6822

March 5, 1986

Maddox Energy
717 N. Harwood, Suite 3030
Dallas, Texas 75201

Attention: Mr. Brad Mantz

Re: Waiver of Objection to Unorthodox Location
from Offset Operators, 760' FNL & 810' FEL
Section 27, T-24-S, R-28-E, Eddy County, NM
Pogo's NM-571

Gentlemen:

Pogo Producing Company ("Pogo") desires to drill a well to test the Atoka and Morrow formations at a location of 760' FNL and 810' FEL of Section 27, T-24-S, R-28-E, Eddy County, New Mexico. Since the proration unit for said well will be 320 acres, being the $N\frac{1}{2}$ of said Section 27, the proposed location is unorthodox and requires approval by the Oil Conservation Division of the State of New Mexico. To obtain approval, Pogo has made application to the Commission by correspondence, a copy of which is attached.

The subject location is being proposed due to topographical restrictions in the $N\frac{1}{2}$ of said Section 27. Therefore, if you have no objection to our proposed location, we request that you execute and return two (2) copies of this letter advising us of same at your earliest convenience. Your cooperation in handling this matter will be greatly appreciated. Should you have any questions, please contact our office.

Yours very truly,

POGO PRODUCING COMPANY

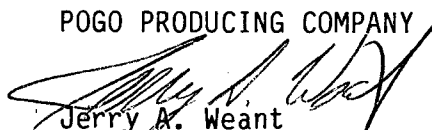
Jerry A. Weant
Landman - Western Division

JAW:mo
Enclosures

The undersigned has no objection to the location specified hereinabove.

Dated this 10th day of March, 1986

Maddox Energy

By:  U.P.



CERTIFIED MAIL - P 167 341 996 - RETURN RECEIPT REQUESTED

Pogo Producing Company

Western Division

600 United Bank Building • Post Office Box 10340 • Midland, Texas 79702-7340 • 915/682-6822

March 5, 1986

HNG Oil Company
P. O. Box 2267
Midland, Texas 79702

Attention: Mr. Frank Estep

Re: Waiver of Objection to Unorthodox Location
from Offset Operators, 760' FNL & 810' FEL
Section 27, T-24-S, R-28-E, Eddy County, NM
Pogo's NM-571

Gentlemen:

Pogo Producing Company ("Pogo") desires to drill a well to test the Atoka and Morrow formations at a location of 760' FNL and 810' FEL of Section 27, T-24-S, R-28-E, Eddy County, New Mexico. Since the proration unit for said well will be 320 acres, being the N $\frac{1}{2}$ of said Section 27, the proposed location is unorthodox and requires approval by the Oil Conservation Division of the State of New Mexico. To obtain approval, Pogo has made application to the Commission by correspondence, a copy of which is attached.

The subject location is being proposed due to topographical restrictions in the N $\frac{1}{2}$ of said Section 27. Therefore, if you have no objection to our proposed location, we request that you execute and return two (2) copies of this letter advising us of same at your earliest convenience. Your cooperation in handling this matter will be greatly appreciated. Should you have any questions, please contact our office.

Yours very truly,

POGO PRODUCING COMPANY

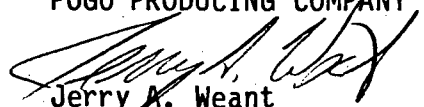
Jerry A. Weant
Landman - Western Division

JAW:mo
Enclosures

The undersigned has no objection to the location specified hereinabove.

Dated this 12 day of MARCH, 1986

HNG Oil Company

By: 



CERTIFIED MAIL - P 167 341 998 - RETURN RECEIPT REQUESTED

Pogo Producing Company

Western Division

600 United Bank Building • Post Office Box 10340 • Midland, Texas 79702-7340 • 915/682-6822

March 5, 1986

M. Brad Bennett
P. O. Box 2062
Midland, Texas 79702

Re: Waiver of Objection to Unorthodox Location
from Offset Operators, 760' FNL & 810' FEL
Section 27, T-24-S, R-28-E, Eddy County, NM
Pogo's NM-571

Gentlemen:

Pogo Producing Company ("Pogo") desires to drill a well to test the Atoka and Morrow formations at a location of 760' FNL and 810' FEL of Section 27, T-24-S, R-28-E, Eddy County, New Mexico. Since the proration unit for said well will be 320 acres, being the $N\frac{1}{2}$ of said Section 27, the proposed location is unorthodox and requires approval by the Oil Conservation Division of the State of New Mexico. To obtain approval, Pogo has made application to the Commission by correspondence, a copy of which is attached.

The subject location is being proposed due to topographical restrictions in the $N\frac{1}{2}$ of said Section 27. Therefore, if you have no objection to our proposed location, we request that you execute and return two (2) copies of this letter advising us of same at your earliest convenience. Your cooperation in handling this matter will be greatly appreciated. Should you have any questions, please contact our office.

Yours very truly,

POGO PRODUCING COMPANY

Jerry A. Weant
Landman - Western Division

JAW:mo
Enclosures

The undersigned has no objection to the location specified hereinabove.

Dated this 12th day of March, 1986

M. Brad Bennett



CERTIFIED MAIL - P 167 342 001 - RETURN RECEIPT REQUESTED

Pogo Producing Company

Western Division

600 Unired Bank Building • Post Office Box 10340 • Midland, Texas 79702-7340 • 915/682-6822

March 5, 1986

Dinero Operating Co.
P. O. Drawer 10505
Midland, Texas 79702

Attention: Mr. Jim Dewey

Re: Waiver of Objection to Unortodox Location
from Offset Operators, 760' FNL & 810' FEL
Section 27, T-24-S, R-28-E, Eddy County, NM
Pogo's NM-571

Gentlemen:

Pogo Producing Company ("Pogo") desires to drill a well to test the Atoka and Morrow formations at a location of 760' FNL and 810' FEL of Section 27, T-24-S, R-28-E, Eddy County, New Mexico. Since the proration unit for said well will be 320 acres, being the $N\frac{1}{2}$ of said Section 27, the proposed location is unorthodox and requires approval by the Oil Conservation Division of the State of New Mexico. To obtain approval, Pogo has made application to the Commission by correspondence, a copy of which is attached.

The subject location is being proposed due to topographical restrictions in the $N\frac{1}{2}$ of said Section 27. Therefore, if you have no objection to our proposed location, we request that you execute and return two (2) copies of this letter advising us of same at your earliest convenience. Your cooperation in handling this matter will be greatly appreciated. Should you have any questions, please contact our office.

Yours very truly,

POGO PRODUCING COMPANY

Jerry A. Weant
Landman - Western Division

JAW:mo
Enclosures

The undersigned has no objection to the location specified hereinabove.

Dated this 18th day of March, 1986

Dinero Operating Co.

By: Russell J. Hamstead



Amoco Production Company

Houston Region
501 WestLake Park Boulevard
Post Office Box 3092
Houston, Texas 77253

R. E. Ogden
Regional Engineering
Manager

March 14, 1986

File: JCA-986.51NM-1983

Re: Unorthodox Well Location
Pogo Producing Company's St. V-492 Well No. 1
Eddy County, New Mexico

State of New Mexico
Energy and Minerals Department
Oil Conservation Division
State Land Office Building
Old Santa Fe Trail
P.O. Box 2088
Santa Fe, NM 87501

Gentlemen,

Amoco Production Company, as an offset operator, has been notified of the intention of Pogo Producing Company to drill the above referenced Atoka-Morrow well at a location 760' FNL and 810' FEL of Section 27, T-24-S, R-28-E, Eddy County, New Mexico. The N/2 of Section 27 will comprise the 320-acre proration unit to be dedicated to the well.

This is to advise that Amoco has no objection to the granting of a permit to drill the subject well at this location and hereby waives objection and notice of hearing on this application.

Very truly yours,

SPS/rr

cc: Pogo Producing Company
600 United Bank Building
P.O. Box 10340
Midland, Texas 79702-7340