

Release Date: July 5, 1988

MERIDIAN OIL

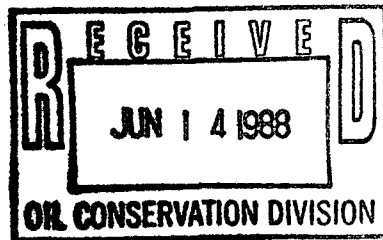

EL PASO
NAT GAS
CO.

For BNC

June 13, 1988

Mr. William LeMay
New Mexico Oil Conservation Division
Post Office Box 2088
Santa Fe, New Mexico 87501

NPL-2541
RULE-104 F(I)
Wildcat Fruitland Pool
160 Acres dcd.
SW1/4 Sec. 26

Dear Mr. LeMay:

This is a request for administrative approval for an unorthodox gas well location in the Undesignated Fruitland Pool.

Juan It is intended to locate the El Paso Natural Gas Company's San Juan 32-5 Unit #106 at 655' from the south line and 1685' from the west line of Section 26, T-32-N, R-6-W, Rio Arriba County, New Mexico.

Extremely rough terrain in the form of steep cliffs makes it impossible to build an orthodox location in the southwest quarter of this section.

A copy of this application is being submitted to all offset operators by certified mail with a request that they furnish your Santa Fe office with a Waiver of Objection, and return one copy to this office.

Plats showing the proposed well location and the terrain in Section 26, along with an ownership plat, are attached.

Sincerely yours,

A handwritten signature in cursive script that reads "Peggy Doak".

Peggy Doak

encl.

WAIVER

_____ hereby waives objection to El Paso Natural Gas application for an unorthodox location for their San Juan 32-5 Unit #106 as proposed above.

By: _____

Date: _____

cc: Northwest Pipeline

MERIDIAN OIL

June 13, 1988
NORTHWEST PIPELINE CORPORATION

Mr. William LeMay
New Mexico Oil Conservation Division
Post Office Box 2088
Santa Fe, New Mexico 87501

'JUN 14 1988

PRODUCTION AND DRILLING

Dear Mr. LeMay:

This is a request for administrative approval for an unorthodox gas well location in the Undesignated Fruitland Pool.

It is intended to locate the El Paso Natural Gas Company's San June 32-5 Unit #106 at 655' from the south line and 1685' from the west line of Section 26, T-32-N, R-6-W, Rio Arriba County, New Mexico.

Extremely rough terrain in the form of steep cliffs makes it impossible to build an orthodox location in the southwest quarter of this section.

A copy of this application is being submitted to all offset operators by certified mail with a request that they furnish your Santa Fe office with a Waiver of Objection, and return one copy to this office.

Plats showing the proposed well location and the terrain in Section 26, along with an ownership plat, are attached.

Sincerely yours,



Peggy Doak

encl.

WAIVER

NORTHWEST PIPELINE hereby waives objection to El Paso Natural Gas application for an unorthodox location for their San Juan 32-5 Unit #106 as proposed above.

By: Paul C. Thompson

Date: 6/14/88

cc: Northwest Pipeline

EL PASO NATURAL GAS COMPANY

Well Name San Juan 32-5 Unit #106, Undesignated Fruitland

Footage----- 655' FSL, 1685' FWL

APPLICATION FOR NON-STANDARD LOCATION

County Rio Arriba State New Mexico Section 26 Township 32N Range 6W

(1)

(1)

(1)

(1)

(1)

(2)

(2)

(2)

REMARKS:

(1) El Paso Natural Gas Company, Operator of San Juan 32-5 Unit

(2) Northwest Pipeline Corporation, Operator of Rosa Unit



OIL CONSERVATION DIVISION

STATE OF NEW MEXICO
ENERGY AND MINERALS DEPARTMENT

P. O. BOX 2088

SANTA FE, NEW MEXICO 37501

Form C-102
Revised 10-1-78

All distances must be from the outer boundaries of the Section.

Operator El Paso Natural Gas Co.			Lease San Juan 32-5 Unit NM-03780		Well No. 106
Unit Letter N	Section 26	Township T32N	Range R6W	County Rio Arriba	
Actual Footage Location of Well: 655 feet from the South line and 1685 feet from the West line					
Ground Level Elev. 6386	Producing Formation Fruitland Coal		Pool Undesignated		Dedicated Acreage: 160 Acres

1. Outline the acreage dedicated to the subject well by colored pencil or hachure marks on the plat below.
2. If more than one lease is dedicated to the well, outline each and identify the ownership thereof (both as to working interest and royalty).
3. If more than one lease of different ownership is dedicated to the well, have the interests of all owners been consolidated by communitization, unitization, force-pooling, etc?

☒ Yes ☐ No If answer is "yes," type of consolidation unitization

If answer is "no," list the owners and tract descriptions which have actually been consolidated. (Use reverse side of this form if necessary.) _____

No allowable will be assigned to the well until all interests have been consolidated (by communitization, unitization, forced-pooling, or otherwise) or until a non-standard unit, eliminating such interests, has been approved by the Division.

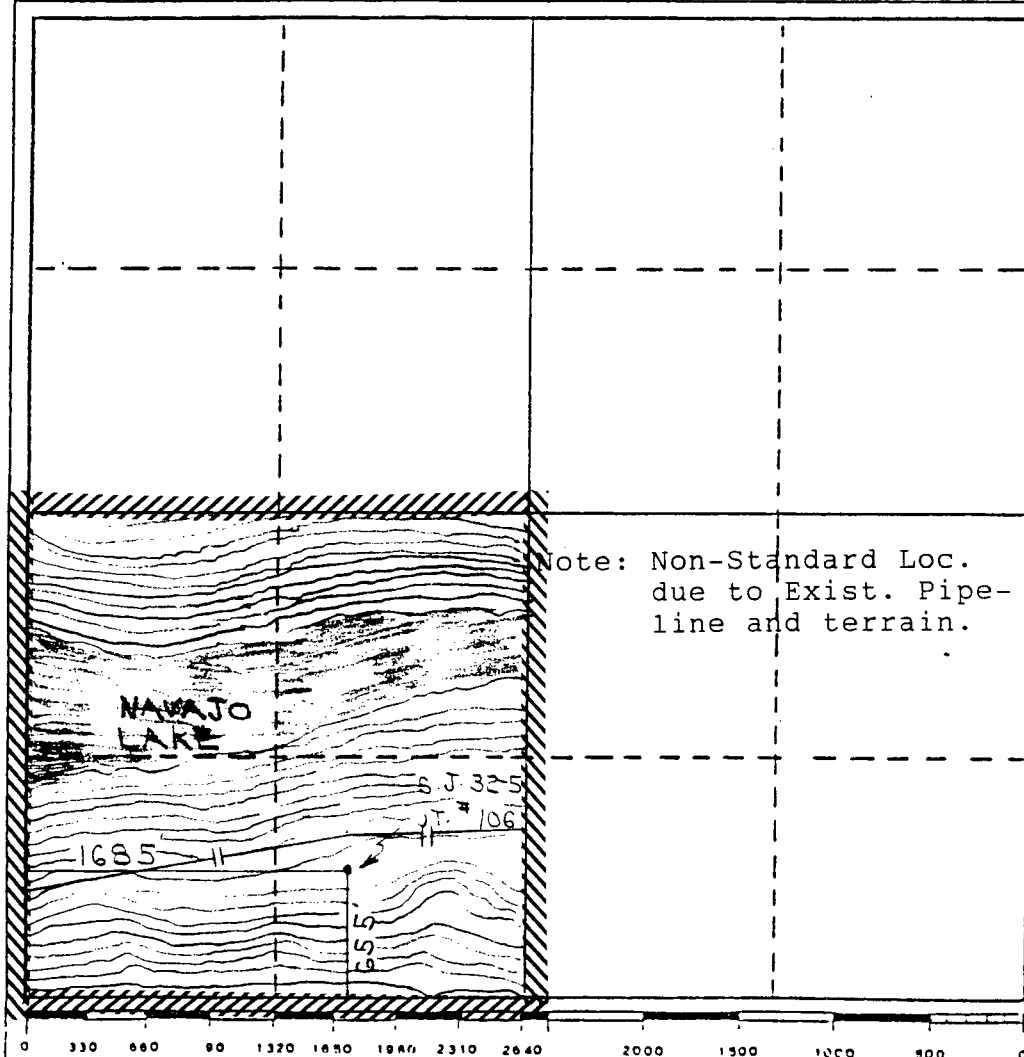

CERTIFICATION

I hereby certify that the information contained herein is true and complete to the best of my knowledge and belief.

Name
Drilling Clerk
Position
El Paso Natural Gas Co
Company

Date

I hereby certify that the well location shown on this plat was determined from field notes of actual surveys made by me or under my supervision, and that the same is true and correct to the best of my knowledge and belief.

Registered Professional
Land Surveyor

Date Surveyed
June 2, 1988

Registered Land Surveyor
R. Howard Daggett

Certificate No.
9679



STATE OF NEW MEXICO
ENERGY AND MINERALS DEPARTMENT

OIL CONSERVATION DIVISION
AZTEC DISTRICT OFFICE

1000 RIO BRAZOS ROAD
AZTEC, NEW MEXICO 87410
(505) 334-6178

OIL CONSERVATION DIVISION
BOX 2088
SANTA FE, NEW MEXICO 87501

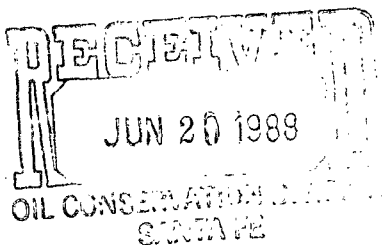

DATE 6-14-88

RE: Proposed MC _____
Proposed DIIC _____
Proposed NSL N _____
Proposed SWD _____
Proposed WFX _____
Proposed PMX _____

Gentlemen:

I have examined the application dated 6-14-88
for the MERIDIAN OIL, INC. S.J. 32-5 #AD6 N-26-32N-60
Operator Lease and Well No. Unit, S-T-R

and my recommendations are as follows:

APPROVE

Yours truly,