

Release Date: August 9, 1988  
No offset

By BCL

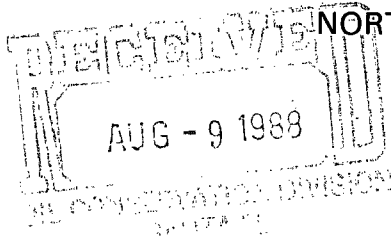

**NORTHWEST PIPELINE CORPORATION**

**PRODUCTION & DRILLING**  
3539 East 30th Street  
Farmington, New Mexico 87401  
4320-PD-092-88

*NSL - 2570*  
*RULE-104 F(E)*

August 5, 1988

*Wildcat Fruitland Pool*  
*160 Acre dcd*  
*8w1/4 Sec 17*

NMOCC  
Attn: Dick LeMay  
P.O. Box 2088  
Santa Fe, NM 87504-2088

Re: Unorthodox Location - Rosa Unit #207

Dear Mr. LeMay:

Northwest Pipeline requests permission to drill a Fruitland well on an unorthodox location due to topography (2035' FSL, 1155' FWL Sec. 17, T31N, R5W). *Rio Arriba County*

The BLM has requested this location to alleviate impact on the steep hillside just south of the location.

Northwest Pipeline is the only operator in the Rosa Unit thus no notification of offset operators is being done.

Attached is a plat and topo map.

Sincerely,

*Mike J. Turnbaugh*  
Mike J. Turnbaugh  
Sr. Engineer

MJT/ch  
Attch

## OIL CONSERVATION DIVISION

STATE OF NEW MEXICO  
ENERGY AND MINERALS DEPARTMENTP. O. BOX 2088  
SANTA FE, NEW MEXICO 87501Form C-102  
Revised 10-1-78

All distances must be from the outer boundaries of the Section.

Operator Northwest Pipeline Corporation			Lease Rosa Unit		Well No. 207
Unit Letter L	Section 17	Township 31 North	Range 5 West	County Rio Arriba	
Actual Footage Location of Well: 2035 feet from the South line and 1155 feet from the West line					
Ground Level Elev. 6301	Producing Formation Fruitland		Pool Undesignated PC	Dedicated Acreage 160 Acres	

1. Outline the acreage dedicated to the subject well by colored pencil or hatchure marks on the plat below.
2. If more than one lease is dedicated to the well, outline each and identify the ownership thereof (both as to working interest and royalty).
3. If more than one lease of different ownership is dedicated to the well, have the interests of all owners been consolidated by communitization, unitization, force-pooling, etc?

☒ Yes ☐ No If answer is "yes," type of consolidation unitization

If answer is "no," list the owners and tract descriptions which have actually been consolidated. (Use reverse side of this form if necessary.)

No allowable will be assigned to the well until all interests have been consolidated (by communitization, unitization, forced-pooling, or otherwise) or until a non-standard unit, eliminating such interests, has been approved by the Division.

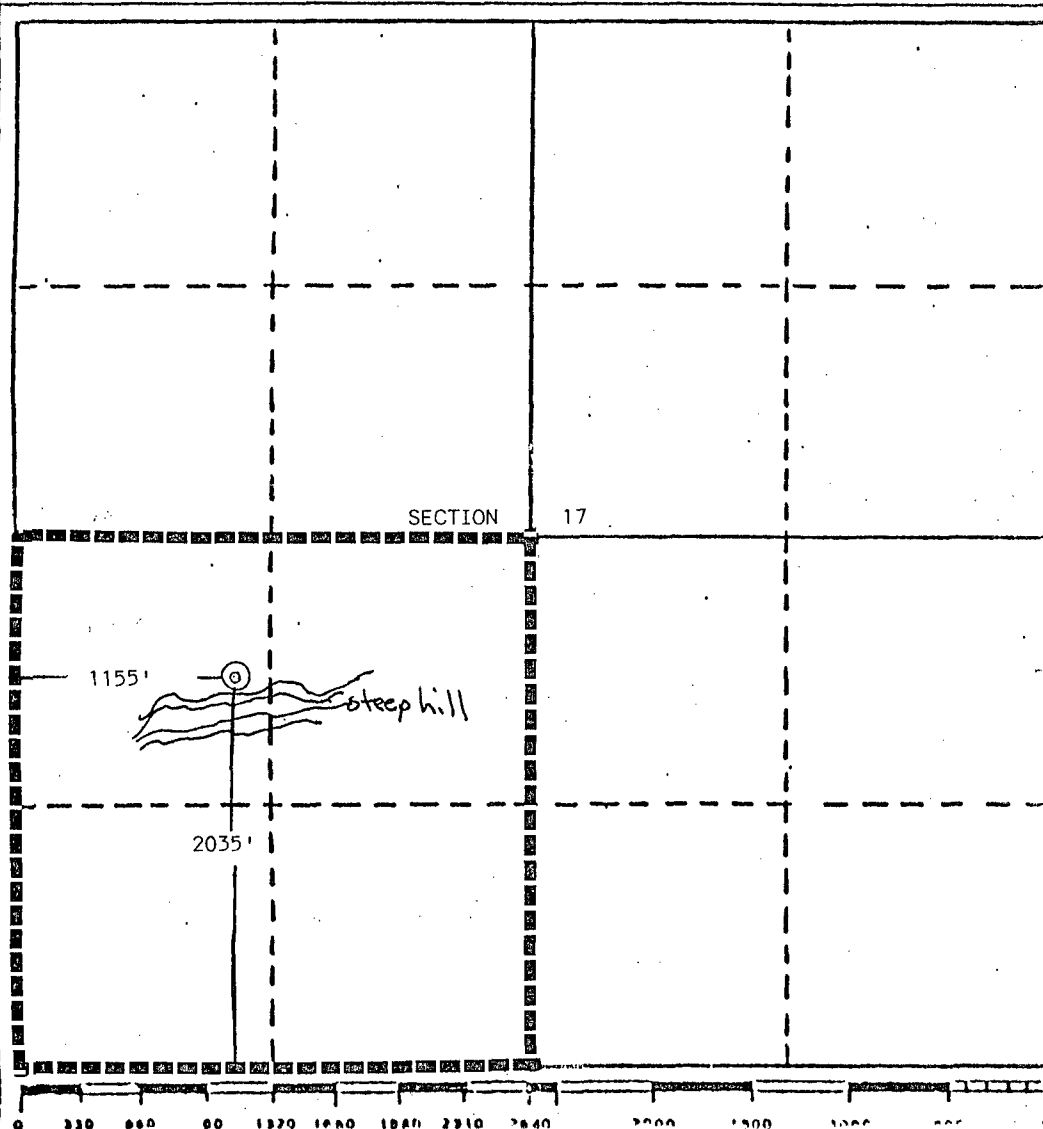

## CERTIFICATION

I hereby certify that the information contained herein is true and complete to the best of my knowledge and belief.

*Mike Turnbaugh*

Name

Mike Turnbaugh

Position

Senior Engineer

Company

Northwest Pipeline Corp.

Date

8-04-88



Date Surveyed

August 2, 1988

Registered Professional Engineer  
and/or Land Surveyor

*Edgar L. Risenhoover*

Certificate No. 5979

Edgar L. Risenhoover, L.S.

