

SIETE OIL & GAS CORPORATION

Petroleum Building Suite 200
P.O. Box 2523 Roswell, New Mexico 88202
Telephone (505) 622-2202

RECEIVED

MAY 15 1989

**OIL CONSERVATION DIV.
SANTA FE**

May 10, 1989

STATE OF NEW MEXICO
Oil Conservation Division
P. O. Box 2088
Santa Fe, NM 87501

Attention: Mike Stogner

RE: VICTORIO STATE NO. 1
Section 31: T16S, R38E
1650' FSL & 660' FWL
Lea County, New Mexico
Lease No. V-988

Gentlemen,

Siete Oil and Gas Corporation respectfully requests your approval of the non-standard location of the above captioned well. The Victorio State No. 1 was drilled to the Atoka formation, at which time it was found to be unproductive in the Atoka. Siete then came uphole and completed it in the Shipp Strawn formation, making it an unorthodox location.

Siete does have the offset acreage to the North and the South, so we are not affecting any operator's acreage offsetting us to the East and West. Enclosed is a copy of the letter sent to each of the offset operators.

We would appreciate your approval on this matter as soon as possible. Thank you for your cooperation.

Sincerely yours,

SIETE OIL AND GAS CORPORATION

By Cathy Batley
Cathy Batley
Drilling & Production Dept.

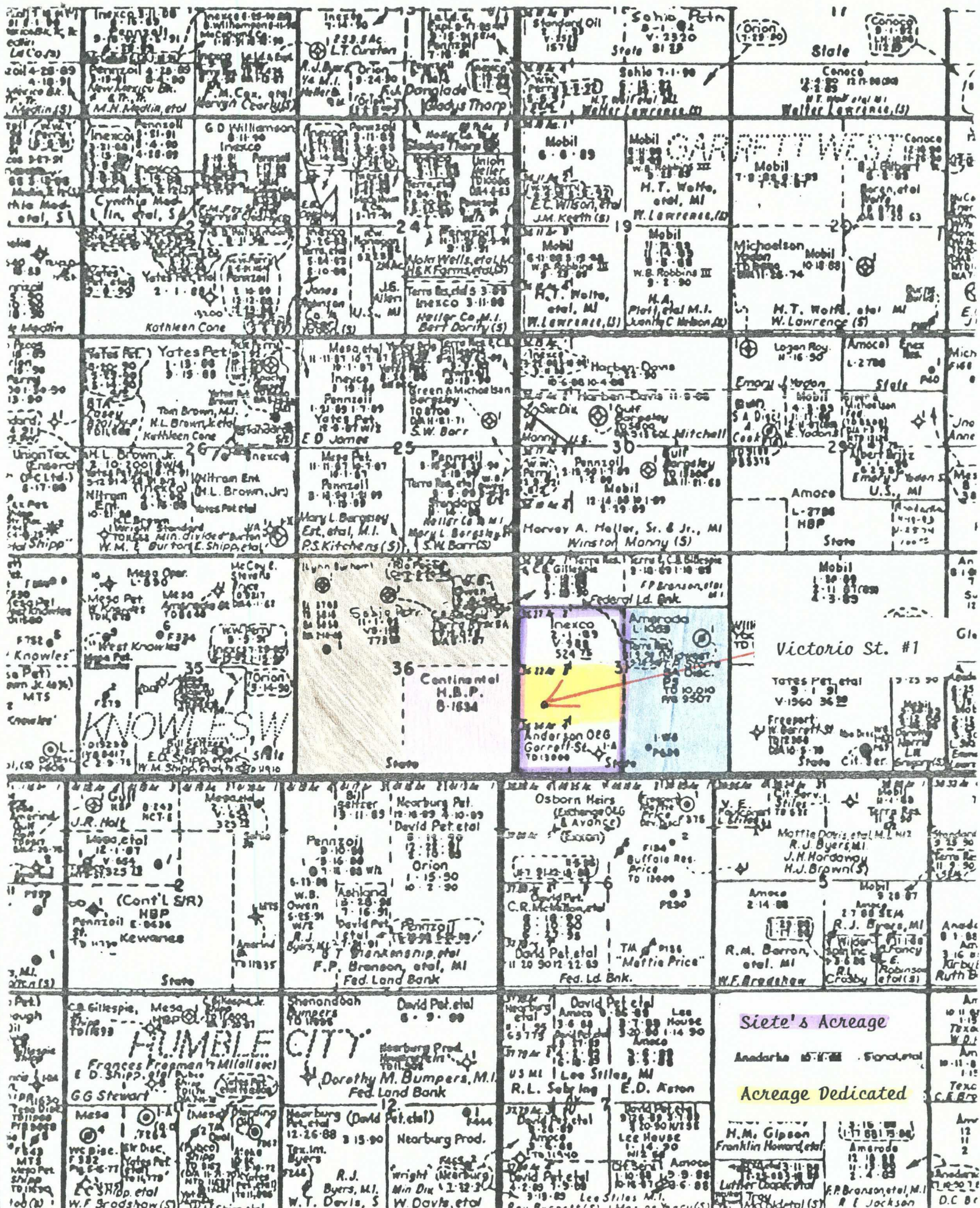

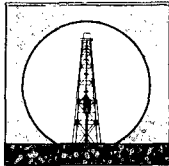

SIETE OIL & GAS CORPORATION

Petroleum Building Suite 200 1989 MAY 18 PM 3: 25
P.O. Box 2523 Roswell, New Mexico 88202
Telephone (505) 622-2202

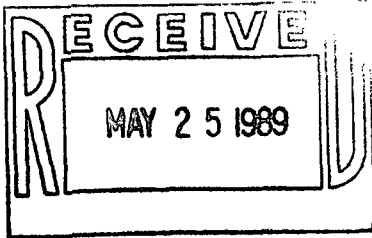

May 10, 1989

RECEIVED

MAY 25 1989

Amerada Hess Corporation
P.O. Box 2040
Tulsa, Oklahoma 74102-2040

OIL CONSERVATION DIV.
SANTA FE

ATTENTION: Land Records

RE: VICTORIO STATE NO. 1
Section 31: T16S, R38E
1650' FSL & 660' FWL
Lea County, New Mexico
Lease No. V-988

Gentlemen,

Siete Oil and Gas Corporation respectfully requests your waiver of the non-standard location of the above captioned well. The Victorio State No. 1 was drilled to the Atoka formation, at which time it was found to be unproductive in the Atoka. Siete then came uphole and completed in the Strawn formation, making it an unorthodox location.

Siete does have the offset acreage to the North and the South, so we are not affecting any of your acreage offsetting us to the East. We would appreciate your compliance with this waiver as soon as possible.

Thank you for your cooperation.

Sincerely yours,

SIETE OIL AND GAS CORPORATION

BY Gilbert E. Miller
Approval by Amerada Hess

BY Cathy Batley
Cathy Batley
Drilling & Production Dept.

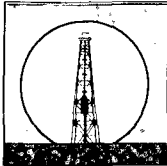

SIETE OIL & GAS CORPORATION

Petroleum Building Suite 200
P.O. Box 2523 Roswell, New Mexico 88202
Telephone (505) 622-2202

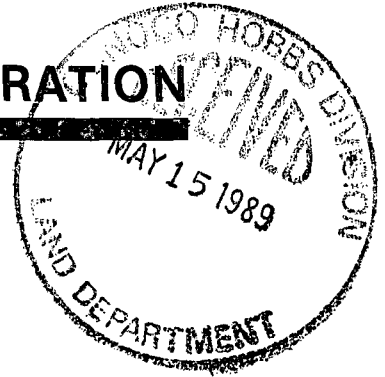

May 10, 1989

Conoco, Inc.
P.O. Box 460
Hobbs, New Mexico 88240

ATTENTION: Jerry Hardin, Landman

RE: VICTORIO STATE NO. 1
Section 31: T16S, R38E
1650' FSL & 660' FWL
Lea County, New Mexico
Lease No. V-988

Dear Mr. Hardin,

Siete Oil and Gas Corporation respectfully requests your waiver of the non-standard location of the above captioned well. The Victorio State No. 1 was drilled to the Atoka formation, at which time it was found to be unproductive in the Atoka. Siete then came uphole and completed in the Strawn formation, making it an unorthodox location.

Siete does have the offset acreage to the North and the South, so we are not affecting any of your acreage offsetting us to the West. We would appreciate your compliance with this waiver as soon as possible.

Thank you for your cooperation.

Sincerely yours,

SIETE OIL AND GAS CORPORATION

BY 
Approved by Conoco, Inc.

BY 
Cathy Batley
Drilling & Production Dept.

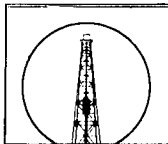

SIETE OIL & GAS CORPORATION

Petroleum Building Suite 200
P.O. Box 2523 Roswell, New Mexico 88202
Telephone (505) 622-2202

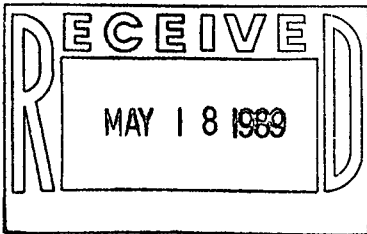

May 10, 1989

BP Exploration, Inc.
P.O. Box 4587
Houston, Texas 77210-4587

ATTENTION: Jim Sikes, Landman

SULF COAST DISTRICT LAND			
MAY 16 '89			
	ROUTE	CC	ACTION
MWB			
CWG			
ABH			
RCS			
JLS	✓		
SEC.			
OTHER CC'S: _____			
CALL UP DATE _____			
FILE: _____			
COMMENTS: _____			

RE: VICTORIO STATE NO. 1
Section 31: T16S, R38E
1650' FSL & 660' FWL
Lea County, New Mexico
Lease No. V-988

Dear Mr. Sikes,

Siete Oil and Gas Corporation respectfully requests your waiver of the non-standard location of the above captioned well. The Victorio State No. 1 was drilled to the Atoka formation, at which time it was found to be unproductive in the Atoka. Siete then came uphole and completed in the Strawn formation, making it an unorthodox location.

Siete does have the offset acreage to the North and the South, so we are not affecting any of your acreage offsetting us to the Northeast. We would appreciate your compliance with this waiver as soon as possible.

Thank you for your cooperation.

Sincerely yours,

SIETE OIL AND GAS CORPORATION

BY James D. Sikes
Approval by BP Exploration

BY Cathy Batley
Cathy Batley
Drilling & Production Dept.

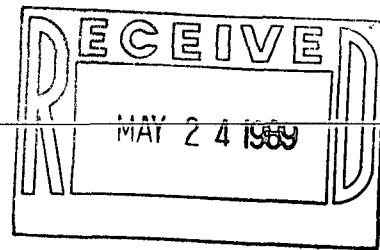

Production Department
Hobbs Division
North American Production

Conoco Inc.
726 East Michigan
P.O. Box 460
Hobbs, NM 88241
(505) 397-5800

May 22, 1989

Siete Oil & Gas Corporation
Petroleum Building, Suite 200
P.O. Box 2523
Roswell, New Mexico 88202

Gentlemen:

Victorio State No. 1, Section 31,
T16S, R38E, 1650' FSL and 660' FWL,
Lea County, New Mexico

Conoco Inc. has approved your letter ballot for the unorthodox location of the subject well. One copy of your ballot is returned, herewith.

Yours very truly,

Hugh A. Ingram
Conservation Coordinator

HAI/tk
4883.

Submit 5 Copies
Appropriate District Office
DISTRICT I
P.O. Box 1980, Hobbs, NM 88240

DISTRICT II
P.O. Drawer DD, Artesia, NM 88210

DISTRICT III
1000 Rio Brazos Rd., Aztec, NM 87410

State of New Mexico
Energy, Minerals and Natural Resources Department

OIL CONSERVATION DIVISION

P.O. Box 2088
Santa Fe, New Mexico 87504-2088

Form C-104
Revised 1-1-89
See Instructions
at Bottom of Page

RECEIVED

REQUEST FOR ALLOWABLE AND AUTHORIZATION
TO TRANSPORT OIL AND NATURAL GAS

MAY - 8 1989

Operator Siete Oil and Gas Corporation		Well APN No. OIL CONSERVATION DIV. 30-025-30542 AFE
Address P.O. Box 2523 Roswell, New Mexico 88202-2523		
Reason(s) for Filing (Check proper box) New Well <input type="checkbox"/> Change in Transporter of: <input checked="" type="checkbox"/> Other (Please explain) Recompletion <input type="checkbox"/> Oil <input type="checkbox"/> Dry Gas <input type="checkbox"/> Test allowable to move 875 bbls oil Change in Operator <input type="checkbox"/> Casinghead Gas <input type="checkbox"/> Condensate <input type="checkbox"/> for perforations 11556'-11789'.		
If change of operator give name and address of previous operator		

II. DESCRIPTION OF WELL AND LEASE

Lease Name Victorio State	Well No. 1	Pool Name, including Formation Wildcat Atoka	Kind of Lease State, Federal or Fee	Lease No. V-988
Location Unit Letter L : 1650 Feet From The South Line and 660 Feet From The West Line Section 31 Township 16S Range 38E, NMPM, Lea County				

III. DESIGNATION OF TRANSPORTER OF OIL AND NATURAL GAS

Name of Authorized Transporter of Oil Lantern Petroleum Corp. <input checked="" type="checkbox"/> or Condensate <input type="checkbox"/>	Address (Give address to which approved copy of this form is to be sent) P.O. Box 2281, Midland, TX 79702
Name of Authorized Transporter of Casinghead Gas Undecided <input checked="" type="checkbox"/> or Dry Gas <input type="checkbox"/>	Address (Give address to which approved copy of this form is to be sent)
If well produces oil or liquids, give location of tanks.	Unit L Sec. 31 Twp. 16S Rge. 38E Is gas actually connected? No When? ASAP
If this production is commingled with that from any other lease or pool, give commingling order number:	

IV. COMPLETION DATA

Designate Type of Completion - (X)	Oil Well X	Gas Well	New Well X	Workover	Deepen	Plug Back	Same Res'v	Diff Res'v
Date Spudded 1/31/89	Date Compl. Ready to Prod. N/A	Total Depth 11950'	P.B.T.D. 11905'					
Elevations (DF, RKB, RT, GR, etc.) 3741.6' GL	Name of Producing Formation Strawn	Top Oil/Gas Pay 11556'	Tubing Depth 11460'					
Perforations 11556'-11789'	Depth Casing Shoe 11950'							
TUBING, CASING AND CEMENTING RECORD								
HOLE SIZE	CASING & TUBING SIZE	DEPTH SET	SACKS CEMENT					
17 1/2"	13 3/8"	420'	370 sks circ					
12 1/4"	8 5/8"	4500'	1800 sks					
7 7/8"	5 1/2"	11850'	1060 sks					
	2 3/8"	11460'						

V. TEST DATA AND REQUEST FOR ALLOWABLE

OIL WELL (Test must be after recovery of total volume of load oil and must be equal to or exceed top allowable for this depth or be for full 24 hours.)			
Date First New Oil Run To Tank	Date of Test	Producing Method (Flow, pump, gas lift, etc.)	
Length of Test	Tubing Pressure	Casing Pressure	Choke Size
Actual Prod. During Test	Oil - Bbls.	Water - Bbls.	Gas - MCF
GAS WELL			
Actual Prod. Test - MCF/D	Length of Test	Bbls. Condensate/MMCF	Gravity of Condensate
Testing Method (pilot, back pr.)	Tubing Pressure (Shut-in)	Casing Pressure (Shut-in)	Choke Size

VI. OPERATOR CERTIFICATE OF COMPLIANCE

I hereby certify that the rules and regulations of the Oil Conservation Division have been complied with and that the information given above is true and complete to the best of my knowledge and belief.

Signature
Cathy Batley, Drilling & Production
Printed Name
May 2, 1989 (505)622-2202
Date
Telephone No.

OIL CONSERVATION DIVISION

MAY 4 1989

Date Approved
By Jerry L. Lipton
Title DISTRICT 1 SUPERVISOR

INSTRUCTIONS: This form is to be filed in compliance with Rule 1104

- 1) Request for allowable for newly drilled or deepened well must be accompanied by tabulation of deviation tests taken in accordance with Rule 111.
- 2) All sections of this form must be filled out for allowable on new and recompleted wells.
- 3) Fill out only Sections I, II, III, and VI for changes of operator, well name or number, transporter, or other such changes.
- 4) Separate Form C-104 must be filed for each pool in multiply completed wells.

Submit 3 Copies
to Appropriate
District Office

State of New Mexico
Energy, Minerals and Natural Resources Department

Form C-103
Revised 1-1-89

DISTRICT I
P.O. Box 1980, Hobbs, NM 88240

DISTRICT II
P.O. Drawer DD, Artesia, NM 88210

DISTRICT III
1000 Rio Brazos Rd., Aztec, NM 87410

OIL CONSERVATION DIVISION
P.O. Box 2088
Santa Fe, New Mexico 87504-2088

WELL API NO.
5. Indicate Type of Lease STATE <input checked="" type="checkbox"/> FEE <input type="checkbox"/>
6. State Oil & Gas Lease No. V-988
7. Lease Name or Unit Agreement Name Victorio State
8. Well No. 1
9. Pool name or Wildcat Wildcat - Atoka

SUNDRY NOTICES AND REPORTS ON WELLS (DO NOT USE THIS FORM FOR PROPOSALS TO DRILL OR TO DEEPEN OR PLUG BACK TO A DIFFERENT RESERVOIR. USE "APPLICATION FOR PERMIT" (FORM C-101) FOR SUCH PROPOSALS.)	
1. Type of Well: OIL WELL <input checked="" type="checkbox"/> GAS WELL <input type="checkbox"/> OTHER	
2. Name of Operator Siete Oil & Gas Corporation	
3. Address of Operator P.O. Box 2523 Roswell, NM 88202-2523	
4. Well Location Unit Letter L : 1650 Feet From The South Line and 660 Feet From The West Line Section 31 Township 16S Range 38E NMPM Lea County	
10. Elevation (Show whether DF, RKB, RT, GR, etc.) 3741.6' GR	

11. Check Appropriate Box to Indicate Nature of Notice, Report, or Other Data	
NOTICE OF INTENTION TO:	SUBSEQUENT REPORT OF:
PERFORM REMEDIAL WORK <input type="checkbox"/>	REMEDIAL WORK <input type="checkbox"/>
TEMPORARILY ABANDON <input type="checkbox"/>	ALTERING CASING <input type="checkbox"/>
PULL OR ALTER CASING <input type="checkbox"/>	COMMENCE DRILLING OPNS. <input checked="" type="checkbox"/>
OTHER: <input type="checkbox"/>	PLUG AND ABANDONMENT <input type="checkbox"/>
	CASING TEST AND CEMENT JOB <input type="checkbox"/>
	OTHER: Perforated & treated <input type="checkbox"/>

12. Describe Proposed or Completed Operations (Clearly state all pertinent details, and give pertinent dates, including estimated date of starting any proposed work) SEE RULE 1103.

3/27/89 RU Schlumberger, GIH w/CBL, POOH, GIH & perforated 11556'-11789' w/33 perforations, POOH GIH w/pkr & tbq, SION.

3/28/89 Set pkr @ 11460', pressure backside to 1000 PSI, held ok, acidized w/5000 gal 15% HCl, divert w/66 ballsealers, AIR-3 BPM, AIP-5000, FPIP-2100, ISIP-3800, max-6000 (balled out), min-4000, @ 5 min-7000, @ 10 min-2400, @ 15 min-2100, flowback 30-45 min, began slopping.

4/13/89 Fraced 2/20,000 gal 20% gelled acid, start injection pad @ 6 BPM @ 4800 PSI, increased to 8 BPM @ 5420 PSI once acid was in formation, AIR-7.4 BPM, AIP-5280, max-5750, FPIP-5690, ISIP-4100, @ 15 min-3400, began flowback, recovered total load of 780 bbls, open well to 32/64" choke.

I hereby certify that the information above is true and complete to the best of my knowledge and belief.

SIGNATURE Cathy D. Batley TITLE Drilling & Production DATE 4/18/89
TYPE OR PRINT NAME _____ TELEPHONE NO. _____

(This space for State Use)

APPROVED BY Eduardo J. Sany TITLE OIL & GAS INSPECTOR DATE APR 21 1989

CONDITIONS OF APPROVAL, IF ANY:

Submit 3 Copies
to Appropriate
District Office

State of New Mexico
Energy, Minerals and Natural Resources Department

Form C-103
Revised 1-1-89

DISTRICT I
P.O. Box 1980, Hobbs, NM 88240

DISTRICT II
P.O. Drawer DD, Artesia, NM 88210

DISTRICT III
1000 Rio Brazos Rd., Aztec, NM 87410

OIL CONSERVATION DIVISION
P.O. Box 2088
Santa Fe, New Mexico 87504-2088

WELL API NO.	30-025-30542
5. Indicate Type of Lease	STATE <input checked="" type="checkbox"/> FEE <input type="checkbox"/>
6. State Oil & Gas Lease No.	V-988
7. Lease Name or Unit Agreement Name	Victorio State
8. Well No.	1
9. Pool name or Wildcat	Wildcat - Atoka
10. Elevation (Show whether DF, RKB, RT, GR, etc.)	3741.6' GR

SUNDRY NOTICES AND REPORTS ON WELLS
(DO NOT USE THIS FORM FOR PROPOSALS TO DRILL OR TO DEEPEN OR PLUG BACK TO A
DIFFERENT RESERVOIR. USE "APPLICATION FOR PERMIT"
(FORM C-101) FOR SUCH PROPOSALS.)

1. Type of Well:
OIL WELL ☒ GAS WELL ☐ OTHER ☐

2. Name of Operator
Siete Oil & Gas Corporation

3. Address of Operator
P.O. Box 2523 Roswell, NM 88202-2523

4. Well Location
Unit Letter L : 1650 Feet From The South Line and 660 Feet From The West Line
Section 31 Township 16S Range 38E NMPM Lea County

11. Check Appropriate Box to Indicate Nature of Notice, Report, or Other Data

NOTICE OF INTENTION TO:

PERFORM REMEDIAL WORK ☐ PLUG AND ABANDON ☐
TEMPORARILY ABANDON ☐ CHANGE PLANS ☐
PULL OR ALTER CASING ☐
OTHER: ☐

SUBSEQUENT REPORT OF:

REMEDIAL WORK ☐ ALTERING CASING ☐
COMMENCE DRILLING OPNS. ☐ PLUG AND ABANDONMENT ☐
CASING TEST AND CEMENT JOB ☒
OTHER: ☐

12. Describe Proposed or Completed Operations (Clearly state all pertinent details, and give pertinent dates, including estimated date of starting any proposed work) SEE RULE 1103.

3/15/89 TD 7 7/8" hole to 11950' @ 1:15 PM, RU & ran CNL/LDT, DLL/MSFL, FMS & Sonic on openhole interval 30'-11943', logger's TD @ 11946', RU & ran 83 jts (3493.39') 17# N-80 5 1/2" csg + 202 jts (8466.42') 17# J-55 csg, set @ 11950' w/1060 sks class H w/.9% CF14 & 10% D-44, PD @ 3:30 AM 3/18/89, est. TOC @ 8200', PBD 11905', WOC for 48 hrs, test BOP to 1000#, held ok, SI for evaluation

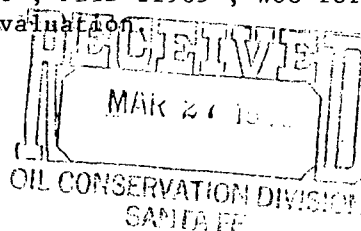

I hereby certify that the information above is true and complete to the best of my knowledge and belief.

SIGNATURE Cathy D. Bailey TITLE Drilling & Production DATE 3/21/89
TYPE OR PRINT NAME Cathy D. Bailey TELEPHONE NO. _____

(This space for State Use)

APPROVED BY Gerry Lopez TITLE DISTRICT 1 SUPERVISOR DATE MAR 23 1989

CONDITIONS OF APPROVAL, IF ANY:

Submit 3 Copies
to Appropriate
District Office

State of New Mexico
Energy, Minerals and Natural Resources Department

Form C-103
Revised 1-1-89

DISTRICT I
P.O. Box 1980, Hobbs, NM 88240

DISTRICT II
P.O. Drawer DD, Artesia, NM 88210

DISTRICT III
1000 Rio Brazos Rd., Aztec, NM 87410

OIL CONSERVATION DIVISION

P.O. Box 2088
Santa Fe, New Mexico 87504-2088

WELL API NO.	30-025-30542
5. Indicate Type of Lease	STATE <input checked="" type="checkbox"/> FEE <input type="checkbox"/>
6. State Oil & Gas Lease No.	V-988
7. Lease Name or Unit Agreement Name	Victorio State
8. Well No.	1
9. Pool name or Wildcat	Wildcat - Atoka
10. Elevation (Show whether DF, RKB, RT, GR, etc.)	
3741.6' GR	

SUNDRY NOTICES AND REPORTS ON WELLS
(DO NOT USE THIS FORM FOR PROPOSALS TO DRILL OR TO DEEPEN OR PLUG BACK TO A
DIFFERENT RESERVOIR. USE "APPLICATION FOR PERMIT"
(FORM C-101) FOR SUCH PROPOSALS.)

1. Type of Well: OIL WELL <input checked="" type="checkbox"/> GAS WELL <input type="checkbox"/> OTHER <input type="checkbox"/>	2. Name of Operator Siete Oil & Gas Corporation	3. Address of Operator P.O. Box 2523 Roswell, NM 88202-2523	4. Well Location Unit Letter L : 1650 Feet From The South Line and 660 Feet From The West Line Section 31 Township 16S Range 38E NMPM Lea County
11. Check Appropriate Box to Indicate Nature of Notice, Report, or Other Data			
NOTICE OF INTENTION TO:		SUBSEQUENT REPORT OF:	
PERFORM REMEDIAL WORK <input type="checkbox"/>	PLUG AND ABANDON <input type="checkbox"/>	REMEDIAL WORK <input type="checkbox"/>	ALTERING CASING <input type="checkbox"/>
TEMPORARILY ABANDON <input type="checkbox"/>	CHANGE PLANS <input type="checkbox"/>	COMMENCE DRILLING OPNS. <input type="checkbox"/>	PLUG AND ABANDONMENT <input type="checkbox"/>
PULL OR ALTER CASING <input type="checkbox"/>	OTHER: <input type="checkbox"/>	CASING TEST AND CEMENT JOB <input type="checkbox"/>	OTHER: Amend Total Depth <input checked="" type="checkbox"/>

12. Describe Proposed or Completed Operations (Clearly state all pertinent details, and give pertinent dates, including estimated date of starting any proposed work) SEE RULE 1103.

3/15/89 Siete Oil & Gas received a verbal to amend the proposed total depth from 11800' to 12000' by Bonnie of OCD in Hobbs.

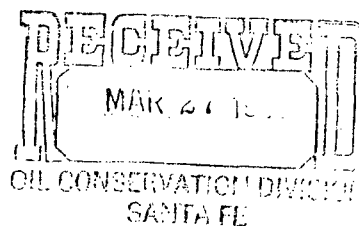

I hereby certify that the information above is true and complete to the best of my knowledge and belief.

SIGNATURE Cathy D. Batley TITLE Drilling & Production DATE 3/21/89
TYPE OR PRINT NAME Cathy D. Batley TELEPHONE NO. _____

(This space for State Use)

APPROVED BY [Signature] TITLE _____ DATE _____

CONDITIONS OF APPROVAL, IF ANY:

DISTRICT 1 SUPERVISOR

MAR 23 1989

Submit 3 Copies
to Appropriate
District Office

State of New Mexico
Energy, Minerals and Natural Resources Department

Form C-103
Revised 1-1-89

DISTRICT I
P.O. Box 1980, Hobbs, NM 88240

DISTRICT II
P.O. Drawer DD, Artesia, NM 88210

DISTRICT III
1000 Rio Brazos Rd., Aztec, NM 87410

OIL CONSERVATION DIVISION
P.O. Box 2088
Santa Fe, New Mexico 87504-2088

WELL API NO.	30-025-30542
5. Indicate Type of Lease	STATE <input checked="" type="checkbox"/> FEE <input type="checkbox"/>
6. State Oil & Gas Lease No.	V-988
7. Lease Name or Unit Agreement Name	
Victorio State	
8. Well No.	1
9. Pool name or Wildcat	Wildcat - Strawn
10. Elevation (Show whether DF, RKB, RT, GR, etc.)	

SUNDRY NOTICES AND REPORTS ON WELLS
(DO NOT USE THIS FORM FOR PROPOSALS TO DRILL OR TO DEEPEN OR PLUG BACK TO A
DIFFERENT RESERVOIR. USE "APPLICATION FOR PERMIT"
(FORM C-101) FOR SUCH PROPOSALS.)

1. Type of Well: OIL WELL <input checked="" type="checkbox"/> GAS WELL <input type="checkbox"/> OTHER <input type="checkbox"/>	2. Name of Operator Siete Oil & Gas Corporation
3. Address of Operator P.O. Box 2523 Roswell, NM 88202-2523	4. Well Location Unit Letter L : 1650 Feet From The South Line and 660 Feet From The West Line Section 31 Township 16S Range 38E NMPM Lea County
10. Elevation (Show whether DF, RKB, RT, GR, etc.)	

11. Check Appropriate Box to Indicate Nature of Notice, Report, or Other Data	
NOTICE OF INTENTION TO:	SUBSEQUENT REPORT OF:
PERFORM REMEDIAL WORK <input type="checkbox"/>	REMEDIAL WORK <input type="checkbox"/>
TEMPORARILY ABANDON <input type="checkbox"/>	ALTERING CASING <input type="checkbox"/>
PULL OR ALTER CASING <input type="checkbox"/>	COMMENCE DRILLING OPNS. <input type="checkbox"/>
OTHER: <input type="checkbox"/>	PLUG AND ABANDONMENT <input type="checkbox"/>
	CASING TEST AND CEMENT JOB <input checked="" type="checkbox"/>
	OTHER: <input type="checkbox"/>

12. Describe Proposed or Completed Operations (Clearly state all pertinent details, and give pertinent dates, including estimated date of starting any proposed work) SEE RULE 1103.

2/7/89 TD 12 1/4" hole @ 12:30 AM, RU & ran 48 jts (2016') 32# J-55 8 5/8" csg + 59 jts (2487') 24# J-55 8 5/8" csg, set @ 4500' w/1600 sks 35/65 POZC w/10% D-44, 6% D-20 & 1/4# D-29, tail-in w/200 sks class C & 1/4# D-29, PD @ 3:00 PM, did not circ, tagged top of cmt @ 130' w/wireline, filled to surface w/5 yds pea gravel, WOC for 20 1/4 hrs, test BOP to 1500#, held ok.

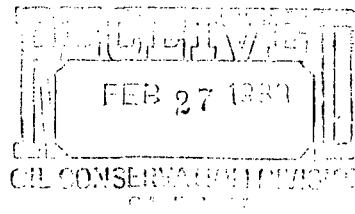

I hereby certify that the information above is true and complete to the best of my knowledge and belief.

SIGNATURE Cathy D. Bailey TITLE Drilling & Production DATE 2/22/89
TYPE OR PRINT NAME TELEPHONE NO.

(This space for State Use)

APPROVED BY Jerry Sexton TITLE DISTRICT 1 SUPERVISOR DATE FEB 24 1989

CONDITIONS OF APPROVAL, IF ANY:

Submit 3 Copies
to Appropriate
District Office

State of New Mexico
Energy, Minerals and Natural Resources Department

Form C-103
Revised 1-1-89

DISTRICT I
P.O. Box 1980, Hobbs, NM 88240

DISTRICT II
P.O. Drawer DD, Artesia, NM 88210

DISTRICT III
1000 Rio Brazos Rd., Aztec, NM 87410

OIL CONSERVATION DIVISION
P.O. Box 2088
Santa Fe, New Mexico 87504-2088

WELL API NO. 30-025-30542
5. Indicate Type of Lease STATE <input checked="" type="checkbox"/> FEE <input type="checkbox"/>
6. State Oil & Gas Lease No. V-988
7. Lease Name or Unit Agreement Name Victorio State
8. Well No. 1
9. Pool name or Wildcat Wildcat - Strawn
10. Elevation (Show whether DF, RKB, RT, GR, etc.) 3741.6' GR

SUNDRY NOTICES AND REPORTS ON WELLS
(DO NOT USE THIS FORM FOR PROPOSALS TO DRILL OR TO DEEPEN OR PLUG BACK TO A
DIFFERENT RESERVOIR. USE "APPLICATION FOR PERMIT"
(FORM C-101) FOR SUCH PROPOSALS.)

1. Type of Well: OIL WELL <input checked="" type="checkbox"/> GAS WELL <input type="checkbox"/> OTHER <input type="checkbox"/>	2. Name of Operator Siete Oil & Gas Corporation
3. Address of Operator P.O. Box 2523 Roswell, NM 88202-2523	4. Well Location Unit Letter L : 1650 Feet From The South Line and 660 Feet From The West Line Section 31 Township 16S Range 38E NMPM Lea County
10. Elevation (Show whether DF, RKB, RT, GR, etc.) 3741.6' GR	

11. Check Appropriate Box to Indicate Nature of Notice, Report, or Other Data	
NOTICE OF INTENTION TO:	SUBSEQUENT REPORT OF:
PERFORM REMEDIAL WORK <input type="checkbox"/>	REMEDIAL WORK <input type="checkbox"/>
TEMPORARILY ABANDON <input type="checkbox"/>	ALTERING CASING <input type="checkbox"/>
PULL OR ALTER CASING <input type="checkbox"/>	COMMENCE DRILLING OPNS. <input checked="" type="checkbox"/>
OTHER: <input type="checkbox"/>	PLUG AND ABANDONMENT <input type="checkbox"/>
	CASING TEST AND CEMENT JOB <input checked="" type="checkbox"/>
	OTHER: <input type="checkbox"/>

12. Describe Proposed or Completed Operations (Clearly state all pertinent details, and give pertinent dates, including estimated date of starting any proposed work) SEE RULE 1103.

1/31/89 Moranco Rig #2 spudded 17½" hole @ 8:00 AM, TIH w/bit, TD 17½" hole to 420' @ 11:45 AM, TOH w/bit, RU & ran 10 jts (425') 13 3/8" 48# J-55 csg, set @ 420' w/170 sks class C w/2% CaCl, ¼# CFR2 & ¼# D-29, tail-in w/200 sks class C w/2% CaCl, PD @ 3:30 PM, circ 60 sks, WOC for 22½ hrs, test BOP to 500#, held ok.

RECEIVED
FEB 07 1989

I hereby certify that the information above is true and complete to the best of my knowledge and belief.

SIGNATURE Cathy A. Batley TITLE Drilling & Production DATE 2/22/89
TYPE OR PRINT NAME Cathy A. Batley TELEPHONE NO. _____

(This space for State Use)

APPROVED BY [Signature] DISTRICT 1 SUPERVISOR DATE FEB 24 1989
CONDITIONS OF APPROVAL, IF ANY _____

Submit to Appropriate
District Office
State Lease - 6 copies
Fee Lease - 5 copies

State of New Mexico
Energy, Minerals and Natural Resources Department

Form C-101
Revised 1-1-89

DISTRICT I
P.O. Box 1980, Hobbs, NM 88240

DISTRICT II
P.O. Drawer DD, Artesia, NM 88210

DISTRICT III
1000 Rio Brazos Rd., Aztec, NM 87410

OIL CONSERVATION DIVISION

P.O. Box 2088
Santa Fe, New Mexico 87504-2088

API NO. (assigned by OCD on New Wells) 30-025-30542
5. Indicate Type of Lease STATE <input checked="" type="checkbox"/> FEE <input type="checkbox"/>
6. State Oil & Gas Lease No. V-988

APPLICATION FOR PERMIT TO DRILL, DEEPEN, OR PLUG BACK

1a. Type of Work: DRILL <input checked="" type="checkbox"/> RE-ENTER <input type="checkbox"/> DEEPEN <input type="checkbox"/> PLUG BACK <input type="checkbox"/>	7. Lease Name or Unit Agreement Name Victorio State
b. Type of Well: OIL WELL <input checked="" type="checkbox"/> GAS WELL <input type="checkbox"/> OTHER <input type="checkbox"/> SINGLE ZONE <input checked="" type="checkbox"/> MULTIPLE ZONE <input type="checkbox"/>	8. Well No. 1
2. Name of Operator Siete Oil and Gas Corporation	9. Pool name or Wildcat Wildcat - Strawn
3. Address of Operator P.O. Box 2523 Roswell, NM 88202-2523	
4. Well Location Unit Letter <u>L</u> : <u>1650</u> Feet From The <u>South</u> Line and <u>660</u> Feet From The <u>West</u> Line Section <u>31</u> Township <u>16S</u> Range <u>38E</u> NMPM <u>Lea</u> County	

10. Proposed Depth 11800'	11. Formation Strawn	12. Rotary or C.T. Rotary	
13. Elevations (Show whether DF, RT, GR, etc.) 3741.6' GR	14. Kind & Status Plug. Bond \$10,000.00 CD	15. Drilling Contractor Moranco	16. Approx. Date Work will start ASAP

17. PROPOSED CASING AND CEMENT PROGRAM					
SIZE OF HOLE	SIZE OF CASING	WEIGHT PER FOOT	SETTING DEPTH	SACKS OF CEMENT	EST. TOP
17 1/2"	13 3/8"	48#	400'	350 sks circ	0'
12 1/4"	8 5/8"	24# & 32#	4500'	1200 sks circ	0'
7 7/8"	5 1/2"	17#	11800'	350 sks	9780'

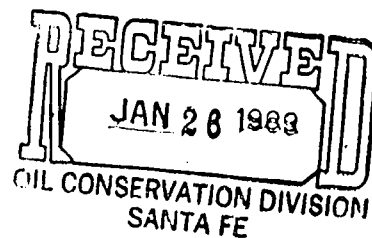

IN ABOVE SPACE DESCRIBE PROPOSED PROGRAM: IF PROPOSAL IS TO DEEPEN OR PLUG BACK, GIVE DATA ON PRESENT PRODUCTIVE ZONE AND PROPOSED NEW PRODUCTIVE ZONE. GIVE BLOWOUT PREVENTER PROGRAM, IF ANY.

I hereby certify that the information above is true and complete to the best of my knowledge and belief.

SIGNATURE Cathy D. Batley TITLE Drilling & Production Secretary DATE 1/19/89
TYPE OR PRINT NAME Cathy D. Batley TELEPHONE NO. 622-2202

(This space for State Use)

APPROVED BY Jerry Seryon TITLE DISTRICT 1 SUPERVISOR DATE JAN 23 1989

CONDITIONS OF APPROVAL, IF ANY:

Permit Expires 6 Months From Approval
Date Unless Drilling Underway.

**NEW MEXICO OIL CONSERVATION COMMISSION
WELL LOCATION AND ACREAGE DEDICATION PLAT**

Form C-102
Supersedes C-128
Effective 1-1-65

All distances must be from the outer boundaries of the Section.

Operator Siete Oil & Gas Corp.			Lease Victorio		Well No. 1
Unit Letter L	Section 31	Township 16 South	Range 38 East	County Lea	
Actual Footage Location of Well: 1650 feet from the South line and 660 feet from the West line					
Ground Level Elev. 3741.6	Producing Formation Strawn		Pool Wildcat Strawn	Dedicated Acreage: 36.22 Acres	

1. Outline the acreage dedicated to the subject well by colored pencil or hatchure marks on the plat below.
2. If more than one lease is dedicated to the well, outline each and identify the ownership thereof (both as to working interest and royalty).
3. If more than one lease of different ownership is dedicated to the well, have the interests of all owners been consolidated by communitization, unitization, force-pooling, etc?

☐ Yes ☐ No If answer is "yes," type of consolidation _____

If answer is "no," list the owners and tract descriptions which have actually been consolidated. (Use reverse side of this form if necessary.) _____

No allowable will be assigned to the well until all interests have been consolidated (by communitization, unitization, forced-pooling, or otherwise) or until a non-standard unit, eliminating such interests, has been approved by the Commission.

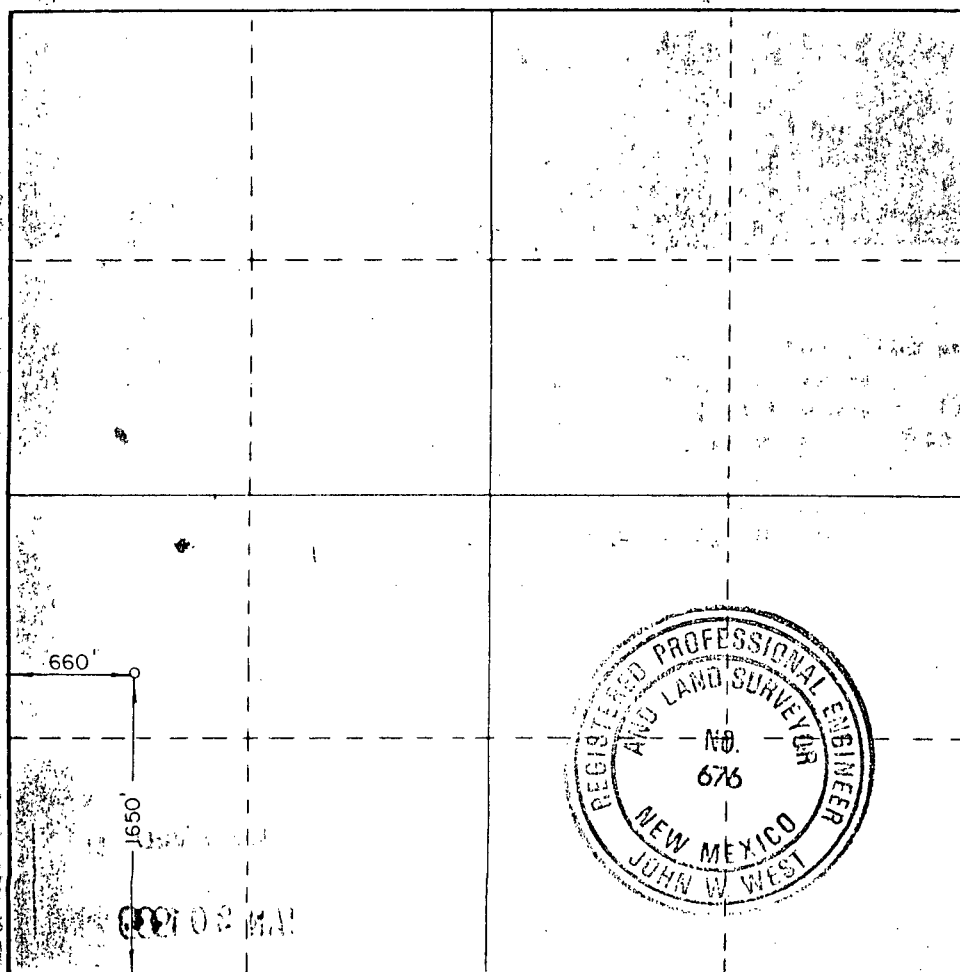

CERTIFICATION

I hereby certify that the information contained herein is true and complete to the best of my knowledge and belief.

Harold D. Justice
Name

Harold D. Justice
Position

V.P. Drilling & Production
Company

Siete Oil & Gas Corporation
Date

January 19, 1989

I hereby certify that the well location shown on this plat was plotted from field notes of actual surveys made by me or under my supervision, and that the same is true and correct to the best of my knowledge and belief.

Date Surveyed

January 17, 1989

Registered Professional Engineer and/or Land Surveyor

John W. West
Certificate No. **JOHN W. WEST, 676**
RONALD J. EIDSON, 3239

0 330 660 990 1320 1650 1980 2310 2640 2000 1500 1000 500 0

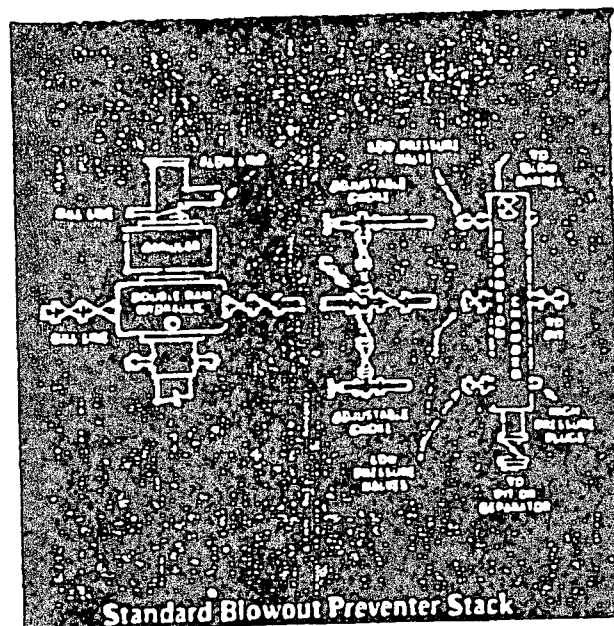

One hydraulic double 10" X 900 series.
 One Hydril 10" X 900 series.
 Choke manifold 4" X 900 series flanged
 connections. 4 valve accumulator closing
 unit.

RECEIVED

JAN 30 1960

HOODS OFFICE
 OCC