

# MERIDIAN OIL

OIL CONSERVATION DIVISION  
RECEIVED

May 4, 1990

'90 MAY 8 AM 10 16

Certified Mail

Mr. William LeMay  
New Mexico Oil Conservation Division  
Post Office Box 2088  
Santa Fe, New Mexico 87503

RE: Grenier #18  
1550'FSL, 1840'FEL  
Section 13, T-31-N, R-12-W  
San Juan County, New Mexico

Dear Mr. LeMay:

This is a request for administrative approval for a non-standard gas well location in the Basin Fruitland Pool.

Meridian Oil intends to plugback and recomplete the Grenier #18 well from the Pictured Cliffs pool to the Basin Fruitland Coal Pool. The current location of this well is 1550'FSL, 1840'FEL, Section 13, T-31-N, R-12-W, San Juan County, New Mexico. The well is considered non-standard due to the NE-SW dedicated pattern established for the Basin Fruitland Coal Pool. To comply with the New Mexico Oil Conservation Division rules, Meridian is submitting the following for your approval of this non-standard location:

1. C-102 plat showing location of the well;
2. Plat showing offset owners/operators;
3. Affidavit of notification of offset owners/operators;
4. Copy of Well Completion Log for original completion.

A copy of this application is being submitted to all offset owners/operators by certified mail with a request that they furnish your Santa Fe office with a Waiver of Objection, and return one copy to this office.

Sincerely yours,

  
Peggy Bradfield  
encl.

## WAIVER

\_\_\_\_\_ hereby waives objection to Meridian Oil Inc.'s application for a non-standard location for their Grenier #18 as proposed above.

By: \_\_\_\_\_ Date: \_\_\_\_\_

xc: Amoco Production Company

Grenier #18  
1550'FSL, 1840'FEL  
Section 13, T-31-N, R-12-W  
San Juan County, New Mexico,

I hereby certify that the following offset owners/operators have been mailed notification of our application for administrative approval for non-standard gas well location for the plugback and recompletion of the above well.

Amoco Production Company  
P.O. Box 800  
Denver, CO 80201

A handwritten signature in cursive script, reading "Peggy A. Bradfield".

Peggy Bradfield  
May 3, 1990

San Juan County  
State of New Mexico

My commission expires August 17, 1992

Submit to Appropriate  
District Office  
State Leases - 4 copies  
Fee Leases - 3 copies

State of New Mexico  
Energy, Minerals and Natural Resources Department

Form C-102  
Revised 1-1-89

OIL CONSERVATION DIVISION

P.O. Box 2088  
Santa Fe, New Mexico 87504-2088

DISTRICT I  
P.O. Box 1980, Hobbs, NM 88240

DISTRICT II  
P.O. Drawer DD, Artesia, NM 88210

DISTRICT III  
1000 Rio Brazos Rd., Aztec, NM 87410

WELL LOCATION AND ACREAGE DEDICATION PLAT

All Distances must be from the outer boundaries of the section

Operator Southland Royalty Company			Lease Grenier (SF-078115)		Well No. 18
Unit Letter J	Section 13	Township 31N	Range 12W	County San Juan	
Actual Footage Location of Well: 1550 feet from the South line and 1840 feet from the East line					
Ground level Elev. 6114'	Producing Formation Fruitland Coal		Pool Basin	Dedicated Acreage: 316.64 Acres	

1. Outline the acreage dedicated to the subject well by colored pencil or hatchure marks on the plat below.

2. If more than one lease is dedicated to the well, outline each and identify the ownership thereof (both as to working interest and royalty).

3. If more than one lease of different ownership is dedicated to the well, have the interest of all owners been consolidated by communitization, unitization, force-pooling, etc.?

☐ Yes ☐ No

If answer is "yes" type of consolidation

communitization agreement will be

If answer is "no" list the owners and tract descriptions which have actually been consolidated. (Use reverse side of this form if necessary.)

obtained

No allowable will be assigned to the well until all interests have been consolidated (by communitization, unitization, forced-pooling, or otherwise) or until a non-standard unit, eliminating such interest, has been approved by the Division.

Prepared from a plat  
dated 2-21-69  
by E. V. Echohawk

OPERATOR CERTIFICATION

I hereby certify that the information contained herein is true and complete to the best of my knowledge and belief.

Signature

Peggy Bradfield

Printed Name

Regulatory Affairs

Position

Southland Royalty Co

Company

Date

SURVEYOR CERTIFICATION

I hereby certify that the well location shown on this plat was plotted from field notes of actual surveys made by me or under my supervision, and that the same is true and correct to the best of my knowledge and belief.

Date Surveyed

Signature  
Professional Surveyor

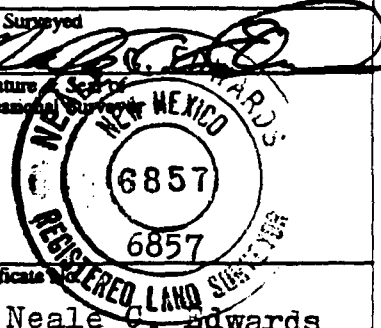

Certificate No.

Neale C. Edwards

0 330 660 990 1320 1650 1980 2310 2640 2000 1500 1000 500 0

SOUTHLAND ROYALTY CO

Well Name Grenier #18

Footage 1550' FSL; 1840' FEL

APPLICATION FOR NON-STANDARD LOCATION

County San Juan State New Mexico Section 13 Township 31N Range 12W

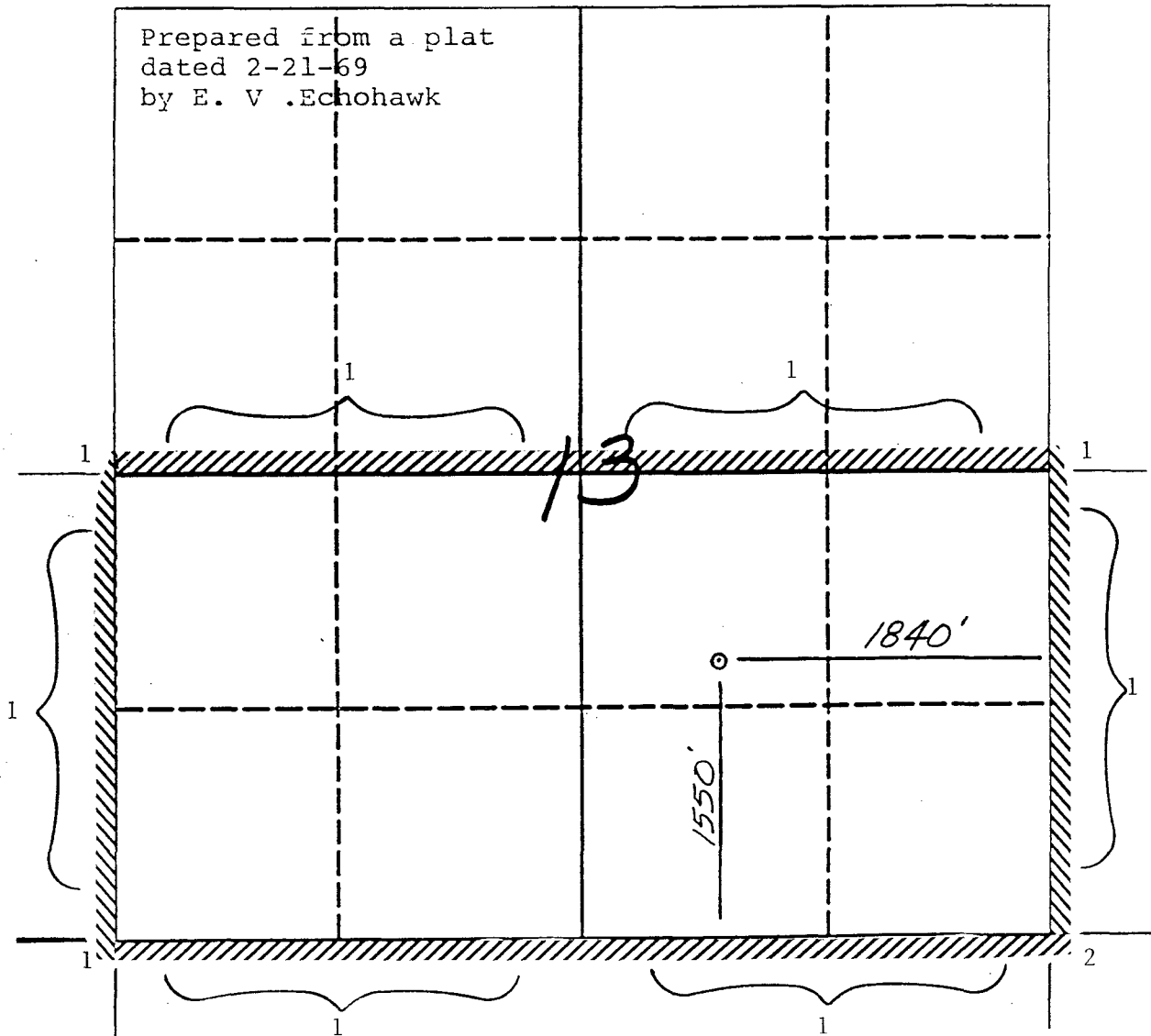

Remarks 1) Southland Royalty Company  
2) Amoco Production Company  
 \_\_\_\_\_  
 \_\_\_\_\_  
 \_\_\_\_\_  
 \_\_\_\_\_

UNITED STATES  
DEPARTMENT OF THE INTERIOR  
GEOLOGICAL SURVEY

SUBMIT IN DUPLICATE\*

(See other instructions on reverse side)

Form approved.  
Budget Bureau No. 42-R355.5.

## WELL COMPLETION OR RECOMPLETION REPORT AND LOG \*

1a. TYPE OF WELL: OIL WELL <input type="checkbox"/> GAS WELL <input checked="" type="checkbox"/> DRY <input type="checkbox"/> Other <input type="checkbox"/>				5. LEASE DESIGNATION AND SERIAL NO. <b>SF-078115</b>			
1b. TYPE OF COMPLETION: NEW WELL <input checked="" type="checkbox"/> WORK OVER <input type="checkbox"/> DEEP-EN <input type="checkbox"/> PLUG BACK <input type="checkbox"/> DIFF. RESVR. <input type="checkbox"/> Other <input type="checkbox"/>				6. IF INDIAN, ALLOTTEE OR TRIBE NAME			
2. NAME OF OPERATOR <b>Aztec Oil and Gas Company</b>				7. UNIT AGREEMENT NAME			
3. ADDRESS OF OPERATOR <b>Drawer 570, Farmington, New Mexico</b>				8. FARM OR LEASE NAME <b>Grenier</b>			
4. LOCATION OF WELL (Report location clearly and in accordance with any State requirements)* At surface <b>1550 FSL &amp; 1840 FEL, Sec. 13-31N-12W</b> At top prod. interval reported below At total depth				9. WELL NO. <b>18</b>			
14. PERMIT NO.				10. FIELD AND POOL, OR WILDCAT <b>Aztec Pictured Cliff</b>			
DATE ISSUED				11. SEC., T., R., M., OR BLOCK AND SURVEY OR AREA <b>Sec. 13-31N-12W</b>			
15. DATE SPUDDED <b>3-22-69</b>				12. COUNTY OR PARISH <b>San Juan</b>			
16. DATE T.D. REACHED <b>3-24-69</b>				13. STATE <b>New Mexico</b>			
17. DATE COMPL. (Ready to prod.) <b>4-15-69</b>				18. ELEVATIONS (DF, RKB, RT, GR, ETC.)* <b>6114 Gr</b>			
19. ELEV. CASINGHEAD <b>6115</b>				20. TOTAL DEPTH, MD & TVD <b>2790</b>			
21. PLUG, BACK T.D., MD & TVD <b>2790</b>				22. IF MULTIPLE COMPL. HOW MANY*			
23. INTERVALS DRILLED BY				24. PRODUCING INTERVAL(S), OF THIS COMPLETION—TOP, BOTTOM, NAME (MD AND TVD)* <b>2682 - 2648</b>			
25. WAS DIRECTIONAL SURVEY MADE				26. TYPE ELECTRIC AND OTHER LOGS RUN <b>Induction Electric</b>			
27. WAS WELL CORED				28. CASING RECORD (Report all strings set in well)			
CASINO SIZE		WEIGHT, LB./FT.	DEPTH SET (MD)	HOLE SIZE	CEMENTING RECORD	AMOUNT PULLED	
8-5/8"	24#	113'	12-1/4"	50 sx			
4-1/2"	9.5#	2790'	6-3/4"	250 sx			
29. LINER RECORD				30. TUBING RECORD			
SIZE	TOP (MD)	BOTTOM (MD)	SACKS CEMENT*	SCREEN (MD)	SIZE	DEPTH SET (MD)	PACKER SET (MD)
					1"	2667'	
31. PERFORATION RECORD (Interval, size and number) <b>2682-72, 2654-48 4 SPF</b>				32. ACID, SHOT, FRACTURE, CEMENT SQUEEZE, ETC.			
				DEPTH INTERVAL (MD)		AMOUNT AND KIND OF MATERIAL USED	
				2648-2682		35,196 gal water	
						25,000# 10/20 sand	
						dropped 15 balls	
33.* PRODUCTION							
DATE FIRST PRODUCTION		PRODUCTION METHOD (Flowing, gas lift, pumping—size and type of pump) <b>flowing</b>			WELL STATUS: (Producing or shut-in) <b>shut-in</b>		
DATE OF TEST	HOURS TESTED	CHOKE SIZE	PROD'N. FOR TEST PERIOD	OIL—BBL.	GAS—MCF.	WATER—BBL.	GAS-OIL RATIO
4-21-69	3 hr	3/4"					
FLOW. TUBING PRESS.	CASING PRESSURE	CALCULATED 24-HOUR RATE	OIL—BBL.	GAS—MCF.	WATER—BBL.	OIL GRAVITY-API (CORR.)	
63	59			840			
34. DISPOSITION OF GAS (Sold, used for fuel, vented, etc.) <b>sold</b>						TEST WITNESSED BY	
35. LIST OF ATTACHMENTS							
36. I hereby certify that the foregoing and attached information is complete and correct as determined from all available records							
SIGNED <b>Joe C. Salazar</b>		TITLE <b>District Superintendent</b>				DATE <b>4-22-69</b>	

\*(See Instructions and Spaces for Additional Data on Reverse Side)

MERIDIAN OIL

RECEIVED  
OIL CONSERVATION DIVISION

'90 JUN 18 AM 9 31

May 4, 1990

Certified Mail

Mr. William LeMay  
New Mexico Oil Conservation Division  
Post Office Box 2088  
Santa Fe, New Mexico 87503

RE: Grenier #18  
1550'FSL, 1840'FEL  
Section 13, T-31-N, R-12-W  
San Juan County, New Mexico

Dear Mr. LeMay:

This is a request for administrative approval for a non-standard gas well location in the Basin Fruitland Pool.

Meridian Oil intends to plugback and recomplete the Grenier #18 well from the Pictured Cliffs pool to the Basin Fruitland Coal Pool. The current location of this well is 1550'FSL, 1840'FEL, Section 13, T-31-N, R-12-W, San Juan County, New Mexico. The well is considered non-standard due to the NE-SW dedicated pattern established for the Basin Fruitland Coal Pool. To comply with the New Mexico Oil Conservation Division rules, Meridian is submitting the following for your approval of this non-standard location:

1. C-102 plat showing location of the well;
2. Plat showing offset owners/operators;
3. Affidavit of notification of offset owners/operators;
4. Copy of Well Completion Log for original completion.

A copy of this application is being submitted to all offset owners/operators by certified mail with a request that they furnish your Santa Fe office with a Waiver of Objection, and return one copy to this office.

Sincerely yours,

  
Peggy Bradfield  
encl.

WAIVER

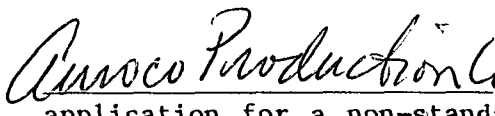
 hereby waives objection to Meridian Oil Inc.'s application for a non-standard location for their Grenier #18 as proposed above.

By:  Date: 6-14-90

xc: Amoco Production Company