

AWB



STATE OF NEW MEXICO  
ENERGY, MINERALS AND NATURAL RESOURCES DEPARTMENT  
OIL CONSERVATION DIVISION  
HOBBS DISTRICT OFFICE

GARREY CARRUTHERS  
GOVERNOR

August 23, 1990

POST OFFICE BOX 1980  
HOBBS, NEW MEXICO 88241-1980  
(505) 393-6161

Chevron USA Inc.  
Box 670  
Hobbs, NM 88240

Attn: M. E. Akins  
Al Bohling

Re: R. R. Bell NCT-F Well #3  
Unit F, Sec. 36, T20S, R36E  
Eumont Gas

Gentlemen:

1820  
Your intention to drill the above-referenced well has been received. This well location, 1520/N & ~~1920~~1820/W, is unorthodox due to the fact that it is nearer than 330 feet to a quarter/quarter section.

If you have not already done so, please make application for approval of this unorthodox location and simultaneous dedication of this well to the established 320-acre proration unit with your R.R. Bell NCT-F Well #2.

Very truly yours,

OIL CONSERVATION DIVISION

A handwritten signature in cursive script, appearing to read "Jerry Sexton".  
Jerry Sexton  
Supervisor, District I

ed

Submit to Appropriate  
District Office  
State Lease - 6 copies  
Fee Lease - 5 copies

State of New Mexico  
Energy, Minerals and Natural Resources Department

Form C-101  
Revised 1-1-89

OIL CONSERVATION DIVISION

DISTRICT I  
P.O. Box 1980, Hobbs, NM 88240

DISTRICT II  
P.O. Drawer DD, Artesia, NM 88210

DISTRICT III  
1000 Rio Brazos Rd., Aztec, NM 87410

P.O. Box 2088  
Santa Fe, New Mexico 87504-2088

API NO. (assigned by OCD on New Wells)

5. Indicate Type of Lease

STATE ☒

FEE ☐

6. State Oil & Gas Lease No.

APPLICATION FOR PERMIT TO DRILL, DEEPEN, OR PLUG BACK

1a. Type of Work:

DRILL ☒

RE-ENTER ☐

DEEPEN ☐

PLUG BACK ☐

b. Type of Well:

OIL  
WELL ☐

GAS  
WELL ☒

OTHER ☐

SINGLE  
ZONE ☐

MULTIPLE  
ZONE ☐

7. Lease Name or Unit Agreement Name

R.R. Bell NCT-F

2. Name of Operator

Chevron U.S.A. Inc.

8. Well No.

3

3. Address of Operator

P.O. Box 670, Hobbs, NM 88240

9. Pool name or Wildcat

Eumont/Queen

4. Well Location

Unit Letter : 1520 Feet From The North Line and 1820 Feet From The West Line

Section 36 Township 20 Range 36 NMPM Lea County

10. Proposed Depth

3750'

11. Formation

Queen

12. Rotary or C.T.

Rotary

13. Elevations (Show whether DF, RT, GR, etc.)

14. Kind & Status Plug. Bond  
blanket

15. Drilling Contractor  
Unknown

16. Approx. Date Work will start  
10-3-90

17.

PROPOSED CASING AND CEMENT PROGRAM

SIZE OF HOLE	SIZE OF CASING	WEIGHT PER FOOT	SETTING DEPTH	SACKS OF CEMENT	EST. TOP
11"	8 5/8"	24#	1250'	350 sx	Circ.
7 7/8"	5 1/2"	15.5#	3750'	350 sx	Circ.

BOP EQUIPMENT

3000 PSI WP SEE ATTACHED CHEVRON CLASS III BOP DRAWING

MUD PROGRAM:

0-1250' FW SPUD MUD 9.0 PPG

1250-3750' BW STARCH 10#

IN ABOVE SPACE DESCRIBE PROPOSED PROGRAM: IF PROPOSAL IS TO DEEPEN OR PLUG BACK, GIVE DATA ON PRESENT PRODUCTIVE ZONE AND PROPOSED NEW PRODUCTIVE ZONE. GIVE BLOWOUT PREVENTER PROGRAM, IF ANY.

I hereby certify that the information above is true and complete to the best of my knowledge and belief.

SIGNATURE M. E. Akins 8/20/90 TITLE Staff Drlg. Engr. DATE 8-20-90

TYPE OR PRINT NAME M.E. Akins

TELEPHONE NO. 393-4121

(This space for State Use)

APPROVED BY \_\_\_\_\_ TITLE \_\_\_\_\_ DATE \_\_\_\_\_

CONDITIONS OF APPROVAL, IF ANY:

NEW MEXICO  
OIL CONSERVATION COMMISSION

Gas Well Plat

Date 8-12-55

Gulf Oil Corporation  
Operator

R. R. Bell #7  
Lease

2  
Well No.

Name of Producing Formation Queen

Pool Emont Gas

Request for Non-Standard Gas  
Proration Unit submitted  
August 12, 1955

No. Acres Dedicated to the Well 320

SECTION 36 TOWNSHIP -20-S RANGE -36-E

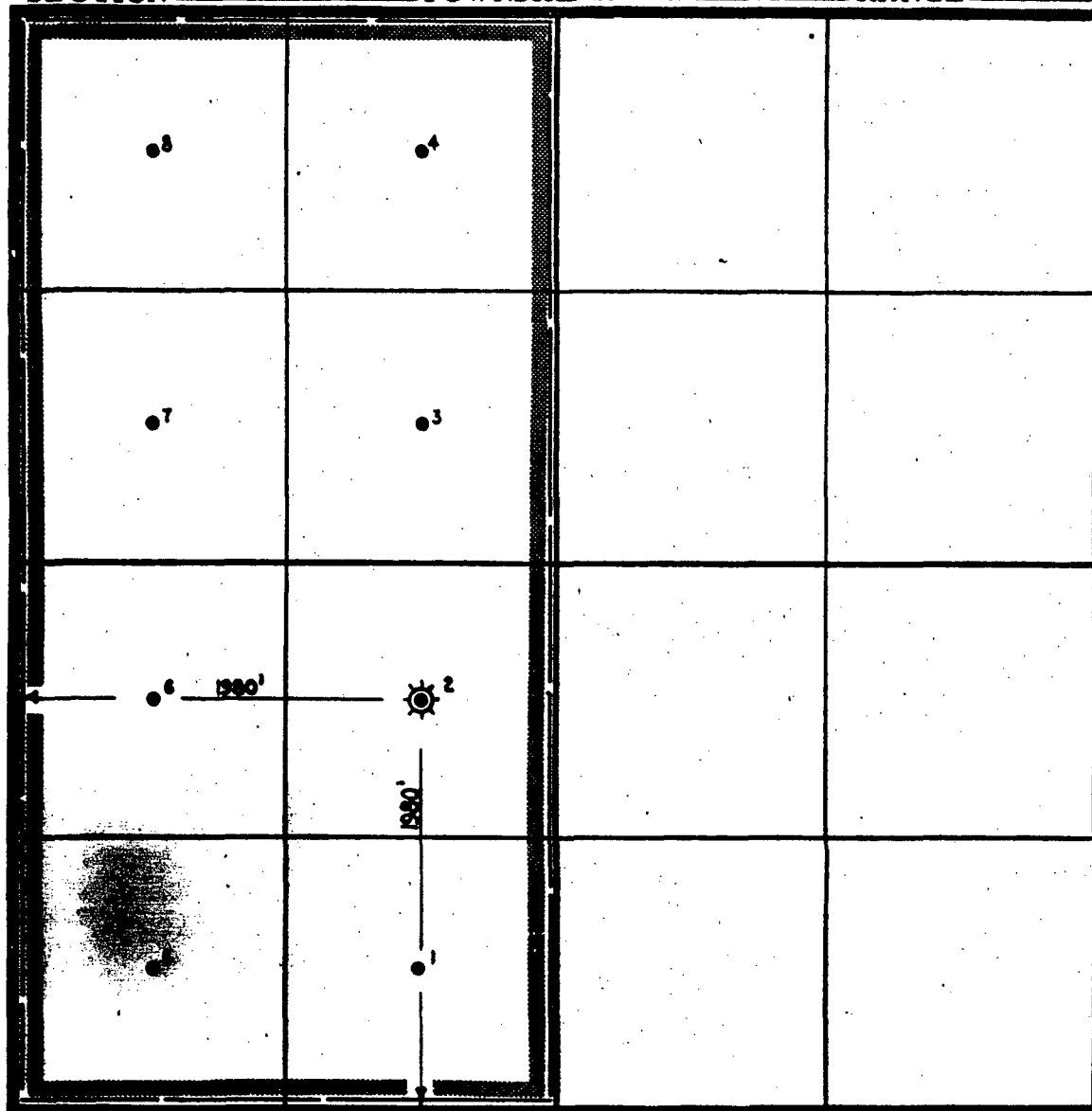

I hereby certify that the information given above is true and complete  
to the best of my knowledge.

- - Oil Well
- ☼ - Gas Well (Dual)
- - Lease Line
- ▬ - Acreage Dedicated

BY  
Name T. W. Rhoads T. W. Rhoads  
Position Division Gas Engineer  
Representing Gulf Oil Corporation  
Address P. O. Box 1290, Fort Worth, Texas

(over)

To Michael Stogner - OCD Hearing Examiner October 4, 1990

From Alan Bohling - Proration Engineer, Chevron

Subject: R.R. Bell (NCT-F) Well No. 3 Our File:

Administrative NSL Application  
and Simultaneous Dedication  
(Dated October 1, 1990).

Your File:

90 OCT 11 AM 8:55  
OIL CONSERVATION DIVISION  
RECEIVED

As I stated on a "buck slip" attached to our application, I am now sending you the attached Surveyor's Plat illustrating how our original (standard) location was moved to our proposed (non-standard) location to avoid buried pipelines and a power line. The new proposed unorthodox location, as mentioned in our application, is 1820' FEL and 1520' FNL, Section 36, T-20-S, R-36-E, NMPPM Lea County, New Mexico.

Should you have any further questions or need additional information, please contact me at (915) 687-7246.

Sincerely yours,

Alan W. Bohling

Proration Engineer

cc: NMOC - Hobbs

Submit to Appropriate  
District Office  
State Lease - 4 copies  
Fee Lease - 3 copies

State of New Mexico  
Energy, Minerals and Natural Resources Department

Form C-102  
Revised 1-1-89

OIL CONSERVATION DIVISION

P.O. Box 2088  
Santa Fe, New Mexico 87504-2088

DISTRICT I  
P.O. Box 1980, Hobbs, NM 88240

DISTRICT II  
P.O. Drawer DD, Artesia, NM 88210

DISTRICT III  
1000 Rio Brazos Rd., Aztec, NM 87410

WELL LOCATION AND ACREAGE DEDICATION PLAT

All Distances must be from the outer boundaries of the section

Operator CHEVRON USA INC			Lease R.R. BELL NCT-F		Well No. 3
Unit Letter F	Section 36	Township 20 SOUTH	Range 36 EAST	County NMPM	LEA
Actual Footage Location of Well: 1520 feet from the NORTH line and 1820 feet from the WEST line					
Ground level Elev. 3546.4'	Producing Formation Queen		Pool Eumont	Dedicated Acreage: 320 Acres	

1. Outline the acreage dedicated to the subject well by colored pencil or hachure marks on the plat below.
2. If more than one lease is dedicated to the well, outline each and identify the ownership thereof (both as to working interest and royalty).
3. If more than one lease of different ownership is dedicated to the well, have the interest of all owners been consolidated by communitization, unitization, force-pooling, etc.  
☐ Yes ☐ No If answer is "yes" type of consolidation \_\_\_\_\_  
If answer is "no" list the owners and tract descriptions which have actually been consolidated. (Use reverse side of this form if necessary).  
No allowable will be assigned to the well until all interests have been consolidated (by communitization, unitization, forced-pooling, or otherwise) or until a non-standard unit, eliminating such interest, has been approved by the Division.

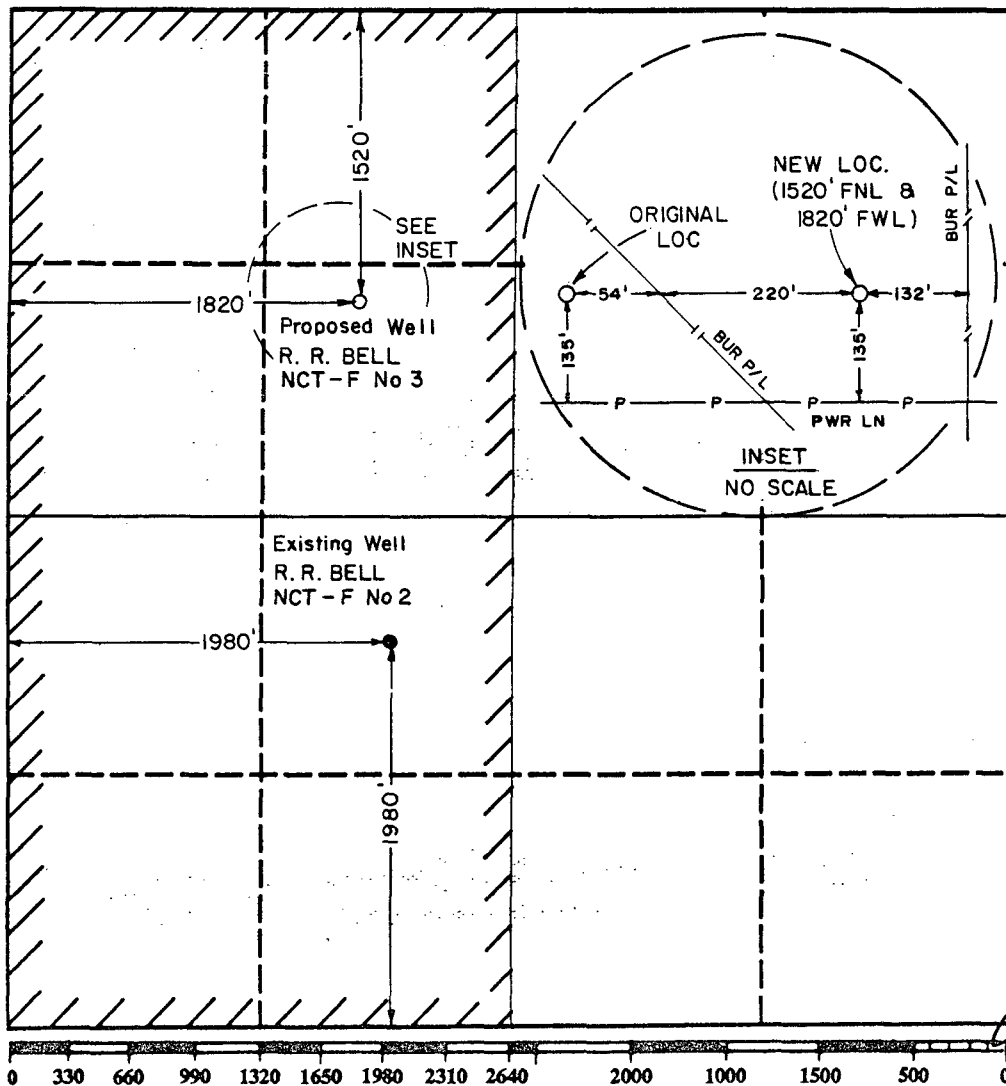

OPERATOR CERTIFICATION

I hereby certify that the information contained herein in true and complete to the best of my knowledge and belief.

Signature

Printed Name

M.E. Akins

Position

Staff Drlg. Engr.

Company

Chevron USA Inc

Date

SURVEYOR CERTIFICATION

I hereby certify that the well location shown on this plat was plotted from field notes of actual surveys made by me or under my supervision, and that the same is true and correct to the best of my knowledge and belief.

Date Surveyed

August 15, 1990

Signature & Seal of Professional Surveyor

JOHN W. WEST  
676  
3239