

MERIDIAN OIL

September 25, 1990

Federal Express

Mr. William LeMay
New Mexico Oil Conservation Division
310 Old Santa Fe Trail
Santa Fe, New Mexico 87503

RE: San Juan 20A
850'FNL, 1100'FWL
Section 35, T-29-N, R-09-W
San Juan County, New Mexico

Dear Mr. LeMay:

This is a request for administrative approval for a non-standard gas well location in the Basin Fruitland Pool.

Meridian Oil intends to recomplete the San Juan 20A well in the Basin Fruitland Coal pool and dual with the existing Mesa Verde formation. The current location of this well is 850'FNL, 1100'FWL, Section 35, T-29-N, R-09-W, San Juan County, New Mexico. The well is considered non-standard due to the NE-SW dedicated pattern established for the Basin Fruitland Coal Pool. To comply with the New Mexico Oil Conservation Division rules, Meridian is submitting the following for your approval of this non-standard location:

1. C-102 plat showing location of the well;
2. Plat showing offset owners/operators;
3. Affidavit of notification of offset owners/operators;
4. Copy of Well Completion Log for original completion.

A copy of this application is being submitted to all offset owners/operators by certified mail with a request that they furnish your Santa Fe office with a Waiver of Objection, and return one copy to this office.

Sincerely yours,



Peggy Bradfield
encl.

WAIVER

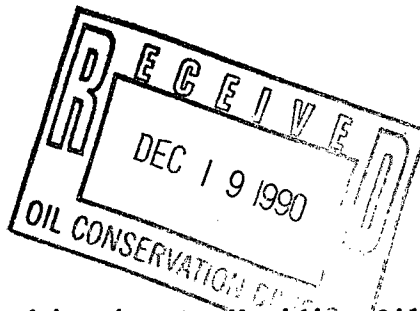

_____ hereby waives objection to Meridian Oil Inc.'s application for a non-standard location for their San Juan 20A as proposed above.

By: _____ Date: _____

xc: Meridian Oil Inc.
Amoco Production Company
DJ Simmons Co.

Meridian Oil Inc., 3535 East 30th St., P.O. Box 4289, Farmington, New Mexico 87499-4289, Telephone 505-326-9700

San Juan 20A
850'FNL, 1100'FWL
Section 35, T-29-N, R-09-W
San Juan County, New Mexico

I hereby certify that the following offset owners/operators have been notified by certified mail of our application for administrative approval for non-standard gas well location for the plugback and recompletion of the above well.

Meridian Oil Inc.
P.O. Box 4289
Farmington, NM 87499

Amoco Production Co.
P.O. Box 800
Denver, CO 80201

DJ Simmons Co.
3005 Northridge Drive
Farmington, NM 87401



Peggy Bradfield
September 25, 1990

San Juan County
State of New Mexico

My commission expires August 17, 1992

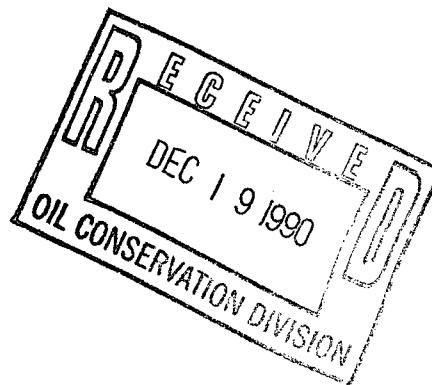

MERIDIAN OIL INC

Well Name San Juan 20A

Footage 850' FNL; 1100' FWL

APPLICATION FOR NON-STANDARD LOCATION

County San Juan State New Mexico Section 35 Township 29N Range 9W

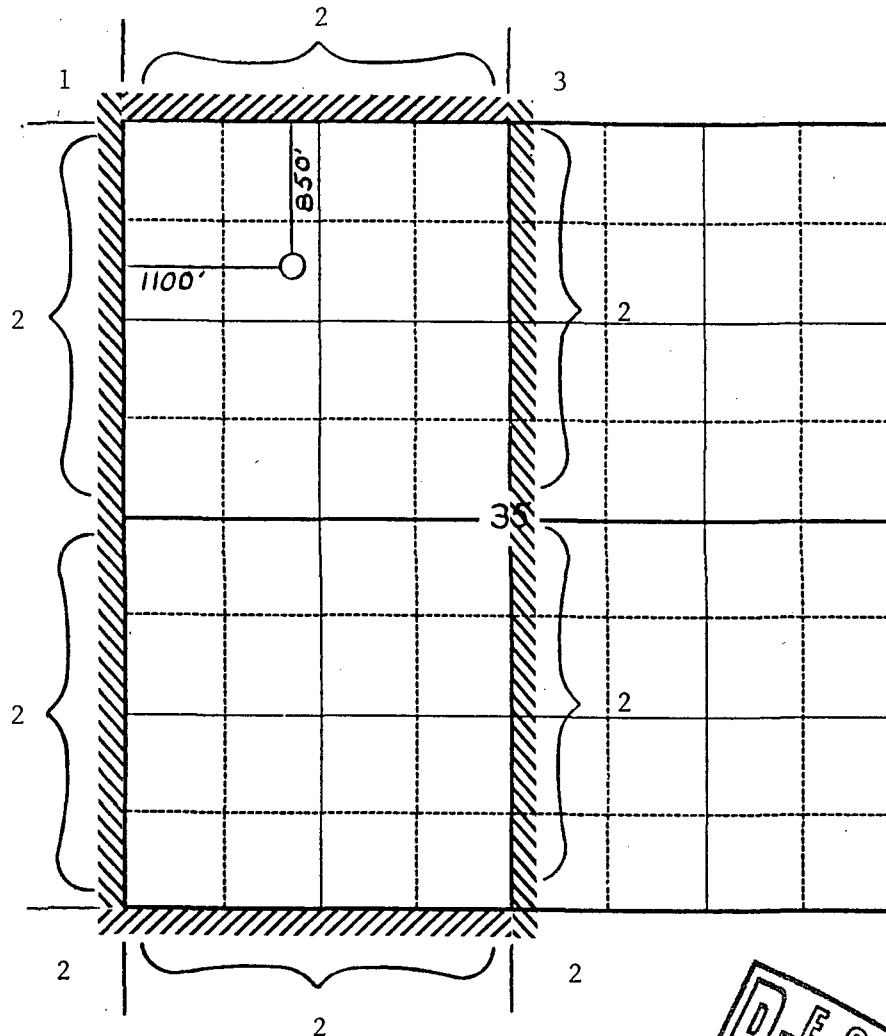

Remarks (1) Meridian Oil Inc.

(2) Amoco Production Company

(3) DJ Simmons Co.

3005 Northridge Drive

Farmington, NM 87401

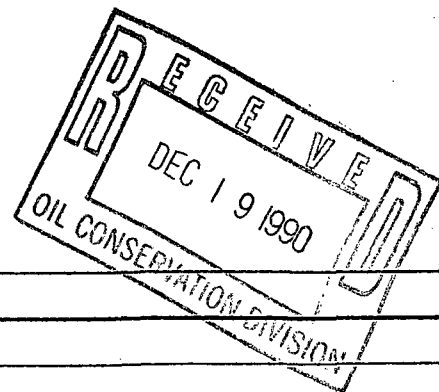

UNITED STATES
DEPARTMENT OF THE INTERIOR
GEOLOGICAL SURVEY

SUBMIT IN DUPLICATE

(See other in-
structions on
reverse side)Form approved
Budget Bureau No. 42-R355.5.

WELL COMPLETION OR RECOMPLETION REPORT AND LOG *

1a. TYPE OF WELL: OIL WELL <input type="checkbox"/> GAS WELL <input checked="" type="checkbox"/> DRY <input type="checkbox"/> Other _____		5. LEASE DESIGNATION AND SERIAL NO. NM 029146	
b. TYPE OF COMPLETION: NEW WELL <input checked="" type="checkbox"/> WORK OVER <input type="checkbox"/> DEEP-EN <input type="checkbox"/> PLUG BACK <input type="checkbox"/> DIFF. RESVR. <input type="checkbox"/> Other _____		6. IF INDIAN, ALLOTTEE OR TRIBE NAME	
2. NAME OF OPERATOR EL PASO NATURAL GAS CO.		7. UNIT AGREEMENT NAME	
3. ADDRESS OF OPERATOR BOX 990, FARMINGTON, NEW MEXICO		8. FARM OR LEASE NAME SAN JUAN	
4. LOCATION OF WELL (Report location clearly and in accordance with any State requirements)* At surface 850'N, 1100'W At top prod. interval reported below At total depth		9. WELL NO. 20A	
14. PERMIT NO.		DATE ISSUED	
15. DATE SPUDDED		16. DATE T.D. REACHED	
17. DATE COMPL. (Ready to prod.)		18. ELEVATIONS (DF, REB, RT, GR, ETC.)*	
19. ELEV. CASINGHEAD		20. TOTAL DEPTH, MD & TVD	
21. PLUG, BACK T.D., MD & TVD		22. IF MULTIPLE COMPL., HOW MANY*	
23. INTERVALS DRILLED BY		ROTARY TOOLS	
24. PRODUCING INTERVAL(S), OF THIS COMPLETION—TOP, BOTTOM, NAME (MD AND TVD)* 3640-4713 (MV)		CABLE TOOLS	
25. WAS DIRECTIONAL SURVEY MADE No		26. TYPE ELECTRIC AND OTHER LOGS RUN Gamma - Ind.; CDL-GR; Temp. Survey	
27. WAS WELL CORED No		28. CASING RECORD (Report all strings set in well)	
CASING SIZE		WEIGHT, LB./FT.	
DEPTH SET (MD)		HOLE SIZE	
CEMENTING RECORD		AMOUNT PULLED	
9 5/8"		32.3#	
205'		13 3/4"	
2412'		8 3/4"	
224 cf.		317 cf.	
29. LINER RECORD		30. TUBING RECORD	
SIZE		TOP (MD)	
BOTTOM (MD)		SACKS CEMENT*	
SCREEN (MD)		SIZE	
DEPTH SET (MD)		PACKER SET (MD)	
4 1/2"		2263'	
4794'		442 cf.	
2 3/8"		4712'	
31. PERFORATION RECORD (Interval, size and number)		32. ACID, SHOT, FRACTURE, CEMENT SQUEEZE, ETC.	
3640, 3646, 3721, 3728, 3780, 3785, 3790, 4122, 4128, 4134, 4168, 4174, 4254, 4259' w/1 SPZ. 4344, 4348, 4352, 4356, 4360, 4365, 4377, 4382, 4396, 4400, 4420, 4451, 4456, 4515, 4523, 4566, 4580, 4583, 4612, 4632, 4642, 4668, 4692, 4713' w/1 SPZ.		DEPTH INTERVAL (MD)	
AMOUNT AND KIND OF MATERIAL USED		3640-4259'	
42,000#sand; 90,300 gal. water		4344-4713'	
75,000#sand; 156,300 gal. water		33. PRODUCTION	
DATE FIRST PRODUCTION		PRODUCTION METHOD (Flowing, gas lift, pumping—size and type of pump)	
WELL STATUS (Producing or shut-in)		After Frac Gauge - 1023 MCE/D	
DATE OF TEST		HOURS TESTED	
CHOKE SIZE		PROD'N. FOR TEST PERIOD	
OIL—BBL.		GAS—MCF.	
WATER—BBL.		GAS—MCF.	
OIL GRAVITY-API (CORR.)		WATER—BBL.	
CASING PRESSURE		CALCULATED 24-HOUR RATE	
SI 750		SI 762	
34. DISPOSITION OF GAS (Sold, used for fuel, vented, etc.)		TEST WITNESSED BY Tom McAndrews	
35. LIST OF ATTACHMENTS		36. I hereby certify that the foregoing and attached information is complete and correct as determined from all available records	
SIGNED <u>N. G. Buice</u>		TITLE <u>Drilling Clerk</u>	
DATE <u>3/7/78</u>			

*(See Instructions and Spaces for Additional Data on Reverse Side)

OPERATOR

NEW MEXICO OIL CONSERVATION COMMISSION
WELL LOCATION AND ACREAGE DEDICATION PLAT

Supersedes
Effective 1-1-55

All distances must be from the outer boundaries of the Section.

Operator EL PASO NATURAL GAS COMPANY			Lease SAN JUAN		(NM-029146)		Well No. 100
Unit Letter D	Section 35	Township 29-N	Range 9-W	County SAN JUAN			
Actual Footage Location of Well: 850 feet from the NORTH line and 1100 feet from the WEST line							
Ground Level Elev. 5656	Producing Formation		Pool		Dedicated Acreage 306.12		

1. Outline the acreage dedicated to the subject well by colored pencil or hachure marks on the plat below.
2. If more than one lease is dedicated to the well, outline each and identify the ownership thereof (both as to working interest and royalty).
3. If more than one lease of different ownership is dedicated to the well, have the interests of all owners been consolidated by communitization, unitization, force-pooling, etc?

☐ Yes ☐ No If answer is "yes," type of consolidation _____

If answer is "no," list the owners and tract descriptions which have actually been consolidated. (Use reverse side of this form if necessary.) _____

No allowable will be assigned to the well until all interests have been consolidated (by communitization, unitization, forced-pooling, or otherwise) or until a non-standard unit, eliminating such interests, has been approved by the Commission.

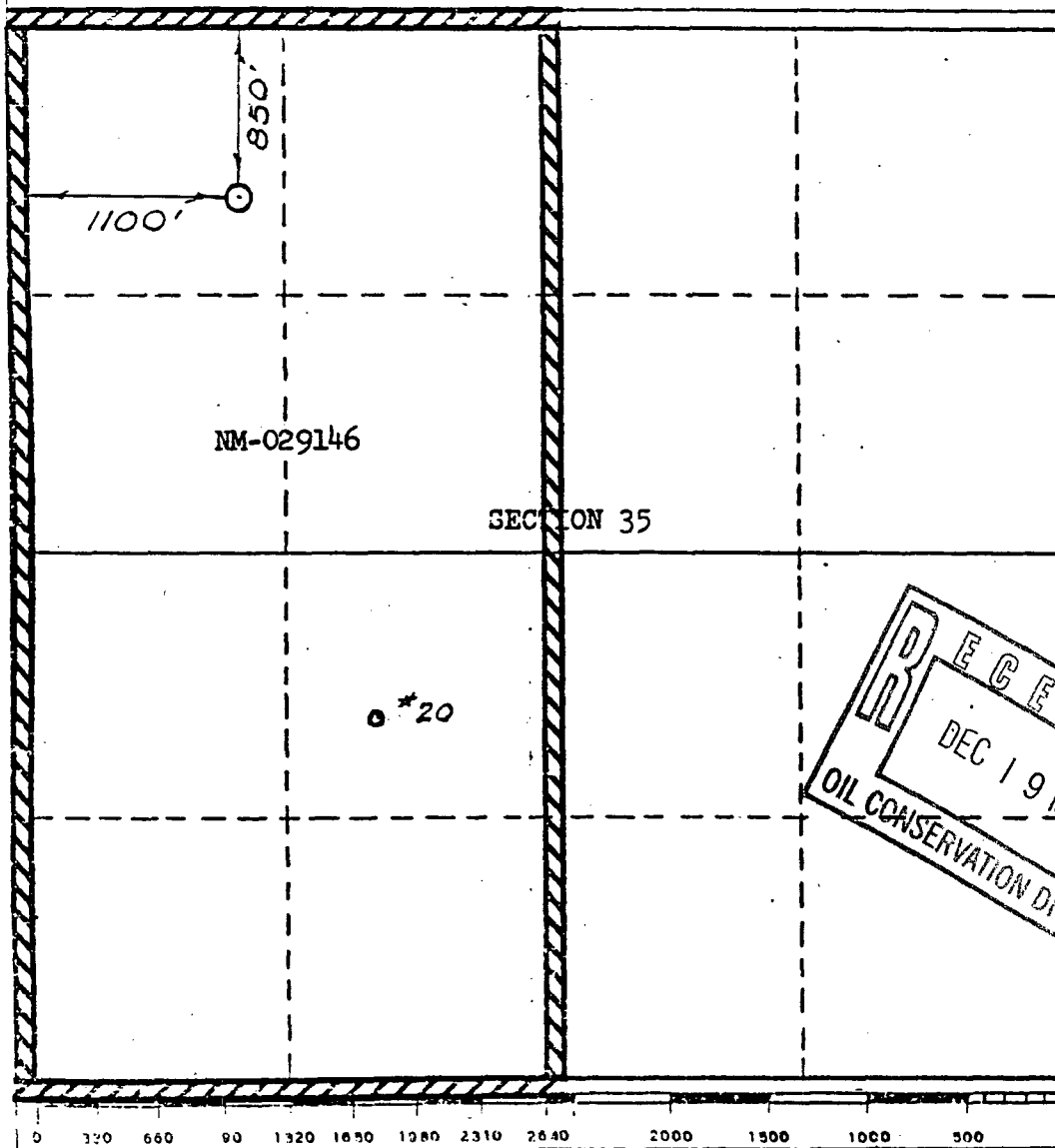

CERTIFICATION

I hereby certify that the information contained herein is true and correct to the best of my knowledge and belief.

Name _____
Position _____
El Paso Natural Gas Co.
Company _____
Date _____

I hereby certify that the well location shown on this plat was plotted from field notes of actual surveys made by me or under my supervision, and the same is true and correct to the best of my knowledge and belief.

Date Surveyed **AUGUST 28, 1977**
Registered Professional Engineer and/or Land Surveyor

Certificate No. **1760**



Heard

STATE OF NEW MEXICO

ENERGY AND MINERALS DEPARTMENT

OIL CONSERVATION DIVISION

AZTEC DISTRICT OFFICE

OIL CONSERVATION DIVISION
RECEIVED

GARREY CARRUTHERS
GOVERNOR

1000 MILLER AVENUE
AZTEC, NEW MEXICO 87410
(505) 334-0170

'90 NOV 28 AM 9 24

Date: 11-26-90

Attn: M. Fogner

Oil Conservation Division
P.O. Box 2088
Santa Fe, NM 87504-2088

Re: Proposed HC _____
Proposed DHC _____
Proposed NSL X _____
Proposed SWD _____
Proposed WFX _____
Proposed PMX _____

Case No. 10150

Gentlemen:

I have examined the application dated 10-27-90
for the ~~Midland Inc.~~ *Sunoco Inc.* 2018
Operator Lease & Well No.

D-35-29N-7W and my recommendations are as follows:
Unit, S-T-R

Approved

Yours truly,

Ernest Bush



OIL CONSERVATION DIVISION
RECEIVED

90 OCT 18 AM 9 35

Amoco Production Company

Denver Region
1670 Broadway
P.O. Box 800
Denver, Colorado 80201
303-830-4040

October 12, 1990

Meridian Oil Inc.
3535 East 30th St.
Farmington, New Mexico 87499

File CAW-222-986.511

San Juan 20A
850' FNL, 1100' FWL, Section 35, T29N-R9W
and
Cain #3R
1610' FSL, 810' FEL, Section 30, T29N-R9W
San Juan County, New Mexico

Amoco Production Company objects to your request for unorthodox well locations for the above-captioned wells. These wells are located in the wrong quarter section and as such could potentially violate our correlative rights.

We recognize the economic advantage of recompleting existing wells as opposed to drilling new wells and have in the past not objected to numerous Meridian applications. In this instance, your proposed recompletions are offset on two or more sides by Amoco acreage which could be affected. We would prefer the recompletion or drilling of a well located in the correct quarter section.

If you would like to discuss this matter further, please contact Mr. Kevin Kilstrom or myself.

Sincerely,

J. W. Hawkins

cc: T. D. Autry
M. E. Cuba
E. L. Nitcher

✓ Mr. William LeMay
NMOCD, 310 Old Santa Fe Trail
Santa Fe, NM 87503

MERIDIAN OIL CONSERVATION DIVISION
RECEIVED

September 25, 1990

'90 OCT 10 AM 9 03

Federal Express

Mr. William LeMay
New Mexico Oil Conservation Division
310 Old Santa Fe Trail
Santa Fe, New Mexico 87503

RE: San Juan 20A
850'FNL, 1100'FWL
Section 35, T-29-N, R-09-W
San Juan County, New Mexico

Dear Mr. LeMay:

This is a request for administrative approval for a non-standard gas well location in the Basin Fruitland Pool.

Meridian Oil intends to recompleate the San Juan 20A well in the Basin Fruitland Coal pool and dual with the existing Mesa Verde formation. The current location of this well is 850'FNL, 1100'FWL, Section 35, T-29-N, R-09-W, San Juan County, New Mexico. The well is considered non-standard due to the NE-SW dedicated pattern established for the Basin Fruitland Coal Pool. To comply with the New Mexico Oil Conservation Division rules, Meridian is submitting the following for your approval of this non-standard location:

1. C-102 plat showing location of the well;
2. Plat showing offset owners/operators;
3. Affidavit of notification of offset owners/operators;
4. Copy of Well Completion Log for original completion.

A copy of this application is being submitted to all offset owners/operators by certified mail with a request that they furnish your Santa Fe office with a Waiver of Objection, and return one copy to this office.

Sincerely yours,



Peggy Bradfield
encl.

WAIVER

D.J. Simmons Co. hereby waives objection to Meridian Oil Inc.'s application for a non-standard location for their San Juan 20A as proposed above.

By:  Date: 10-5-90

xc: Meridian Oil Inc.
Amoco Production Company
DJ Simmons Co.

Meridian Oil Inc., 3535 East 30th St., P.O. Box 4289, Farmington, New Mexico 87499-4289, Telephone 505-326-9700