

UNITED STATES
DEPARTMENT OF THE INTERIOR
BUREAU OF LAND MANAGEMENT

SUBMIT IN DUPLICATE*

(See other instructions on reverse side)

Form approved.
Budget Bureau No. 1004-0137
Expires August 31, 1985

CONSE...ION DIVISION

WELL COMPLETION OR RECOMPLETION REPORT AND LOG *

1. TYPE OF WELL Oil 51
2. TYPE OF COMPLETION:
NEW WELL ☒ WORK OVER ☐ DEEPEN ☐ PLUG BACK ☐ DIFF. SERV. ☐ Other Oil 51

2. NAME OF OPERATOR
Incline Reserves, Inc.

3. ADDRESS OF OPERATOR
1603 SW 37th St., Topeka, KS 66611 913-267-5033

4. LOCATION OF WELL (Report location clearly and in accordance with any State requirements)*
At surface 1450' FSL, 2250' FWL (NESW)
At top prod. interval reported below Same
At total depth SAME

14. PERMIT NO. 30-045-28475 DATE ISSUED

5. LEASE DESIGNATION AND SERIAL NO.
NM 04202
6. IF INDIAN, ALLOTTEE OR TRIBE NAME
7. UNIT AGREEMENT NAME
8. FARM OR LEASE NAME
Federal 11
9. WELL NO.
#2

10. FIELD AND POOL, OR WILDCAT
Basin Fruitland Coal
11. SEC., T., R., M., OR BLOCK AND SURVEY OR AREA
11, T28N, R9W, NMPM

12. COUNTY OR PARISH
San Juan 13. STATE
NM

15. DATE SPUDDED 12/09/90 16. DATE T.D. REACHED 12/14/90 17. DATE COMPL. (Ready to prod.) 12/29/90 18. ELEVATIONS (DF, RKB, RT, OR, ETC.)* 5775' GR 19. ELEV. CASINGHEAD 5776"

20. TOTAL DEPTH, MD & TVD 2310' 21. PLUG, BACK T.D., MD & TVD 2300' 22. IF MULTIPLE COMPL., HOW MANY* 1 23. INTERVALS DRILLED BY ROTARY TOOLS Surf-2310' CABLE TOOLS

24. PRODUCING INTERVAL(S), OF THIS COMPLETION—TOP, BOTTOM, NAME (MD AND TVD)*
1934'-2120', Fruitland Coal Seam 25. WAS DIRECTIONAL SURVEY MADE
1-1/2° @ 1289'

26. TYPE ELECTRIC AND OTHER LOGS RUN
DIL/GR, HiRes Denisty/Neutron 27. WAS WELL CORRED
No

CASING RECORD (Report all strings set in well)					
CASING SIZE	WEIGHT, LB./FT.	DEPTH SET (MD)	HOLE SIZE	CEMENTING RECORD	AMOUNT PULLED
8-5/8"	20#	252'	12-1/4"	240 sx reg	
4-1/2"	10.5#	2307'	7-7/8"	400 sx Poz, 135 sx reg	

LINER RECORD					TUBING RECORD		
SIZE	TOP (MD)	BOTTOM (MD)	BACKS CEMENT*	SCREEN (MD)	SIZE	DEPTH SET (MD)	PACKER SET (MD)
					1.900"	2139'	

31. PERFORATION RECORD (Interval, size and number)		32. ACID, SHOT, FRACTURE, CEMENT SQUEEZE, ETC.	
		DEPTH INTERVAL (MD)	AMOUNT AND KIND OF MATERIAL USED
1934'-41', 2027'-30', 2032'-40', 2045'-48', 2050'-56', 2060'-62', 2106'-20', 50 holes		1934'-2120'	500 gal 7-1/2% HCl
		same	Frac w/900,000 cuft N2, 950 bbls gelled wtr, 11,000# 40/70 sand, 275,000# 20/40 sand

33. PRODUCTION							
DATE FIRST PRODUCTION		PRODUCTION METHOD (Flowing, gas lift, pumping—size and type of pump)				WELL STATUS (Producing or shut-in)	
12/31/90		flowing				SI - WOPL	
DATE OF TEST	HOURS TESTED	CHOKE SIZE	PROD'N. FOR TEST PERIOD	OIL—BBL.	GAS—MCF.	WATER—BBL.	GAS-OIL RATIO
01/03/91	24	1/4"		390			
FLOW, TUBING PRESS.	CASING PRESSURE	CALCULATED 24-HOUR RATE	OIL—BBL.	GAS—MCF.	WATER—BBL.	OIL GRAVITY-API (CORR.)	
250 psig				390			

34. DISPOSITION OF GAS (Sold, used for fuel, vented, etc.)
ACCEPTED FOR RECORD
Steve Owen

35. LIST OF ATTACHMENTS
OIL CON. DIV.
FEB 04 1991

36. I hereby certify that the foregoing and attached information is complete and correct as determined from all available information.
SIGNED J.P. Garrett TITLE Vice President BY Steve Owen DATE 01/11/91

*(See Instructions and Spaces for Additional Data on Reverse Side)

37. SUMMARY OF POROUS ZONES: (Show all important zones of porosity and contents thereof; cored intervals; and all drill-stem tests, including depth interval tested, cushion used, flowing and shut-in pressures, and recoveries):

FORMATION	TOP	BOTTOM	DESCRIPTION, CONTENTS, ETC.
			(No samples kept, no mud logs, no tests)

38. GEOLOGIC MARKERS

NAME	TOP	
	MEAS. DEPTH	TRUE VERT. DEPTH
Ojo Alamo Kirtland Sh. Fruitland Coal Picture Cliffs	1075? 1207 1934 2161	

Form 3160-5
(June 1990)
DIVISION
RECEIVED

UNITED STATES
DEPARTMENT OF THE INTERIOR
BUREAU OF LAND MANAGEMENT

RECEIVED
BLM

FORM APPROVED
Budget Bureau No. 1004-0135
Expires: March 31, 1993

FEB 22 AM 9 51

SUNDRY NOTICES AND REPORTS ON WELLS

Do not use this form for proposals to drill or to deepen or reentry to a different reservoir.
Use "APPLICATION FOR PERMIT—" for such proposals.

3. Lease Designation and Serial No.

NM 04202

6. If Indian, Allottee or Tribe Name

FARMINGTON, N.M.

SUBMIT IN TRIPLICATE

1. Type of Well

☐ Oil Well ☒ Gas Well ☐ Other

2. Name of Operator

Incline Reserves, Inc.

3. Address and Telephone No.

1603 SW 37th St., Topeka, KS 66611 913-267-5033

4. Location of Well (Footage, Sec., T., R., M., or Survey Description)

1450' FSL, 2250' FWL (NESW)
Sec. 11, T28N, R9W, NMPM

7. If Unit or CA, Agreement Designation

8. Well Name and No.

Federal 11 #2

9. API Well No.

30-045-28475

10. Field and Pool, or Exploratory Area

Basin Fruitland Coal

11. County or Parish, State

San Juan, NM

12. CHECK APPROPRIATE BOX(S) TO INDICATE NATURE OF NOTICE, REPORT, OR OTHER DATA

TYPE OF SUBMISSION

- ☐ Notice of Intent
☒ Subsequent Report
☐ Final Abandonment Notice

TYPE OF ACTION

- ☐ Abandonment
☐ Recompletion
☐ Plugging Back
☐ Casing Repair
☐ Altering Casing
☒ Other Acidize & Fracture Treatment

- ☐ Change of Plans
☐ New Construction
☐ Non-Routine Fracturing
☐ Water Shut-Off
☐ Conversion to Injection
☐ Dispose Water

(Note: Report results of multiple completion on Well Completion or Recompletion Report and Log form.)

13. Describe Proposed or Completed Operations (Clearly state all pertinent details, and give pertinent dates, including estimated date of starting any proposed work. If well is directionally drilled, give subsurface locations and measured and true vertical depths for all markers and zones pertinent to this work.)

Acidized perforations from 1934' - 2120' w/500 gal 7-1/2% HCl.
Frac'd Fruitland Coal down csg w/900,000 cuft N2, 950 bbls gelled
wtr, 11,000# 40/70 sand, 275,000# 20/40 sand. Air - 65 BPM, AIP.
- 1800 psi. SIWH - 4 hrs. Flowed well to pit. 12/31/90

RECEIVED
FEB 19 1991
OIL CON. DIV.
DIST. 3

14. I hereby certify that the foregoing is true and correct

Signed J.P. Garrett Title Vice President

Date 01/10/91

(This space for Federal or State office use)

ACCEPTED FOR RECORD

Approved by _____ Title _____
Conditions of approval, if any:

Date FEB 04 1991

Title 18 U.S.C. Section 1001, makes it a crime for any person knowingly and willfully to make to any department or agency of the United States any false, fictitious or fraudulent statements or representations as to any matter within its jurisdiction.

*See Instruction on Reverse Side

UNITED STATES
DEPARTMENT OF THE INTERIOR
BUREAU OF LAND MANAGEMENT

FORM APPROVED
Budget Bureau No. 1004-0135
Expires: March 31, 1993

91 FEB 6 AM 9 20

SUNDRY NOTICES AND REPORTS ON WELLS

Do not use this form for proposals to drill or to deepen or reentry to a different reservoir.
Use "APPLICATION FOR PERMIT—" for such proposals

SUBMIT IN TRIPLICATE

1. Type of Well
☐ Oil Well ☒ Gas Well ☐ Other

2. Name of Operator
Incline Reserves, Inc.

3. Address and Telephone No.
1603 SW 37th St., Topeka, KS 66611 913-267-5033

4. Location of Well (Footage, Sec., T., R., M., or Survey Description)
1450' FSL, 2250' FWL (NESW)
Sec. 11, T28N, R9W, NMPM

5. Lease Designation and Serial No.
NM 04202

6. If Indian, Allottee or Tribe Name

7. If Unit or CA, Agreement Designation

8. Well Name and No.
Federal 11 #2

9. API Well No.

10. Field and Pool, or Exploratory Area
Basin Fruitland Coal

11. County or Parish, State
San Juan, NM

12. CHECK APPROPRIATE BOX(s) TO INDICATE NATURE OF NOTICE, REPORT, OR OTHER DATA

TYPE OF SUBMISSION	TYPE OF ACTION	
<input type="checkbox"/> Notice of Intent	<input type="checkbox"/> Abandonment	<input type="checkbox"/> Change of Plans
<input checked="" type="checkbox"/> Subsequent Report	<input type="checkbox"/> Recompletion	<input type="checkbox"/> New Construction
<input type="checkbox"/> Final Abandonment Notice	<input type="checkbox"/> Plugging Back	<input type="checkbox"/> Non-Routine Fracturing
	<input type="checkbox"/> Casing Repair	<input type="checkbox"/> Water Shut-Off
	<input type="checkbox"/> Altering Casing	<input type="checkbox"/> Conversion to Injection
	<input type="checkbox"/> Other Spud, csg. test & cement	<input type="checkbox"/> Dispose Water

(Note: Report results of multiple completion on Well Completion or Recompletion Report and Log form.)

13. Describe Proposed or Completed Operations (Clearly state all pertinent details, and give pertinent dates, including estimated date of starting any proposed work. If well is directionally drilled, give subsurface locations and measured and true vertical depths for all markers and zones pertinent to this work.)

Spud well on 12/09/90 w/Beeman Drlg. Co. Drilled 12-1/4" hole to 260'. Ran 252' new 8-5/8" 20#/ft csg., landed @ 252'. Cement w/240 sx reg. cmt. Circulate cement to surface. Plug Down @ 1:30 AM, 12/10/90. Pressure test csg. to 600 psi.

Drilled 7-7/8" hole to TD of 2310' w/Summit Drlg. Ran 2309' new 4-1/2" 10/5#/ft csg., landed @ 2307'. Cement w/400 sx Poz, 135 sx reg. cmt. Circulate cement to surface. Plug Down @ 2:00 AM, 12/15/90. Pressure test csg. to 3500 psi.

RECEIVED
FEB 04 1991
OIL CON. DIV.
DIST. 3

14. I hereby certify that the foregoing is true and correct

Signed J.P. Garrett Title Vice President Date 12/19/90

(This space for Federal or State office use)

Approved by _____ Title _____ Date _____
Conditions of approval, if any:

ACCEPTED FOR RECORD
JAN 17 1991

UNITED STATES
DEPARTMENT OF THE INTERIOR
BUREAU OF LAND MANAGEMENT

30-045-28475

APPLICATION FOR PERMIT TO DRILL, DEEPEN, OR PLUG BACK

1a. TYPE OF WORK

DRILL ☒ AM 10 58

DEEPEN ☐

PLUG BACK ☐

b. TYPE OF WELL

OIL WELL ☐

GAS WELL ☒

OTHER

SINGLE ZONE ☒

MULTIPLE ZONE ☐

2. NAME OF OPERATOR

Incline Reserves, Inc. ✓

3. ADDRESS OF OPERATOR

1603 SW 37th Topeka, KS 66611

4. LOCATION OF WELL (Report location clearly and in accordance with any State requirements.)*

At surface

1450' FSL, 2250' FWL (NESW)

At proposed prod. zone

Same

14. DISTANCE IN MILES AND DIRECTION FROM NEAREST TOWN OR POST OFFICE*

12 miles from Blanco, NM

15. DISTANCE FROM PROPOSED*

LOCATION TO NEAREST
PROPERTY OR LEASE LINE, FT.
(Also to nearest drig. unit line, if any)

16. NO. OF ACRES IN LEASE

1198.28

17. NO. OF ACRES ASSIGNED

TO THIS WELL

ALL 220 267.72 ✓

18. DISTANCE FROM PROPOSED LOCATION*

TO NEAREST WELL, DRILLING, COMPLETED,
OR APPLIED FOR, ON THIS LEASE, FT.

19. PROPOSED DEPTH

2350'

20. ROTARY OR CABLE TOOLS

Rotary

21. ELEVATIONS (Show whether DF, RT, GR, etc.) THIS ACTION IS SUBJECT TO TECHNICAL AND
5775' GR procedural review pursuant to 43 CFR 3100.2
and appeal pursuant to 43 CFR 3100.4

22. APPROX. DATE WORK WILL START*

As soon as permitted

23.

PROPOSED CASING AND CEMENTING PROGRAM

ALL OPERATIONS AUTHORIZED ARE
SUBJECT TO COMPLIANCE WITH ATTACHED
"GENERAL QUANTITY OF CEMENT"

SIZE OF HOLE	SIZE OF CASING	WEIGHT PER FOOT	SETTING DEPTH	QUANTITY OF CEMENT
12 1/4"	8 5/8"	20#	240'	150 sx (cement to surface)
7 7/8"	4 1/2"	10.5#	2350'	275 sx (cement to surface)

RECEIVED
DEC 07 1990
OIL CON. DIV.
DIST. 3

"Approval of this action does
not warrant that the applicant
holds legal or equitable rights
or title to this lease."

IN ABOVE SPACE DESCRIBE PROPOSED PROGRAM: If proposal is to deepen or plug back, give data on present productive zone and proposed new productive zone. If proposal is to drill or deepen directionally, give pertinent data on subsurface locations and measured and true vertical depths. Give blowout preventer program, if any.

24.

SIGNED

Dana Deluenthal

TITLE Agent

DATE Oct. 22, 1990

(This space for Federal or State office use)

PERMIT NO.

APPROVAL DATE

APPROVED BY

TITLE

CONDITIONS OF APPROVAL, IF ANY:

AS AMENDED

NOV 27 1990

John S. Keller
AREA MANAGER

Hold C-104 FOR NSL NMOC

*See Instructions On Reverse Side

Submit to Appropriate
District Office
State Lease - 4 copies
Fee Lease - 3 copies

State of New Mexico
Energy, Minerals and Natural Resources Department

Form C-102
Revised 1-1-89

OIL CONSERVATION DIVISION

P.O. Box 2088
Santa Fe, New Mexico 87504-2088

DISTRICT I
P.O. Box 1920, Hobbs, NM 88240

DISTRICT II
P.O. Drawer DD, Artesia, NM 88210

DISTRICT III
1000 Rio Brazos Rd., Aztec, NM 87410

WELL LOCATION AND ACREAGE DEDICATION PLAT

All Distances must be from the outer boundaries of the section

Operator INCLINE RESERVES.		Lease Federal 11		Well Fed. 11 #	
Unit Letter K	Section 11	Township 28 North	Range 9 West	County San Juan	
Actual Footage Location of Well: 1450		South		2250 West	
feet from the		line and		feet from the	
Ground level Elev. 5775	Producing Formation Fruitland	Pool Basin Fruitland Coal		Dedicated Acreage: 320 267.72 Acres	

1. Outline the acreage dedicated to the subject well by colored pencil or hatchure marks on the plat below.

2. If more than one lease is dedicated to the well, outline each and identify the ownership thereof (both as to working interest and royalty).

3. If more than one lease of different ownership is dedicated to the well, have the interest of all owners been consolidated by communitization, unitization, force-pooling, etc.?

☐ Yes

☐ No

If answer is "yes" type of consolidation

If answer is "no" list the owners and tract descriptions which have actually been consolidated. (Use reverse side of this form if necessary.)

No allowable will be assigned to the well until all interests have been consolidated (by communitization, unitization, forced-pooling, or otherwise) or until a non-standard unit, eliminating such interest, has been approved by the Division.

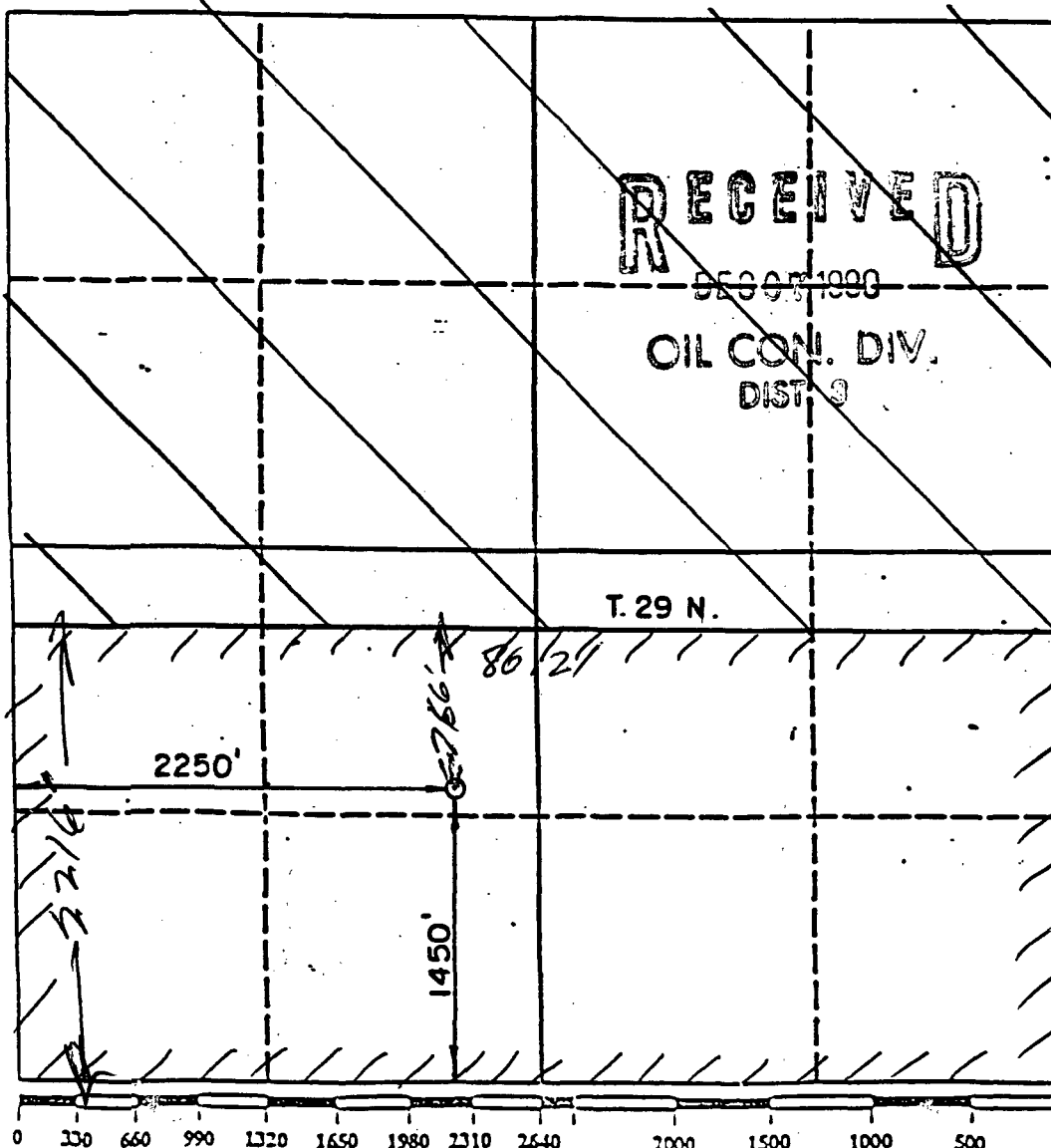

OPERATOR CERTIFICATION

I hereby certify that the information contained herein is true and complete to the best of my knowledge and belief.

Signature

Dana Delventhal

Printed Name

Dana Delventhal

Position

Agent

Company

Incline Reserves, Inc.

Date

October 22, 1990

SURVEYOR CERTIFICATION

I hereby certify that the well location shown on this plat was plotted from field notes of actual surveys made by me or under my supervision, and that the same is true and correct to the best of my knowledge and belief.

Date Surveyed

Signature of Professional Surveyor

G. H. Huddleston

Certificate No.

6844