

ENRON
Oil & Gas Company

OIL CONSERVATION DIVISION
RECEIVED

'92 JUN 15 AM 9 09

P. O. Box 2267 Midland, Texas 79702 (915) 686-3600

June 15, 1992

New Mexico Oil Conservation Commission
P. O. Box 2088
Santa Fe, New Mexico 87501

Attn: Mike Stogner

In Re: Administrative Order NSL-3103
Cedar Lake 35 Federal Com., Well No. 1
Section 35, T17S, R30E
Eddy County, New Mexico

Dear Mr. Stogner:

Please find enclosed three (3) copies of Form 3160-3 and plat which has been submitted to the Bureau of Land Management in Carlsbad, New Mexico to plug back the above-named well from the Devonian to the Lower Morrow. Also enclosed is a map which shows the location of all offset operators, and where applicable the mineral interest owners all of which were notified of this request for non-standard location today June 15, 1992.

Location had to be drilled as non-standard because of a pipeline that crosses the northeast corner of the lease.

Very truly yours,

Enron Oil & Gas Company



Betty Gildon
Regulatory Analyst

enclosures

bg

ENRON

Oil & Gas Company

P. O. Box 2267 Midland, Texas 79702 (915) 686-3600

June 23, 1992

Mr. Robert G. Stovall
General counsel
Oil Conservation Division
Energy, Mineral and Natural Resources Department
P.O. Box 2088
Santa Fe, New Mexico 87504

RE: CEDAR LAKE "35" FEDERAL COM. NO. 1

Dear Mr. Stovall:

Please reference your letter dated June 15, 1992 regarding the recent recompletion and production of the Morrow formation. Enron's actions are the result of a serious oversight of the Commission's Rules and Regulations, but not of willful intent to violate or circumvent the Commission's operational requirements. The purpose of this letter is to explain the circumstances of Enron's actions. Also in accordance with your request, we have enclosed copies of all pertinent documents regarding this well.

The Cedar Lake "35" Federal Com. No. 1 was designated as a 12,500' well to test the Devonian interval with secondary potential possible in the Atoka and Wolfcamp zones. Surface constraints required that the location be moved two-hundred and fifty feet closer than standard minimum lease line distances and the Division's approval of the resultant "unorthodox" location was obtained for the zones anticipated to be encountered. Subsequent drilling and testing showed the Devonian to be non-productive but productive Morrow was encountered, casing was set and testing was begun. The Morrow zone's high potential was evidenced by a drill stem test creating a high level of distraction, and production testing was undertaken without Enron double checking to see that the appropriate approvals were acquired.

Enron respectfully requests the Commission's tolerance with our actions regarding this matter. Our intent is for Enron to maintain a position of integrity and respect within New Mexico and throughout the industry. We are making every effort to see that such actions are not repeated.

Sincerely,



Ray L. Ingle
Division Operations Manager

/lgh

lh259riw

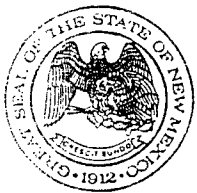

STATE OF NEW MEXICO

ENERGY, MINERALS AND NATURAL RESOURCES DEPARTMENT

OIL CONSERVATION DIVISION

June 15, 1992

BRUCE KING
GOVERNOR

POST OFFICE BOX 2088
STATE LAND OFFICE BUILDING
SANTA FE, NEW MEXICO 87504
(505) 827-5800

**CERTIFIED - RETURN
RECEIPT REQUESTED**

**Enron Oil & Gas Company
P. O. Box 2267
Midland, Texas 79702**

Attention: Betty Gildon

**Re: Cedar Lake 35 Federal Com
Well No. 1
Completion in Cedar Lake Morrow Gas Pool**

Dear Ms. Gildon:

It has come to the attention of the Division that your company has recompleted the above-referenced well in the Cedar Lake-Morrow Gas Pool without obtaining prior approval of the Division for the recompletion work as required by Rule 1101. We have further learned that your company connected this formation to the pipe line and began producing gas without approval of the Division in violation of Rule 1104.

These actions are very serious violations of the Rules and Regulations of the Oil Conservation Division. The Oil and Gas Act (Sec. 70-2-31, NMSA 1978) provides Civil penalties of not more than \$1,000 for each violation and each day is considered a separate violation.

The production superintendent or other person responsible for conducting these operations in violation of Division rules is hereby directed to file a complete explanation of why such operations were conducted without obtaining proper prior approval and completion approval from the Division. This information should be submitted in detail with all supporting documentation within ten days of the date of this letter.

Failure to do so will result in immediate action being taken by the Division to enforce its rules and regulations, including the possible imposition of Civil penalties.

Sincerely,

**ROBERT G. STOVALL,
General Counsel**

RGS/dr

ENRON

Oil & Gas Company

P. O. Box 2267 Midland, Texas 79702 (915) 686-3600

June 15, 1992

CERTIFIED MAIL
P 355 206 252

Richard L. Ray
Richard L. Ray, Trustee
Fair Oil, Ltd.
225 S. College
Box 689
Tyler, Texas 75710

P 355 206 253
Lincoln Aston
P. O. Box 3048
LaJolla, Calif 92038

P355 206 254
Sunwest Bank of Albuquerque as Ancillary
Personal Representative of the
Charles Albert Aston, Jr. Estate
P. O. Box 26900
Albuquerque, NM 87125

P 355 206 255
Rogers Aston
P. O. Box 1090
Roswell, NM 88202

P 355 206 256
Rogers Aston and
NCNB Texas National Bank as Co-Trustees
of the "C" Trusts U/W/O Bert Aston
P. O. Box 830308
Dallas, Texas 75283-0308

P 355206 257
Sharon A. Olsen, Trustee Under Declaration of
Trust created by Sharon Aston Olsen, Trustor
P. O. Box 7296
Laguna Niguel, Calif. 92607-7296

Re: Cedar Lake 35 Federal Com., Well No. 1
Sec 35, T17S, R30E, Eddy County, NM

Gentlemen:

Enron Oil & Gas Company has applied to the New Mexico Oil Conservation Division in Santa Fe, New Mexico to plug back to the Lower Morrow the unorthodox location for the above-named well as per the attached Application and location plat. If you, as mineral interest owner, have no objection to this special permit, please sign in the space provided below, and return to my attention in the enclosed envelope.

Your early attention is appreciated.

Very truly yours,

ENRON OIL & GAS COMPANY



Betty Gildon
Regulatory Analyst

BG

DATE: _____ COMPANY: _____ BY: _____

UNITED STATES
DEPARTMENT OF THE INTERIOR
BUREAU OF LAND MANAGEMENT

5. LEASE DESIGNATION AND SERIAL NO.
NM 0384576

6. IF INDIAN, ALLOTTEE OR TRIBE NAME

7. UNIT AGREEMENT NAME

8. FARM OR LEASE NAME

Cedar Lake 35 Federal Com.

9. WELL NO.

1

10. FIELD AND POOL, OR WILDCAT

Wildcat Lower Morrow

11. SEC., T., R., M., OR BLK.
AND SURVEY OR AREA

Section 35, T17S, R30E

12. COUNTY OR PARISH 13. STATE

Eddy

NM

1a. TYPE OF WORK

DRILL ☐

DEEPEN ☐

PLUG BACK ☒

b. TYPE OF WELL

OIL
WELL ☐

GAS
WELL ☒

OTHER

SINGLE
ZONE ☒

MULTIPLE
ZONE ☐

2. NAME OF OPERATOR

Enron Oil & Gas Company

3. ADDRESS OF OPERATOR

P. O. Box 2267, Midland, Texas 79702

4. LOCATION OF WELL (Report location clearly and in accordance with any State requirements.)*

At surface

1240' FNL & 1980' FEL

At proposed prod. zone

1240' FNL & 1980' FEL

14. DISTANCE IN MILES AND DIRECTION FROM NEAREST TOWN OR POST OFFICE*

2 miles SW from Loco Hills

15. DISTANCE FROM PROPOSED*

LOCATION TO NEAREST
PROPERTY OR LEASE LINE, FT. 1240
(Also to nearest drlg. unit line, if any)

1240

16. NO. OF ACRES IN LEASE

320

17. NO. OF ACRES ASSIGNED
TO THIS WELL

320

18. DISTANCE FROM PROPOSED LOCATION*
TO NEAREST WELL, DRILLING, COMPLETED,
OR APPLIED FOR, ON THIS LEASE, FT.

None

19. PROPOSED DEPTH PBD

12,095

20. ROTARY OR CABLE TOOLS

-

21. ELEVATIONS (Show whether DF, RT, GR, etc.)

3548.1' GR

22. APPROX. DATE WORK WILL START*

6-5-92

23.

PROPOSED CASING AND CEMENTING PROGRAM

SIZE OF HOLE	SIZE OF CASING	WEIGHT PER FOOT	SETTING DEPTH	QUANTITY OF CEMENT
17-1/2	13-3/8	54.50	626	525 sacks CIRCULATED
11	8-5/8	32	4506	2200 sacks CIRCULATED
7-7/8	5-1/2	17	12500	1035 sacks TOC: tagged at 8487'

Plug back from Devonian to Lower Morrow
Original TD 12,500'

IN ABOVE SPACE DESCRIBE PROPOSED PROGRAM: If proposal is to deepen or plug back, give data on present productive zone and proposed new productive zone. If proposal is to drill or deepen directionally, give pertinent data on subsurface locations and measured and true vertical depths. Give blowout preventer program, if any.

24.

SIGNED

Betty Gildon

Betty Gildon

TITLE

Regulatory Analyst

DATE

6/15/92

(This space for Federal or State office use)

PERMIT NO.

APPROVAL DATE

APPROVED BY

TITLE

DATE

CONDITIONS OF APPROVAL, IF ANY:

*See Instructions On Reverse Side

Title 18 U.S.C. Section 1001, makes it a crime for any person knowingly and willfully to make to any department or agency of the United States any false, fictitious or fraudulent statements or representations as to any matter within its jurisdiction.

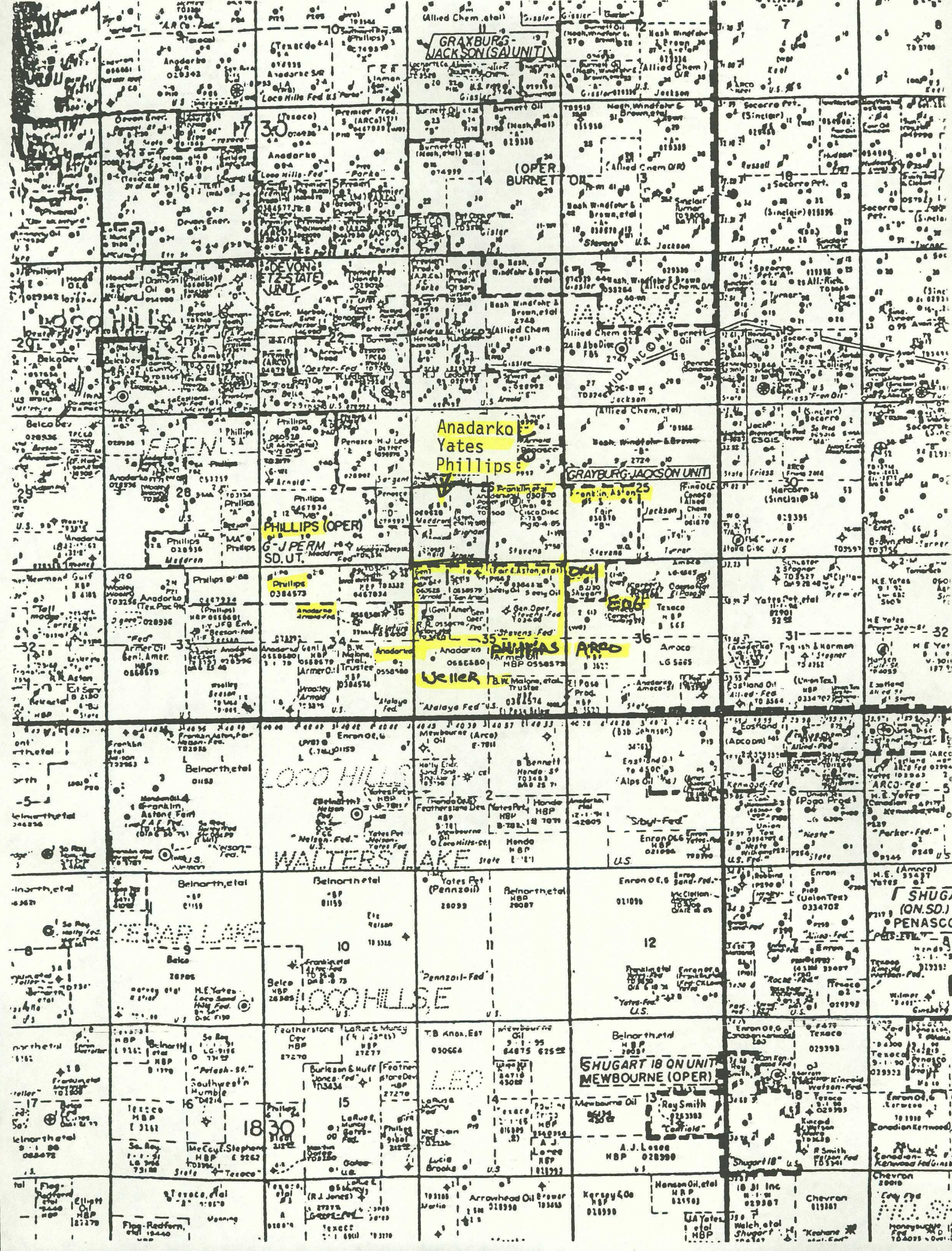

Submit to Appropriate
District Office
State Lease - 4 copies
Fee Lease - 3 copies

State of New Mexico
Energy, Minerals and Natural Resources Department

Form C-102
Revised 1-1-88

OIL CONSERVATION DIVISION

P.O. Box 2088
Santa Fe, New Mexico 87504-2088

DISTRICT I

P.O. Box 1980, Hobbs, NM 88240

DISTRICT II

P.O. Drawer DD, Artesia, NM 88210

DISTRICT III

1000 Rio Arriba Rd., Aztec, NM 87410

WELL LOCATION AND ACREAGE DEDICATION PLAT

All Distances must be from the outer boundaries of the section.

Operator Enron Oil & Gas Company			Lease Cedar Lake 35 Fed. Com.		Well No. 1
Unit Letter B	Section 35	Township 17 South	Range 30 East	County RMPM	Eddy
Actual Footage Location of Well: 1240 feet from the North line and 1980 feet from the East line					
Ground Level Elev. 3548.1	Producing Formation Lower Morrow	Pool Wildcat	Dedicated Acreage: 112 320 Acres		

- Outline the acreage dedicated to the subject well by colored pencil or hatchure marks on the plat below.
- If more than one lease is dedicated to the well, outline each and identify the ownership thereof (both as to working interest and royalty).
- If more than one lease of different ownership is dedicated to the well, have the interest of all owners been consolidated by communization, unitization, force-pooling, etc.?
☐ Yes ☐ No If answer is "yes" type of consolidation _____

If answer is "no" list of owners and tract descriptions which have actually been consolidated. (Use reverse side of this form necessary.)

No allowable will be assigned to the well unit all interests have been consolidated (by communization, unitization, forced-pooling, otherwise) or until a non-standard unit, eliminating such interest, has been approved by the Division.

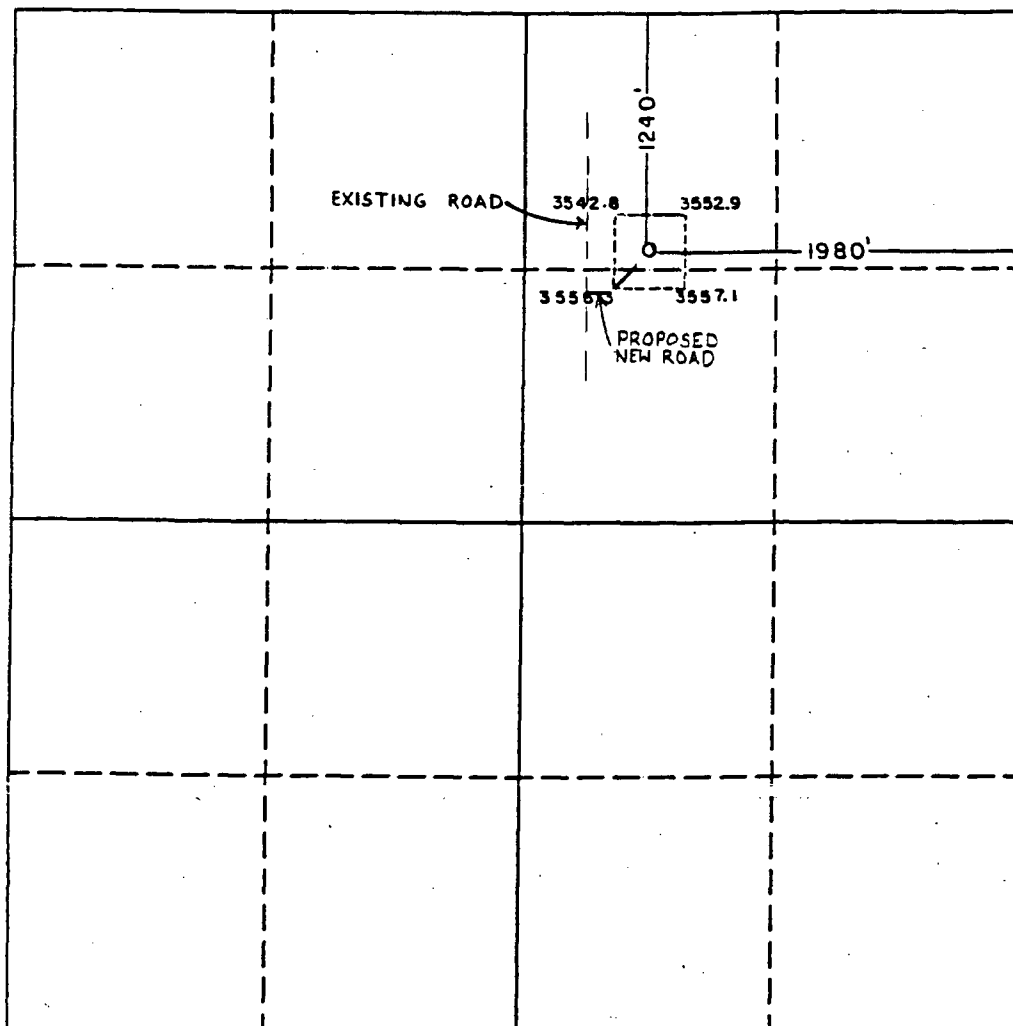

OPERATOR CERTIFICATION

I hereby certify the information contained herein is true and complete to the best of my knowledge and belief.

Signature
Betty Gildon

Printed Name
Betty Gildon

Position
Regulatory Analyst

Company
Enron Oil & Gas Company

Date
6/15/92

SURVEYOR CERTIFICATION

I hereby certify that the well location shown on this plat was plotted from field notes of actual surveys made by me or under my supervision, and that the same is true and correct to the best of my knowledge and belief.

Date Surveyed
January 29, 1992

Signature & Seal of
Professional Surveyor

REGISTERED LAND SURVEYOR
No. 1111
Certificate No. 1111
JOHN W. WEST, 878
RONALD E. ERSON, 3238
SANDY L. GONZALEZ, 7977
W.O. 9201110142

UNITED STATES
DEPARTMENT OF THE INTERIOR
BUREAU OF LAND MANAGEMENT

SUBMIT IN DUPLICATE*

(See other in-
structions on
reverse side)

Form approved:
Budget Bureau No. 1004-0137
Expires August 31, 1985

WELL COMPLETION OR RECOMPLETION REPORT AND LOG *

1a. TYPE OF WELL: OIL WELL ☐ GAS WELL ☒ DRY ☐ Other _____

b. TYPE OF COMPLETION: NEW WELL ☒ WORK OVER ☐ DEEP-EN ☐ PLUG BACK ☐ DIFF. RENVR. ☐ Other _____

2. NAME OF OPERATOR
Enron Oil & Gas Company

3. ADDRESS OF OPERATOR
P. O. Box 2267, Midland, Texas 79702

4. LOCATION OF WELL (Report location clearly and in accordance with any State requirements)*
At surface 1240' FNL & 1980' FEL
At top prod. interval reported below Same
At total depth Same

14. PERMIT NO. 30 015 26969 DATE ISSUED 3-11-92

15. DATE SPUNDED 3-29-92 16. DATE T.D. REACHED 5-10-92 17. DATE COMPL. (Ready to prod.) 6-6-92 18. ELEVATIONS (DF, RKB, RT, GR, ETC.)* 3548.1' GR

20. TOTAL DEPTH, MD & TVD 12,500 21. PLUG. BACK T.D., MD & TVD 12,095' 22. IF MULTIPLE COMPL., HOW MANY* 23. INTERVALS DRILLED BY X

24. PRODUCING INTERVAL(S), OF THIS COMPLETION—TOP, BOTTOM, NAME (MD AND TVD)* 11,188'-11,234' (Lower Morrow)

26. TYPE ELECTRIC AND OTHER LOGS RUN Dual Ind GR; Z- Density, Comp Neut GR, Caliper; BHC Acoustilog, GR

27. WAS WELL CORED No

CASING RECORD (Report all strings set in well)					
CASING SIZE	WEIGHT, LB./FT.	DEPTH SET (MD)	HOLE SIZE	CEMENTING RECORD	AMOUNT PULLED
13-3/8	54.50	626	17-1/2	525 sx Prem Plus	Circulated
8-5/8	32	4506	11	2200 sx Prem Plus	Circulated
5-1/2	17	12500	7-7/8	1035 sx Prem Plus	TOC: 8487' tagged

LINER RECORD					TUBING RECORD		
SIZE	TOP (MD)	BOTTOM (MD)	SACKS CEMENT*	SCREEN (MD)	SIZE	DEPTH SET (MD)	PACKER SET (MD)
					1-7/8	10,834	10,834
					Baker FB-1		

31. PERFORATION RECORD (Interval, size and number)			32. ACID, SHOT, FRA	
12374 -80	(.35" - 13)	Fusselman	DEPTH INTERVAL (MD)	
12366-68	(.35" - 5)		12353-12380	CIB
12359-63	(.35" - 9)		12160-12210	CIB
12353-56	(.35" - 7)		11188-11234	
12160-210	(.35" - 101)	Devonian		

33.* 11188 - 11234 (.35" - 36) ~~PRODUCTION~~ LOWER MORROW PERFS

DATE FIRST PRODUCTION 06-08-92 PRODUCTION METHOD (Flowing, gas lift, pumping—size and type of pump) Flowing WELL STATUS (Producing or Shut-in) Producing

DATE OF TEST 6-12-92 HOURS TESTED 24 CHOKE SIZE 14/64 PROD'N. FOR TEST PERIOD 104 OIL—BSL. 2512 GAS—MCF. 14 WATER—BSL. 24,154

FLOW. TUBING PRESS. 3500 CASING PRESSURE 440 CALCULATED 24-HOUR RATE 55.0

34. DISPOSITION OF GAS (Sold, used for fuel, vented, etc.) Sold TEST WITNESSED BY

35. LIST OF ATTACHMENTS
Logs

36. I hereby certify that the foregoing and attached information is complete and correct as determined from all available records
SIGNED Betty Gildon TITLE Regulatory Analyst DATE 6/15/92

*(See Instructions and Spaces for Additional Data on Reverse Side)

37. SUMMARY OF POROUS ZONES: (Show all important zones of porosity and contents thereof; cored intervals; and all drill-stem, tests, including depth interval tested, cushion used, time tool open, flowing and shut-in pressures, and recoveries):

FORMATION	TOP	BOTTOM	DESCRIPTION, CONTENTS, ETC.	GEOLOGIC MARKERS		
				NAME	MEAS. DEPTH	TOP TRUE VERT. DEPTH
St. Spring Sand	1698	1698	Surface Rodk & Red Beds	Yates	1532	
	2189	2189	Anhy & Shale	Queen	2532	
	2596	2596	Anhy, Dolo, Sh	San Andres	3368	
	3273	3273	Sd, Sh Anhy, Dolo	Wolfcamp	8200	
	3596	3596	Dolo	Strawn	10208	
	4193	4193	Dolo, Shale	Atoka	10517	
	4884	4884	Dolomite	Morrow	10823	
	5483	5483	dolo, chert	Lower Morrow	11103	
	6466	6466	lime, sh	Mississippi	11428	
	7220	7220	dolo, sh	Chester	11551	
	8222	8222	lm, dolo, sh, chert, sd	Miss Lime	12147	
	8338	8338	sand	Devonian		
	9185	9185	dolo			
	9425	9425	lm, sh			
	9789	9789	lm, sh, chert			
Atoka Limestone Middle Morrow	9789	10560	sh, lime			
	10560	10715	lime, shale, trace chert			
	10715	11600	lime, shale			
	11600	11859	shale, lime, chert			
	11859	12086	lime			
Woodford Shale Top of Fusselman	12086	12335	lime, chert, sh			
	12335	12500	lm, chert, dolo, sh			
	12500	TD	100% shale			

Submit 5 Copies
Appropriate District Office
DISTRICT I
P.O. Box 1980, Hobbs, NM 88240

DISTRICT II
P.O. Drawer DD, Artesia, NM 88210

DISTRICT III
1000 Rio Brazos Rd., Aztec, NM 87410

OIL CONSERVATION DIVISION
P.O. Box 2088
Santa Fe, New Mexico 87504-2088

REQUEST FOR ALLOWABLE AND AUTHORIZATION
TO TRANSPORT OIL AND NATURAL GAS

I.

Operator Enron Oil & Gas Company	Well API No. 30 015 26969
Address P. O. Box 2267, Midland, Texas 79702	
Reason(s) for Filing (Check proper box) <input type="checkbox"/> Other (Please explain)	
New Well <input checked="" type="checkbox"/>	Change in Transporter of:
Recompletion <input type="checkbox"/>	Oil <input type="checkbox"/> Dry Gas <input type="checkbox"/>
Change in Operator <input type="checkbox"/>	Casinghead Gas <input type="checkbox"/> Condensate <input type="checkbox"/>
If change of operator give name and address of previous operator	

II. DESCRIPTION OF WELL AND LEASE

Lease Name Cedar Lake 35 Federal Com	Well No. 1	Pool Name, Including Formation Wildcat Lower Morrow	Kind of Lease State, Federal or Fee	Lease No. NM 0384576
Location				
Unit Letter B	1240'	Feet From The North	Line and 1980'	Feet From The East
Section 35	Township 17S	Range 30E	NMPM	Eddy
County				

III. DESIGNATION OF TRANSPORTER OF OIL AND NATURAL GAS

Name of Authorized Transporter of Oil <input type="checkbox"/> or Condensate <input checked="" type="checkbox"/>	Address (Give address to which approved copy of this form is to be sent)					
Enron Oil Trading & Transp Co.	P. O. Box 1188, Houston, Texas 77251-1188					
Name of Authorized Transporter of Casinghead Gas <input type="checkbox"/> or Dry Gas <input checked="" type="checkbox"/>	Address (Give address to which approved copy of this form is to be sent)					
Chevron Pipeline Co.	P. O. Box 1150, Midland, Texas 79701					
If well produces oil or liquids, give location of tanks.	Unit B	Sec. 35	Twp. 17S	Rge. 30E	Is gas actually connected? Yes	When? 6-10-92

If this production is commingled with that from any other lease or pool, give commingling order number:

IV. COMPLETION DATA

Designate Type of Completion - (X)	Oil Well	Gas Well	New Well	Workover	Deepen	Plug Back	Same Res'v	Diff Res'v
		X	X					
Date Spudded 3-29-92	Date Compl. Ready to Prod. 6-06-92	Total Depth 12,500	P.B.T.D. 12,095					
Elevations (DF, RKB, RT, GR, etc.) 3548.1' GR	Name of Producing Formation Morrow	Top Oil/Gas Pay 11,188	Tubing Depth 10,834					
Perforations 11,188'-11,234' Lower Morrow			Depth Casing Shoe 12,500					
TUBING, CASING AND CEMENTING RECORD								
HOLE SIZE	CASING & TUBING SIZE	DEPTH SET	SACKS CEMENT					
17-1/2	13-3/8	626	525					
11	8-5/8	4506	2200					
7-7/8	5-1/2	12500	1035					
	2-7/8 tubing	10834						

V. TEST DATA AND REQUEST FOR ALLOWABLE
OIL WELL (Test must be after recovery of total volume of load oil and must be equal to or exceed top allowable for this depth or be for full 24 hours.)

Date First New Oil Run To Tank	Date of Test	Producing Method (Flow, pump, gas lift, etc.)	
Length of Test	Tubing Pressure	Casing Pressure	Choke Size
Actual Prod. During Test	Oil - Bbls.	Water - Bbls.	Gas- MCF

GAS WELL

Actual Prod. Test - MCF/D 6-11-92	Length of Test 24	Bbls. Condensate/WATER 104	Gravity of Condensate 55.0
Testing Method (pilot, back pr.) Back Pressure	Tubing Pressure (Shut-in) 3500	Casing Pressure (Shut-in) 100	Choke Size 14/64

VI. OPERATOR CERTIFICATE OF COMPLIANCE

I hereby certify that the rules and regulations of the Oil Conservation Division have been complied with and that the information given above is true and complete to the best of my knowledge and belief.

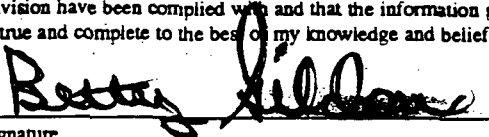
Signature
Betty Gildon, Regulatory Analyst
Printed Name
6/12/92
Date
915/686-3714
Telephone No.

OIL CONSERVATION DIVISION

Date Approved _____

By _____

Title _____

- INSTRUCTIONS: This form is to be filed in compliance with Rule 1104
- 1) Request for allowable for newly drilled or deepened well must be accompanied by tabulation of deviation tests taken in accordance with Rule 111.
 - 2) All sections of this form must be filled out for allowable on new and recompleted wells.
 - 3) Fill out only Sections I, II, III, and VI for changes of operator, well name or number, transporter, or other such changes.
 - 4) Separate Form C-104 must be filed for each pool in multiply completed wells.

UNITED STATES
DEPARTMENT OF THE INTERIOR
BUREAU OF LAND MANAGEMENT

API #

3001526969

APPLICATION FOR PERMIT TO DRILL, DEEPEN, OR PLUG BACK

1a. TYPE OF WORK

DRILL ☒

DEEPEN ☐

PLUG BACK ☐

b. TYPE OF WELL

OIL
WELL ☐

GAS
WELL ☒

OTHER

SINGLE
ZONE ☒

MULTIPLE
ZONE ☐

2. NAME OF OPERATOR

Enron Oil & Gas Company

3. ADDRESS OF OPERATOR

P. O. Box 2267, Midland, Texas 79702

4. LOCATION OF WELL (Report location clearly and in accordance with any State requirements.)

At surface

1240' FNL & 1980' FEL

At proposed prod. zone

1240' FNL & 1980' FEL

14. DISTANCE IN MILES AND DIRECTION FROM NEAREST TOWN OR POST OFFICE*

2 miles SW from Loco Hills

15. DISTANCE FROM PROPOSED*

LOCATION TO NEAREST
PROPERTY OR LEASE LINE, FT.
(Also to nearest drlg. unit line, if any)

1240

16. NO. OF ACRES IN LEASE

320

17. NO. OF ACRES ASSIGNED
TO THIS WELL

320

18. DISTANCE FROM PROPOSED LOCATION*
TO NEAREST WELL, DRILLING COMPLETED,
OR APPLIED FOR, ON THIS LEASE, FT.

None

19. PROPOSED DEPTH

12,500'

20. ROTARY OR CABLE TOOL-

Rotary

21. ELEVATIONS (Show whether DF, RT, GR, etc.)

3548.1' GL

22. APPROX. DATE WORK WILL START*

Before April 1, 1992

23.

PROPOSED CASING AND CEMENTING PROGRAM

No. Water Basin

SIZE OF HOLE	SIZE OF CASING	WEIGHT PER FOOT	SETTING DEPTH	QUANTITY OF CEMENT
17-1/2	13-3/8	48	600	515 sacks circulated
11	8-5/8	32	4500	1475 sacks circulated
7-7/8	5-1/2	15.5 & 17	12500	525 sacks

BOP - Install at 4500' with 3000# cap. and 3000# annular preventer.

Will use standard Surface Controlled BOP installation.

Acres dedicated.

IN ABOVE SPACE DESCRIBE PROPOSED PROGRAM: If proposal is to deepen or plug back, give data on present productive zone and proposed new productive zone. If proposal is to drill or deepen directionally, give pertinent data on subsurface locations and measured and true vertical depths. Give blowout preventer program, if any.

24.

SIGNED

Betty Seldon

TITLE Regulatory Analyst

DATE 2/18/92

(This space for Federal or State office use)

PERMIT NO.

APPROVAL DATE

APPROVED BY

Donald W. Mann

TITLE

DATE

3-11-92

CONDITIONS OF APPROVAL, IF ANY:

APPROVAL SUBJECT TO
GENERAL REQUIREMENTS AND
SPECIAL STIPULATIONS

*See Instructions On Reverse Side

Subject to
Like Approval
by State

Title 18 U.S.C. Section 1001, makes it a crime for any person knowingly and willfully to make to any department or agency of the United States any false, fictitious or fraudulent statements or representations as to any matter within its jurisdiction.

3/13/92 - orig to WFS
copies to RLI + WDS

OIL CONSERVATION DIVISION

P.O. Box 2088
Santa Fe, New Mexico 87504-2088

DISTRICT I

P.O. Box 1960, Hobbs, NM 88240

DISTRICT II

P.O. Drawer 88, Artesia, NM 86210

DISTRICT III

1000 Rio Brazos Rd., Artesia, NM 87410

WELL LOCATION AND ACREAGE DEDICATION PLAT

All Distances must be from the outer boundaries of the section

Operator Enron Oil & Gas Company			Lease Cedar Lake 35 Fed. Com.		Well No. 1
Unit Letter B	Section 35	Township 17 South	Range 30 East	NMPM	County Eddy

Actual Footage Location of Well:

1240 feet from the North line and		1980 feet from the East line	
Ground Level Elev. 3548.1	Producing Formation Devonian	Pool Wildcat	Dedicated Acreage: 320 N/2 Acres

1. Outline the acreage dedicated to the subject well by colored pencil or hatchure marks on the plat below.
2. If more than one lease is dedicated to the well, outline each and identify the ownership thereof (both as to working interest and royalty).
3. If more than one lease of different ownership is dedicated to the well, have the interest of all owners been consolidated by communization, unitization, force-pooling, etc.?
☐ Yes ☐ No If answer is "yes" type of consolidation _____

If answer is "no" list of owners and tract descriptions which have actually been consolidated. (Use reverse side of this form necessary.)

No allowable will be assigned to the well unit all interests have been consolidated (by communization, unitization, forced-pooling, otherwise) or until a non-standard unit, eliminating such interest, has been approved by the Division.

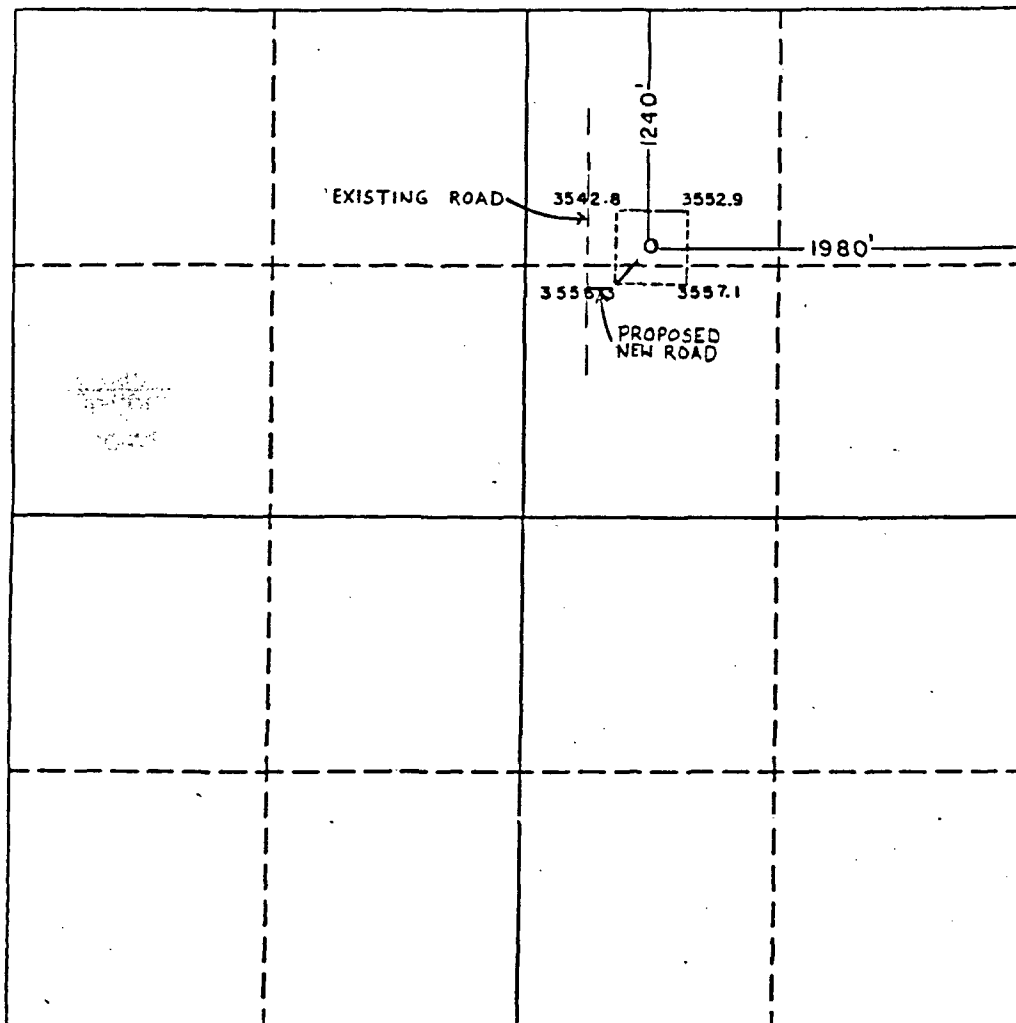

OPERATOR CERTIFICATION

I hereby certify the the information contained herein is true and complete to the best of my knowledge and belief.

Signature
Betty Gildon
Printed Name
Betty Gildon
Position
Regulatory Analyst
Company
Enron Oil & Gas Company
Date
2/11/92

SURVEYOR CERTIFICATION

I hereby certify that the well location shown on this plat was plotted from field notes of actual surveys made by me or under my supervision, and that the same is true and correct to the best of my knowledge and belief.

Date Surveyed
January 29, 1992

Signature & Seal of
Professional Surveyor

Ronald J. Edson
Certificate No. 678
JOHN F. WEST
RONALD J. EDSON, 3236
MEXICO
BARRY D. JONES, 7977
W-01092-AP-0112

County Eddy Pool Cedar Lake - Morrow Gas

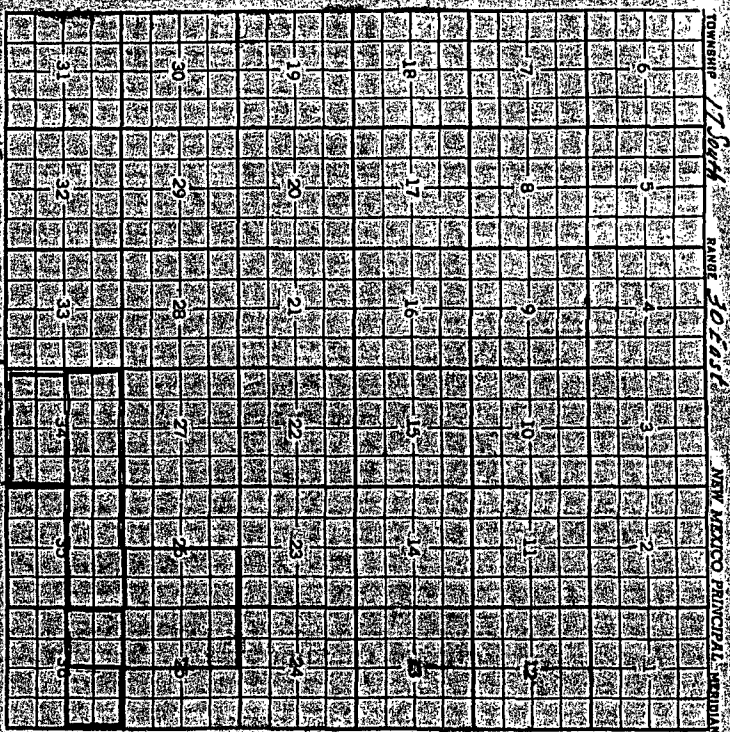

Ext. 0/1 Sec. 15, 16, 17, 18, 19, 20, 21, 22, 23, 24, 25, 26, 27, 28, 29, 30, 31, 32, 33, 34, 35, 36 (R-7009, 6-N-82)
Ext. 3/4 Sec. 11 (R-7009, 6-N-82)

County Eddy Pool Cedar Lake - Morrow Gas

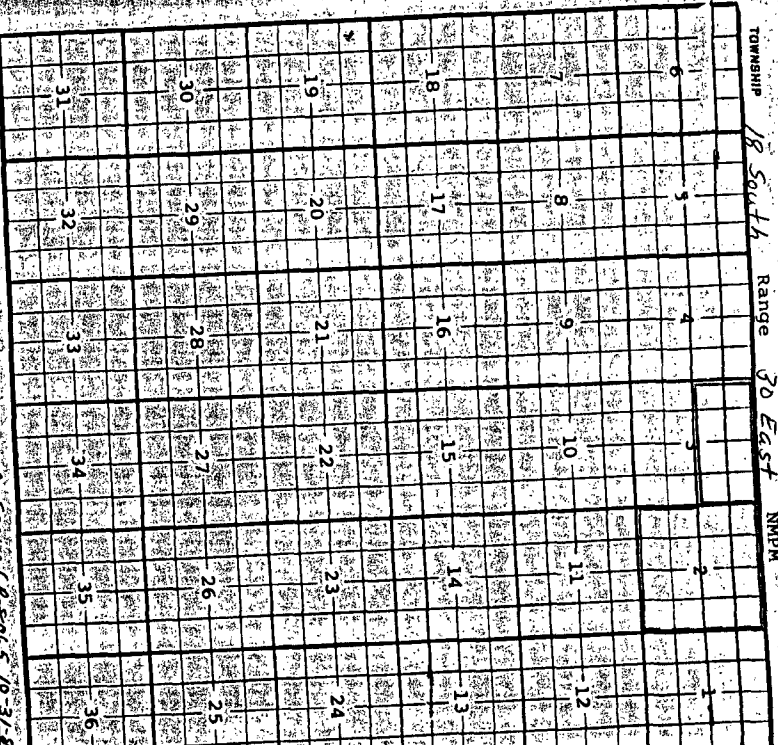

Ext. 0/1 Sec. 3 (R-7009, 6-N-82) Ext. 0/1 Sec. 2 (R-7009, 6-N-82)

ENRON
Oil & Gas Company

P. O. Box 2267 Midland, Texas 79702 (915) 686-3600

OIL CONSERVATION DIVISION
RECEIVED

'92 JUL 23 AM 8 41

June 15, 1992

Phillips Petroleum Company
4001 Penbrook
Odessa, Texas 79762
Attn: Mr. D. R. Weir

Arco Oil & Gas Company
P. O. Box 1610
Midland, Texas 79702
Attn: Mr. Padrick Pinkney

Weller Energy, Inc.
P. O. Box 1388
E. Orleans, MA 02643
Attn: Mr. Frank Weller

Oxy USA, Inc.
P. O. Box 50250
Midland, Texas 79710
Attn: Mr. Pat McGee

Anadarko Petroleum Company
P. O. Box 2497
400 W. Illinois, Ste 1300
Midland, Texas 79702
Attn: Mr. Mike Goode

Yates Petroleum
105 South 4th
Artesia, NM 88210
Attn: Mr. Randy Patterson

Re: Cedar Lake 35 Federal Com., Well No. 1
Sec 35, T17S, R30E, Eddy County, NM

Gentlemen:

Enron Oil & Gas Company has applied to the New Mexico Oil Conservation Division in Santa Fe, New Mexico to plug back to the Lower Morrow the unorthodox location for the above-named well as per the attached Application and location plat. If you, as offset operator, have no objection to this special permit, please sign in the space provided below, and return to my attention in the enclosed envelope.

Your early attention is appreciated.

Very truly yours,

ENRON OIL & GAS COMPANY

Betty Gildon
Regulatory Analyst

BG

DATE: 7/15/92

COMPANY: Weller Energy Inc

BY: Bonnie J. Weller
President

M-33-81

ENRON

Oil & Gas Company

P. O. Box 2267 Midland, Texas 79702 (915) 686-3600

June 15, 1992

Phillips Petroleum Company
4001 Penbrook
Odessa, Texas 79762
Attn: Mr. D. R. Weir

Arco Oil & Gas Company
P. O. Box 1610
Midland, Texas 79702
Attn: Mr. Padrick Pinkney

Weller Energy, Inc.
P. O. Box 1388
E. Orleans, MA 02643
Attn: Mr. Frank Weller

Oxy USA, Inc.
P. O. Box 50250
Midland, Texas 79710
Attn: Mr. Pat McGee

Anadarko Petroleum Company
P. O. Box 2497
✓ 400 W. Illinois, Ste 1300
Midland, Texas 79702
Attn: Mr. Mike Goode

Yates Petroleum
105 South 4th
Artesia, NM 88210
Attn: Mr. Randy Patterson

Re: Cedar Lake 35 Federal Com., Well No. 1
Sec 35, T17S, R30E, Eddy County, NM

Gentlemen:

Enron Oil & Gas Company has applied to the New Mexico Oil Conservation Division in Santa Fe, New Mexico to plug back to the Lower Morrow the unorthodox location for the above-named well as per the attached Application and location plat. If you, as offset operator, have no objection to this special permit, please sign in the space provided below, and return to my attention in the enclosed envelope.

Your early attention is appreciated.

Very truly yours,

ENRON OIL & GAS COMPANY

Betty Gildon
Regulatory Analyst

BG

DATE:

6-17-92

COMPANY:

ANADARKO PETROLEUM CORP.

BY:

MR. Goode

ENRON
Oil & Gas Company

P. O. Box 2267 Midland, Texas 79702 (915) 686-3600

June 23, 1992

Mewborne Oil Company
500 West Texas, Suite 1020
Midland, Texas 79701

Attn: Mr. Paul Haden

In Re: Cedar Lake 35 Federal Com, Well No. 1
Sec 35-17S-30E, Eddy County, NM

Dear Mr. Haden:

Enron Oil & Gas Company has applied to the New Mexico Oil Conservation Division in Santa Fe, New Mexico to plug back to the Lower Morrow the unorthodox location for the above-named well as per the attached application and location plat. If you, as offset operator, have no objection to this special permit, please sign in the space provided below, and return to my attention in the enclosed envelope.

Your early attention is appreciated.

Very truly yours,

ENRON OIL & GAS COMPANY

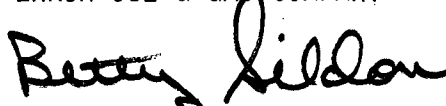

Betty Gildon
Regulatory Analyst

BG

enclosures

DATE: 6-24-92 COMPANY: Mewbourne Oil Co. BY: 

D. Paul Haden,
Landman

plat

ENRON
Oil & Gas Company

P. O. Box 2267 Midland, Texas 79702 (915) 686-3600

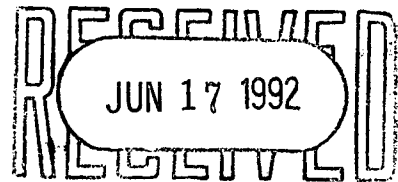

June 15, 1992

Phillips Petroleum Company
4001 Penbrook
Odessa, Texas 79762
Attn: Mr. D. R. Weir

Arco Oil & Gas Company
P. O. Box 1610
Midland, Texas 79702
Attn: Mr. Padrick Pinkney

Weller Energy, Inc.
P. O. Box 1388
E. Orleans, MA 02643
Attn: Mr. Frank Weller

Oxy USA, Inc.
P. O. Box 50250
Midland, Texas 79710
Attn: Mr. Pat McGee

Anadarko Petroleum Company
P. O. Box 2497
400 W. Illinois, Ste 1300
Midland, Texas 79702
Attn: Mr. Mike Goode

Yates Petroleum
105 South 4th
Artesia, NM 88210
Attn: Mr. Randy Patterson

Re: Cedar Lake 35 Federal Com., Well No. 1
Sec 35, T17S, R30E, Eddy County, NM

Gentlemen:

Enron Oil & Gas Company has applied to the New Mexico Oil Conservation Division in Santa Fe, New Mexico to plug back to the Lower Morrow the unorthodox location for the above-named well as per the attached Application and location plat. If you, as offset operator, have no objection to this special permit, please sign in the space provided below, and return to my attention in the enclosed envelope.

Your early attention is appreciated.

Very truly yours,

ENRON OIL & GAS COMPANY

Betty Gildon
Regulatory Analyst

BG

DATE: 6-30-92 COMPANY: YATES PETROLEUM CORP. BY: Randy Patterson

ENRON

Oil & Gas Company

P. O. Box 2267 Midland, Texas 79702 (915) 686-3600

June 15, 1992

Richard L. Ray
Richard L. Ray, Trustee
Fair Oil, Ltd.
225 S. College
Box 689
Tyler, Texas 75710

Lincoln Aston
P. O. Box 3048
LaJolla, Calif 92038

Sunwest Bank of Albuquerque as Ancillary
Personal Representative of the
Charles Albert Aston, Jr. Estate
P. O. Box 26900
Albuquerque, NM 87125

Rogers Aston
P. O. Box 1090
Roswell, NM 88202

Rogers Aston and
NCNB Texas National Bank as Co-Trustees
of the "C" Trusts U/W/O Bert Aston
P. O. Box 830308
Dallas, Texas 75283-0308

Sharon A. Olsen, Trustee Under Declaration of
Trust created by Sharon Aston Olsen, Trustor
P. O. Box 7296
Laguna Niguel, Calif. 92607-7296

Re: Cedar Lake 35 Federal Com., Well No. 1
Sec 35, T17S, R30E, Eddy County, NM

Gentlemen:

Enron Oil & Gas Company has applied to the New Mexico Oil Conservation Division in Santa Fe, New Mexico to plug back to the Lower Morrow the unorthodox location for the above-named well as per the attached Application and location plat. If you, as mineral interest owner, have no objection to this special permit, please sign in the space provided below, and return to my attention in the enclosed envelope.

Your early attention is appreciated.

Very truly yours,

ENRON OIL & GAS COMPANY



Betty Gildon
Regulatory Analyst

BG

DATE: 06-30-92 COMPANY: Richard L. Ray Trustee
Fair Oil, Ltd. &

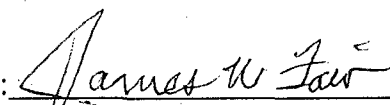
BY: 
James W. Fair, General Partner

ENRON
Oil & Gas Company

P. O. Box 2267 Midland, Texas 79702 (915) 686-3600

June 15, 1992

Richard L. Ray
Richard L. Ray, Trustee
Fair Oil, Ltd.
225 S. College
Box 689
Tyler, Texas 75710

Lincoln Aston
P. O. Box 3048
LaJolla, Calif 92038

Sunwest Bank of Albuquerque as Ancillary
Personal Representative of the
Charles Albert Aston, Jr. Estate
P. O. Box 26900
Albuquerque, NM 87125

Rogers Aston
P. O. Box 1090
Roswell, NM 88202

Rogers Aston and
NCNB Texas National Bank as Co-Trustees
of the "C" Trusts U/W/O Bert Aston
P. O. Box 830308
Dallas, Texas 75283-0308

Sharon A. Olsen, Trustee Under Declaration of
Trust created by Sharon Aston Olsen, Trustor
P. O. Box 7296
Laguna Niguel, Calif. 92607-7296

Re: Cedar Lake 35 Federal Com., Well No. 1
Sec 35, T17S, R30E, Eddy County, NM

Gentlemen:

Enron Oil & Gas Company has applied to the New Mexico Oil Conservation Division in Santa Fe, New Mexico to plug back to the Lower Morrow the unorthodox location for the above-named well as per the attached Application and location plat. If you, as mineral interest owner, have no objection to this special permit, please sign in the space provided below, and return to my attention in the enclosed envelope.

Your early attention is appreciated.

Very truly yours,

ENRON OIL & GAS COMPANY

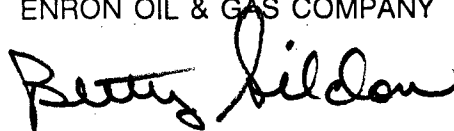

Betty Gildon
Regulatory Analyst

BG Sunwest Bank of Albuquerque, N.A., Agent
for Sunwest Bank of Roswell, N.A., Ancillary
Personal Rep. of the Charles Aston Estate

DATE: 6/23/92 COMPANY: _____

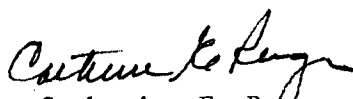
BY: Catherine E. Rugen, Trust
Officer

ENRON

Oil & Gas Company

P. O. Box 2267 Midland, Texas 79702 (915) 686-3600

June 15, 1992

Richard L. Ray
Richard L. Ray, Trustee
Fair Oil, Ltd.
225 S. College
Box 689
Tyler, Texas 75710

Lincoln Aston
P. O. Box 3048
LaJolla, Calif 92038

Sunwest Bank of Albuquerque as Ancillary
Personal Representative of the
Charles Albert Aston, Jr. Estate
P. O. Box 26900
Albuquerque, NM 87125

~~Rogers Aston~~
~~P. O. Box 1090~~
~~Roswell, NM 88202~~

Rogers Aston and
NCNB Texas National Bank as Co-Trustees
of the "C" Trusts U/W/O Bert Aston
P. O. Box 830308
Dallas, Texas 75283-0308

Sharon A. Olsen, Trustee Under Declaration of
Trust created by Sharon Aston Olsen, Trustor
P. O. Box 7296
Laguna Niguel, Calif. 92607-7296

Re: Cedar Lake 35 Federal Com., Well No. 1
Sec 35, T17S, R30E, Eddy County, NM

Gentlemen:

Enron Oil & Gas Company has applied to the New Mexico Oil Conservation Division in Santa Fe, New Mexico to plug back to the Lower Morrow the unorthodox location for the above-named well as per the attached Application and location plat. If you, as mineral interest owner, have no objection to this special permit, please sign in the space provided below, and return to my attention in the enclosed envelope.

Your early attention is appreciated.

Very truly yours,

ENRON OIL & GAS COMPANY



Betty Gildon
Regulatory Analyst

BG

DATE: June 18, 1992 COMPANY: Rogers Aston BY: _____

ENRON

Oil & Gas Company

P. O. Box 2267 Midland, Texas 79702 (915) 686-3600

June 15, 1992

Richard L. Ray
Richard L. Ray, Trustee
Fair Oil, Ltd.
225 S. College
Box 689
Tyler, Texas 75710

Rogers Aston
P. O. Box 1090
Roswell, NM 88202

Lincoln Aston
P. O. Box 3048
LaJolla, Calif 92038

Rogers Aston and
NCNB Texas National Bank as Co-Trustees
of the "C" Trusts U/W/O Bert Aston
P. O. Box 830308
Dallas, Texas 75283-0308

Sunwest Bank of Albuquerque as Ancillary
Personal Representative of the
Charles Albert Aston, Jr. Estate
P. O. Box 26900
Albuquerque, NM 87125

Sharon A. Olsen, Trustee Under Declaration of
Trust created by Sharon Aston Olsen, Trustor
P. O. Box 7296
Laguna Niguel, Calif. 92607-7296

Re: Cedar Lake 35 Federal Com., Well No. 1
Sec 35, T17S, R30E, Eddy County, NM

Gentlemen:

Enron Oil & Gas Company has applied to the New Mexico Oil Conservation Division in Santa Fe, New Mexico to plug back to the Lower Morrow the unorthodox location for the above-named well as per the attached Application and location plat. If you, as mineral interest owner, have no objection to this special permit, please sign in the space provided below, and return to my attention in the enclosed envelope.

Your early attention is appreciated.

Very truly yours,

ENRON OIL & GAS COMPANY



Betty Gildon
Regulatory Analyst

BG

DATE: 6/19/92 COMPANY: Sharon A. Olsen Trust BY: Sharon A. Olsen Trustee

ENRON
Oil & Gas Company

OIL CONSERVATION DIVISION
RECEIVED

92 JUN 29 AM 4 11

P. O. Box 2267 Midland, Texas 79702 (915) 686-3600

CERTIFIED MAIL

June 15, 1992

P-355-206-101

P 297 005 781
Phillips Petroleum Company
4001 Penbrook
Odessa, Texas 79762
Attn: Mr. D. R. Weir

~~Arco Oil & Gas Company~~ Mewborne bought out
~~P. O. Box 1610~~ Arco's interest
~~Midland, Texas 79702~~ (See Below)
~~Attn: Mr. Patrick Pinkney~~

P 537 062 980
Weller Energy, Inc.
P. O. Box 1388
E. Orleans, MA 02643
Attn: Mr. Frank Weller

P 355 206 102
Oxy USA, Inc.
P. O. Box 50250
Midland, Texas 79710
Attn: Mr. Pat McGee

P 537 062 981
Anadarko Petroleum Company
P. O. Box 2497
400 W. Illinois, Ste 1300
Midland, Texas 79702
Attn: Mr. Mike Goode

P 355 206 103
Yates Petroleum
105 South 4th
Artesia, NM 88210
Attn: Mr. Randy Patterson

Re: Cedar Lake 35 Federal Com., Well No. 1
Sec 35, T17S, R30E, Eddy County, NM

P 355 206 104
Mewborne Oil Company
500 West Texas, Ste 1020
Midland, Texas 79701
Attn: Paul Haden

Gentlemen:

Enron Oil & Gas Company has applied to the New Mexico Oil Conservation Division in Santa Fe, New Mexico to plug back to the Lower Morrow the unorthodox location for the above-named well as per the attached Application and location plat. If you, as offset operator, have no objection to this special permit, please sign in the space provided below, and return to my attention in the enclosed envelope.

Your early attention is appreciated.

Very truly yours,

ENRON OIL & GAS COMPANY



Betty Gildon
Regulatory Analyst

BG

DATE: _____ COMPANY: _____ BY: _____

● **SENDER:** Complete items 1 and 2 when additional services are desired, and complete items 3 and 4.

Put your address in the "RETURN TO" Space on the reverse side. Failure to do this will prevent this card from being returned to you. The return receipt fee will provide you the name of the person delivered to and the date of delivery. For additional fees the following services are available. Consult postmaster for fees and check box(es) for additional service(s) requested.

1. ☐ Show to whom delivered, date, and addressee's address. (Extra charge) 2. ☐ Restricted Delivery (Extra charge)

3. Article Addressed to:

Enron Oil & Gas Company
P. O. Box 2267
Midland, Texas 79702

Attn: Betty Gildon

4. Article Number

P106-675-302

Type of Service:

- ☐ Registered ☐ Insured
☒ Certified ☐ COD
☐ Express Mail ☐ Return Receipt for Merchandise

Always obtain signature of addressee or agent and **DATE DELIVERED**.

5. Signature - Address

X *[Signature]*

6. Signature - Agent

X

7. Date of Delivery **JUN 18 1992**

8. Addressee's Address (ONLY if requested and fee paid)