

12/7/07 DATE IN	SUSPENSE	W Sembo ENGINEER	12/7/07 LOGGED IN	DHC TYPE 3977	PKVRO734156380 APP NO.
--------------------	----------	---------------------	----------------------	---------------------	---------------------------

ABOVE THIS LINE FOR DIVISION USE ONLY

NEW MEXICO OIL CONSERVATION DIVISION

- Engineering Bureau -

1220 South St. Francis Drive, Santa Fe, NM 87505



ADMINISTRATIVE APPLICATION CHECKLIST

THIS CHECKLIST IS MANDATORY FOR ALL ADMINISTRATIVE APPLICATIONS FOR EXCEPTIONS TO DIVISION RULES AND REGULATIONS WHICH REQUIRE PROCESSING AT THE DIVISION LEVEL IN SANTA FE

Application Acronyms:

[NSL-Non-Standard Location] [NSP-Non-Standard Proration Unit] [SD-Simultaneous Dedication]
[DHC-Downhole Commingling] [CTB-Lease Commingling] [PLC-Pool/Lease Commingling]
[PC-Pool Commingling] [OLS - Off-Lease Storage] [OLM-Off-Lease Measurement]
[WFX-Waterflood Expansion] [PMX-Pressure Maintenance Expansion]
[SWD-Salt Water Disposal] [IPI-Injection Pressure Increase]
[EOR-Qualified Enhanced Oil Recovery Certification] [PPR-Positive Production Response]

[1] TYPE OF APPLICATION - Check Those Which Apply for [A]

[A] Location - Spacing Unit - Simultaneous Dedication
☐ NSL ☐ NSP ☐ SD

Check One Only for [B] or [C]

[B] Commingling - Storage - Measurement
 [X] DHC ☐ CTB ☐ PLC ☐ PC ☐ OLS ☐ OLM

[C] Injection - Disposal - Pressure Increase - Enhanced Oil Recovery
☐ WFX ☐ PMX ☐ SWD ☐ IPI ☐ EOR ☐ PPR

[D] Other: Specify _____

[2] NOTIFICATION REQUIRED TO: - Check Those Which Apply, or ☐ Does Not Apply

- [A] ☐ Working, Royalty or Overriding Royalty Interest Owners
 [B] ☐ Offset Operators, Leaseholders or Surface Owner
 [C] ☐ Application is One Which Requires Published Legal Notice
 [D] ☐ Notification and/or Concurrent Approval by BLM or SLO
U.S. Bureau of Land Management - Commissioner of Public Lands, State Land Office
 [E] ☐ For all of the above, Proof of Notification or Publication is Attached, and/or,
 [F] ☐ Waivers are Attached

[3] SUBMIT ACCURATE AND COMPLETE INFORMATION REQUIRED TO PROCESS THE TYPE OF APPLICATION INDICATED ABOVE.

[4] **CERTIFICATION:** I hereby certify that the information submitted with this application for administrative approval is **accurate** and **complete** to the best of my knowledge. I also understand that **no action** will be taken on this application until the required information and notifications are submitted to the Division.

Note: Statement must be completed by an individual with managerial and/or supervisory capacity.

Robert L. Verquer
Print or Type Name

Robert L. Verquer
Signature

Superintendent
Title

December 3, 2007
Date

caulkinsoil@qwestoffice.net
e-mail Address

RECEIVED
 2007 DEC 7 PM 2 56

Oil Conservation Division
1220 South St. Francis Dr.
Santa Fe, New Mexico 87505

APPLICATION TYPE
____ Single Well
____ Establish Pre-Approved Pools
EXISTING WELLBORE
____ X Yes ____ No

APPLICATION FOR DOWNHOLE COMMINGLING

Operator Caulkins Oil Company Address 1409 W. Aztec, Blvd., Suite 7, Aztec NM 87410

Lease BREECH Well No. 228 Unit Letter-Section-Township-Range UNIT A - SEC. 18-26N-6W County Rio Arriba

OGRID No. 003824 Property Code 2454 API No. 30-039-21533 Lease Type: X Federal ____ State ____ Fee

DATA ELEMENT	UPPER ZONE	INTERMEDIATE ZONE	INTERMEDIATE ZONE	LOWER ZONE
Pool Name	<i>SOUTH BLADE</i> Pictured Cliffs	Otero Chacra	Blanco Mesa Verde	Basin Dakota
Pool Code	72439	82329	72319	71599
Top and Bottom of Pay Section (Perforated or Open-Hole Interval)	2718' - 2816'	3600' - 3725'	4949' - 5070'	6979' - 7194'
Method of Production (Flowing or Artificial Lift)	Flowing	Flowing	Flowing	Flowing
Bottomhole Pressure (Note: Pressure data will not be required if the bottom perforation in the lower zone is within 150% of the depth of the top perforation in the upper zone)	N/A	N/A	N/A	N/A
Oil Gravity or Gas BTU (Degree API or Gas BTU)	1186	1186	1250	1250
Producing, Shut-In or New Zone	Producing	Producing	Producing	Producing
Date and Oil/Gas/Water Rates of Last Production.	Date: 12 month average	Date: 12 month average	Date: 12 month average	Date: 12 month average
(Note: For new zones with no production history, applicant shall be required to attach production estimates and supporting data.)	Rate: Avg. 12 month Gas Oil Water 31 0 0 MCF/D Bbl Bbl	Rate: Avg. 12 month Gas Oil Water 13 0 0 MCF/D Bbl Bbl	Rate: Avg. 12 month Gas Oil Water 9 .962 .139 MCF/D Bbl Bbl	Rate: Avg. 12 month Gas Oil Water 76 .337 .052 MCF/D Bbl Bbl
Fixed Allocation Percentage (Note: If allocation is based upon something other than current or past production, supporting data or explanation will be required.)	Gas Oil 24 % 0 %	Gas Oil 10 % 0 %	Gas Oil 7 % 74 %	Gas Oil 59 % 26 %

ADDITIONAL DATA

Are all working, royalty and overriding royalty interests identical in all commingled zones? Yes X No ____
If not, have all working, royalty and overriding royalty interest owners been notified by certified mail? Yes ____ No ____
Are all produced fluids from all commingled zones compatible with each other? Yes X No ____
Will commingling decrease the value of production? Yes ____ No X
If this well is on, or communitized with, state or federal lands, has either the Commissioner of Public Lands or the United States Bureau of Land Management been notified in writing of this application? Yes ____ No ____

NMOCD Reference Case No. applicable to this well: DHC-2031 and DHC-455-A

Attachments:
C-102 for each zone to be commingled showing its spacing unit and acreage dedication.
Production curve for each zone for at least one year. (If not available, attach explanation.)
For zones with no production history, estimated production rates and supporting data.
Data to support allocation method or formula.
Notification list of working, royalty and overriding royalty interests for uncommon interest cases.
Any additional statements, data or documents required to support commingling.

PRE-APPROVED POOLS

If application is to establish Pre-Approved Pools, the following additional information will be required:

List of other orders approving downhole commingling within the proposed Pre-Approved Pools
List of all operators within the proposed Pre-Approved Pools
Proof that all operators within the proposed Pre-Approved Pools were provided notice of this application.
Bottomhole pressure data.

I hereby certify that the information above is true and complete to the best of my knowledge and belief.

SIGNATURE Robert L. Verquer TITLE Superintendent DATE December 3, 2007
TYPE OR PRINT NAME Robert L. Verquer TELEPHONE NO. (505) 334-4323

UNITED STATES
DEPARTMENT OF THE INTERIOR
BUREAU OF LAND MANAGEMENT

SUNDRY NOTICES AND REPORTS ON WELLS

(Do not use this form for proposals to drill or to deepen or plug back to a different reservoir. Use "APPLICATION FOR PERMIT--" for such proposals)

5. Lease

NMNM-03733

6. If Indian, Allottee or Tribe Name

7. Unit Agreement Name

1. Oil Well ☐ Gas Well ☐ Other ☐
GAS WELL

8. Well Name and No.

BREECH 228

2. Name of Operator:

Caulkins Oil Company

9. API Well No.

30-039-21533-00C1

3. Address of Operator:

(505) 334-4323

1409 W. Aztec Blvd. Ste B7, Aztec, NM 87410

10. Field and Pool, Exploratory Area

DAKOTA, MESA VERDE, CHACRA,
PICTURED CLIFFS

4. Location of Well (Footage, Sec., Twp., Rge.)

830' F/N 830' F/E

SEC. 18-26N-6W

11. Country or Parish, State

Rio Arriba Co., New Mexico

12. CHECK APPROPRIATE BOX(s) TO INDICATE NATURE OF NOTICE, REPORT, OR OTHER DATA

TYPE OF SUBMISSION

TYPE OF ACTION

☒ Notice of Intent

☐ Abandonment

☐ Change of Plans

☐ Subsequent Report

☐ Recompletion

☐ New Construction

☐ Plugging Back

☐ Non-Routine Fracturing

☐ Casing Repair

☐ Water Shut-Off

☐ Final Abandonment Notice

☐ Altering Casing

☐ Conversion to Injection

☒ Other Downhole Commingle

☐ Dispose Water

17. Describe Proposed or Completed Operations:

12-3-07

We request approval to downhole commingle this well in the Dakota, Mesa Verde, Otero Chacra and Pictured Cliffs formations by the following procedure:

Rig. up.

T.O.H. laying down 3755' of 1 1/4" tubing.

T.O.H. laying down 7131' of 1 1/2" tubing with model R-3 packer.

T.I.H. with mill in 2 3/8" tubing.

Mill out model "D" packer set at 5101' with air foam unit.

Clean out to 7325' (PBTD) with air package.

T.O.H. with mill.

T.I.H. with new 2 3/8" production tubing.

Land tubing on doughnut at approximately 7150'.

Rig down and move.

NOTE: The format is issued in lieu of U.S. BLM Form 3160-5

18. I HEREBY CERTIFY THE FOREGOING IS TRUE AND CORRECT

SIGNED:

ROBERT L. VERQUER

TITLE: Superintendent

DATE: December 3, 2007

APPROVED BY:

TITLE:

DATE:

CONDITIONS OF APPROVAL, IF ANY

WELL LOCATION AND ACREAGE DEDICATION PLAT

¹ API Number 30-039-21533	² Pool Code 72439	³ Pool Name PICTURED CLIFFS
⁴ Property Code 2454	⁵ Property Name BREECH	
⁷ OGRID No. 003824	⁸ Operator Name Caulkins Oil Company	
		⁶ Well Number 228
		⁹ Elevation 6384 GR

¹⁰ Surface Location

UL or lot no.	Section	Township	Range	Lot Idn	Feet from the	North/South line	Feet from the	East/West line	County
A	18	26N	6W		830'	North	830'	East	Rio Arriba

¹¹ Bottom Hole Location If Different From Surface

UL or lot no.	Section	Township	Range	Lot Idn	Feet from the	North/South line	Feet from the	East/West line	County

¹² Dedicated Acres	¹³ Joint or Infill	¹⁴ Consolidation Code	¹⁵ Order No.

NO ALLOWABLE WILL BE ASSIGNED TO THIS COMPLETION UNTIL ALL INTERESTS HAVE BEEN CONSOLIDATED OR A NON-STANDARD UNIT HAS BEEN APPROVED BY THE DIVISION

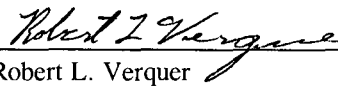
16				830'	Breech 228	¹⁷ OPERATOR CERTIFICATION I hereby certify that the information contained herein is true and complete to the best of my knowledge and belief, and this organization either owns a working interest or unleased mineral interest in the land including the proposed bottom hole location or has a right to drill the well at this location pursuant to a contract with an owner of such a mineral or working interest, or to a voluntary pooling agreement or a compulsory pooling under heretofore entered by the division.  Robert L. Verquer Superintendent Date: December 3, 2007
				830'		
				1122'	Breech 228-M	¹⁸ SURVEYOR CERTIFICATION I hereby certify that the well location shown on this plat was plotted from field notes of actual surveys made by me or under my supervision, and that the same is true and correct to the best of my belief. Date of Survey Signature and Seal of Professional Surveyor Certificate Number
				1520'		

WELL LOCATION AND ACREAGE DEDICATION PLAT

¹ API Number 30-039-21533		² Pool Code 82329		³ Pool Name OTERO CHACRA	
⁴ Property Code 2454		⁵ Property Name BREECH			⁶ Well Number 228
⁷ OGRID No. 003824		⁸ Operator Name Caulkins Oil Company			⁹ Elevation 6384 GR

¹⁰ Surface Location

UL or lot no. A	Section 18	Township 26N	Range 6W	Lot Idn	Feet from the 830'	North/South line North	Feet from the 830'	East/West line East	County Rio Arriba
--------------------	---------------	-----------------	-------------	---------	-----------------------	---------------------------	-----------------------	------------------------	----------------------

¹¹ Bottom Hole Location If Different From Surface

UL or lot no.	Section	Township	Range	Lot Idn	Feet from the	North/South line	Feet from the	East/West line	County
¹² Dedicated Acres		¹³ Joint or Infill		¹⁴ Consolidation Code		¹⁵ Order No.			

NO ALLOWABLE WILL BE ASSIGNED TO THIS COMPLETION UNTIL ALL INTERESTS HAVE BEEN CONSOLIDATED OR A NON-STANDARD UNIT HAS BEEN APPROVED BY THE DIVISION

16

830'

Breech 228

830'

1122'

Breech 228-M

1520'

¹⁷ OPERATOR CERTIFICATION

I hereby certify that the information contained herein is true and complete to the best of my knowledge and belief, and this organization either owns a working interest or unleased mineral interest in the land including the proposed bottom hole location or has a right to drill the well at this location pursuant to a contract with an owner of such a mineral or working interest, or to a voluntary pooling agreement or a compulsory pooling under heretofore entered by the division.

Robert L. Verquer

Superintendent

Date: December 3, 2007

¹⁸ SURVEYOR CERTIFICATION

I hereby certify that the well location shown on this plat was plotted from field notes of actual surveys made by me or under my supervision, and that the same is true and correct to the best of my belief.

Date of Survey

Signature and Seal of Professional Surveyor

Certificate Number

District I

State of New Mexico

Form C-102

PO Box 1980, Hobbs, NM 88241-1980

Energy, Minerals & Natural Resources Department

Revised October 18, 1994

District II

Instructions on back

811 South First, Artesia, NM 88210

OIL CONSERVATION DIVISION

Submit to Appropriate District Office

District III

1220 South St. Francis Drive

State Lease - 4 Copies

1000 Rio Brazos Rd., Aztec, NM 87410

Santa Fe, NM 87504

Fee Lease - 3 Copies

District IV

2040 South Pacheco, Santa Fe, NM 87505



AMENDED REPORT

WELL LOCATION AND ACREAGE DEDICATION PLAT

¹ API Number 30-039-21533	² Pool Code 72319	³ Pool Name MESA VERDE
⁴ Property Code 2454	⁵ Property Name BREECH	⁶ Well Number 228
⁷ OGRID No. 003824	⁸ Operator Name Caulkins Oil Company	⁹ Elevation 6384 GR

¹⁰ Surface Location

UL or lot no. A	Section 18	Township 26N	Range 6W	Lot Idn	Feet from the 830'	North/South line North	Feet from the 830'	East/West line East	County Rio Arriba
---------------------------	----------------------	------------------------	--------------------	---------	------------------------------	----------------------------------	------------------------------	-------------------------------	-----------------------------

¹¹ Bottom Hole Location If Different From Surface

UL or lot no.	Section	Township	Range	Lot Idn	Feet from the	North/South line	Feet from the	East/West line	County
¹² Dedicated Acres	¹³ Joint or Infill	¹⁴ Consolidation Code	¹⁵ Order No.						

NO ALLOWABLE WILL BE ASSIGNED TO THIS COMPLETION UNTIL ALL INTERESTS HAVE BEEN CONSOLIDATED OR A NON-STANDARD UNIT HAS BEEN APPROVED BY THE DIVISION

¹⁶				830' Breech 228 830'	¹⁷ OPERATOR CERTIFICATION <i>I hereby certify that the information contained herein is true and complete to the best of my knowledge and belief, and this organization either owns a working interest or unleased mineral interest in the land including the proposed bottom hole location or has a right to drill the well at this location pursuant to a contract with an owner of such a mineral or working interest, or to a voluntary pooling agreement or a compulsory pooling under heretofore entered by the division.</i> <i>Robert L. Verquer</i> Robert L. Verquer Superintendent Date: December 3, 2007
				1122' Breech 228-M 1520'	¹⁸ SURVEYOR CERTIFICATION <i>I hereby certify that the well location shown on this plat was plotted from field notes of actual surveys made by me or under my supervision, and that the same is true and correct to the best of my belief.</i> Date of Survey Signature and Seal of Professional Surveyor Certificate Number

WELL LOCATION AND ACREAGE DEDICATION PLAT

¹ API Number 30-039-21533	² Pool Code 71599	³ Pool Name BASIN DAKOTA
⁴ Property Code 2454	⁵ Property Name BREECH	⁶ Well Number 228
⁷ OGRID No. 003824	⁸ Operator Name Caulkins Oil Company	⁹ Elevation 6384 GR

¹⁰ Surface Location									
UL or lot no. A	Section 18	Township 26N	Range 6W	Lot Idn	Feet from the 830'	North/South line North	Feet from the 830'	East/West line East	County Rio Arriba

¹¹ Bottom Hole Location If Different From Surface									
UL or lot no.	Section	Township	Range	Lot Idn	Feet from the	North/South line	Feet from the	East/West line	County
¹² Dedicated Acres	¹³ Joint or Infill	¹⁴ Consolidation Code		¹⁵ Order No.					

NO ALLOWABLE WILL BE ASSIGNED TO THIS COMPLETION UNTIL ALL INTERESTS HAVE BEEN CONSOLIDATED OR A NON-STANDARD UNIT HAS BEEN APPROVED BY THE DIVISION

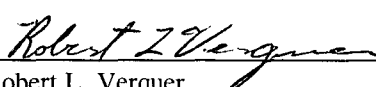
16				830' Breech 228	¹⁷ OPERATOR CERTIFICATION I hereby certify that the information contained herein is true and complete to the best of my knowledge and belief, and this organization either owns a working interest or unleased mineral interest in the land including the proposed bottom hole location or has a right to drill the well at this location pursuant to a contract with an owner of such a mineral or working interest, or to a voluntary pooling agreement or a compulsory pooling under heretofore entered by the division.  Robert L. Verquer Superintendent Date: December 3, 2007
				830'	
				1122'	¹⁸ SURVEYOR CERTIFICATION I hereby certify that the well location shown on this plat was plotted from field notes of actual surveys made by me or under my supervision, and that the same is true and correct to the best of my belief. Date of Survey Signature and Seal of Professional Surveyor Certificate Number
				Breech 228-M 1520'	

**NEW MEXICO OIL CONSERVATION COMMISSION
WELL LOCATION AND ACREAGE DEDICATION PLAT**

Form C-102
Supersedes C-128
Effective 1-1-65

All distances must be from the outer boundaries of the Section.

Operator Caulkins Oil Company		Lease NM 03733 (Breech)		Well No. 228
Unit Letter A	Section 18	Township 26 North	Range 6 West	County Rio Arriba
Actual Footage Location of Well: 830 feet from the North line and 830 feet from the East line				
Ground Level Elev. 6384	Producing Formation Pictured Cliffs		Pool South Blanco	Dedicated Acreage: 160 Acres

1. Outline the acreage dedicated to the subject well by colored pencil or hatchure marks on the plat below.
2. If more than one lease is dedicated to the well, outline each and identify the ownership thereof (both as to working interest and royalty).
3. If more than one lease of different ownership is dedicated to the well, have the interests of all owners been consolidated by communitization, unitization, force-pooling, etc?

☐ Yes ☐ No If answer is "yes," type of consolidation _____

If answer is "no," list the owners and tract descriptions which have actually been consolidated. (Use reverse side of this form if necessary.) _____

No allowable will be assigned to the well until all interests have been consolidated (by communitization, unitization, forced-pooling, or otherwise) or until a non-standard unit, eliminating such interests, has been approved by the Commission.

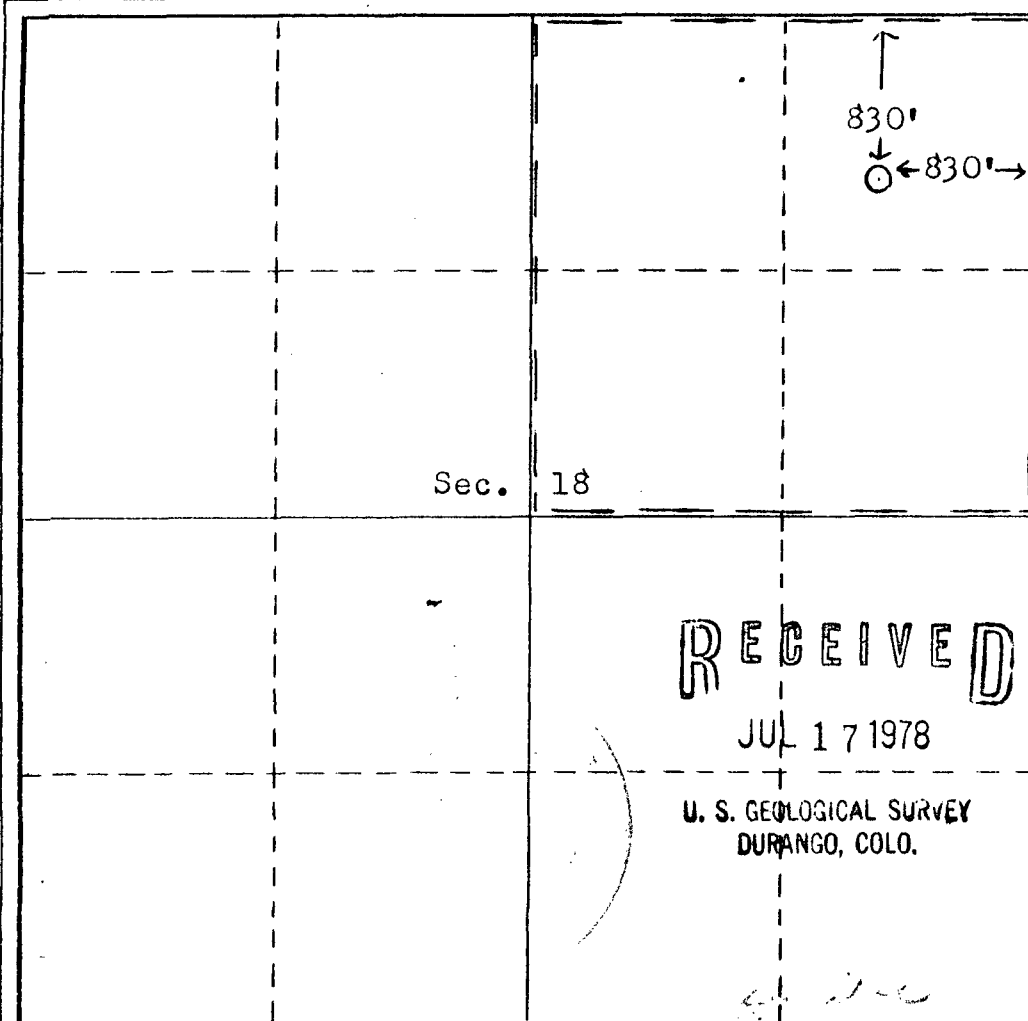

CERTIFICATION

I hereby certify that the information contained herein is true and complete to the best of my knowledge and belief.

Name *Charles J. Jarama*
Position Superintendent

Company Caulkins Oil Co.

Date July 12, 1978

I hereby certify that the well location shown on this plat was plotted from field notes of actual surveys made by me or under my supervision, and that the same is true and correct to the best of my knowledge and belief.

C005338

Date Surveyed October 18, 1977

Registered Professional Engineer and/or Land Surveyor

E. V. Echohawk

Certificate No. **3602**

0 330 660 990 1320 1650 1980 2310 2640 2000 1500 1000 500 0

**NEW MEXICO OIL CONSERVATION COMMISSION
WELL LOCATION AND ACREAGE DEDICATION PLAT**

Form C-102
Supersedes C-128
Effective 1-1-65

All distances must be from the outer boundaries of the Section.

Operator Caulkins Oil Company			Lease NM 03733 (Breech)		Well No. 228
Unit Letter A	Section 18	Township 26 North	Range 6 West	County Idio Arriba	
Actual Footage Location of Well:					
Ground Level Elev. 6384	Producing Formation Chacra	Pool Otero Chacra	Dedicated Acreage: 160 Acres		

1. Outline the acreage dedicated to the subject well by colored pencil or hatchure marks on the plat below.
2. If more than one lease is dedicated to the well, outline each and identify the ownership thereof (both as to working interest and royalty).
3. If more than one lease of different ownership is dedicated to the well, have the interests of all owners been consolidated by communitization, unitization, force-pooling, etc?

☐ Yes ☐ No If answer is "yes," type of consolidation _____

If answer is "no," list the owners and tract descriptions which have actually been consolidated. (Use reverse side of this form if necessary.) _____

No allowable will be assigned to the well until all interests have been consolidated (by communitization, unitization, forced-pooling, or otherwise) or until a non-standard unit, eliminating such interests, has been approved by the Commission.

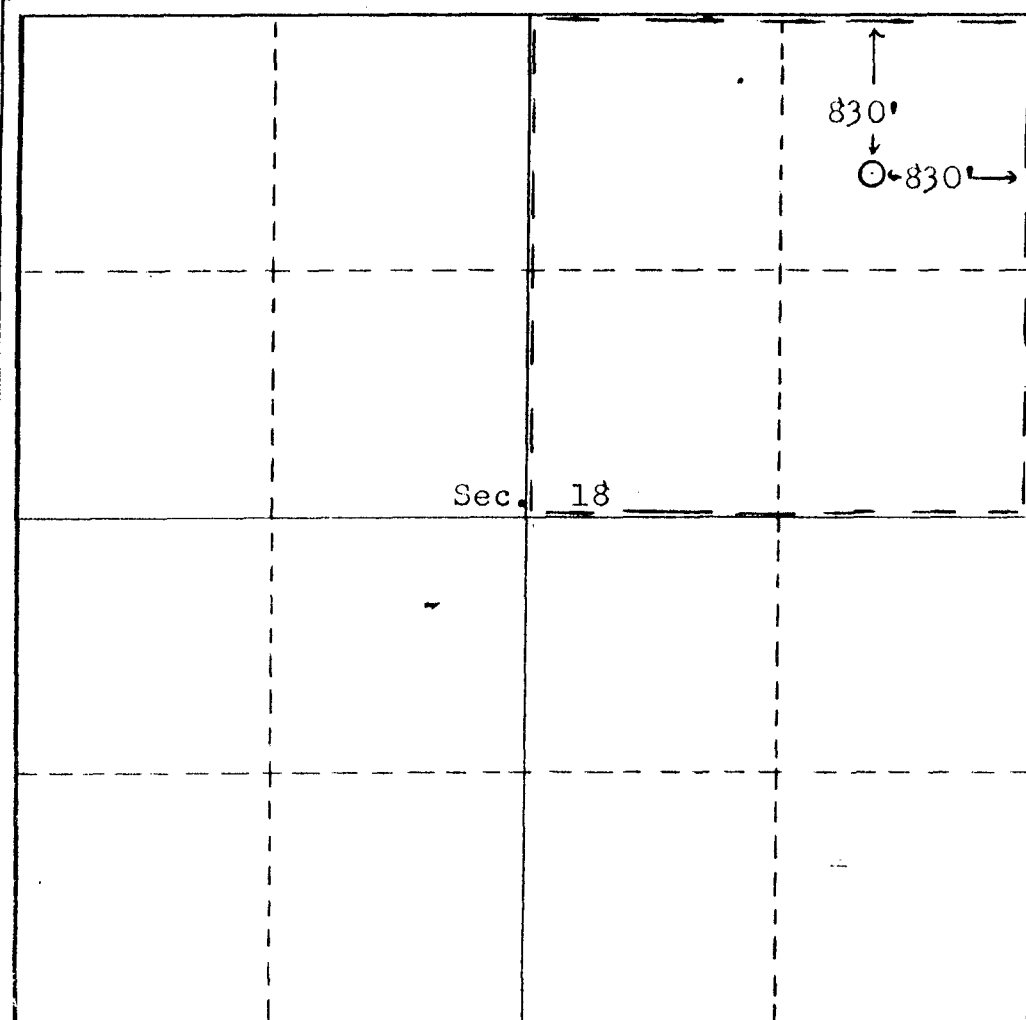

CERTIFICATION

I hereby certify that the information contained herein is true and complete to the best of my knowledge and belief.

Name: *Charles Verguer*
Position: _____

Superintendent

Company: **Caulkins Oil Co.**

Date: **July 12, 1978**

I hereby certify that the well location shown on this plat was plotted from field notes of actual surveys made by me or under my supervision, and that the same is true and correct to the best of my knowledge and belief.

C005339

Date Surveyed: **October 18, 1978**

Registered Professional Engineer and/or Land Surveyor

E. V. Echohawk

Certificate No. **3602**

0 330 660 990 1320 1650 1980 2310 2640 2000 1500 1000 500 0

**NEW MEXICO OIL CONSERVATION COMMISSION
WELL LOCATION AND ACREAGE DEDICATION PLAT**

Form C-102
Supersedes C-128
Effective 1-1-65

All distances must be from the outer boundaries of the Section.

Operator Caulkins Oil Company			Lease NM 03733 (Breech)		Well No. 228
Unit Letter A	Section 18	Township 26N	Range 6W	County Rio Arriba	
Actual Footage Location of Well: <div style="display: flex; justify-content: space-between; align-items: center;"> 830 feet from the North line and 830 feet from the East line </div>					
Ground Level Elev. 6384	Producing Formation Mesa Verde	Pool Blanco Mesa Verde		Dedicated Acreage: 320 Acres	

1. Outline the acreage dedicated to the subject well by colored pencil or hachure marks on the plat below.
2. If more than one lease is dedicated to the well, outline each and identify the ownership thereof (both as to working interest and royalty).
3. If more than one lease of different ownership is dedicated to the well, have the interests of all owners been consolidated by communitization, unitization, force-pooling, etc?

☐ Yes ☐ No If answer is "yes," type of consolidation _____

If answer is "no," list the owners and tract descriptions which have actually been consolidated. (Use reverse side of this form if necessary.) _____

No allowable will be assigned to the well until all interests have been consolidated (by communitization, unitization, forced-pooling, or otherwise) or until a non-standard unit, eliminating such interests, has been approved by the Commission.

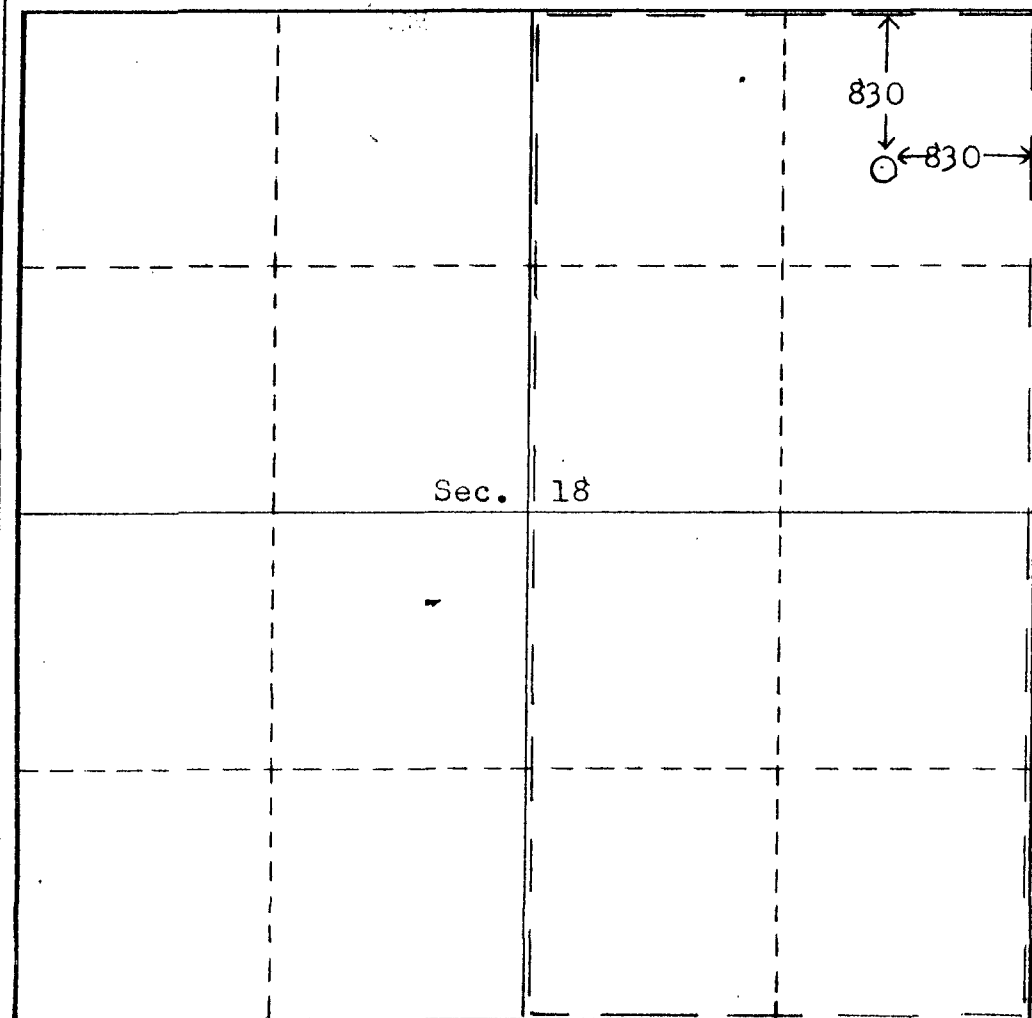

CERTIFICATION

I hereby certify that the information contained herein is true and complete to the best of my knowledge and belief.

Name *Charles Vergara*
Position **Superintendent**

Company **Caulkins Oil Co.**

Date **July 12, 1978**

I hereby certify that the well location shown on this plat was plotted from field notes of actual surveys made by me or under my supervision, and that the same is true and correct to the best of my knowledge and belief.

C005340

Date Surveyed **October 18, 1977**

Registered Professional Engineer and/or Land Surveyor

E. V. Echohawk

Certificate No. **3602**

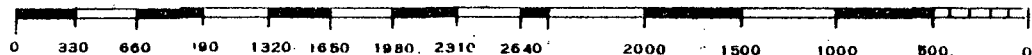

NEW MEXICO OIL CONSERVATION COMMISSION
WELL LOCATION AND ACREAGE DEDICATION PLAT

Form C-102
Supersedes C-128
Effective 1-1-65

All distances must be from the outer boundaries of the Section.

Operator Caulkins Oil Company		Lease NM 03733		Well No. 228
Unit Letter A	Section 18	Township 26 North	Range 6 West	County Rio Arriba
Actual Footage Location of Well:				
830	feet from the North	line and	830	feet from the East
Ground Level Elev. 6384	Producing Formation Basin Dakota	Pool Basin Dakota	Dedicated Acreage: 320 Acres	

1. Outline the acreage dedicated to the subject well by colored pencil or hatchure marks on the plat below.
2. If more than one lease is dedicated to the well, outline each and identify the ownership thereof (both as to working interest and royalty).
3. If more than one lease of different ownership is dedicated to the well, have the interests of all owners been consolidated by communitization, unitization, force-pooling, etc?

☐ Yes ☐ No If answer is "yes," type of consolidation _____

If answer is "no," list the owners and tract descriptions which have actually been consolidated. (Use reverse side of this form if necessary.) _____

No allowable will be assigned to the well until all interests have been consolidated (by communitization, unitization, forced-pooling, or otherwise) or until a non-standard unit, eliminating such interests, has been approved by the Commission.

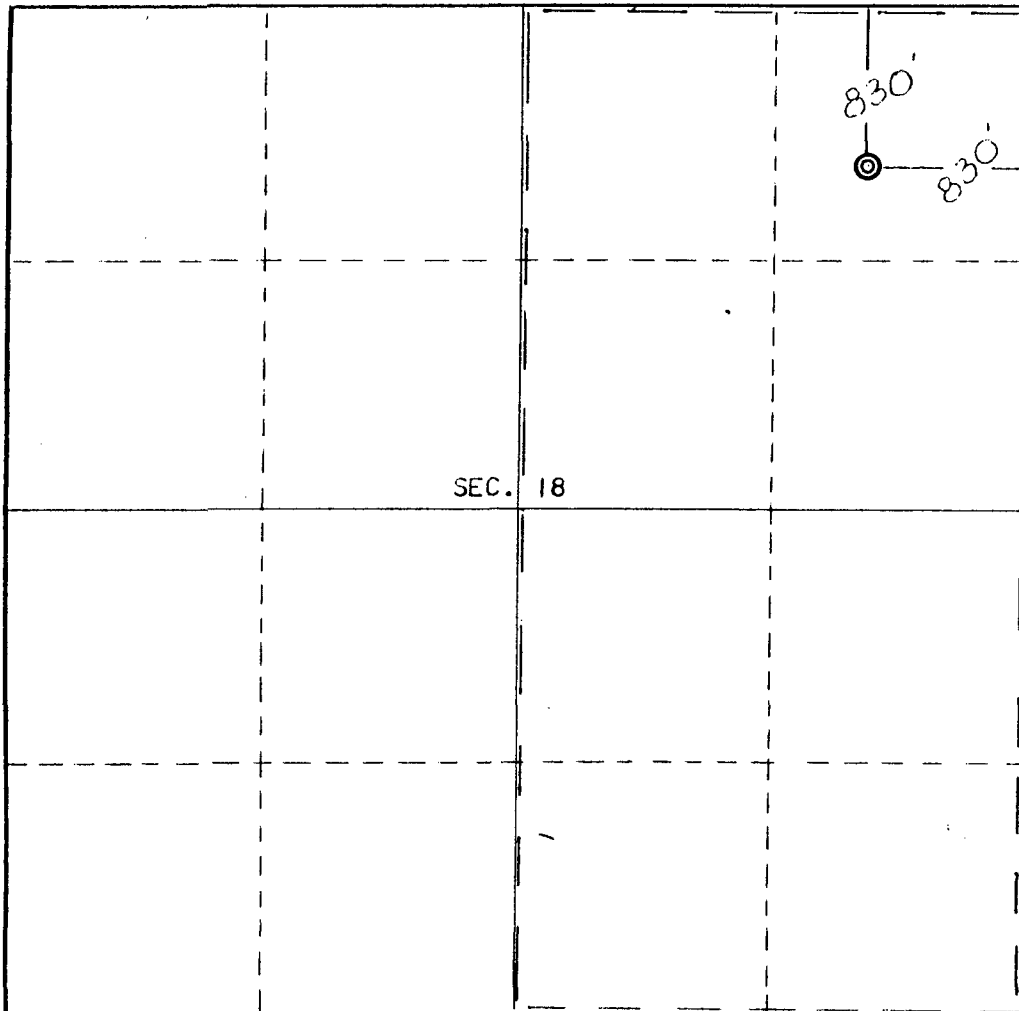

CERTIFICATION

I hereby certify that the information contained herein is true and complete to the best of my knowledge and belief.

Name: Charles E. Echowhawk
Position: Superintendent

Company: Caulkins Oil Company

Date: Oct. 26, 1977

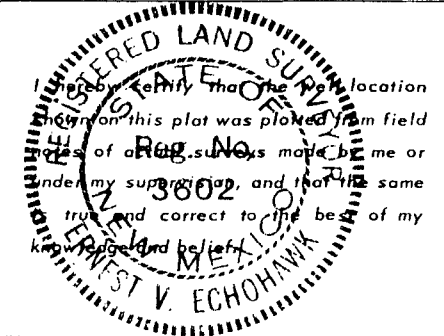

Date Surveyed: October 18, 1977

Registered Professional Engineer and/or Land Surveyor: C005341

Certificate No. 3602
E.V. Echowhawk LS

0 330 660 990 1320 1650 1980 2310 2640 2000 1500 1000 500 0

**LAST 12-MONTHS PRODUCTION
FOR
BREECH 228**

DAKOTA

MONTH	GAS	OIL	WATER	DAYS	GAS DPA	OIL DPA
10/06	2,225	6	1	27	82	0.222
11/06	2,195	12	2	30	73	0.400
12/06	1,767	6	1	25	71	0.240
01/07	2,543	7	1	29	88	0.241
02/07	2,425	9	1	28	87	0.321
03/07	2,265	11	2	31	73	0.355
04/07	2,217	10	2	30	74	0.333
05/07	2,303	15	2	31	74	0.484
06/07	2,252	11	2	30	75	0.367
07/07	2,346	11	2	31	76	0.355
08/07	2,294	13	2	31	74	0.419
09/07	1,894	9	1	29	65	0.310
	26,726	120	19		76	0.337

MESA VERDE

MONTH	GAS	OIL	WATER	DAYS	GAS DPA	OIL DPA
10/06	271	18	3	27	10	0.667
11/06	267	33	5	30	9	1.100
12/06	214	17	3	25	9	0.680
01/07	310	20	3	29	11	0.690
02/07	295	26	4	28	11	0.929
03/07	275	30	4	31	9	0.968
04/07	270	30	4	30	9	1.000
05/07	280	43	6	31	9	1.387
06/07	274	29	4	30	9	0.967
07/07	285	33	5	31	9	1.065
08/07	279	38	6	31	9	1.226
09/07	230	25	4	29	8	0.862
	3,250	342	51		9	0.962

**LAST 12-MONTHS PRODUCTION
FOR
BREECH 228**

PICTURED CLIFFS

MONTH	GAS	OIL	WATER	DAYS	GAS DPA	OIL DPA
10/06	919	0	0	26	35	0.000
11/06	953	0	0	30	32	0.000
12/06	759	0	0	25	30	0.000
01/07	904	0	0	31	29	0.000
02/07	865	0	0	28	31	0.000
03/07	965	0	0	31	31	0.000
04/07	964	0	0	30	32	0.000
05/07	997	0	0	31	32	0.000
06/07	967	0	0	30	32	0.000
07/07	777	0	0	28	28	0.000
08/07	972	0	0	31	31	0.000
09/07	924	0	0	29	32	0.000
	10,966	0	0		31	0.000

OTERO CHACRA

MONTH	GAS	OIL	WATER	DAYS	GAS DPA	OIL DPA
10/06	384	0	0	26	15	0.000
11/06	397	0	0	30	13	0.000
12/06	315	0	0	25	13	0.000
01/07	375	0	0	31	12	0.000
02/07	360	0	0	28	13	0.000
03/07	401	0	0	31	13	0.000
04/07	402	0	0	30	13	0.000
05/07	415	0	0	31	13	0.000
06/07	403	0	0	30	13	0.000
07/07	322	0	0	28	12	0.000
08/07	404	0	0	31	13	0.000
09/07	385	0	0	29	13	0.000
	4,563	0	0		13	0.000