

GW-4

RECEIVED

OCT 13 2003

Oil Conservation Division
Environmental Bureau

Groundwater Investigation
Summary Report

ChevronTexaco Eunice #2 (North) Plant
Eunice, Lea County, New Mexico

REPORTS

Volume 2
Figures

10/13/2003

October 9, 2003

PREPARED FOR

ChevronTexaco Exploration & Production
Company

ARCADIS
Infrastructure, buildings, environment, communications

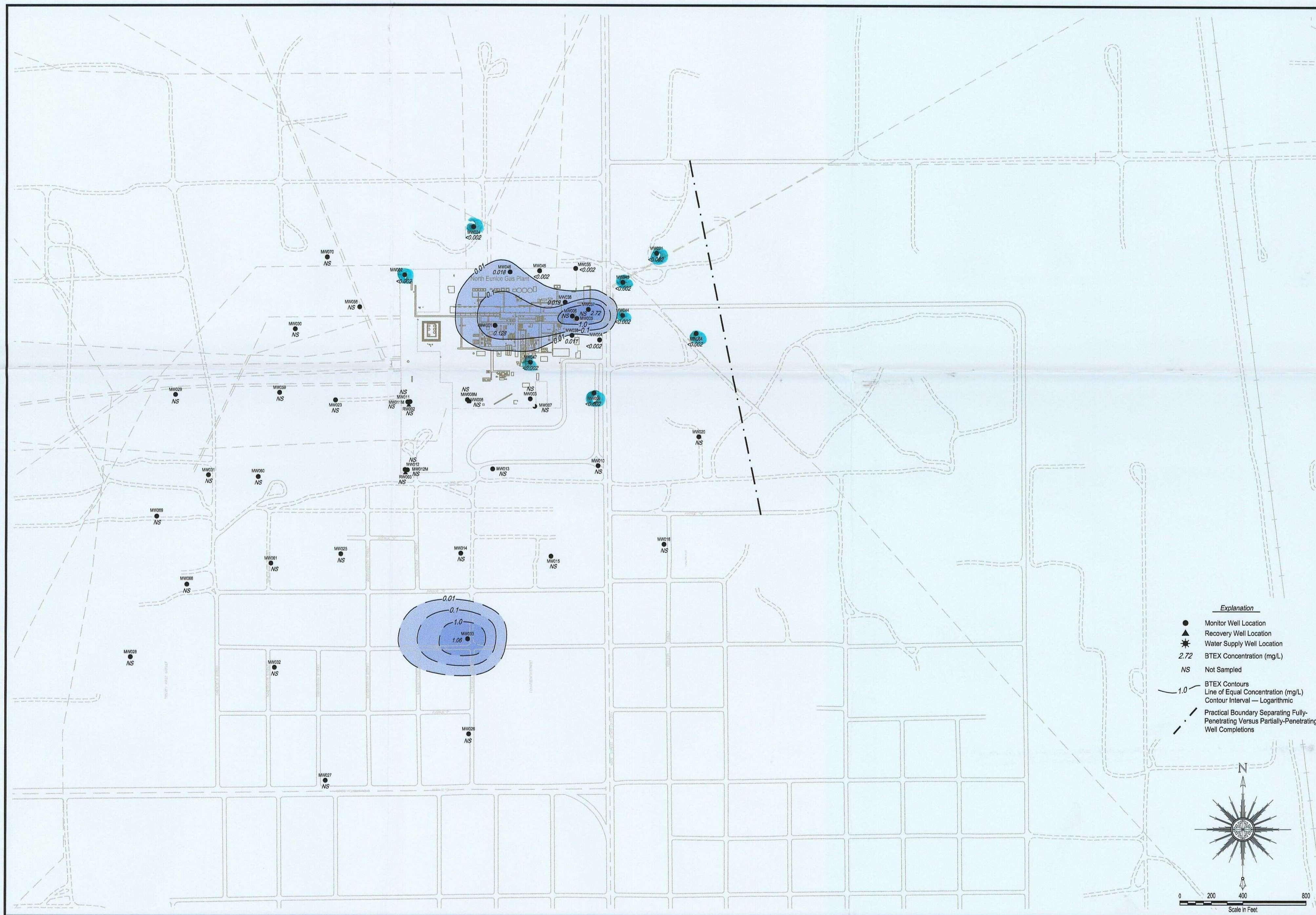

- Explanation**
- Monitor Well Location
 - ▲ Recovery Well Location
 - ★ Water Supply Well Location
 - 2.72 BTEX Concentration (mg/L)
 - NS Not Sampled
 - BTEX Contours
 - Line of Equal Concentration (mg/L)
 - Contour Interval — Logarithmic
 - - - Practical Boundary Separating Fully-Penetrating Versus Partially-Penetrating Well Completions

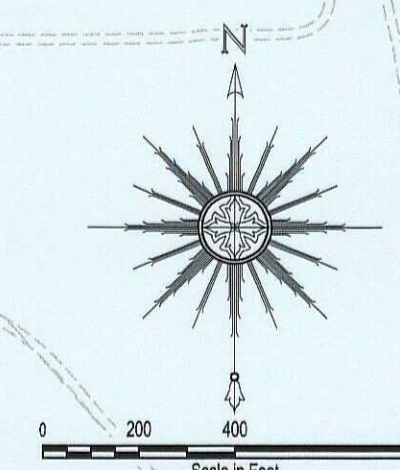

copyright © 2003



1004 N. Big Spring Street, Suite 300
Midland, TX 79701-3383
Tel 432 687 5400 Fax 432 687 5401

Drawn By
H. Clardy

Drawing Date
29 September 2003

File Location
\\AutoCAD\\DWG\\ChevronTexaco\\North Eunice\\MT000700.004

File Name
MT700483.dwg

Unique Number
31-014-00543

Project Director
M. Hagan

Area Manager
A. Schmidt

Task Manager
L. Markham

Technical Review
S. Tischer

Project Number
MT000700.0004

Figure
65

ChevronTexaco Exploration & Production Company
North Eunice Plant Groundwater Investigation
Shallow Groundwater Isoconcentration (May, 2003)
BTEX (mg/L)
Eunice #2 (North) Gas Plant, Lea County, New Mexico