

QUALITY PRODUCTION CORP.

707 Shell Avenue
Post Office Box 50128
Midland, Texas 79710-0128
(915) 686-0778
FAX (915) 686-1057

611 West Mahone
Post Office Box 1412
Artesia, New Mexico 88211-1412
(505) 748-3352
FAX (505) 748-9869

215 South Leech
Post Office Box 250
Hobbs, New Mexico 88241-0250
(505) 397-2727
FAX (505) 393-4111

May 26, 1993

Mr. Mike Stogner
Oil Conservation Division
PO Box 2088
Santa Fe, NM 88504-2088

Re: Unorthodox Location
Murphy H. Baxter Maljamar Waterflood Unit
Maljamar Grayburg San Andres Field
Lea County, New Mexico

Dear Mr. Stogner:

The Wiser Oil Company requests approval for an outside unorthodox location in the subject waterflood. The applicant is the offset operator. This location, designated State 18-B No. 10 is shown on the attached map. The location of this well is as follows:

State 18-B No. 10
1365' FNL & 1260' FEL, Unit H
Section 18 - T17S - R32E

This well will more efficiently and effectively establish the pattern of the waterflood as set out by Order No. R-2156.

Attached are copies of the C-101, C-102, map showing existing wells, proposed wells and proposed access roads and plat of the waterflood area showing the original 80-acre 5-spot waterflood patterns. It is anticipated that the injection pattern will become a 40-acre 5-spot pattern.

Your earliest consideration of this request will be appreciated as it is desired to start drilling during the week of June 21, if possible. Should you have any questions or require additional data, please contact the undersigned in Artesia at 748-3352.

Sincerely,

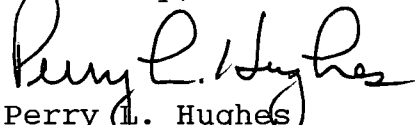

Perry L. Hughes
Agent for
The Wiser Oil Company

PLH/mp
Enclosures

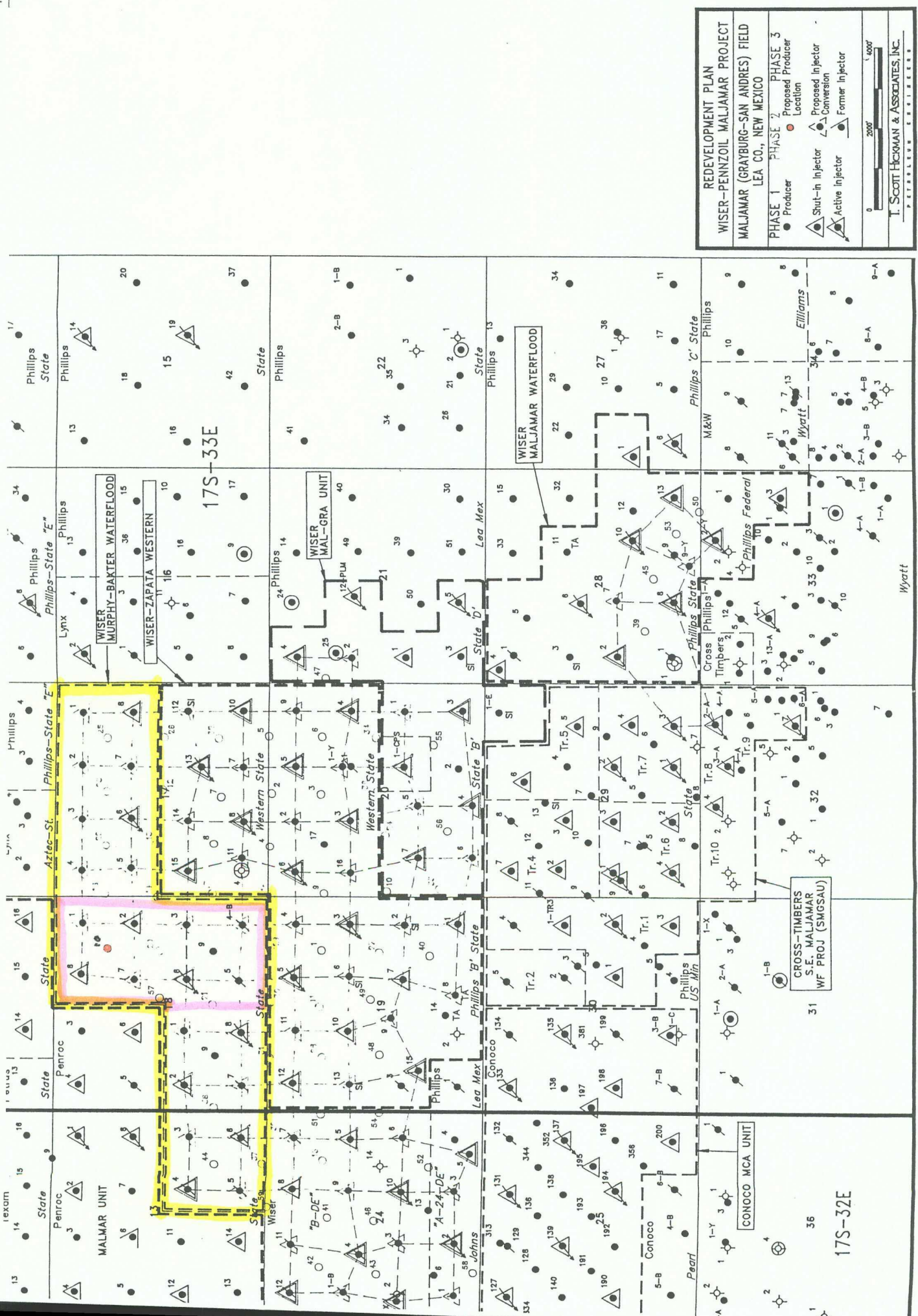

REDEVELOPMENT PLAN
WISER-PENNZOIL MALJAMAR PROJECT
MALJAMAR (GRAYBURG-SAN ANDRES) FIELD
LEA CO., NEW MEXICO

PHASE 1 ● Producer
 ▲ Shut-in Injector
 ▲ Active Injector

PHASE 2 ○ Proposed Producer
 ○ Location
 ▲ Proposed Injector
 ▲ Conversion

PHASE 3 ● Former Injector

0 1000' 2000'

T. SCOTT HECKMAN & ASSOCIATES, INC.
 P E T R O L E U M

FIGURE 17

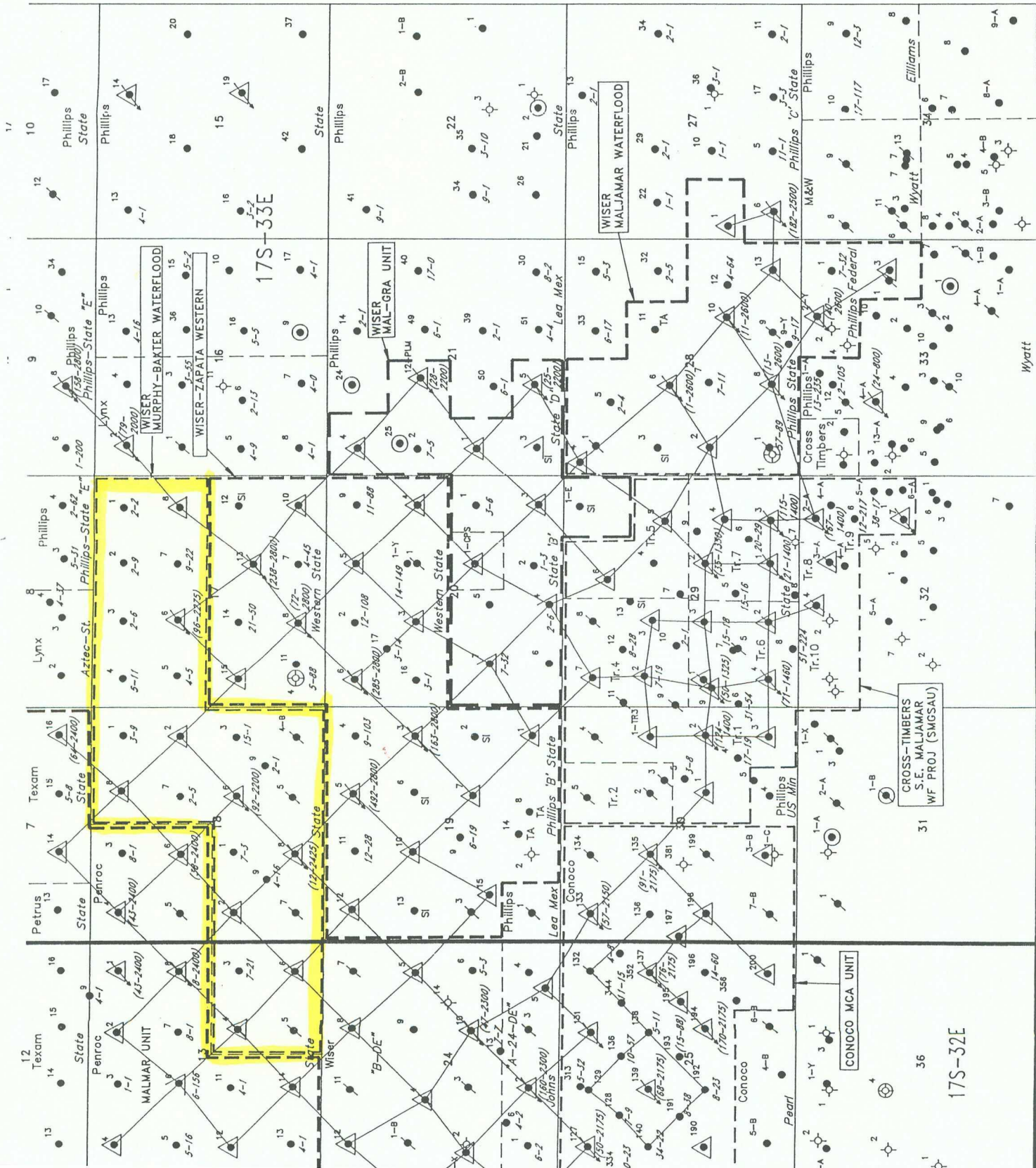

CURRENT WELL STATUS: JULY 1, 1992
 (Evaluated Wells Are Wiser Owned or Offsets)
MALJAMAR (GRAYBURG-SAN ANDRES) FIELD
 LEA CO., NEW MEXICO

●	Producer	○	Proposed Producer
○	10-10 BOPD-BWPD	○	Location
△	Shut-in Injector	△	Proposed Injector
△	Active Injector	△	Conversion
△	(200-2600) BWPD-WHP	△	Former Injector

0 2000' 4000'

T. SCOTT HICKMAN & ASSOCIATES, INC.
 P E T R O L E U M E N G I N E E R S

FIGURE 8

Submit to Appropriate District Office
State Lease - 6 copies
Fee Lease - 5 copies

State of New Mexico
Energy, Minerals and Natural Resources Department

Form C-101
Revised 1-1-89

OIL CONSERVATION DIVISION
P.O. Box 2088
Santa Fe, New Mexico 87504-2088

DISTRICT I
P.O. Box 1980, Hobbs, NM 88240

DISTRICT II
P.O. Drawer DD, Artesia, NM 88210

DISTRICT III
1000 Rio Brazos Rd., Aztec, NM 87410

API NO. (assigned by OCD on New Wells)

5. Indicate Type of Lease
STATE FEE

6. State Oil & Gas Lease No.
B-2148

APPLICATION FOR PERMIT TO DRILL, DEEPEN, OR PLUG BACK

1a. Type of Work:
DRILL RE-ENTER DEEPEN PLUG BACK
b. Type of Well:
OIL WELL GAS WELL OTHER
SINGLE ZONE MULTIPLE ZONE

7. Lease Name or Unit Agreement Name
State 18-B

2. Name of Operator
The Wiser Oil Company

8. Well No.
10

3. Address of Operator
PO Box 1412, Artesia, NM 88211-1412

9. Pool name or Wildcat
Maljamar Grayburg San Andres

4. Well Location
Unit Letter H : 1365 Feet From The North Line and 1260 Feet From The East Line
Section 18 Township 17S Range 33E NMPM Lea County

10. Proposed Depth 4900'
11. Formation Grayburg San Andres
12. Rotary or C.T. Rotary

13. Elevations (Show whether DF, RT, GR, etc.) 4215' GR
14. Kind & Status Plug Bond Statewide
15. Drilling Contractor
16. Approx. Date Work will start June 15, 1993

17. PROPOSED CASING AND CEMENT PROGRAM

SIZE OF HOLE	SIZE OF CASING	WEIGHT PER FOOT	SETTING DEPTH	SACKS OF CEMENT	EST. TOP
12-1/4"	8-5/8"	24#	1100'	650	Circulate
7-7/8"	5-1/2"	17#	4900'	600	2300' (base of salt)

It is proposed to drill the above captioned well to a total depth of 4900' with rotary tools. If commercial production is indicated, the well will be perforated and stimulated as necessary.

Blow out Prevention: 10" Series 900 Type "E" Shaffer Hydraulic BOP.

IN ABOVE SPACE DESCRIBE PROPOSED PROGRAM: IF PROPOSAL IS TO DEEPEN OR PLUG BACK, GIVE DATA ON PRESENT PRODUCTIVE ZONE AND PROPOSED NEW PRODUCTIVE ZONE. GIVE BLOWOUT PREVENTER PROGRAM, IF ANY.

I hereby certify that the information above is true and complete to the best of my knowledge and belief.

SIGNATURE

Perry L. Hughes

TITLE

AGENT

DATE

5/18/93

TYPE OR PRINT NAME

Perry L. Hughes

TELEPHONE NO. *505-748-3352*

(This space for State Use)

APPROVED BY

TITLE

DATE

CONDITIONS OF APPROVAL, IF ANY:

OIL CONSERVATION DIVISION

P.O. Box 2088

Santa Fe, New Mexico 87504-2088

District Office
State Lease - 3 copies
Fee Lease - 3 copies

DISTRICT I
P.O. Box 1980, Hobbs, NM 88240

DISTRICT II
P.O. Drawer DD, Artesia, NM 88210

DISTRICT III
1000 Rio Brazos Rd., Aztec, NM 87410

WELL LOCATION AND ACREAGE DEDICATION PLAT

All Distances must be from the outer boundaries of the section

Operator The Wiser Oil Company		Lease State 18-B		Well No. 10
Unit Letter H	Section 18	Township 17 South	Range 33 East	County Lea
Actual Footage Location of Well: 1365 feet from the North line and 1260 feet from the East line				
Ground level Elev. 4215	Producing Formation Grayburg & San Andres	Pool Maljamar Grayburg San Andres	Dedicated Acreage: 40 Acres	

- Outline the acreage dedicated to the subject well by colored pencil or hatchure marks on the plat below.
 - If more than one lease is dedicated to the well, outline each and identify the ownership thereof (both as to working interest and royalty).
 - If more than one lease of different ownership is dedicated to the well, have the interest of all owners been consolidated by communitization, unitization, force-pooling, etc.?
 - Yes No If answer is "yes" type of consolidation _____
 - If answer is "no" list the owners and tract descriptions which have actually been consolidated. (Use reverse side of this form if necessary.) _____
- No allowable will be assigned to the well until all interests have been consolidated (by communitization, unitization, forced-pooling, or otherwise) or until a non-standard unit, eliminating such interest, has been approved by the Division.

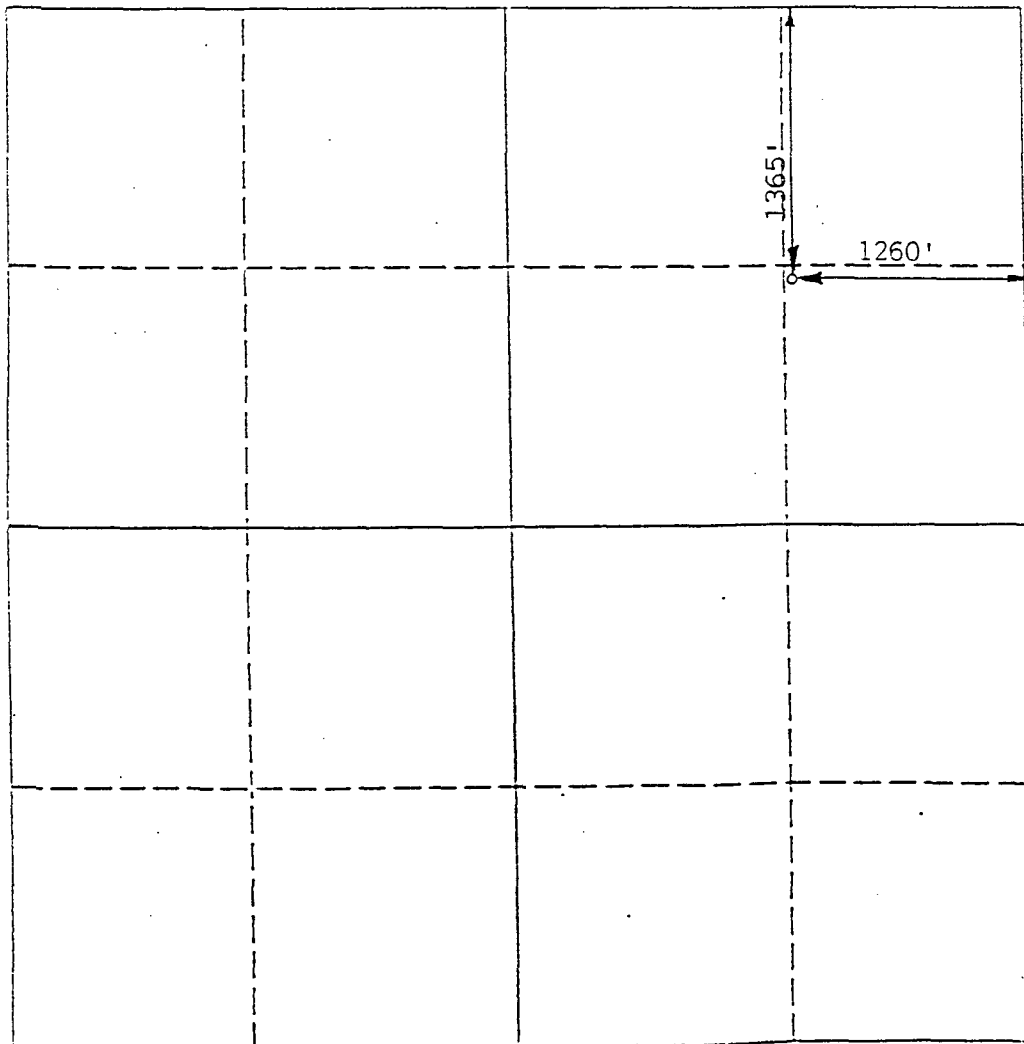

OPERATOR CERTIFICATION

I hereby certify that the information contained herein is true and complete to the best of my knowledge and belief.

Signature: *Perry L. Hughes*

Printed Name: **PERRY L. HUGHES**

Position: **AGENT**

Company: **THE WISER OIL CO.**

Date: **5/18/93**

SURVEYOR CERTIFICATION

I hereby certify that the well location shown on this plat was plotted from field notes of actual surveys made by me or under my supervision, and that the same is true and correct to the best of my knowledge and belief.

Date Surveyed: **May 5, 1993**

Signature & Seal of Professional Surveyor: *[Signature]* **BARTON** Ratton

Certificate No.: **8112**

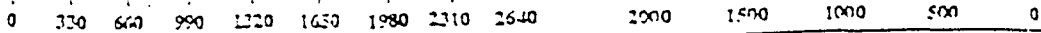



STATE OF NEW MEXICO

ENERGY, MINERALS AND NATURAL RESOURCES DEPARTMENT

OIL CONSERVATION DIVISION
RECEIVED OIL CONSERVATION DIVISION
HOBBS DISTRICT OFFICE

'93 JUN 1 AM 9 55-28-93

BRUCE KING
GOVERNOR

POST OFFICE BOX 1980
HOBBS, NEW MEXICO 88241-1980
(505) 393-6161

OIL CONSERVATION DIVISION
P. O. BOX 2088
SANTA FE, NEW MEXICO 87501

RE: Proposed:

- MC _____
- DHC _____
- NSL _____
- NSP _____
- SWD _____
- WFX _____
- PMX _____

Gentlemen:

I have examined the application for the:

The Wiser Oil Co. Phillips B State #16-B 19-17-32
 Operator Lease & Well No. Unit S-T-R

and my recommendations are as follows:

OK

Yours very truly,

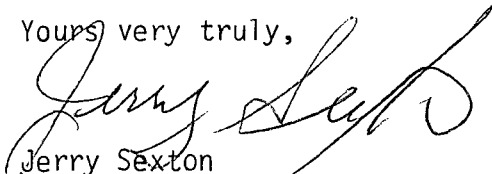
 Jerry Sexton
 Supervisor, District 1

/ed



STATE OF NEW MEXICO
ENERGY, MINERALS AND NATURAL RESOURCES DEPARTMENT

OIL CONSERVATION DIVISION
HOBBS DISTRICT OFFICE

5-28-93

BRUCE KING
GOVERNOR

OIL CONSERVATION DIVISION
RECEIVED

'93 JUN 1 AM 9 59

POST OFFICE BOX 1980
HOBBS, NEW MEXICO 88241-1980
(505) 393-6161

OIL CONSERVATION DIVISION
P. O. BOX 2088
SANTA FE, NEW MEXICO 87501

RE: Proposed:

MC _____
DHC _____
NSL _____
NSP _____
SWD _____
WFX _____
PMX _____

Gentlemen:

I have examined the application for the:

The Wiser Oil Co. State 18-B #10-14 18-17-32
Operator Lease & Well No. Unit S-T-R

and my recommendations are as follows:

OK

Yours very truly,

Jerry Sexton
Supervisor, District 1

/ed