

GW - 004

2006 MONITORING REPORTS

03/12/2007

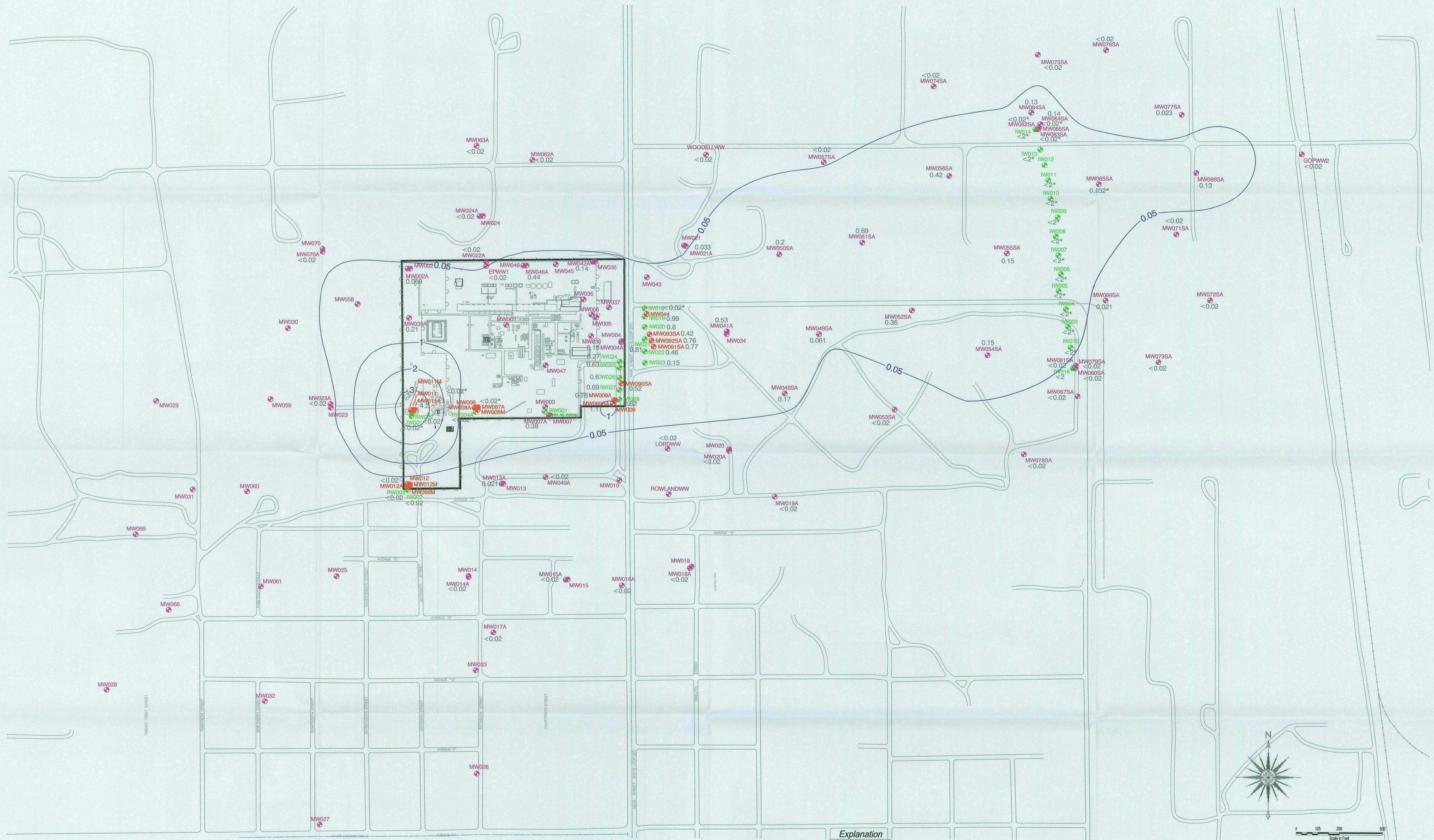

- Explanation**
- Monitoring Well Location
 - Hexavalent Chromium Concentration (mg/L)
 - * Value not used to generate contours
 - Recovery Well Location
 - Injection Well Location
 - Water Supply Well Location
 - Hexavalent Chromium Isoconcentration Contour
 - Inferred Isoconcentration Contour

Note: It is believed previous molasses injection resulted in laboratory interferences and elevated detection limits in affected wells.



FOR: **Chevron**
EUNICE NORTH GAS PLANT
EUNICE, NEW MEXICO

HEXAVALENT CHROMIUM
ISOCONCENTRATION MAP -
DEEP WELLS
(JUNE/JULY 2006)

FIGURE:
14
DATE: 10/13/2006

JOB NUMBER: 89CH-49410.07 DRAWN BY: RDT CHECKED BY: APPROVED BY: DATE: 10/13/2006