

3R - 223

**ANNUAL
MONITORING
REPORT**

04/02/2008



MWH

BUILDING A BETTER WORLD

RECEIVED

2008 APR 4 PM 1 38

April 2, 2008

Mr. Glenn von Gonten
New Mexico Oil Conservation Division (NMOCD)
1220 South St., Francis Drive
Santa Fe, New Mexico 87505

**RE: El Paso Tennessee Pipeline Company Pit Groundwater Remediation Sites
2007 Annual Reports**

Dear Mr. Von Gonten:

MWH Americas, Inc., on behalf of El Paso Tennessee Pipeline Company (EPTPC), is submitting the enclosed 2007 Annual Reports for each of EPTPC's 21 remaining San Juan River Basin pit groundwater remediation Sites. The reports present the 2007 sampling and product recovery data and include recommendations for 2008 activities at these Sites.

Copies of the reports for Sites located on Federal or Navajo lands are also being sent under separate cover to the Bureau of Land Management and the Navajo Nation Environmental Protection Agency.

If you have any questions concerning the enclosed reports, please call either Nancy Prince of EPTPC (719-520-4690) or me (303-291-2276).

Sincerely,

Jed Smith
Project Manager

cc: Brandon Powell – NMOCD, Aztec, NM
Nancy Prince – EPTPC
MWH Project File

**2007 ANNUAL GROUNDWATER REPORT
FEDERAL SITES VOLUME I
EL PASO TENNESSEE PIPELINE COMPANY**

TABLE OF CONTENTS

METER or LINE ID	SITE NAME	TOWNSHIP	RANGE	SECTION	UNIT	
89961	Fields A#7A	32N	11W	34	E	3R170
89232	Johnston Fed #6A	31N	09W	35	F	3R202
94715	James F. Bell #1E	30N	13W	10	P	3R196
89620	Sandoval GC A #1A	30N	09W	35	C	3R235
LD151	Lat 0-21 Line Drip	30N	09W	12	O	3R213
73220	Fogelson 4-1 Com. #14	29N	11W	4	P	3R068
97213	Hamner #9	29N	09W	20	A	3R190
LD174	LAT L 40	28N	04W	13	H	3R212
89894	Hammond #41A	27N	08W	25	O	3R186
94810	Miles Fed 1A	26N	07W	5	F	3R223
LD072	K27 LD072	25N	06W	4	E	3R204
87640	Canada Mesa #2	24N	06W	24	I	3R155
70194	Johnston Fed #4	31N	09W	33	H	3R201



MWH

**EPTPC GROUNDWATER SITES
2007 ANNUAL GROUNDWATER REPORT**

3R223

**Miles Fed 1A
Meter Code: 94810**

SITE DETAILS

Legal Description:	Town:	26N	Range:	7W	Sec:	5	Unit:	F
NMOCD Haz Ranking:	40	Land Type:	Federal	Operator:	Louis Dreyfus Natural Gas			

PREVIOUS ACTIVITIES

Site Assessment:	5/94	Excavation:	6/94	Soil Boring:	9/95
Monitor Well:	9/95	Geoprobe:	2/97	Additional MWs:	10/99
Downgradient MWs:	10/99	Replace MW:	NA	Quarterly Initiated:	NA
ORC Nutrient Injection:	NA	Re-Excavation:	NA	PSH Removal Initiated:	2/99
Annual Initiated:	10/99	Quarterly Resumed:	NA	PSH Removal in 2007?	No

SUMMARY OF 2007 ACTIVITIES

MW-1: Quarterly water level monitoring was performed in 2007.

MW-2: Quarterly water level monitoring was performed in 2007.

MW-3: Quarterly water level monitoring was performed in 2007.

Site-Wide Activities: The Site was inspected quarterly for hydrocarbon seeps. No seeps were detected.

SITE MAP

A Site map (2007) is attached as Figure 1.

SUMMARY TABLES AND GRAPHS

- Historic analytical data are presented graphically in Figures 2 through 4.
- Historic free product recovery data are presented graphically in Figure 5.
- Field documentation is presented in Attachment 1 (included on CD).

GEOLOGIC LOGS AND WELL COMPLETION DIAGRAMS

No subsurface activities were performed at this Site during 2007.

**EPTPC GROUNDWATER SITES
2007 ANNUAL GROUNDWATER REPORT**

**Miles Fed 1A
Meter Code: 94810**

DISPOSITION OF GENERATED WASTES

No wastes were generated in 2007.

ISOCONCENTRATION MAPS

No isoconcentration maps were prepared for this Site; however, the attached Site map presents representative potentiometric surface contours from the July 2007 gauging event.

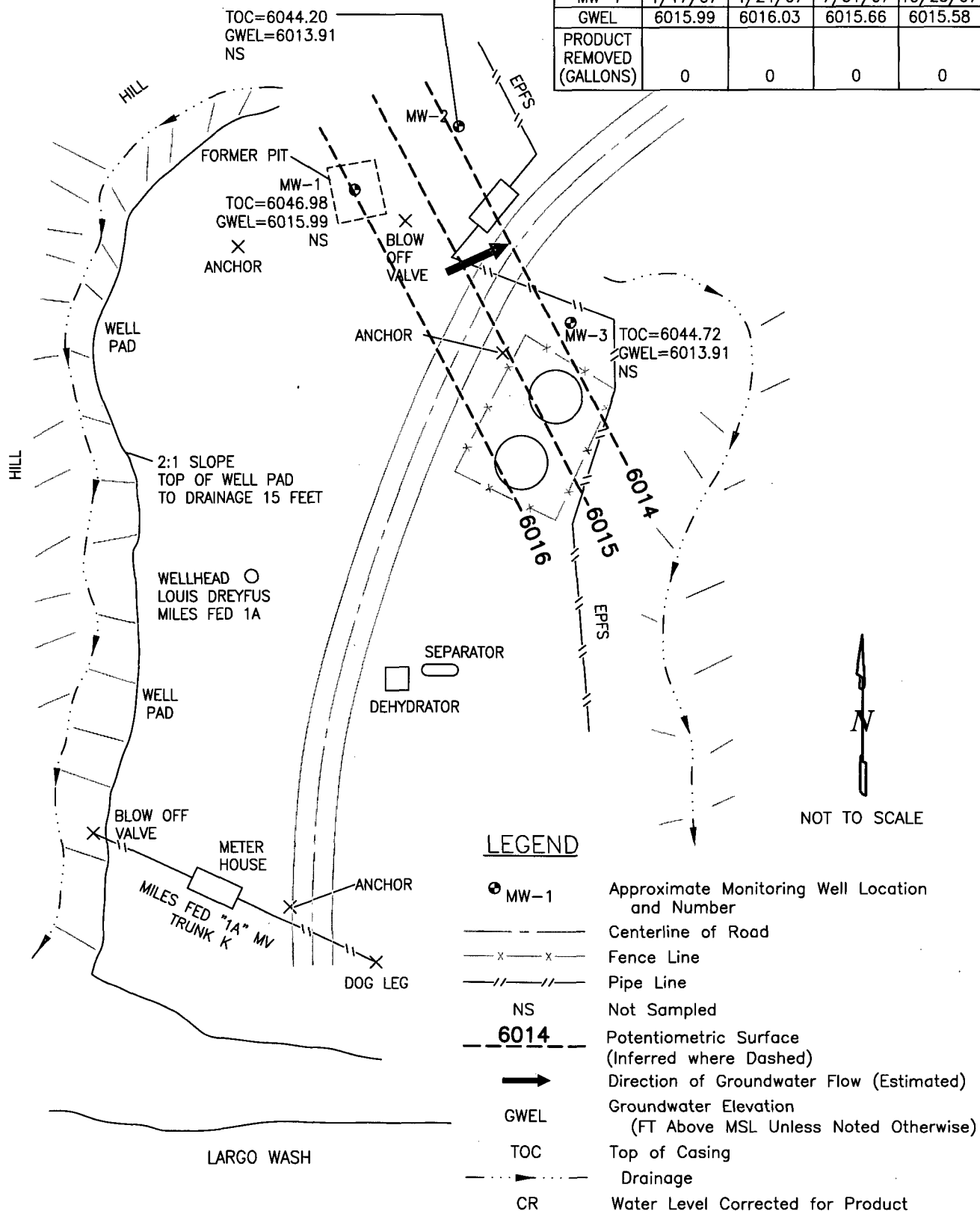
CONCLUSIONS

- The groundwater flow direction at this Site is toward the northeast.
- No free-product was observed in 2007. The cumulative total free-product recovered to date is approximately 11.97 gallons.
- No seeps along the well pad slopes were noted during 2007.

RECOMMENDATIONS

- On a quarterly basis, EPTPC will gauge water levels at the Site and inspect the well pad slopes for evidence of seeps. If free-product is observed, recovery activities will be re-initiated. If a seep is found, photographic documentation will be made and the seep will be sampled.
- If free-product continues to be absent from MW-1, this well will be sampled on an annual basis until sample results approach closure criteria. The well will then be scheduled for quarterly sampling until closure criteria are met. The first sample event will be in April 2008, if possible.
- MW-2 and MW-3 will be sampled once, in conjunction with MW-1. These wells were historically clean.

MW-1	1/17/07	4/24/07	7/31/07	10/25/07
GWEL	6015.99	6016.03	6015.66	6015.58
PRODUCT REMOVED (GALLONS)	0	0	0	0



1	01/08	D.Wade	N.Day	J.Smith	
0	Issued for Report	12/07	D. Wade	N.Day	J.Smith
REV. No.	REVISIONS	REV. DATE	DESIGN BY	DRAWN BY	REVIEWED AND SIGNED BY
PROJECT No.: 1005521.0601					
AutoCAD FILE: milesfed.dwg					
SCALE: As Shown		FIGURE No: 1			

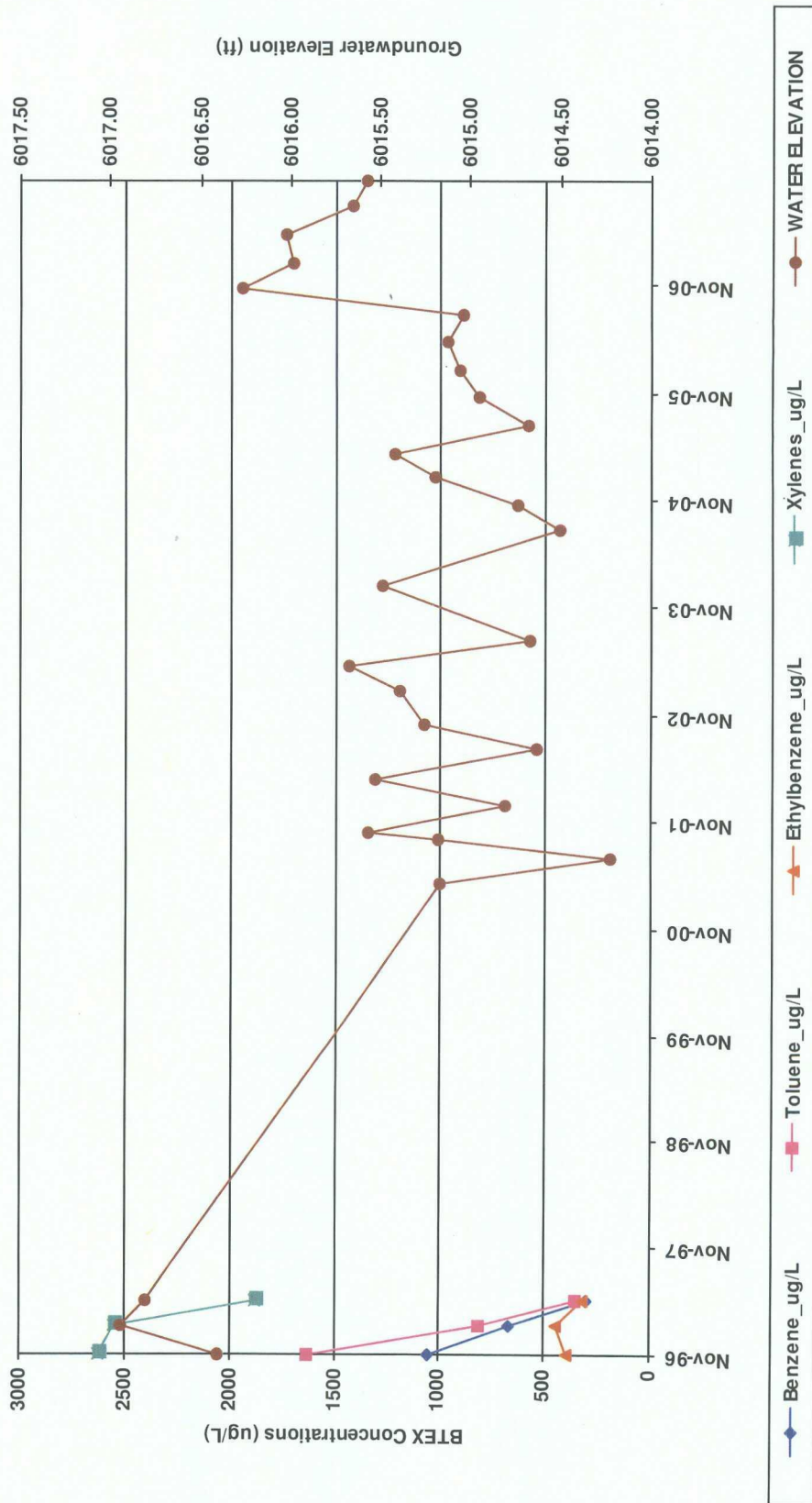


EL PASO TENNESSEE PIPELINE COMPANY
MILES FED 1A, METER 94810

GROUNDWATER POTENTIOMETRIC
SURFACE CONTOURS
JULY 2007

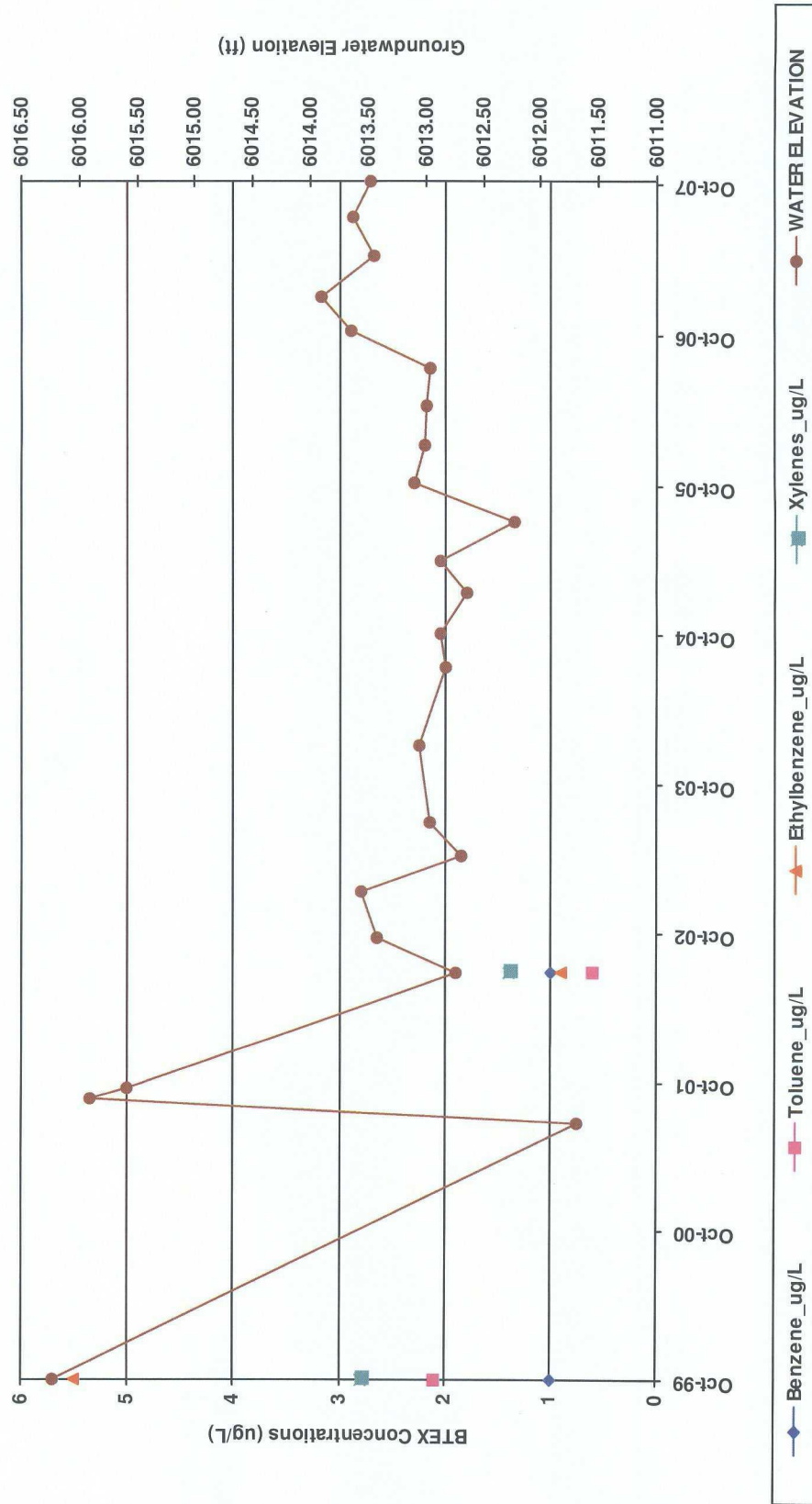


FIGURE 2
SUMMARY OF BTEX COMPOUNDS IN GROUNDWATER SAMPLES
MILES FED 1A (METER #94810)
MW01



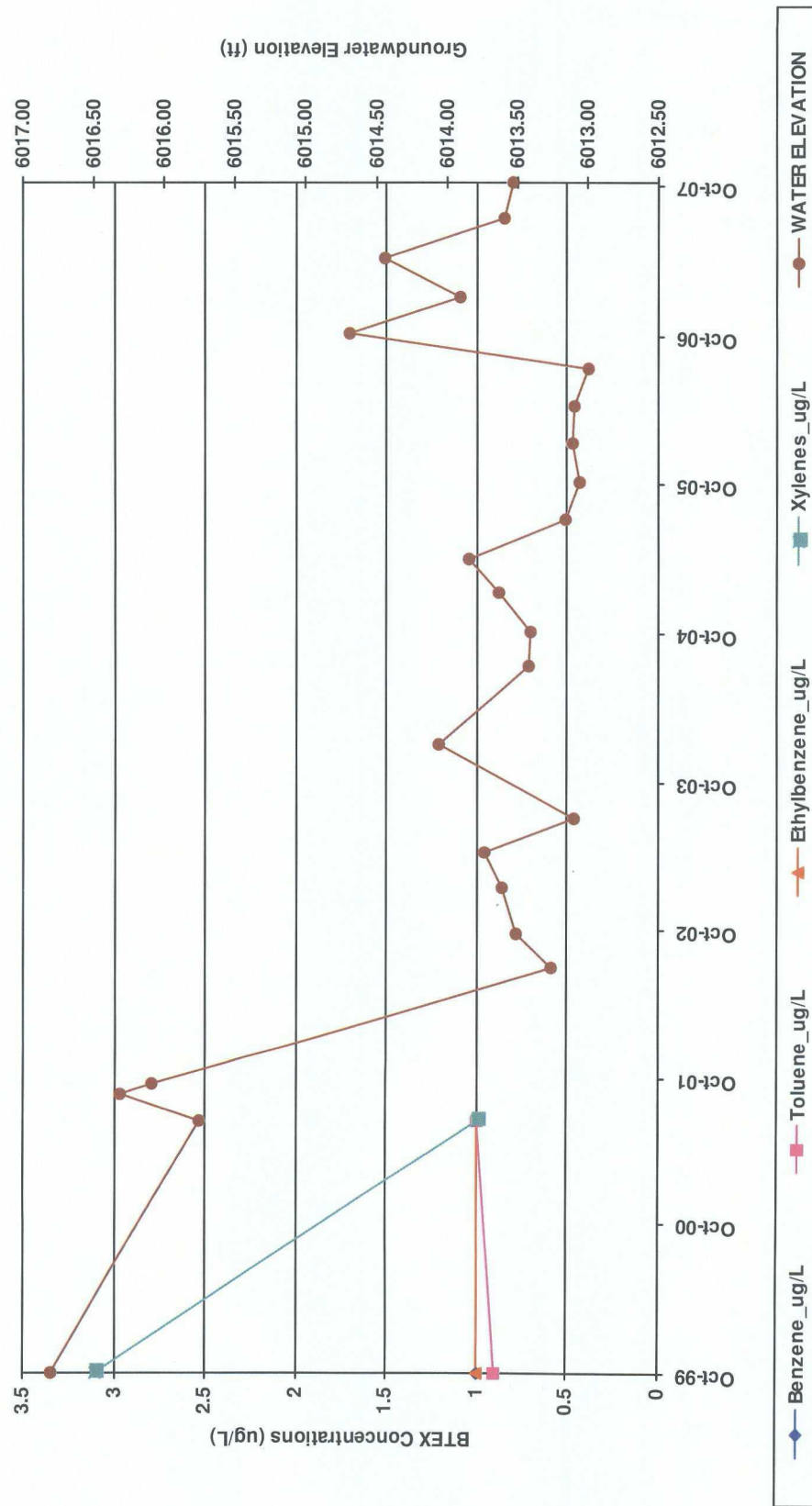
Note: Non Detects are represented by a value of 1.

FIGURE 3
SUMMARY OF BTEX COMPOUNDS IN GROUNDWATER SAMPLES
MILES FED 1A (METER #94810)
MW02



Note: Non Detects are represented by a value of 1.

FIGURE 4
SUMMARY OF BTEX COMPOUNDS IN GROUNDWATER SAMPLES
MILES FED 1A (METER #94810)
MW03



Note: Non Detects are represented by a value of 1.

FIGURE 5
SUMMARY OF FREE-PRODUCT REMOVAL
MILES FED 1A (METER #94810)
MW01

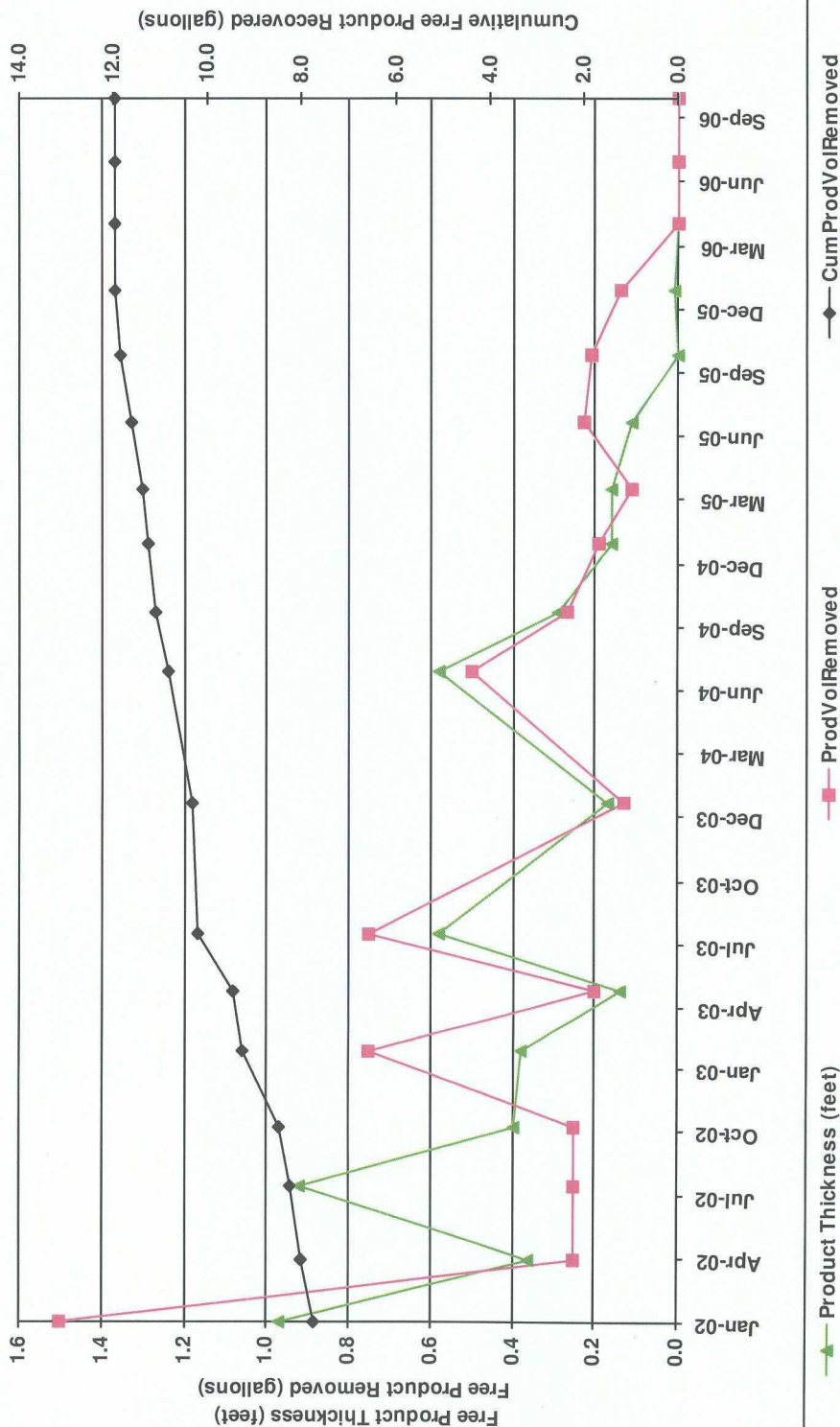


TABLE 1**SUMMARY OF BTEX COMPOUNDS IN GROUNDWATER SAMPLES
MILES FED 1A (METER #94810)**

Monitoring Well	Sample Date	Benzene (ug/L)	Toluene (ug/L)	Ethylbenzene (ug/L)	Total Xylenes (ug/L)	Depth to Water (ft BTOC)
MW01	11/5/1996	1050	1630	391	2620	30.58
	2/7/1997	671	809	439	2550	30.05
	5/6/1997	300	350	320	1880	30.18
MW02	10/15/1999	1	2.1	5.5	2.8	27.97
	7/15/2002	1	0.6	0.9	1.4	31.46
MW03	10/15/1999	1	0.9	1	3.1	27.92
	7/3/2001	1	1	1	1	28.97

Note: Non Detects are represented by a value of 1.

TABLE 2

**SUMMARY OF FREE-PRODUCT REMOVAL
MILES FED 1A (METER #94810)**

Monitoring Well	Removal Date	Depth to Product (feet btoc)	Depth to Water (feet btoc)	Product Thickness (feet)	Volume Removed (gallons)	Cumulative Volume of Product Removed (gallons)
MW01	1/2/2002	31.2	32.17	0.97	1.5	7.75
	4/1/2002	31.09	31.45	0.36	0.25	8.00
	7/15/2002	31.43	32.35	0.92	0.25	8.25
	10/8/2002	31.33	31.725	0.40	0.25	8.50
	1/27/2003	31.21	31.59	0.38	0.75	9.25
	4/26/2003	31.16	31.3	0.14	0.2	9.45
	7/17/2003	31.73	32.31	0.58	0.75	10.20
	1/19/2004	31.32	31.49	0.17	0.13	10.33
	7/27/2004	31.89	32.47	0.58	0.5	10.83
	10/20/2004	31.95	32.24	0.29	0.27	11.09
	1/25/2005	31.75	31.91	0.16	0.19	11.28
	4/14/2005	31.52	31.52	0.00	0.11	11.39
	7/19/2005	32.32	32.43	0.11	0.23	11.62
	10/21/2005		32.02	0	0.21	11.83
	1/23/2006	31.92	31.93	0.01	0.14	11.97
	4/28/2006		31.85	0	0	11.97
	7/26/2006		31.94	0	0	11.97
	10/24/2006		30.71	0	0	11.97