

MERIDIAN OIL

*Received
9/15/93*

September 14, 1993

Federal Express

Mr. William LeMay
New Mexico Oil Conservation Division
310 Old Santa Fe Trail
Santa Fe, New Mexico 87503

Re: Huerfano Unit #205
1850'FSL, 1850'FEL
Section 28, T-26-N, R-9-W, San Juan County, NM

Dear Mr. LeMay:

This is a request for administrative approval for a non-standard gas well location in the Basin Fruitland Coal Pool.

Meridian Oil intends to plugback and recomplete the Huerfano Unit #205 from the Basin Dakota to the Basin Fruitland Coal Pool. The current location of this well is considered non-standard due to the NE-SW dedicated pattern established for the Basin Fruitland Coal pool. To comply with the New Mexico Oil Conservation Division rules, Meridian is submitting the following for your approval of this non-standard location:

1. C-102 plat showing location of the well;
2. Plat showing offset owners/operators;
3. Affidavit of notification of offset owners/operators;
4. Copy of Well Completion Log for original completion.

A copy of this application is being submitted to all offset owners/operators by certified mail with a request that they furnish your Santa Fe office with a Waiver of Objection, and return one copy to this office.

Sincerely yours,



Peggy Bradfield
Regulatory/Compliance Representative

WAIVER

_____ hereby waives objection to Meridian Oil's application for non-standard location for the Huerfano Unit #205 as proposed above.

By: _____ Date: _____

xc: Amax Petroleum
Koch Exploration

NEW MEXICO OIL CONSERVATION COMMISSION
WELL LOCATION AND ACREAGE DEDICATION PLAT

Form O-122
Supersedes O-128
Effective 1-1-61

All distances must be from the outer boundaries of the Section.

Operator Meridian Oil Inc.		Lease HUERFANO UNIT (SF-078060-A)		Well No. 205
Section J	Section 28	Township 26-N	Range 9-W	County SAN JUAN
Actual Point of Location of Well: 1850 feet from the SOUTH line of the 1850 feet to the EAST line.				
Ground Level Elev. 6467	Producing Formation Fruitland Coal	Basin Basin	Dedicated Acreage 320.00	

1. Outline the acreage dedicated to the subject well by colored pencil or hachure marks on the plat below.
2. If more than one lease is dedicated to the well, outline each and identify the ownership thereof (both as to working interest and royalty).
3. If more than one lease of different ownership is dedicated to the well, have the interests of all owners been consolidated by communitization, unitization, force-pooling, etc?

☒ Yes ☐ No If answer is "yes" type of consolidation unitization

If answer is "no" list the owners and tract descriptions which have actually been consolidated. (Use reverse side of this form if necessary.)

No allowable will be assigned to the well until all interests have been consolidated (by communitization, unitization, forced-pooling, or otherwise) or until a non-standard unit, eliminating such interests, has been approved by the Commission.

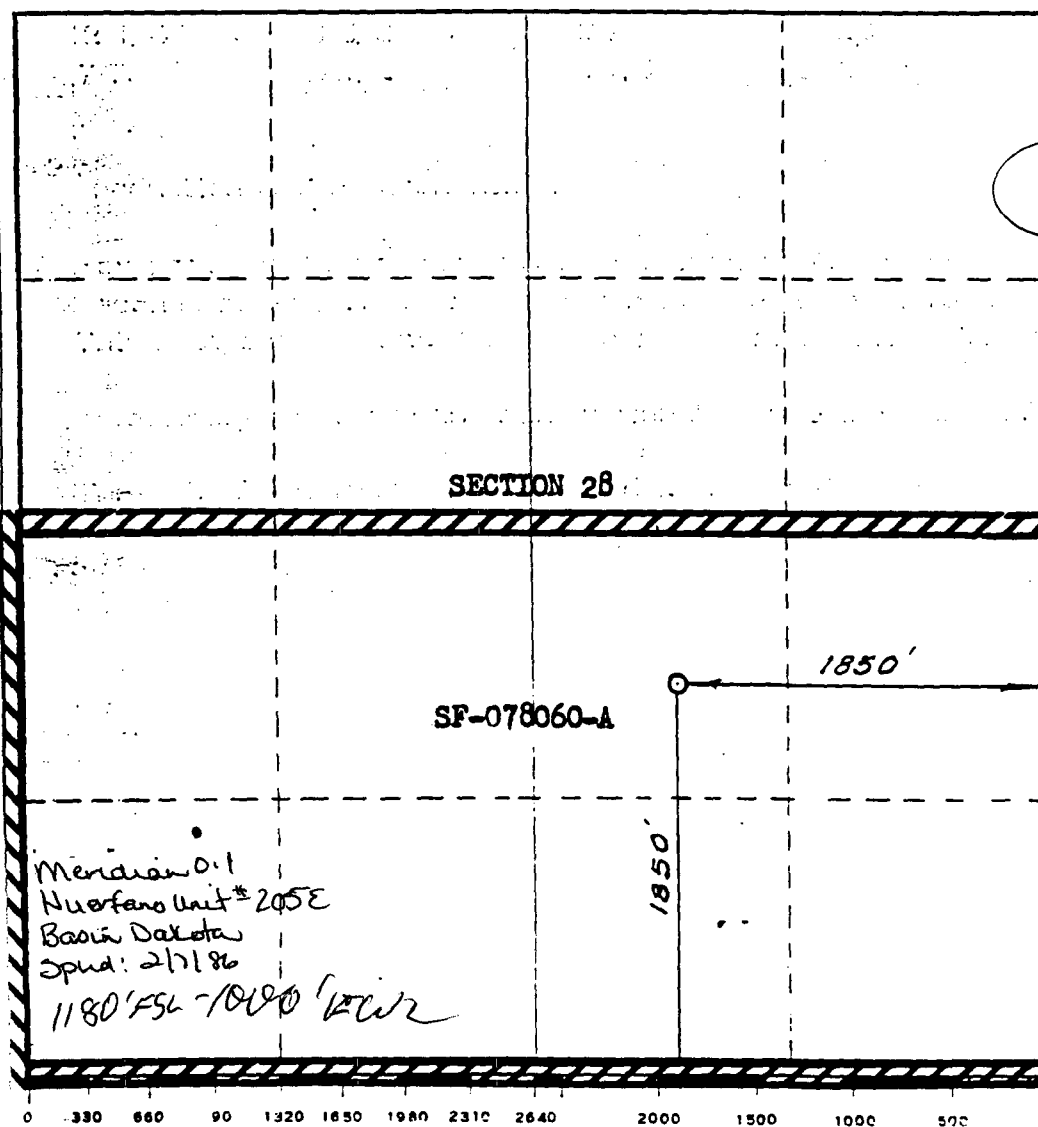

CERTIFICATION

I hereby certify that the information contained herein is true and complete to the best of my knowledge and belief.

Name
Peggy Bradfield
Position
Regulatory Representative
Company
Meridian Oil Inc.
Date
9-8-93

I hereby certify that the well location shown on this plat was plotted from field notes of actual surveys made by me or under my supervision, and that the same is true and correct to the best of my knowledge and belief.

DECEMBER 10, 1970

Registered Professional Engineer
and/or Licensed Surveyor

[Signature]
Certificate No. **1760**

OFFSET OPERATOR PLAT

Huerfano Unit #205

S/2 Section, T26N, R9W

1850' FEL & 1850' FSL

Fruitland Coal Recompletion

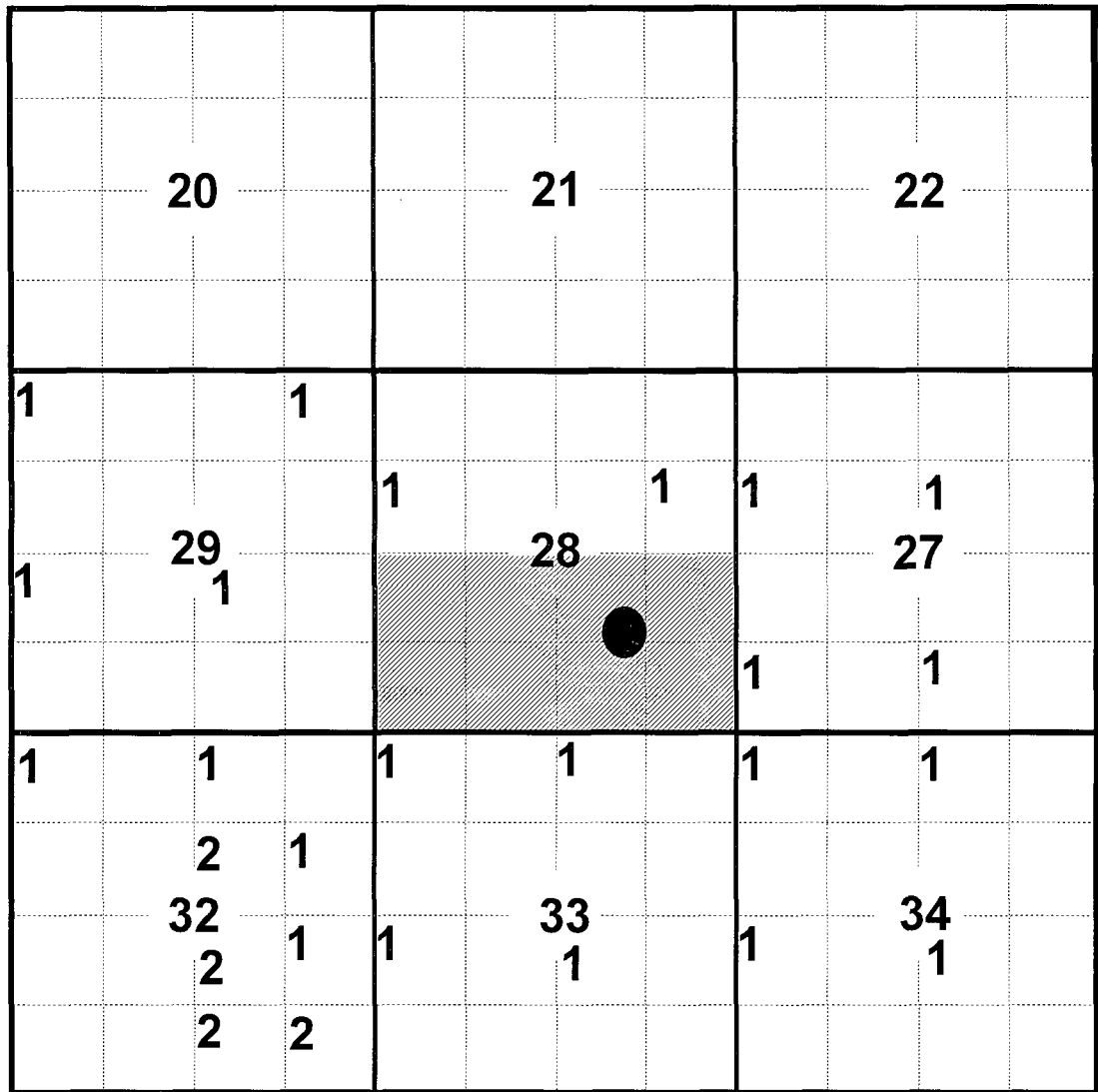

1.) All offsetting drill blocks are within the Huerfano Unit, Operated by Meridian Oil Inc.

2.) Land not committed to Huerfano Unit

Amax Petroleum, P.O. Box 297007, Houston, TX 77297

Koch Exploration, P.O. Box 2256, Wichita, KS 67201

MERIDIAN OIL

September 14, 1993

Huerfano Unit #205
1850'FSL, 1850'FEL
Section 28, T-26-N, R-9-W
San Juan County, New Mexico

I hereby certify that the following offset owners/operators have been notified by certified mail of our application for administrative approval for non-standard gas well location for the plugback and recompletion of the above well.

Amax Petroleum
PO Box 297007
Houston, TX 77297

Koch Exploration
PO Box 2256
Wichita, KS 67201

Peggy Bradfield
Notary Public
San Juan County, New Mexico

My commission expires August 17, 1996.

UNITED STATES
DEPARTMENT OF THE INTERIOR
GEOLOGICAL SURVEY

SUBMIT IN DUPLICATE

(See other instructions on reverse side)

Form approved.
Budget Bureau No. 42-R355.5.

5. LEASE DESIGNATION AND SERIAL NO.

SF 078060-A

6. IF INDIAN, ALLOTTEE OR TRIBE NAME

7. UNIT AGREEMENT NAME

Huerfano Unit

8. FARM OR LEASE NAME

Huerfano Unit

9. WELL NO.

205

10. FIELD AND POOL, OR WILDCAT

Basin Dakota

11. SEC., T., R., M., OR BLOCK AND SURVEY OR AREA

Sec. 28, T-26-N, R-9-W
N. M. P. M.

12. COUNTY OR PARISH

San Juan

13. STATE

New Mexico

WELL COMPLETION OR RECOMPLETION REPORT AND LOG *

1a. TYPE OF WELL: OIL WELL ☐ GAS WELL ☒ DRY ☐ Other

b. TYPE OF COMPLETION:

NEW WELL ☒ WORK OVER ☐ DEEP-EN ☐ PLUG BACK ☐ DIFF. RESVR. ☐ Other

2. NAME OF OPERATOR

El Paso Natural Gas Company

3. ADDRESS OF OPERATOR

Box 990, Farmington, New Mexico 87401

4. LOCATION OF WELL (Report location clearly and in accordance with any State requirements)*

At surface 1850'S, KX 1850'E

At top prod. interval reported below

At total depth

14. PERMIT NO.

DATE ISSUED

15. DATE SPUDDED 6-5-70 16. DATE T.D. REACHED 6-17-70 17. DATE COMPL. (Ready to prod.) 7-7-70 18. ELEVATIONS (DF, REB, RT, GR, ETC.)* 6467' GL 19. ELEV. CASINGHEAD

20. TOTAL DEPTH, MD & TVD 6764' 21. PLUG, BACK T.D., MD & TVD 6749' 22. IF MULTIPLE COMPL., HOW MANY* 23. INTERVALS DRILLED BY 24. PRODUCING INTERVAL(S), OF THIS COMPLETION—TOP, BOTTOM, NAME (MD AND TVD)* 6432 - 6666' (Dakota) 25. WAS DIRECTIONAL SURVEY MADE No

26. TYPE ELECTRIC AND OTHER LOGS RUN

Ind. Elec, Gamma-Density, Temp. Survey

27. WAS WELL CORED

No

28. CASING RECORD (Report all strings set in well)

CASINO SIZE	WEIGHT, LB./FT.	DEPTH SET (MD)	HOLE SIZE	CEMENTING RECORD	AMOUNT PULLED
8 5/8"	24#	228'	12 1/4"	160 Sks.	
4 1/2"	10.5#	6764'	7 7/8"	679 Sks.	

29. LINER RECORD

SIZE	TOP (MD)	BOTTOM (MD)	SACKS CEMENT*	SCREEN (MD)	SIZE	DEPTH SET (MD)	PACKER SET (MD)
					2 3/8"	6669'	

31. PERFORATION RECORD (Interval, size and number)

6432-40, 6470-74, 6522-30
6540-48, 6614-22, 6658-66 w/16 SPZ

32. ACID, SHOT, FRACTURE, CEMENT SQUEEZE, ETC.

DEPTH INTERVAL (MD)	AMOUNT AND KIND OF MATERIAL USED
6432-6666	71,000 gal. water, 70,000# sand

33.* PRODUCTION

DATE FIRST PRODUCTION PRODUCTION METHOD (Flowing, gas lift, pumping—size and type of pump) Flowing WELL STATUS (Producing or shut-in) Shut In

DATE OF TEST	HOURS TESTED	CHOKE SIZE	PROD'N. FOR TEST PERIOD	OIL—BBL.	GAS—MCF.	WATER—BBL.	GAS-OIL RATIO
7-7-70	3 Hrs.	3/4" Variable	→	59.29			
FLOW, TUBING PRESS.	CASING PRESSURE	CALCULATED 24-HOUR RATE	OIL—BBL.	GAS—MCF.	WATER—BBL.	OIL GRAVITY-API (CORR.)	
SI 1971	SI 1952	→		4043 MCF/D	A. O. F.		

34. DISPOSITION OF GAS (Sold, used for fuel, vented, etc.)

TEST WITNESSED BY

R. E. Stauffer & R. E. Fielder

35. LIST OF ATTACHMENTS

36. I hereby certify that the foregoing and attached information is complete and correct as determined from all available records

SIGNED

Original Signed F. H. WOOD

TITLE

Petroleum Engineer

DATE

7-7-70

*(See Instructions and Spaces for Additional Data on Reverse Side)

MERIDIAN OIL

September 14, 1993

Federal Express

Mr. William LeMay
New Mexico Oil Conservation Division
310 Old Santa Fe Trail
Santa Fe, New Mexico 87503

Re: Huerfano Unit #205
1850'FSL, 1850'FEL
Section 28, T-26-N, R-9-W, San Juan County, NM

Dear Mr. LeMay:

This is a request for administrative approval for a non-standard gas well location in the Basin Fruitland Coal Pool.

Meridian Oil intends to plugback and recomplete the Huerfano Unit #205 from the Basin Dakota to the Basin Fruitland Coal Pool. The current location of this well is considered non-standard due to the NE-SW dedicated pattern established for the Basin Fruitland Coal pool. To comply with the New Mexico Oil Conservation Division rules, Meridian is submitting the following for your approval of this non-standard location:

1. C-102 plat showing location of the well;
2. Plat showing offset owners/operators;
3. Affidavit of notification of offset owners/operators;
4. Copy of Well Completion Log for original completion.

A copy of this application is being submitted to all offset owners/operators by certified mail with a request that they furnish your Santa Fe office with a Waiver of Objection, and return one copy to this office.

Sincerely yours,



Peggy Bradfield
Regulatory/Compliance Representative

WAIVER

_____ hereby waives objection to Meridian Oil's application for non-standard location for the Huerfano Unit #205 as proposed above.

By: _____ Date: _____

xc: Amax Petroleum
Koch Exploration

NEW MEXICO OIL CONSERVATION COMMISSION
WELL LOCATION AND ACREAGE DEDICATION PLAT

Form 7-122
Supersedes C-128
Effective 1-1-61

All distances must be from the outer boundaries of the Section.

Operator Meridian Oil Inc.		Lease HUERFANO UNIT (SF-078060-A)		Well No. 205
Section J	Range 28	Township 26-N	Range 9-W	County SAN JUAN
Actual location of well: <div style="display: flex; justify-content: space-between;"> 1850 SOUTH 1850 EAST </div>				
Ground Level Elev. 6467	Producing Formation Fruitland Coal	Basin Basin	Designated Acreage 320.00	

- Outline the acreage dedicated to the subject well by colored pencil or hachure marks on the plat below.
- If more than one lease is dedicated to the well, outline each and identify the ownership thereof (both as to working interest and royalty).
- If more than one lease of different ownership is dedicated to the well, have the interests of all owners been consolidated by communitization, unitization, force-pooling, etc?

unitization

☒ Yes ☐ No If answer is "yes," type of consolidation _____

If answer is "no," list the owners and tract descriptions which have actually been consolidated. (Use reverse side of this form if necessary.) _____

No allowable will be assigned to the well until all interests have been consolidated (by communitization, unitization, forced-pooling, or otherwise) or until a non-standard unit, eliminating such interests, has been approved by the Commission.

SECTION 28

SF-078060-A

1850'

1850'

CERTIFICATION

I hereby certify that the information contained herein is true and complete to the best of my knowledge and belief.

Name
Peggy Bradfield

Position
Regulatory Representative

Company
Meridian Oil Inc.

Date
9-8-93

I hereby certify that the well location shown on this plat was plotted from field notes of actual surveys made by me or under my supervision, and that the same is true and correct to the best of my knowledge and belief.

DECEMBER 10, 1970

Registered Professional Engineer and/or Land Surveyor

David C. [Signature]
Certificate No. **1760**

OFFSET OPERATOR PLAT

Huerfano Unit #205

S/2 Section, T26N, R9W

1850' FEL & 1850' FSL

Fruitland Coal Recompletion

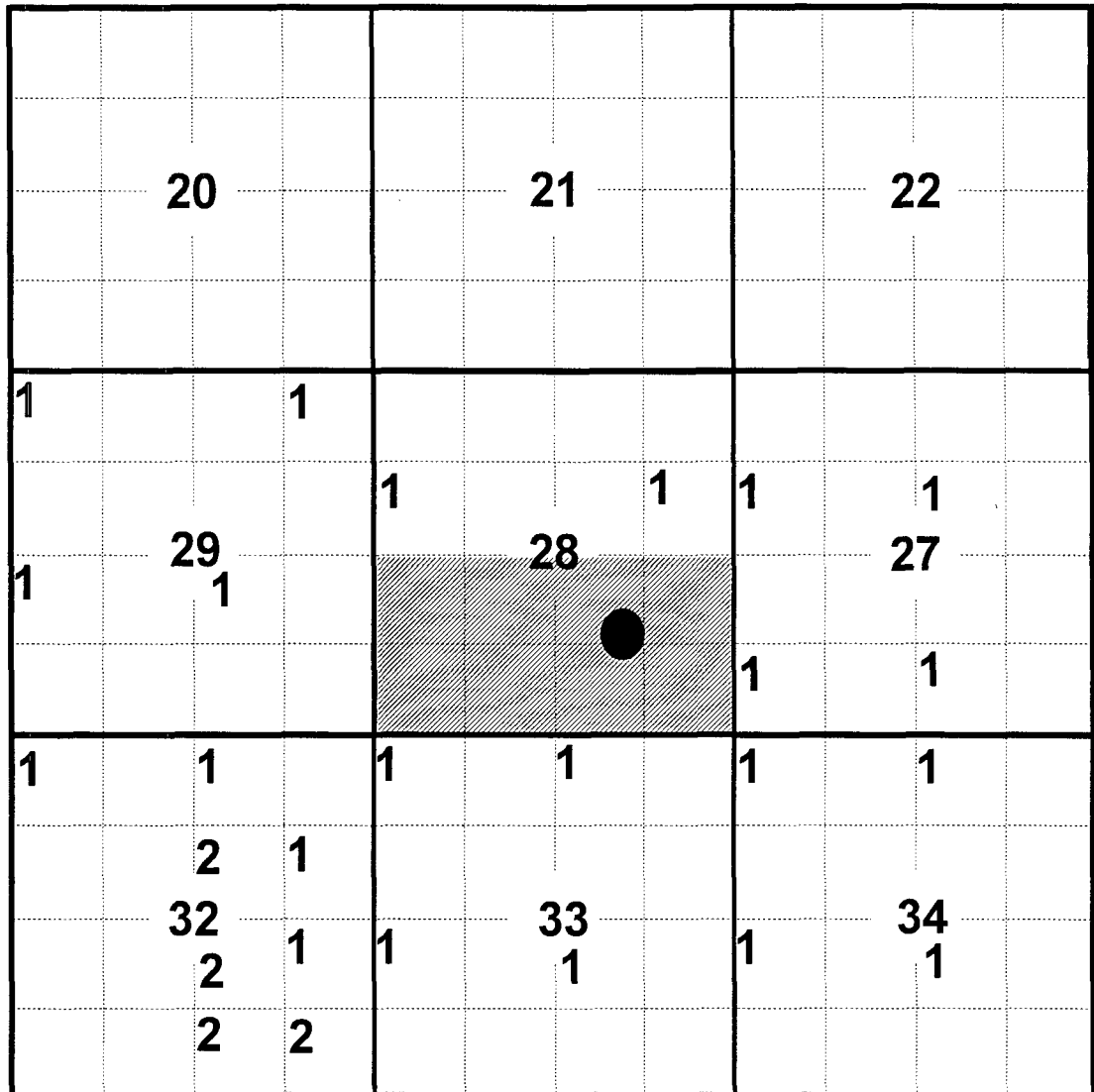

1.) All offsetting drill blocks are within the Huerfano Unit, Operated by Meridian Oil Inc.

2.) Land not committed to Huerfano Unit

Amax Petroleum, P.O. Box 297007, Houston, TX 77297

Koch Exploration, P.O. Box 2256, Wichita, KS 67201

MERIDIAN OIL

September 14, 1993

Huerfano Unit #205
1850'FSL, 1850'FEL
Section 28, T-26-N, R-9-W
San Juan County, New Mexico

I hereby certify that the following offset owners/operators have been notified by certified mail of our application for administrative approval for non-standard gas well location for the plugback and recompletion of the above well.

Amax Petroleum
PO Box 297007
Houston, TX 77297

Koch Exploration
PO Box 2256
Wichita, KS 67201



Peggy Bradfield
Notary Public
San Juan County, New Mexico

My commission expires August 17, 1996.

UNITED STATES
DEPARTMENT OF THE INTERIOR
GEOLOGICAL SURVEY

SUBMIT IN DUPLICATE

(See letter in-
structions on
reverse side)Form approved.
Budget Bureau No. 42-R355.5.

WELL COMPLETION OR RECOMPLETION REPORT AND LOG *

1a. TYPE OF WELL:		OIL WELL <input type="checkbox"/>	GAS WELL <input checked="" type="checkbox"/>	DRY <input type="checkbox"/>	Other <input type="checkbox"/>		
b. TYPE OF COMPLETION:		NEW WELL <input checked="" type="checkbox"/>	WORK OVER <input type="checkbox"/>	DEEP-EN <input type="checkbox"/>	PLUG BACK <input type="checkbox"/>	DIFF. RESVR. <input type="checkbox"/>	Other <input type="checkbox"/>
2. NAME OF OPERATOR El Paso Natural Gas Company						7. UNIT AGREEMENT NAME Huerfano Unit	
3. ADDRESS OF OPERATOR Box 990, Farmington, New Mexico 87401						8. FARM OR LEASE NAME Huerfano Unit	
4. LOCATION OF WELL (Report location clearly and in accordance with any State requirements)* At surface 1850'S, XX 1850'E At top prod. interval reported below At total depth						9. WELL NO. 205	
14. PERMIT NO.						DATE ISSUED	
15. DATE SPURDRED 6-5-70						16. DATE T.D. REACHED 6-17-70	
17. DATE COMPL. (Ready to prod.) 7-7-70						18. ELEVATIONS (DF, REB, BT, GR, ETC.)* 6467' GL	
19. ELEV. CASINGHEAD						20. TOTAL DEPTH, MD & TVD 6764'	
21. PLUG, BACK T.D., MD & TVD 6749'						22. IF MULTIPLE COMPL., HOW MANY*	
23. INTERVALS DRILLED BY →						ROTARY TOOLS D - 6764	
24. PRODUCING INTERVAL(S), OF THIS COMPLETION—TOP, BOTTOM, NAME (MD AND TVD)* 6432 - 6666' (Dakota)						25. WAS DIRECTIONAL SURVEY MADE No	
26. TYPE ELECTRIC AND OTHER LOGS RUN Ind-Elec, Gamma-Density, Temp. Survey						27. WAS WELL CORED No	
28. CASING RECORD (Report all strings set in well)							
CASING SIZE		WEIGHT, LB./FT.		DEPTH SET (MD)		HOLE SIZE	
8 5/8"		24#		228'		12 1/4"	
4 1/2"		10.5#		6764'		7 7/8"	
29. LINER RECORD							
SIZE		TOP (MD)		BOTTOM (MD)		SACKS CEMENT*	
30. TUBING RECORD							
SIZE		DEPTH SET (MD)		PACKER SET (MD)			
2 3/8"		6669'					
31. PERFORATION RECORD (Interval, size and number)							
6432-40, 6470-74, 6522-30 6540-48, 6614-22, 6658-66 w/16 SPZ							
32. ACID, SHOT, FRACTURE, CEMENT SQUEEZE, ETC.							
DEPTH INTERVAL (MD)				AMOUNT AND KIND OF MATERIAL USED			
6432-6666				71,000 gal. water; 70,000# sand			
33. PRODUCTION							
DATE FIRST PRODUCTION		PRODUCTION METHOD (Flowing, gas lift, pumping—size and type of pump) Flowing				WELL STATUS (Producing or shut-in) Shut In	
DATE OF TEST 7-7-70		HOURS TESTED 3 Hrs.		CHOKE SIZE 3/4" Variable →		OIL—BSL. 59.29	
FLOW. TUBING PRESS. SI 1971		CASING PRESSURE SI 1952		CALCULATED 24-HOUR RATE →		OIL—BSL. 4043 MCF/D - A. O. F.	
34. DISPOSITION OF GAS (Sold, used for fuel, vented, etc.)							
TEST WITNESSED BY R. E. Stauffer & R. E. Fielder							
35. LIST OF ATTACHMENTS							
36. I hereby certify that the foregoing and attached information is complete and correct as determined from all available records							
SIGNED		Original Signed F. H. WOOD				TITLE Petroleum Engineer	
						DATE 7-7-70	

*(See Instructions and Spaces for Additional Data on Reverse Side)



USE THIS AIRBILL FOR SHIPMENTS WITHIN THE CONTINENTAL U.S.A., ALASKA AND HAWAII.
USE THE INTERNATIONAL AIR WAYBILL FOR SHIPMENTS TO PUERTO RICO AND ALL NON U.S. LOCATIONS.
QUESTIONS? CALL 800-238-5355 TOLL FREE.

AIRBILL
PACKAGE
TRACKING NUMBER

8106786391

3228M

8106786391

RECIPIENT'S COPY

From (Your Name) Please Print Peggy Bradfield		Your Phone Number (Very Important) (505) 326-9700		To (Recipient's Name) Please Print Michael Stogner		Recipient's Phone Number (Very Important) (505) 827-5811			
Company MERIDIAN OIL PRODUCTION INC		Department/Floor No.		Company NM Oil Conservation Division		Department/Floor No.			
Street Address 3535 E 30TH STREET				Exact Street Address (We cannot deliver to P.O. Boxes or APO/FPO addresses) 310 Old Santa Fe Trail					
City FARMINGTON		State NM		City Santa Fe		State NM			
ZIP Required 87401		ZIP Required 87501							
YOUR INTERNAL BILLING REFERENCE INFORMATION (optional) (First 24 characters will appear on invoice.) Santa Fe FEDEX LOCATION, Print FEDEX Address Here									
PAYMENT 1 <input checked="" type="checkbox"/> Bill Sender 2 <input type="checkbox"/> Bill Recipient/FedEx Acct. No. 3 <input type="checkbox"/> Bill 3rd Party FedEx Acct. No. 4 <input type="checkbox"/> Bill Credit Card				City Santa Fe State NM ZIP Required 87501					
5 <input type="checkbox"/> Cash Check									
4 SERVICES (Check only one box)		5 DELIVERY AND SPECIAL HANDLING (Check services required)		6 PACKAGES		7 EMPLOYEE INFORMATION			
Priority Overnight (Delivery by next business morning) 11 <input type="checkbox"/> OTHER PACKAGING 12 <input checked="" type="checkbox"/> FEDEX LETTER 13 <input type="checkbox"/> FEDEX PAK 14 <input type="checkbox"/> FEDEX BOX 15 <input type="checkbox"/> FEDEX TUBE		Standard Overnight (Delivery by next business afternoon - no Saturday delivery) 51 <input type="checkbox"/> OTHER PACKAGING 52 <input type="checkbox"/> FEDEX LETTER 53 <input type="checkbox"/> FEDEX PAK 54 <input type="checkbox"/> FEDEX BOX 55 <input type="checkbox"/> FEDEX TUBE		Weekday Service 1 <input type="checkbox"/> HOLD AT FEDEX LOCATION WEEKDAY (Fill in Section H) 2 <input checked="" type="checkbox"/> DELIVER WEEKDAY Saturday Service 31 <input type="checkbox"/> HOLD AT FEDEX LOCATION SATURDAY (Fill in Section H) 3 <input type="checkbox"/> DELIVER SATURDAY (Extra charge) (Not available to all locations) 9 <input type="checkbox"/> SATURDAY PICK-UP (Extra charge)		Special Handling 4 <input type="checkbox"/> DANGEROUS GOODS (Extra charge) 6 <input type="checkbox"/> DRY ICE Dangerous Goods Shipper's Declaration not required 70 <input type="checkbox"/> OVERNIGHT FREIGHT** (Confirmed reservation required) 80 <input type="checkbox"/> TWO-DAY FREIGHT** (Declared value limit \$500. Call for delivery schedule.)		Dim Shipment (Chargeable Weight) L x W x H 1 x 1 x 1 1 <input checked="" type="checkbox"/> Regular Stop 3 <input type="checkbox"/> Drop Box 2 <input type="checkbox"/> On-Call Stop 5 <input type="checkbox"/> Station	
						Received At 1 <input type="checkbox"/> Regular Stop 3 <input type="checkbox"/> Drop Box 2 <input type="checkbox"/> On-Call Stop 5 <input type="checkbox"/> Station			
						Release Signature: _____			



USE THIS AIRBILL FOR SHIPMENTS WITHIN THE CONTINENTAL U.S.A., ALASKA AND HAWAII.
USE THE INTERNATIONAL AIR WAYBILL FOR SHIPMENTS TO PUERTO RICO AND ALL NON U.S. LOCATIONS.
QUESTIONS? CALL 800-238-5355 TOLL FREE.

AIRBILL
PACKAGE
TRACKING NUMBER
8106786391

3228M

8106786391

RECIPIENT'S COPY

From (Your Name) Please Print

Date 09-11-93

Your Phone Number (Very Important)

To (Recipient's Name) Please Print

Recipient's Phone Number (Very Important)

Peggy Bradford

(505) 326-9701

Michael Stogner

505

Department 505

MERIDIAN OIL PRODUCTION INC

Exact Street Address (We cannot deliver to PO Boxes or P.O. Box Coasts) DIVISION

3535 E 30TH STREET

310 Old Santa Fe

State 11

ZIP Required

FARMINGTON

State NM

ZIP Required 87401

YOUR INTERNAL BILLING REFERENCE INFORMATION (optional) (First 24 characters will appear on invoice.)

310 Old Santa Fe
HOLD AT FEDEX LOCATION, Print FEDEX Address Here

State 11 ZIP Required 81501

PRIME 1 ☒ Bill Sender 2 ☐ Bill Recipient's FedEx Acct. No. 3 ☐ Bill 3rd Party FedEx Acct. No. 4 ☐ Bill Credit Card

5 ☐ Other ☐ Other

City State ZIP Required

Base Charges

SERVICES (Check only one box)

5 DELIVERY AND SPECIAL HANDLING (Check services required)

PACKAGES WEIGHT In Pounds (See page)

YOUR DECLARED VALUE (See page)

Federal Express Use

Priority Overnight (Delivery by next business morning)

1 ☐ HOLD AT FEDEX LOCATION WEEKEND (Fill in section H)

2 ☒ DELIVER WEEKDAY

Emp. No. Date

Declared Value Change

11 OTHER PACKAGING

51 OTHER PACKAGING

Return Shipment

City State Zip

Other 1

12 FEDEX LETTER

56 FEDEX LETTER

Third Party

City State Zip

Other 2

13 FEDEX PAK

52 FEDEX PAK

Cng. To Del

City State Zip

Other 3

14 FEDEX BOX

53 FEDEX BOX

Cng. To Hold

City State Zip

Other 4

15 FEDEX TUBE

54 FEDEX TUBE

Received By:

City State Zip

Other 5

16 FEDEX TUBE

55 FEDEX TUBE

Date/Time Received

City State Zip

Other 6

17 FEDEX TUBE

56 FEDEX TUBE

Fedex Employee Number

City State Zip

Other 7

18 FEDEX TUBE

57 FEDEX TUBE

Release Signature:

City State Zip

Other 8

19 FEDEX TUBE

58 FEDEX TUBE

Revision Date 12/92

City State Zip

Other 9

20 FEDEX TUBE

59 FEDEX TUBE

Part #137204 FPEM 799

City State Zip

Other 10

21 FEDEX TUBE

60 FEDEX TUBE

Format #158

City State Zip

Other 11

22 FEDEX TUBE

61 FEDEX TUBE

© 1992-93 FEDEX

City State Zip

Other 12

23 FEDEX TUBE

62 FEDEX TUBE

PRINTED IN U.S.A.

City State Zip

Other 13

24 FEDEX TUBE

63 FEDEX TUBE

158

City State Zip

Other 14

25 FEDEX TUBE

64 FEDEX TUBE

158

City State Zip

Other 15

26 FEDEX TUBE

65 FEDEX TUBE

158

City State Zip

Other 16

27 FEDEX TUBE

66 FEDEX TUBE

158

City State Zip

Other 17

28 FEDEX TUBE

67 FEDEX TUBE

158

City State Zip

Other 18

29 FEDEX TUBE

68 FEDEX TUBE

158

City State Zip

Other 19

30 FEDEX TUBE

69 FEDEX TUBE

158

City State Zip

Other 20

31 FEDEX TUBE

70 FEDEX TUBE

158

City State Zip

Other 21

32 FEDEX TUBE

71 FEDEX TUBE

158

City State Zip

Other 22

33 FEDEX TUBE

72 FEDEX TUBE

158

City State Zip

Other 23

34 FEDEX TUBE

73 FEDEX TUBE

158

City State Zip

Other 24

35 FEDEX TUBE

74 FEDEX TUBE

158

City State Zip

Other 25

36 FEDEX TUBE

75 FEDEX TUBE

158

City State Zip

Other 26

37 FEDEX TUBE

76 FEDEX TUBE

158

City State Zip

Other 27

38 FEDEX TUBE

77 FEDEX TUBE

158

City State Zip

Other 28

39 FEDEX TUBE

78 FEDEX TUBE

158

City State Zip

Other 29

40 FEDEX TUBE

79 FEDEX TUBE

158

City State Zip

Other 30

41 FEDEX TUBE

80 FEDEX TUBE

158

City State Zip

Other 31

42 FEDEX TUBE

81 FEDEX TUBE

158

City State Zip

Other 32

43 FEDEX TUBE

82 FEDEX TUBE

158

City State Zip

Other 33

44 FEDEX TUBE

83 FEDEX TUBE

158

City State Zip

Other 34

45 FEDEX TUBE

84 FEDEX TUBE

158

City State Zip

Other 35

46 FEDEX TUBE

85 FEDEX TUBE

158

City State Zip

Other 36

47 FEDEX TUBE

86 FEDEX TUBE

158

City State Zip

Other 37

48 FEDEX TUBE

87 FEDEX TUBE

158

City State Zip

Other 38

49 FEDEX TUBE

88 FEDEX TUBE

158

City State Zip

Other 39

50 FEDEX TUBE

89 FEDEX TUBE

158

City State Zip

Other 40

51 FEDEX TUBE

90 FEDEX TUBE

158

City State Zip

Other 41

52 FEDEX TUBE

91 FEDEX TUBE

158

City State Zip

Other 42

53 FEDEX TUBE

92 FEDEX TUBE

158

City State Zip

Other 43

54 FEDEX TUBE

93 FEDEX TUBE

158

City State Zip

Other 44

55 FEDEX TUBE

94 FEDEX TUBE

158

City State Zip

Other 45

56 FEDEX TUBE

95 FEDEX TUBE

158

City State Zip

Other 46

57 FEDEX TUBE

96 FEDEX TUBE

158

City State Zip

Other 47

58 FEDEX TUBE

97 FEDEX TUBE

158

City State Zip

Other 48

59 FEDEX TUBE

98 FEDEX TUBE

158

City State Zip

Other 49

60 FEDEX TUBE

99 FEDEX TUBE

158

City State Zip

Other 50

61 FEDEX TUBE

100 FEDEX TUBE

158

City State Zip

Other 51

62 FEDEX TUBE

101 FEDEX TUBE

158

City State Zip

Other 52

63 FEDEX TUBE

102 FEDEX TUBE

158

City State Zip

Other 53

64 FEDEX TUBE

103 FEDEX TUBE

158

City State Zip

Other 54

65 FEDEX TUBE

104 FEDEX TUBE

158

City State Zip

Other 55

66 FEDEX TUBE

105 FEDEX TUBE

158

City State Zip

Other 56

67 FEDEX TUBE

106 FEDEX TUBE

158

City State Zip

Other 57

68 FEDEX TUBE

107 FEDEX TUBE

158

City State Zip

Other 58

69 FEDEX TUBE

108 FEDEX TUBE

158

City State Zip

Other 59

70 FEDEX TUBE

109 FEDEX T

MERIDIAN OIL

OIL CONSERVATION DIVISION
RECEIVED

'93 OCT 8 AM 9 20

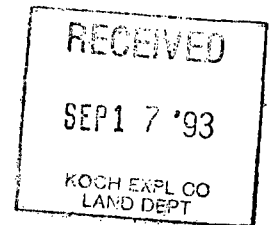

September 14, 1993

Federal Express

Mr. William LeMay
New Mexico Oil Conservation Division
310 Old Santa Fe Trail
Santa Fe, New Mexico 87503

Re: Huerfano Unit #205
1850'FSL, 1850'FEL
Section 28, T-26-N, R-9-W, San Juan County, NM

Dear Mr. LeMay:

This is a request for administrative approval for a non-standard gas well location in the Basin Fruitland Coal Pool.

Meridian Oil intends to plugback and recomplete the Huerfano Unit #205 from the Basin Dakota to the Basin Fruitland Coal Pool. The current location of this well is considered non-standard due to the NE-SW dedicated pattern established for the Basin Fruitland Coal pool. To comply with the New Mexico Oil Conservation Division rules, Meridian is submitting the following for your approval of this non-standard location:

1. C-102 plat showing location of the well;
2. Plat showing offset owners/operators;
3. Affidavit of notification of offset owners/operators;
4. Copy of Well Completion Log for original completion.

A copy of this application is being submitted to all offset owners/operators by certified mail with a request that they furnish your Santa Fe office with a Waiver of Objection, and return one copy to this office.

Sincerely yours,

Peggy Bradfield
Regulatory/Compliance Representative

WAIVER

Koch Exploration Co hereby waives objection to Meridian Oil's application for non-standard location for the Huerfano Unit #205 as proposed above.

By: [Signature] Date: 10/5/93

xc: Amax Petroleum
Koch Exploration

May 24, 1990

Meridian Oil, Inc.
P.O. Box 4289
Farmington, NM 87499-4289

Attention: Peggy Bradfield

Administrative Order NSL- 3320

Dear Ms. Bradfield:

Reference is made to your application dated 9/14/93 1990 for a non-standard Basin-Fruitland coal gas well location for your existing Meridian Unit Well No. 205 which was drilled in 1970 and completed in the Basin Dakota Pool at a standard gas well location 1850 feet from the South line and 1850 feet from the East line (Unit 1) of Section 28, Township 26 North, Range 9 West, NMPM, Sanguan County, New Mexico.

It is my understanding that the Dakota zone will be properly plugged back and said well will be recomplected to the Basin-Fruitland Coal Gas Pool, which pursuant to the Special Rules and Regulations for the Basin-Fruitland Coal Gas Pool as promulgated by Division Order No. R-8768, is unorthodox. Further, 2/2 of said Section 28 shall be dedicated to the well forming a standard 320-acre gas spacing and proration unit for said pool.

By the authority granted me under the provisions of Rule 8 of said Division Order No. R-8768, the above-described unorthodox coal gas well location is hereby approved.

Sincerely,

William J. LeMay
Director

WJL/MES/ag

cc: Oil Conservation Division - Aztec
US Bureau of Land Management - Farmington



STATE OF NEW MEXICO
ENERGY, MINERALS AND NATURAL RESOURCES DEPARTMENT
OIL CONSERVATION DIVISION



BRUCE KING
GOVERNOR

ANITA LOCKWOOD
CABINET SECRETARY

POST OFFICE BOX 2088
STATE LAND OFFICE BUILDING
SANTA FE, NEW MEXICO 87504
(505) 827-5800

April 13, 1994

Meridian Oil, Inc.
P.O. Box 4289
Farmington, NM 87499-4289

Attention: Peggy Bradfield

**RE: *Unorthodox coal gas well location, Huerfano Unit Well No. 205.
1850' FS & EL, (Unit J); Section 28, Township 26 North, Range 9 West,
NMPM, Basin-Fruitland Coal Gas Pool, San Juan County, New Mexico.***

Dear Ms. Bradfield:

Per your letter dated April 5, 1994, the subject application is hereby withdrawn from consideration.

Sincerely,

A handwritten signature in black ink, appearing to read "Michael E. Stogner".

Michael E. Stogner
Chief Hearing Officer/Engineer

MES/amg

cc: Oil Conservation Division - Aztec
US Bureau of Land Management - Farmington

STATE OF NEW MEXICO

ENERGY, MINERALS AND NATURAL RESOURCES DEPARTMENT

OIL CONSERVATION DIVISION



BRUCE KING
GOVERNOR

ANITA LOCKWOOD
CABINET SECRETARY

October 19, 1993

POST OFFICE BOX 2088
STATE LAND OFFICE BUILDING
SANTA FE, NEW MEXICO 87504
(505) 827-5800

Meridian Oil, Inc.
P.O. Box 4289
Farmington, NM 87499-4289

Attention: Peggy Bradfield

Administrative Order NSL-3320

Dear Ms. Bradfield:

Reference is made to your application dated September 14, 1993, 1992 for a non-standard Basin-Fruitland coal gas well location for your existing Huerfano Unit Well No. 205 which was drilled in 1970 and completed in the Basin Dakota Pool at a standard gas well location 1850 feet from the South and East lines (Unit J) of Section 28, Township 26 North North, Range 9 West West, NMPM, San Juan County, New Mexico.

It is my understanding that the Dakota zone will be properly plugged back and said well will be recompleted to the Basin-Fruitland Coal Gas Pool, which pursuant to the Special Rules and Regulations for the Basin-Fruitland Coal Gas Pool as promulgated by Division Order No. R-8768, as amended, is unorthodox. Further, the S/2 of said Section 28 shall be dedicated to the well forming a standard 320-acre gas spacing and proration unit for said pool.

By the authority granted me under the provisions of Rule 8 of said Division Order No. R-8768, as amended, the above-described unorthodox coal gas well location is hereby approved.

Sincerely,

William J. LeMay
Director

WJL/MES/amg

cc: Oil Conservation Division - Aztec
US Bureau of Land Management - Farmington



STATE OF NEW MEXICO
ENERGY, MINERALS AND NATURAL RESOURCES DEPARTMENT
OIL CONSERVATION DIVISION



BRUCE KING
GOVERNOR

October 28, 1993

POST OFFICE BOX 2088
STATE LAND OFFICE BUILDING
SANTA FE, NEW MEXICO 87504
(505) 827-5800

ANITA LOCKWOOD
CABINET SECRETARY

Meridian Oil, Inc.
P.O. Box 4289
Farmington, NM 87499-4289

Attention: Peggy Bradfield

RE: *Unorthodox coal gas well location, Huerfano Unit Well No. 205, 1850' FSL & EL (Unit J); Section 28, Township 26 North, Range 9 West, NMPM, Basin-Fruitland Coal Gas Pool, San Juan County, New Mexico.*

Dear Ms. Bradfield:

Having receiving several applications in the past to recomplete existing wells to the Basin-Fruitland Coal Gas Pool at unorthodox coal gas well locations, which are off pattern for coal gas development, it appears that additional information may be necessary to properly evaluate future filings in instances when there are two wells in the proposed coal spacing unit producing from the same formation in which the one to be recompleted is also off pattern.

In the immediate instance, the proposed S/2 320-acre coal dedication has two Basin Dakota gas wells; the subject Huerfano Unit Well No. 205 located in Unit J and the Huerfano Unit Well No. 205E located in Unit M at a standard coal gas well location. Why was the No. 205 well chosen over the 205E well? Also, how does this off pattern recompletion affect coal development in the immediate area? Please submit any supporting production data, engineering evaluation and related technical data to support your choice of wells for recompletion. Also, submit a plat of the offsetting sections showing the coal completions presently planned or currently producing and provide a discussion addressing the proposed off pattern development.

Should you have any questions, please contact me.

Sincerely,

Michael E. Stogner
Chief Hearing Officer/Engineer

MES/amg

cc: Oil Conservation Division - Aztec
US Bureau of Land Management - Farmington



STATE OF NEW MEXICO
ENERGY, MINERALS AND NATURAL RESOURCES DEPARTMENT
OIL CONSERVATION DIVISION



BRUCE KING
GOVERNOR

ANITA LOCKWOOD
CABINET SECRETARY

March 4, 1994

POST OFFICE BOX 2088
STATE LAND OFFICE BUILDING
SANTA FE, NEW MEXICO 87504
(505) 827-5800

Meridian Oil, Inc.
P.O. Box 4289
Farmington, NM 87499-4289

Attention: Peggy Bradfield

**RE: Unorthodox coal gas well location, Huerfano Unit Well No. 205.
1850' FS & EL, (Unit J); Section 28, Township 26 North, Range 9 West,
NMPM, Basin-Fruitland Coal Gas Pool, San Juan County, New Mexico.**

Dear Ms. Bradfield:

In reviewing my records of outstanding administrative applications, I show the subject application dated September 14, 1993 is still pending action by the Division. Further, I don't show a reply to my letter dated October 28, 1993 (see copy attached).

Please contact me as to Meridian's plans for pursuing this application further.

Should you have any questions, please contact me.

Sincerely,

A handwritten signature in black ink, appearing to read "Michael E. Stogner".

Michael E. Stogner
Chief Hearing Officer/Engineer

MES/amg

cc: Oil Conservation Division - Aztec
US Bureau of Land Management - Farmington



STATE OF NEW MEXICO
ENERGY, MINERALS AND NATURAL RESOURCES DEPARTMENT
OIL CONSERVATION DIVISION



BRUCE KING
GOVERNOR

ANITA LOCKWOOD
CABINET SECRETARY

October 28, 1993

POST OFFICE BOX 2088
STATE LAND OFFICE BUILDING
SANTA FE, NEW MEXICO 87504
(505) 827-5800

Meridian Oil, Inc.
P.O. Box 4289
Farmington, NM 87499-4289

Attention: Peggy Bradfield

RE: *Unorthodox coal gas well location, Huerfano Unit Well No. 205, 1850' FSL & EL (Unit J); Section 28, Township 26 North, Range 9 West, NMPM, Basin-Fruitland Coal Gas Pool, San Juan County, New Mexico.*

Dear Ms. Bradfield:

Having receiving several applications in the past to recomplete existing wells to the Basin-Fruitland Coal Gas Pool at unorthodox coal gas well locations, which are off pattern for coal gas development, it appears that additional information may be necessary to properly evaluate future filings in instances when there are two wells in the proposed coal spacing unit producing from the same formation in which the one to be recompleted is also off pattern.

In the immediate instance, the proposed S/2 320-acre coal dedication has two Basin Dakota gas wells; the subject Huerfano Unit Well No. 205 located in Unit J and the Huerfano Unit Well No. 205E located in Unit M at a standard coal gas well location. Why was the No. 205 well chosen over the 205E well? Also, how does this off pattern recompletion affect coal development in the immediate area? Please submit any supporting production data, engineering evaluation and related technical data to support your choice of wells for recompletion. Also, submit a plat of the offsetting sections showing the coal completions presently planned or currently producing and provide a discussion addressing the proposed off pattern development.

Should you have any questions, please contact me.

Sincerely,

Michael E. Stogner
Chief Hearing Officer/Engineer

MES/amg

cc: Oil Conservation Division - Aztec
US Bureau of Land Management - Farmington

MERIDIAN OIL

OIL CONSERVATION DIVISION
RECEIVED
'94 APR 13 AM 8 50

April 5, 1994

Mr. Michael E. Stogner
Chief Hearing Officer/Engineer
New Mexico Oil Conservation Division
310 Old Santa Fe Trail
Santa Fe, New Mexico 87501

Re: Huerfano Unit #205
1850'FSL, 1850'FEL, Section 28, T-26-N, R-9-W

Dear Michael:

Please withdraw our application for unorthodox location for the above well. We do not plan to proceed with the recompletion of this well at this time. We will re-apply if the well is considered for recompletion in the future.

Thank you for your consideration of this matter.

Sincerely,

Peggy Bradfield
Regulatory/Compliance Representative



STATE OF NEW MEXICO
ENERGY, MINERALS and NATURAL RESOURCES DEPARTMENT
OIL CONSERVATION DIVISION
AZTEC DISTRICT OFFICE

'93 SEP 22 PM 8 59

1000 RIO BRAZOS ROAD
AZTEC, NEW MEXICO 87410
(505) 334-6178

Date: 9-21-93

Attn: Mike Stogner

Oil Conservation Division
P.O. Box 2088
Santa Fe, NM 87504-2088

RE: Proposed MC _____
Proposed NSL X _____
Proposed WFX _____
Proposed NSP _____

Proposed DHC _____
Proposed SWD _____
Proposed PMX _____
Proposed DD _____

Gentlemen:

I have examined the application received on 9-16-93
for the Meridian Huerfano Unit #205
OPERATOR LEASE & WELL NO.

J-28-26N-09W and my recommendations are as follows:
UL-S-T-R

Approve

Yours truly,

Emilio Busch