

5/22/08 DATE IN	SUSPENSE	W Jones ENGINEER	5/22/08 LOGGED IN	DHC TYPE 4031	PKUR08/4330965 APP NO.
--------------------	----------	---------------------	----------------------	---------------------	---------------------------

ABOVE THIS LINE FOR DIVISION USE ONLY

NEW MEXICO OIL CONSERVATION DIVISION
- Engineering Bureau -
 1220 South St. Francis Drive, Santa Fe, NM 87505



ADMINISTRATIVE APPLICATION CHECKLIST

THIS CHECKLIST IS MANDATORY FOR ALL ADMINISTRATIVE APPLICATIONS FOR EXCEPTIONS TO DIVISION RULES AND REGULATIONS WHICH REQUIRE PROCESSING AT THE DIVISION LEVEL IN SANTA FE

Application Acronyms:

[NSL-Non-Standard Location] [NSP-Non-Standard Proration Unit] [SD-Simultaneous Dedication]
[DHC-Downhole Commingling] [CTB-Lease Commingling] [PLC-Pool/Lease Commingling]
[PC-Pool Commingling] [OLS - Off-Lease Storage] [OLM-Off-Lease Measurement]
[WFX-Waterflood Expansion] [PMX-Pressure Maintenance Expansion]
[SWD-Salt Water Disposal] [IPI-Injection Pressure Increase]
[EOR-Qualified Enhanced Oil Recovery Certification] [PPR-Positive Production Response]

[1] TYPE OF APPLICATION - Check Those Which Apply for [A]

[A] Location - Spacing Unit - Simultaneous Dedication
☐ NSL ☐ NSP ☐ SD

Check One Only for [B] or [C]

[B] Commingling - Storage - Measurement
☒ DHC ☐ CTB ☐ PLC ☐ PC ☐ OLS ☐ OLM

[C] Injection - Disposal - Pressure Increase - Enhanced Oil Recovery
☐ WFX ☐ PMX ☐ SWD ☐ IPI ☐ EOR ☐ PPR

[D] Other: Specify _____

[2] NOTIFICATION REQUIRED TO: - Check Those Which Apply, or ☐ Does Not Apply

- [A] ☐ Working, Royalty or Overriding Royalty Interest Owners
- [B] ☐ Offset Operators, Leaseholders or Surface Owner
- [C] ☐ Application is One Which Requires Published Legal Notice
- [D] ☐ Notification and/or Concurrent Approval by BLM or SLO
U.S. Bureau of Land Management - Commissioner of Public Lands, State Land Office
- [E] ☐ For all of the above, Proof of Notification or Publication is Attached, and/or,
- [F] ☐ Waivers are Attached

RECEIVED
2008 MAY 21 PM 12 42

[3] SUBMIT ACCURATE AND COMPLETE INFORMATION REQUIRED TO PROCESS THE TYPE OF APPLICATION INDICATED ABOVE.

[4] CERTIFICATION: I hereby certify that the information submitted with this application for administrative approval is **accurate** and **complete** to the best of my knowledge. I also understand that **no action** will be taken on this application until the required information and notifications are submitted to the Division.

Note: Statement must be completed by an individual with managerial and/or supervisory capacity.

Billy E. Prichard
 Print or Type Name

Billy E. Prichard
 Signature

Agent for Judah Oil LLC
 Title

5/18/08
 Date

billy@pwillc.net
 e-mail Address

Pueblo West LLC
Oilfield Consulting Service

May 18, 2008

New Mexico Oil Conservation Division
Engineering Bureau
1220 South St. Francis
Santa Fe, NM 87505

Re: Judah Oil, LLC

**Application for Downhole Commingle of the Penroc New Mexico BW State #2
API # 30-005-10081**

UL F, Section 20, T8S, R33E

Lea County, NM

Will,

Please find enclosed the paperwork for the Downhole Commingle of the Tobac, Abo and the Tobac, Penn in the above referenced well. Judah proposes to drill out CIBP and individually test the 2 zones. Past production data was hard to determine on the 2 zones and percentages of production will be reported when the testing is complete. Please call or email in further information is required.

Sincerely,

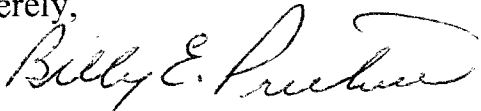

Billy (Bill) E. Prichard

*1611 SE 5th Street
Seminole, TX 79360
Phone: 432-955-0680
Cell: 575-390-9100
E-mail: billy@pwllc.net*

RECEIVED
2008 MAY 21 PM 12 42

District I
1625 N. French Drive, Hobbs, NM 88240

District II
1301 W. Grand Avenue, Artesia, NM 88210

District III
1000 Rio Brazos Road, Aztec, NM 87410

District IV
1220 S. St. Francis Dr., Santa Fe, NM 87505

State of New Mexico
Energy, Minerals and Natural Resources Department

Form C-107A
Revised June 10, 2003

Oil Conservation Division

1220 South St. Francis Dr.
Santa Fe, New Mexico 87505

APPLICATION TYPE

☒ Single Well
☒ Establish Pre-Approved Pools
EXISTING WELLBORE

☒ Yes ☐ No

APPLICATION FOR DOWNHOLE COMMINGLING

Judah Oil, L.L.C. P.O. Box 568 Artesia, NM 88211

DAC-4031

Operator Address
PENROC NEW MEXICO BW STATE No. 002 F -20-8S-33E Chaves

Lease Well No. Unit Letter-Section-Township-Range County

OGRID No. 245872 Property Code 303435 API No. 3000510081 Lease Type: ☐ Federal ☒ State ☐ Fee

DATA ELEMENT	UPPER ZONE	INTERMEDIATE ZONE	LOWER ZONE
Pool Name	Tobac; Abo <i>DIL</i>		Tobac; <i>Upper Penn</i> <i>oil</i>
Pool Code	59340 <i>✓</i>		59350
Top and Bottom of Pay Section (Perforated or Open-Hole Interval)	Perforations 8162-8270ft		Perforations 8967-8984ft
Method of Production (Flowing or Artificial Lift)	Artificial Lift 320 Pumping Unit		Artificial Lift 320 Pumping Unit
Bottomhole Pressure (Note: Pressure data will not be required if the bottom perforation in the lower zone is within 150% of the depth of the top perforation in the upper zone)			
Oil Gravity or Gas BTU (Degree API or Gas BTU)	42.3 API		42.6
Producing, Shut-In or New Zone	Shut In		Shut In
Date and Oil/Gas/Water Rates of Last Production. (Note: For new zones with no production history, applicant shall be required to attach production estimates and supporting data.)	Date: December 1984 Rates: 2 BO, 0BW	Date: Rates:	Date: April 1983 Rates: No available data
Fixed Allocation Percentage (Note: If allocation is based upon something other than current or past production, supporting data or explanation will be required.)	Oil Gas No current production % will be calculated when well is tested	Oil Gas % %	Oil Gas No current production % will be calculated when well is tested

ADDITIONAL DATA

Are all working, royalty and overriding royalty interests identical in all commingled zones? Yes ☒ No ☐
If not, have all working, royalty and overriding royalty interest owners been notified by certified mail? Yes ☐ No ☐

Are all produced fluids from all commingled zones compatible with each other? Yes ☒ No ☐

Will commingling decrease the value of production? Yes ☐ No ☒

If this well is on, or communitized with, state or federal lands, has either the Commissioner of Public Lands
or the United States Bureau of Land Management been notified in writing of this application? Yes ☐ No ☒

NMOCD Reference Case No. applicable to this well: _____

Attachments:

- C-102 for each zone to be commingled showing its spacing unit and acreage dedication.
- Production curve for each zone for at least one year. (If not available, attach explanation.)
- For zones with no production history, estimated production rates and supporting data.
- Data to support allocation method or formula.
- Notification list of working, royalty and overriding royalty interests for uncommon interest cases.
- Any additional statements, data or documents required to support commingling.

PRE-APPROVED POOLS

If application is to establish Pre-Approved Pools, the following additional information will be required:
List of other orders approving downhole commingling within the proposed Pre-Approved Pools
List of all operators within the proposed Pre-Approved Pools
Proof that all operators within the proposed Pre-Approved Pools were provided notice of this application.
Bottomhole pressure data.

I hereby certify that the information above is true and complete to the best of my knowledge and belief.

SIGNATURE *Billy E. Prichard* TITLE Agent for Judah Oil, LLC DATE *5/18/08*

TYPE OR PRINT NAME Billy E. Prichard

TELEPHONE NO. 575-390-9100

E-MAIL ADDRESS billy@pwlle.net

Federal Les. No. _____ All distances must be from the outer boundaries of the Section.

Operator Exxon Corporation		Lease New Mexico State "BW"		Well No. 2
Unit Letter F	Section 20	Township 8 South	Range 33 East	County Chaves
Actual Footage Location of Well: 1980 feet from the North line and 1980 feet from the West line				
Ground Level Elev.:	Producing Formation ABO	Pool Undesignated Abo	Dedicated Acreage: 40 Acres	

1. Outline the acreage dedicated to the subject well by colored pencil or hachure marks on the plat below.
2. If more than one lease is dedicated to the well, outline each and identify the ownership thereof (both as to working interest and royalty).
3. If more than one lease of different ownership is dedicated to the well, have the interests of all owners been consolidated by communitization, unitization, force-pooling, etc?

☐ Yes ☐ No If answer is "yes," type of consolidation _____

If answer is "no," list the owners and tract descriptions which have actually been consolidated. (Use reverse side of this form if necessary.) _____

No allowable will be assigned to the well until all interests have been consolidated (by communitization, unitization, forced-pooling, or otherwise) or until a non-standard unit, eliminating such interests, has been approved by the Commission.

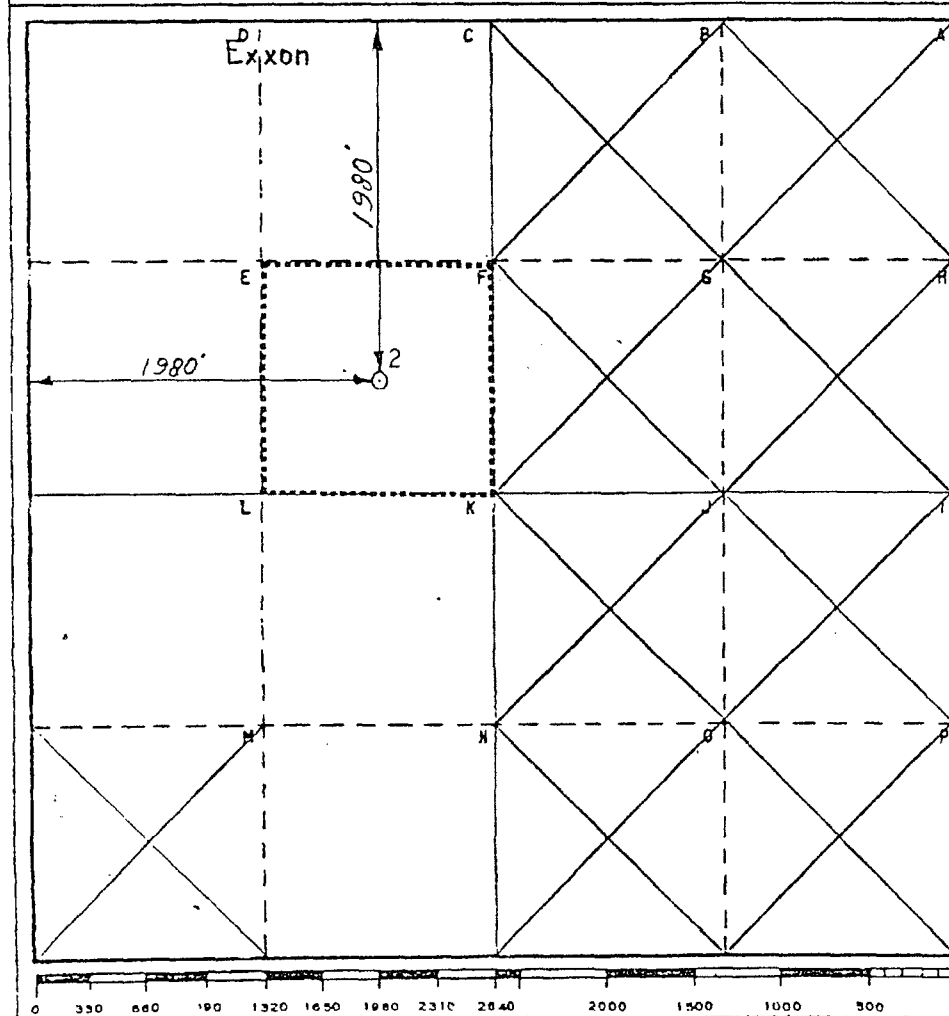

CERTIFICATION

I hereby certify that the information contained herein is true and complete to the best of my knowledge and belief.

Name
Melba Kripling

Position
UNIT HEAD

Company Exxon Corporation
Box 1600 Midland, Texas

Date
8-21-84

I hereby certify that the well location shown on this plat was plotted from field notes of actual surveys made by me or under my supervision, and that the same is true and correct to the best of my knowledge and belief.

Date Surveyed
8-3-84
Registered Professional Engineer
and/or Land Surveyor

W. K. R. H. H.

Certificate No.
46595 Texas

2.1 Miles West of Midland, New Mexico

C.E. Sec. File No. W-A-3589

HUMBLE LEASE NO. 211597 NEW MEXICO OIL CONSERVATION COMMISSION

STATE LEASE NO. E9089

FEDERAL LEASE NO.

Well Location and Acreage Dedication Plat

Form C-128
Revised 5/1/57

Section A.

Date Sept 3, 1964

Operator HUMBLE OIL & REFINING CO. Lease NEW MEXICO STATE "B.N."
Well No. 2 Unit Letter F Section 20 Township B South Range 33 East NWPM
Located 1980 Feet From North Line, 1980 Feet From West Line
County CHAVES G. L. Elevation Later Dedicated Acreage 80 Acres
Name of Producing Formation Pean (Blough "C") Pool TOBAC

1. Is the Operator the only owner* in the dedicated acreage outlined on the plat below?

Yes ☒ No ☐

2. If the answer to question one is "no", have the interests of all the owners been consolidated by communitization agreement or otherwise? Yes ☐ No ☒ If answer is "yes," Type of Consolidation _____

3. If the answer to question two is "no," list all the owners and their respective interests below:

Owner

Land Description

Section B

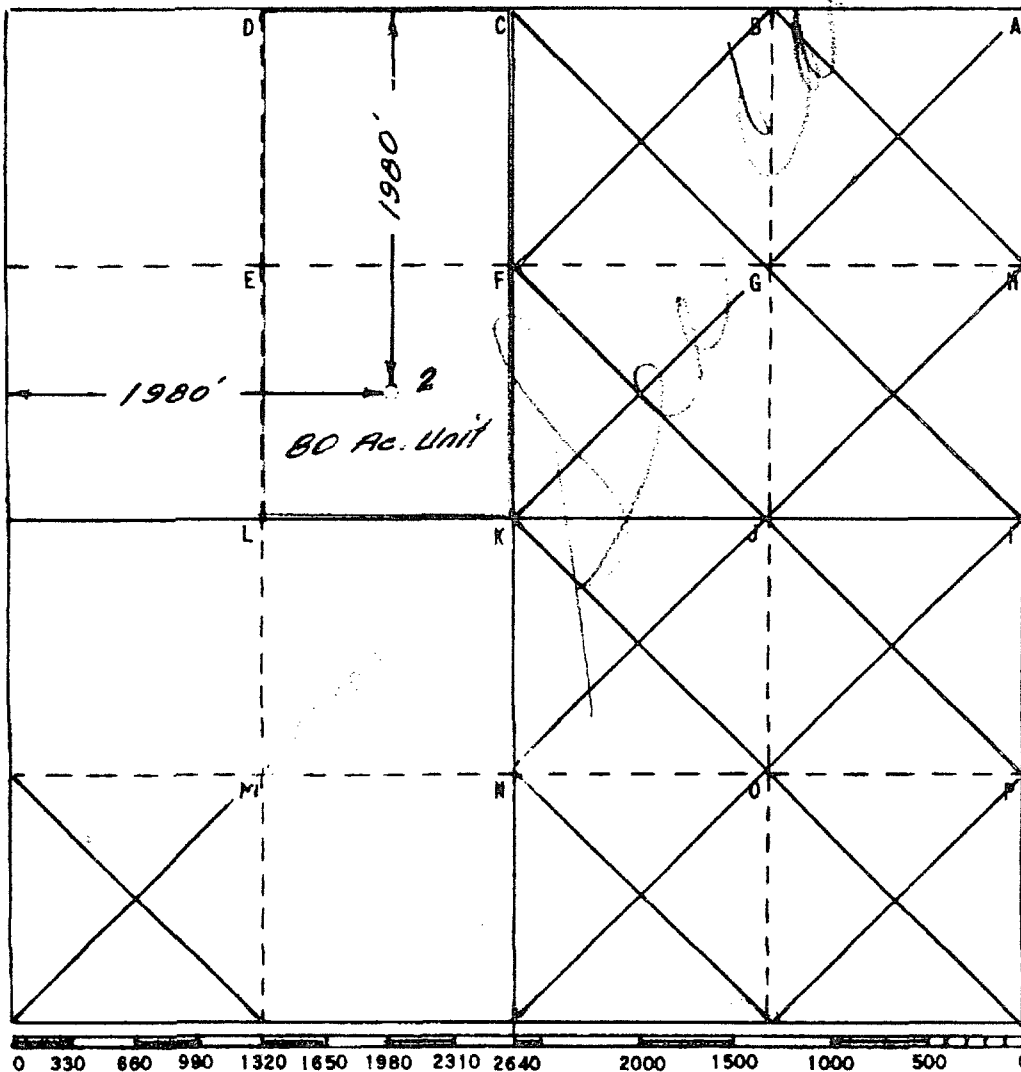

This is to certify that the information in Section A above is true and complete to the best of my knowledge and belief

HUMBLE OIL & REFG. CO.

(Operator)

H. R. Hensley

(Representative)

Box 1600 Midland, Texas

Address

This is to certify that the well location shown on the plat in Section B was plotted from field notes of actual surveys made by me or under my supervision and that the same is true and correct to the best of my knowledge and belief.

Date Surveyed 9-3-64

H. S. Hesterfield
Registered Professional
Engineer and/or Land Surveyor

Certificate No. 1382

FILE NO. W-A- 3589

Judah Oil, LLC
 Penroc New Mexico BW State # 2
 API # 30-005-10081
 UL "F", Section 2, T8S, R33E
 Chaves County, New Mexico
 Prior to DO and DHC

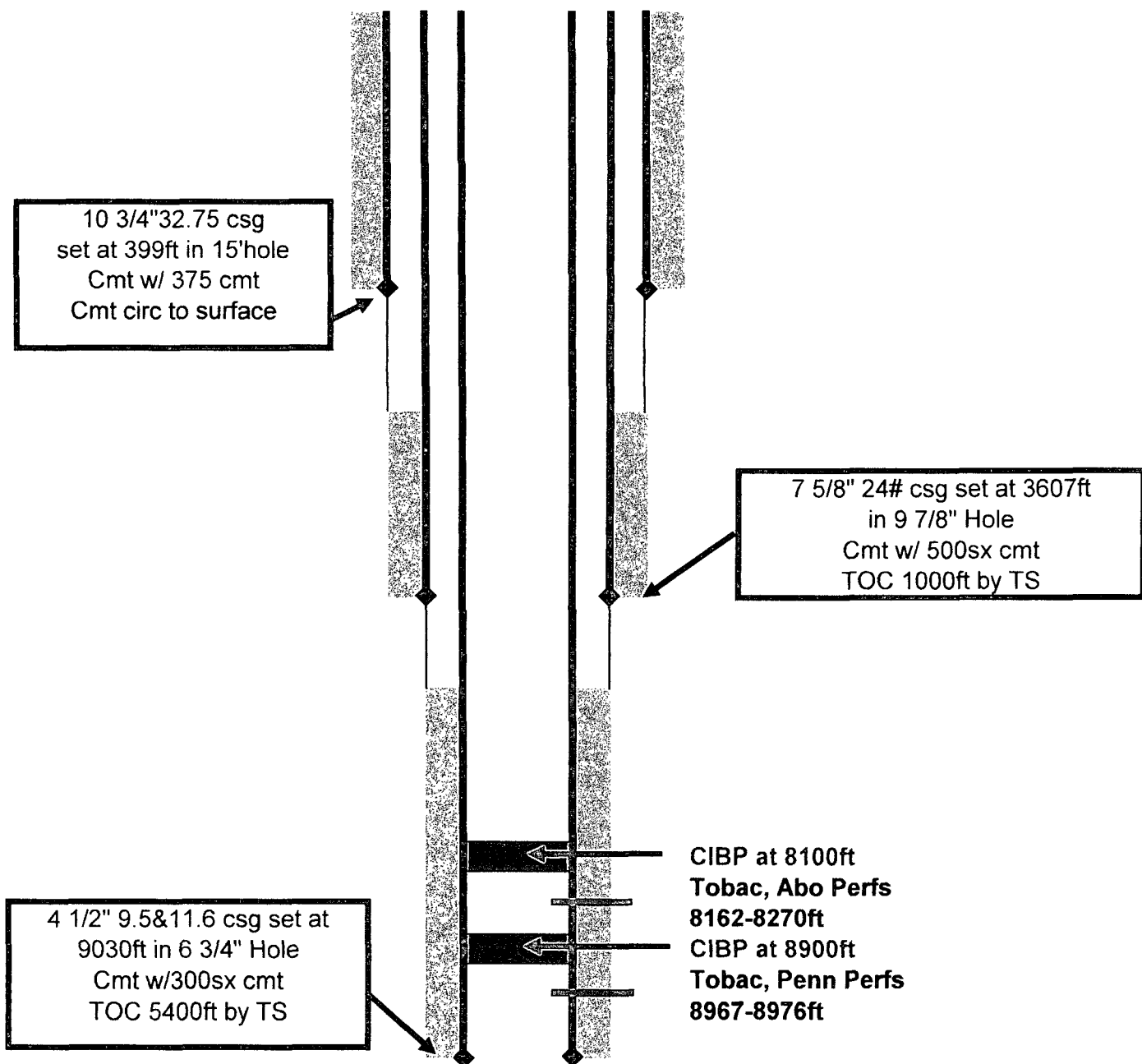

Judah Oil, LLC
Penroc New Mexico BW State # 2
API # 30-005-10081
UL "F", Section 2, T8S, R33E
Chaves County, New Mexico
After to DO and DHC

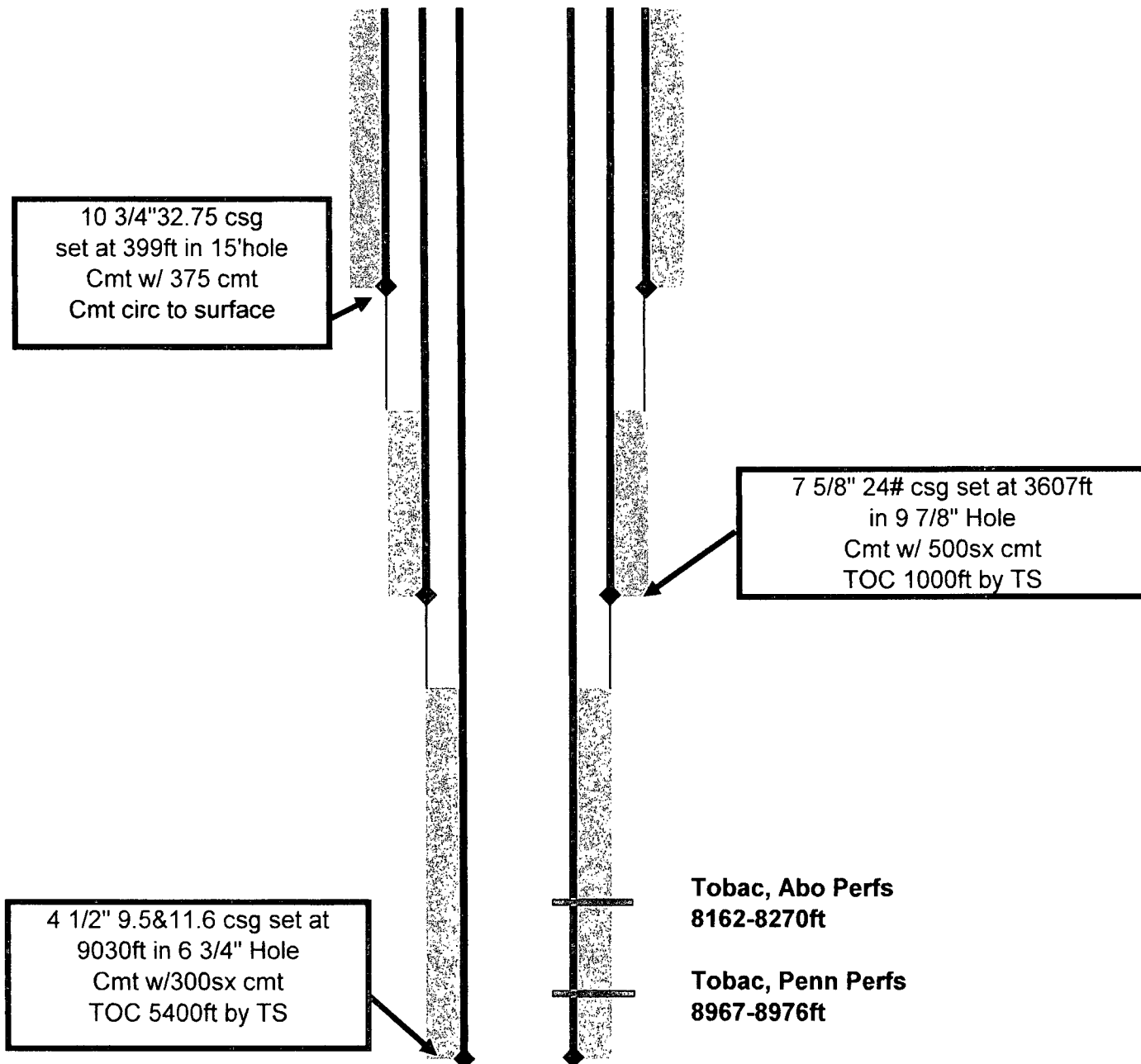

Pueblo West LLC
Oilfield Consulting Service

May 18, 2008

New Mexico Oil Conservation Division
1625 N. French Drive
Hobbs, NM 88240

CERTIFIED MAIL ; 7007 0710 0002 5069 8912

Re: Judah Oil, LLC

**Application for Downhole Commingle of the Penroc New Mexico BW State #2
API # 30-005-10081
UL F, Section 20, T8S, R33E
Lea County, NM**

To Whom It May Concern:

Please find enclosed the paperwork for the Downhole Commingle of the Tobac, Abo and the Tobac, Penn in the above referenced well. Judah proposes to drill out CIBP and individually test the 2 zones. Past production data was hard to determine on the 2 zones and percentages of production will be reported when the testing is complete. Please call or email in further information is required. NMOCD form C107a was sent to the engineering bureau in the Santa Fe office.

Sincerely,



Billy (Bill) E. Prichard

*1611 SE 5th Street
Seminole, TX 79360
Phone: 432-955-0680
Cell: 575-390-9100
E-mail: billy@pwllc.net*

District I

1625 N. French Dr., Hobbs, NM 88240

District II

1301 W. Grand Ave., Artesia, NM 88210

District III

1000 Rio Brazos Rd., Aztec, NM 87410

District IV

1220 S. St. Francis Dr., Santa Fe, NM 87505

State of New Mexico
Energy, Minerals and Natural Resources

OIL CONSERVATION DIVISION
1220 South St. Francis Dr.
Santa Fe, NM 87505

May 27, 2004

WELL API NO.

30-005-10081

5. Indicate Type of Lease

STATE ☒ FEE ☐

6. State Oil & Gas Lease No.

7. Lease Name or Unit Agreement Name

Penroc New Mexico BW State

8. Well Number **#002**

9. OGRID Number

245872

10. Pool name or Wildcat

Tobac; Abo

SUNDRY NOTICES AND REPORTS ON WELLS

(DO NOT USE THIS FORM FOR PROPOSALS TO DRILL OR TO DEEPEN OR PLUG BACK TO A DIFFERENT RESERVOIR. USE "APPLICATION FOR PERMIT" (FORM C-101) FOR SUCH PROPOSALS.)

1. Type of Well: Oil Well ☒ Gas Well ☐ Other ☐

2. Name of Operator

Judah Oil, L.L.C.

3. Address of Operator

P.O. Box 568 Artesia, NM 88211

4. Well Location

Unit Letter **F** : **1980** feet from the **North** line and **1980** feet from the **West** line

Section **20** Township **8S** Range **33E** NMPM **Chaves** County

11. Elevation (Show whether DR, RKB, RT, GR, etc.)

Pit or Below-grade Tank Application ☐ or Closure ☐

Pit type _____ Depth to Groundwater _____ Distance from nearest fresh water well _____ Distance from nearest surface water _____

Pit Liner Thickness: _____ mil Below-Grade Tank: Volume _____ bbls; Construction Material _____

12. Check Appropriate Box to Indicate Nature of Notice, Report or Other Data

NOTICE OF INTENTION TO:

PERFORM REMEDIAL WORK ☐ PLUG AND ABANDON ☐

TEMPORARILY ABANDON ☐ CHANGE PLANS ☐

PULL OR ALTER CASING ☐ MULTIPLE COMPL ☐

OTHER: DO CIBP and DHC ☒

SUBSEQUENT REPORT OF:

REMEDIAL WORK ☐ ALTERING CASING ☐

COMMENCE DRILLING OPNS. ☐ P AND A ☐

CASING/CEMENT JOB ☐

OTHER: ☐

13. Describe proposed or completed operations. (Clearly state all pertinent details, and give pertinent dates, including estimated date of starting any proposed work). SEE RULE 1103. For Multiple Completions: Attach wellbore diagram of proposed completion or recompletion.

Judah Oil, LLC proposes to drill out 2 CIBP that are currently in the well and individually test the Tobac; Abo 8162-8270ft and the Tobac, Penn 8967-8986ft. NMOCD from C107a has been filed with NMOCD Santa Fe to Downhole Commingle the 2 Zones.

Attachments current and proposed wellbore diagrams

NMOCD Form C107a

I hereby certify that the information above is true and complete to the best of my knowledge and belief. I further certify that any pit or below-grade tank has been/will be constructed or closed according to NMOCD guidelines ☐, a general permit ☐ or an (attached) alternative OCD-approved plan ☐.

SIGNATURE Billy E. Prichard TITLE Agent for Judah Oil, LLC DATE 5/18/08

Type or print name **Billy E. Prichard**

E-mail address: **billy@pwllc.net** Telephone No. **575-390-9100**

For State Use Only

APPROVED BY: _____ TITLE _____ DATE _____

Conditions of Approval (if any):