

DATE IN 6/27/08	SUSPENSE	ENGINEER Jones	LOGGED IN 6/30/08	TYPE DHC	APP NO. PKVR0818232083
-----------------	----------	----------------	-------------------	----------	------------------------

ABOVE THIS LINE FOR DIVISION USE ONLY

NEW MEXICO OIL CONSERVATION DIVISION
- Engineering Bureau -
1220 South St. Francis Drive, Santa Fe, NM 87505



ADMINISTRATIVE APPLICATION CHECKLIST

THIS CHECKLIST IS MANDATORY FOR ALL ADMINISTRATIVE APPLICATIONS FOR EXCEPTIONS TO DIVISION RULES AND REGULATIONS WHICH REQUIRE PROCESSING AT THE DIVISION LEVEL IN SANTA FE

Application Acronyms:

[NSL-Non-Standard Location] [NSP-Non-Standard Proration Unit] [SD-Simultaneous Dedication]
[DHC-Downhole Commingling] [CTB-Lease Commingling] [PLC-Pool/Lease Commingling]
[PC-Pool Commingling] [OLS - Off-Lease Storage] [OLM-Off-Lease Measurement]
[WFX-Waterflood Expansion] [PMX-Pressure Maintenance Expansion]
[SWD-Salt Water Disposal] [IPI-Injection Pressure Increase]
[EOR-Qualified Enhanced Oil Recovery Certification] [PPR-Positive Production Response]

- [1] **TYPE OF APPLICATION** - Check Those Which Apply for [A]
- [A] Location - Spacing Unit - Simultaneous Dedication
☐ NSL ☐ NSP ☐ SD
- Check One Only for [B] or [C]
- [B] Commingling - Storage - Measurement
☒ DHC ☐ CTB ☐ PLC ☐ PC ☐ OLS ☐ OLM
- [C] Injection - Disposal - Pressure Increase - Enhanced Oil Recovery
☐ WFX ☐ PMX ☐ SWD ☐ IPI ☐ EOR ☐ PPR
- [D] Other: Specify _____
- [2] **NOTIFICATION REQUIRED TO:** - Check Those Which Apply, or ☐ Does Not Apply
- [A] ☐ Working, Royalty or Overriding Royalty Interest Owners
- [B] ☐ Offset Operators, Leaseholders or Surface Owner
- [C] ☐ Application is One Which Requires Published Legal Notice
- [D] ☒ Notification and/or Concurrent Approval by BLM or SLO
U.S. Bureau of Land Management - Commissioner of Public Lands, State Land Office
- [E] ☐ For all of the above, Proof of Notification or Publication is Attached, and/or,
- [F] ☐ Waivers are Attached
- [3] **SUBMIT ACCURATE AND COMPLETE INFORMATION REQUIRED TO PROCESS THE TYPE OF APPLICATION INDICATED ABOVE.**

[4] **CERTIFICATION:** I hereby certify that the information submitted with this application for administrative approval is **accurate** and **complete** to the best of my knowledge. I also understand that **no action** will be taken on this application until the required information and notifications are submitted to the Division.

Note: Statement must be completed by an individual with managerial and/or supervisory capacity.

<u>Robin Terrell</u>		<u>SR Production Engineer</u>	<u>06/24/08</u>
Print or Type Name	Signature	Title	Date
		<u>rterrell@mewbourne.com</u>	
		e-mail Address	

RECEIVED
2008 JUN 27 PM 3 40

MEWBOURNE OIL COMPANY
PO BOX 5270
HOBBS, NM 88240
575-393-5905
FAX 575-397-6252

RECEIVED
2008 JUN 27 PM 3 15

June 24, 2008

Engineering Bureau
New Mexico Oil Conservation Division
1220 S. St. Francis Drive
Santa Fe, NM 87505

RE: Form C-107A
Pearl "26" #1
Drillout & Commingle

To Whom It May Concern:

Please find enclosed the following for the application to downhole commingle production from the Pearl Morrow North and Undesignated Chester zones in the referenced well:

Form C107A
Attachments information
Form C-102 for both zones
Administrative Application Checklist

Mewbourne Oil Company would appreciate this commingle request being processed as soon as possible. If you need further information, please call me at (575) 390-4816.

Thank you,



Robin Terrell
SR Production Engineer

District I
1625 N. Franch Drive, Hobbs, NM 88240

District II
1301 W. Grand Avenue, Artesia, NM 88210

District III
1000 Rio Brazos Road, Aztec, NM 87410

District IV
1220 S. St. Francis Dr., Santa Fe, NM 87505

State of New Mexico
Energy, Minerals and Natural Resources Department

Form C-107A
Revised June 10, 2003

Oil Conservation Division

1220 South St. Francis Dr.
Santa Fe, New Mexico 87505

APPLICATION TYPE

Single Well

Establish Pre-Approved Pools

EXISTING WELLBORE

☒ X Yes ☐ No

APPLICATION FOR DOWNHOLE COMMINGLING

Mewbourne Oil Company
Operator

PO Box 5270, Hobbs, NM 88240
Address

DHC-4045

Pearl "26" #1 G - Sec 26, T19S, R35E Eddy
Lease Well No. Unit Letter-Section-Township-Range County

OGRID No. 14744 Property Code 36234 API No. 30-025-38241 Lease Type: Federal State ☒ X Fee

DATA ELEMENT	UPPER ZONE	INTERMEDIATE ZONE	LOWER ZONE
Pool Name	Pearl Morrow North		NORTH Pearl Morrow Undesignated Chester
Pool Code			01-97623-01
Top and Bottom of Pay Section (Perforated or Open-Hole Interval)	12404' - 12460'		12690' - 12790'
Method of Production (Flowing or Artificial Lift)	Flowing		Flowing
Bottomhole Pressure (Note: Pressure data will not be required if the bottom perforation in the lower zone is within 150% of the depth of the top perforation in the upper zone)			
Oil Gravity or Gas BTU (Degree API or Gas BTU)			
Producing, Shut-In or New Zone	New Zone		Producing
Date and Oil/Gas/Water Rates of Last Production. (Note: For new zones with no production history, applicant shall be required to attach production estimates and supporting data.)	Date: Est. Rate: Rates: 400 MCF 5 BO, 7 BW	Date: Rates:	Date: 11/07 Rates: 450 MCF 15 BO, 10 BW
Fixed Allocation Percentage (Note: If allocation is based upon something other than current or past production, supporting data or explanation will be required.)	Oil Gas 25 % 47 %	Oil Gas % %	Oil Gas 75 % 53 %

ADDITIONAL DATA

Are all working, royalty and overriding royalty interests identical in all commingled zones?
If not, have all working, royalty and overriding royalty interest owners been notified by certified mail?

Yes ☒ X No ☐
Yes ☐ No ☐

Are all produced fluids from all commingled zones compatible with each other?

Yes ☒ X No ☐

Will commingling decrease the value of production?

Yes ☐ No ☒ X

If this well is on, or communitized with, state or federal lands, has either the Commissioner of Public Lands or the United States Bureau of Land Management been notified in writing of this application?

Yes ☒ X No ☐

NMOCD Reference Case No. applicable to this well:

Attachments:

- C-102 for each zone to be commingled showing its spacing unit and acreage dedication.
- Production curve for each zone for at least one year. (If not available, attach explanation.)
- For zones with no production history, estimated production rates and supporting data.
- Data to support allocation method or formula.
- Notification list of working, royalty and overriding royalty interests for uncommon interest cases.
- Any additional statements, data or documents required to support commingling.

PRE-APPROVED POOLS

If application is to establish Pre-Approved Pools, the following additional information will be required:

- List of other orders approving downhole commingling within the proposed Pre-Approved Pools
- List of all operators within the proposed Pre-Approved Pools
- Proof that all operators within the proposed Pre-Approved Pools were provided notice of this application.
- Bottomhole pressure data.

I hereby certify that the information above is true and complete to the best of my knowledge and belief.

SIGNATURE Robin Terrell TITLE Sr Production Engineer DATE 06/24/08

TYPE OR PRINT NAME Robin Terrell TELEPHONE NO. (575) 393-5905

E-MAIL ADDRESS rtterrell@mewbourne.com

MEWBOURNE OIL COMPANY
Pearl "26" #1
Unit Letter G, Sec 26 T19S R35E
Pearl Morrow North and Undesignated Chester
Lea Co., NM

Attachments to C-107A

1. **C102 for each zone to be commingled showing its spacing unit & acreage dedication.**
2. **Production curve for existing Morrow perfs showing current production. Atoka is estimated.**

Pearl Morrow North (Current production 400 MCF 5 BO, 7 BW)
Undesignated Chester (Previously tested 450 MCF, 15 BO, 10 BW)

3. **Notification list of working, royalty and overriding royalty interests for uncommon interest cases.**

No uncommon interests.

4. **Additional statements and data to support commingle.**

The well is completed with 5 1/2" OD casing. In order to dually complete the well to recover all economic reserves, the use of small diameter special clearance tubing would be required. Performing a dual completion as described could not be economically justified for a zone with limited deliverability. To produce the Morrow interval (upper zone) up the annulus (5 1/2" - 2 7/8") is not recommended due to liquid loading and insufficient velocity to lift produced fluids with the estimated gas rates listed above. The addition of the Morrow as a commingled zone will prevent waste that would not otherwise be possible due to the increased cost to produce each individual zone. Commingling will prevent early abandonment of each productive zone.

DISTRICT I
1625 N. French Dr., Hobbs, NM 88240
DISTRICT II
1301 W. Grand Avenue, Artesia, NM 88210
DISTRICT III
1000 Rio Brazos Rd., Aztec, NM 87410
DISTRICT IV
1220 S. St. Francis Dr., Santa Fe, NM 87505

State of New Mexico
Energy, Minerals and Natural Resources Department

Form C-102
Revised October 12, 2005

Submit to Appropriate District Office
State Lease - 4 Copies
Fee Lease - 3 Copies

OIL CONSERVATION DIVISION
1220 South St. Francis Dr.
Santa Fe, New Mexico 87505

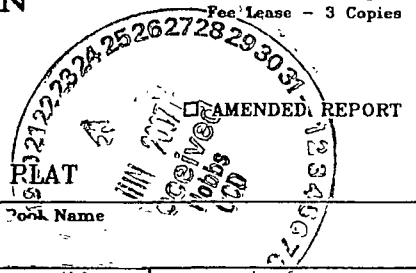

WELL LOCATION AND ACREAGE DEDICATION PLAT

API Number 30-025-38241	Pool Code 97623	Well Name Pearl Monow North
Property Code 36234	Property Name PEARL "26" STATE	Well Number 1
OGRID No. 14744	Operator Name MEWBOURNE OIL COMPANY	Elevation 3695'

Surface Location

UL or lot No.	Section	Township	Range	Lot Idn	Feet from the	North/South line	Feet from the	East/West line	County
G	26	19 S	35 E		1980	NORTH	1800	EAST	LEA

Bottom Hole Location If Different From Surface

UL or lot No.	Section	Township	Range	Lot Idn	Feet from the	North/South line	Feet from the	East/West line	County

Dedicated Acres 320	Joint or Infill	Consolidation Code	Order No.
------------------------	-----------------	--------------------	-----------

NO ALLOWABLE WILL BE ASSIGNED TO THIS COMPLETION UNTIL ALL INTERESTS HAVE BEEN CONSOLIDATED
OR A NON-STANDARD UNIT HAS BEEN APPROVED BY THE DIVISION

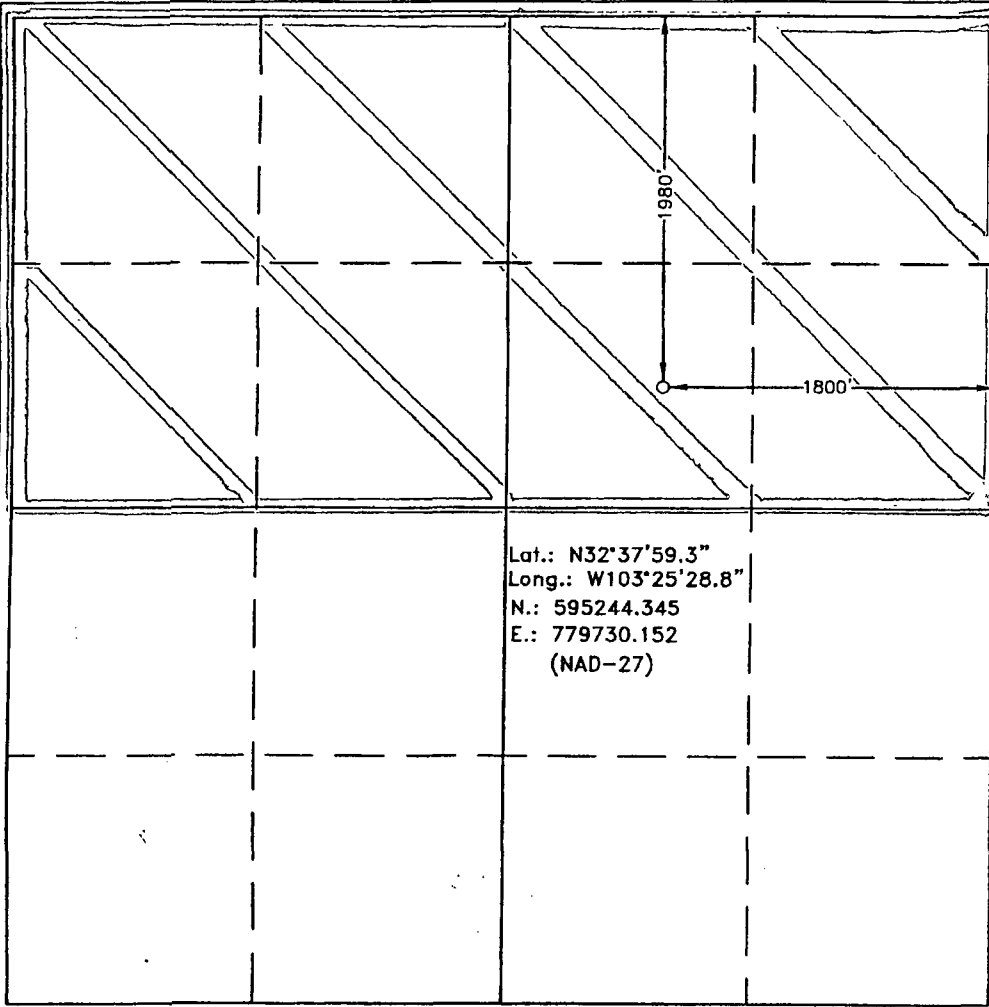

OPERATOR CERTIFICATION

I hereby certify that the information contained herein is true and complete to the best of my knowledge and belief, and that this organization either owns a working interest or unleased mineral interest in the land including the proposed bottom hole location pursuant to a contract with an owner of such a mineral or working interest, or to a voluntary pooling agreement or a compulsory pooling order heretofore entered by the division.

Kristi Green 6/01/07
Signature Date

Kristi Green

Printed Name

SURVEYOR CERTIFICATION

I hereby certify that the well location shown on this plat was plotted from field notes of actual surveys made by me or under my supervision and that the same is true and correct to the best of my belief

NOVEMBER 17, 2006

Date Surveyed
Signature & Seal of
Professional Surveyor

Gary L. Jones
7977
W.O. No. 17434

Certificate No. Gary L. Jones 7977

PROFESSIONAL LAND SURVEYOR
BASIN SURVEYS

DISTRICT I
1625 N. French Dr., Hobbs, NM 88240

DISTRICT II
1301 W. Grand Avenue, Artesia, NM 88210

DISTRICT III
1000 Rio Brazos Rd., Aztec, NM 87410

DISTRICT IV
1220 S. St. Francis Dr., Santa Fe, NM 87505

State of New Mexico
Energy, Minerals and Natural Resources Department

Form C-102
Revised October 12, 2005

Submit to Appropriate District Office
State Lease - 4 Copies
Fee Lease - 3 Copies

OIL CONSERVATION DIVISION
1220 South St. Francis Dr.
Santa Fe, New Mexico 87505

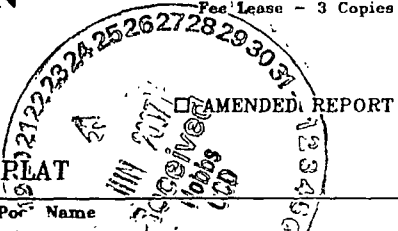

WELL LOCATION AND ACREAGE DEDICATION PLAT

API Number 30-025-38241	Pool Code 97623	Port Name Under Chester
Property Code 36234	Property Name PEARL "26" STATE	Well Number 1
OGRID No. 14744	Operator Name MEWBOURNE OIL COMPANY	Elevation 3695'

Surface Location

UL or lot No.	Section	Township	Range	Lot Idn	Feet from the	North/South line	Feet from the	East/West line	County
G	26	19 S	35 E		1980	NORTH	1800	EAST	LEA

Bottom Hole Location If Different From Surface

UL or lot No.	Section	Township	Range	Lot Idn	Feet from the	North/South line	Feet from the	East/West line	County

Dedicated Acres 320	Joint or Infill	Consolidation Code	Order No.
------------------------	-----------------	--------------------	-----------

NO ALLOWABLE WILL BE ASSIGNED TO THIS COMPLETION UNTIL ALL INTERESTS HAVE BEEN CONSOLIDATED
OR A NON-STANDARD UNIT HAS BEEN APPROVED BY THE DIVISION

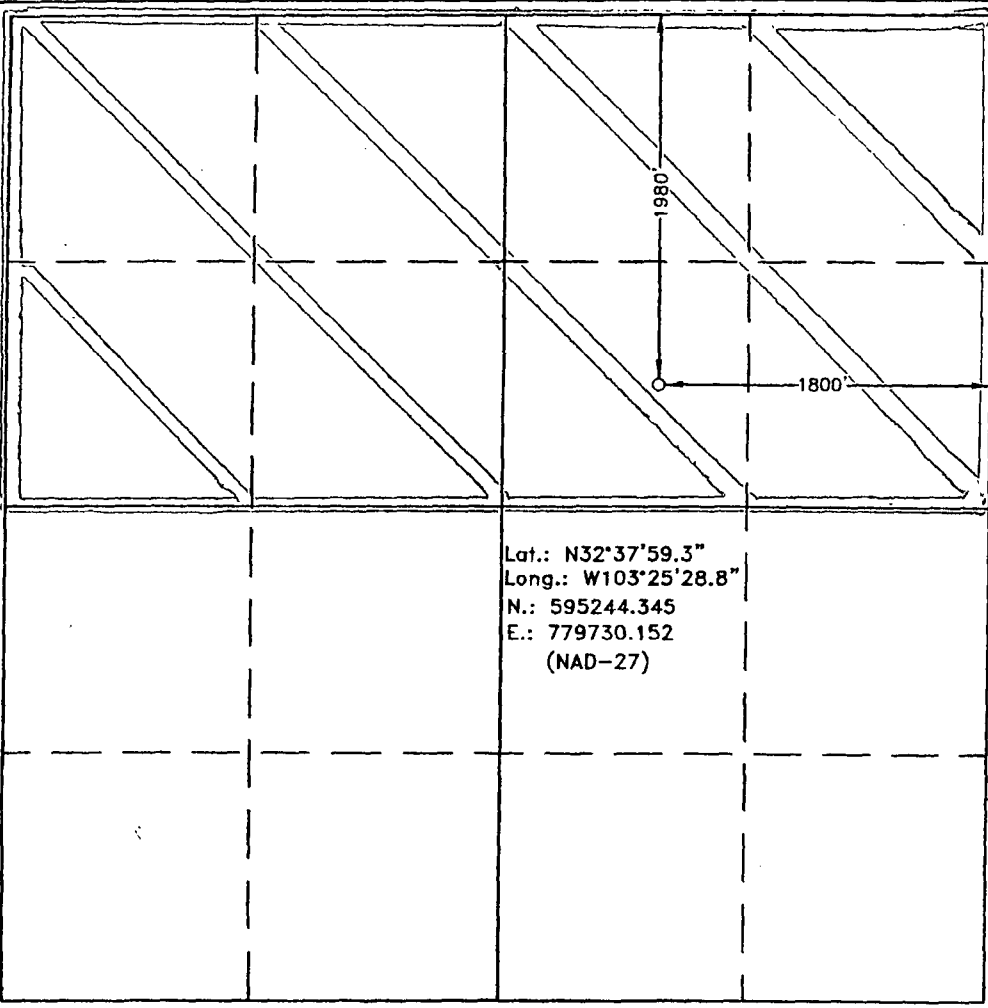

OPERATOR CERTIFICATION

I hereby certify that the information contained herein is true and complete to the best of my knowledge and belief, and that this organization either owns a working interest or unleased mineral interest in the land including the proposed bottom hole location pursuant to a contract with an owner of such a mineral or working interest, or to a voluntary pooling agreement or a compulsory pooling order heretofore entered by the division.

Kristi Green 6/07/07
Signature Date
Kristi Green
Printed Name

SURVEYOR CERTIFICATION

I hereby certify that the well location shown on this plat was plotted from field notes of actual surveys made by me or under my supervision and that the same is true and correct to the best of my belief

NOVEMBER 17, 2006

Date Surveyed
Signature of Gary L. Jones
Professional Surveyor
NEW MEXICO
REG. NO. 7977
W.O. No. 17434
Certificate No. Gary L. Jones 7977
BASINS SURVEYS