

DATE IN <u>6/19/08</u>	SUSPENSE	ENGINEER <u>W Jones</u>	LOGGED IN <u>6/20/08</u>	TYPE <u>PC</u>	APP NO. <u>PKVR0817229840</u>
------------------------	----------	-------------------------	--------------------------	----------------	-------------------------------

ABOVE THIS LINE FOR DIVISION USE ONLY

NEW MEXICO OIL CONSERVATION DIVISION
 - Engineering Bureau -
 1220 South St. Francis Drive, Santa Fe, NM 87505



ADMINISTRATIVE APPLICATION CHECKLIST

THIS CHECKLIST IS MANDATORY FOR ALL ADMINISTRATIVE APPLICATIONS FOR EXCEPTIONS TO DIVISION RULES AND REGULATIONS WHICH REQUIRE PROCESSING AT THE DIVISION LEVEL IN SANTA FE

Application Acronyms:

[NSL-Non-Standard Location] [NSP-Non-Standard Proration Unit] [SD-Simultaneous Dedication]
[DHC-Downhole Commingling] [CTB-Lease Commingling] [PLC-Pool/Lease Commingling]
[PC-Pool Commingling] [OLS - Off-Lease Storage] [OLM-Off-Lease Measurement]
[WFX-Waterflood Expansion] [PMX-Pressure Maintenance Expansion]
[SWD-Salt Water Disposal] [IPI-Injection Pressure Increase]
[EOR-Qualified Enhanced Oil Recovery Certification] [PPR-Positive Production Response]

[1] TYPE OF APPLICATION - Check Those Which Apply for [A]

[A] Location - Spacing Unit - Simultaneous Dedication
☒ NSL ☐ NSP ☐ SD

Check One Only for [B] or [C]

[B] Commingling - Storage - Measurement
☐ DHC ☐ CTB ☐ PLC ☒ PC ☐ OLS ☐ OLM

[C] Injection - Disposal - Pressure Increase - Enhanced Oil Recovery
☐ WFX ☐ PMX ☐ SWD ☐ IPI ☐ EOR ☐ PPR

[D] Other: Specify _____

[2] NOTIFICATION REQUIRED TO: - Check Those Which Apply, or ☐ Does Not Apply

- [A] ☒ Working, Royalty or Overriding Royalty Interest Owners
- [B] ☐ Offset Operators, Leaseholders or Surface Owner
- [C] ☐ Application is One Which Requires Published Legal Notice
- [D] ☐ Notification and/or Concurrent Approval by BLM or SLO
U.S. Bureau of Land Management - Commissioner of Public Lands, State Land Office
- [E] ☐ For all of the above, Proof of Notification or Publication is Attached, and/or,
- [F] ☐ Waivers are Attached

RECEIVED
2008 JUN 19 PM 1 34

[3] SUBMIT ACCURATE AND COMPLETE INFORMATION REQUIRED TO PROCESS THE TYPE OF APPLICATION INDICATED ABOVE.

[4] CERTIFICATION: I hereby certify that the information submitted with this application for administrative approval is **accurate** and **complete** to the best of my knowledge. I also understand that **no action** will be taken on this application until the required information and notifications are submitted to the Division.

Note: Statement must be completed by an individual with managerial and/or supervisory capacity.

Judith A. Barnett
 Print or Type Name
 Judith.Barnett@dm.com
 e-mail Address

Signature

Regulatory Analyst
 Title
 Date 06/16/2008



Devon Energy Corporation
20 North Broadway
Oklahoma City, Oklahoma 73102-8260

June 16, 2008

Mr. William Jones
State of New Mexico
Oil Conservation Division
1220 S. St. Francis Drive
Santa Fe, New Mexico 87505

RE: REVISED SURFACE COMMINGLING

NM-91509 & NM-89052
SEC 25 T22S R30E
Eddy County, New Mexico

Dear Mr. Jones:

Please find attached the *Revised* BLM Form 3160-5 Sundry Notice of Intent to Surface Commingle and the *Revised* OCD form C-107B for the proposed zones. Devon is the record title owner of the leases to be commingled and the owner of 100% WI in the commingled wells. The ownership is uniform in both of the leases and all of the wells. No additional notification is necessary.

If there are any additional questions or if additional information is needed, please do not hesitate to contact me at 405.228.8699.

Sincerely,

DEVON ENERGY PRODUCTION COMPANY, L.P.

Judy A. Barnett
Regulatory Analyst
Judith.Barnett@dvn.com

cc: Oil Conservation Division -Artesia
Bureau of Land Management – Carlsbad

Attachments



Devon Energy Corporation
20 North Broadway
Oklahoma City, Oklahoma 73102-8260
Fax 405-552-8113

April 15, 2008

New Mexico Oil Conservation Division
1220 South St. Francis Drive
Santa Fe, New Mexico 87505
Attn: David Brooks

Re: Surface Commingling
NM-91509 & NM-89052
Section 25-T22S-R30E
Eddy County, New Mexico

Gentlemen:

Devon Energy Production Company, L.P. ("Devon") intends to dismantle the Apache 25 Federal #2 battery located in the SE/4 SE/4 Section 25-T22S-R30E, Eddy County, New Mexico. This battery currently services the Apache 25 Federal #2, #5, and #9 wells as evidenced by the attached Commingling Order PC-1098 dated September 9, 2003.

In lieu of Commingling Order PC-1098, Devon respectfully requests the Commission administratively approve a new surface commingling order allowing for the commingling of production from the Apache 25 Federal #2, #5, #6, #9 and the Apache 25 Federal #10H which are currently producing into the existing Apache 25 Federal #6 battery located in SE/4 SE/4 (Unit letter P) of Said section 25. Attached is Form C-107-B for your approval.

Devon is the record title owner of the leases to be commingled and the owner of 100% WI interest in the commingled wells. The ownership of all interests is uniform in both of the leases and all of the wells. Therefore, no additional notification should be necessary.

If there are any questions or if additional information is required feel free to contact me at (405) 552-4633 or Judy Barnett at (405) 228-8699.

Yours very truly,

DEVON ENERGY PRODUCTION COMPANY, L.P.

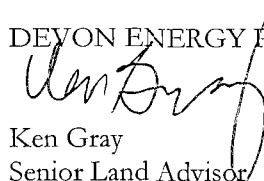

Ken Gray
Senior Land Advisor

UNITED STATES
DEPARTMENT OF THE INTERIOR
BUREAU OF LAND MANAGEMENT

FORM APPROVED
OMB No. 1004-0137
Expires: March 31, 2007

SUNDRY NOTICES AND REPORTS ON WELLS
**Do not use this form for proposals to drill or to re-enter an
abandoned well. Use Form 3160-3 (APD) for such proposals.**

5. Lease Serial No.
NM95109 and NM89052

6. If Indian, Allottee or Tribe Name

SUBMIT IN TRIPLICATE - Other instructions on page 2.

1. Type of Well

☒ Oil Well ☐ Gas Well ☐ Other

2. Name of Operator
Devon Energy Production Company, L.P.

3a. Address
20 North Broadway, Oklahoma City, OK 73102

3b. Phone No. (include area code)
405-228-8699

4. Location of Well (Footage, Sec., T., R., M., or Survey Description)
SEC 25 T22S R30E

7. If Unit of CA/Agreement, Name and/or No.

8. Well Name and No.
See Attached

9. API Well No.
See Attached

10. Field and Pool or Exploratory Area

11. Country or Parish, State
Eddy NM

12. CHECK THE APPROPRIATE BOX(ES) TO INDICATE NATURE OF NOTICE, REPORT OR OTHER DATA

TYPE OF SUBMISSION	TYPE OF ACTION			
<input checked="" type="checkbox"/> Notice of Intent	<input type="checkbox"/> Acidize	<input type="checkbox"/> Deepen	<input type="checkbox"/> Production (Start/Resume)	<input type="checkbox"/> Water Shut-Off
<input type="checkbox"/> Subsequent Report	<input type="checkbox"/> Alter Casing	<input type="checkbox"/> Fracture Treat	<input type="checkbox"/> Reclamation	<input type="checkbox"/> Well Integrity
<input type="checkbox"/> Final Abandonment Notice	<input type="checkbox"/> Casing Repair	<input type="checkbox"/> New Construction	<input type="checkbox"/> Recomplete	<input checked="" type="checkbox"/> Other <u>Surface Commingle</u>
	<input type="checkbox"/> Change Plans	<input type="checkbox"/> Plug and Abandon	<input type="checkbox"/> Temporarily Abandon	<u>REVISED</u>
	<input type="checkbox"/> Convert to Injection	<input type="checkbox"/> Plug Back	<input type="checkbox"/> Water Disposal	

13. Describe Proposed or Completed Operation: Clearly state all pertinent details, including estimated starting date of any proposed work and approximate duration thereof. If the proposal is to deepen directionally or recompleat horizontally, give subsurface locations and measured and true vertical depths of all pertinent markers and zones. Attach the Bond under which the work will be performed or provide the Bond No. on file with BLM/BIA. Required subsequent reports must be filed within 30 days following completion of the involved operations. If the operation results in a multiple completion or recompleat in a new interval, a Form 3160-4 must be filed once testing has been completed. Final Abandonment Notices must be filed only after all requirements, including reclamation, have been completed and the operator has determined that the site is ready for final inspection.)

Devon Energy Production Company, L. P. respectfully requests approval for surface commingle for measurement of hydrocarbon production the following wells:

Apache 25 Federal 2 Unit P Sec 25 T22S R30E: API# 30-015-27478 660 FSL 1310 FEL Pool: Los Medanos; Bone Spring (40295)
~~Apache 25 Federal 5 Unit I Sec 25 T22S R30E: API# 30-015-32720 1980 FSL 330 FEL DHG-3178 Los Medanos; Bone Spring (40295); G. Los Medanos; Wolfcamp (96336)~~
~~Apache 25 Federal 6 Unit P Sec 25 T22S R30E: API# 30-015-29894 330 FSL 330 FEL Quahada Ridge SE; Delaware (50443)~~
~~Apache 25 Federal 9 Unit J Sec 25 T22S R30E: API# 30-015-32797 1980 FSL 1650 FEL Los Medanos; Bone Spring (40295); Los Medanos (South)~~
Apache 25 Federal 10H Unit P Sec 25 T22S R30E: API# 30-015-35597 810 FSL 910 FEL Quahada Ridge SE; Delaware (50443)

Surface commingle will be at the Apache 25 Federal 6. The ownership is uniform in both leases and all of the wells.

14. I hereby certify that the foregoing is true and correct.

Name (Printed/Typed)
Judy A. Barnett

Title Regulatory Analyst

Signature

Date 06/16/2008

THIS SPACE FOR FEDERAL OR STATE OFFICE USE

Approved by

Title

Date

Conditions of approval, if any, are attached. Approval of this notice does not warrant or certify that the applicant holds legal or equitable title to those rights in the subject lease which would entitle the applicant to conduct operations thereon.

Office

Title 18 U.S.C. Section 1001 and Title 43 U.S.C. Section 1212, make it a crime for any person knowingly and willfully to make to any department or agency of the United States any false, fictitious or fraudulent statements or representations as to any matter within its jurisdiction.

(Instructions on page 2)

APPLICATION FOR SURFACE COMMINGLING: REVISED

Bureau of Land Management
1220 S. St Francis Drive
Santa Fe, New Mexico 87505

Devon Energy Production Company, L. P. requests approval for surface commingling and measurement of hydrocarbon production from the following wells on Federal Lease:

Lease Name & No. NM 91509				Formation
Apache 25 Federal 5	SEC 25	T22S	R30E	Los Medanos; Bone Spring & S. Los
Medanos; Wolfcamp				
Apache 25 Federal 9	SEC 25	T 22S	R30E	Los Medanos; Bone Spring; Los
Medanos Wolfcamp, <i>South</i>				
Lease Name & No. NM89502				Formation
Apache 25 Federal 2	SEC 25	T22S	R30E	Los Medanos; Bone Spring
Apache 25 Federal 6	SEC 25	T22S	R30E	Quahada Ridge SE; Delaware
Apache 25 Federal 10H	SEC 25	T22S	R30E	Quahada Ridge SE; Delaware

Exhibit I is a schematic, which shows the equipment that will be utilized to determine well production from each well that will contribute production to the proposed commingled facility.

Surface Commingling Proposal for Apache 25 Federal #2, #5, #6, #9 and #10H.

Devon proposes to surface commingle the producing wells; the Apache 25 Federal 2, Apache 25 Federal 5, Apache 25 Federal 6, Apache 25 Federal 9 and the Apache 25 Federal 10H to the Apache 25 Federal 6 battery facility. This commingling will in effect lessen the disturbance and impact on the environment.

Oil metering:

Oil and water volumes from each well producing to this battery will be determined by using a test separator/heater treater at the proposed facility so that one of the wells is always producing through the testing equipment. Daily production will be allocated on a daily basis based on the most recent individual well tests of oil, gas and water. Well tests for each well will be conducted at least once per month..

Process and Flow Description: A common gas sales meter associated with a DCP central delivery point (CDP) is currently located and will continue to be used at the Apache 25 Federal 6 location (#6 battery), SEC 25 T22S R30E Federal Lease NM89052. This sales meter currently accepts gas from the Apache 25 Federal 3 battery, the currently existing Apache 25 Federal 2 battery (which will be dismantled upon approval of this surface commingling permit), as well as the gas production from the #6 battery. Upon dismantling of the #2 battery, the entire 3-phase flow streams from the #2, #5, #9 and #10H wells will be directed to the #6 battery, rather than being processed at the #2 battery, and oil gas and water volumes will be allocated to each well using the test separator/heater treater located at the #6 battery. These meters will be calibrated on a regular basis per API, NMOCD and BLM specifications. The attached facility diagrams show the proposed metering arrangement. The BLM will be notified if there is any future change in facility location. Please see attached diagram for the "current" facilities set up and "proposed" Apache 25 Federal 6 production facility.

APPLICATION FOR SURFACE COMMINGLING REVISED

Bureau of Land Management
1110 S. St. Francis Drive
Santa Fe, New Mexico 87505
Page 2

Devon Energy Production Company, L. P. is the record title owner of the leases to be commingled and the owner of 100% WI interest in the commingle wells. The ownership of all interests is uniform in both of the leases and all of the wells. Therefore, no additional notification should be necessary.

The proposed commingling of production is to reduce operating expense among the referenced wells as well as to reduce the surface footprint and overall emissions associated with producing these wells. This will result in increasing the economic life of the wells.

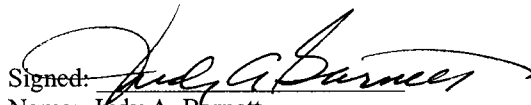
Signed: 
Name: Judy A. Barnett
Title: Regulatory Analyst
Date: June 16, 2008

District I
1625 N. French Drive, Hobbs, NM 88240
District II
1301 W. Grand Ave, Artesia, NM 88210
District III
1000 Rio Brazos Road, Aztec, NM 87410
District IV
1220 S. St Francis Dr, Santa Fe, NM
87505

State of New Mexico
Energy, Minerals and Natural Resources Department

Form C-107-B
Revised June 10, 2003

OIL CONSERVATION DIVISION
1220 S. St Francis Drive
Santa Fe, New Mexico 87505

Submit the original
application to the Santa Fe
office with one copy to the
appropriate District Office.

APPLICATION FOR SURFACE COMMINGLING (DIVERSE OWNERSHIP)

OPERATOR NAME: Devon Energy Production Company L. P.

OPERATOR ADDRESS: 20 N. Broadway, Oklahoma City, Oklahoma 73102-8260

APPLICATION TYPE:

☐ Pool Commingling ☐ Lease Commingling ☒ Pool and Lease Commingling ☐ Off-Lease Storage and Measurement (Only if not Surface Commingled)

LEASE TYPE: ☐ Fee ☐ State ☒ Federal

Is this an Amendment to existing Order? ☐ Yes ☒ No If "Yes", please include the appropriate Order No. _____

Have the Bureau of Land Management (BLM) and State Land office (SLO) been notified in writing of the proposed commingling

☒ Yes ☐ No

(A) POOL COMMINGLING

Please attach sheets with the following information

(1) Pool Names and Codes	Gravities / BTU of Non-Commingled Production	Calculated Gravities / BTU of Commingled Production		Calculated Value of Commingled Production	Volumes
Los Medanos; Bone Spring 40295 + South Los Medanos; Wolfcamp 96336 (Well #9 - DHC)	45.1/ 1303	42.6/ 1315			
Los Medanos; Bone Spring 40295 S. Los Medanos; Wolfcamp 96336 (#5)	40.4/ 1245	42.6/ 1315			
Quahada Ridge ;SE Delaware 50443 (#6)	40.2/ 1339	42.6/ 1315			
Los Medanos; Bone Spring 40295 (#2) Quahada Ridge SE; Delaware 50443 (#10)	44.7/ 1378 42.7 / 1404	42.6/ 1315			

(2) Are any wells producing at top allowables? ☐ Yes ☒ No

(3) Has all interest owners been notified by certified mail of the proposed commingling? ☒ Yes ☐ No.

(4) Measurement type: ☐ Metering ☒ Other (Monthly representative well tests)

(5) Will commingling decrease the value of production? ☐ Yes ☒ No If "yes", describe why commingling should be approved

(B) LEASE COMMINGLING

Please attach sheets with the following information

(1) Pool Name and Code.

(2) Is all production from same source of supply? ☐ Yes ☐ No

(3) Has all interest owners been notified by certified mail of the proposed commingling? ☐ Yes ☐ No

(4) Measurement type: ☐ Metering ☐ Other (Specify)

(C) POOL and LEASE COMMINGLING

Please attach sheets with the following information

(1) Complete Sections A and E.

(D) OFF-LEASE STORAGE and MEASUREMENT

Please attached sheets with the following information

(1) Is all production from same source of supply? ☐ Yes ☐ No

(2) Include proof of notice to all interest owners.

(E) ADDITIONAL INFORMATION (for all application types)

Please attach sheets with the following information

(1) A schematic diagram of facility, including legal location.

(2) A plat with lease boundaries showing all well and facility locations. Include lease numbers if Federal or State lands are involved.

(3) Lease Names, Lease and Well Numbers, and API Numbers.

I hereby certify that the information above is true and complete to the best of my knowledge and belief.

SIGNATURE: Judy A. Barnett TITLE: Regulatory Analyst

DATE: 06/16/2008

TYPE OR PRINT NAME Judy A. Barnett TELEPHONE NO.: 405.228.8699 EMAIL ADDRESS: _____

Exhibit #2
Apache "25" Federal No. 5
Eddy County, New Mexico

State of New Mexico
Energy, Minerals and Natural Resources Department

Form C-102
Revised 1-1-99

RECEIVED

DEC 2 - 2004

OOD-ARTESIA

Submit to Appropriate
District Office
State Lease - 4 copies
For Lease - 3 copies

DISTRICT I
P.O. Box 1980, Hobbs, NM 88240

DISTRICT II
P.O. Drawer DD, Artesia, NM 88210

DISTRICT III
1000 Rio Brazos Rd., Aztec, NM 87410

OIL CONSERVATION DIVISION
P.O. Box 2088
Santa Fe, New Mexico 87504-2088

WELL LOCATION AND ACREAGE DEDICATION PLAT
All Distances must be from the outer boundaries of the section

30-015-32720

Operator Devon Energy Production			Lease APACHE 25 FEDERAL		Well No. #5
Unit Letter I	Section 25	Township 22S.	Range 30E.	County NMDM	Eddy
Actual Footage Location of Well: 1980 feet from the SOUTH line and 330 feet from the EAST line					
Ground level Elev. 3344	Producing Formation Delaware		Pool Quahada Ridge SE. 50443		Dedicated Acreage: 40 Acres

- Outline the acreage dedicated to the subject well by colored pencil or hatchure marks on the plat below.
- If more than one lease is dedicated to the well, outline each and identify the ownership thereof (both as to working interest and royalty).
- If more than one lease of different ownership is dedicated to the well, have the interest of all owners been consolidated by communitization, unitization, force-pooling, etc?
☐ Yes ☐ No If answer is "yes" type of consolidation _____
If answer is "no" list the owners and tract descriptions which have actually been consolidated. (Use reverse side of this form if necessary.)
No allowable will be assigned to the well until all interests have been consolidated (by communitization, unitization, force-pooling, or otherwise) or until a non-standard unit, eliminating such interest, has been approved by the Division.

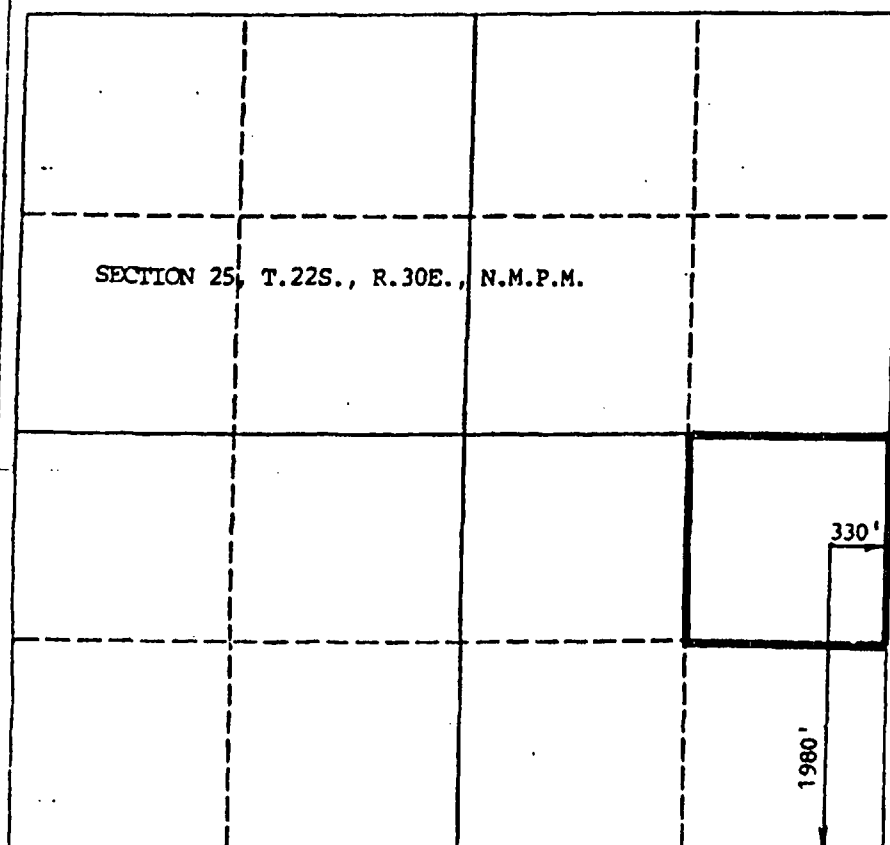

OPERATOR CERTIFICATION

I hereby certify that the information contained herein is true and complete to the best of my knowledge and belief.

Signature: Linda Guthrie
Printed Name: Linda Guthrie
Position: Regulatory Specialist
Company: Devon Energy Prod.
Date: 11/30/04

SURVEYOR CERTIFICATION

I hereby certify that the well location shown on this plat was plotted from field notes of actual surveys made by me or under my supervision, and that the same is true and correct to the best of my knowledge and belief.

Date Surveyed
8/11/93

Signature & Seal of
Professional Surveyor

JOHN LAQUESS
NEW MEXICO
8298
Professional Surveyor
16APACHE



Laboratory Services, Inc.

2609 West Marland
Hobbs, New Mexico 88240

Telephone: (505) 397-3713

M

FOR: Devon Energy
P. O. Box 250
Artesia, New Mexico 88211-0250

SAMPLE: Sta. #74086-00
IDENTIFICATION Apache 25 Fed. #6
COMPANY: Devon Energy
LEASE:
PLANT:

SAMPLE DATA: DATE SAMPLED 7/9/07 7:45 am
ANALYSIS DATE: 7/11/07
PRESSURE - PSIG 56.7
SAMPLE TEMP. °F 83.2
ATMOS. TEMP. °F
REMARKS: H2S = 0

GAS (XX) LIQUID ()
SAMPLED BY: Lemmons
ANALYSIS BY: Vickie Sullivan

COMPONENT ANALYSIS

COMPONENT	MOL PERCENT	GPM
Hydrogen Sulfide (H2S)		
Nitrogen (N2)	4.367	
Carbon Dioxide (CO2)	0.015	
Methane (C1)	68.435	
Ethane (C2)	13.273	3.541
Propane (C3)	8.370	2.301
I-Butane (IC4)	0.971	0.317
N-Butane (NC4)	2.505	0.788
I-Pentane (IC5)	0.606	0.221
N-Pentane (NC5)	0.606	0.219
Hexane Plus (C6+)	0.852	0.370
	100.000	7.757

BTU/CU.FT. - DRY 1339
AT 14.650 DRY 1335
AT 14.650 WET 1312
AT 14.73 DRY 1342
AT 14.73 WET 1319

MOLECULAR WT. 23.5719

SPECIFIC GRAVITY -
CALCULATED 0.812
MEASURED

Apache "25" Federal No. 9
 Eddy County, New Mexico

Form C-102
 Revised 1-1-89

Submit to Appropriate
 District Office
 State Lease - 4 copies
 Fee Lease - 3 copies

State of New Mexico
 Energy, Minerals and Natural Resources Department

OIL CONSERVATION DIVISION

P.O. Box 2088

Santa Fe, New Mexico 87504-2088

DISTRICT I

P.O. Box 1980, Hobbs, NM 88240

DISTRICT II

P.O. Drawer 60, Artesia, NM 87210

DISTRICT III

1000 Rio Brazos Rd., Alamogordo, NM 87108

WELL LOCATION AND ACREAGE DEDICATION PLAT

All Distances must be from the outer boundaries of the section

Operator Devon Energy Production Co., LP			Lease APACHE 25 FEDERAL		Well No. #9
Unit Letter J	Section 25	Township 22S.	Range 30E.	County N.M.	EDDY
Actual Footage Location of Well: 1980					
Foot from the		SOUTH	Base and	1650	Foot from the
Ground level Elev. 3343		Production Formation Wolfcamp	Pool	Los Medanos	Dedicated Acreage: 40 Acres

1. Outline the acreage dedicated to the subject well by colored pencil or ballpoint pen on the plat below.

2. If more than one lease is dedicated to the well, outline each and identify the ownership thereof (both as to working interest and royalty).

3. If more than one lease of different ownership is dedicated to the well, have the interest of all owners been consolidated by communitization, unitization, force-pooling, etc.?

☐ Yes ☐ No If answer is "yes" type of consolidation _____

If answer is "no" list the owners and tract descriptions which have actually been consolidated. (Use reverse side of this form if necessary.)

No allowable well is assigned to the well until all interests have been consolidated (by communitization, unitization, force-pooling, or otherwise) or until a non-standard unit, allowing each interest, has been approved by the Division.

OPERATOR CERTIFICATION

I hereby certify that the information contained herein is true and complete to the best of my knowledge and belief.

Signature *[Signature]*

Printed Name **Stephanie A. Ysasaga**

Position **Sr. Staff Engineering Tech**

Company **Devon Energy**

Date **12/29/05**

SURVEYOR CERTIFICATION

I hereby certify that the well location shown on this plat was plotted from field notes of actual surveys made by me or under my supervision, and that the same is true and correct to the best of my knowledge and belief.

Date Surveyed **8/11/93**

Signature & Seal of Professional Surveyor

[Seal of John Laquess, Professional Surveyor, New Mexico, No. 6298]

JOHN LAQUESS
NEW MEXICO
6298
PROFESSIONAL SURVEYOR



Laboratory Services, Inc.

 2609 West Marland
 Hobbs, New Mexico 88240

Telephone: (505) 397-3713

 FOR: Devon Energy
 Attention: Jack Pittman
 P.O. Box 250
 Artesia, New Mexico 88211-0250

 SAMPLE: Sta. # 390-49-037(Apache Test
 IDENTIFICATION Apache 25 #10
 COMPANY: Devon Energy
 LEASE:
 PLANT:

 SAMPLE DATA: DATE SAMPLED 1/14/08
 ANALYSIS DATE: 1/15/08
 PRESSURE - PSIG 15
 SAMPLE TEMP. °F 70
 ATMOS. TEMP. °F 68

 GAS (XX) LIQUID ()
 SAMPLED BY: Rob
 ANALYSIS BY: Vicki McDaniel

REMARKS: H2S = 1 PPM

 Pressure Base: 14.65
 Vol. 119 MCF/Day

COMPONENT ANALYSIS

COMPONENT	MOL PERCENT	GPM
Hydrogen Sulfide (H2S)		
Nitrogen (N2)	3.983	
Carbon Dioxide (CO2)	0.010	
Methane (C1)	63.959	
Ethane (C2)	15.487	4.132
Propane (C3)	10.513	2.890
I-Butane (IC4)	1.180	0.385
N-Butane (NC4)	2.792	0.878
I-Pentane (IC5)	0.595	0.217
N-Pentane (NC5)	0.602	0.218
Hexane Plus (C6+)	0.879	0.381
	100.000	9.101

 BTU/CU.FT. - DRY 1404
 AT 14.650 DRY 1399
 AT 14.650 WET 1375
 AT 14.73 DRY 1407
 AT 14.73 WET 1383

MOLECULAR WT. 24.6574

 SPECIFIC GRAVITY -
 CALCULATED 0.850
 MEASURED



Laboratory Services, Inc.

2609 West Marland
Hobbs, New Mexico 88240

Telephone: (505) 397-3713

M

FOR: Devon Energy
P. O. Box 250
Artesia, New Mexico 88211-0250

SAMPLE: Sta. #39033011
IDENTIFICATION Apache 25 Fed. #2
COMPANY: Devon Energy
LEASE:
PLANT:

SAMPLE DATA: DATE SAMPLED 8/27/07 9:30 am
ANALYSIS DATE: 8/31/07
PRESSURE - PSIG 73.3
SAMPLE TEMP. °F 97.6
ATMOS. TEMP. °F

GAS (XX) LIQUID ()
SAMPLED BY: Lemmons
ANALYSIS BY: Vickie Sullivan

REMARKS: H2S = 0

COMPONENT ANALYSIS

COMPONENT	MOL PERCENT	GPM
Hydrogen Sulfide (H2S)	0.000	
Nitrogen (N2)	3.216	
Carbon Dioxide (CO2)	0.025	
Methane (C1)	68.732	
Ethane (C2)	13.459	3.591
Propane (C3)	8.024	2.206
I-Butane (IC4)	0.996	0.325
N-Butane (NC4)	2.763	0.869
I-Pentane (IC5)	0.706	0.258
N-Pentane (NC5)	0.822	0.297
Hexane Plus (C6+)	<u>1.257</u>	<u>0.546</u>
	100.000	8.092

BTU/CU.FT. - DRY 1378
AT 14.650 DRY 1374
AT 14.650 WET 1350
AT 14.73 DRY 1381
AT 14.73 WET 1357

MOLECULAR WT. 23.9719

SPECIFIC GRAVITY -
CALCULATED 0.825
MEASURED

Submit to Appropriate
District Office
State Lease - 4 copies
Fee Lease - 3 copies

State of New Mexico
Energy, Minerals and Natural Resources Department

Form C-102
Revised 1-1-89

OIL CONSERVATION DIVISION

P.O. Box 2088
Santa Fe, New Mexico 87504-2088

RECEIVED

FEB 4 11 58 AM '93

DISTRICT I
P.O. Box 1980, Hobbs, NM 88240

DISTRICT II
P.O. Drawer DD, Artesia, NM 88210

DISTRICT III
1000 Rio Brazos Rd., Aztec, NM 87410

WELL LOCATION AND ACREAGE DEDICATION PLAT

All Distances must be from the outer boundaries of the section

Operator Devon Energy Production Company, LP			Lease Apache "25" Fed		Well No. 2
Unit Letter P	Section 25	Township 22S	Range 30E	County NMPM	Eddy
Actual Footage Location of Well: 1310 feet from the East line and 660 feet from the South line					
Ground level Elev. 3336	Producing Formation Bone Spring		Pool Los Medanos	Dedicated Acreage: 40 Acres	

1. Outline the acreage dedicated to the subject well by colored pencil or hatchure marks on the plat below.
2. If more than one lease is dedicated to the well, outline each and identify the ownership thereof (both as to working interest and royalty).
3. If more than one lease of different ownership is dedicated to the well, have the interest of all owners been consolidated by communitization, unitization, force-pooling, etc.?
☐ Yes ☐ No If answer is "yes" type of consolidation _____
If answer is "no" list the owners and tract descriptions which have actually been consolidated. (Use reverse side of this form if necessary). _____
No allowable will be assigned to the well until all interests have been consolidated (by communitization, unitization, forced-pooling, or otherwise) or until a non-standard unit, eliminating such interest, has been approved by the Division.

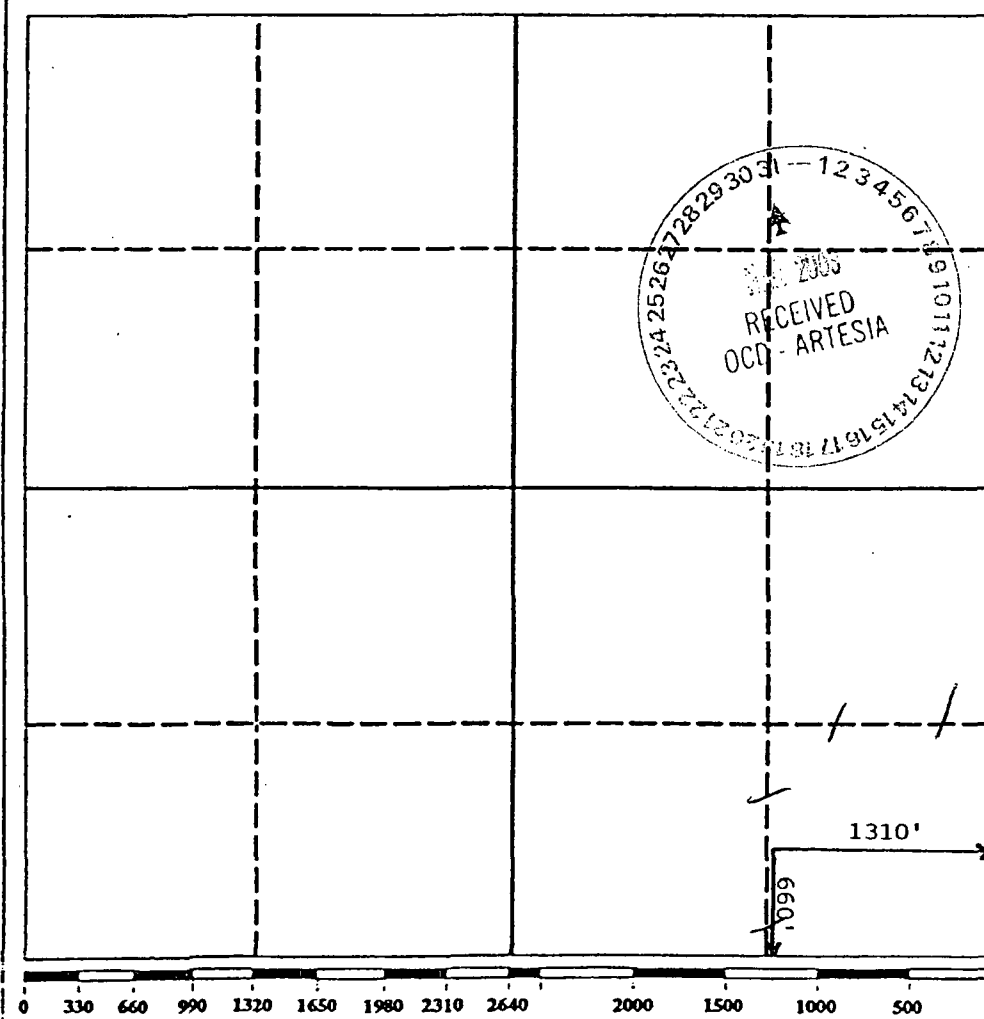

OPERATOR CERTIFICATION

I hereby certify that the information contained herein is true and complete to the best of my knowledge and belief.

Signature: *James Blount*
Printed Name: James Blount
Position: Operations Engineer Advisor
Company: Devon Energy Production Co., LP
Date: March 26, 2003

SURVEYOR CERTIFICATION

I hereby certify that the well location shown on this plat was plotted from field notes of actual surveys made by me or under my supervision, and that the same is true and correct to the best of my knowledge and belief.

Date Surveyed: _____
Signature & Seal of Professional Surveyor: _____
Certificate No.: _____



Laboratory Services, Inc.

2609 West Marland
Hobbs, New Mexico 88240

Telephone: (505) 397-3713

FOR: Devon Energy
P. O. Box 250
Artesia, New Mexico 88211-0250

SAMPLE: Sta. #39049037
IDENTIFICATION Apache 25 #5
COMPANY: Devon Energy
LEASE:
PLANT:

SAMPLE DATA: DATE SAMPLED 12/19/07
ANALYSIS DATE: 12/19/07
PRESSURE - PSIG 22
SAMPLE TEMP. °F 50
ATMOS. TEMP. °F 56

REMARKS: H2S = 0.5 PPM

GAS (XX) LIQUID ()
SAMPLED BY: R.H.
ANALYSIS BY: Vickie Sullivan

COMPONENT ANALYSIS

COMPONENT	MOL PERCENT	GPM
Hydrogen Sulfide (H2S)		
Nitrogen (N2)	5.526	
Carbon Dioxide (CO2)	0.025	
Methane (C1)	71.876	
Ethane (C2)	12.088	3.225
Propane (C3)	6.810	1.872
I-Butane (IC4)	0.687	0.224
N-Butane (NC4)	1.691	0.532
I-Pentane (IC5)	0.325	0.119
N-Pentane (NC5)	0.332	0.120
Hexane Plus (C6+)	0.640	0.278
	100.000	6.370

BTU/CU.FT. - DRY 1245 MOLECULAR WT. 22.1739
 AT 14.650 DRY 1242
 AT 14.650 WET 1220
 AT 14.73 DRY 1248
 AT 14.73 WET 1227

SPECIFIC GRAVITY -
 CALCULATED 0.764
 MEASURED

District I
PO Box 1998, Hobbs, NM 88241-1998
District II
PO Drawer DD, Artesia, NM 88211-0719
District III
1000 Rio Brazos Rd., Aztec, NM 87410
District IV
PO Box 2088, Santa Fe, NM 87504-2088

State of New Mexico
Energy, Minerals & Natural Resources Department

OIL CONSERVATION DIVISION
PO Box 2088
Santa Fe, NM 87504-2088

Form C-102
Revised February 10, 1994
Instructions on back
Submit to Appropriate District Office
State Lease - 4 Copies
Fee Lease - 3 Copies

☐ AMENDED REPORT

WELL LOCATION AND ACREAGE DEDICATION PLAT

API Number 30-015-29894		Pool Code 50443	Pool Name Guadalupe Ridge Delaware SE
Property Code	Property Name Apache 25 Federal		Well Number 6
OGRID No.	Operator Name Mitchell Energy		Elevation 3330

¹⁰ Surface Location

UL or lot no.	Section	Township	Range	Lot Idn	Feet from the	North/South line	Feet from the	East/West line	County
P	25	22S	30E		330	South	330	East	Eddy

¹¹ Bottom Hole Location If Different From Surface

UL or lot no.	Section	Township	Range	Lot Idn	Feet from the	North/South line	Feet from the	East/West line	County
¹² Dedication Acres 40		¹³ Joint or Infill		¹⁴ Consolidation Code		¹⁵ Order No.			

NO ALLOWABLE WILL BE ASSIGNED TO THIS COMPLETION UNTIL ALL INTERESTS HAVE BEEN CONSOLIDATED
OR A NON-STANDARD UNIT HAS BEEN APPROVED BY THE DIVISION

16					<p>¹⁷ OPERATOR CERTIFICATION</p> <p>I hereby certify that the information contained herein is true and complete to the best of my knowledge and belief</p> <p><i>Judy A. Barnett</i> Signature Judy A. Barnett Printed Name Regulatory Analyst Title 6/16/08 Date</p> <p>¹⁸ SURVEYOR CERTIFICATION</p> <p>I hereby certify that the well location shown on this plat was plotted from field notes of actual surveys made by me or under my supervision, and that the same is true and correct to the best of my belief.</p> <p>9/13/97 Date of Survey Signature and Seal of Professional Surveyor: 10204 Certificate Number</p>

330' 330'

Wildcat Measurement Service
P.O. Box 1836
Artesia, New Mexico 88211-1836
TollFree #888-421-9453
Office #505-746-3481
"Quality and Service is our First Concern"

PDS 06/25/00

Run No. 271018-09
Date Run 10/18/2007
Date Sampled 10/18/2007

Analysis for: DEVON ENERGY PRODUCTION COMPANY

GPANGL.L62

Well Name: APACHE "25" #9
Field: APACHE
Sta. Number: APACHE 25-2 BTY
Purpose: SPOT-DRY FLOW
Sampling Temp: 59.4 DEG F
Volume/day: 50 MCF/DAY
Pressure on Cylinder: 20.0 PSIG

Producer: DEVON ENERGY PRODUCTION CO.
County: EDDY State: NM
Sampled By: ROBERT HERNANDEZ
Atmos Temp: 64 DEG F
Formation:
Line Pressure: 33.2 PSIA

GAS COMPONENT ANALYSIS

Pressure Base: 14.7300

		Mol %	GPM
Carbon Dioxide	CO2	0.0723	
Nitrogen	N2	1.3421	
Methane	C1	74.0419	
Ethane	C2	14.1264	3.7759
Propane	C3	7.0256	1.9344
Iso-Butane	IC4	0.7954	0.2602
Nor-Butane	NC4	1.6913	0.5332
Iso-Pentane	IC5	0.3142	0.1150
Nor-Pentane	NC5	0.3147	0.1140
Hexanes Plus	C6+	0.2761	0.1205
TOTAL		100.0000	6.8530

Real BTU Dry: 1302.93
Real BTU Wet: 1280.27
Real Calc. Specific Gravity: 0.7549
Field Specific Gravity: 0.0000

Standard Pressure: 14.6960
BTU Dry: 1294.99
BTU Wet: 1272.46

Z Factor: 0.9962
N Value: 1.2733
Avg Mol Weight: 21.7886
Avg CuFt/Gal: 53.8027
26 Lb Product: 0.5134
Methane+ GPM: 19.4028
Ethane+ GPM: 6.8530
Propane+ GPM: 3.0772
Butane+ GPM: 1.1428
Pentane+ GPM: 0.3494

REMARKS:

Approved by: DON NORKAN

Tue Oct 23 11:47:44 2007

DISTRICT I
1626 N. French Dr., Hobbs, NM 88240

DISTRICT II
1301 W. Grand Avenue, Artesia, NM 88210

DISTRICT III
1000 Elc Brazos Rd., Aztec, NM 87410

DISTRICT IV
1220 S. St. Francis Dr., Santa Fe, NM 87505

State of New Mexico
Energy, Minerals and Natural Resources Department

OIL CONSERVATION DIVISION
1220 South St. Francis Dr.
Santa Fe, New Mexico 87505

Form C-102
Revised October 12, 2005

Submit to Appropriate District Office
State Lease - 4 Copies
Fee Lease - 3 Copies

☐ AMENDED REPORT

WELL LOCATION AND ACREAGE DEDICATION PLAT

API Number	Pool Code 33745	Pool Name INGLE WELLS
Property Code	Property Name APACHE "25" FEDERAL	Well Number 10 H
OGHD No. 6137	Operator Name DEVON ENERGY PRODUCTION COMPANY LP	Elevation 3338'

Surface Location

UL or lot No.	Section	Township	Range	Lot Idn	Feet from the	North/South line	Feet from the	East/West line	County
P	25	22 S	30 E		810	SOUTH	910	EAST	EDDY

Bottom Hole Location If Different From Surface

UL or lot No.	Section	Township	Range	Lot Idn	Feet from the	North/South line	Feet from the	East/West line	County
M	25	22 S	30 E		430	SOUTH	330	WEST	EDDY
Dedicated Acres 160	Joint or Infill	Consolidation Code	Order No.						

NO ALLOWABLE WILL BE ASSIGNED TO THIS COMPLETION UNTIL ALL INTERESTS HAVE BEEN CONSOLIDATED
OR A NON-STANDARD UNIT HAS BEEN APPROVED BY THE DIVISION

<p>Producing Area</p> <p>Project Area</p> <p>BOTTOM HOLE LOCATION Lat - N32°21'25.5" Long - W103°50'29.8" (NAD-83)</p> <p>SURFACE LOCATION Lat - N32°21'29.1" Long - W103°49'42.7" (NAD-83)</p>		<p>OPERATOR CERTIFICATION</p> <p>I hereby certify that the information contained herein is true and complete to the best of my knowledge and belief, and that this organization either owns a working interest or unleased mineral interest in the land including the proposed bottom hole location pursuant to a contract with an owner of such a mineral or working interest, or to a voluntary pooling agreement or a compulsory pooling order heretofore entered by the division.</p> <p><i>Judy A. Barnett</i> 4/11/07 Signature Date</p> <p>Judy A. Barnett Printed Name Regulatory Analyst</p>
		<p>SURVEYOR CERTIFICATION</p> <p>I hereby certify that the well location shown on this plat was plotted from field notes of actual surveys made by me or under my supervision and that the same is true and correct to the best of my belief.</p> <p>DECEMBER 22, 2006 Date Surveyed</p> <p><i>Gary L. Jones</i> Signature & Seal Professional Surveyor</p> <p>7977 Certificate No. Gary L. Jones</p> <p>BASIN SURVEYS</p>

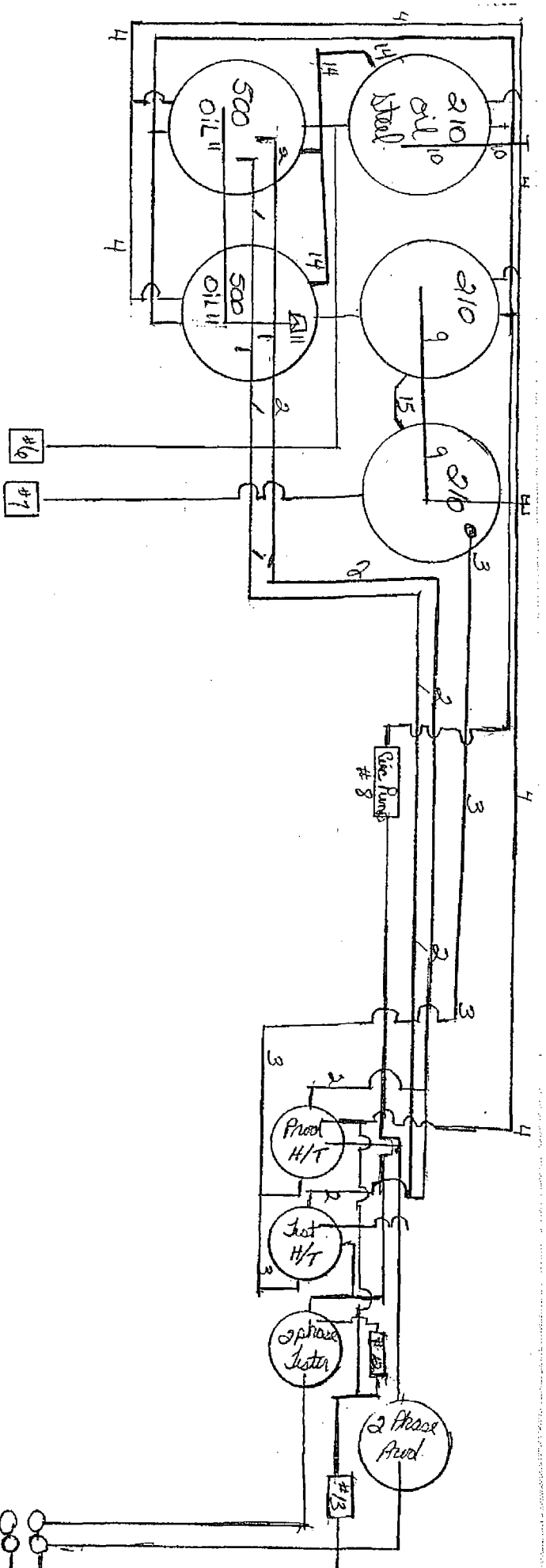

1. Production fill line
2. Test fill line
3. Water fill line
4. 1" Pull line
5. Oil load line
6. Water load line
7. One Pump
8. 400 Vent line
9. 210 oil Vent line
10. 500 oil Vent line
11. 500 Check meter
12. 500 Check meter
13. Equalizer oil tanks
14. Equalizer oil tanks
15. Equalizer

Open 25 #2 Battery



Jones, William V., EMNRD

From: Barnett, Judith [Judith.Barnett@dvn.com]
Sent: Monday, July 21, 2008 8:21 AM
To: Jones, William V., EMNRD
Cc: Wilson, Kimberly M, EMNRD
Subject: RE: Suurface Commingle Application from Devon: Apache 25 Federal Wells 2, 5, 6, 9, 10H Eddy County

William,

Thanks for taking time to help figure all of this out with me! I have spoken with Kimberly at the OCD in Artesia and she has helped to verify the following:

- 1) Apache 25 Federal 9: Sundry 3160-5 should read the South Los Medanos Wolfcamp and the pool number is correct.
- 2) Apache 25 Federal 5: Sundry 3160-5 should read: Quahada Ridge; SE Delaware

Since you do not need any further paperwork reflecting the above changes, I will await to hear back when it is approved. I appreciate your time and patience in this matter and thanks for all your help.

Judy A. Barnett

Regulatory Analyst
Corporate Tower 03.055C
Oklahoma City, OK 73102
(405) 228-8699 Phone
(405) 552-8113 Fax
Judith.Barnett@dvn.com

From: Jones, William V., EMNRD [mailto:William.V.Jones@state.nm.us]
Sent: Tuesday, July 15, 2008 4:55 PM
To: Barnett, Judith
Cc: Reno, Carmen, EMNRD
Subject: Suurface Commingle Application from Devon: Apache 25 Federal Wells 2, 5, 6, 9, 10H Eddy County

Hello Judy:
I still have a couple wells that seem to have differences on the completed intervals.

- 1) Well Num 9 says on your sundry form to be producing from the Los Medanos; Wolfcamp; but it seems it is in the South Los Medanos; Wolfcamp. You have the correct Pool name, so I am assuming this is a mistake.
- 2) Well Num 5 on the Sundry form you just sent says production is from the Los Medanos; Bone Spring and South Los Medanos; Wolfcamp. Our records show this well to ONLY be producing from the Southeast Quahada; Delaware. Please look at your internal records and see what really is producing in this well and let me know for the sake of this permit application and also get it corrected if necessary with the Artesia District Office. You don't need to correct any more forms sent to me - I can just put the actuals on the Permit.

Thanks for fixing the API number issues.

William V. Jones PE
New Mexico Oil Conservation Division
1220 South St. Francis
Santa Fe, NM 87505
505-476-3448

7/21/2008

Jones, William V., EMNRD

From: Barnett, Judith [Judith.Barnett@dvn.com]

Sent: Tuesday, June 17, 2008 8:51 AM

To: Jones, William V., EMNRD

Subject: Application for Apache Surface Commingling_Revised: Apache 25 Federal Wells 2, 5, 6, 9, 10H Eddy County

William,

As per your email of June 10, 2008, I am resending the Revised Application for the Apache Surface Commingling on the above wells under separate cover. I have addressed the API#'s which were mistaken by me since there were two API#'s for several of the wells in question on the OCD website. This in itself attributed to giving me more accurate information which was needed. I hope you find everything in the packet which you requested.

Thanks for all your help:)

Judy A. Barnett

Regulatory Analyst

Corporate Tower 03.055C

Oklahoma City, OK 73102

(405) 228-8699 Phone

(405) 552-8113 Fax

Judith.Barnett@dvn.com

Confidentiality Warning: This message and any attachments are intended only for the use of the intended recipient(s), are confidential, and may be privileged. If you are not the intended recipient, you are hereby notified that any review, retransmission, conversion to hard copy, copying, circulation or other use of all or any portion of this message and any attachments is strictly prohibited. If you are not the intended recipient, please notify the sender immediately by return e-mail, and delete this message and any attachments from your system.

This inbound email has been scanned by the MessageLabs Email Security System.

6/17/2008

Jones, William V., EMNRD

From: Jones, William V., EMNRD
Sent: Tuesday, July 15, 2008 3:55 PM
To: 'Barnett, Judith'
Cc: Reno, Carmen, EMNRD
Subject: Suurface Commingle Application from Devon: Apache 25 Federal Wells 2, 5, 6, 9, 10H Eddy County

Hello Judy:

I still have a couple wells that seem to have differences on the completed intervals.

1) Well Num 9 says on your sundry form to be producing from the Los Medanos; Wolfcamp; but it seems it is in the South Los Medanos; Wolfcamp. You have the correct Pool name, so I am assuming this is a mistake.

2) Well Num 5 on the Sundry form you just sent says production is from the Los Medanos; Bone Spring and South Los Medanos; Wolfcamp. Our records show this well to ONLY be producing from the Southeast Quahada; Delaware. Please look at your internal records and see what really is producing in this well and let me know for the sake of this permit application and also get it corrected if necessary with the Artesia District Office. You don't need to correct any more forms sent to me - I can just put the actuals on the Permit.

Thanks for fixing the API number issues.

William V. Jones PE
 New Mexico Oil Conservation Division
 1220 South St. Francis
 Santa Fe, NM 87505
 505-476-3448

From: Jones, William V., EMNRD
Sent: Tuesday, June 10, 2008 2:39 PM
To: 'Barnett, Judith'
Cc: Reno, Carmen, EMNRD; Ezeanyim, Richard, EMNRD; Wilson, Kimberly M, EMNRD; Warnell, Terry G, EMNRD
Subject: Surface Commingle Application from Devon: Apache 25 Federal Wells 2, 5, 6, 9, 10H Eddy County

Hello Judy:

For some reason, these federal wells were assigned API numbers originally when they were proposed and the wells were not drilled, then they were proposed again with the same well name and given NEW API numbers - and this time the wells were actual drilled. So there is some confusion and it has taken some of my time and will take time from everyone working on these wells from NOW ON. Anyway - must have been a reason for this, but it is unfortunate.

Some items to clarify for your application:

- 1) The API numbers you used in your application for these wells (in all but well no. 2) seem to be the wrong API's. Would you correct this on your sundry form and on this application?
- 2) Well No. 5 may be producing in the upper Bone Spring and lower Delaware - but your application and the approved DHC-3178 do not say this. Would you first look at Devon's internal records and find out what the true story is and let me know. Also if DHC-3178 needs amended, then send another C-107A.
- 3) Well No. 9 appears to be producing from the Bone Spring and the Wolfcamp and DHC-3609 and parts of the application is consistent with that. However your sundry only lists Bone Spring as producing.
- 4) Please send a map of Section 25, showing all wells to be included in this commingle and their spacing unit size/orientation.

Thanks,

William V. Jones PE
 New Mexico Oil Conservation Division
 1220 South St. Francis
 Santa Fe, NM 87505
 505-476-3448

7/15/2008