

1R - 495

REPORTS

DATE:

10-17-08

Hansen, Edward J., EMNRD

From: Hansen, Edward J., EMNRD
Sent: Friday, October 17, 2008 5:05 PM
To: 'Savoie, Tony'
Subject: RE: Red Byrd Monument (1R-495)

Tony,
Could you please send me a hard copy of your PowerPoint presentation at:

Edward J. Hansen
Oil Conservation Division
EMNRD
1220 S. St. Francis Dr.
Santa Fe, NM 87505

Thanks.

505-476-3489

From: Savoie, Tony [mailto:tony.savoie@sug.com]
Sent: Friday, October 17, 2008 7:37 AM
To: Hansen, Edward J., EMNRD
Subject: RE: Red Byrd Monument

Dear Mr. Hansen

Follow up on our site investigation at the Plains Red Byrd #1 and SUGS Job #2007-019

On 10/1/08 we removed approximately 1 ft. of soil from the bottom of the excavation under our 8" line going east by west approximately 50 ft and north by south approximately 25 ft.

All of the soil has been stockpiled on site.

Soil Samples were collected from the bottom of the excavation starting directly beneath the leak area on our 8" line progressing to the south side of the excavation.

All of the samples were placed in plastic bags and screened with a PID.

The samples that exhibited the highest readings were selected for a BTEX analysis.

Two samples beneath our release point were also selected for a BTEX and Chlorides analysis.

All of the samples collected were analyzed for TPH 8015 GRO-DRO.

Attached is a power point presentation with a site sketch and photos.

The landowner was on-site during most of the excavation and sampling.

The local NMOCD representative was not available.

Plains Pipeline was not on-site.

The lab analysis is also attached

Thanks, Tony

From: Hansen, Edward J., EMNRD [mailto:edwardj.hansen@state.nm.us]
Sent: Wednesday, September 17, 2008 1:48 PM
To: Savoie, Tony
Cc: Price, Wayne, EMNRD; Johnson, Larry, EMNRD
Subject: RE: Red Byrd Monument

Dear Mr. Savoie:

10/17/2008

The New Mexico Oil Conservation Division (OCD) has reviewed the submitted analytical results for the soil samples taken at the "Red Byrd 8-inch - Monument" site. The results indicate that continued investigation is required by Southern Union at this site. Please submit a work plan for further investigation (i.e., below the current depth of the excavation at your pipeline) at the site to the OCD by Friday, October 17, 2008. The work plan should include a generalized plan for corrective action (i.e., contaminated soil removal and disposal).

If you have any question regarding this matter, please call me at 505-476-3489.

Edward J. Hansen
Hydrologist
Environmental Bureau
Oil Conservation Division

From: Savoie, Tony [mailto:tony.savoie@sug.com]
Sent: Thursday, August 28, 2008 6:42 AM
To: Hansen, Edward J., EMNRD
Subject: Red Byrd Monument

We were calling this project #2007-019

We first responded to the release near the monitor well and collected samples at the point of release on 6/8/07

Samples were collected starting at 1 ft. below ground surface. Samples were also collected at 2', 3', 4', 5', 6', 8', 12', and 15'

These samples were collected as we were excavating the area around the monitor well. Reference lab ID 7F08022-01.

We returned and started excavating all of the black carbon discolored soil on 6/11/08.

The excavated soil was sampled for chlorides only on 6/12/07. Reference lab ID 7f13018.

The excavated area was sampled on 6/15/07. Bottom hole and sidewall samples were collected. Reference lab ID 7f15011

During the excavation of the area it was noted that we started digging into oily soil to the south and west side of the excavation.

Photos were taken as the obvious source point was from the south of the excavation where a repair had been made on a 6" crude oil pipeline.

These findings were shown to the landowner and discussed with the environmental personnel working for Plains.

I have attached all of the lab tests.

Thanks,

Tony <<7f15011.pdf>> <<7f08022.pdf>> <<7f13018.pdf>>

10/17/2008

Private and confidential as detailed [here](#). If you cannot access hyperlink, please e-mail sender.

This inbound email has been scanned by the MessageLabs Email Security System.

Confidentiality Notice: This e-mail, including all attachments is for the sole use of the intended recipient (s) and may contain confidential and privileged information. Any unauthorized review, use, disclosure or distribution is prohibited unless specifically provided under the New Mexico Inspection of Public Records Act. If you are not the intended recipient, please contact the sender and destroy all copies of this message. -- This email has been scanned by the Sybari - Antigen Email System.

Private and confidential as detailed [here](#). If you cannot access hyperlink, please e-mail sender.

This inbound email has been scanned by the MessageLabs Email Security System.



PHONE (575) 393-2326 • 101 E. MARLAND • HOBBS, NM 88240

ANALYTICAL RESULTS FOR
SOUTHERN UNION GAS SERVICES
ATTN: TONY SAVOIE
P.O. BOX 1226
JAL, NM 88252

Receiving Date: 10/01/08
Reporting Date: 10/03/08
Project Number: 2007-019
Project Name: BYRD 8"
Project Location: S.W. OF MONUMENT, NM

Sampling Date: 10/01/08
Sample Type: SOIL
Sample Condition: COOL & INTACT
Sample Received By: ML
Analyzed By: AB

LAB NUMBER	SAMPLE ID	GRO (C ₆ -C ₁₀) (mg/kg)	DRO (C ₁₀ -C ₂₈) (mg/kg)
		10/02/08	10/02/08
H16018-1	B-1	<25.0	<25.0
H16018-2	B-2	<25.0	<25.0
H16018-3	B-3	<25.0	33.7
H16018-4	B-4	<25.0	28.7
H16018-5	B-5	<25.0	<25.0
H16018-6	B-6	<25.0	<25.0
H16018-7	B-7	<25.0	<25.0
H16018-8	B-8	370	2,030
H16018-9	B-9	<25.0	<25.0
H16018-10	B-10	<25.0	<25.0
H16018-11	B-11	932	3,350
H16018-12	B-12	609	2,050
H16018-13	B-13	376	2,640
H16018-14	B-14	152	1,340
H16018-15	B-16	814	4,010
H16018-16	B-17	817	2,920
H16018-17	B-15	1,290	5,200
Quality Control		542	566
True Value QC		500	500
% Recovery		108	113
Relative Percent Difference		2.5	4.7

METHODS: TPH GRO & DRO: EPA SW-846 8015 M

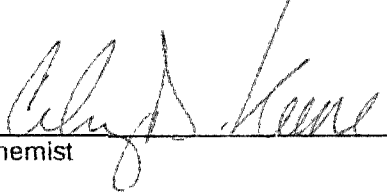
Chemist

Date

H16018 T SUGS

PLEASE NOTE: Liability and Damages. Cardinal's liability and client's exclusive remedy for any claim arising, whether based in contract or tort, shall be limited to the amount paid by client for analyses. All claims, including those for negligence and any other cause whatsoever shall be deemed waived unless made in writing and received by Cardinal within thirty (30) days after completion of the applicable service. In no event shall Cardinal be liable for incidental or consequential damages, including, without limitation, business interruptions, loss of use, or loss of profits incurred by client, its subsidiaries, affiliates or successors arising out of or related to the performance of services hereunder by Cardinal, regardless of whether such claim is based upon any of the above-stated reasons or otherwise. Results relate only to the samples identified above. This report shall not be reproduced except in full with written approval of Cardinal Laboratories.



ARDINAL LABORATORIES

PHONE (575) 393-2326 • 101 E. MARLAND • HOBBS, NM 88240

ANALYTICAL RESULTS FOR
SOUTHERN UNION GAS SERVICES
ATTN: TONY SAVOIE
P.O. BOX 1226
JAL, NM 88252

Receiving Date: 10/01/08
Reporting Date: 10/03/08
Project Number: 2007-019
Project Name: BYRD 8"
Project Location: S.W. OF MONUMENT, NM

Sampling Date: 10/01/08
Sample Type: SOIL
Sample Condition: COOL & INTACT
Sample Received By: ML
Analyzed By: ZL/HM

LAB NUMBER	SAMPLE ID	BENZENE (mg/kg)	TOLUENE (mg/kg)	ETHYL BENZENE (mg/kg)	TOTAL XYLENES (mg/kg)
ANALYSIS DATE		10/02/08	10/02/08	10/02/08	10/02/08
H16018-3	B-3	<0.050	<0.050	<0.050	<0.150
H16018-7	B-7	<0.050	<0.050	<0.050	<0.150
H16018-11	B-11	0.297	0.996	2.49	7.22
H16018-12	B-12	0.075	0.536	1.66	4.57
H16018-16	B-17	0.098	0.580	1.74	5.01
Quality Control		0.053	0.050	0.051	0.164
True Value QC		0.050	0.050	0.050	0.150
% Recovery		106	100	102	109
Relative Percent Difference		5.4	1.2	3.7	2.5

METHODS: BTEX - EPA SW-846-8021B

TEXAS NELAP CERTIFICATION T104704398-08-TX FOR BENZENE, TOLUENE, ETHYL BENZENE,
AND TOTAL XYLENES.

Chemist

Date

PLEASE NOTE: Liability and Damages. Cardinal's liability and client's exclusive remedy for any claim arising, whether based in contract or tort, shall be limited to the amount paid by client for analyses. All claims, including those for negligence and any other cause whatsoever shall be deemed waived unless made in writing and received by Cardinal within thirty (30) days after completion of the applicable service. In no event shall Cardinal be liable for incidental or consequential damages, including, without limitation, business interruptions, loss of use, or loss of profits incurred by client, its subsidiaries, affiliates or successors arising out of or related to the performance of services hereunder by Cardinal, regardless of whether such claim is based upon any of the above-stated reasons or otherwise. Results relate only to the samples identified above. This report shall not be reproduced except in full with written approval of Cardinal Laboratories.



CARDINAL LABORATORIES

PHONE (575) 393-2326 • 101 E. MARLAND • HOBBS, NM 88240

ANALYTICAL RESULTS FOR
SOUTHERN UNION GAS SERVICES
ATTN: TONY SAVOIE
P.O. BOX 1226
JAL, NM 88252

Receiving Date: 10/01/08
Reporting Date: 10/03/08
Project Number: 2007-019
Project Name: BYRD 8"
Project Location: S.W. OF MONUMENT

Analysis Date: 10/02/08
Sampling Date: 10/01/08
Sample Type: SOIL
Sample Condition: COOL & INTACT
Sample Received By: ML
Analyzed By: HM

LAB NO.	SAMPLE ID	Cl ⁻ (mg/kg)
H16018-2	B-2	48
H16018-7	B-7	< 16
Quality Control		500
True Value QC		500
% Recovery		100
Relative Percent Difference		< 0.1

METHOD: Standard Methods

4500-ClB

Note: Analyses performed on 1:4 w:v aqueous extracts.

Chemist

10-03-08
Date

H16018 SUGS

PLEASE NOTE: Liability and Damages. Cardinal's liability and client's exclusive remedy for any claim arising, whether based in contract or tort, shall be limited to the amount paid by client for analyses. All claims, including those for negligence and any other cause whatsoever shall be deemed waived unless made in writing and received by Cardinal within thirty (30) days after completion of the applicable service. In no event shall Cardinal be liable for incidental or consequential damages, including, without limitation, business interruptions, loss of use, or loss of profits incurred by client, its subsidiaries, affiliates or successors arising out of or related to the performance of services hereunder by Cardinal, regardless of whether such claim is based upon any of the above-stated reasons or otherwise. Results relate only to the samples identified above. This report shall not be reproduced except in full with written approval of Cardinal Laboratories.



CARDINAL LABORATORIES

101 East Marland, Hobbs, NM 88240

(575) 393-2326 Fax (575) 393-2476

BILL TO				ANALYSIS REQUEST											
Company Name: 54 G.S.															
Project Manager: Tom Savais															
Address: 610 Commerce															
City: JAL															
State: NM															
Zip: 88252															
Phone #: 575-395-2116															
Fax #: 															
Project #: 2007-019															
Project Owner: 															
Project Name: Byrd 8"															
Project Location: SW of Monument															
Sampler Name: Don Green															
FOR LAB USE ONLY															
Lab I.D.				Sample I.D.											
H16Q18-10				B-10											
-11				B-11											
-12				B-12											
-13				B-13											
-14				B-14											
-15				B-16											
-16				B-17											

MATRIX	GROUNDWATER	WASTEWATER	SOIL	OIL	SLUDGE	OTHER	ACIDBASE	ICE/COOL	OTHER	PRESERV	DATE	TIME
✓	✓	✓	✓	✓	✓	✓	✓	✓	✓	✓	10-1-08	2:30
✓	✓	✓	✓	✓	✓	✓	✓	✓	✓	✓	"	"
✓	✓	✓	✓	✓	✓	✓	✓	✓	✓	✓	"	"
✓	✓	✓	✓	✓	✓	✓	✓	✓	✓	✓	"	"
✓	✓	✓	✓	✓	✓	✓	✓	✓	✓	✓	"	"
✓	✓	✓	✓	✓	✓	✓	✓	✓	✓	✓	"	"

PLEASE NOTE: Laboratory and Client's respective liability for any claim arising whether based in contract or tort, shall be limited to the amount paid by the client for the analysis. All claims involving negligence and any other claim whatsoever shall be deemed waived unless made in writing and received by Cardinal within 30 days after completion of the applicable service. In no event shall Cardinal be liable for Accidents or consequential damages, including without limitation, business interruption, loss of use, or loss of profits incurred by client, its subsidiaries, affiliates, successors and assigns, or its customers or the performance of services hereunder to Cardinal regardless of whether such claim is based upon any of the above stated reasons or otherwise.

Sampler Relinquished: **Don Green** Date: **10-1-08** Received By: **Yufy** Date: **10-1-08**

Relinquished By: **Don Green** Time: **14:13** Received By: **Yufy** Date: **10-1-08**

Delivered By: (Circle One) **Don Green** Temp: Sample Condition: **Intact** Checked By: **Yufy**

Sampler - UPS - Bus - Other: Yes ☒ No ☐ Yes ☐ No ☐

Phone Result: ☐ No ☐ Add'l Phone #:

Fax Result: ☐ No ☐ Add'l Fax #:

REMARKS:

† Cardinal cannot accept verbal changes. Please fax written changes to 575-393-2476.

RECEIVED
OCT 21 PM 2 53

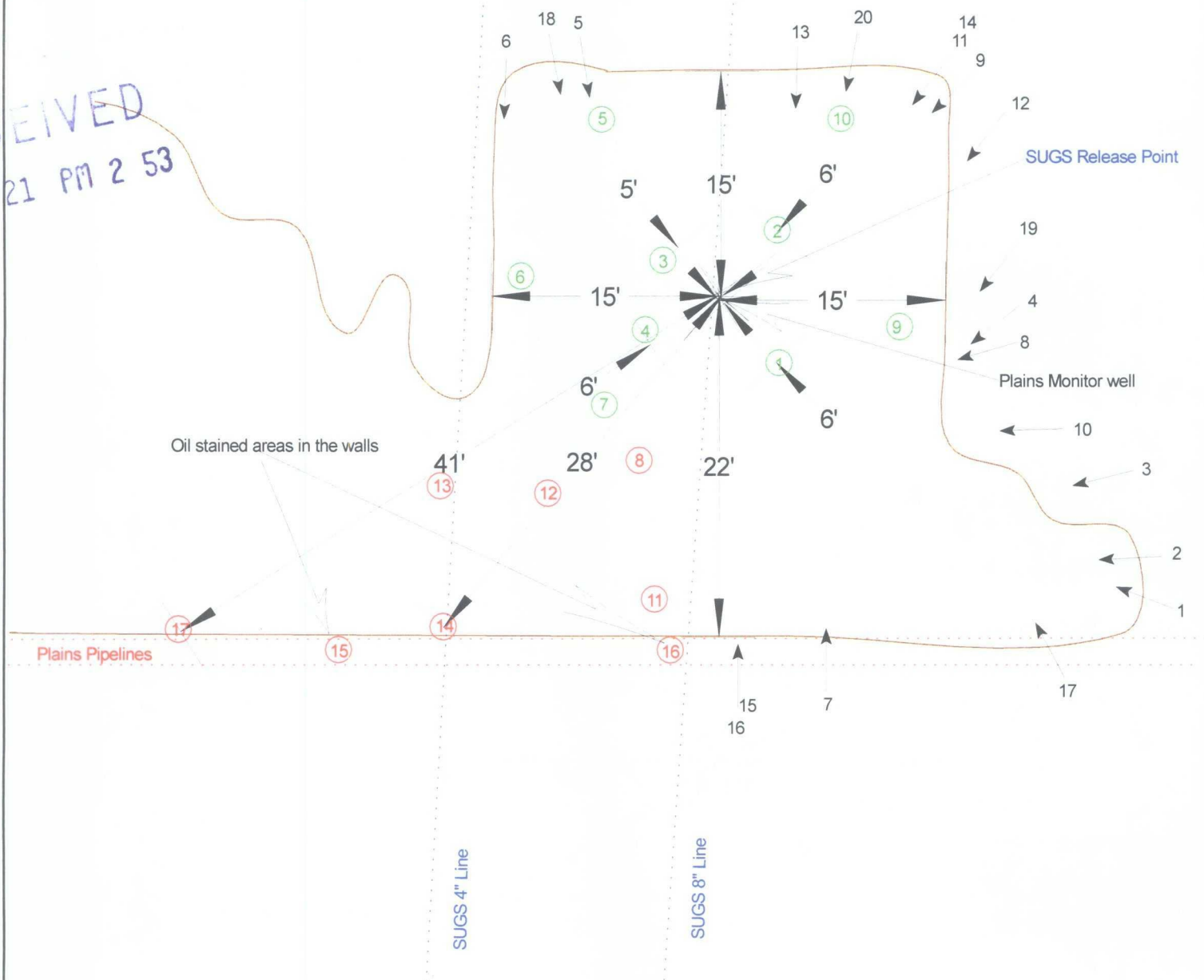

Soil samples were taken after approximately 1 ft. of soil had been removed from the bottom of the excavation.
Samples 15 & 16 were taken 2' up from the floor on the South wall
All of the other samples were taken from the floor of the excavation
Samples in red exceed the closure level
Samples in green are below the closure level.

Approximate
Scale 1"= 10'



Unit ltr. "H"
Section 1
Twns.-20 S
Range 36E
County-Lea, N.M.
GPS
Lat- 32-36.199N
Long-103-18.066 W

Southern Union
Gas Services

Site Plan-Red Byrd 8"

Lea County Area Jal, N.M.

Job # 2007-019

Figure 2

Photo 1



Photo 4



Photo 2



Photo 5



Photo 3



Photo 6



Bed Byrd #1 Photos taken 10/1/08
9:44 a.m. to 9:46 a.m.
Cleaning sediment from Excavation

Photo 7



Photo 10



Photo 8



Photo 11



Photo 9



Photo 12



Bed Byrd #1 Photos taken 10/1/08
11:02a.m. to 11:04 a.m.
Cleaning sediment from
Excavation

Photo 13



Photo 16



Photo 14



Photo 17



Photo 15



Photo 18



Bed Byrd #1 Photos taken 10/1/08
12:55 p.m. to 12:58 p.m.
During sampling Event

Photo 19



Photo 20



Red Byrd #1 SUGS Job# 2007-019
Photos Taken 12:06 p.m. 10/9/08

Red Byrd 8"
#2007-019

Date Collected	Location	PID P.P.M.	GRO C-6-C10 mg/kg	DRO C10-C28 mg/kg	Total C6-C28 mg/kg	Chloride mg/kg	Benzene mg/kg	Toluene mg/kg	Ethylbenzene mg/kg	Total Xylenes mg/kg
10/1/2008	B-1	9	<25.0	<25.0	<25.0					
10/1/2008	B-2	0	<25.0	<25.0	<25.0	48				
10/1/2008	B-3	7	<25.0	33.7	33.7		<0.050	<0.050	<0.050	<0.150
10/1/2008	B-4	14	<25.0	28.7	28.7					
10/1/2008	B-5	0	<25.0	<25.0	<25.0					
10/1/2008	B-6	8	<25.0	<25.0	<25.0					
10/1/2008	B-7	14	<25.0	<25.0	<25.0	<16	<0.050	<0.050	<0.050	<0.150
10/1/2008	B-8	767	370	2030	2400					
10/1/2008	B-9	0	<25.0	<25.0	<25.0					
10/1/2008	B-10	10	<25.0	<25.0	<25.0					
10/1/2008	B-11	>1000	932	3350	4282		0.297	0.996	2.49	7.22
10/1/2008	B-12	992	609	2050	2659		0.075	0.536	1.66	4.57
10/1/2008	B-13	371	376	2640	3016					
10/1/2008	B-14	290	152	1340	1492					
10/1/2008	B-15	552	1290	5200	6490					
10/1/2008	B-16	>1000	814	4010	4824					
10/1/2008	B-17	>1000	817	2920	3737		0.098	0.580	1.74	5.01

Analytical summary



PHONE (575) 393-2326 • 101 E. MARLAND • HOBBS, NM 88240

ANALYTICAL RESULTS FOR
SOUTHERN UNION GAS SERVICES
ATTN: TONY SAVOIE
P.O. BOX 1226
JAL, NM 88252

Receiving Date: 10/01/08
Reporting Date: 10/03/08
Project Number: 2007-019
Project Name: BYRD 8"
Project Location: S.W. OF MONUMENT, NM

Sampling Date: 10/01/08
Sample Type: SOIL
Sample Condition: COOL & INTACT
Sample Received By: ML
Analyzed By: AB

LAB NUMBER	SAMPLE ID	GRO	DRO
		(C ₆ -C ₁₀) (mg/kg)	(>C ₁₀ -C ₂₈) (mg/kg)

ANALYSIS DATE	10/02/08	10/02/08
H16018-1 B-1	<25.0	<25.0
H16018-2 B-2	<25.0	<25.0
H16018-3 B-3	<25.0	33.7
H16018-4 B-4	<25.0	28.7
H16018-5 B-5	<25.0	<25.0
H16018-6 B-6	<25.0	<25.0
H16018-7 B-7	<25.0	<25.0
H16018-8 B-8	370	2,030
H16018-9 B-9	<25.0	<25.0
H16018-10 B-10	<25.0	<25.0
H16018-11 B-11	932	3,350
H16018-12 B-12	609	2,050
H16018-13 B-13	376	2,640
H16018-14 B-14	152	1,340
H16018-15 B-16	814	4,010
H16018-16 B-17	817	2,920
H16018-17 B-15	1,290	5,200
Quality Control	542	566
True Value QC	500	500
% Recovery	108	113
Relative Percent Difference	2.5	4.7

METHODS: TPH GRO & DRO: EPA SW-846 8015 M

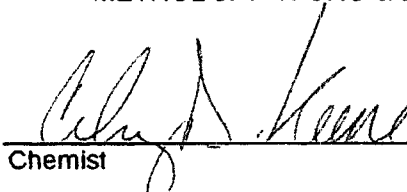
Chemist

Date

H16018 T SUGS

PLEASE NOTE: Liability and Damages. Cardinal's liability and client's exclusive remedy for any claim arising, whether based in contract or tort, shall be limited to the amount paid by client for analyses. All claims, including those for negligence and any other cause whatsoever shall be deemed waived unless made in writing and received by Cardinal within thirty (30) days after completion of the applicable service. In no event shall Cardinal be liable for incidental or consequential damages, including, without limitation, business interruptions, loss of use, or loss of profits incurred by client, its subsidiaries, affiliates or successors arising out of or related to the performance of services hereunder by Cardinal, regardless of whether such claim is based upon any of the above-stated reasons or otherwise. Results relate only to the samples identified above. This report shall not be reproduced except in full with written approval of Cardinal Laboratories.



PHONE (575) 393-2326 • 101 E. MARLAND • HOBBS, NM 88240

ANALYTICAL RESULTS FOR
SOUTHERN UNION GAS SERVICES
ATTN: TONY SAVOIE
P.O. BOX 1226
JAL, NM 88252

Receiving Date: 10/01/08
Reporting Date: 10/03/08
Project Number: 2007-019
Project Name: BYRD 8"
Project Location: S.W. OF MONUMENT, NM

Sampling Date: 10/01/08
Sample Type: SOIL
Sample Condition: COOL & INTACT
Sample Received By: ML
Analyzed By: ZL/HM

LAB NUMBE	SAMPLE ID	BENZENE (mg/kg)	TOLUENE (mg/kg)	ETHYL BENZENE (mg/kg)	TOTAL XYLENES (mg/kg)
ANALYSIS DATE		10/02/08	10/02/08	10/02/08	10/02/08
H16018-3	B-3	<0.050	<0.050	<0.050	<0.150
H16018-7	B-7	<0.050	<0.050	<0.050	<0.150
H16018-11	B-11	0.297	0.996	2.49	7.22
H16018-12	B-12	0.075	0.536	1.66	4.57
H16018-16	B-17	0.098	0.580	1.74	5.01
Quality Control		0.053	0.050	0.051	0.164
True Value QC		0.050	0.050	0.050	0.150
% Recovery		106	100	102	109
Relative Percent Difference		5.4	1.2	3.7	2.5

METHODS: BTEX - EPA SW-846-8021B

TEXAS NELAP CERTIFICATION T104704398-08-TX FOR BENZENE, TOLUENE, ETHYL BENZENE,
AND TOTAL XYLENES.

Chemist

Date

PLEASE NOTE: Liability and Damages. Cardinal's liability and client's exclusive remedy for any claim arising, whether based in contract or tort, shall be limited to the amount paid by client for analyses. All claims, including those for negligence and any other cause whatsoever shall be deemed waived unless made in writing and received by Cardinal within thirty (30) days after completion of the applicable service. In no event shall Cardinal be liable for incidental or consequential damages, including, without limitation, business interruptions, loss of use, or loss of profits incurred by client, its subsidiaries, affiliates or successors arising out of or related to the performance of services hereunder by Cardinal, regardless of whether such claim is based upon any of the above-stated reasons or otherwise. Results relate only to the samples identified above. This report shall not be reproduced except in full with written approval of Cardinal Laboratories.



PHONE (575) 393-2326 • 101 E. MARLAND • HOBBS, NM 88240

ANALYTICAL RESULTS FOR
SOUTHERN UNION GAS SERVICES
ATTN: TONY SAVOIE
P.O. BOX 1226
JAL, NM 88252

Receiving Date: 10/01/08
Reporting Date: 10/03/08
Project Number: 2007-019
Project Name: BYRD 8"
Project Location: S.W. OF MONUMENT

Analysis Date: 10/02/08
Sampling Date: 10/01/08
Sample Type: SOIL
Sample Condition: COOL & INTACT
Sample Received By: ML
Analyzed By: HM

LAB NO.	SAMPLE ID	Cl ⁻ (mg/kg)
H16018-2	B-2	48
H16018-7	B-7	< 16
Quality Control		500
True Value QC		500
% Recovery		100
Relative Percent Difference		< 0.1

METHOD: Standard Methods

4500-Cl⁻B

Note: Analyses performed on 1:4 w:v aqueous extracts.

He L. M. S.
Chemist

10-03-08
Date

H16018 SUGS

PLEASE NOTE: Liability and Damages. Cardinal's liability and client's exclusive remedy for any claim arising, whether based in contract or tort, shall be limited to the amount paid by client for analyses. All claims, including those for negligence and any other cause whatsoever shall be deemed waived unless made in writing and received by Cardinal within thirty (30) days after completion of the applicable service. In no event shall Cardinal be liable for incidental or consequential damages, including, without limitation, business interruptions, loss of use, or loss of profits incurred by client, its subsidiaries, affiliates or successors arising out of or related to the performance of services hereunder by Cardinal, regardless of whether such claim is based upon any of the above-stated reasons or otherwise. Results relate only to the samples identified above. This report shall not be reproduced except in full with written approval of Cardinal Laboratories.



CARDINAL LABORATORIES
101 East Marland, Hobbs, NM 88240
(575) 393-2326 Fax (575) 393-2476

BILL TO				ANALYSIS REQUEST														
Company Name: <u>SUGS</u>																		
Project Manager: <u>TONY SAVOIE</u>																		
Address: <u>610 COMMENCE</u> <u>PO Box 1226</u>																		
City: <u>JAL</u> State: <u>NM</u> Zip: <u>88252</u>																		
Phone #: <u>575-395-2116</u> Fax #: _____																		
Project #: <u>2007-019</u> Project Owner: _____																		
Project Name: <u>Byad 8"</u>																		
Project Location: <u>SW of Monument</u>																		
Sampler Name: <u>DON GAER</u>																		
FOR LAB USE ONLY																		
Lab I.D.	Sample I.D.	(G) LAB OR (C) COMP.	# CONTAINERS	MATRIX			PRESERV.			SAMPLING			DATE			TIME		
				GROUNDWATER	WASTEWATER	SOIL	OIL	SLUDGE	OTHER:	ACID/BASE:	ICE / COOL	OTHER:						
<u>H11008-17</u>	<u>B-1</u>	<u>G</u>	<u>1</u>	<input checked="" type="checkbox"/>	<input checked="" type="checkbox"/>	<input checked="" type="checkbox"/>	<input checked="" type="checkbox"/>	<input checked="" type="checkbox"/>	<input checked="" type="checkbox"/>	<input checked="" type="checkbox"/>	<input checked="" type="checkbox"/>	<input checked="" type="checkbox"/>	<u>10/1/08</u>	<u>9:20</u>	<input checked="" type="checkbox"/>	<u>774</u>	<u>8015</u>	
<u>-1</u>	<u>B-1</u>	<u>"</u>	<u>1</u>	<input checked="" type="checkbox"/>	<input checked="" type="checkbox"/>	<input checked="" type="checkbox"/>	<input checked="" type="checkbox"/>	<input checked="" type="checkbox"/>	<input checked="" type="checkbox"/>	<input checked="" type="checkbox"/>	<input checked="" type="checkbox"/>	<input checked="" type="checkbox"/>	<u>"</u>	<u>2:30</u>	<input checked="" type="checkbox"/>	<u>BTEX</u>	<u>CL</u>	
<u>-2</u>	<u>B-2</u>	<u>"</u>	<u>1</u>	<input checked="" type="checkbox"/>	<input checked="" type="checkbox"/>	<input checked="" type="checkbox"/>	<input checked="" type="checkbox"/>	<input checked="" type="checkbox"/>	<input checked="" type="checkbox"/>	<input checked="" type="checkbox"/>	<input checked="" type="checkbox"/>	<input checked="" type="checkbox"/>	<u>"</u>	<u>"</u>	<input checked="" type="checkbox"/>	<u>"</u>	<u>"</u>	
<u>-3</u>	<u>B-3</u>	<u>"</u>	<u>1</u>	<input checked="" type="checkbox"/>	<input checked="" type="checkbox"/>	<input checked="" type="checkbox"/>	<input checked="" type="checkbox"/>	<input checked="" type="checkbox"/>	<input checked="" type="checkbox"/>	<input checked="" type="checkbox"/>	<input checked="" type="checkbox"/>	<input checked="" type="checkbox"/>	<u>"</u>	<u>"</u>	<input checked="" type="checkbox"/>	<u>"</u>	<u>"</u>	
<u>4</u>	<u>B-4</u>	<u>"</u>	<u>1</u>	<input checked="" type="checkbox"/>	<input checked="" type="checkbox"/>	<input checked="" type="checkbox"/>	<input checked="" type="checkbox"/>	<input checked="" type="checkbox"/>	<input checked="" type="checkbox"/>	<input checked="" type="checkbox"/>	<input checked="" type="checkbox"/>	<input checked="" type="checkbox"/>	<u>"</u>	<u>"</u>	<input checked="" type="checkbox"/>	<u>"</u>	<u>"</u>	
<u>5</u>	<u>B-5</u>	<u>"</u>	<u>1</u>	<input checked="" type="checkbox"/>	<input checked="" type="checkbox"/>	<input checked="" type="checkbox"/>	<input checked="" type="checkbox"/>	<input checked="" type="checkbox"/>	<input checked="" type="checkbox"/>	<input checked="" type="checkbox"/>	<input checked="" type="checkbox"/>	<input checked="" type="checkbox"/>	<u>"</u>	<u>"</u>	<input checked="" type="checkbox"/>	<u>"</u>	<u>"</u>	
<u>6</u>	<u>B-6</u>	<u>"</u>	<u>1</u>	<input checked="" type="checkbox"/>	<input checked="" type="checkbox"/>	<input checked="" type="checkbox"/>	<input checked="" type="checkbox"/>	<input checked="" type="checkbox"/>	<input checked="" type="checkbox"/>	<input checked="" type="checkbox"/>	<input checked="" type="checkbox"/>	<input checked="" type="checkbox"/>	<u>"</u>	<u>"</u>	<input checked="" type="checkbox"/>	<u>"</u>	<u>"</u>	
<u>7</u>	<u>B-7</u>	<u>"</u>	<u>1</u>	<input checked="" type="checkbox"/>	<input checked="" type="checkbox"/>	<input checked="" type="checkbox"/>	<input checked="" type="checkbox"/>	<input checked="" type="checkbox"/>	<input checked="" type="checkbox"/>	<input checked="" type="checkbox"/>	<input checked="" type="checkbox"/>	<input checked="" type="checkbox"/>	<u>"</u>	<u>"</u>	<input checked="" type="checkbox"/>	<u>"</u>	<u>"</u>	
<u>8</u>	<u>B-8</u>	<u>"</u>	<u>1</u>	<input checked="" type="checkbox"/>	<input checked="" type="checkbox"/>	<input checked="" type="checkbox"/>	<input checked="" type="checkbox"/>	<input checked="" type="checkbox"/>	<input checked="" type="checkbox"/>	<input checked="" type="checkbox"/>	<input checked="" type="checkbox"/>	<input checked="" type="checkbox"/>	<u>"</u>	<u>"</u>	<input checked="" type="checkbox"/>	<u>"</u>	<u>"</u>	
<u>9</u>	<u>B-9</u>	<u>"</u>	<u>1</u>	<input checked="" type="checkbox"/>	<input checked="" type="checkbox"/>	<input checked="" type="checkbox"/>	<input checked="" type="checkbox"/>	<input checked="" type="checkbox"/>	<input checked="" type="checkbox"/>	<input checked="" type="checkbox"/>	<input checked="" type="checkbox"/>	<input checked="" type="checkbox"/>	<u>"</u>	<u>"</u>	<input checked="" type="checkbox"/>	<u>"</u>	<u>"</u>	

PLEASE NOTE: Latency and Damages. Cardinal's liability and damages are limited to the amount paid by the client for the services. Any claims, including those for negligence and any other cause whatsoever shall be deemed waived unless made in writing and received by Cardinal within 30 days after completion of the applicable service. In no event shall Cardinal be liable for accidental or consequential damages, including without limitation, business interruptions, loss of use, or loss of profits incurred by client, its subsidiaries, affiliates, or licensees. The limitation of damages hereunder shall not be subject to the performance of the above stated reasons or otherwise.

Terms and Conditions: Interest will be charged on all accounts more than 30 days past due at the rate of 24% per annum from the original date of invoice, and all costs of collections, including attorney's fees.

Sampler Relinquished: Don Gaer Date: 10-1-08 Received By: Upty LeBut
Relinquished By: Don Gaer Date: 10-1-08 Received By: Upty LeBut

Delivered By: (Circle One) _____ Temp. _____ Sample Condition _____ Checked By: _____
Sampler - UPS - Bus - Other: _____ Cool/Intact: ☒ Yes ☐ No ☐ Yes ☐ No

Phone Result: ☐ No ☐ Add'l Phone #: _____
Fax Result: ☐ No ☐ Add'l Fax #: _____

REMARKS: _____

† Cardinal cannot accept verbal changes. Please fax written changes to 575-393-2476.



CARDINAL LABORATORIES

101 East Marland, Hobbs, NM 88240

(575) 393-2326 Fax (575) 393-2476

BILL TO				ANALYSIS REQUEST															
Company Name: 54.6.S.																			
Project Manager: TONY SAVOIE																			
Address: 610 COMMENCE RO. EX 1226																			
City: JAL State: NM Zip: 88252																			
Phone #: 575-395-2116 Fax #: _____																			
Project #: 2007-019 Project Owner: _____																			
Project Name: BYRD 8'																			
Project Location: SW of MONUMENT																			
Sampler Name: Don Green																			
FOR LAB USE ONLY																			
Lab I.D.				MATRIX		PRESERV.		SAMPLING											
				GROUNDWATER		ACID/BASE													
				WASTEWATER		ICE/COOL													
				SOIL		OTHER:													
				OIL															
				SLUDGE															
				# CONTAINERS															
				(G) RAB OR (C) OMP															
Sample I.D.																			
H1608-10 B-10				✓		✓		10-1-08 2:30											
-11 B-11				✓		✓		"											
-12 B-12				✓		✓		"											
-13 B-13				✓		✓		"											
-14 B-14				✓		✓		"											
-15 B-16				✓		✓		"											
-16 B-17				✓		✓		"											

PLEASE NOTE: Cardinal Laboratories and clients agree that the amount paid by the client for the analysis of all claims involving toxic substances and any other cause whatsoever shall be deemed to be payment in full for the analysis of the claim. In no event shall Cardinal Laboratories be liable for incidental or consequential damages, including without limitation, business interruptions, loss of use, or loss of profits incurred by client, its subsidiaries, affiliates, or licensees, arising out of or from the analysis of the claim. The amount paid by the client shall be deemed to be payment in full for the analysis of the claim. The amount paid by the client shall be deemed to be payment in full for the analysis of the claim.

Sampler Relinquished: **Don Green** Received By: **Don Green** Date: **10-1-08** Time: **14:13**

Relinquished By: _____ Received By: _____ Date: _____ Time: _____

Delivered By: (Circle One) _____ Temp. _____ Sample Condition: Cool ☒ Intact ☒

Sampler - UPS - Bus - Other: _____

Phone Result: ☒ No ☐ Add'l Phone #: _____

Fax Result: ☒ No ☐ Add'l Fax #: _____

REMARKS: _____