

DATE IN 1/27/09	SUSPENSE 2/11/09	ENGINEER W. Jones	LOGGED IN 1/28/09	TYPE DHC	APP NO. PKAA-0902850259
--------------------	---------------------	----------------------	----------------------	-------------	----------------------------

ABOVE THIS LINE FOR DIVISION USE ONLY

RECEIVED NEW MEXICO OIL CONSERVATION DIVISION

- Engineering Bureau -

2009 JAN 27 PM 1:11 1220 South St. Francis Drive, Santa Fe, NM 87505



30.045-20533  
Greener #21  
Burlington Res.  
14638

## ADMINISTRATIVE APPLICATION CHECKLIST

THIS CHECKLIST IS MANDATORY FOR ALL ADMINISTRATIVE APPLICATIONS FOR EXCEPTIONS TO DIVISION RULES AND REGULATIONS WHICH REQUIRE PROCESSING AT THE DIVISION LEVEL IN SANTA FE

### Application Acronyms:

[NSL-Non-Standard Location] [NSP-Non-Standard Proration Unit] [SD-Simultaneous Dedication]  
[DHC-Downhole Commingling] [CTB-Lease Commingling] [PLC-Pool/Lease Commingling]  
[PC-Pool Commingling] [OLS - Off-Lease Storage] [OLM-Off-Lease Measurement]  
[WFX-Waterflood Expansion] [PMX-Pressure Maintenance Expansion]  
[SWD-Salt Water Disposal] [IPI-Injection Pressure Increase]  
[EOR-Qualified Enhanced Oil Recovery Certification] [PPR-Positive Production Response]

### [1] TYPE OF APPLICATION - Check Those Which Apply for [A]

[A] Location - Spacing Unit - Simultaneous Dedication  
☐ NSL ☐ NSP ☐ SD

Check One Only for [B] or [C]

[B] Commingling - Storage - Measurement  
☒ DHC ☐ CTB ☐ PLC ☐ PC ☐ OLS ☐ OLM

[C] Injection - Disposal - Pressure Increase - Enhanced Oil Recovery  
☐ WFX ☐ PMX ☐ SWD ☐ IPI ☐ EOR ☐ PPR

[D] Other: Specify \_\_\_\_\_

### [2] NOTIFICATION REQUIRED TO: - Check Those Which Apply, or Does Not Apply

[A] ☒ Working, Royalty or Overriding Royalty Interest Owners

[B] ☐ Offset Operators, Leaseholders or Surface Owner

[C] ☐ Application is One Which Requires Published Legal Notice

[D] ☐ Notification and/or Concurrent Approval by BLM or SLO  
U.S. Bureau of Land Management - Commissioner of Public Lands, State Land Office

[E] ☐ For all of the above, Proof of Notification or Publication is Attached, and/or,

[F] ☐ Waivers are Attached

### [3] SUBMIT ACCURATE AND COMPLETE INFORMATION REQUIRED TO PROCESS THE TYPE OF APPLICATION INDICATED ABOVE.

[4] **CERTIFICATION:** I hereby certify that the information submitted with this application for administrative approval is **accurate** and **complete** to the best of my knowledge. I also understand that **no action** will be taken on this application until the required information and notifications are submitted to the Division.

Note: Statement must be completed by an individual with managerial and/or supervisory capacity.

Rhonda Rogers  
Print or Type Name

*Rhonda Rogers*  
Signature

Regulatory Technician  
Title

1/23/09  
Date

rogerrs@conocophillips.com  
e-mail Address

District I  
1625 N. French Drive, Hobbs, NM 88240

District II  
1301 W. Grand Avenue, Artesia, NM 88210

District III  
1000 Rio Brazos Road, Aztec, NM 87410

District IV  
1220 S. St. Francis Dr., Santa Fe, NM 87505

State of New Mexico  
Energy, Minerals and Natural Resources Department

Form C-107A  
Revised June 10, 2003

Oil Conservation Division  
1220 South St. Francis Dr.  
Santa Fe, New Mexico 87505

APPLICATION TYPE  
☒ Single Well  
☐ Establish Pre-Approved Pools  
EXISTING WELLBORE  
☒ Yes ☐ No

APPLICATION FOR DOWNHOLE COMMINGLING

Burlington Resources Oil & Gas Company LP  
Operator

P.O.Box 4289 Farmington, NM 87499  
Address

Grenier  
Lease

21  
Well No.

Unit K, Sec. 13, 031N, 012W  
Unit Letter-Section-Township-Range

SAN JUAN  
County

OGRID No: 14538 Property Code 18530 API No. 30045205330000 Lease Type: ☐ Federal ☐ State ☒ Fee

DATA ELEMENT	UPPER ZONE	INTERMEDIATE ZONE	LOWER ZONE
Pool Name	GLADES FRUITLAND SAND <input checked="" type="checkbox"/>	BASIN FRUITLAND COAL <input checked="" type="checkbox"/>	AZTEC PICTURED CLIFFS <input checked="" type="checkbox"/>
Pool Code	77410 <input checked="" type="checkbox"/>	71629 <input checked="" type="checkbox"/>	71280 <input checked="" type="checkbox"/>
Top and Bottom of Pay Section (Perforated or Open-Hole Interval)	2300'-2430' Estimated	2460'-2640' Estimated	2674'-2696'
Method of Production (Flowing or Artificial Lift)	New Zone	New Zone	Flowing
Bottomhole Pressure (Note: Pressure data will not be required if the bottom perforation in the lower zone is within 150% of the depth of the top perforation in the upper zone)	N/A - 150% Rule	N/A - 150% Rule	N/A - 150% Rule
Oil Gravity or Gas BTU (Degree API or Gas BTU)	BTU 1000	BTU 1000	BTU 1000
Producing, Shut-In or New Zone	New Zone	New Zone	Producing
Date and Oil/Gas/Water Rates of Last Production. (Note: For new zones with no production history, applicant shall be required to attach production estimates and supporting data.)	Date: N/A Rates: N/A	Date: N/A Rates: N/A	Date: Aug 2008 Rates: 260 MCF
Fixed Allocation Percentage (Note: If allocation is based upon something other than current or past production, supporting data or explanation will be required.)	Oil Gas Will be supplied upon completion	Oil Gas Will be supplied upon completion	Oil Gas Will be supplied upon completion

ADDITIONAL DATA

Are all working, royalty and overriding royalty interests identical in all commingled zones? Yes ☐ No ☒  
If not, have all working, royalty and overriding royalty interest owners been notified by certified mail? Yes ☒ No ☐

Are all produced fluids from all commingled zones compatible with each other? Yes ☒ No ☐

Will commingling decrease the value of production? Yes ☐ No ☒

If this well is on, or communitized with, state or federal lands, has either the Commissioner of Public Lands or the United States Bureau of Land Management been notified in writing of this application? Yes ☒ No ☐

NMOCD Reference Case No. applicable to this well: \_\_\_\_\_

Attachments:

- C-102 for each zone to be commingled showing its spacing unit and acreage dedication.
- Production curve for each zone for at least one year. (If not available, attach explanation.)
- For zones with no production history, estimated production rates and supporting data.
- Data to support allocation method or formula.
- Notification list of working, royalty and overriding royalty interests for uncommon interest cases.
- Any additional statements, data or documents required to support commingling.

PRE-APPROVED POOLS

If application is to establish Pre-Approved Pools, the following additional information will be required:

- List of other orders approving downhole commingling within the proposed Pre-Approved Pools
- List of all operators within the proposed Pre-Approved Pools
- Proof that all operators within the proposed Pre-Approved Pools were provided notice of this application.
- Bottomhole pressure data.

I hereby certify that the information above is true and complete to the best of my knowledge and belief.

SIGNATURE Ryan Frost TITLE Engineer DATE 1/26/09  
TYPE OR PRINT NAME Ryan Frost, Engineer TELEPHONE NO. (505) 326-9700  
E-MAIL ADDRESS Ryan.M.Frost@conocophillips.com

Grenier 21

Unit K, Section 13, T31N, R12W

The Grenier 21 is a Basin Fruitland Coal, Glades Fruitland Sand and Aztec Pictured Cliffs recomple. A cased hole neutron log will be run prior to completion to identify the Basin Fruitland Coal, Glades Fruitland Sand and Aztec Pictured Cliffs zones. If the Basin Fruitland Coal, Glades Fruitland Sand and Aztec Pictured Cliffs horizons can be isolated, a separator test will be performed and the allocation will be assigned with results using the subtraction method applied to the rate. In the event that the Basin Fruitland Coal, Glades Fruitland Sand and Aztec Pictured Cliffs can not be tested separately, a volumetric calculation will be performed to determine the allocation percentages between the Basin Fruitland Coal, Glades Fruitland Sand and Aztec Pictured Cliffs. All documentation will be submitted to the Aztec NMOCD office.

District I

1625 N. French Dr., Hobbs, NM 88240  
Phone:(505) 393-6161 Fax:(505) 393-0720

District II

1301 W. Grand Ave., Artesia, NM 88210  
Phone:(505) 748-1283 Fax:(505) 748-9720

District III

1000 Rio Brazos Rd., Aztec, NM 87410  
Phone:(505) 334-6178 Fax:(505) 334-6170

District IV

1220 S. St Francis Dr., Santa Fe, NM 87505  
Phone:(505) 476-3470 Fax:(505) 476-3462

**State of New Mexico**  
**Energy, Minerals and Natural Resources**

**Oil Conservation Division****1220 S. St Francis Dr.****Santa Fe, NM 87505**

Form C-102  
Permit 86074

**WELL LOCATION AND ACREAGE DEDICATION PLAT**

1. API Number <b>30-045-20533</b>	2. Pool Code <b>77410</b>	3. Pool Name <b>GLADES FRUITLAND SAND (GAS)</b>
4. Property Code <b>18530</b>	5. Property Name <b>GRENIER</b>	6. Well No. <b>021</b>
7. OGRID No. <b>14538</b>	8. Operator Name <b>BURLINGTON RESOURCES OIL &amp; GAS COMPANY LP</b>	9. Elevation <b>6110</b>

**10. Surface Location**

UL - Lot <b>K</b>	Section <b>13</b>	Township <b>31N</b>	Range <b>12W</b>	Lot Idn	Feet From <b>1650</b>	N/S Line <b>S</b>	Feet From <b>1650</b>	E/W Line <b>W</b>	County <b>SAN JUAN</b>
----------------------	----------------------	------------------------	---------------------	---------	--------------------------	----------------------	--------------------------	----------------------	---------------------------

**11. Bottom Hole Location If Different From Surface**

UL - Lot	Section	Township	Range	Lot Idn	Feet From	N/S Line	Feet From	E/W Line	County
12. Dedicated Acres <b>160.00</b>	13. Joint or Infill	14. Consolidation Code	15. Order No.						

**NO ALLOWABLE WILL BE ASSIGNED TO THIS COMPLETION UNTIL ALL INTERESTS HAVE BEEN CONSOLIDATED OR A NON-STANDARD UNIT HAS BEEN APPROVED BY THE DIVISION**

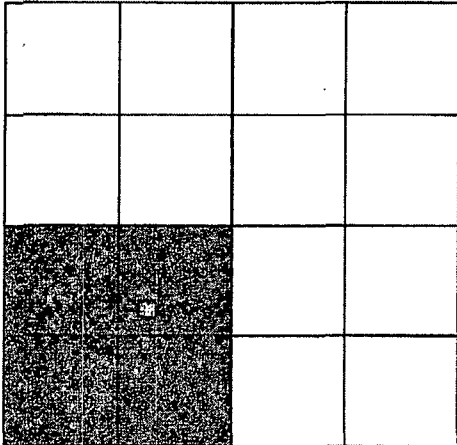
	<p align="center"><b>OPERATOR CERTIFICATION</b></p> <p><i>I hereby certify that the information contained herein is true and complete to the best of my knowledge and belief, and that this organization either owns a working interest or unleased mineral interest in the land including the proposed bottom hole location(s) or has a right to drill this well at this location pursuant to a contract with an owner of such a mineral or working interest, or to a voluntary pooling agreement or a compulsory pooling order heretofore entered by the division.</i></p> <p>E-Signed By: <b>Tamra Sessions</b> Title: <b>Staff Regulatory Technician</b> Date: <b>12/01/2008</b></p>
	<p align="center"><b>SURVEYOR CERTIFICATION</b></p> <p><i>I hereby certify that the well location shown on this plat was plotted from field notes of actual surveys made by me or under my supervision, and that the same is true and correct to the best of my belief.</i></p> <p>Surveyed By: <b>Fred B. Kerr Jr.</b> Date of Survey: <b>5/2/1969</b> Certificate Number: <b>3950</b></p>

District I

1625 N. French Dr., Hobbs, NM 88240  
Phone:(505) 393-6161 Fax:(505) 393-0720

District II

1301 W. Grand Ave., Artesia, NM 88210  
Phone:(505) 748-1283 Fax:(505) 748-9720

District III

1000 Rio Brazos Rd., Aztec, NM 87410  
Phone:(505) 334-6178 Fax:(505) 334-6170

District IV

1220 S. St Francis Dr., Santa Fe, NM 87505  
Phone:(505) 476-3470 Fax:(505) 476-3462

**State of New Mexico**  
**Energy, Minerals and Natural Resources**  
**Oil Conservation Division**  
**1220 S. St Francis Dr.**  
**Santa Fe, NM 87505**

Form C-102  
Permit 86074

**WELL LOCATION AND ACREAGE DEDICATION PLAT**

1. API Number <b>30-045-20533</b>	2. Pool Code <b>71629</b>	3. Pool Name <b>BASIN FRUITLAND COAL (GAS)</b>
4. Property Code <b>18530</b>	5. Property Name <b>GRENIER</b>	6. Well No. <b>021</b>
7. OGRID No. <b>14538</b>	8. Operator Name <b>BURLINGTON RESOURCES OIL &amp; GAS COMPANY LP</b>	9. Elevation <b>6110</b>

**10. Surface Location**

UL - Lot <b>K</b>	Section <b>13</b>	Township <b>31N</b>	Range <b>12W</b>	Lot Idn	Feet From <b>1650</b>	N/S Line <b>S</b>	Feet From <b>1650</b>	E/W Line <b>W</b>	County <b>SAN JUAN</b>
----------------------	----------------------	------------------------	---------------------	---------	--------------------------	----------------------	--------------------------	----------------------	---------------------------

**11. Bottom Hole Location If Different From Surface**

UL - Lot	Section	Township	Range	Lot Idn	Feet From	N/S Line	Feet From	E/W Line	County
12. Dedicated Acres <b>316.64</b>	13. Joint or Infill	14. Consolidation Code	15. Order No.						

**NO ALLOWABLE WILL BE ASSIGNED TO THIS COMPLETION UNTIL ALL INTERESTS HAVE BEEN CONSOLIDATED OR A NON-STANDARD UNIT HAS BEEN APPROVED BY THE DIVISION**

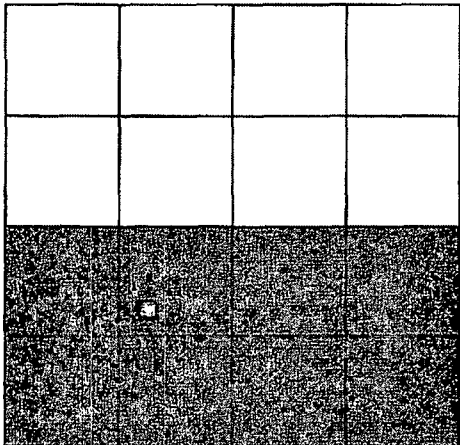
	<p style="text-align: center;"><b>OPERATOR CERTIFICATION</b></p> <p><i>I hereby certify that the information contained herein is true and complete to the best of my knowledge and belief, and that this organization either owns a working interest or unleased mineral interest in the land including the proposed bottom hole location(s) or has a right to drill this well at this location pursuant to a contract with an owner of such a mineral or working interest, or to a voluntary pooling agreement or a compulsory pooling order heretofore entered by the division.</i></p> <p>E-Signed By: <i>Tamra Sessions</i> <b>Tamra Sessions</b> Title: <b>Staff Regulatory Technician</b> Date: <b>12/01/2008</b></p> <hr/> <p style="text-align: center;"><b>SURVEYOR CERTIFICATION</b></p> <p><i>I hereby certify that the well location shown on this plat was plotted from field notes of actual surveys made by me or under my supervision, and that the same is true and correct to the best of my belief.</i></p> <p>Surveyed By: <b>Fred B. Kerr Jr.</b> Date of Survey: <b>5/2/1969</b> Certificate Number: <b>3950</b></p>
---	--

# MEXICO OIL CONSERVATION COMMISSION WELL LOCATION AND ACREAGE DEDICATION PLAT

Form C-102  
Supersedes C-128  
Effective 1-1-65

All distances must be from the outer boundaries of the Section.

Operator <b>Artec Oil &amp; Gas Company</b>			Lease		Well No. <b>21</b>
Unit Letter <b>K</b>	Section <b>13</b>	Township <b>31N</b>	Range <b>12W</b>	County <b>San Juan</b>	
Actual Footage Location of Well: <b>1650'</b> feet from the <b>South</b> line and <b>1650'</b> feet from the <b>West</b> line					
Ground Level Elev. <b>6110</b>	Producing Formation <b>Pictured Cliffs</b>		Pool	Dedicated Acreage:  Acres	

1. Outline the acreage dedicated to the subject well by colored pencil or hachure marks on the plat below.
2. If more than one lease is dedicated to the well, outline each and identify the ownership thereof (both as to working interest and royalty).
3. If more than one lease of different ownership is dedicated to the well, have the interests of all owners been consolidated by communitization, unitization, force-pooling, etc?

☐ Yes ☐ No If answer is "yes," type of consolidation \_\_\_\_\_

If answer is "no," list the owners and tract descriptions which have actually been consolidated. (Use reverse side of this form if necessary.) \_\_\_\_\_

No allowable will be assigned to the well until all interests have been consolidated (by communitization, unitization, forced-pooling, or otherwise) or until a non-standard unit, eliminating such interests, has been approved by the Commission.

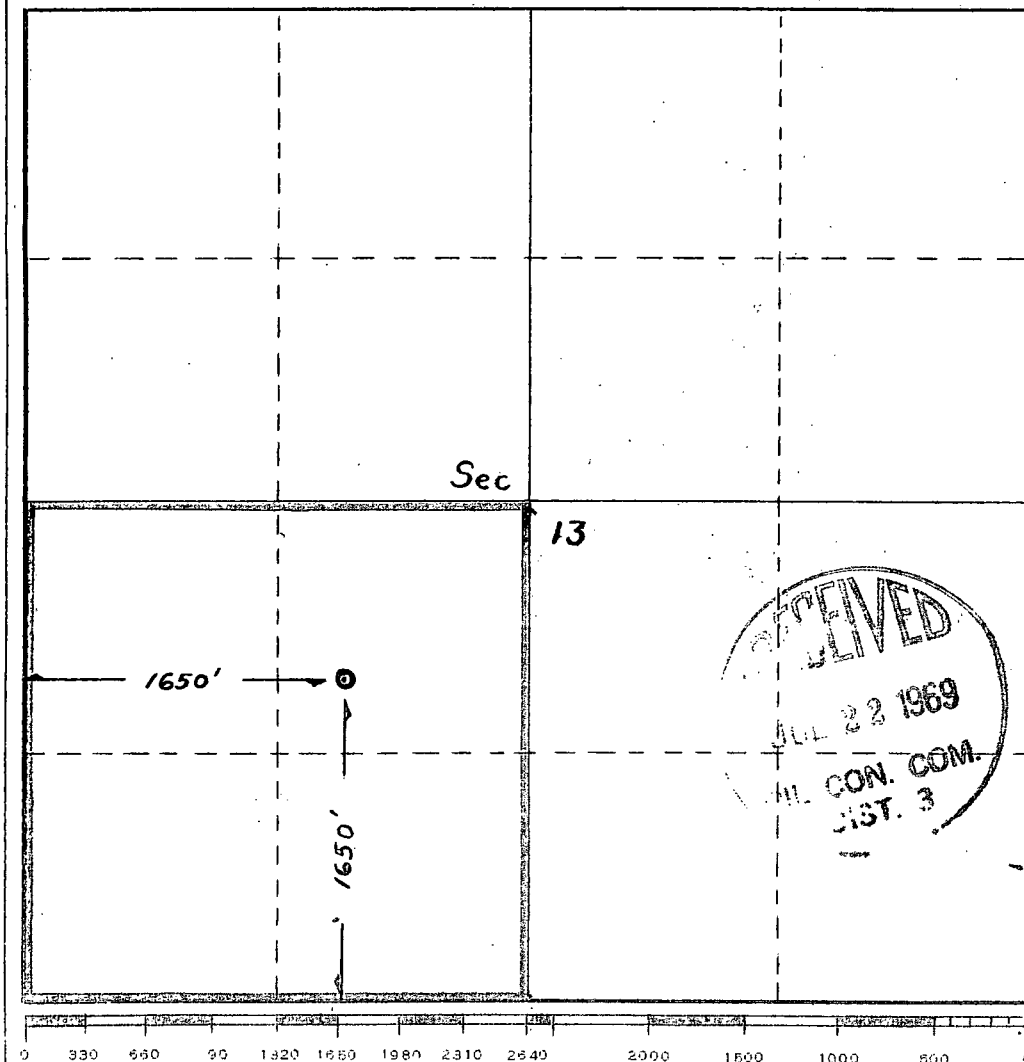

## CERTIFICATION

I hereby certify that the information contained herein is true and complete to the best of my knowledge and belief.

Name
Position
Company
Date

I hereby certify that the well location shown on this plat was plotted from field notes of actual surveys made by me or under my supervision, and that the same is true and correct to the best of my knowledge and belief.

Date Surveyed <b>July 2, 1969</b>
Registered Professional Engineer and/or Land Surveyor <b>Fred B. Kerr Jr.</b>
Certificate No. <b>3950</b>

## **Roland, Kandis R**

---

**From:** Pippin, Eddie A  
**Sent:** Monday, January 19, 2009 4:56 PM  
**To:** Roland, Kandis R  
**Subject:** RE: Grenier 21

FC: 2640' - 2460'  
FS: 2430' - 2300'

---

**From:** Roland, Kandis R  
**Sent:** Monday, January 19, 2009 7:55 AM  
**To:** Pippin, Eddie A  
**Subject:** FW: Grenier 21

Eddie,

Will you please send me the estimated perf's.

Thanks!  
Kandis

---

**From:** Rogers, Rhonda S  
**Sent:** Friday, January 16, 2009 10:24 AM  
**To:** Roland, Kandis R  
**Subject:** Grenier 21

Kandis I need a C-107A for this trimingle. Adding the Basin Fruitland Coal (71629)/Glades Fruitland Sand (77410) to the existing Aztec Pictured Cliff. API # 30-045-20533. Sec 13 31N 12W. Thank you very much

***Rhonda Rogers***

Regulatory Technician  
ConocoPhillips - SJBU  
phone (505) 599-4018  
Fax #918-662-6404  
e-mail [rogerrs@conocophillips.com](mailto:rogerrs@conocophillips.com)

GRENIER 21 FC RC Data: Jan.2009-Jan.2009

Operator:

Field:

Zone:

Type: Other

Group: None

No

Active

Forecast

Production Cums

Oil: 0 MSTB

Gas: 0 MMSCF

Water: 0 MSTB

Cond: 0 MSTB

Oil Rate - Bbl/d

Cum: 0.00

Gas Rate - mcf/d

Cum: 0.00

Water Rate - Bbl/d

Cum: 0.00

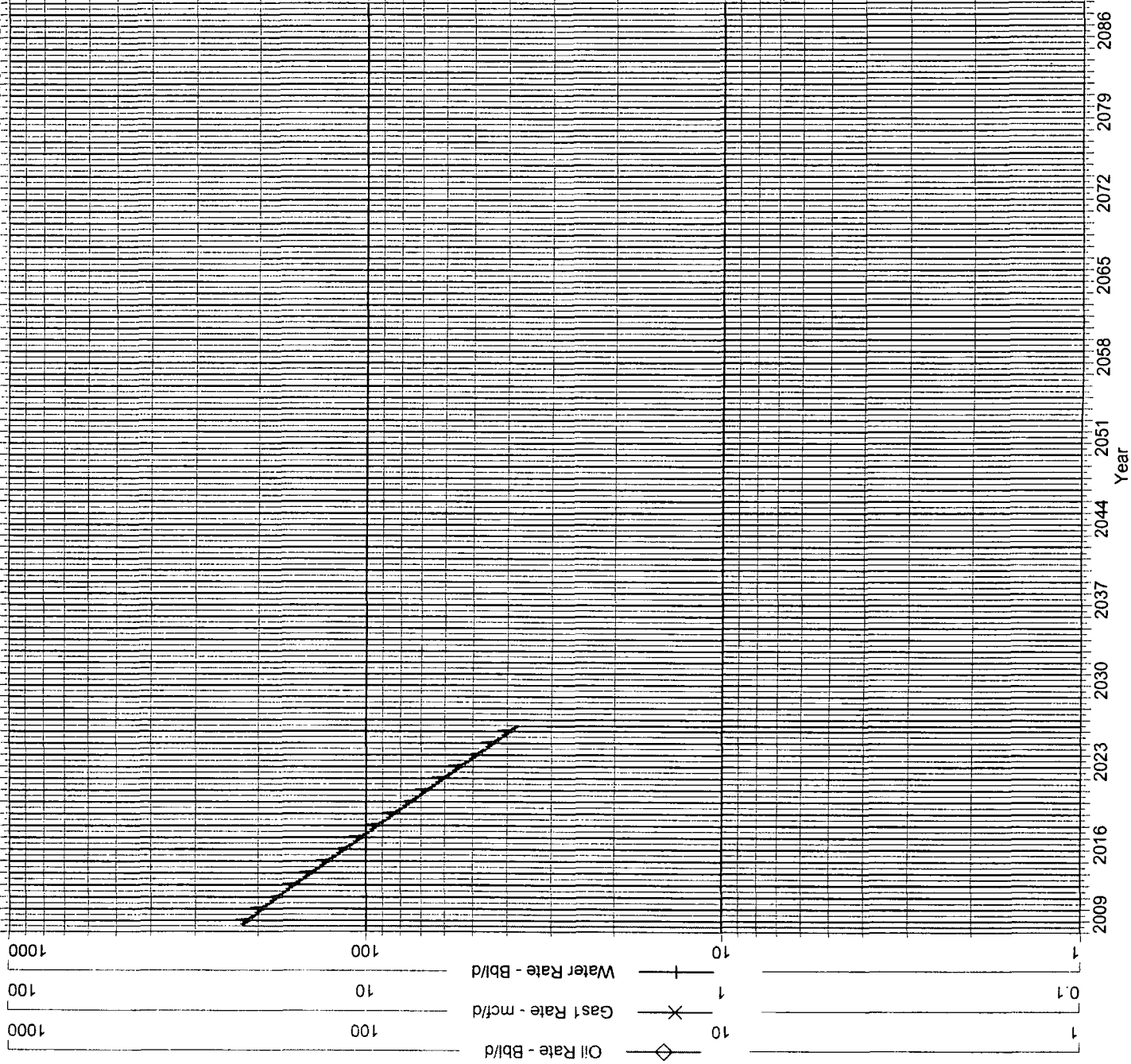



# GRENIER 21 FS RC Data: Jan. 2009-Jan. 2009

Operator:

Field:

Zone:

Type: Other

Group: None

No

Active

Forecast

Production Cums

Oil: 0 MSTB

Gas: 0 MMSCF

Water: 0 MSTB

Cond: 0 MSTB

◇ Oil Rate - Bbl/d

Cum: 0.00

\* Gas1 Rate - mcf/d

Cum: 0.00

— Water Rate - Bbl/d

Cum: 0.00

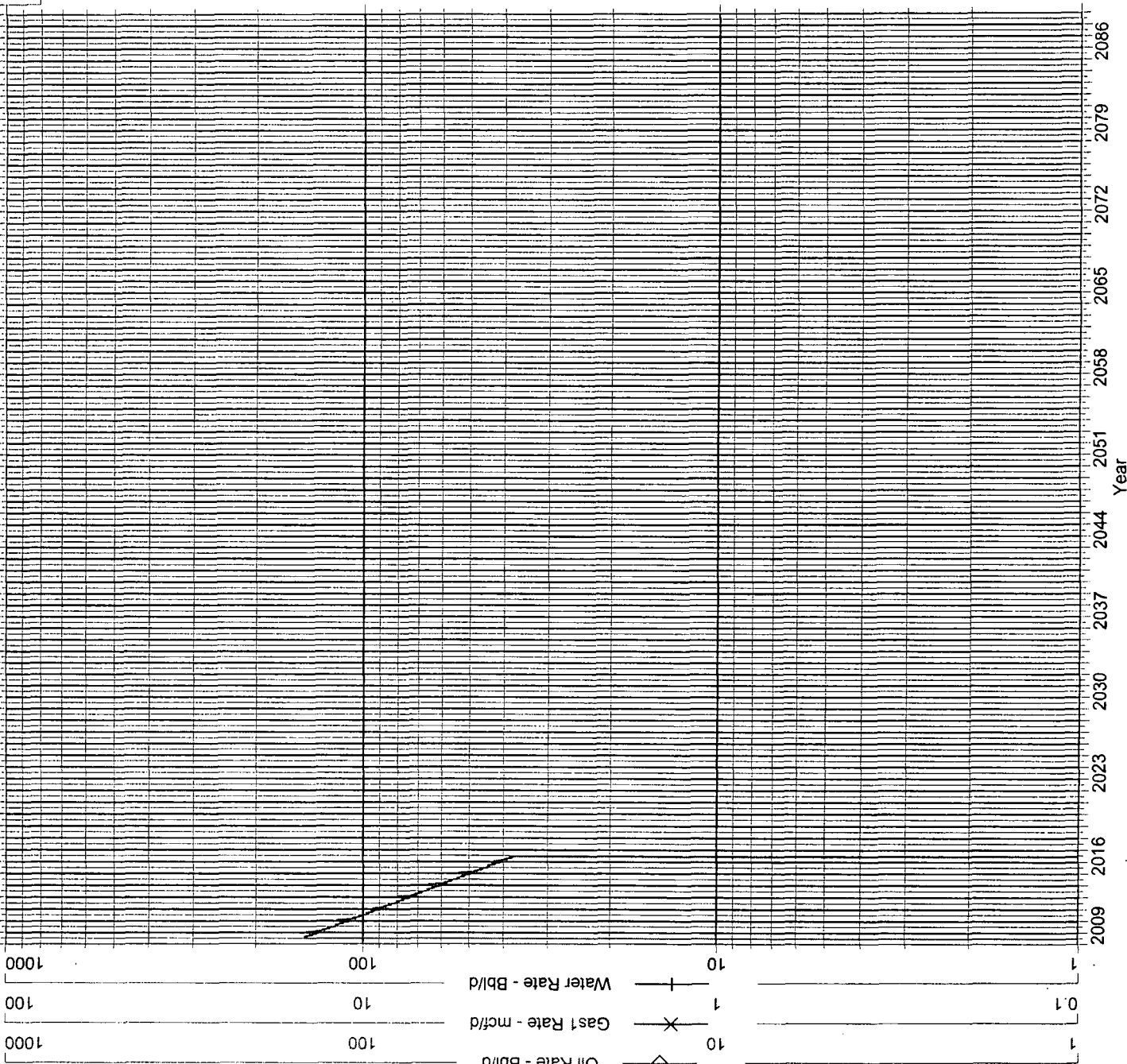

Lease Name: GRENIER  
County, State: SAN JUAN, NM  
Operator: BURLINGTON RESOURCES O&G CO LP  
Field: AZTEC  
Reservoir: PICTURED CLIFFS  
Location: 13 31N 12W SW NE SW

GRENIER - AZTEC

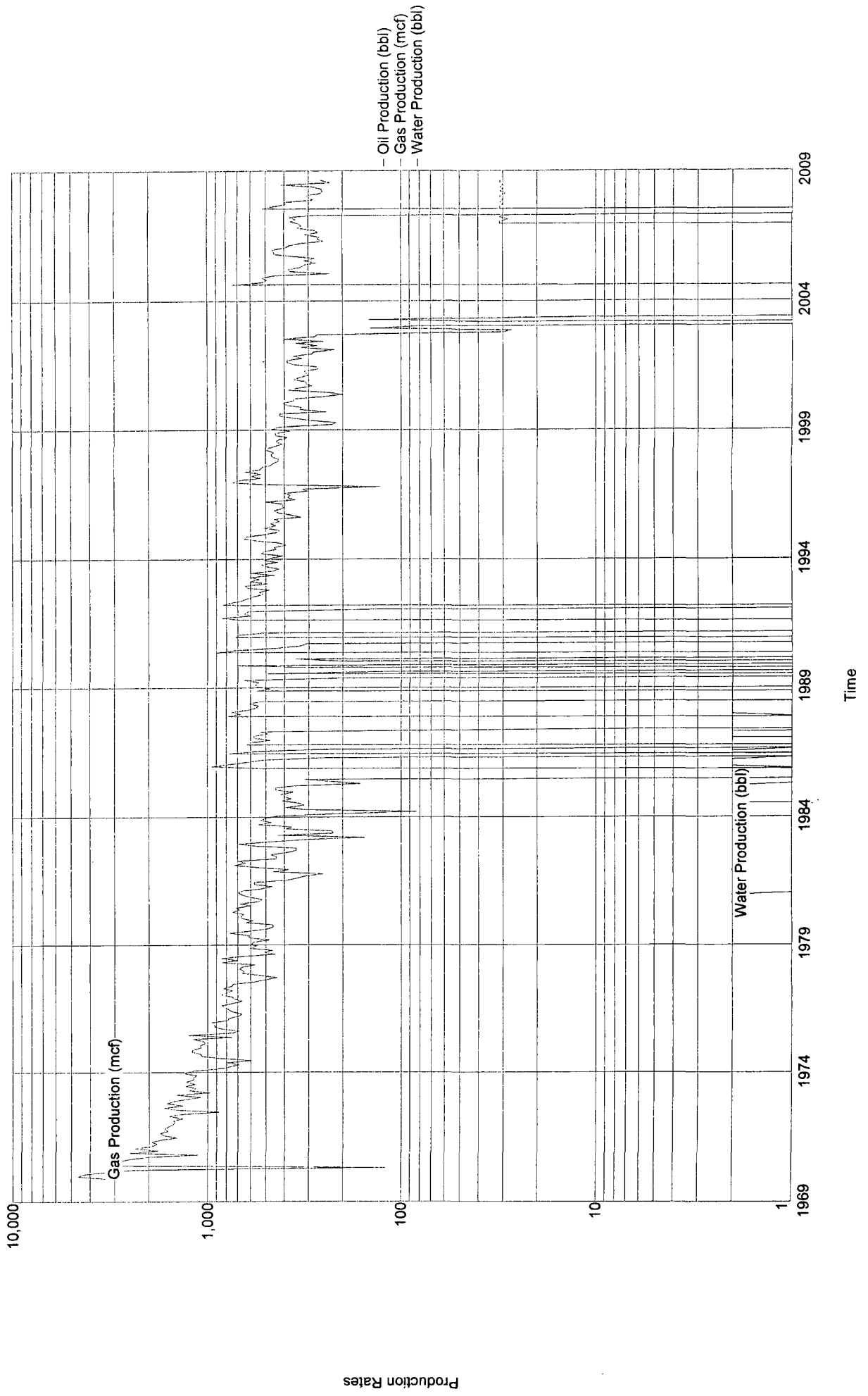

SAN JUAN NM

GRENIER 21

BURLINGTON RESOURCES O&amp;G CO LP

ACTIVE

## Detailed Production Report

<b>Lease Name:</b>	<b>GRENIER</b>	<b>Well Number:</b>	<b>21</b>
Lease Number:	018530	Cum Oil:	
Operator Name:	BURLINGTON RESOURCES O&G	Cum Gas:	273,335 since NOV 1969
State:	NEW MEXICO	Cum Water:	687 since JAN 1980
County:	SAN JUAN	First Production Date:	
Field:	AZTEC	Last Production Date:	AUG 2008
Sec Twn Rng:	13K 31N 12W	Spot:	SW NE SW
Latitude/Longitude:	36.8961 -108.05223	Lat/Long Source:	TS
Regulatory #:		Completion Date:	AUG 11, 1969
API:	30045205330000	Total Depth:	2730
Production ID:	2300430452053371280	Upper Perforation:	2674
Reservoir Name:	PICTURED CLIFFS	Lower Perforation:	2696
Prod Zone:	PICTURED CLIFFS	Gas Gravity:	0.68
Prod Zone Code:	604PCCF	Oil Gravity:	
Basin Name:	SAN JUAN BASIN	Temp Gradient:	1.7
Gas Gatherer:		N Factor:	
Liquid Gatherer:		GOR:	
Status:	ACTIVE		GAS

Annual Production		(40 years)	
Year	Oil BBLs	Gas MCF	Water BBLs

## Beginning

Cum:

1969	7,937	
1970	28,647	
1971	21,034	
1972	17,012	
1973	14,464	
1974	11,469	
1975	11,458	
1976	8,984	
1977	8,060	
1978	7,529	
1979	6,889	
1980	7,736	24
1981	5,627	11
1982	6,276	12
1983	4,605	1
1984	4,052	12
1985	3,458	11
1986	5,386	12
1987	3,639	11
1988	4,660	14
1989	4,159	

1990	3,968		
1991	4,614		
1992	6,410		
1993	6,148		
1994	5,951		
1995	5,143		
1996	4,815		
1997	6,279		
1998	5,271		
1999	4,125		
2000	3,804		
2001	3,894		
2002	2,865		
2003	277		
2004	2,724		
2005	4,217		
2006	3,745	31	
2007	3,724	304	
2008	2,280	244	
Totals:			
	273,335	687	

**Monthly Production**

Date MO/YR	Oil BBLS	Gas MCF	Water BBLS	Cond Yld STB/MMCF	% Water	# of Wells	Days on
AUG 1969		0				0	
SEP 1969		0				0	
OCT 1969		0				0	
NOV 1969		3,333				1	
DEC 1969		4,604				1	
Totals:							
1969		7,937					
JAN 1970		4,345				1	
FEB 1970		3,298				1	
MAR 1970		2,408				1	
APR 1970		120				1	
MAY 1970		2,753				1	
JUN 1970		2,897				1	
JUL 1970		2,882				1	
AUG 1970		2,530				1	
SEP 1970		1,996				1	
OCT 1970		1,122				1	
NOV 1970		2,500				1	
DEC 1970		1,796				1	
Totals:							
1970		28,647					
JAN 1971		2,362				1	
FEB 1971		1,942				1	
MAR 1971		1,818				1	
APR 1971		1,936				1	

MAY 1971	1,725	1
JUN 1971	1,441	1
JUL 1971	1,682	1
AUG 1971	1,753	1
SEP 1971	1,596	1
OCT 1971	1,662	1
NOV 1971	1,599	1
DEC 1971	1,518	1
Totals:		
1971	21,034	
JAN 1972	1,472	1
FEB 1972	1,497	1
MAR 1972	1,343	1
APR 1972	1,586	1
MAY 1972	1,368	1
JUN 1972	878	1
JUL 1972	1,439	1
AUG 1972	1,671	1
SEP 1972	1,343	1
OCT 1972	1,620	1
NOV 1972	1,511	1
DEC 1972	1,284	1
Totals:		
1972	17,012	
JAN 1973	1,087	1
FEB 1973	1,444	1
MAR 1973	975	1
APR 1973	1,241	1
MAY 1973	1,150	1
JUN 1973	1,300	1
JUL 1973	1,162	1
AUG 1973	1,290	1
SEP 1973	1,179	1
OCT 1973	1,187	1
NOV 1973	1,133	1
DEC 1973	1,316	1
Totals:		
1973	14,464	
JAN 1974	1,221	1
FEB 1974	905	1
MAR 1974	778	1
APR 1974	689	1
MAY 1974	793	1
JUN 1974	593	1
JUL 1974	862	1
AUG 1974	1,068	1
SEP 1974	1,087	1
OCT 1974	1,204	1
NOV 1974	1,192	1
DEC 1974	1,077	1
Totals:		
1974	11,469	
JAN 1975	1,098	1

FEB 1975	1,030	1
MAR 1975	1,052	1
APR 1975	1,188	1
MAY 1975	749	1
JUN 1975	1,260	1
JUL 1975	743	1
AUG 1975	688	1
SEP 1975	853	1
OCT 1975	917	1
NOV 1975	926	1
DEC 1975	954	1

Totals:

1975	11,458	
------	--------	--

JAN 1976	790	1
FEB 1976	774	1
MAR 1976	695	1
APR 1976	666	1
MAY 1976	742	1
JUN 1976	779	1
JUL 1976	812	1
AUG 1976	845	1
SEP 1976	742	1
OCT 1976	664	1
NOV 1976	724	1
DEC 1976	751	1

Totals:

1976	8,984	
------	-------	--

JAN 1977	849	1
FEB 1977	788	1
MAR 1977	745	1
APR 1977	830	1
MAY 1977	749	1
JUN 1977	735	1
JUL 1977	573	1
AUG 1977	507	1
SEP 1977	436	1
OCT 1977	536	1
NOV 1977	664	1
DEC 1977	648	1

Totals:

1977	8,060	
------	-------	--

JAN 1978	681	1
FEB 1978	664	1
MAR 1978	569	1
APR 1978	840	1
MAY 1978	704	1
JUN 1978	849	1
JUL 1978	644	1
AUG 1978	444	1
SEP 1978	509	1
OCT 1978	460	1
NOV 1978	604	1
DEC 1978	561	1

Totals:

1978	7,529			
JAN 1979	593		1	
FEB 1979	580		1	
MAR 1979	479		1	
APR 1979	614		1	
MAY 1979	606		1	
JUN 1979	771		1	
JUL 1979	623		1	
AUG 1979	491		1	
SEP 1979	458		1	
OCT 1979	460		1	
NOV 1979	632		1	
DEC 1979	582		1	
Totals:				
1979	6,889			
JAN 1980	666	2	1	31
FEB 1980	672	2	1	29
MAR 1980	649	2	1	31
APR 1980	744	2	1	30
MAY 1980	684	2	1	31
JUN 1980	714	2	1	29
JUL 1980	599	2	1	31
AUG 1980	680	2	1	31
SEP 1980	545	2	1	30
OCT 1980	523	2	1	31
NOV 1980	599	2	1	30
DEC 1980	661	2	1	31
Totals:				
1980	7,736	24		
JAN 1981	693	1	1	31
FEB 1981	667	1	1	28
MAR 1981	523	1	1	31
APR 1981	462	0	1	8
MAY 1981	573	1	1	31
JUN 1981	575	1	1	30
JUL 1981	393	1	1	31
AUG 1981	343	1	1	31
SEP 1981	306	1	1	24
OCT 1981	253	1	1	31
NOV 1981	459	1	1	30
DEC 1981	380	1	1	31
Totals:				
1981	5,627	11		
JAN 1982	533	1	1	28
FEB 1982	729	1	1	28
MAR 1982	635	1	1	31
APR 1982	696	1	1	30
MAY 1982	443	1	1	31
JUN 1982	438	1	1	30
JUL 1982	470	1	1	31
AUG 1982	388	1	1	31
SEP 1982	347	1	1	30
OCT 1982	346	1	1	31

NOV 1982	559	1	1	30
DEC 1982	692	1	1	31
Totals:				
1982	6,276	12		
JAN 1983	465	1	1	31
FEB 1983	300	0	1	28
MAR 1983	154	0	1	27
APR 1983	436	0	1	30
MAY 1983	224	0	1	24
JUN 1983	228	0	1	16
JUL 1983	391	0	1	31
AUG 1983	367	0	1	31
SEP 1983	544	0	1	30
OCT 1983	466	0	1	31
NOV 1983	532	0	1	30
DEC 1983	498	0	1	31
Totals:				
1983	4,605	1		
JAN 1984	433	0	1	31
FEB 1984	211	0	1	29
MAR 1984	83	0	1	22
APR 1984	320	0	1	30
MAY 1984	394	0	1	31
JUN 1984	315	0	1	30
JUL 1984	336	2	1	31
AUG 1984	410	2	1	31
SEP 1984	368	2	1	30
OCT 1984	403	2	1	30
NOV 1984	418	2	1	30
DEC 1984	361	2	1	30
Totals:				
1984	4,052	12		
JAN 1985	442	2	1	31
FEB 1985	446	2	1	28
MAR 1985	364	2	1	28
APR 1985	161	1	1	20
MAY 1985	234	0	1	5
JUN 1985	315	1	1	11
JUL 1985	0	0	0	0
AUG 1985	0	0	0	0
SEP 1985	0	0	0	0
OCT 1985	0	0	0	0
NOV 1985	542	1	1	10
DEC 1985	954	2	1	24
Totals:				
1985	3,458	11		
JAN 1986	769	2	1	31
FEB 1986	621	2	1	28
MAR 1986	511	2	1	28
APR 1986	236	1	1	17
MAY 1986	0	0	0	0
JUN 1986	782	2	1	25
JUL 1986	542	2	1	30



AUG 1986	216	1	1	15
SEP 1986	0	0	0	0
OCT 1986	624	0	1	18
NOV 1986	613	0	1	30
DEC 1986	472	0	1	30
Totals:				
1986	5,386	12		
JAN 1987	573	2	1	31
FEB 1987	577	2	1	28
MAR 1987	487	2	1	28
APR 1987	532	2	1	30
MAY 1987	13	0	1	1
JUN 1987	0	0	0	0
JUL 1987	0	0	0	0
AUG 1987	0	0	0	0
SEP 1987	0	0	0	0
OCT 1987	0	0	0	0
NOV 1987	784	1	1	17
DEC 1987	673	2	1	30
Totals:				
1987	3,639	11		
JAN 1988	757	2	1	31
FEB 1988	624	2	1	29
MAR 1988	562	2	1	29
APR 1988	545	2	1	30
MAY 1988	609	2	1	30
JUN 1988	534	2	1	28
JUL 1988	0	0	0	0
AUG 1988	0	0	0	0
SEP 1988	0	0	0	0
OCT 1988	0	0	0	0
NOV 1988	557	1	1	12
DEC 1988	472	1	1	12
Totals:				
1988	4,660	14		
JAN 1989	559		1	31
FEB 1989	563		1	28
MAR 1989	541		1	12
APR 1989	649		1	30
MAY 1989	202		1	16
JUN 1989	0		0	0
JUL 1989	495		1	15
AUG 1989	119		1	31
SEP 1989	0		0	0
OCT 1989	315		1	9
NOV 1989	716		1	16
DEC 1989	0		0	0
Totals:				
1989	4,159			
JAN 1990	206		1	6
FEB 1990	355		1	8
MAR 1990	0		0	0
APR 1990	0		0	0

MAY 1990	900	1	31
JUN 1990	708	1	30
JUL 1990	445	1	18
AUG 1990	330	1	31
SEP 1990	308	1	9
OCT 1990	0	0	0
NOV 1990	0	0	0
DEC 1990	716	1	24
Totals:			
1990	3,968		
JAN 1991	704	1	31
FEB 1991	516	1	22
MAR 1991	0	0	0
APR 1991	0	0	0
MAY 1991	0	0	0
JUN 1991	0	0	0
JUL 1991	0	0	0
AUG 1991	689	1	22
SEP 1991	843	1	23
OCT 1991	599	1	31
NOV 1991	647	1	30
DEC 1991	616	1	30
Totals:			
1991	4,614		
JAN 1992	142	1	31
FEB 1992	0	0	0
MAR 1992	840	1	31
APR 1992	765	1	30
MAY 1992	668	1	31
JUN 1992	626	1	30
JUL 1992	573	1	31
AUG 1992	517	1	31
SEP 1992	540	1	30
OCT 1992	479	1	31
NOV 1992	619	1	30
DEC 1992	641	1	31
Totals:			
1992	6,410		
JAN 1993	489	1	31
FEB 1993	605	1	28
MAR 1993	541	1	31
APR 1993	606	1	30
MAY 1993	452	1	23
JUN 1993	598	1	30
JUL 1993	461	1	24
AUG 1993	427	1	31
SEP 1993	500	1	23
OCT 1993	527	1	31
NOV 1993	432	1	30
DEC 1993	510	1	31
Totals:			
1993	6,148		
JAN 1994	470	1	31

FEB 1994	408	1	28
MAR 1994	526	1	31
APR 1994	515	1	30
MAY 1994	441	1	31
JUN 1994	454	1	30
JUL 1994	394	1	31
AUG 1994	425	1	31
SEP 1994	539	1	30
OCT 1994	644	1	31
NOV 1994	630	1	30
DEC 1994	505	1	31

Totals:

1994

5,951

JAN 1995	431	1	31
FEB 1995	424	1	28
MAR 1995	511	1	31
APR 1995	442	1	30
MAY 1995	473	1	31
JUN 1995	425	1	30
JUL 1995	451	1	31
AUG 1995	328	1	31
SEP 1995	370	1	30
OCT 1995	428	1	31
NOV 1995	454	1	30
DEC 1995	406	1	31

Totals:

1995

5,143

JAN 1996	406	1	31
FEB 1996	412	1	29
MAR 1996	505	1	31
APR 1996	351	1	30
MAY 1996	384	1	31
JUN 1996	373	1	30
JUL 1996	399	1	31
AUG 1996	303	1	31
SEP 1996	325	1	30
OCT 1996	128	1	31
NOV 1996	489	1	30
DEC 1996	740	1	31

Totals:

1996

4,815

JAN 1997	687	1	31
FEB 1997	528	1	28
MAR 1997	593	1	31
APR 1997	528	1	30
MAY 1997	641	1	31
JUN 1997	531	1	30
JUL 1997	526	1	31
AUG 1997	472	1	31
SEP 1997	454	1	30
OCT 1997	429	1	31
NOV 1997	428	1	30
DEC 1997	462	1	31

Totals:

1997	6,279		
JAN 1998	467	1	31
FEB 1998	453	1	28
MAR 1998	493	1	31
APR 1998	483	1	30
MAY 1998	444	1	30
JUN 1998	410	1	30
JUL 1998	442	1	31
AUG 1998	430	1	31
SEP 1998	385	1	30
OCT 1998	444	1	31
NOV 1998	447	1	30
DEC 1998	373	1	31
Totals:			
1998	5,271		
JAN 1999	466	1	31
FEB 1999	421	1	28
MAR 1999	226	1	31
APR 1999	217	1	30
MAY 1999	299	1	31
JUN 1999	362	1	30
JUL 1999	421	1	31
AUG 1999	424	1	31
SEP 1999	241	1	30
OCT 1999	334	1	31
NOV 1999	327	1	30
DEC 1999	387	1	31
Totals:			
1999	4,125		
JAN 2000	408	1	31
FEB 2000	358	1	29
MAR 2000	358	1	31
APR 2000	252	1	30
MAY 2000	199	1	31
JUN 2000	241	1	30
JUL 2000	383	1	31
AUG 2000	340	1	31
SEP 2000	288	1	30
OCT 2000	308	1	31
NOV 2000	310	1	30
DEC 2000	359	1	31
Totals:			
2000	3,804		
JAN 2001	329	1	31
FEB 2001	301	1	28
MAR 2001	309	1	31
APR 2001	316	1	30
MAY 2001	268	1	31
JUN 2001	275	1	30
JUL 2001	353	1	31
AUG 2001	386	1	31
SEP 2001	387	1	30
OCT 2001	323	1	31

NOV 2001	359	1	30
DEC 2001	288	1	31
Totals:			
2001	3,894		
JAN 2002	283	1	31
FEB 2002	221	1	28
MAR 2002	327	1	31
APR 2002	271	1	30
MAY 2002	350	1	31
JUN 2002	252	1	30
JUL 2002	410	1	31
AUG 2002	279	1	31
SEP 2002	271	1	30
OCT 2002	30	1	31
NOV 2002	27	1	30
DEC 2002	144	1	31
Totals:			
2002	2,865		
JAN 2003	75	1	31
FEB 2003	0	0	0
MAR 2003	40	1	31
APR 2003	146	1	30
MAY 2003	16	1	31
Totals:			
2003	277		
JAN 2004	0	0	0
FEB 2004	0	0	0
MAR 2004	0	0	0
APR 2004	0	0	0
MAY 2004	0	0	0
JUN 2004	0	0	0
JUL 2004	0	0	0
AUG 2004	740	1	28
SEP 2004	518	1	30
OCT 2004	491	1	31
NOV 2004	519	1	30
DEC 2004	456	1	31
Totals:			
2004	2,724		
JAN 2005	233	1	31
FEB 2005	370	1	28
MAR 2005	380	1	31
APR 2005	327	1	30
MAY 2005	317	1	31
JUN 2005	274	1	30
JUL 2005	319	1	31
AUG 2005	278	1	31
SEP 2005	355	1	30
OCT 2005	449	1	31
NOV 2005	454	1	30
DEC 2005	461	1	31
Totals:			
2005	4,217		

JAN 2006	394	0	1	31
FEB 2006	375	0	1	28
MAR 2006	329	0	1	31
APR 2006	250	0	1	30
MAY 2006	270	0	1	31
JUN 2006	263	0	1	30
JUL 2006	315	0	1	31
AUG 2006	267	0	1	31
SEP 2006	278	0	1	30
OCT 2006	342	0	1	31
NOV 2006	326	0	1	30
DEC 2006	336	31	1	31

Totals:				
2006	3,745	31		

JAN 2007	371	31	1	31
FEB 2007	347	28	1	28
MAR 2007	376	31	1	31
APR 2007	279	30	1	30
MAY 2007	0	0	0	0
JUN 2007	0	0	0	0
JUL 2007	523	31	1	31
AUG 2007	451	31	1	31
SEP 2007	392	30	1	30
OCT 2007	401	31	1	31
NOV 2007	284	30	1	30
DEC 2007	300	31	1	31

Totals:				
2007	3,724	304		

JAN 2008	308	31	1	31
FEB 2008	262	29	1	29
MAR 2008	254	31	1	31
APR 2008	259	30	1	30
MAY 2008	288	31	1	31
JUN 2008	419	30	1	30
JUL 2008	230	31	1	31
AUG 2008	260	31	1	31

Gas Tests	Total count: 9		244							
API	Well	Test	WHSIP	WHFP	BHP	BHP/Z	Water	Cond	Gas	AOF
Number	Number	Date					B/D	B/D	MCFD	MCFD

## First Test

30045205330000	21	19690811	703	44	753	837			458	
30045205330000	21	19700924	463	298	495	531			114	
30045205330000	21	19710617	427	241	456	486			67	
30045205330000	21	19720625	414	233	442	470			50	
30045205330000	21	19730509	366	174	391	413			41	
30045205330000	21	19750717	315	149	336	352			34	
30045205330000	21	19770516	273	120	291	303			28	
30045205330000	21	19790815	295	147	315	329			16	
30045205330000	21	19830502	288	223	307	320			6	

## Jones, William V., EMNRD

---

**From:** Rogers, Rhonda S [Rhonda.S.Rogers@conocophillips.com]  
**Sent:** Tuesday, February 24, 2009 1:12 PM  
**To:** Jones, William V., EMNRD  
**Subject:** RE: Downhole Commingle Applications from Burlington: Cooper #6  
**Attachments:** Cooper 6 certified mail receipts.pdf

William, here is the certified receipts for the Cooper 6. Sorry to take so long and thank you again

William V. Jones PE  
New Mexico Oil Conservation Division  
1220 South St. Francis  
Santa Fe, NM 87505  
505-476-3448

---

**From:** Jones, William V., EMNRD  
**Sent:** Friday, January 30, 2009 5:08 PM  
**To:** 'ryan.m.frost@conocophillips.com'  
**Cc:** Ezeanyim, Richard, EMNRD; Brooks, David K., EMNRD; Warnell, Terry G, EMNRD  
**Subject:** Downhole Commingle Applications from Burlington: Cooper #6 and Grenier #21

Hello Ryan:

These are both diverse interest commingles and you requested to submit the allocation percentages later.

- 1) Please let me know how you will arrive at the final percentages or allocation method.
- 2) Send to the Engineering Bureau of the OCD in Santa Fe, a list of all affected parties in each well and a copy of the certified receipt OR just the certified number beside each name.

Thank You,

William V. Jones PE  
New Mexico Oil Conservation Division  
1220 South St. Francis  
Santa Fe, NM 87505  
505-476-3448

Confidentiality Notice: This e-mail, including all attachments is for the sole use of the intended recipient(s) and may contain confidential and privileged information. Any unauthorized review, use, disclosure or distribution is prohibited unless specifically provided under the New Mexico Inspection of Public Records Act. If you are not the intended recipient, please contact the sender and destroy all copies of this message. -- This email has been scanned by the Sybari - Antigen Email System.

---

This inbound email has been scanned by the MessageLabs Email Security System.

---

<b>1. Article Number</b> 7110 6605 9590 0000 1493		<b>COMPLETE THIS SECTION ON DELIVERY</b> A. Signature <u>X Laura Z Albright</u> <input type="checkbox"/> Agent <input type="checkbox"/> Addressee B. Received by (Printed Name) <u>Laura Z Albright</u> <input type="checkbox"/> Date of Delivery C. Is delivery address different from item 1? <input type="checkbox"/> Yes <input type="checkbox"/> No D. YES enter delivery address below	
<b>Article Addressed to:</b> ALBRIGHT LIVING TRUST LAURA Z ALBRIGHT TRUSTEE 3205 REXTON LN DALLAS, TX 75214 11/24/2008 11:01 AM Code: DHC-Cooper 6 Recompt-T. Monroe		3. Service Type <input checked="" type="checkbox"/> <b>Certified</b> 4. Restricted Delivery? (Extra Fee) <input type="checkbox"/> Yes <input type="checkbox"/> No	

<b>1. Article Number</b> 7110 6605 9590 0000 1509		<b>COMPLETE THIS SECTION ON DELIVERY</b> A. Signature <u>X</u> <input type="checkbox"/> Agent <input type="checkbox"/> Addressee B. Received by (Printed Name) <u>MIN 23</u> <input type="checkbox"/> Date of Delivery C. Is delivery address different from item 1? <input type="checkbox"/> Yes <input type="checkbox"/> No D. YES enter delivery address below	
<b>Article Addressed to:</b> MINERALS MGT SERVICE ONSHORE FEDERAL 17556 P O BOX 5810 DENVER, CO 80217-5810 11/24/2008 11:01 AM Code: DHC-Cooper 6 Recompt-T. Monroe		3. Service Type <input checked="" type="checkbox"/> <b>Certified</b> 4. Restricted Delivery? (Extra Fee) <input type="checkbox"/> Yes <input type="checkbox"/> No	