

DATE IN <u>2/2/09</u>	SUSPENSE	ENGINEER <u>D. Brooks</u>	LOGGED IN <u>2/2/09</u>	TYPE <u>NSL</u>	APP NO. <u>PKAA0903352403</u>
-----------------------	----------	---------------------------	-------------------------	-----------------	-------------------------------

ABOVE THIS LINE FOR DIVISION USE ONLY

RECEIVED

2009 FEB 2 PM 1 05

NEW MEXICO OIL CONSERVATION DIVISION

- Engineering Bureau -

1220 South St. Francis Drive, Santa Fe, NM 87505



30-045-29276
Ute #027
Burlington
14538

ADMINISTRATIVE APPLICATION CHECKLIST

5997

THIS CHECKLIST IS MANDATORY FOR ALL ADMINISTRATIVE APPLICATIONS FOR EXCEPTIONS TO DIVISION RULES AND REGULATIONS WHICH REQUIRE PROCESSING AT THE DIVISION LEVEL IN SANTA FE

Application Acronyms:

[NSL-Non-Standard Location] [NSP-Non-Standard Proration Unit] [SD-Simultaneous Dedication]
[DHC-Downhole Commingling] [CTB-Lease Commingling] [PLC-Pool/Lease Commingling]
[PC-Pool Commingling] [OLS - Off-Lease Storage] [OLM-Off-Lease Measurement]
[WFX-Waterflood Expansion] [PMX-Pressure Maintenance Expansion]
[SWD-Salt Water Disposal] [IPI-Injection Pressure Increase]
[EOR-Qualified Enhanced Oil Recovery Certification] [PPR-Positive Production Response]

[1] **TYPE OF APPLICATION** - Check Those Which Apply for [A]

[A] Location - Spacing Unit - Simultaneous Dedication
☒ NSL ☐ NSP ☐ SD

Check One Only for [B] or [C]

[B] Commingling - Storage - Measurement
☐ DHC ☐ CTB ☐ PLC ☐ PC ☐ OLS ☐ OLM

[C] Injection - Disposal - Pressure Increase - Enhanced Oil Recovery
☐ WFX ☐ PMX ☐ SWD ☐ IPI ☐ EOR ☐ PPR

[D] Other: Specify _____

[2] **NOTIFICATION REQUIRED TO:** - Check Those Which Apply, or XX Does Not Apply

[A] ☐ Working, Royalty or Overriding Royalty Interest Owners
[B] ☐ Offset Operators, Leaseholders or Surface Owner
[C] ☐ Application is One Which Requires Published Legal Notice
[D] ☐ Notification and/or Concurrent Approval by BLM or SLO
U.S. Bureau of Land Management - Commissioner of Public Lands, State Land Office
[E] ☐ For all of the above, Proof of Notification or Publication is Attached, and/or,
[F] ☐ Waivers are Attached

[3] **SUBMIT ACCURATE AND COMPLETE INFORMATION REQUIRED TO PROCESS THE TYPE OF APPLICATION INDICATED ABOVE.**

[4] **CERTIFICATION:** I hereby certify that the information submitted with this application for administrative approval is **accurate** and **complete** to the best of my knowledge. I also understand that **no action** will be taken on this application until the required information and notifications are submitted to the Division.

Note: Statement must be completed by an individual with managerial and/or supervisory capacity.

Patsy Clugston

Print or Type Name

Patsy Clugston
Signature

Sr. Regulatory Specialist

Title

1/30/09

Date

clugspl@conocophillips.com
e-mail Address

Burlington Resources Oil & Gas, LP

3401 E. 30th Street
Farmington, NM 87401

Sent UPS Overnight

January 30, 2009

NMOCD

Attn: NSL Examiner
1220 S. St. Francis Drive
Santa Fe, NM 87503

Re: Ute 27
Unit L (NWSW), 2125' FSL & 1270' FWL, Sec. 16, T32N, R14W,
San Juan Co, NM
API- 30-045-29276

Dear Sir:

Burlington Resources is applying for administrative approval of a non-standard gas well location completed in the Barker Dome Ismay, the Barker Dome Desert Creek and WC Barker Dome Hermosa formations. Ute #27 was a Barker Dome-Desert Creek well that we recently recompleted into the Barker Dome Ismay, WC Barker Dome Hermosa zones. The Barker Dome Desert Creek and the Barker Dome Ismay are part of the Paradox and they considered non-standard since they are less than 790' from the section line as per R-46-D. The WC Barker Dome Hermosa zone is considered NSL because it is less than 660' as per statewide spacing for wildcats under Rule 104.

Upon reviewing the well file it was determined that Burlington should have received NSL approval on the original completion, the Barker Dome Desert Creek. The well has been flowing since 1995 and neither Burlington nor NMOCD realized that NSL approval wasn't obtained prior to gas sale. Now that we have recompleted into the other two formations are requesting NSL approval on all three.

There was no real indication in the well records as to why the well was staked non-standard when it was staked in 1994, but the bulk of the terrain in the legal window is very rugged and this area is known to have an enormous amount of archaeological sites.

The Barker Dome Ismay and the WC Barker Dome Hermosa has a standard spacing unit of 160 acres, which SW/4 of Section 26. The Barker Dome Desert Creek has a standard spacing unit of 320 acres, which is the S/2 of Section 26. Attached to help you make your decision are the following:

C102 (plats) for the Barker Dome Desert Creek, Barker Dome Ismay and WC Barker Dome Hermosa
Off-set operator plat
Topo and Aerial maps

Currently there are no wells completed in the formations requesting NSL exception to in the N/2 of Section 16, therefore we are not encroaching on any particular well. Burlington Resources owns 100% minerals from the base of the Dakota to the center of the earth for the entire section therefore it is not necessary to make offset notification in this instance. If there is anything else that will be needed please call me at 505-326-9518. Thank you for considering this application.

Sincerely,



Patsy Clugston
Sr. Regulatory Specialist

DD, Atlanta, NM 10211-0719

OIL CONSERVATION DIVISION

Submit to Appropriate District

Brown Rd., Aztec, NM 87410

PO Box 2088
Santa Fe, NM 87504-2088

State Lease -

iv

IN 1968, Santa Fe. NM 87506-2000

☐ AMENDED 2

WELL LOCATION AND ACREAGE DEDICATION PLAT

APR Number 30-045- 29276		Pool Code 96353/96354/		Pool Name Barker Dome Desert Creek/Barker Dome Ismay/ WC Hermosa 1632N14E	
Property Code 7618		Property Name Ute			Well Name 27
OCRID No. 14538		Operator Name BURLINGTON RESOURCES OIL & GAS COMPANY LP			Elevation 6363'

10 Surface Location

UL or lot no.	Section	Township	Range	Lot Idn	Feet from the	North/South line	Feet from the	East/West line	County
L	16	32N	14W		2125	South	1270	West	S.J

" Bottom Hole Location If Different From Surface

UL or lot no.	Section	Township	Range	Lat 1/4	Feet from the	North/South line	Feet from the	East/West line	County
---------------	---------	----------	-------	---------	---------------	------------------	---------------	----------------	--------

" Dedicated Area S/320 160/160	" Joint or Infill	" Consolidation Code	" Order No.
--------------------------------------	-------------------	----------------------	-------------

NO ALLOWABLE WILL BE ASSIGNED TO THIS COMPLETION UNTIL ALL INTERESTS HAVE BEEN CONSOLIDATED OR A NON-STANDARD UNIT HAS BEEN APPROVED BY THE DIVISION

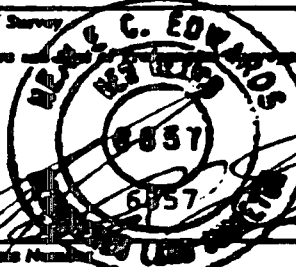
16	5283.30		<p>17 OPERATOR CERTIFICATE</p> <p><i>I hereby certify that the information contained hereon is true and complete to the best of my knowledge and belief.</i></p> <p style="text-align: right;"><i>Tracey N. Monroe</i></p> <p>_____ Signature</p> <p>Tracey N. Monroe Printed Name</p> <p>Regulatory Technician Title</p> <p>May 14, 2008 Date</p>
<div style="position: relative; width: 100%; height: 100%;"> <div style="position: absolute; top: 0; left: 0; width: 100%; height: 100%; border: 1px solid black; border-style: dashed;"></div> <div style="position: absolute; top: 50%; left: 50%; transform: translate(-50%, -50%); font-size: 4em; font-weight: bold;">X</div> </div>		<p>18 SURVEYOR CERTIFICATE</p> <p><i>I hereby certify that the well location shown on this map was plotted from field notes of actual surveys made or under my supervision, and that the same is true and correct to the best of my belief.</i></p> <p style="text-align: right;">11-4-94</p> <p>Date of Survey</p> <p>_____ Signature</p> <div style="text-align: center;">  </div> <p>Certificate Number</p>	
<div style="position: relative; width: 100%; height: 100%;"> <div style="position: absolute; top: 0; left: 0; width: 100%; height: 100%; border: 1px solid black; border-style: dashed;"></div> <div style="position: absolute; top: 50%; left: 50%; transform: translate(-50%, -50%); font-size: 4em; font-weight: bold;">X</div> </div>	<div style="position: relative; width: 100%; height: 100%;"> <div style="position: absolute; top: 0; left: 0; width: 100%; height: 100%; border: 1px solid black; border-style: dashed;"></div> <div style="position: absolute; top: 50%; left: 50%; transform: translate(-50%, -50%); font-size: 4em; font-weight: bold;">X</div> </div>	<p style="font-size: 2em; font-weight: bold;">RECEIVED</p> <p>MAY 20 2008</p> <p style="text-align: center;">5282.64</p>	

RECEIVED

~~May 9, 1968~~

8

9

10

Legend



DESERT CREEK



Offset Operator:
100%-Burlington Resources

32N-14W/
17

16

15



UTE 27_DC / I 5 MAY / W C H C R M O S A
BURLINGTON RESOURCES O&G CO LP



GCS North American 1927

ConocoPhillips

@ Unpublished Work, ConocoPhillips



Ute 27
Sec. 16, T32N, R14W
Offset Operator Map

20

21

22

Author: FLORENCE LEBLANC	Date: 1/29/2009
Compiled by: RAPHAEL PIERCE	Scale: <Scale>
Project: San Juan Basin Template.mxd	



Legend

 **DESERT CREEK**

Setback
790'



ConocoPhillips
© Unpublished Work, ConocoPhillips

Ute 27
Sec. 16, T32N, R14W
2125 FSL, 1270 FWL
Topographic Map

Author: RICHARD DAVIS	Date: 1/29/2009
Compiled by: R1P16100101 Projects\San Juan Basin Template.mxd	Scale: <Scale>

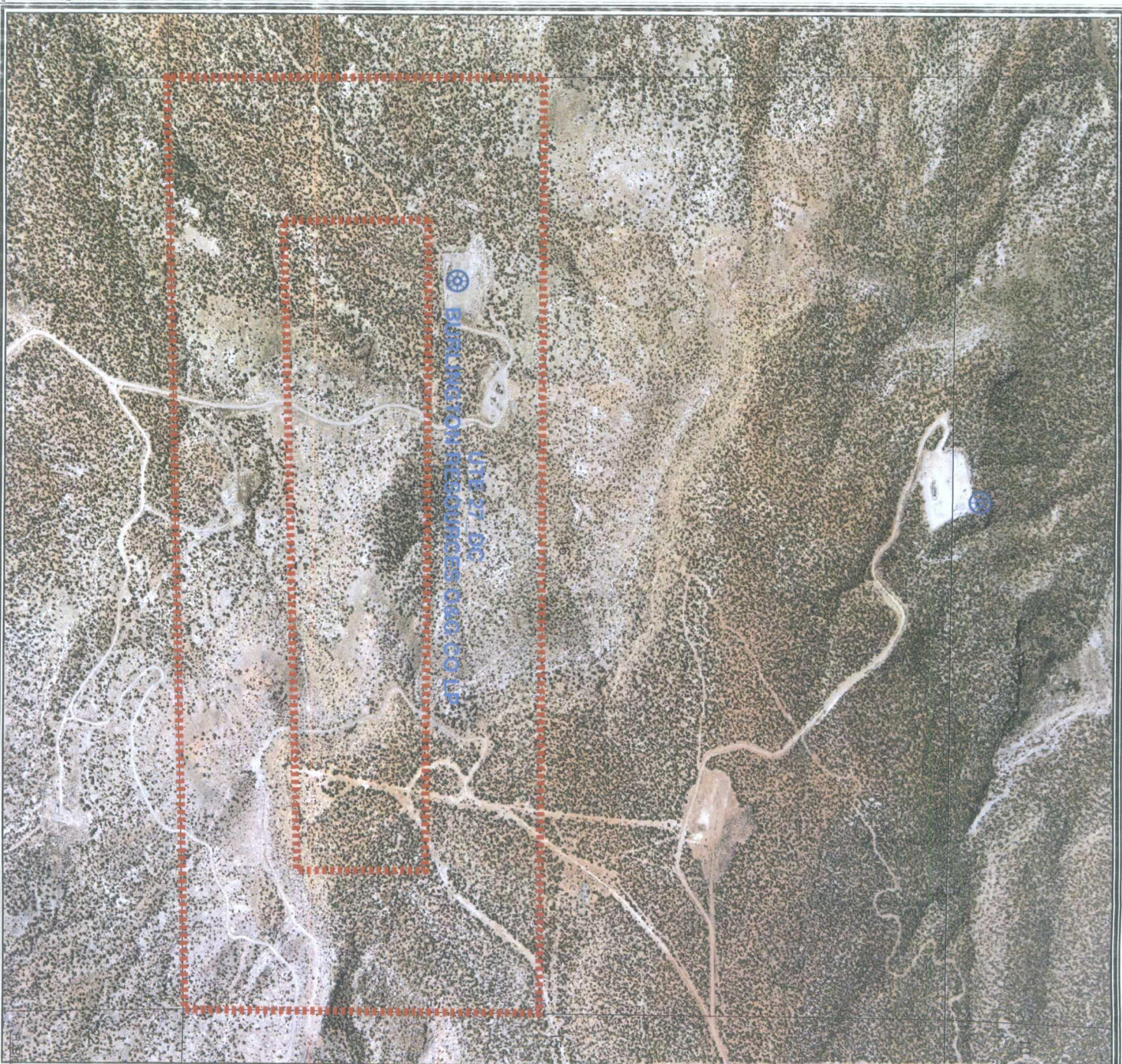

Legend



DESERT CREEK



Setback
790'



GCS North American 1927

ConocoPhillips
© Unpublished Work, ConocoPhillips



Ute 27
Sec. 16, T32N, R14W
2125 FSL, 1270 FWL
Aerial Map

Author:	Richard Lavis	Date:	1/29/2009
Compiled by:		Scale:	<Scale>
Project:	San Juan Basin Template.mxd		