

DATE IN 5/28/99	SUSPENSE 6/17/99	ENGINEER MS	LOGGED KW	TYPE NSL
--------------------	---------------------	----------------	--------------	-------------

ABOVE THIS LINE FOR DIVISION USE ONLY

## NEW MEXICO OIL CONSERVATION DIVISION

- Engineering Bureau -

### ADMINISTRATIVE APPLICATION COVERSHEET

THIS COVERSHEET IS MANDATORY FOR ALL ADMINISTRATIVE APPLICATIONS FOR EXCEPTIONS TO DIVISION RULES AND REGULATIONS

#### Application Acronyms:

[NSP-Non-Standard Proration Unit] [NSL-Non-Standard Location]  
 [DD-Directional Drilling] [SD-Simultaneous Dedication]  
 [DHC-Downhole Commingling] [CTB-Lease Commingling] [PLC-Pool/Lease Commingling]  
 [PC-Pool Commingling] [OLS - Off-Lease Storage] [OLM-Off-Lease Measurement]  
 [WFX-Waterflood Expansion] [PMX-Pressure Maintenance Expansion]  
 [SWD-Salt Water Disposal] [IPI-Injection Pressure Increase]  
 [EOR-Qualified Enhanced Oil Recovery Certification] [PPR-Positive Production Response]

#### [1] TYPE OF APPLICATION - Check Those Which Apply for [A]

[A] Location - Spacing Unit - Directional Drilling  
 X\_ NSL \_ NSP \_ DD \_ SD

Check One Only for [B] and [C]

[B] Commingling - Storage - Measurement  
 \_ DHC \_ CTB \_ PLC \_ PC \_ OLS \_ OLM

[C] Injection - Disposal - Pressure Increase - Enhanced Oil Recovery  
 \_ WFX \_ PMX \_ SWD \_ IPI \_ EOR \_ PPR

#### [2] NOTIFICATION REQUIRED TO: - Check Those Which Apply, or \_ Does Not Apply

[A] \_ Working, Royalty or Overriding Royalty Interest Owners

[B] X\_ Offset Operators, Leaseholders or Surface Owner *(Anco only)*

[C] \_ Application is One Which Requires Published Legal Notice

[D] X\_ Notification and/or Concurrent Approval by BLM or SLO

U.S. Bureau of Land Management - Commissioner of Public Lands, State Land Office

[E] \_ For all of the above, Proof of Notification or Publication is Attached, and/or,

[F] \_ Waivers are Attached

#### [3] INFORMATION / DATA SUBMITTED IS COMPLETE - Statement of Understanding

I hereby certify that I, or personnel under my supervision, have read and complied with all applicable Rules and Regulations of the Oil Conservation Division. Further, I assert that the attached application for administrative approval is accurate and complete to the best of my knowledge and where applicable, verify that all interest (WI, RI, ORRI) is common. I understand that any omission of data, information or notification is cause to have the application package returned with no action taken.

Note: Statement must be completed by an individual with supervisory capacity.

J W Hawkins

*J W Hawkins*

Regulatory Affairs Engineer

5/24/99



**Amoco Production Company**

BP Amoco  
Western Gas Business Unit  
Post Office Box 3092  
Houston, TX 77253-3092

May 20, 1999

Ms. Lori Wrotenbery, Director  
New Mexico Oil Conservation Division  
2040 S. Pacheco Street  
P.O. Box 6429  
Santa Fe, NM 87505

**Application For Unorthodox Location**  
**Gallegos Canyon Unit Com D#160 Well**  
**1850' FSL, 1190' FWL, Unit I, Section 27-T29N-R12W**  
**Basin Fruitland Coal Pool**  
**San Juan County, New Mexico**

Amoco Production Company hereby requests administrative approval for an unorthodox well location for the Gallegos Canyon Unit Com D#160 well in the Basin Fruitland Coal Pool. Amoco plans to plug back this well from the Basin Dakota Pool. The well location is unorthodox due to the fact it is not located in the NE/4 or SW/4 of the section.

Attached is the Form C-102 showing the location of the well, and a nine section plat showing wells drilled in the area. This well is located in the interior of the Gallegos Canyon Unit and Amoco is the only offset operator affected by this application.

Sincerely,

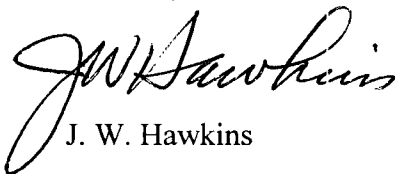

J. W. Hawkins

Attachments

cc: John Papageorge  
Mary Corley  
Well file  
Proration file

**DISTRICT I**

P.O. Box 1980, Hobbs, NM 88240

**DISTRICT II**

311 South First., Artesia, NM 88210

**DISTRICT III**

1000 Rio Brazos Rd., Aztec, NM 87410

**DISTRICT IV**

2040 South Pacheco, Santa Fe, NM 87505

## State of New Mexico

Energy, Minerals and Natural Resources Department

Form C-102

Revised October 18, 1994

Submit to Appropriate District Office

State Lease - 4 Copies

Fee Lease - 3 Copies

**OIL CONSERVATION DIVISION**

2040 South Pacheco

Santa Fe, New Mexico 87505

**WELL LOCATION AND ACREAGE DEDICATION PLAT**

API Number 30-045-07832	Pool Code 71629	Pool Name BASIN FRUITLAND COAL
Property Code 000576	Property Name GALLEGOS CANYON UNIT COM D	Well Number 160
OGRID No. 000778	Operator Name AMOCO PRODUCTION COMPANY	Elevation 5384' RDB

**Surface Location**

UL or lot no. UNIT I	Section 27	Township 29N	Range 12W	Lot. Idn	Feet from the 1850	North/South Line SOUTH	Feet from the 1190	East/West Line EAST	County San Juan
-------------------------	---------------	-----------------	--------------	----------	-----------------------	---------------------------	-----------------------	------------------------	--------------------

**Bottom Hole Location If Different From Surface**

UL or lot no.	Section	Township	Range	Lot. Idn	Feet from the	North/South Line	Feet from the	East/West Line	County
Dedicated Acreage: 320	Joint or Infill	Consolidation Code	Order No.						

**NO ALLOWABLE WILL BE ASSIGNED TO THIS COMPLETION UNTIL ALL INTERESTS HAVE BEEN CONSOLIDATED  
OR A NON-STANDARD UNIT HAS BEEN APPROVED BY THE DIVISION**

	<b>OPERATOR CERTIFICATION</b> <i>I hereby certify that the information contained herein is true and complete to the best of my knowledge and belief</i> Signature <i>Mary Corley</i> Printed Name <b>MARY CORLEY</b> Position <b>SR. BUSINESS ANALYST</b> Date
	<b>SURVEY CERTIFICATION</b> <i>I hereby certify that the well location shown on this plat was plotted from field notes of actual surveys made by me or under my supervision, and that the same is true and correct to the best of my knowledge and belief.</i> <div style="border: 1px solid black; height: 20px; width: 100%;"></div> Date of Survey Signature & Seal of Professional Surveyor <div style="border: 1px solid black; padding: 5px; text-align: center;">JAMES P LEASE</div> Certificate No. <b>1463</b>

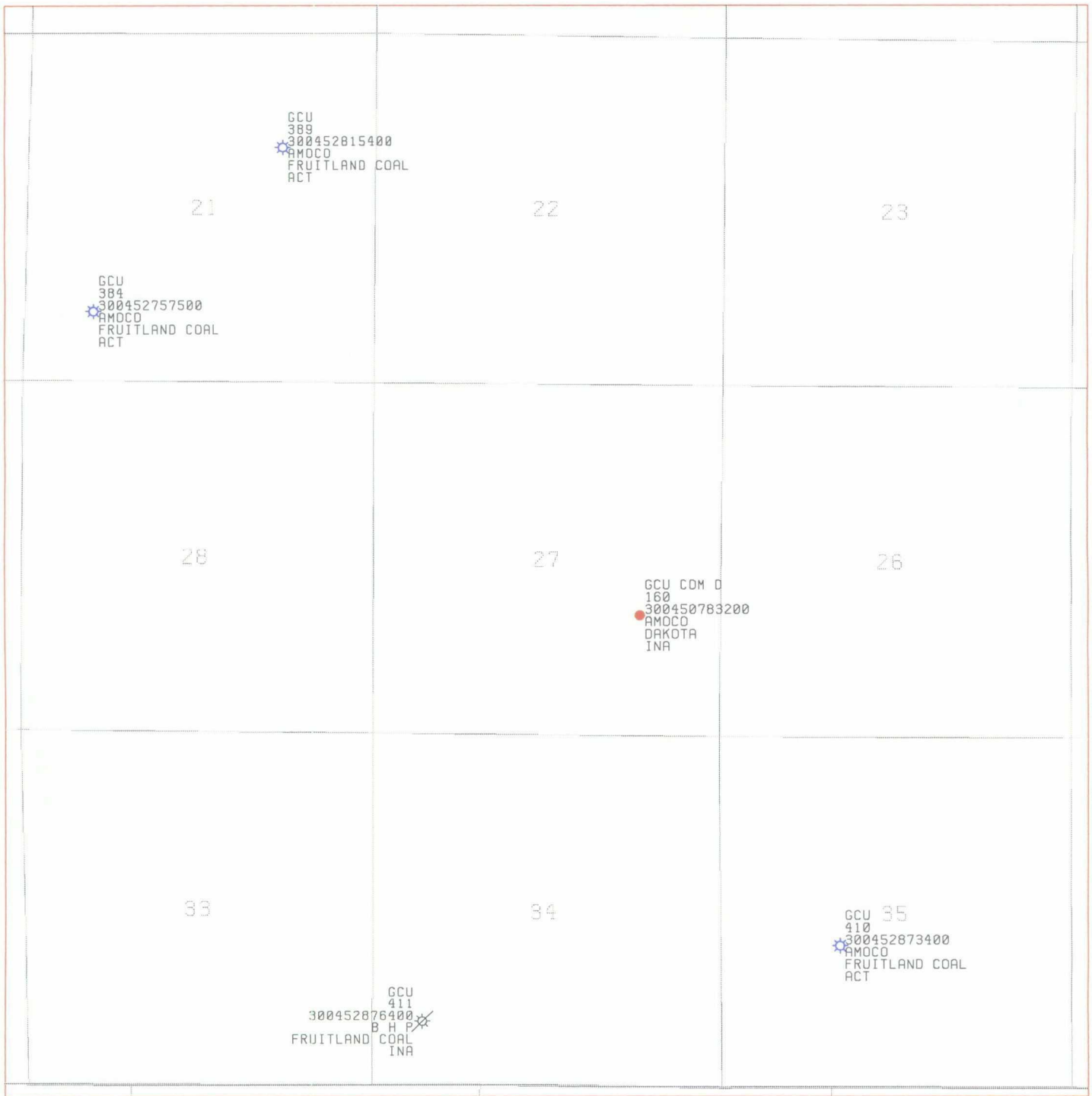

AMOCO PRODUCTION COMPANY HOUSTON, TEXAS			
GCU COM D 160 RECOMPLETION NINE SECTION PLAT 27-29N-12W			
SCALE	DRIVER T. HANSON	DATE 25-MAY-1999	
DRIVER DATE			

DATE IN	SUSPENSE	ENGINEER	LOGGED	TYPE
---------	----------	----------	--------	------

ABOVE THIS LINE FOR DIVISION USE ONLY

## NEW MEXICO OIL CONSERVATION DIVISION

- Engineering Bureau -

### ADMINISTRATIVE APPLICATION COVERSHEET

THIS COVERSHEET IS MANDATORY FOR ALL ADMINISTRATIVE APPLICATIONS FOR EXCEPTIONS TO DIVISION RULES AND REGULATIONS

#### Application Acronyms:

[NSP-Non-Standard Proration Unit] [NSL-Non-Standard Location]  
 [DD-Directional Drilling] [SD-Simultaneous Dedication]  
 [DHC-Downhole Commingling] [CTB-Lease Commingling] [PLC-Pool/Lease Commingling]  
 [PC-Pool Commingling] [OLS - Off-Lease Storage] [OLM-Off-Lease Measurement]  
 [WFX-Waterflood Expansion] [PMX-Pressure Maintenance Expansion]  
 [SWD-Salt Water Disposal] [IPI-Injection Pressure Increase]  
 [EOR-Qualified Enhanced Oil Recovery Certification] [PPR-Positive Production Response]

#### [1] TYPE OF APPLICATION - Check Those Which Apply for [A]

[A] Location - Spacing Unit - Directional Drilling  
 X NSL \_ NSP \_ DD \_ SD

Check One Only for [B] and [C]

[B] Commingling - Storage - Measurement  
 \_ DHC \_ CTB \_ PLC \_ PC \_ OLS \_ OLM

[C] Injection - Disposal - Pressure Increase - Enhanced Oil Recovery  
 \_ WFX \_ PMX \_ SWD \_ IPI \_ EOR \_ PPR

#### [2] NOTIFICATION REQUIRED TO: - Check Those Which Apply, or \_ Does Not Apply

[A] \_ Working, Royalty or Overriding Royalty Interest Owners

[B] X Offset Operators, Leaseholders or Surface Owner *(Amoco only)*

[C] \_ Application is One Which Requires Published Legal Notice

[D] X Notification and/or Concurrent Approval by BLM or SLO  
 U.S. Bureau of Land Management - Commissioner of Public Lands, State Land Office

[E] \_ For all of the above, Proof of Notification or Publication is Attached, and/or,

[F] \_ Waivers are Attached

#### [3] INFORMATION / DATA SUBMITTED IS COMPLETE - Statement of Understanding

I hereby certify that I, or personnel under my supervision, have read and complied with all applicable Rules and Regulations of the Oil Conservation Division. Further, I assert that the attached application for administrative approval is accurate and complete to the best of my knowledge and where applicable, verify that all interest (WI, RI, ORRI) is common. I understand that any omission of data, information or notification is cause to have the application package returned with no action taken.

Note: Statement must be completed by an individual with supervisory capacity.

J W Hawkins

Regulatory Affairs Engineer

5/24/99



**Amoco Production Company**

BP Amoco  
Western Gas Business Unit  
Post Office Box 3092  
Houston, TX 77253-3092

May 20, 1999

Ms. Lori Wrotenbery, Director  
New Mexico Oil Conservation Division  
2040 S. Pacheco Street  
P.O. Box 6429  
Santa Fe, NM 87505

**Application For Unorthodox Location  
Gallegos Canyon Unit Com D#160 Well  
1850' FSL, 1190' FWL, Unit I, Section 27-T29N-R12W  
Basin Fruitland Coal Pool  
San Juan County, New Mexico**

Amoco Production Company hereby requests administrative approval for an unorthodox well location for the Gallegos Canyon Unit Com D#160 well in the Basin Fruitland Coal Pool. Amoco plans to plug back this well from the Basin Dakota Pool. The well location is unorthodox due to the fact it is not located in the NE/4 or SW/4 of the section.

Attached is the Form C-102 showing the location of the well, and a nine section plat showing wells drilled in the area. This well is located in the interior of the Gallegos Canyon Unit and Amoco is the only offset operator affected by this application.

Sincerely,

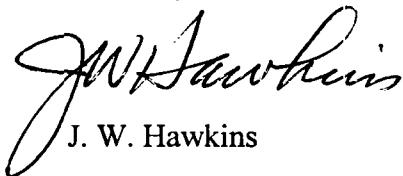

J. W. Hawkins

Attachments

cc: John Papageorge  
Mary Corley  
Well file  
Proration file

DISTRICT I  
P.O. Box 1980, Hobbs, NM 88240  
DISTRICT II  
311 South First., Artesia, NM 88210  
DISTRICT III  
1000 Rio Brazos Rd., Aztec, NM 87410  
DISTRICT IV  
2040 South Pacheco, Santa Fe, NM 87505

State of New Mexico  
Energy, Minerals and Natural Resources Department

OIL CONSERVATION DIVISION

2040 South Pacheco  
Santa Fe, New Mexico 87505

Form C-102  
Revised October 18, 1994  
Submit to Appropriate District Office  
State Lease - 4 Copies  
Fee Lease - 3 Copies

WELL LOCATION AND ACREAGE DEDICATION PLAT

API Number 30-045-07832	Pool Code 71629	Pool Name BASIN FRUITLAND COAL
Property Code 000576	Property Name GALLEGOS CANYON UNIT COM D	Well Number 160
OGRID No. 000778	Operator Name AMOCO PRODUCTION COMPANY	Elevation 5384' RDB

Surface Location

UL or lot no. UNIT I	Section 27	Township 29N	Range 12W	Lot. Idn	Feet from the 1850	North/South Line SOUTH	Feet from the 1190	East/West Line EAST	County San Juan
-------------------------	---------------	-----------------	--------------	----------	-----------------------	---------------------------	-----------------------	------------------------	--------------------

Bottom Hole Location If Different From Surface

UL or lot no.	Section	Township	Range	Lot. Idn	Feet from the	North/South Line	Feet from the	East/West Line	County
Dedicated Acreage: 320		Joint or Infill	Consolidation Code		Order No.				

NO ALLOWABLE WILL BE ASSIGNED TO THIS COMPLETION UNTIL ALL INTERESTS HAVE BEEN CONSOLIDATED  
OR A NON-STANDARD UNIT HAS BEEN APPROVED BY THE DIVISION

	<b>OPERATOR CERTIFICATION</b> <i>I hereby certify that the information contained herein is true and complete to the best of my knowledge and belief</i> Signature <i>Mary Corley</i> Printed Name <b>MARY CORLEY</b> Position <b>SR. BUSINESS ANALYST</b> Date
	<b>SURVEY CERTIFICATION</b> <i>I hereby certify that the well location shown on this plat was plotted from field notes of actual surveys made by me or under my supervision, and that the same is true and correct to the best of my knowledge and belief.</i> <div></div>
	Date of Survey
	Signature & Seal of Professional Surveyor <div><b>JAMES P LEASE</b></div>
Certificate No. 1463	

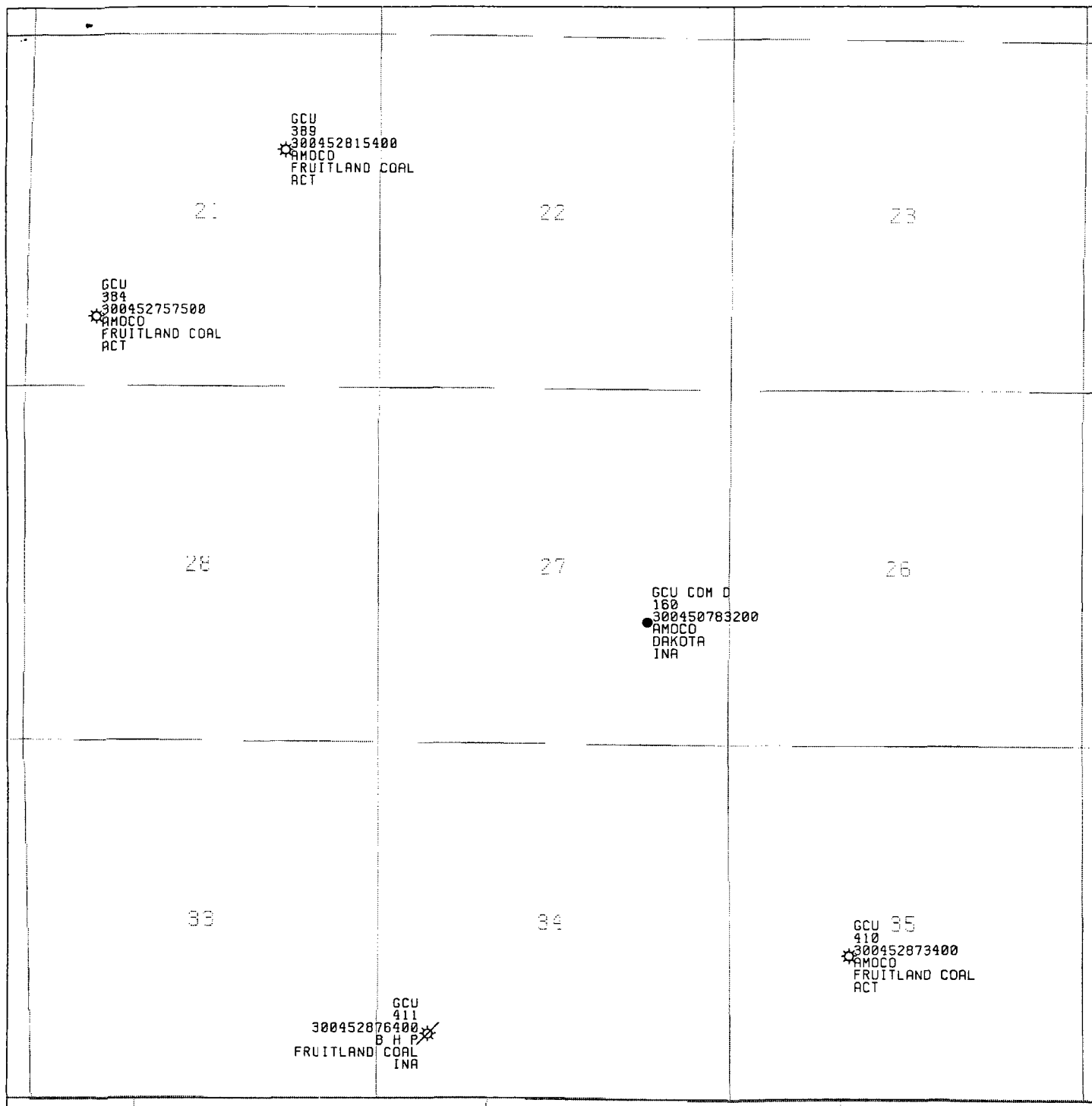

AMOCO PRODUCTION COMPANY  
HOUSTON, TEXAS

GCU COM D 160 RECOMPLETION  
NINE SECTION PLAT  
27-29N-12W

DATE	BY	DATE
	T. HANSON	25-MAY-1999



CMD :  
OG5SECT

ONGARD  
INQUIRE LAND BY SECTION

06/01/99 12:28:38  
OGOMES -TP1F  
PAGE NO: 1

Sec : 27 Twp : 29N Rng : 12W Section Type : NORMAL

D 40.00  Fee owned U	C 40.00  Fee owned U	B 40.00  Federal owned U A C A	A 40.00  Federal owned U
E 40.00  Fee owned U A A	F 40.00  Fee owned U	G 40.00  Federal owned U	H 40.00  Federal owned U

PF01 HELP	PF02	PF03 EXIT	PF04 GoTo	PF05	PF06
PF07 BKWD	PF08 FWD	PF09 PRINT	PF10 SDIV	PF11	PF12

CMD :  
OG5SECT

ONGARD  
INQUIRE LAND BY SECTION

06/01/99 12:53:43  
OGOMES -TP1F  
PAGE NO: 2

Sec : 27 Twp : 29N Rng : 12W Section Type : NORMAL

L 40.00	K 40.00	J 40.00	I 40.00
Fee owned U	Fee owned U	Federal owned U	Federal owned U A
M 40.00	N 40.00	O 40.00	P 40.00
Fee owned U	Fee owned U A A	Fee owned U	Fee owned U A

PF01 HELP  
PF07 BKWD

PF02  
PF08 FWD

PF03 EXIT  
PF09 PRINT

PF04 GoTo  
PF10 SDIV

PF05  
PF11

PF06  
PF12

OIL CONSERVATION DIVISION

P.O. Box 2088  
Santa Fe, New Mexico 87504-2088

REQUEST FOR ALLOWABLE AND AUTHORIZATION  
TO TRANSPORT OIL AND NATURAL GAS

Operator <u>Amaco Production Co</u>		Well API No.
Address <u>2325 E. 30th Street, Farmington NM 87401</u>		
Reason(s) for Filing (Check proper box) <input type="checkbox"/> Other (Please explain)		
New Well <input type="checkbox"/>	Change in Transporter of:	
Recompletion <input type="checkbox"/>	Oil <input type="checkbox"/> Dry Gas <input type="checkbox"/> Effective <u>4-1-89</u>	
Change in Operator <input type="checkbox"/>	Casinghead Gas <input type="checkbox"/> Condensate <input checked="" type="checkbox"/>	<u>290382</u>
If change of operator give name and address of previous operator		

II. DESCRIPTION OF WELL AND LEASE

Lease Name <u>Gallegos Canyon Unit Com D</u>	Well No. <u>160</u>	Pool Name, Including Formation <u>Basin Dakota</u>	Kind of Lease State, Federal or Fee	Lease No. <u>SF-080224</u>
Location Unit Letter <u>I</u> : <u>1850</u> Feet From The <u>S</u> Line and <u>1190</u> Feet From The <u>E</u> Line Section <u>27</u> Township <u>29N</u> Range <u>12W</u> , NMPM, <u>San Juan</u> County				

III. DESIGNATION OF TRANSPORTER OF OIL AND NATURAL GAS

Name of Authorized Transporter of Oil <input type="checkbox"/> or Condensate <input checked="" type="checkbox"/> <u>Meridian Oil Inc.</u>	Address (Give address to which approved copy of this form is to be sent) <u>P.O. Box 4289, Farmington NM 87499</u>	
Name of Authorized Transporter of Casinghead Gas <input type="checkbox"/> or Dry Gas <input checked="" type="checkbox"/> <u>El Paso Natural Gas</u>	Address (Give address to which approved copy of this form is to be sent) <u>Caller Service 4990, Farmington NM 87499</u>	
If well produces oil or liquids, give location of tanks.	Unit <u>I</u> Sec. <u>27</u> Twp. <u>29N</u> Rge. <u>12W</u>	Is gas actually connected? <u>Yes</u> When? <u>2-2-65</u>

If this production is commingled with that from any other lease or pool, give commingling order number:

IV. COMPLETION DATA

Designate Type of Completion - (X)	Oil Well	Gas Well	New Well	Workover	Deepen	Plug Back	Same Res'v	Diff Res'v
Date Spudded	Date Compl. Ready to Prod.		Total Depth			P.B.T.D.		
Elevations (DF, RKB, RT, GR, etc.)	Name of Producing Formation		Top Oil/Gas Pay			Tubing Depth		
Perforations						Depth Casing Shoe		

TUBING, CASING AND CEMENTING RECORD

HOLE SIZE	CASING & TUBING SIZE	DEPTH SET	SACKS CEMENT

V. TEST DATA AND REQUEST FOR ALLOWABLE

OIL WELL (Test must be after recovery of total volume of load oil and must be equal to or exceed top allowable for this depth or be for full 24 hours)

Date First New Oil Run To Tank	Date of Test	Producing Method (Flow, pump, gas lift, etc.)	
Length of Test	Tubing Pressure	Casing Pressure	Choke Size
Actual Prod. During Test	Oil - Bbls.	Water - Bbls.	Gas - MCF

GAS WELL

Actual Prod. Test - MCF/D	Length of Test	Bbls. Condensate/MMCF	Gravity of Condensate
Testing Method (pilot, back pr.)	Tubing Pressure (Shut-in)	Casing Pressure (Shut-in)	Choke Size

VI. OPERATOR CERTIFICATE OF COMPLIANCE

I hereby certify that the rules and regulations of the Oil Conservation Division have been complied with and that the information given above is true and complete to the best of my knowledge and belief.

B.D. Shaw

Signature

B.D. Shaw

Printed Name

3-29-89

Date

Adm. Supv

Title

(505) 325-8841

Telephone No.

OIL CONSERVATION DIVISION

Date Approved APR 03 1989

By [Signature]

Title SUPERVISION DISTRICT #3

INSTRUCTIONS: This form is to be filed in compliance with Rule 1104

- 1) Request for allowable for newly drilled or deepened well must be accompanied by tabulation of deviation tests taken in accordance with Rule 111.
- 2) All sections of this form must be filled out for allowable on new and recompleted wells.
- 3) Fill out only Sections I, II, III, and VI for changes of operator, well name or number, transporter, or other such changes.
- 4) Separate Form C-104 must be filed for each well in multiple completion.

STATE OF NEW MEXICO  
ENERGY AND MINERALS DEPARTMENT

NO. OF COPIES RECEIVED	
DISTRIBUTION	
SANTA FE	
FILE	
U.S.G.S.	
LAND OFFICE	
TRANSPORTER	OIL
	GAS
OPERATOR	
PRODUCTION OFFICE	

OIL CONSERVATION DIVISION

P. O. BOX 2088  
SANTA FE, NEW MEXICO 87501

SEP 18 1987

Form C-104  
Revised 10-01-78  
Format C6-01-83  
Page 1

REQUEST FOR ALLOWABLE  
AND  
AUTHORIZATION TO TRANSPORT OIL AND NATURAL GAS

Operator Amoco Production Company	
Address 501 Airport Drive Farmington, NM 87401	
Reason(s) for filing (Check proper box)	Other (Please explain)
<input type="checkbox"/> New Well <input type="checkbox"/> Recompletion <input type="checkbox"/> Change in Ownership	Change in Transporter of: <input type="checkbox"/> Oil <input type="checkbox"/> Gas <input type="checkbox"/> Condensate <input checked="" type="checkbox"/> Other

If change of ownership give name and address of previous owner

II. DESCRIPTION OF WELL AND LEASE

Lease Name Gallegos Canyon Unit Contd	Well No. 160	Pool Name, including Formation Basin Dakota	Kind of Lease State, Federal or Free Federal	Lease No. SF 880224
Location Unit Letter <u>I</u> : <u>1850</u> Feet From The <u>South</u> Line and <u>1190</u> Feet From The <u>East</u> Line of Section <u>27</u> Township <u>29N</u> Range <u>12W</u> , NMPM, <u>San Juan</u> County				

III. DESIGNATION OF TRANSPORTER OF OIL AND NATURAL GAS

Name of Authorized Transporter of Oil <input type="checkbox"/> or Condensate <input checked="" type="checkbox"/>	Address (Give address to which approved copy of this form is to be sent)
Permian Corp. Permian (Eff. 9 / 1 / 87)	P. O. Box 1702 Farmington, NM 87499
Name of Authorized Transporter of Gas <input type="checkbox"/> or Dry Gas <input checked="" type="checkbox"/>	Address (Give address to which approved copy of this form is to be sent)
El Paso Natural Gas Company	P. O. Box 990 Farmington, NM 87401
If well produces oil or liquids, give location of tanks.	Unit Sec. Twp. Rge. Is gas actually connected? When
	<u>I</u> <u>27</u> <u>29N</u> <u>12W</u>

If this production is commingled with that from any other lease or pool, give commingling order number:

NOTE: Complete Parts IV and V on reverse side if necessary.

VI. CERTIFICATE OF COMPLIANCE

I hereby certify that the rules and regulations of the Oil Conservation Division have been complied with and that the information given is true and complete to the best of my knowledge and belief.

BDS Shaw

(Signature)

Admin. Supervisor

1-2-85

(Date)

RECEIVED  
JAN 03 1985  
OIL CONSERVATION DIVISION

OIL CONSERVATION DIVISION

APPROVED JAN 22 1985  
BY Charles E. Shaw  
TITLE DEPUTY OIL & GAS INSPECTOR, DIST. #3

This form is to be filed in compliance with RULE 1104.

If this is a request for allowable for a newly drilled or deepened well, this form must be accompanied by a tabulation of the deviation tests taken on the well in accordance with RULE 111.

All sections of this form must be filled out completely for allowable on new and recompleted wells.

Fill out only Sections I, II, III, and VI for changes of owner, well name or number, or transporter, or other such change of condition.

Separate Forms C-104 must be filed for each pool in multiply completed wells.

UNITED STATES  
DEPARTMENT OF THE INTERIOR  
BUREAU OF LAND MANAGEMENT

SUBMIT IN TRIPPLICATE  
(Other instructions on reverse side)

Budget Bureau No. 1004-0135  
Expires August 31, 1985

SUNDRY NOTICES AND REPORTS ON WELLS

(Do not use this form for proposals to drill or to deepen or plug back to a different reservoir.  
Use "APPLICATION FOR PERMIT" for such proposals.)

OIL WELL ☐ GAS WELL ☒ OTHER ☐

RECEIVED

1. NAME OF OPERATOR

Amoco Production Company

2. ADDRESS OF OPERATOR

2325 E. 30th, Farmington, NM 87401

3. LOCATION OF WELL (Report location clearly and in accordance with any Survey  
See also space 17 below.)  
At surface

1850' FSL x 1190' FEL

JUL 22 1986

BUREAU OF LAND MANAGEMENT  
FARMINGTON RESOURCE AREA

5. LEASE DESIGNATION AND SERIAL NO

SF-080224

6. IF INDIAN, ALLOTTEE OR TRIBE NAME

7. UNIT AGREEMENT NAME

Gallegos Canyon Unit Com D

8. FARM OR LEASE NAME

9. WELL NO.

160

10. FIELD AND POOL, OR WILDCAT

Basin Dakota

11. SEC., T., R., OR ALK. AND  
SURVEY OR AREA

NE/SE Sec. 27, T29N, R12W

12. COUNTY OR PARISH 13. STATE

San Juan

NM

4. Check Appropriate Box To Indicate Nature of Notice, Report, or Other Data

NOTICE OF INTENTION TO:

FEET WATER SHUT-OFF

FRACTURE TREAT

SHOOT OR ACIDIZE

REPAIR WELL

(Other)

PLUG OR ALTER CASING

MULTIPLE COMPLETION

ABANDON

CHANGE PLANS

WATER SHUT-OFF

FRACTURE TREATMENT

SHOOTING OR ACIDIZING

(Other)

SUBSEQUENT REPORT OF:

REPAIRING WELL

ALTERING CASING

ABANDONMENT

(NOTE: Report results of multiple completion on Well  
Completion or Recompletion Report and Log form.)

7. DESCRIBE PROPOSED OR COMPLETED OPERATIONS (Clearly state all pertinent details, and give pertinent dates, including estimated date of starting any proposed work. If well is directionally drilled, give subsurface locations and measured and true vertical depths for all markers and zones pertinent to this work.)

Moved in and rigged up service unit on 8-5-85. Tripped in and set a drillable bridgeplug at 5836'. Pressure tested casing to 1000 psi for 30 minutes. Milled up bridgeplug with nitrogen foam. Cleaned out sand fill with nitrogen foam. Landed 2-3/8" tubing at 5991' and released the rig on 8-13-85.

I hereby certify that the foregoing is true and correct

SIGNED

B. Shaw

TITLE Adm. Supervisor

ACCEPTED FOR RECORD

DATE 7-18-86

(This space for Federal or State office use)

APPROVED BY

TITLE

CONDITIONS OF APPROVAL, IF ANY:

DATE

FARMINGTON RESOURCE AREA

BY

Smm

\*See Instructions on Reverse Side

NMOCC

STATE OF NEW MEXICO  
ENERGY AND MINERALS DEPARTMENT

NO. OF COPIES RECEIVED	
DISTRIBUTION	
SANTA FE	
FILE	
U.S.O.J.	
LAND OFFICE	
TRANSPORTER	OIL
OPERATOR	GAS
PRODUCTION OFFICE	

OIL CONSERVATION DIVISION  
P. O. BOX 2088  
SANTA FE, NEW MEXICO 87501

Form C-104  
Revised 10-01-78  
Format 08-01-83  
Page 1

REQUEST FOR ALLOWABLE  
AND  
AUTHORIZATION TO TRANSPORT OIL AND NATURAL GAS

Operator Amoco Production Company	
Address 501 Airport Drive Farmington, NM 87401	
Reason(s) for filing (Check proper box)	Other (Please explain)
<input type="checkbox"/> New Well <input type="checkbox"/> Recompletion <input type="checkbox"/> Change in Ownership	Change in Transporter of: <input type="checkbox"/> Oil <input type="checkbox"/> Casinghead Gas <input type="checkbox"/> Dry Gas <input checked="" type="checkbox"/> Condensate

If change of ownership give name and address of previous owner \_\_\_\_\_

II. DESCRIPTION OF WELL AND LEASE

Lease Name Gallegos Canyon Unit Comd	Well No. 160	Pool Name, including Formation Basin Dakota	Kind of Lease State, Federal or Free <u>Federal</u>	Lease No. SF 080224
Location Unit Letter <u>I</u> : <u>1850</u> Feet From The <u>South</u> Line and <u>1190</u> Feet From The <u>East</u> Line of Section <u>27</u> Township <u>29N</u> Range <u>12W</u> , NMPM, <u>San Juan</u> County				

III. DESIGNATION OF TRANSPORTER OF OIL AND NATURAL GAS

Name of Authorized Transporter of Oil <input type="checkbox"/> or Condensate <input checked="" type="checkbox"/>	Address (Give address to which approved copy of this form is to be sent)
Permian Corp.	P. O. Box 1702 Farmington, NM 87499
Name of Authorized Transporter of Casinghead Gas <input type="checkbox"/> or Dry Gas <input checked="" type="checkbox"/>	Address (Give address to which approved copy of this form is to be sent)
El Paso Natural Gas Company	P. O. Box 990 Farmington, NM 87401
If well produces oil or liquids, give location of tanks.	Unit Sec. Twp. Rge. Is gas actually connected? When
	<u>I</u> <u>27</u> <u>29N</u> <u>12W</u>

If this production is commingled with that from any other lease or pool, give commingling order number: \_\_\_\_\_

NOTE: Complete Parts IV and V on reverse side if necessary.

VI. CERTIFICATE OF COMPLIANCE

I hereby certify that the rules and regulations of the Oil Conservation Division have been complied with and that the information given is true and complete to the best of my knowledge and belief.

BDS Shaw

(Signature)

Admin. Supervisor

(Title)

1-2-85

(Date)

OIL CONSERVATION DIVISION

APPROVED

JAN 23 1985

BY

Charles E. Hobson

TITLE

DEPUTY OIL & GAS INSPECTOR, DIST. #3

This form is to be filed in compliance with RULE 1102.

If this is a request for allowable for a newly drilled or deepened well, this form must be accompanied by a tabulation of the deviation tests taken on the well in accordance with RULE 111.

All sections of this form must be filled out completely for allowable on new and recompleted wells.

Fill out only Sections I, II, III, and VI for changes of owner, well name or number, or transporter, or other such change of condition.

Separate Forms C-104 must be filed for each pool in multiply completed wells.

## OIL CONSERVATION DIVISION

P. O. BOX 2088

SANTA FE, NEW MEXICO 87501

Form C-104  
Revised 10-1-78REQUEST FOR ALLOWABLE  
AND

## AUTHORIZATION TO TRANSPORT OIL AND NATURAL GAS

## I. PRODUCTION OFFICE

Operator

AMOCO PRODUCTION COMPANY

Address

501 Airport Drive, Farmington, NM 87401

Reason(s) for filing (Check proper box)

New Well ☐Recompletion ☐Change in Ownership ☐

Change in Transporter of:

Oil ☐Casinghead Gas ☐Dry Gas ☐Condensate ☒

Other (Please explain)

GOC

If change of ownership give name  
and address of previous owner

## II. DESCRIPTION OF WELL AND LEASE

Lease Name Gallegos Canyon Unit	Well No. 160	Pool Name, including Formation Basin Dakota	Kind of Lease State, Federal or Fee Federal	Lease No.
Location Unit Letter <u>I</u> ; <u>1850</u> Feet From The <u>South</u> Line and <u>1190</u> Feet From The <u>East</u> Line of Section <u>27</u> Township <u>29N</u> Range <u>12W</u> , NMPM, San Juan County				

## III. DESIGNATION OF TRANSPORTER OF OIL AND NATURAL GAS

Name of Authorized Transporter of Oil <input type="checkbox"/> or Condensate <input checked="" type="checkbox"/> Giant Industries, Inc.	Address (Give address to which approved copy of this form is to be sent) P.O. Box 256, Farmington, NM 87401	
Name of Authorized Transporter of Casinghead Gas <input type="checkbox"/> or Dry Gas <input checked="" type="checkbox"/> El Paso Natural Gas Company	Address (Give address to which approved copy of this form is to be sent) P.O. Box 990, Farmington, NM 87401	
If well produces oil or liquids, give location of tanks.	Unit I	Sec. 27
	Twp. 29N	Rge. 12W
	Is gas actually connected? When	

If this production is commingled with that from any other lease or pool, give commingling order number:

## IV. COMPLETION DATA

Designate Type of Completion - (X)	Oil Well	Gas Well	New Well	Workover	Deepen	Plug Back	Same Res'v.	Diff. Res'v.
Date Spudded	Date Compl. Ready to Prod.		Total Depth		P.B.T.D.			
Elevations (DF, RKB, RT, GR, etc.)	Name of Producing Formation		Top Oil/Gas Pay		Tubing Depth			
Perforations					Depth Casing Shoe			
TUBING, CASING, AND CEMENTING RECORD								
HOLE SIZE	CASING & TUBING SIZE		DEPTH SET		SACKS CEMENT			

V. TEST DATA AND REQUEST FOR ALLOWABLE  
OIL WELL

(Test must be after recovery of total volume of load oil and must be equal to or exceed top allowable for this depth or be for full 24 hours)

Date First New Oil Run To Tanks	Date of Test	Producing Method (Flow, pump, gas lift, etc.)	
Length of Test	Tubing Pressure	Casing Pressure	
Actual Prod. During Test	Oil - Bbls.	Water - Bbls.	

## GAS WELL

Actual Prod. Test-MCF/D	Length of Test	Bbls. Condensate/MMCF	Gravity of Condensate
Testing Method (pilot, back pr.)	Tubing Pressure (shut-in)	Casing Pressure (shut-in)	Choke Size

## VI. CERTIFICATE OF COMPLIANCE

I hereby certify that the rules and regulations of the Oil Conservation Division have been complied with and that the information given above is true and complete to the best of my knowledge and belief.

  
(Signature)District Administrative Supervisor  
(Title)10/28/81  
(Date)

## OIL CONSERVATION DIVISION

APPROVED

DEC 8 - 1981

BY

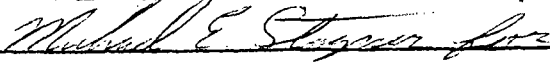

SUPERVISOR DISTRICT # 3

TITLE

This form is to be filed in compliance with RULE 1104.

If this is a request for allowable for a newly drilled or deepened well, this form must be accompanied by a tabulation of the deviate tests taken on the well in accordance with RULE 111.

All sections of this form must be filled out completely for allowable on new and recompleted wells.

Fill out only Sections I, II, III, and VI for changes of owner, well name or number, or transporter, or other such change of condition.

OIL CONSERVATION DIVISION  
P. O. BOX 2088  
SANTA FE, NEW MEXICO 87501REQUEST FOR ALLOWABLE  
AND  
AUTHORIZATION TO TRANSPORT OIL AND NATURAL GAS

TRANSPORTER	OIL
OPERATOR	GAS
PRODUCTION OFFICE	
Operator	

Amoco Production Company

Address

501 Airport Drive, Farmington, N.M. 87401

Reason(s) for filing (Check proper box)

New Well ☐  
Recompletion ☐  
Change In Ownership ☐

Change In Transporter of:

Oil ☐ Dry Gas ☐  
Casinghead Gas ☐ Condensate ☒

Other (Please explain)

If change of ownership give name  
and address of previous owner

## DESCRIPTION OF WELL AND LEASE

Lease Name Gallegos Canyon Unit	Well No. 160	Pool Name, Including Formation Basin Dakota	Kind of Lease State, Federal or Fee Federal	Lease No. SF-080224
Location Unit Letter <u>I</u> : <u>1850</u> Feet From The <u>South</u> Line and <u>1190</u> Feet From The <u>East</u> Line of Section <u>27</u> Township <u>29N</u> Range <u>12W</u> , NMPM, <u>San Juan</u> County				

## DESIGNATION OF TRANSPORTER OF OIL AND NATURAL GAS

Name of Authorized Transporter of Oil <input type="checkbox"/> or Condensate <input checked="" type="checkbox"/> Plateau, Inc.	Address (Give address to which approved copy of this form is to be sent) P.O. Box 489, Bloomfield, N.M. 87413	
Name of Authorized Transporter of Casinghead Gas <input type="checkbox"/> or Dry Gas <input checked="" type="checkbox"/> EL PASO NATURAL GAS COMPANY P. O. BOX 990	Address (Give address to which approved copy of this form is to be sent)	
If well is in the State of New Mexico give location of well: FARMINGTON, NEW MEXICO	Unit I	Sec. 27
	Twp. 29N	Rge. 12W
Is gas actually connected?		When

If this production is commingled with that from any other lease or pool, give commingling order number:

## COMPLETION DATA

Designate Type of Completion - (X)	Oil Well	Gas Well	New Well	Workover	Deepen	Plug Back	Same Res'v.	Diff. Res'v.
Date Spudded	Date Compl. Ready to Prod.		Total Depth		P.B.T.D.			
Elevations (D <sub>1</sub> , RT, GR, etc.)	Name of Producing Formation		Top Oil/Gas Pay		Tubing Depth			
Perforations					Depth Casing Shoe			

## TUBING, CASING, AND CEMENTING RECORD

HOLE SIZE	CASING & TUBING SIZE	DEPTH SET	SACKS CEMENT

TEST DATA AND REQUEST FOR ALLOWABLE  
OIL WELL

(Test must be after recovery of total volume of load oil and must be produced or exceed top allowable for this depth or be for full 24 hours)

Date First New Oil Run To Tanks	Date of Test	Producing Method (Flow, pump, etc.)	
Length of Test	Tubing Pressure	Casing Pressure	Choke Size
Actual Prod. During Test	Oil - Bbls.	Water - Bbls.	CONDENSATE

## GAS WELL

Actual Prod. Test-MCF/D	Length of Test	Bbls. Condensate/MMCF	Gravity of Condensate
Testing Method (pilot, back pr.)	Tubing Pressure (Shut-in)	Casing Pressure (Shut-in)	Choke Size

## CERTIFICATE OF COMPLIANCE

I hereby certify that the rules and regulations of the Oil Conservation Division have been complied with and that the information given above is true and complete to the best of my knowledge and belief.

District Administrative Supervisor  
(Title)

September 28, 1983

(Date)

## OIL CONSERVATION DIVISION

APPROVED \_\_\_\_\_, 19\_\_\_\_  
BY Frank J. [Signature]  
TITLE SUPervisorThis form is to be filed in compliance with RULE 1104.  
If this is a request for allowable for a newly drilled or deepened well, this form must be accompanied by a tabulation of the deviation tests taken on the well in accordance with RULE 111.

All sections of this form must be filled out completely for allowable on new and recompleted wells.

Fill out only Sections I, II, III, and VI for changes of owner, well name or number, or transporter, or other such change of condition.

Separate Forms C-104 must be filed for each pool in multiply completed wells.



NO. OF COPIES RECEIVED		5
DISTRIBUTION		
SANTA FE		/
FILE		/
U.S.G.S.		
LAND OFFICE		
TRANSPORTER	OIL	/
	GAS	/
OPERATOR		
PRORATION OFFICE		

NEW MEXICO OIL CONSERVATION COMMISSION  
REQUEST FOR ALLOWABLE  
AND  
AUTHORIZATION TO TRANSPORT OIL AND NATURAL GAS

Form C-104  
Supersedes Old C-104 and C-110  
Effective 1-1-65

I. OPERATOR

Operator **PAN AMERICAN PETROLEUM CORPORATION** **Eff. 2-1-71,**  
Address **Security Life Building, Denver, Colorado** **Pan American Petro. Corp.**  
**has changed its name to**  
**AMOCO PROD. CO.**

Reason(s) for filing (Check proper box)

New Well ☐ Change in Transporter of: Oil ☐ Dry Gas ☐  
Recompletion ☐ Casinghead Gas ☐ Condensate ☒  
Change in Ownership ☐

Other (explain)

If change of ownership give name and address of previous owner

II. DESCRIPTION OF WELL AND LEASE

Lease Name	Lease No.	Well No.	Pool Name, including Formation	Kind of Lease
<b>Gallegos Canyon 160 Unit</b>		<b>1</b>	<b>Basin Dakota</b>	State, Federal or Fee <b>Federal</b>
Location				
Unit Letter <b>I</b>	<b>1850</b>	Feet From The <b>South</b>	Line and <b>1190</b>	Feet From The <b>East</b>
Line of Section <b>27</b>	Township <b>29N</b>	Range <b>12W</b>	San Juan County	

III. DESIGNATION OF TRANSPORTER OF OIL AND NATURAL GAS

Name of Authorized Transporter of Oil <input type="checkbox"/> or Condensate <input checked="" type="checkbox"/>	Address (Give address to which approved copy of this form is to be sent)
<b>Graves Oil Company</b>	<b>P. O. Box 2077, Farmington, New Mexico</b>
Name of Authorized Transporter of Casinghead Gas <input type="checkbox"/> or Dry Gas <input checked="" type="checkbox"/>	Address (Give address to which approved copy of this form is to be sent)
<b>El Paso Natural Gas Company</b>	<b>P. O. Box 990, Farmington, New Mexico</b>
If well produces oil or liquids, give location of tanks.	Unit Sec. Twp. Rge. Is gas actual? When
<b>I 27 29N 12W</b>	<b>Yes 2-2-65</b>

If this production is commingled with that from any other lease or pool, give contract or order number:

IV. COMPLETION DATA

Designate Type of Completion -- (X)	Oil Well	Gas Well	New Well	Workover	Deepen	Plug Back	Same Res'v.	Diff. Res'v.
Date Spudded	Date Compl. Ready to Prod.	Total Depth	P.B.T.D.					
Elevations (DF, RKB, RT, GR, etc.)	Name of Producing Formation	Top Oil/Gas Way	Tubing Depth					
Perforations	Depth Casing Shoe							

TUBING, CASING, AND CEMENTING RECORD

HOLE SIZE	CASING & TUBING SIZE	DEPTH SET	SACKS CEMENT

V. TEST DATA AND REQUEST FOR ALLOWABLE OIL WELL

(Test must be after recovery of total volume of load oil and must be equal to or exceed top allowable for this depth or be for full 24 hours)

Date First New Oil Run To Tanks	Date of Test	Producing Method (Flow, pump, gas lift, etc.)	
Length of Test	Tubing Pressure	Casing Pressure	Choke Size
Actual Prod. During Test	Oil - Bbls.	Water - Bbls.	Gas - MCF

GAS WELL

Actual Prod. Test-MCF/D	Length of Test	Bbls. Condensate/MMCF	Gravel or Sand
Testing Method (pitot, back pr.)	Tubing Pressure	Casing Pressure	Choke Size

VI. CERTIFICATE OF COMPLIANCE

I hereby certify that the rules and regulations of the Oil Conservation Commission have been complied with and that the information given above is true and complete to the best of my knowledge and belief.

  
(Signature)

Administrative Assistant

(Title)

September 27, 1965

(Date)

OIL CONSERVATION COMMISSION

APPROVED **SEP 28 1965**, 19

BY   
TITLE **Supervisor Dist. # 3**

This form is to be filed in compliance with RULE 1104.

If this is a request for allowable for a newly drilled or deepened well, this form must be accompanied by a tabulation of the deviation tests taken on the well in accordance with RULE 111.

All sections of this form must be filled out completely for allowable on new and recompleted wells.

Fill out only Sections I, II, III, and VI for changes of owner, well name or number, or transporter, or other such change of condition.

Separate Forms C-104 must be filed for each pool in multiply completed wells.

OIL CONSERVATION COMMISSION

BOX 697

120 EAST CHACO

AZTEC, NEW MEXICO

NOTICE OF GAS CONNECTION **CORRECTED COPY**

DATE March 8, 1965

THIS IS TO NOTIFY THE OIL CONSERVATION COMMISSION THAT CONNECTION FOR THE PURCHASE OF GAS FROM  
THE Pan American Petroleum Corporation  
OPERATOR

Gallegos Canyon No. 160 Unit #1  
LEASE

"I"  
WELL UNIT

27-29-12  
S-T-R

Basin Dakota  
POOL

El Paso Natural Gas Company  
NAME OF PURCHASER

WAS MADE ON January 29, 1965 , FIRST DELIVERY February 2, 1965 \*  
DATE DATE

\* Corrected first delivery date

Choke 10,999 MCF  
AOF 28,196 MCF  
INITIAL POTENTIAL

El Paso Natural Gas Company  
PURCHASER

Original Signed By W. M. Adams  
REPRESENTATIVE

Chief Dispatcher  
TITLE

CC: TO OPERATOR **Fort Worth and Farmington**  
OIL CONSERVATION COMMISSION - SANTA FE  
F. N. WOODRUFF - EL PASO  
~~E. B. ADAMS~~

FILE

OIL CONSERVATION COMMISSION

BOX 697

120 EAST CHACO

AZTEC, NEW MEXICO

NOTICE OF GAS CONNECTION

DATE February 5, 1965

THIS IS TO NOTIFY THE OIL CONSERVATION COMMISSION THAT CONNECTION FOR THE PURCHASE OF GAS FROM  
THE Pan American Petroleum Corporation  
OPERATOR

Gallegos Canyon No. 160 Unit #1  
LEASE

"I"  
WELL UNIT

27-29-12  
S-T-R

Basin Dakota  
POOL

El Paso Natural Gas Company  
NAME OF PURCHASER

WAS MADE ON January 29, 1965  
DATE

, FIRST DELIVERY February 1, 1965  
DATE

Choke 10,999 MCF  
AOF 28,196 MCF  
INITIAL POTENTIAL

El Paso Natural Gas Company  
PURCHASER

Original Signed By W. M. Rodgers  
REPRESENTATIVE

Chief Dispatcher  
TITLE

CC: TO OPERATOR Fort Worth and Farmington  
OIL CONSERVATION COMMISSION - SANTA FE  
F. N. WOODRUFF - EL PASO  
B. D. ADAMS

FILE

2/10/65

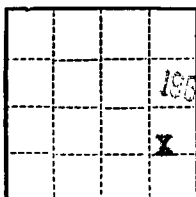

(SUBMIT IN TRIPLICATE)

UNITED STATES  
DEPARTMENT OF THE INTERIOR  
GEOLOGICAL SURVEY

Land Office Santa Fe  
Lease No. SF-080224  
Unit Gallegos Canyon  
No. 160 Unit

SUNDRY NOTICES AND REPORTS ON WELLS

NOTICE OF INTENTION TO DRILL.....	SUBSEQUENT REPORT OF WATER SHUT-OFF.....
NOTICE OF INTENTION TO CHANGE PLANS.....	SUBSEQUENT REPORT OF SHOOTING OR ACIDIZING.....
NOTICE OF INTENTION TO TEST WATER SHUT-OFF.....	SUBSEQUENT REPORT OF ALTERING CASING.....
NOTICE OF INTENTION TO RE-DRILL OR REPAIR WELL.....	SUBSEQUENT REPORT OF RE-DRILLING OR REPAIR.....
NOTICE OF INTENTION TO SHOOT OR ACIDIZE.....	SUBSEQUENT REPORT OF ABANDONMENT.....
NOTICE OF INTENTION TO PULL OR ALTER CASING.....	SUPPLEMENTARY WELL HISTORY.....
NOTICE OF INTENTION TO ABANDON WELL.....	

(INDICATE ABOVE BY CHECK MARK NATURE OF REPORT, NOTICE, OR OTHER DATA)

Farmington, New Mexico May 7, 1964

Gallegos Canyon No. 160 Unit  
Well No. 1 is located 1850 ft. from N line and 1190 ft. from E line of sec. 27

NE/4 SE/4 Section 27 T-29-N R-12-W NMPM  
(1/4 Sec. and Sec. No.) (Twp.) (Range) (Meridian)

Basin Dakota San Juan New Mexico  
(Field) (County or Subdivision) (State or Territory)

The elevation of the derrick floor above sea level is 5384 ft.

DETAILS OF WORK

(State names of and expected depths to objective sands; show sizes, weights, and lengths of proposed casings; indicate mudlogging jobs, cementing points, and all other important proposed work)

The above well was spudded on April 14, 1964 and drilled to a depth of 358'. 8 5/8" Casing was landed at that depth and cemented with 225 sacks cement. Cement did not circulate. Cemented to surface thru 1" pipe with 25 sacks. After waiting on cement tested casing with 500 psi. Test ok. Reduced hole to 7 7/8" and resumed drilling.

Well was drilled to a total depth of 6032', 4 1/2" casing was set at that depth with two stage tool set at 4189. Cemented first stage with 400 sacks cement containing 6% gel, 2 pounds medium tuf plug and followed by 100 sacks cement. Cemented second stage with 1100 sacks cement containing 6% gel and 2 pounds medium tuf plug per sack. Cement circulated to surface. After waiting on cement tested casing with 3500 psi. Test ok.

Perforated 5936-60 and 5972-84 with 2 shots per foot. Fractured these perforations

I understand that this plan of work must receive approval in writing by the Geological Survey before operations may be commenced.

Company Pan American Petroleum Corporation

Address P. O. Box 480

Farmington, New Mexico

Fred L. Nabors, District Engineer

ORIGINAL SIGNED BY  
Fred L. Nabors

By

Title

47,910 gallons water containing 1% calcium chloride and 4 pounds FR-4 per 1000 gallons and 50,000 pounds sand. No breakdown pressure. Treating pressure 3125. Average injection rate 53 BPM. Set bridge plug at 5920. Tested plug with 3500 psi. Test ok. Perforated 5856-68 with 4 shots per foot. Fractured these perforations with 25,110 gallons water containing additives as above and 20,000 pounds sand. Breakdown pressure 2200. Treating 3325. Average injection rate 40 BPM.

2 3/8" Tubing landed at 5839 and well completed as Basin Dakota Field Development Well May 3, 1964. Preliminary test 10,000 MCFD.

UNITED STATES  
DEPARTMENT OF THE INTERIOR  
GEOLOGICAL SURVEY

SUBMIT IN DUPLICATE\*

(See other in-  
structions on  
reverse side)Form approved.  
Budget Bureau No. 42-R355.5.

## WELL COMPLETION OR RECOMPLETION REPORT AND LOG \*

1a. TYPE OF WELL: OIL WELL <input type="checkbox"/> GAS WELL <input checked="" type="checkbox"/> DRY <input type="checkbox"/> Other <input type="checkbox"/>		5. LEASE DESIGNATION AND SERIAL NO. <b>3F-080224</b>	
b. TYPE OF COMPLETION: NEW WELL <input checked="" type="checkbox"/> WORK OVER <input type="checkbox"/> DEEP-EN <input type="checkbox"/> PLUG BACK <input type="checkbox"/> DIFF. RESVR. <input type="checkbox"/> Other <input type="checkbox"/>		6. IF INDIAN, ALLOTTEE OR TRIBE NAME	
2. NAME OF OPERATOR <b>Pan American Petroleum Corporation</b>		7. UNIT AGREEMENT NAME	
3. ADDRESS OF OPERATOR <b>P. O. Box 480 Farmington, New Mexico</b>		8. FARM OR LEASE NAME <b>Gallegos Canyon No. 160 Unit</b>	
4. LOCATION OF WELL (Report location clearly and in accordance with any State requirements)* At surface <b>1850' FSL and 1190' FSL</b> At top prod. interval reported below At total depth <b>Same</b>		9. WELL NO. <b>1</b>	
14. PERMIT NO.		DATE ISSUED <b>MAY 13 1964</b>	
15. DATE SPUDDED <b>4-21-64</b>		16. DATE T.D. REACHED <b>April 21, 1964</b>	
17. DATE COMPL. (Ready to prod.) <b>May 3, 1964</b>		18. ELEVATIONS (DF, RKB, RT, GR, ETC.)* <b>NDB 5384</b>	
20. TOTAL DEPTH, MD & TVD <b>6032</b>		21. PLUG BACK T.D., MD & TVD <b>5977</b>	
22. IF MULTIPLE COMPL., HOW MANY*		23. INTERVALS DRILLED BY <b>ROTARY TOOLS</b>	
24. PRODUCING INTERVAL(S), OF THIS COMPLETION—TOP, BOTTOM, NAME (MD AND TVD)* <b>5855 - 5928 Graneros Dakota</b> <b>5928 - 5990 Main Dakota</b>		25. WAS DIRECTIONAL SURVEY MADE <b>No</b>	
26. TYPE ELECTRIC AND OTHER LOGS RUN <b>Induction Electric and Gamma Ray Sonic</b>		27. WAS WELL CORED <b>No</b>	
28. CASING RECORD (Report all strings set in well)			
CASING SIZE	WEIGHT, LB./FT.	DEPTH SET (MD)	HOLE SIZE
<b>8 5/8"</b>	<b>24#</b>	<b>358</b>	<b>12 1/4"</b>
<b>4 1/2"</b>	<b>10.5#</b>	<b>6032</b>	<b>7 7/8"</b>
CEMENTING RECORD			
<b>250 Sacks</b>			
<b>1600 Sacks</b>			
AMOUNT PULLED			
<b>None</b>			
<b>None</b>			
29. LINER RECORD			
SIZE	TOP (MD)	BOTTOM (MD)	SACKS CEMENT*
30. TUBING RECORD			
SIZE	DEPTH SET (MD)	PACKER SET (MD)	
<b>2 3/8"</b>	<b>5839</b>		
31. PERFORATION RECORD (Interval, size and number)			
<b>5936-60 and 5972-84 with 2 shots per foot</b> <b>5856-68 with 4 shots per foot</b>			
32. ACID, SHOT, FRACTURE, CEMENT SQUEEZE, ETC.			
DEPTH INTERVAL (MD)		AMOUNT AND KIND OF MATERIAL USED	
<b>5936-60x5972-84</b>		<b>47,910 Gal Water x 50,000 Lb Sar.</b>	
<b>5856-68</b>		<b>25,110 Gal Water x 20,000 Lb Can</b>	
33.* PRODUCTION			
DATE FIRST PRODUCTION	PRODUCTION METHOD (Flowing, gas lift, pumping—size and type of pump)		WELL STATUS (Producing or shut-in)
	<b>Flow</b>		<b>Shut-in</b>
DATE OF TEST	HOURS TESTED	CHOKE SIZE	PROD'N. FOR TEST PERIOD
<b>May 3, 1964</b>	<b>3</b>	<b>3/4"</b>	
FLOW. TUBING PRESS.	CASING PRESSURE	CALCULATED 24-HOUR RATE	OIL—BBL.
<b>775</b>	<b>1625</b>		<b>10,000</b>
34. DISPOSITION OF GAS. (Sold, used for fuel, vented, etc.)			
<b>To be sold to El Paso Natural Gas Company</b>			
35. LIST OF ATTACHMENTS			
<b>None</b>			
36. I hereby certify that the foregoing and attached information is complete and correct as determined from all available records			
SIGNED <b>Fred L. Nabors, District Engineer</b>			
ORIGINAL SIGNED BY <b>Fred L. Nabors</b>			
TITLE <b>DATE May 8, 1964</b>			

(See Instructions and Spaces for Additional Data on Reverse Side)

# INSTRUCTIONS

**General:** This form is designed for submitting a complete and correct well completion report and log on all types of lands and leases to either a Federal agency or a State agency, or both, pursuant to applicable Federal and/or State laws and regulations. Any necessary special instructions concerning the use of this form and the number of copies to be submitted, particularly with regard to local, area, or regional procedures and practices, either are shown below or will be issued by, or may be obtained from, the local Federal and/or State office. See instructions on items 22 and 24, and 33, below regarding separate reports for separate completions.

If not filed prior to the time this summary record is submitted, copies of all currently available logs (drillers, geologists, sample and core analysis, all types electric, etc.), formation and pressure tests, and directional surveys, should be attached hereto, to the extent required by applicable Federal and/or State laws and regulations. All attachments should be listed on this form, see item 35.

**Item 4:** If there are no applicable State requirements, locations on Federal or Indian land should be described in accordance with Federal requirements. Consult local State or Federal office for specific instructions.

**Item 18:** Indicate which elevation is used as reference (where not otherwise shown) for depth measurements given in other spaces on this form and in any attachments.

**Items 22 and 24:** If this well is completed for separate production from more than one interval zone (multiple completion), so state in item 22, and in item 24 show the producing interval, or intervals, top(s), bottom(s) and name(s) (if any) for only the interval reported in item 33. Submit a separate report (page) on this form, adequately identified, for each additional interval to be separately produced, showing the additional data pertinent to such interval.

**Item 29: "Sacks Cement":** Attached supplemental records for this well should show the details of any multiple stage cementing and the location of the cementing tool.

**Item 33:** Submit a separate completion report on this form for each interval to be separately produced. (See instruction for items 22 and 24 above.)

## 37. SUMMARY OF POROUS ZONES:

SHOW ALL IMPORTANT ZONES OF POROSITY AND CONTENTS THEREOF: CORED INTERVALS; AND ALL DRILL-STEM TESTS, INCLUDING DEPTH INTERVAL TESTED, CUSHION USED, TIME TOOL OPEN, FLOWING AND SHUT-IN PRESSURES, AND RECOVERIES

FORMATION	TOP	BOTTOM	DESCRIPTION, CONTENTS, ETC.	NAME	MEAS. DEPTH	TRUE VERT. DEPTH
Sand x Shale	0	1340				
Pictured Cliffs	1340	1550				
Leola Shale	1550	2907				
Kesaverville	2907	4075				
Maroon Shale	4075	4994				
Gallup	4994	5358				
Base Gallup	5358	5758				
Greenhorn	5758	5820				
Graneros Shale	5820	5855				
Graneros Dakota	5855	5928				
Main Dakota	5928	6032				

UNITED STATES  
DEPARTMENT OF THE INTERIOR  
GEOLOGICAL SURVEYSUBMIT IN TRIPLICATE\*  
(Other instructions on reverse side)Form approved.  
Budget Bureau No. 42-R1424.

5. LEASE DESIGNATION AND SERIAL NO.

SF-030224

6. IF INDIAN, ALLOTTEE OR TRIBE NAME

7. UNIT AGREEMENT NAME

8. FARM OR LEASE NAME

Gallegos Canyon No. 160 Un

9. WELL NO.

1

10. FIELD AND POOL, OR WILDCAT

Basin Dakota

11. SEC., T., R., M., OR BLK. AND  
SURVEY OR AREA

NE/4 SE/4 Section 27

T-29N, R-12W, NMPM

12. COUNTY OR PARISH

San Juan

New Mexico

1.

OIL WELL ☐ GAS WELL ☒ OTHER

2. NAME OF OPERATOR

PAN AMERICAN PETROLEUM CORPORATION

3. ADDRESS OF OPERATOR

P. O. Box 400, Farmington, New Mexico

4. LOCATION OF WELL (Report location clearly and in accordance with any State requirements.\*  
See also space 17 below.)  
At surface

1850 FSL and 1190 FEL of Section 27, T-29N, R-12W, NMPM

14. PERMIT NO.

15. ELEVATIONS (Show whether DF, RT, GR, etc.)

5384 (RDB)

16.

Check Appropriate Box To Indicate Nature of Notice, Report, or Other Data

NOTICE OF INTENTION TO:

TEST WATER SHUT-OFF

☐  
☐  
☐  
☐

PULL OR ALTER CASING

☐  
☐  
☐  
☐

FRACTURE TREAT

MULTIPLE COMPLETE

SHOOT OR ACIDIZE

ABANDON\*

REPAIR WELL

CHANGE PLANS

(Other)

SUBSEQUENT REPORT OF:

WATER SHUT-OFF

☐  
☐  
☐

FRACTURE TREATMENT

SHOOTING OR ACIDIZING

(Other) Report of Potential Test

REPAIRING WELL

ALTERING CASING

ABANDONMENT\*

☐  
☐  
☐  
☒(NOTE: Report results of multiple completion on Well  
Completion or Recompletion Report and Log form.)

17. DESCRIBE PROPOSED OR COMPLETED OPERATIONS (Clearly state all pertinent details, and give pertinent dates, including estimated date of starting any proposed work. If well is directionally drilled, give subsurface locations and measured and true vertical depths for all markers and zones pertinent to this work.)\*

This is to report the following Potential Test:

Potential Test May 11, 1964. Flowed 10,999 MCFPD through 3/4" choke after 3 hours flow. Absolute open flow potential 28,196 MCFPD. Shut in casing pressure after 8 days 2099 psig.

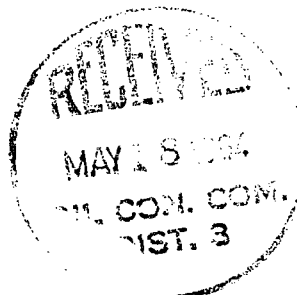

RECEIVED

MAY 15 1964

U. S. GEOLOGICAL SURVEY  
WASHINGTON, D. C.

18. I hereby certify that the foregoing is true and correct

ORIGINAL SIGNED BY

SIGNED

W. E. TURNER

TITLE

Administrative Clerk

DATE

May 13, 1964

(This space for Federal or State office use)

APPROVED BY

TITLE

DATE

CONDITIONS OF APPROVAL, IF ANY:

\*See instructions on Reverse Side



NUMBER OF COPIES RECEIVED	
DISTRIBUTION	
SANTA FE	
FILE	
U.S.G.S.	
LAND OFFICE	
TRANSPORTER	OIL GAS
PRODUCTION OFFICE	
OPERATOR	

**NEW MEXICO OIL CONSERVATION COMMISSION**  
**SANTA FE, NEW MEXICO**  
**CERTIFICATE OF COMPLIANCE AND AUTHORIZATION**  
**TO TRANSPORT OIL AND NATURAL GAS**

**FORM C-110**  
 (Rev. 7-60)

**FILE THE ORIGINAL AND 4 COPIES WITH THE APPROPRIATE OFFICE**

Company or Operator <b>Pan American Petroleum Corporation</b>				Lease <b>Collegos Canyon No. 160 Unit 1</b>		Well No. <b>1</b>	
Unit Letter <b>I</b>	Section <b>27</b>	Township <b>T-29-N</b>	Range <b>R-12-W</b>	County <b>San Juan</b>			
Pool <b>Basin Dakota</b>				Kind of Lease (State, Fed, Fee) <b>Federal</b>			
If well produces oil or condensate give location of tanks			Unit Letter <b>I</b>	Section <b>27</b>	Township <b>T-29-N</b>	Range <b>R-12-W</b>	
Authorized transporter of oil <input type="checkbox"/> or condensate <input checked="" type="checkbox"/>				Address (give address to which approved copy of this form is to be sent)			
<b>Plateau, Inc.</b>				<b>P. O. Box 103 Farmington, New Mexico</b>			
Is Gas Actually Connected? Yes <input type="checkbox"/> No <input type="checkbox"/>							
Authorized transporter of casing head gas <input type="checkbox"/> or dry gas <input checked="" type="checkbox"/>			Date Connected	Address (give address to which approved copy of this form is to be sent)			
<b>El Paso Natural Gas Company</b>				<b>P. O. Box 990 Farmington, New Mexico</b>			

If gas is not being sold, give reasons and also explain its present disposition:

**REASON(S) FOR FILING (please check proper box)**

New Well ..... ☒ Change in Ownership ..... ☐  
 Change in Transporter (check one) Other (explain below)  
 Oil ..... ☐ Dry Gas ..... ☐  
 Casing head gas . ☐ Condensate.. ☐

Remarks

Well completed May 3, 1964 as Basin Dakota Field Well.

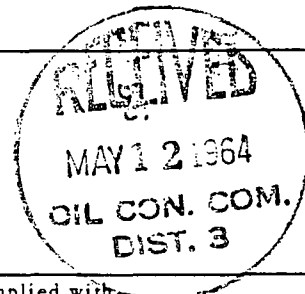

The undersigned certifies that the Rules and Regulations of the Oil Conservation Commission have been complied with.

Executed this the \_\_\_\_\_ day of \_\_\_\_\_, 19 \_\_\_\_.

OIL CONSERVATION COMMISSION		By 
Approved by 	Title <b>Administrative Clerk</b>	
Title <b>Supervisor Dist. # 3</b>	Company <b>Pan American Petroleum Corporation</b>	
Date <b>MAY 14 1964</b>	Address <b>P. O. Box 100 Farmington, New Mexico</b>	

NUMBER OF COPIES RECEIVED	
DISTRIBUTION	
SANTA FE	
FILE	
U.S.G.S.	
LAND OFFICE	
TRANSPORTER	OIL GAS
PRODUCTION OFFICE	
OPERATOR	

# NEW MEXICO OIL CONSERVATION COMMISSION

(Form C-104)  
Revised 7/1/57

Santa Fe, New Mexico

## REQUEST FOR (OIL) - (GAS) ALLOWABLE

New Well  
Recompletion

This form shall be submitted by the operator before an initial allowable will be assigned to any completed Oil or Gas well. Form C-104 is to be submitted in QUADRUPLICATE to the same District Office to which Form C-101 was sent. The allowable will be assigned effective 7:00 A.M. on date of completion or recompletion, provided this form is filed during calendar month of completion or recompletion. The completion date shall be that date in the case of an oil well when new oil is delivered into the stock tanks. Gas must be reported on 15.025 psia at 60° Fahrenheit.

Farmington, New Mexico  
(Place)

May 7, 1964  
(Date)

### WE ARE HEREBY REQUESTING AN ALLOWABLE FOR A WELL KNOWN AS:

Pan American Petroleum Corporation-Gallegos Canyon, Well No. 1, in NE 1/4 SE 1/4,  
(Company or Operator) (Lease)

I, Sec. 27, T-29-N, R-12-W, NMPM., Basin Dakota Pool  
Unit Letter

San Juan

County. Date Spudded April 14, 1964 Date Drilling Completed April 21, 1964

Please indicate location:

D	C	B	A
E	F	G	H
L	K	J	I
M	N	O	P

Elevation 5384 (RDB) Total Depth 6032 PBT 2997

Top Oil/Gas Pay 5856 Name of Prod. Form. Dakota

PRODUCING INTERVAL - 5936-60 and 5972-84 with 2 shots per foot

Perforations 5856-68 with 4 shots per foot

Open Hole None Depth Casing Shoe 6032 Depth Tubing 5889

#### OIL WELL TEST -

Natural Prod. Test: bbls. oil, bbls water in hrs, min. Size

Test After Acid or Fracture Treatment (after recovery of volume of oil equal to volume of Choke load oil used): bbls. oil, bbls water in hrs, min. Size

#### GAS WELL TEST -

Natural Prod. Test: MCF/Day; Hours flowed Choke Size

Method of Testing (pitot, back pressure, etc.):

Test After Acid or Fracture Treatment: 10,000 MCF/Day; Hours flowed 3

Choke Size 3/4 Method of Testing: Pitot Tube

Acid or Fracture Treatment (Give amounts of materials used, such as acid, water, oil, and sand): 73,020 Gallons water and 70,000 lb. sand.

Casing Press. 1625 Tubing Press. 775 Date first new oil run to tanks Shut In

Oil Transporter Plateau Inc.

Gas Transporter El Paso Natural Gas Company

Remarks: Well completed May 3, 1964 as Basin Dakota Field Development  
Copies of Deviation survey are attached.

I hereby certify that the information given above is true and complete to the best of my knowledge.

Approved MAY 13 1964 19

Pan American Petroleum Corporation  
(Company or Operator)

By: E. R. Turner  
(Signature)

Title Administrative Clerk

Send Communications regarding well to:

Name Pan American Petroleum Corporation

Address P. O. Box 120, Farmington, New Mexico

OIL CONSERVATION COMMISSION

By: E. C. Lewis

Title Supervisor Dist. # 3

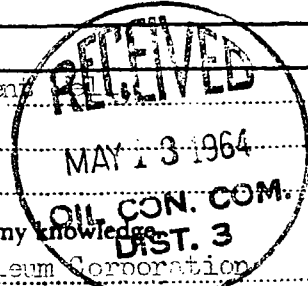

1964 MAY 13 AM 8:50

<u>DEPTH</u>	<u>DEVIATION</u>
359'	1/4°
788'	1/4°
1185'	1/2°
1586'	1/2°
1979'	1/2°
2469'	3/4°
2829'	1/4°
3244'	1/2°
3813'	1/4°
4214'	1/2°
4722'	3/4°
5296'	1/4°
5541'	1/4°
5884'	3/4°
6030'	1°

A F F I D A V I T

THIS IS TO CERTIFY that to the best of my knowledge the above tabulation details the deviation test taken on PAN AMERICAN PETROLEUM CORPORATION'S Gallegos Canyon No. 160 Unit No. 1, Basin Dakota Field located in the NE/4 SE/4 of Section 27, T-29-N, R-12-W, San Juan County, New Mexico.

Signed Paul E. N...  
District Petroleum Engineer

THE STATE OF NEW MEXICO )  
COUNTY OF SAN JUAN ) SS.

BEFORE ME, the undersigned authority, on this day personally appeared Fred L. Nabors known to me to be <sup>District</sup> Petroleum Engineer for Pan American Petroleum Corporation and to be the person whose name is subscribed to the above statement, who, being by me duly sworn on oath, states that he has knowledge of the facts stated herein and that said statement is true and correct.

SUBSCRIBED AND SWORN TO before me, a Notary Public in and for said County and State this 11th day of May, 1964.

S.K. Dietz  
Notary Public

My Commission Expires February 27, 1965.

UNITED STATES  
DEPARTMENT OF THE INTERIOR

## GEOLOGICAL SURVEY

## APPLICATION FOR PERMIT TO DRILL, DEEPEN, OR PLUG BACK

## 1a. TYPE OF WORK

DRILL ☒ DEEPEN ☐ PLUG BACK ☐

## b. TYPE OF WELL

OIL WELL ☐ GAS WELL ☒ OTHER ☐ SINGLE ZONE ☒ MULTIPLE ZONE ☐

## 2. NAME OF OPERATOR

PAN AMERICAN PETROLEUM CORPORATION

## 3. ADDRESS OF OPERATOR

P. O. Box 480, Farmington, New Mexico

## 4. LOCATION OF WELL (Report location clearly and in accordance with any State requirements.)\*

At surface

1850 FSL and 1190 FEL

At proposed prod. zone

Same

## 14. DISTANCE IN MILES AND DIRECTION FROM NEAREST TOWN OR POST OFFICE\*

6 Miles East of Farmington, New Mexico

## 15. DISTANCE FROM PROPOSED\*

LOCATION TO NEAREST

PROPERTY OR LEASE LINE, FT.

(Also to nearest drlg. line, if any)

530'

## 18. DISTANCE FROM PROPOSED LOCATION\*

TO NEAREST WELL, DRILLING, COMPLETED,  
OR APPLIED FOR, ON THIS LEASE, FT.

2,640'

## 16. NO. OF ACRES IN LEASE

320

## 19. PROPOSED DEPTH

6,000'

## 17. NO. OF ACRES ASSIGNED

TO THIS WELL

320

## 20. ROTARY OR CABLE TOOLS

Rotary

## 21. ELEVATIONS (Show whether DF, RT, GR, etc.)

Will Report Later

## 22. APPROX. DATE WORK WILL START\*

April 16, 1964

## 23.

## PROPOSED CASING AND CEMENTING PROGRAM

SIZE OF HOLE	SIZE OF CASING	WEIGHT PER FOOT	SETTING DEPTH	QUANTITY OF CEMENT
12 1/4"	8 5/8"	24#	350	250
7 7/8"	4 1/2"	10.5#	6000	1500 2 Stage

Completion will be as indicated upon reaching total depth.

Copies of Location Plat are attached.

Copies of any logs run will be furnished upon completion of well.

Verbal approval received March 18, 1964. Baier to Hollingsworth.

IN ABOVE SPACE DESCRIBE PROPOSED PROGRAM: If proposal is to deepen or plug back, give data on present productive zone and proposed new productive zone. If proposal is to drill or deepen directionally, give pertinent data on subsurface locations and measured and true vertical depths. - Give blowout preventer program, if any.

## 24.

Fred L. Nabors, District Engineer

SIGNED

ORIGINAL SIGNED BY

TITLE

DATE

March 18, 1964

(This space for District or State office use)

PERMIT NO.

APPROVAL DATE

APPROVED BY

TITLE

CONDITIONS OF APPROVAL, IF ANY:

\*See Instructions On Reverse Side

RECEIVED  
MAR 24 1964  
OIL CON. COM.  
DIST. 3

## Well Location and Acreage Dedication Plat

Section A.

Date MARCH 18, 1964

Operator PAN AMERICAN PETROLEUM CORPORATION Lease GALLEGOS CANYON NO. 160 UNIT  
 Well No. 1 Unit Letter I Section 27 Township 29 NORTH Range 12 WEST, NMPM  
 Located 1850 Feet From SOUTH Line, 1190 Feet From EAST Line  
 County SAN JUAN G. L. Elevation REPORT LATER Dedicated Acreage 320 Acres  
 Name of Producing Formation DAKOTA Pool BASIN DAKOTA

1. Is the Operator the only owner in the dedicated acreage outlined on the plat below?

Yes        No X2. If the answer to question one is "no", have the interests of all the owners been consolidated by communitization agreement or otherwise? Yes X No       . If answer is "yes", Type of Consolidation. Communiti-

zation agreements for the S/2 Section 27 are being circulated for signature - unit will consist of tracts committed &amp; non-committed to Gallegos Canyon Unit. All owners have agree

2. If the answer to question two is "no", list all the owners and their respective interests below: to join in drilling of well.

Owner

Land Description

Section B.

This is to certify that the information in Section A above is true and complete to the best of my knowledge and belief.

PAN AMERICAN PETROLEUM CORP.F. H. Hollingsworth (Operator)F. H. Hollingsworth  
(Representative)P. O. Box 480

(Address)

Farmington, New Mexico

Note: All distances must be from outer boundaries

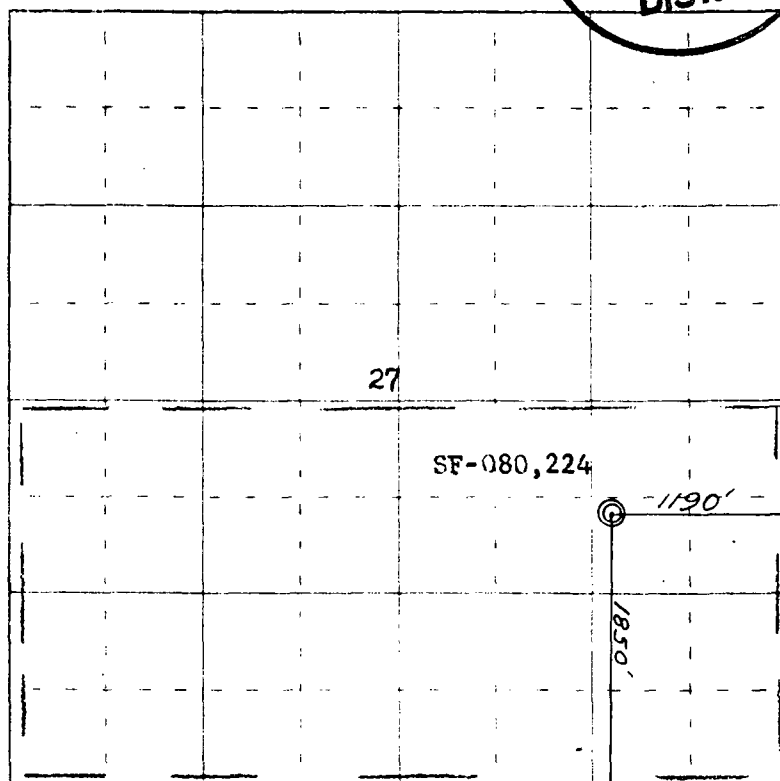

0 330 660 990 1320 1650 1980 2310 2640 2000 1500 1000 500 0

Scale 4 inches equal 1 mile

Ref: GLO plat dated 7 April 1881

This is to certify that the above plat was prepared from field notes of actual surveys made by me or under my supervision and that the same are true and correct to the best of my knowledge and belief.

Date Surveyed 3 February 1964

Registered Professional Engineer and or Land Surveyor

James P. Lease

New Mexico Reg. No. 1463

Farmington, New Mexico

IS PORTION, OR ANY PART THEREOF,  
 Y BE PLACED OUTSIDE OF SUB-  
 RUCTURE, IF DESIRED. USE LONG  
 DIUS BENDS. PIPE USED FOR  
 TENSION SHOULD BE SHOP MADE  
 TH NO SCREWED CONNECTIONS AND  
 ESSURE TESTED INITIALLY TO SAME  
 ST PRESSURE AS THE CHOKE  
 NIFOLD.

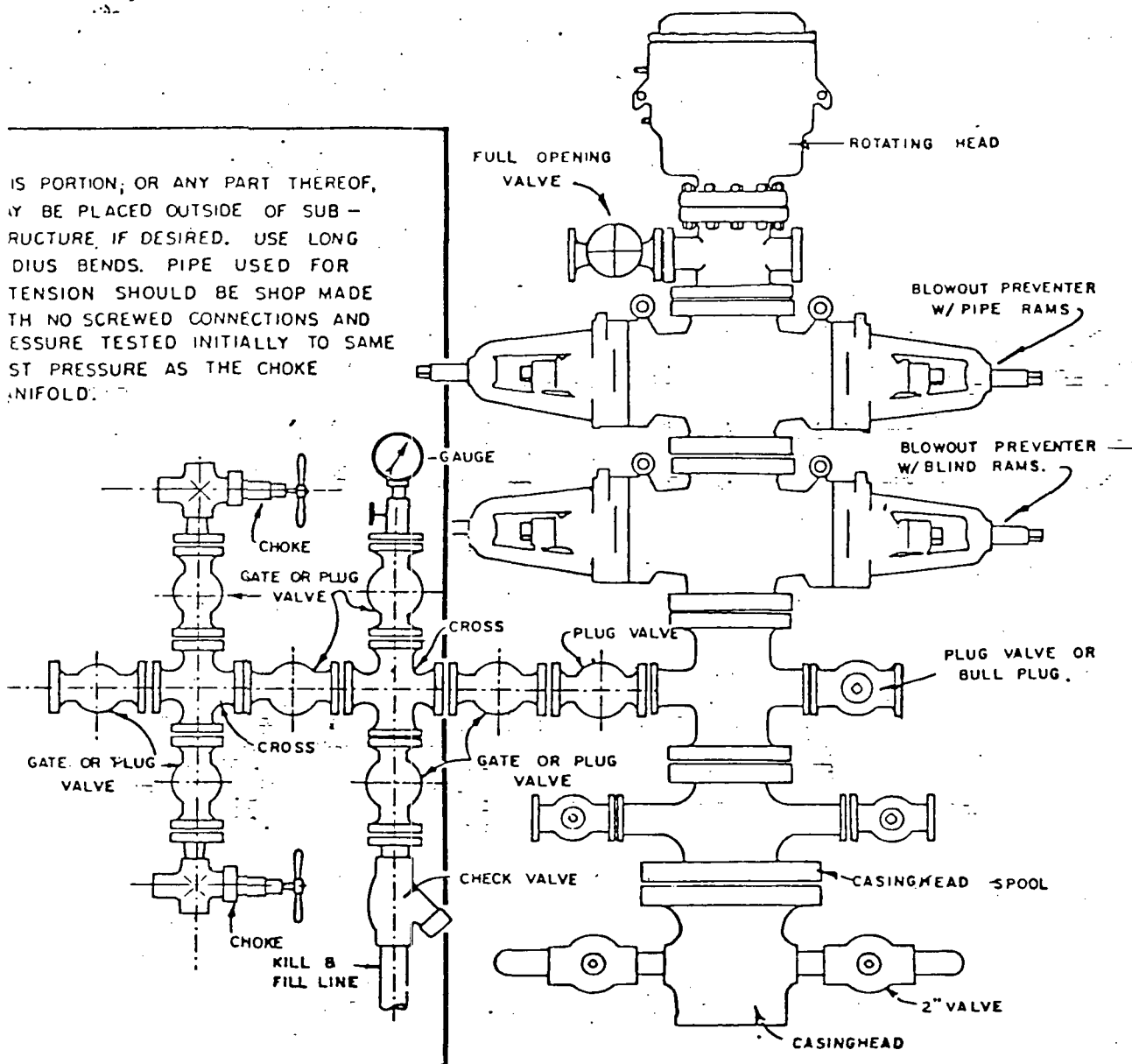

BLOWOUT PREVENTER HOOKUP