



1963 JUL 17 PM 1 25

CONTINENTAL OIL COMPANY

P. O. BOX 1377
ROSWELL, NEW MEXICO

PRODUCTION DEPARTMENT
NEW MEXICO DIVISION

A. B. SLAYBAUGH
DIVISION SUPERINTENDENT
V. C. EISSLER
ASSISTANT DIVISION SUPERINTENDENT

July 16, 1963

825 PETROLEUM BUILDING
TELEPHONE: MAIN 2-4202

New Mexico Oil Conservation Commission
Post Office Box 871
Santa Fe, New Mexico

Attention: Mr. A. L. Porter, Jr., Secretary-Director

Gentlemen:

Re: APPLICATION FOR NON-
STANDARD GAS PRORATION
UNIT - BLINEBRY POOL,
LOCKHART A-35 NO. 1

We forward herewith application in triplicate for approval of a 120-acre non-standard gas proration unit in the Blinebry Pool for our Lockhart A-35 Well No. 1 located in Unit D, Section 35, T21S, R37E, Lea County, New Mexico.

This application represents a reduction in size of the currently approved standard proration unit consisting of the NW/4 of Section 35. The reduction in size is necessary due to the recent recompletion of Moran Oil Producing and Drilling Corporation's Elliott No. 1 in Unit E of this section.

Offset operators, as defined by the Blinebry Gas Rules, are being furnished copies of this application by Registered mail. Your further handling and approval of this application will be sincerely appreciated.

Yours very truly,

A. B. Slaybaugh

VTL-pr

Enc.

cc: RGP GW JWK JRP

Copies by Registered Mail:

Humble Oil & Refining Company, Box 2617, Hobbs, N. M.
Sinclair Oil & Gas Company, 520 E. Broadway, Hobbs, N. M.
Moran Oil Producing & Drilling Corp., Box 1718, Hobbs, N. M.

CONTINENTAL OIL COMPANY

Roswell, New Mexico

July 16, 1963

MAILED 1000
New Mexico Oil Conservation Commission
Post Office Box 871
Santa Fe, New Mexico

Attention: Mr. A. L. Porter, Jr., Secretary Director

Re: Continental Oil Company
application for 120-acre
non-standard gas proration
unit for its Lockhart A-35
No. 1 in Section 35, T21S,
R37E, NMPM, Blinebry Pool,
Lea County, New Mexico

Gentlemen:

Continental Oil Company respectfully requests administrative approval under the provisions of Rule 5C of the Special Rules and Regulations for the Blinebry Gas Pool of Order R-1670 for the formation of a 120-acre non-standard gas proration unit consisting of the E/2 NW/4 and the NW/4 NW/4 of Section 35, Township 21 South, Range 37 East, for its Lockhart A-35 No. 1 well located 660 feet from the north line and 660 feet from the west line of Section 35, Township 21 South, Range 37 East, Lea County, New Mexico, in the Blinebry Gas Pool.

In support of this request we should like to point out that the proposed unit conforms with the requirements of said Rule 5C in all respects as follows:

1. Said proposed non-standard gas proration unit consists of contiguous quarter-quarter sections.
2. Said proposed non-standard gas proration unit lies wholly within a single governmental quarter-section.
3. The entire proposed non-standard gas proration unit may be reasonably presumed to be productive of gas.
4. The length or width of said unit does not exceed 2,640 feet.
5. Copies of this application have been furnished this date by registered mail to all offset operators within the same quarter-section and/or within 1,500 feet of said well.

A plat is attached hereto showing to the best of our knowledge and belief the proposed unit, the location of the No. 1 well and other wells on the lease, offset wells and ownership thereof.

The granting of this application is in the interest of preventing waste and the protection of correlative rights.

In view of the facts set out herein it is respectfully requested that the Commission enter an order approving the non-standard gas proration unit for Continental Oil Company's Lockhart A-35 No. 1 well as described above.

A. B. Slaybaugh
A. B. Slaybaugh
Division Superintendent
of Production
New Mexico Division

Copies to: NMOCC-3
RGP -1
GW -1
JWK -1
JRP -1
File -1

Copies by registered mail to:

Humble Oil & Refining Company
P. O. Box 2617
Hobbs, New Mexico

Sinclair Oil and Gas Company
520 E. Broadway
Hobbs, New Mexico

Moran Oil Producing and Drilling Corporation
903 W. Marland
P. O. Box 1718
Hobbs, New Mexico

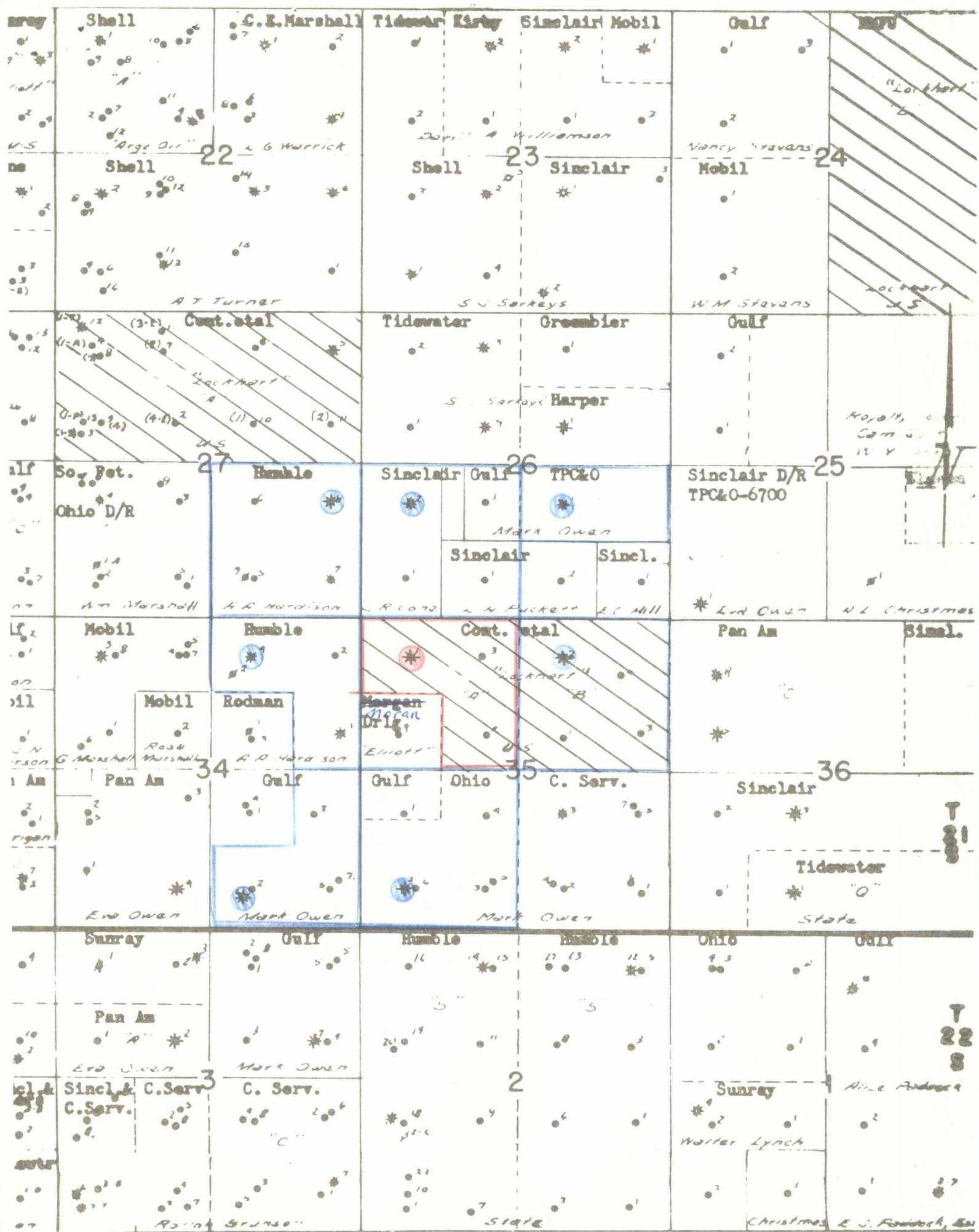

A-37-E

- Proposed Blinebry Gas NSP Unit
- Proposed Gas Well
- Offset Blinebry Gas Units
- Offset Blinebry Gas Wells

CONTINENTAL OIL COMPANY	
Production Department	Eunice, New Mexico
LOCATION PLAT	
LOCKHART A-35	
Date: 7-9-63	Drawn By: MLC/JL
Scale: 1" = 2000'	