

Gulf Oil Corporation

ROSWELL PRODUCTION DISTRICT

July 17, 1964

1964 JUL 20 AM 7:49

P. O. Drawer 1938
Roswell, New Mexico 88201

NSP-688
30 days
aug 19
W. B. Hopkins
DISTRICT MANAGER
M. I. Taylor
DISTRICT PRODUCTION
MANAGER
F. O. Mortlock
DISTRICT EXPLORATION
MANAGER
H. A. Rankin
DISTRICT SERVICES MANAGER

Oil Conservation Commission
State of New Mexico
Post Office Box 2088
Santa Fe, New Mexico

Re: Application of Gulf Oil Corporation for Approval of a Non-Standard 40-Acre Gas Proration Unit, Blinebry Gas Pool, Lea County, New Mexico

Gentlemen:

Gulf Oil Corporation respectfully requests administrative approval of a Non-Standard 40-Acre Blinebry Gas Proration Unit covering the SW/4 SE/4 Section 1, Township 22 South, Range 37 East, Lea County, New Mexico. This non-standard unit is to be attributed to Gulf's Alice Paddock Well No. 1 located 660 feet from the south line and 1980 feet from the east line of this Section 1.

In support of this application, the following facts are submitted:

- (1) Gulf's Alice Paddock Well No. 1 is now a Blinebry Oil well; however, effective August 1, 1964, it is being reclassified as a Blinebry Gas well.
- (2) The proposed non-standard gas proration unit consists of a quarter-quarter section and lies wholly within a single governmental quarter section.
- (3) The entire non-standard gas proration unit is reasonably presumed to be gas productive in the Blinebry Gas Pool.
- (4) The length or width does not exceed 2,640 feet.
- (5) All Operators in this quarter section and within 1500 feet of the Unit Well have been furnished a copy of this application.

Respectfully submitted,

GULF OIL CORPORATION

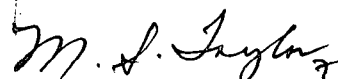

M. I. Taylor

JHH:dch

cc: New Mexico Oil Conservation Commission
Post Office Box 1980
Hobbs, New Mexico 88240
Sunray DX Oil Company
Post Office Box 128
Hobbs, New Mexico 88240

Sinclair Oil & Gas Company
Post Office Box 1470
Midland, Texas 79704
Humble Oil & Refining Company
Post Office Box 1650
Hobbs, New Mexico 88240



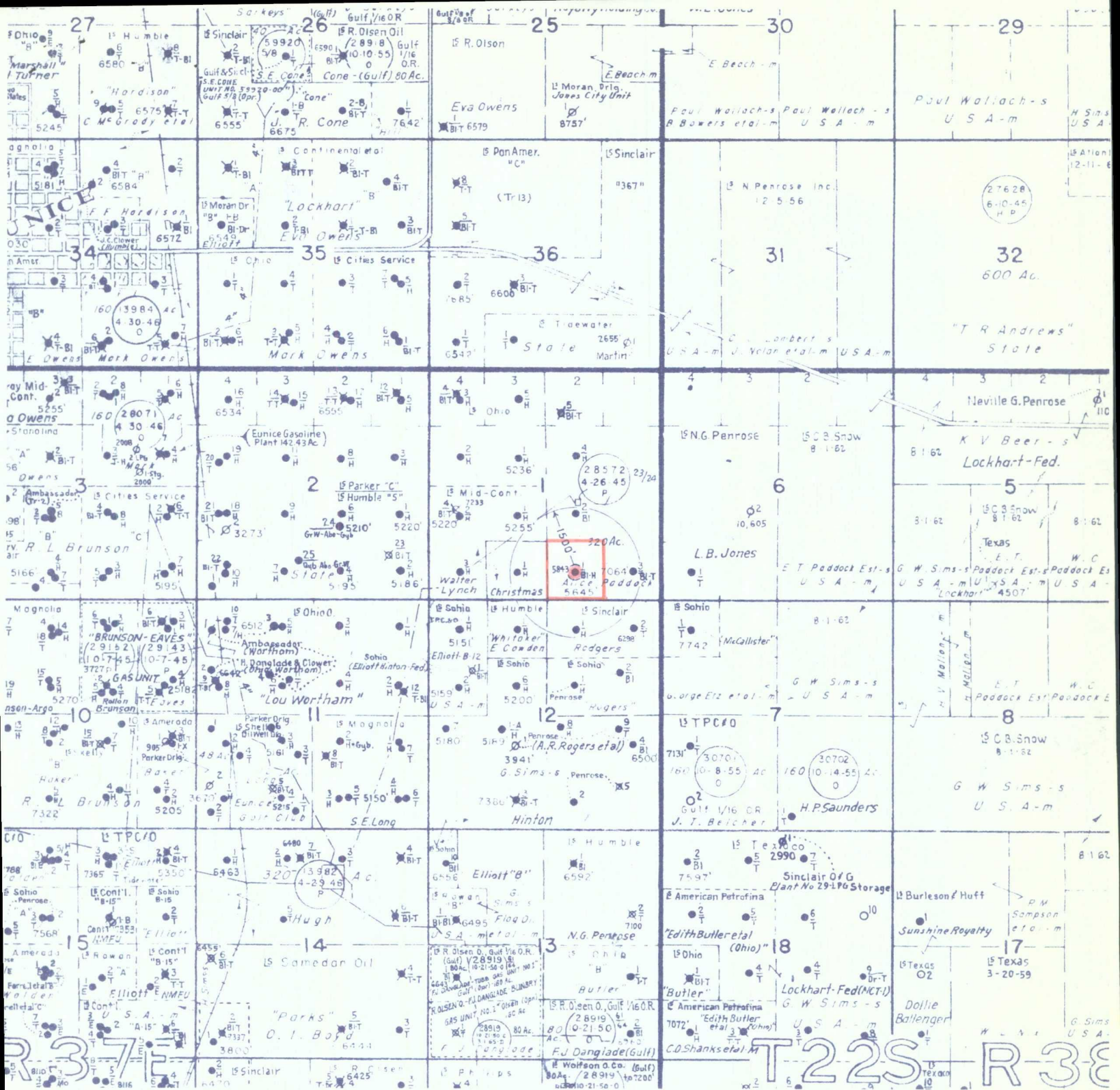

PLAT

**ALICE PADDOCK LEASE
BLINBERRY GAS POOL**

Lea County, New Mexico

- LEGEND -

Proposed Non-Standard Unit

Pertinent Well

Gulf Oil Corporation